

IMPORTANT INSTRUCTIONS AND OPERATING MANUAL

REFRIGERATOR & FREEZERS

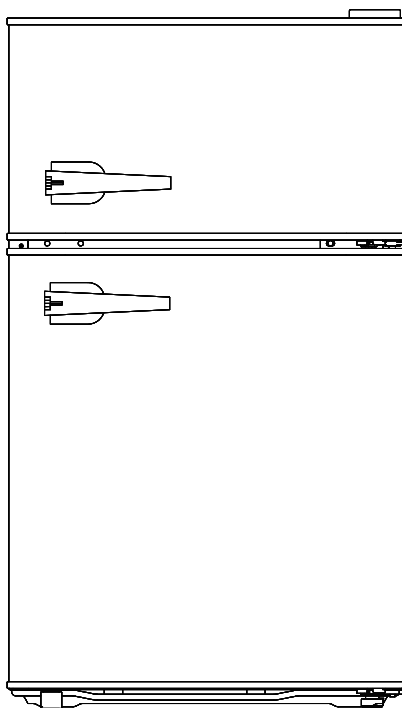

KD-93F



Thank you for purchasing this product! If you have questions about the product such as missing parts, damaged products, product assembling and operation etc., please contact us via Amazon Message or customer service phone: 213-4467172 or 661-4358826.

TABLE OF CONTENTS

PACKING LIST	2
NAMES OF THE PARTS.....	3
IMPORTANT SAFETY INSTRUCTIONS.....	3 - 4
INSTALLATION INSTRUCTIONS	
BEFORE USING YOUR REFRIGERATOR	5
INSTALLING YOUR REFRIGERATOR	5
ELECTRICAL CONNECTION.....	5
OPERATING YOUR REFRIGERATOR	
TEMPERATURE CONTROL.....	6
ICE TRAY	6
THE FREEZER COMPARTMENT	6
WHEN TO DEFROST.....	6
HOW TO DEFROST.....	7
HOW TO CHANGE THE INTERIOR LIGHT	7
CARE AND MAINTENANCE	
CLEANING YOUR REFRIGERATOR	8
VACATION TIME.....	8
MOVING YOUR REFRIGERATOR.....	8
ENERGY SAVING TIPS.....	8
HANDLE INSTALL INSTRUCTION	9
TROUBLESHOOTING GUIDE.....	10 - 11

PACKING LIST

NO.	Description	Quantity
1	Handle	2 pc
2	Ice-making box	1 pc
3	Manual	1 pc

NAMES OF THE PARTS

- (1) Freezer Compartment
- (2) Temperature Control
- (3) Glass Shelf
- (4) Crisper with Glass Cover
- (5) Top Hinge
- (6) Freezer Door
- (7) Refrigerator Door Bin
- (8) Can Holders
- (9) Adjustable Foot

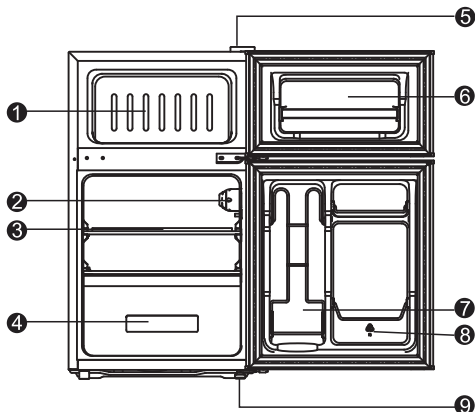

⚡ WARNING ⚡ : Never touch the interior of the Freezer Chamber or frozen foods in the compartment with wet hands as this could result in frostbite.

IMPORTANT SAFETY INSTRUCTIONS

⚡ WARNING ⚡	To reduce the risk of fire, electric shock, or injury when using your refrigerator, follow these basic precautions:
<ul style="list-style-type: none"> • Read all instructions before using the refrigerator. • DANGER or WARNING: Risk of child entrapment. • To avoid the possibility of child entrapment, please take the following precautions before throwing out the refrigerator. <ul style="list-style-type: none"> - Remove all doors from the unit. - Leave the shelves in place so that children may not easily climb inside. • Never allow children to operate, play with, or crawl inside the refrigerator. • Never clean refrigerator parts with flammable fluids. The fumes can create a fire hazard or explosion. • Do not store or use gasoline or any other flammable vapors and liquids in the vicinity of this or any other refrigerator. The fumes can create a fire hazard or an explosion. 	

-Save these instructions-



WARNING

To reduce the risk of fire, electrical shock or injury, follow these basic precautions when using your refrigerator.

- 1) **WARNING**—Keep ventilation openings, in the appliance enclosure or in the built-in structure, clear of obstruction.
- 2) **WARNING**—Do not use mechanical devices or other means to accelerate the defrosting process, other than those recommended by the manufacturer.
- 3) **WARNING**—Do not damage the refrigerant tubing to increase the risk of a leakage when handling, moving and using the refrigerator.
- 4) **WARNING**—Do not use electrical appliances inside the food storage compartments of the appliance, unless they are of the type recommended by the manufacturer.
- 5) **WARNING**—**DANGER**: Never allow children to play with, operate, or crawl inside the refrigerator. Risk of child entrapment. Before you throw away your old refrigerator or freezer:
 - Take off the doors
 - Leave the shelves in place so that children may not easily climb inside.
- 6) The appliance must be unplugged before your maintenance to it.
- 7) This appliance can be used by children older than 8 years old. For persons who are with reduced physical sensory or mental capabilities and those who lack experience and knowledge, this appliance can be used if they understand the hazards involved and have been given supervision or instruction concerning the use of the appliance in a safe way.
- 8) If the component part is damaged, it must be replaced by the manufacturer, its service agent or similarly qualified persons in order to avoid a hazard.
- 9) Please abandon the refrigerator according to local regulations as the unit contains flammable blowing gas and refrigerant.
- 10) Follow local regulations regarding disposal of the appliance due to flammable refrigerant and blowing gas. All refrigeration products contain refrigerants, which under the guidelines of federal law must be removed before disposal. It is the consumer's responsibility to comply with federal and local regulations when disposing this product.
- 11) This appliance is intended to be used in household and similar environments such as
 - staff kitchen areas in shops, offices and other working environments;
 - farm houses, by clients in hotels and motels, and other residential type environments;
 - bed and breakfast type environments;
 - catering and similar non-retail applications.
- 12) Do not store or use gasoline or any inflammable liquors and liquids inside or close to refrigerator.
- 13) Do not use an extension cord with this appliance. If the power cord is too short, have a qualified electrician install an outlet near the appliance. Use of an extension can negatively affect the unit's performance.



Caution: risk of fire



IT IS HAZARDOUS FOR ANYONE OTHER THAN AUTHORIZED SERVICE PERSONNEL TO REPAIR THE ITEM INCLUDING THE REMOVAL OF COVERS.



TO AVOID THE RISK OF AN ELECTRIC SHOCK DO NOT ATTEMPT REPAIRS YOURSELF.

INSTALLATION INSTRUCTIONS

Before Using Your Refrigerator

- Remove the exterior and interior packing.
- Before connecting the refrigerator to the power source, let it stand upright for approximately 4 hours. This will reduce the possibility of a malfunction in the cooling system from improper handling during transportation.
- Clean the interior surface with lukewarm water using a soft cloth. (Cleaning instruction on page 8)

Installing Your Refrigerator

- This appliance is designed to be free-standing only, and should not be recessed or built-in.
- Place your refrigerator on a floor that is strong enough to support the refrigerator when it is fully loaded.
- The clearance between the wall and the back, left, and right sides of the unit should be 5 inches, which allows the proper air ventilation.
- Keep the refrigerator away from direct sunlight and sources of heat (stove, heater, radiator, etc.). Direct sunlight may affect the acrylic coating and heat sources may increase electrical consumption. Ambient temperature below 50 °F or above 85 °F will hinder the performance of this appliance. This unit is only designed for indoor use.
- Avoid locating the refrigerator in moist areas.
- Plug the refrigerator into a specialized grounding wall outlet that is properly installed. Do not cut or remove the third (ground) prong from the power cord under any circumstances. Any questions concerning power and grounding should be referred to the certified electrician or the authorized service center. This unit is not designed to be installed in an RV or used with an inverter.
- After plugging the appliance into a wall outlet, turn the unit on and allow the unit to cool down for 2-3 hours before placing food in the refrigerator or the freezer compartment.

Electrical Connection

⚡WARNING⚡

Improper use of the grounded plug can result in the risk of electric shock. If the power cord is damaged, have it replaced by an authorized service center.

This refrigerator should be properly grounded for your safety. The power cord of this refrigerator is equipped with a three-prong plug which matches with standard three-prong wall outlets to minimize the possibility of electric shock.

Do not, under any circumstances, cut or remove the third ground prong from the power cord supplied.

The refrigerator requires a standard 115Volt A.C., 60Hz electrical three-prong grounding outlet.

This refrigerator is not designed to be used with an inverter.

The cord should be secured behind the refrigerator and it cannot be left exposed or dangling to prevent accidental injury.

Never unplug the refrigerator by pulling the power cord. Always grip the plug firmly and pull it straight out from the receptacle.

Do not use an extension cord with this appliance. If the power cord is too short, have a qualified electrician or service technician install an outlet near the appliance. Use of an extension cord can negatively affect the performance of the unit.

If you have questions about the product such as missing parts, damaged products, product assembling and operation etc., please contact us via Amazon Message or customer service phone: 213-4467172 or 661-4358826.

OPERATING YOUR REFRIGERATOR

Temperature Control

- Your refrigerator has one control for regulating the temperature. The temperature control is located on the top center of the refrigerator compartment.
- The first time you turn the unit on, adjust the temperature control knob to "7" and let it run for at least 2 hours before putting foods inside.
- The range of the refrigerator temperature control is from position "1", the cold, to "7", the coldest. Adjust the temperature control to the setting which suits your needs best. The setting of "4" should be appropriate for home or office refrigerator use.
- Turning the temperature control knob to "o" position can stop the cooling cycle but does not shut off the power of the unit.

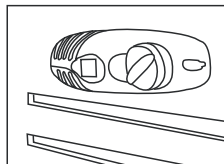

NOTE:

- If the unit is unplugged, it will lose power; you must wait 3 to 5 minutes before restarting the unit. If you attempt to restart it before this time delay, the refrigerator will not start up.
- Large amounts of food will decrease the cooling efficiency of the appliance.
- Do not place the foods on the air outlet. Please leave space for airflow.
- If you choose to change the thermostat setting, adjust thermostat control by one increment at a time. Allow several hours for temperature to stabilize between adjustments.

Ice Tray

- Recommended temperature control setting for ice making is "7".
- Fill the ice cube tray (2/3 capacity) with cold water and place the tray on the bottom of the chiller compartment to do the freezing properly.
- To eject the ice cubes from the tray, place them over the ice bucket and twist it slightly.
- Re-set the temperature control to setting "4".

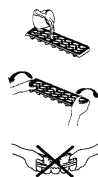

The Freezer Compartment

- This compartment is designed for the long-term storage of frozen food.
- The storage life of frozen foods varies and the recommended storage time should not be exceeded.
- Place frozen food into the freezer as quickly as possible after purchase. If there are instructions on the packet, carefully follow these instructions regarding the storage time.

When To Defrost

This unit is not designed to defrost automatically. In order to prevent damage to the interior liner of the unit from excessive frost build-up, please manually defrost the unit every 3 months or defrost it when ice / frost is approximately 1/4 " thick inside the freezer compartment.

How To Defrost

Defrost the freezer compartment when the ice / frost is approximately 0.2 - 0.4 inch thick or every 3 months whichever comes first. Set the thermostat dial to "O" to defrost. Remove all contents from the freezer compartment. Leave the freezer door open to allow accumulated ice / frost to melt off. Remove large pieces of ice if needed. Do not use hot water or other electric-heating devices to melt the accumulated ice. After defrosting, remove accumulated ice / water, wipe and dry the freezer compartment with a soft cloth. In the event that the ice is not visibly present in the freezer compartment, please allow the evaporator located behind the freezer wall to completely defrost for approximately 2 hours before restarting the unit. Restart the unit following starting instructions.

How To Change The Interior Light

NOTE: All parts removed must be saved to do the reinstallation of the light bulb. Before removing the light bulb, unplug the appliance from the power supply. Failure to do so could result in electric shock or personal injury.

1. Remove the lamp cover.
2. Unscrew the old bulb and install the new bulb.
3. Re-install the lamp cover.

CARE AND MAINTENANCE

Cleaning Your Refrigerator

- Upon installation of your new appliance, cleaning it thoroughly is highly recommended.
- Turn off the refrigerator first and then unplug the unit from the wall outlet.
- Remove all food inside.
- Wash the inside with a damp warm cloth soaked in lukewarm water and baking soda solution. The solution should be about 2 tablespoons of baking soda to a quart of water.
- Be sure to keep the door gasket (seal) clean to keep the unit running efficiently.
- The outside of the refrigerator should be cleaned with mild detergent and warm water.
- Dry the interior and exterior with a soft cloth.

Vacation Time

- Turn off the refrigerator first and then unplug the unit from the wall outlet.
- Remove all the food.
- Clean the refrigerator.
- Leave the door open slightly to avoid possible formation of condensation, mold, or odor.
- Pay close attention to children. The unit should not be accessible to children's games.
- **Short vacations:** Leave the refrigerator operating during vacations of less than three weeks.
- **Long vacations:** If the appliance will not be used for several months, remove all the food inside and unplug the power cord. Clean and dry the interior thoroughly. To prevent odor and mold growth, leave the door open slightly: keep it open if necessary or have the door removed.

Moving Your Refrigerator

- Turn off the refrigerator first and then unplug the unit from the wall outlet.
- Remove all the food.
- Securely take down all loose items inside your refrigerator.
- Tape the doors shut.
- Be sure the refrigerator stays in the upright position during transportation.

Energy Saving Tips

- The refrigerator should be located in the coolest area of the room, away from heat-producing appliances or direct sunlight.
- Let hot food cool down to room temperature before putting it into the refrigerator. Overloading the refrigerator will force the compressor to run longer. Foods that freeze too slowly may lose quality.
- Be sure to wrap foods properly, and wipe containers dry before placing them in the refrigerator. It can reduce frosting in the refrigerator.
- Organize and label food to reduce door openings and extended searches. Remove as many items as needed at one time, and close the door as soon as possible.

HANDLE INSTALL INSTRUCTION

Please note that the Handle parts are inseparable once joined. Please ensure that the handle base is screwed firmly on the door before joining the actual handle part onto its base.

- **Take out the handle from the unit and remove the package (two handle parts and two screws).**
- **Use a screwdriver to fix the handle bottom on the door using the two screws.**
- **Push the handle horizontally until it clicks in.**
- **Push and pull the handle to make sure that it is installed completely.**

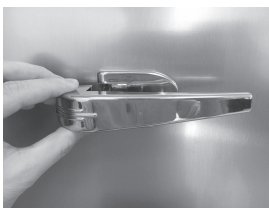

TROUBLESHOOTING GUIDE

You can solve many common refrigerator problems easily, saving you the cost of a possible service call. Try the suggestions below to see if you can solve the problem before calling for service.

PROBLEM	POSSIBLE CAUSE
Refrigerator does not operate.	It is not plugged in. The circuit breaker has tripped or a fuse has blown.
Compressor turns on and off frequently.	The room temperature is hotter than normal. A large amount of food has been added to the refrigerator. The door opens too often. The door is not closed completely. The temperature control is not set correctly. The door gasket does not seal properly. The refrigerator does not have the correct clearances. The refrigerator has recently been disconnected for a period of time. 4 hours are required for the refrigerator to cool down completely.
Temperature inside the refrigerator is too warm.	Temperature control is set too warm. Turn the control to a cooler setting and allow several hours for the temperature to stabilize. The door is kept open too long or is opened too frequently. Warm air enters the refrigerator every time the door is opened. Open the door less often. The door is not closed completely. The door gasket does not seal properly. A large amount of warm or hot food might have been stored recently. Wait until the refrigerator has had a chance to reach its selected temperature. The refrigerator has recently been disconnected for a period of time. 4 hours are required for the refrigerator to cool down completely.
Temperature inside the refrigerator is too cold.	Temperature control is set too cold. Turn the control to a warmer setting and allow several hours for the temperature to stabilize.
Temperature of external refrigerator surface is warm.	The exterior refrigerator walls can be as much as 30°F warmer than room temperature. This is normal while the compressor works to transfer heat from inside the refrigerator cabinet.
Popping or cracking sound when compressor comes on.	Metal parts undergo thermal expansion in response to the changes in temperature. This is normal. Sound will level off or disappear as refrigerator continues to run.
Bubbling or gurgling sound, like water boiling.	Refrigerant (used to cool refrigerator) is circulating throughout the system. This is normal.
Vibrations.	Check to ensure that the refrigerator is on a level surface. Floor is uneven or weak. Refrigerator rocks on the floor when it is moved slightly. Be sure the floor can adequately support the refrigerator. Level the

	<p>refrigerator by putting wood or metal shims under parts of the refrigerator.</p> <p>The refrigerator is touching the wall. Re-level the refrigerator and move it from the wall.</p> <p>See "Installation Instructions".</p>
Moisture forms on the inside of the refrigerator walls.	<p>Weather is hot and humid, which increases the rate of a frost build-up. This is normal.</p> <p>The door is slightly open.</p> <p>The door is kept open too long, or it opens too frequently. Open the door less often.</p> <p>The door is not sealed properly.</p>
Moisture forms on the outside of the refrigerator.	<p>The door is slightly open, causing cold air from inside the refrigerator to meet warm moist air from outside.</p>
The door will not close properly.	<p>The refrigerator is not on a level surface.</p> <p>The gasket is dirty.</p>