

Assembly Instructions

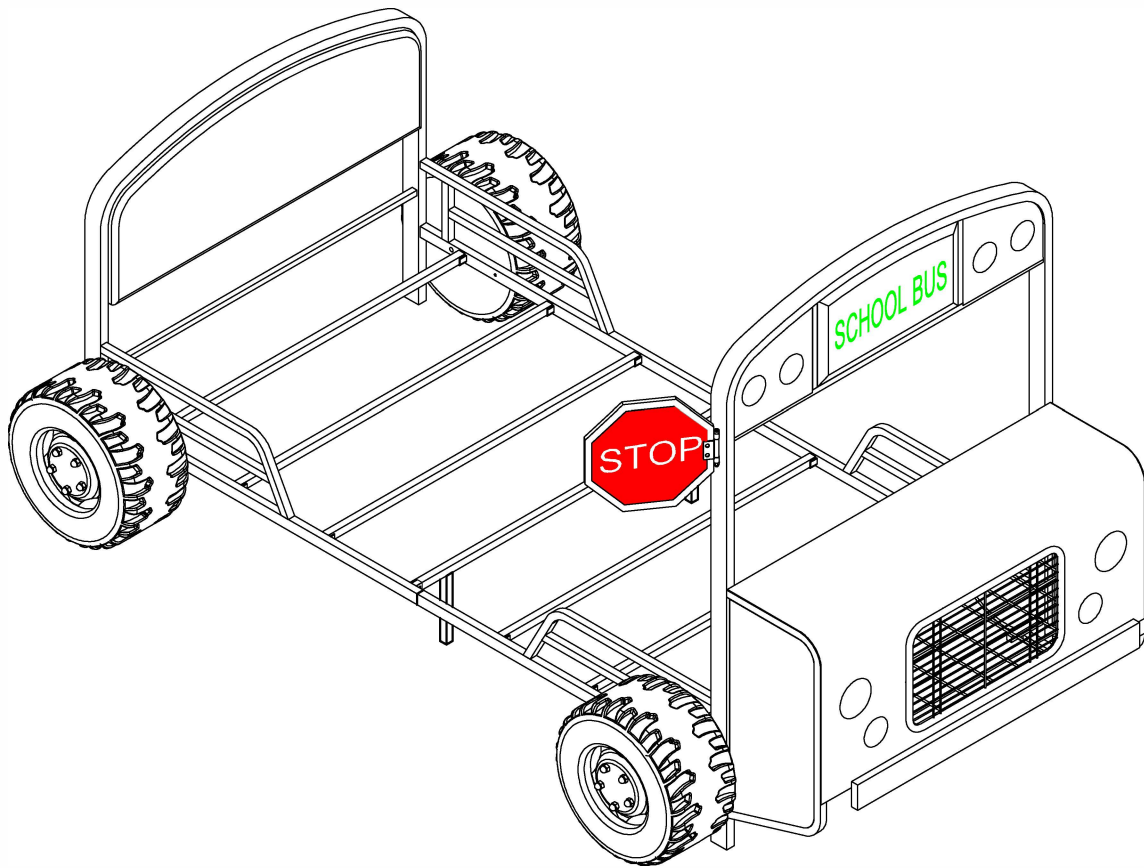

ASSEMBLY RATING

The Assembly Rating is a 5-point system that shows the degree of effort needed in assembling a specific product (with 1 being easy and 5 being difficult). For some products, two persons are recommended.

EASY



DIFFICULT

Tools Required For Assembly:

Allen Wrench

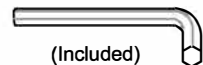

(Included)

Phillips Screwdriver



(Not Included)



2 PERSONS RECOMMENDED

ASSEMBLY & CARE ADVICE

FOR YOUR FURNITURE TO LAST, CORRECT ASSEMBLY AND PROPER MAINTENANCE ARE NECESSARY. PLEASE FOLLOW THE INFORMATION PROVIDED BELOW TO FULLY ENJOY YOUR FURNITURE.

BASIC ASSEMBLY TECHNIQUES

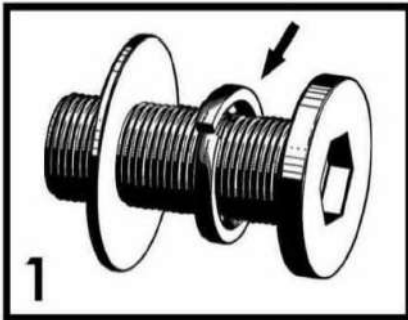

When lock or spring washer is used in an assembly, please make sure the lock or spring washer is placed between the larger flat washer and the head of the screw or bolt.

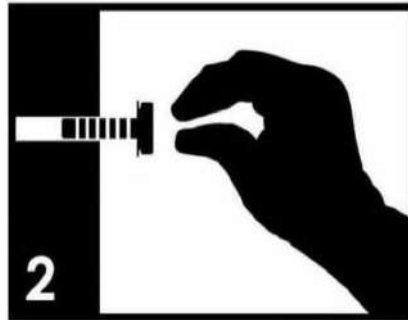

Position each part correctly and insert screws or bolts into their respective holes by hand tighten or using the proper hand tool. Only tighten when step is completed or when instructed to do so.

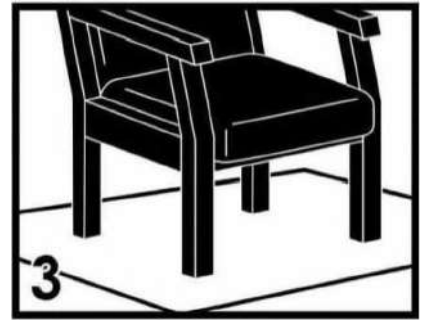

Use cardboard or carpet area when assembling furniture to prevent scratches. Make sure the furniture rests on a flat and level surface with each leg evenly touching the floor.

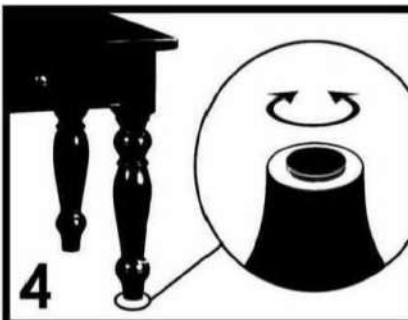

Some furniture comes with height adjustment knobs underneath each leg. To lower or to raise each leg, you need to turn clockwise or counterclockwise, respectively.

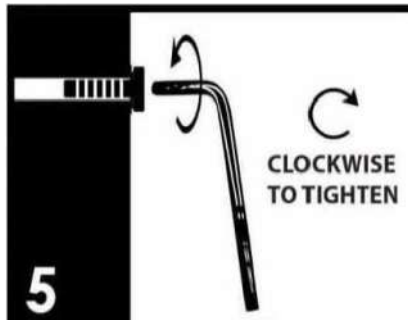

Make sure all parts are properly aligned, then use the appropriate hand tool to completely tighten the bolts or screws. Do not use power tools and do not overtighten.

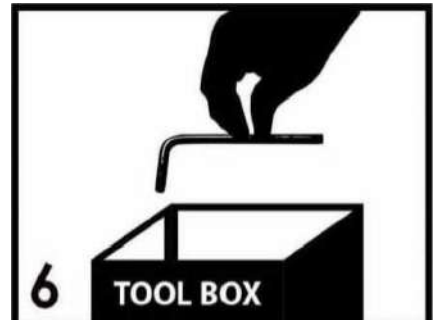

Save the instructions and store the Allen wrench or any supplied tool for later maintenance. After two weeks, check and tighten any loose hardware and repeat again every six months thereafter.

IT IS THE USER'S RESPONSIBILITY TO MAINTAIN THE FURNITURE. THE HARDWARE MAY LOOSEN OVER TIME AND MAY CAUSE THE FURNITURE TO BE WOBBLY AND UNABLE TO SUPPORT ITS INTENDED WEIGHT CAPACITY. THIS MAY LEAD TO COLLAPSE AND MAY CAUSE SERIOUS INJURY.



FAILURE TO FOLLOW THE GUIDELINES ABOVE MAY RESULT IN INJURY AND/OR PROPERTY DAMAGE.

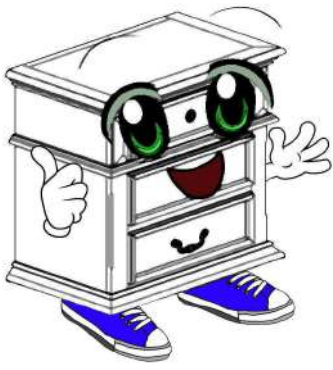

Before you begin, please read Page 2 of "Assembly and Care Advice".

And remember, do not tighten until each step is completed or instructed.

Parts List

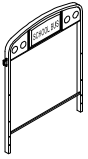

#1 x 1pc
Footboard Support



#2 x 1pc
Headboard

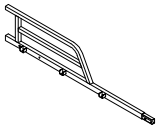

#3 x 2pcs
Right Panel

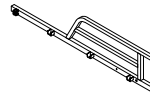

#4 x 2pcs
Left Panel

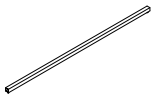

#5 x 6pcs
Middle Foundation Bar

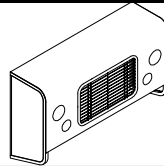

#6x 1pc
Footboard

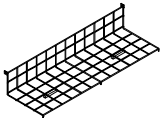

#7 x 1pc
Footboard Frame

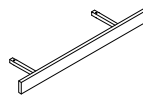

#8 x 1pc
Footboard Panel



#9 x 1pc
Warning board



#10 x 4pcs
Wheel



#11 x 4pcs
Wheel Cover

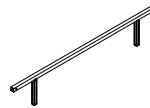

#12 x 1pc
Middle Support



Before you begin, please read Page 2 of "Assembly and Care Advice".

And remember, do not tighten until each step is completed or instructed.

Hardware List



#A x 8pcs
Antiskid Bolt 1/4"X3"



#B x 4pcs
Bolt 1/4"X1-1/4"



#C x 10pcs
Bolt 1/4"X 5/8"

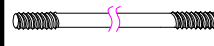

#D x 4pcs
Washer



#Ex 4pcs
Bolt (5/16" x 3/4")



#Fx 2pcs
Bolt (1/4" x 3/8")



#G x 4pcs
Bolt 1/4"X3"



#H x 4pcs
Screw

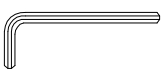

#I x 1pc
Allen Wrench M5



#J x 2pcs
Allen Wrench M4



#1

Insert the right panel (#3) into the left panel (#4). Insert 2 bolts (#C) into each and secure using the Allen wrench (#J).

#C x 4pcs

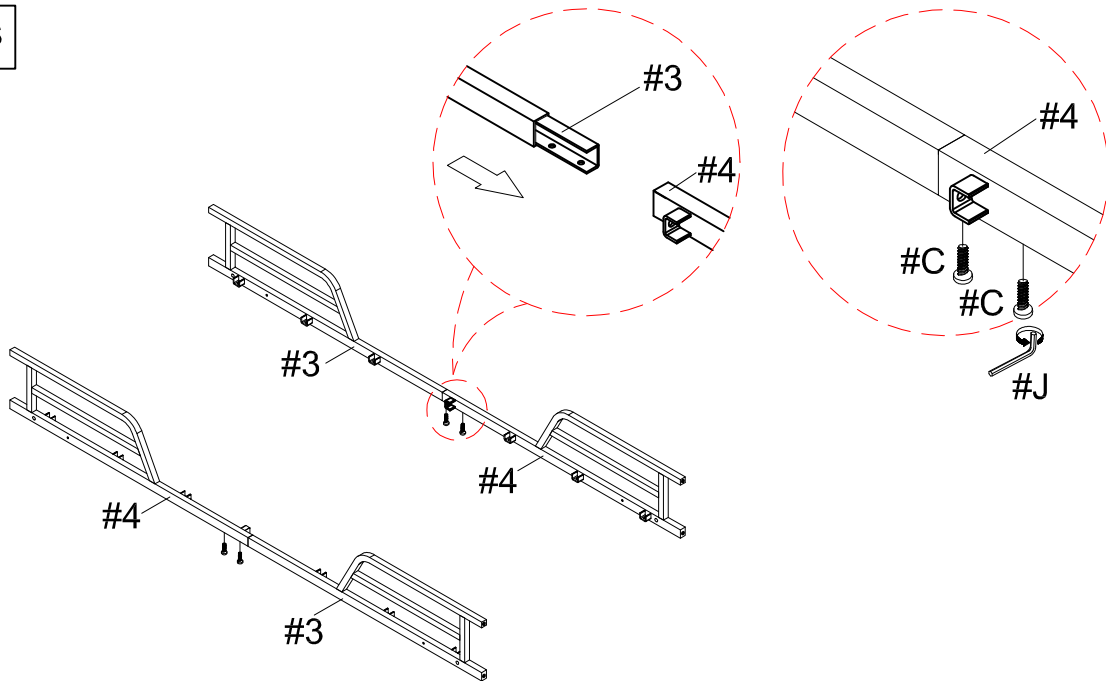

#2

#A x 8pcs
#C x 2pcs
#F x 2pcs

- I. Align the panels to the pre-drilled holes on the head board (#2) and footboard support (#1).
- II. Insert anti-skid bolts (#A) into each end and secure using the Allen wrench (#J).

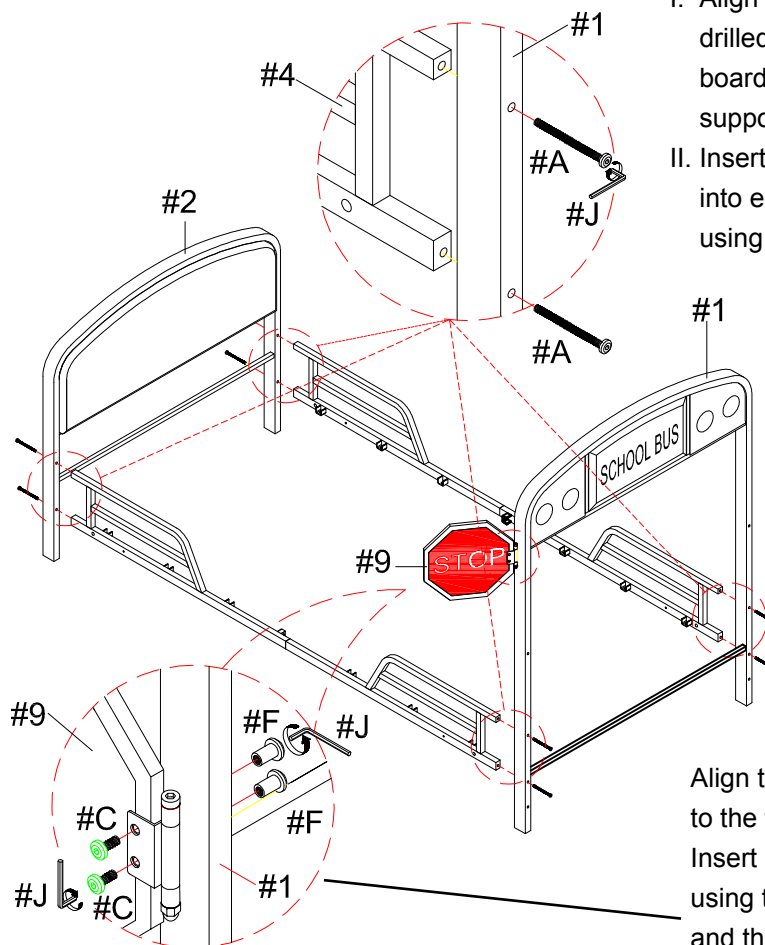

Align the warning board (#9) to the footboard support (#1). Insert 2 bolts (#C), secure using the Allen wrench (#J) and then insert bolt (#F) on the other side and secure.



#3

#C x 2pcs

- I. Insert the middle support (#12) into the center slot along the sides of the panels. Apply bolts (#C) into each end of the middle support (#12) and secure using the Allen wrench (#J).
- II. Then insert the 6 middle foundation bars into the remaining designated slots along the sides of the panels as displayed.

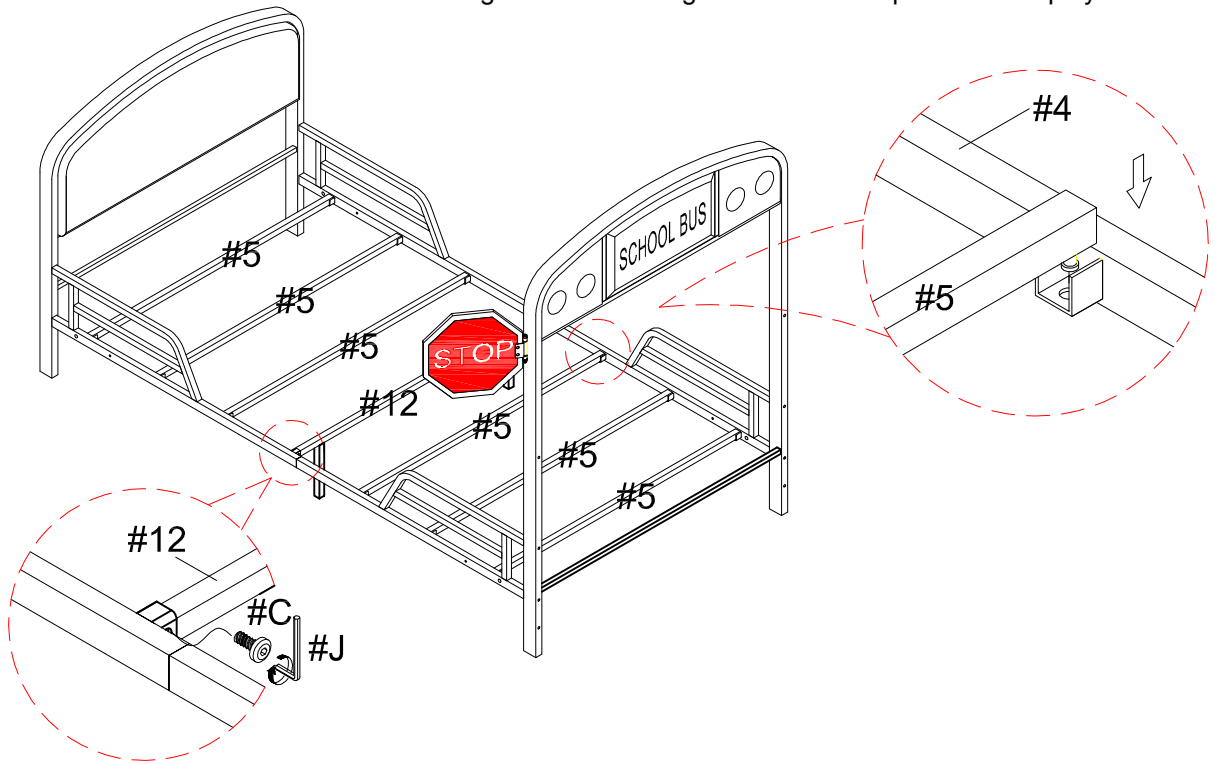

#4

#G x 4pcs

Align the footboard (#6) to the pre-drilled holes on the footboard support (#1). Insert 2 bolts (#G) on top and 2 bolts (#G) on the bottom. Secure using the Allen wrench (#J).

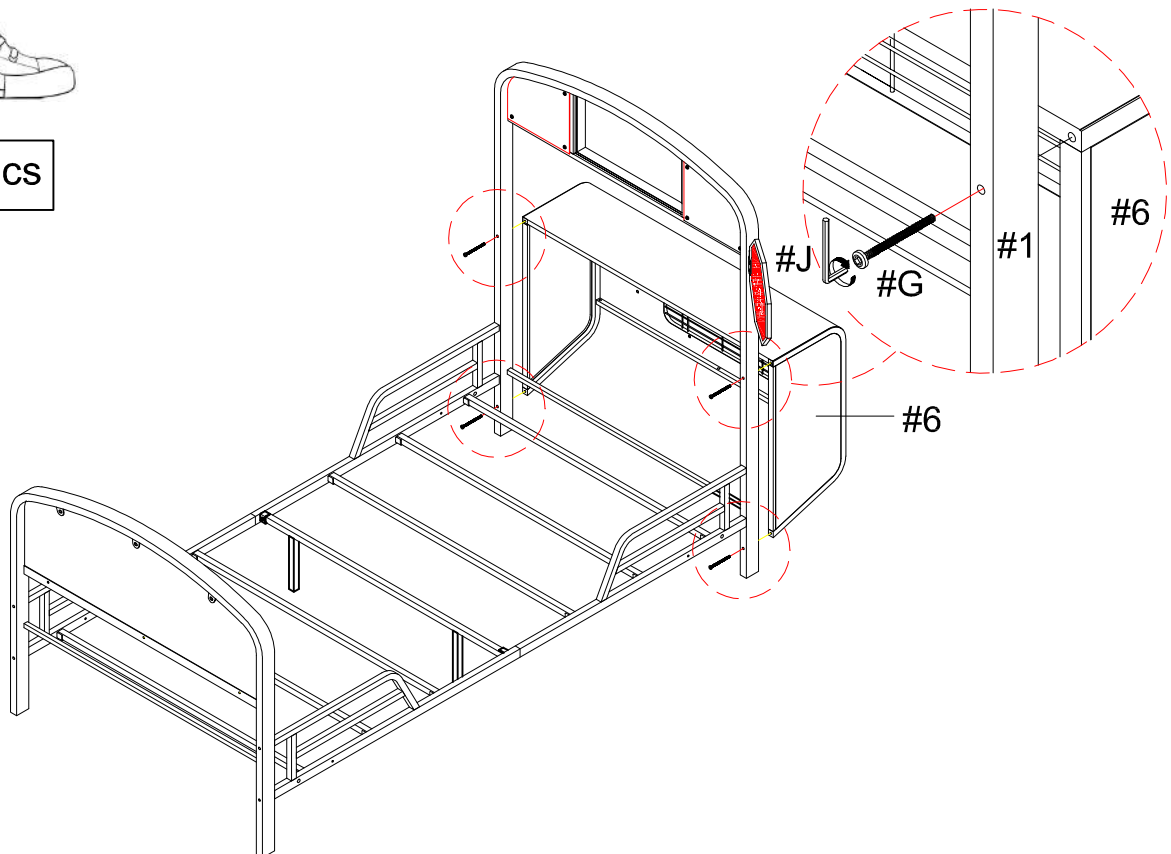



#C x 2pcs

- I. Hook the footboard frame (#7) to the front of the footboard (#6).
Align the top of the footboard frame (#7) to the sides of the footboard support (#1).
- II. Insert a bolt (#C) into each side and secure using the Allen wrench (#J).

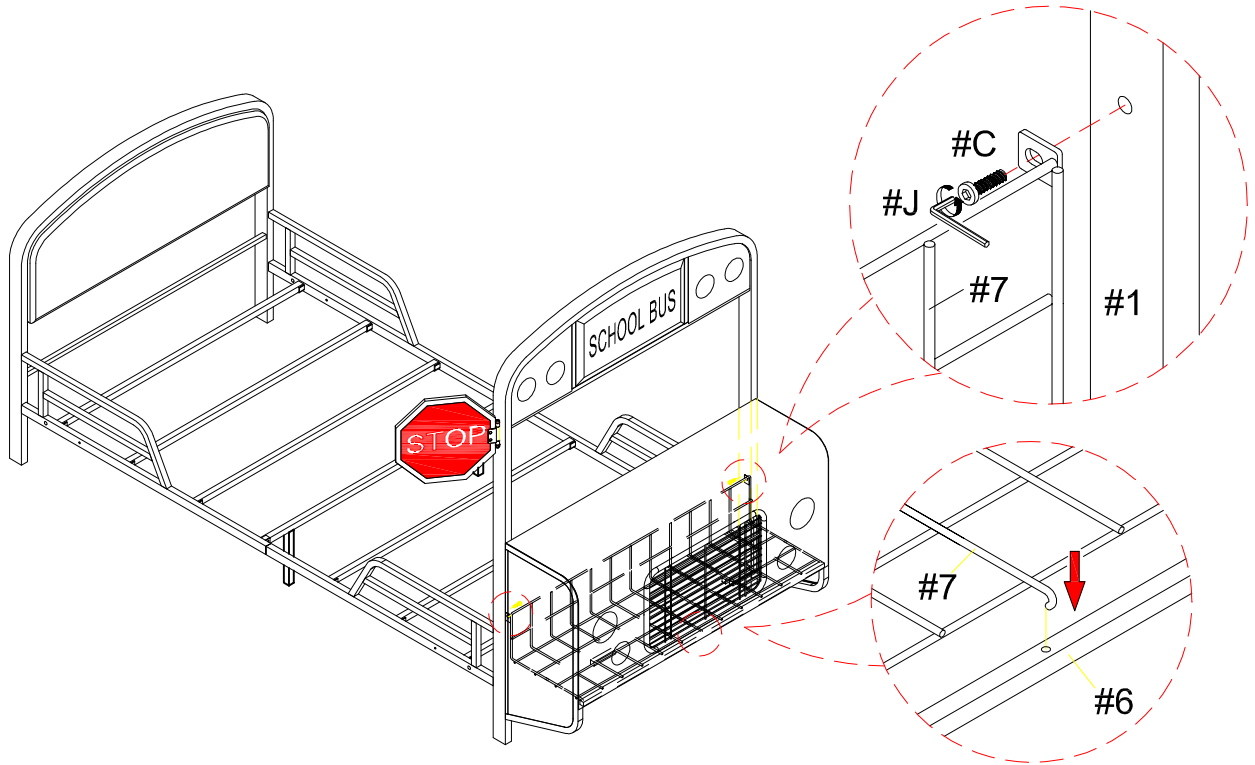

#B x 4pcs

- I. Align the footboard panel (#8) to the footboard (#6).
- II. Insert 4 bolts (#B) and secure using the Allen wrench (#J).

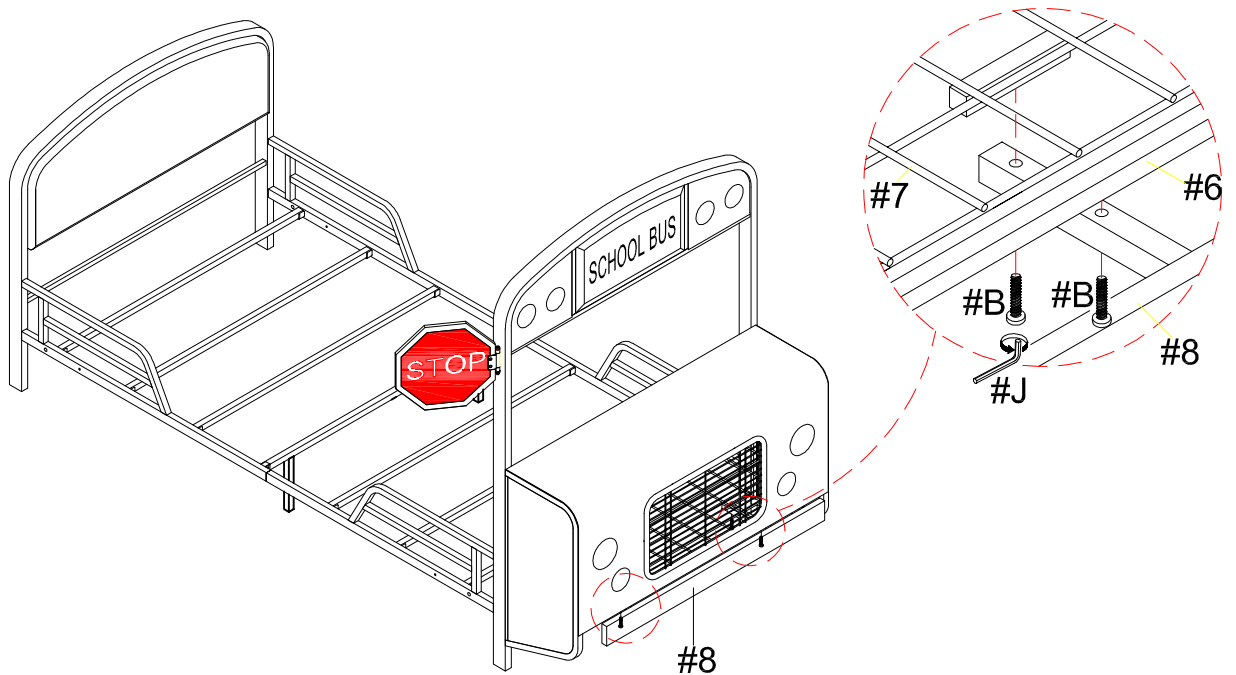



#D x 4pcs
#E x 4pcs
#H x 4pcs

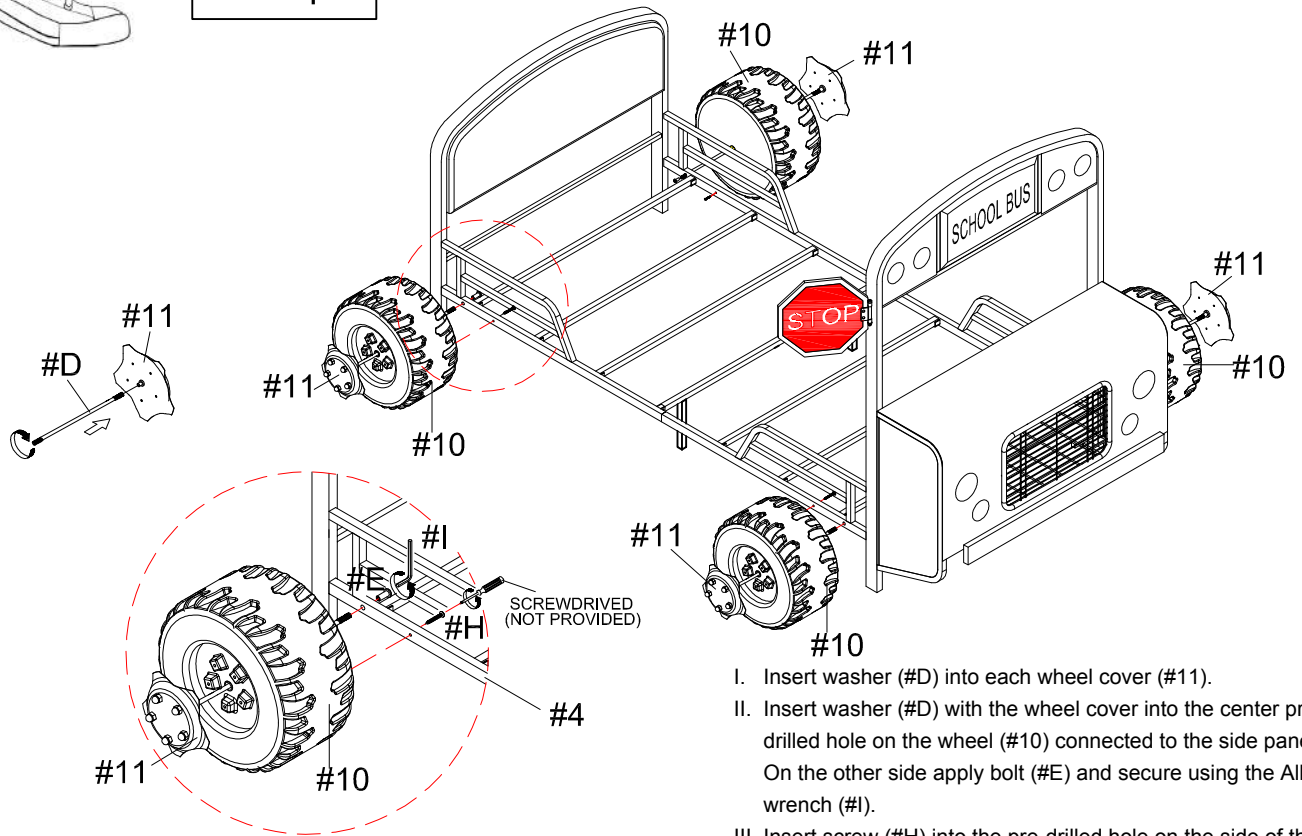

- I. Insert washer (#D) into each wheel cover (#11).
- II. Insert washer (#D) with the wheel cover into the center pre-drilled hole on the wheel (#10) connected to the side panels. On the other side apply bolt (#E) and secure using the Allen wrench (#I).
- III. Insert screw (#H) into the pre-drilled hole on the side of the wheel and secure using the Phillips screwdriver.

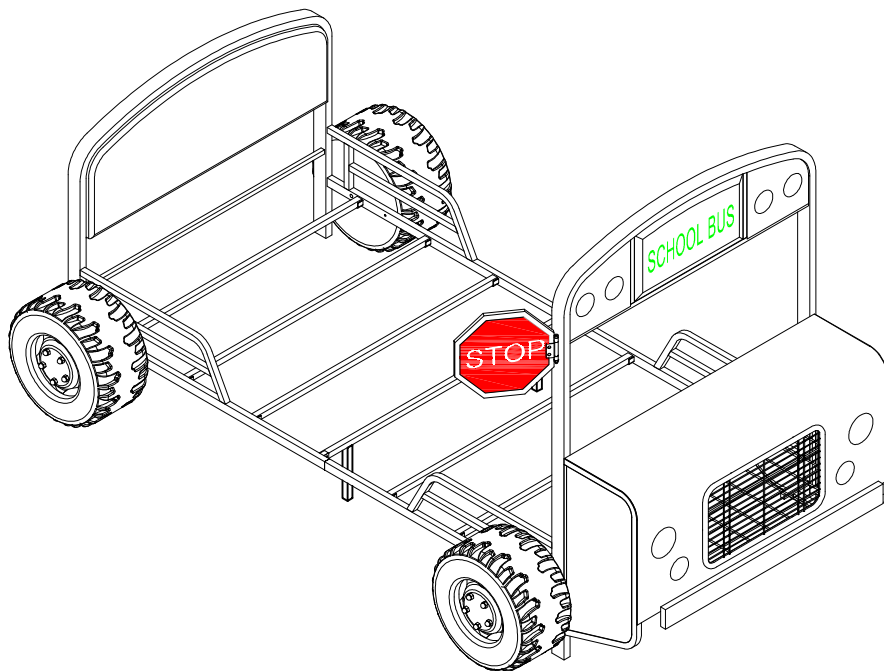

ASSEMBLY IS COMPLETED