

# ASSEMBLY AND DRESSING INSTRUCTIONS

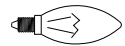

All electrical components must be installed by a licensed electrician in accordance with the National Electric Code and the appropriate local electrical codes.



You will need 5- Cand, Bulb  
40 Watts Recommended  
60 Watts Max  
Bulb not included.

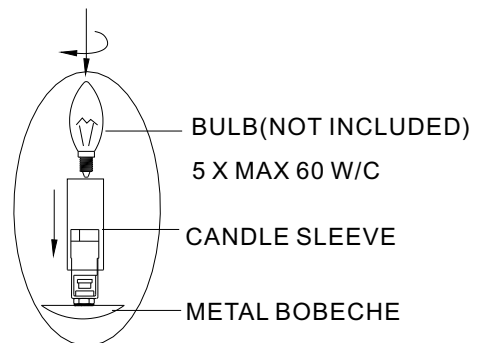
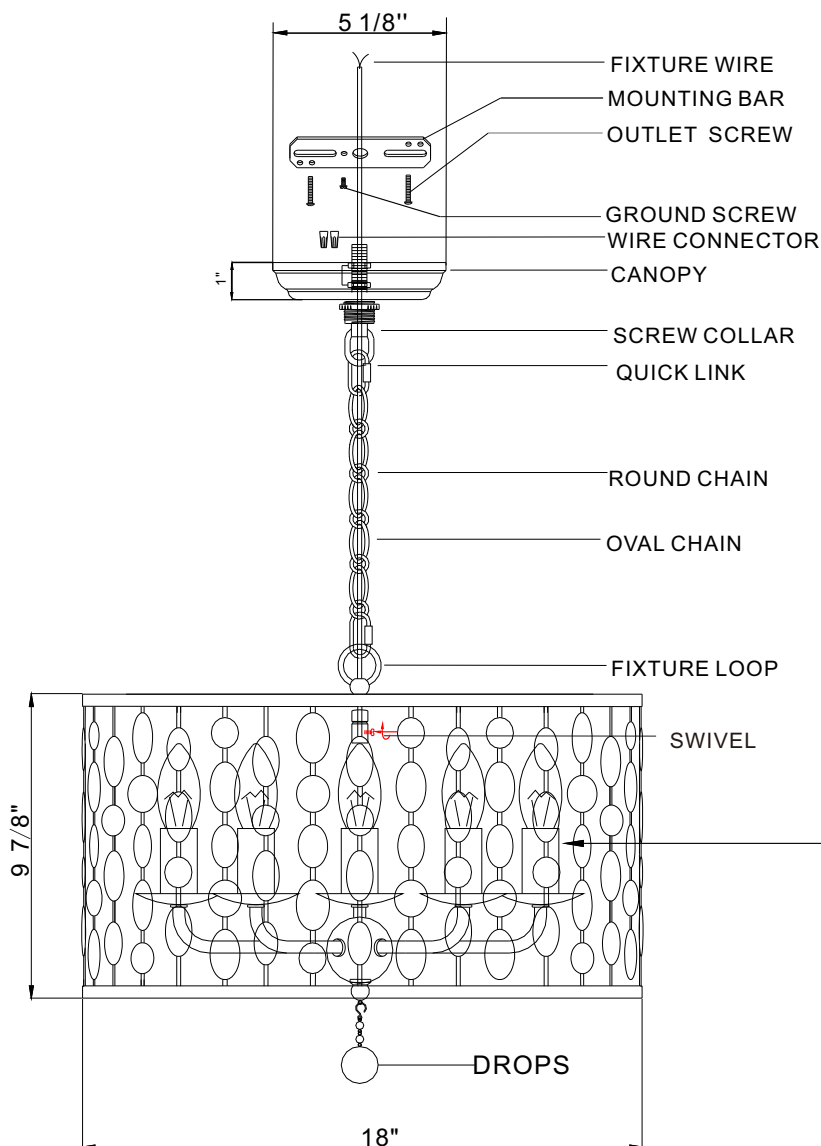

DROPS = ( 10mm brass bead x 2 pcs + 60mm brass bead x 1 pcs ) x 1 sets