

Articulating Ceiling TV Mount

MOUNT-VC02A

Assembly Manual



WARNING



If you do not understand these directions, or if you have any doubts about the safety of the installation, please contact our product support team at 309-278-5303 or help@vivo-us.com for further assistance. Check carefully to make sure there are no missing or defective parts. Failure to report missing parts within 30 days may result in denial of free replacement. Improper installation may cause damage or serious injury. Do not use this product for any purpose that is not explicitly specified in this manual. Do not exceed weight capacity. We cannot be liable for damage or injury caused by improper mounting, incorrect assembly or inappropriate use.



WARNING: CHOKING HAZARD

SMALL PARTS - NOT FOR CHILDREN UNDER 3 YEARS. ADULT SUPERVISION IS REQUIRED.



DO NOT EXCEED WEIGHT CAPACITY

FAILURE TO DO SO MAY RESULT IN SERIOUS INJURY.



WARNING: DO NOT INSTALL INTO DRYWALL ALONE

VERIFY YOUR WALL CONSTRUCTION. USE WOOD STUDS TO MOUNT. We include mounting for brick and concrete walls. If unsure, please contact us at vivo-us.com, email at help@vivo-us.com, or call us at 309-278-5303.

Need Help? We're Here For You

US-Based Customer Support from Trained Professionals

Monday-Friday from 7am-7pm CST

Saturday 8am-4pm CST



Email Us

help@vivo-us.com



Chat with Live Agent

www.vivo-us.com



Give Us a Call

309-278-5303 ext. 1



Assembly Video & Product Info

www.vivo-us.com/products/mount-vc02a

Package Contents

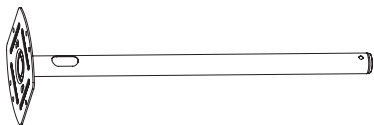

A (x1)
Mounting Pole

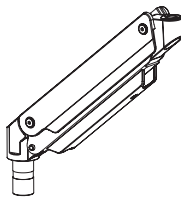

B (x1)
Arm



C (x1)
Arm Support



D (x1)
VESA Bracket

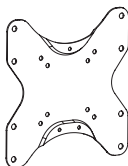

E (x1)
Large VESA
Plate

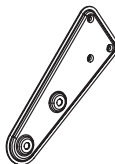

F (x2)
VESA Extension Set

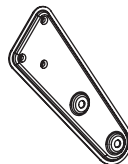

G (x2)
VESA Extension Set

Included Hardware



S-A (x1)
Hex Spacer

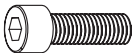

S-B (x1)
M8x25mm
Screw



S-C (x8)
M6x8mm
Screw



S-D (x4)
M5x8mm
Screw



S-E (x1)
M8x50mm
Screw



S-F (x4)
M5 Nut



S-G (x1)
M8 Nut

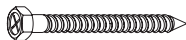

W-A (x4)
ST6.3x55mm
Screw

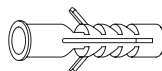

W-B (x4)
Concrete Anchor



W-C (x8)
M6 Washer

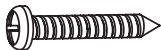

W-D (x4)
ST6.3x38mm
Screw



W-E (x4)
Drywall
Anchor

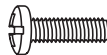

M-A (x4)
M4x12mm
Screw

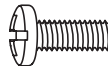

M-B (x4)
M5x12mm
Screw

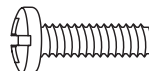

M-C (x4)
M6x20mm
Screw



M-D (x4)
M6x30mm
Screw



M-E (x4)
M8x20mm
Screw

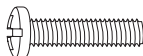

M-F (x4)
M8x35mm
Screw



M-G (x4)
M5 Washer



M-H (x4)
M8 Washer



M-I (x4)
Small Spacer



M-J (x4)
Large Spacer

Included Tools



T-A (x1)
3mm Allen
Wrench



T-B (x1)
6mm Allen
Wrench

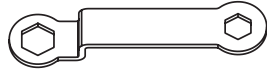

T-C (x1)
8-10mm Wrench



T-D (x1)
10-13mm Wrench

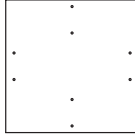

T-E (x1)
Template

Tools Needed:



**Phillips
Screwdriver**



Drill

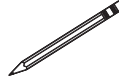

Pencil



Stud Finder

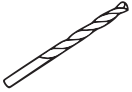

**3/16" (4.5mm)
Drill Bit**

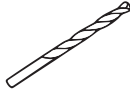

**3/8" (10mm)
Drill Bit**

Weight Capacity:



Assembly Options

Determine your intended mounting surface and follow instructions as identified below.

- Option 1 -
Drywall
Page 6

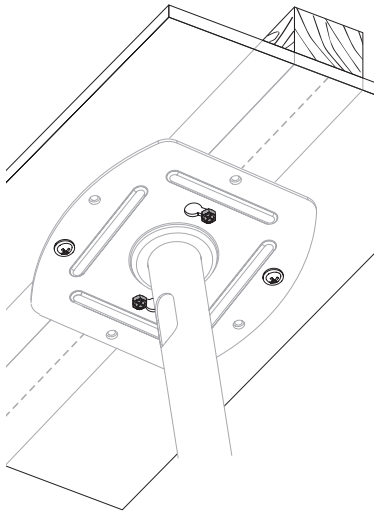

- Option 2 -
Concrete
Page 9

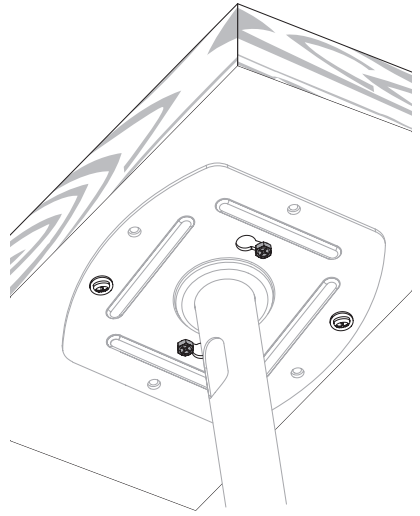

- Option 3 -
Solid Wood
Page 12

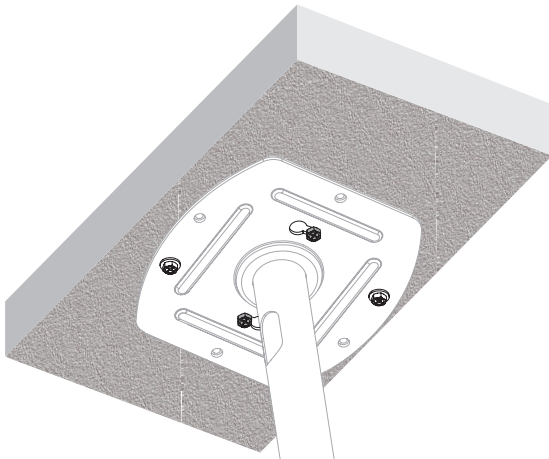

Option 1: Drywall Mounting

STEP 1

Align the four center holes on Template (T-E) with your wood joist, and mark drilling locations in a diamond pattern using the two inner holes and two opposite side holes. Use of a stud finder is recommended.

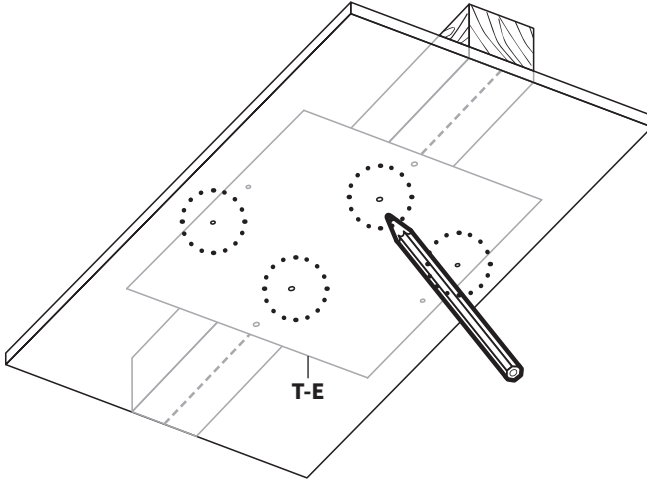

Pre-Drilling Instructions

Drill the center mounting holes using the illustration shown

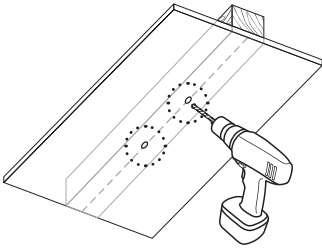

Drill Bit: 3/16" (4.5mm)

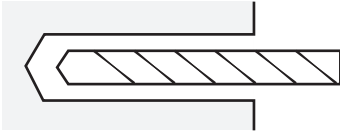

Hole Depth:
2.2" (55mm)

Drill the side mounting holes using the illustration shown

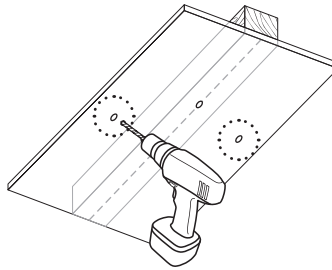

Drill Bit: 3/8" (10mm)

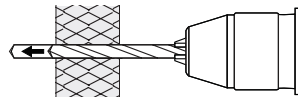

*Drill through the drywall

STEP 2

Separate Drywall Screws with Washers (**W-E1**) from the Drywall Anchors (**W-E**) using a Phillips screwdriver.

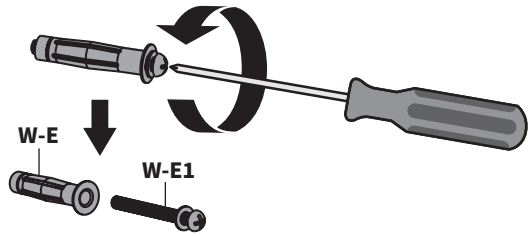

Insert Drywall Anchors (**W-E**) into the two side holes.

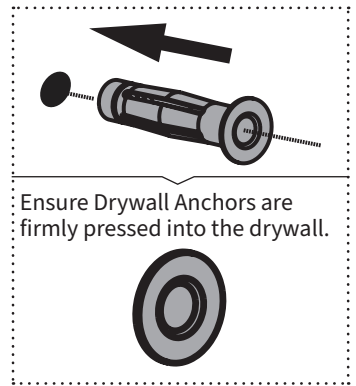
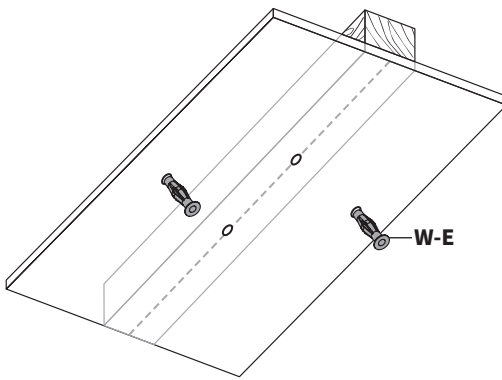

Secure Drywall Anchors (**W-E**) by threading Drywall Screws with Washers (**W-E1**) back into the Drywall Anchors. Then remove the Drywall Screws with Washers again using a Phillips screwdriver.

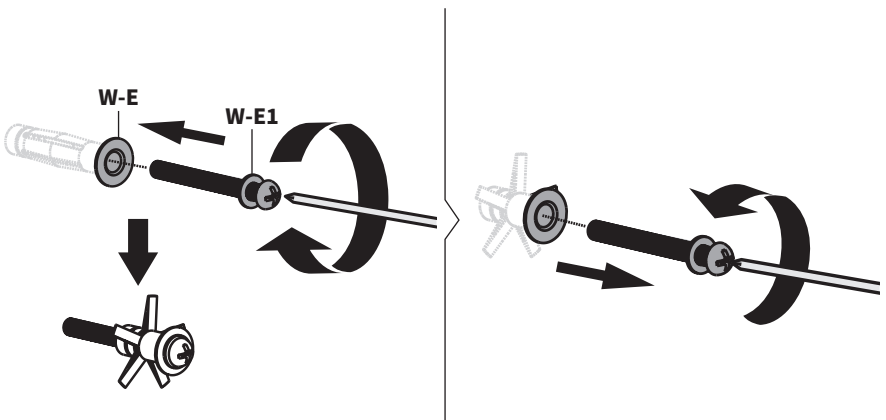

STEP 3

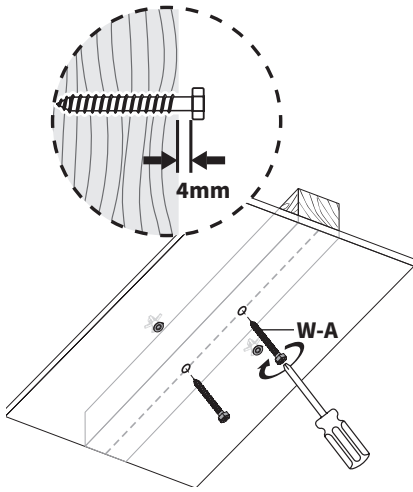

Partially install ST6.3x55mm Screws (**W-A**) into the center two holes using a Phillips screwdriver leaving a 4mm gap.

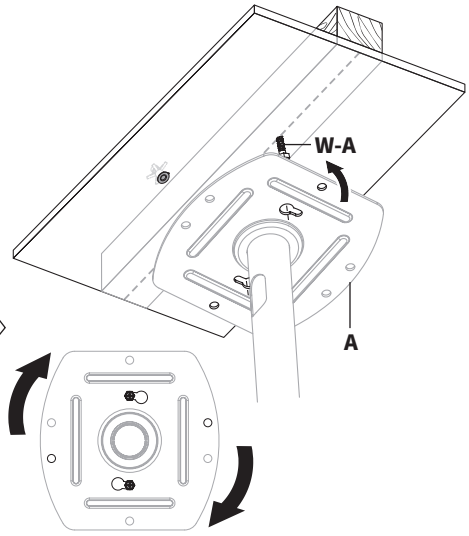

Place Mounting Pole (**A**) onto the ST6.3x55mm Screws (**W-A**), then rotate so that Mounting Pole is resting on the screw heads.

Tighten previously installed ST6.3x55mm Screws (**W-A**). Thread Drywall Anchors with Screws (**W-E1**) through Mounting Plate (**A1**) and into Drywall Anchors (**W-E**) using a Phillips screwdriver.

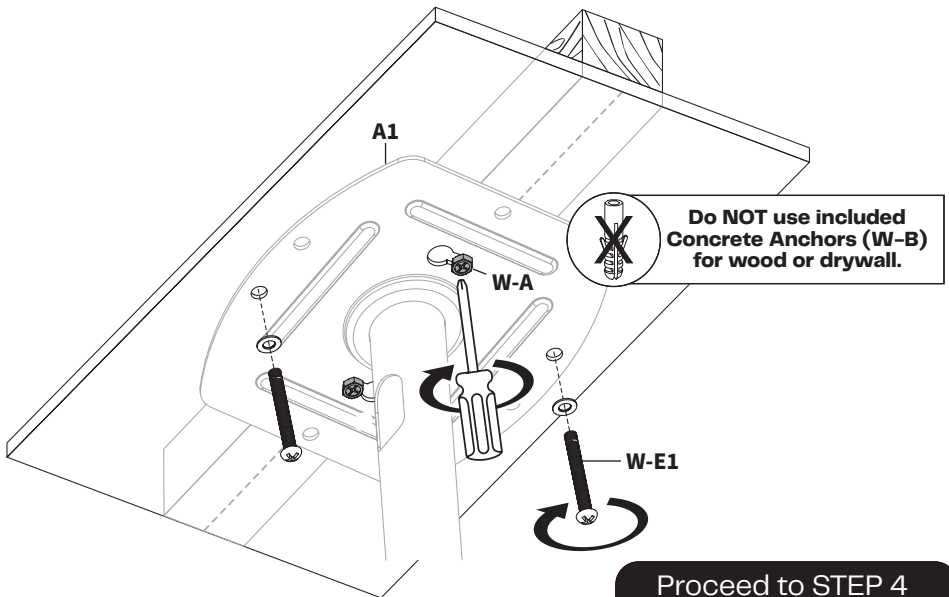

Proceed to **STEP 4**
on **Page 14**

Option 2 – Solid Wood Mounting

Wood thickness must be at least 5/8" (16mm)

STEP 1

Hold Template (**T-E**) onto your desired mounting location, and mark drilling locations in a diamond pattern using the two inner holes and two opposite side holes. Use of a stud finder is recommended.

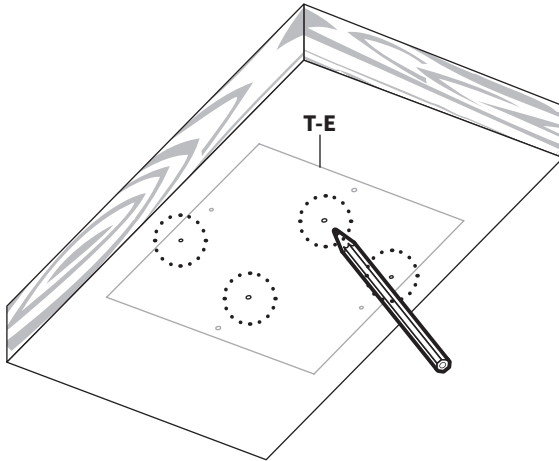

Pre-Drilling Instructions

Drill the center mounting holes using the illustration shown

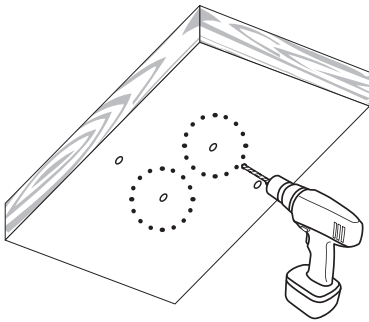

Drill Bit: 3/16" (4.5mm)

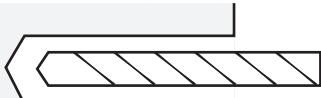

Hole Depth:
2.2" (55mm)

Drill the side mounting holes using the illustration shown

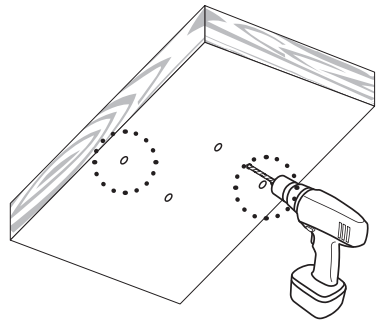

Drill Bit: 3/16" (4.5mm)

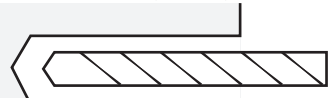

Hole Depth:
1.5" (38mm)

STEP 2

Partially install ST6.3x55mm Screws (**W-A**) into the center two holes using a Phillips screwdriver leaving a 4mm gap.

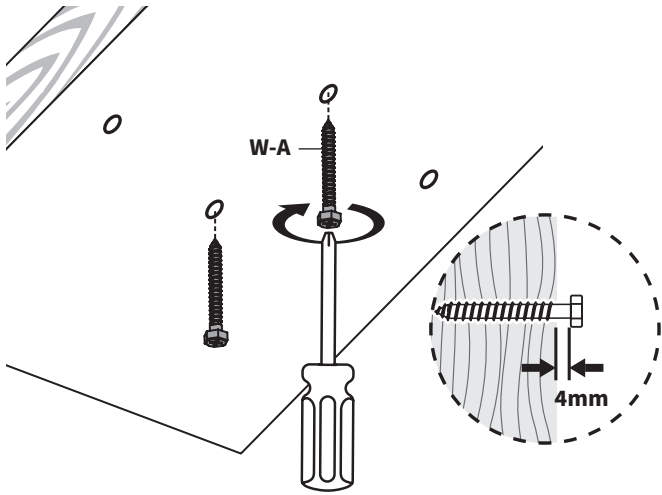

Place Mounting Pole (**A**) onto the ST6.3x55mm Screws (**W-A**), then rotate so that Mounting Pole is resting on the screw heads.

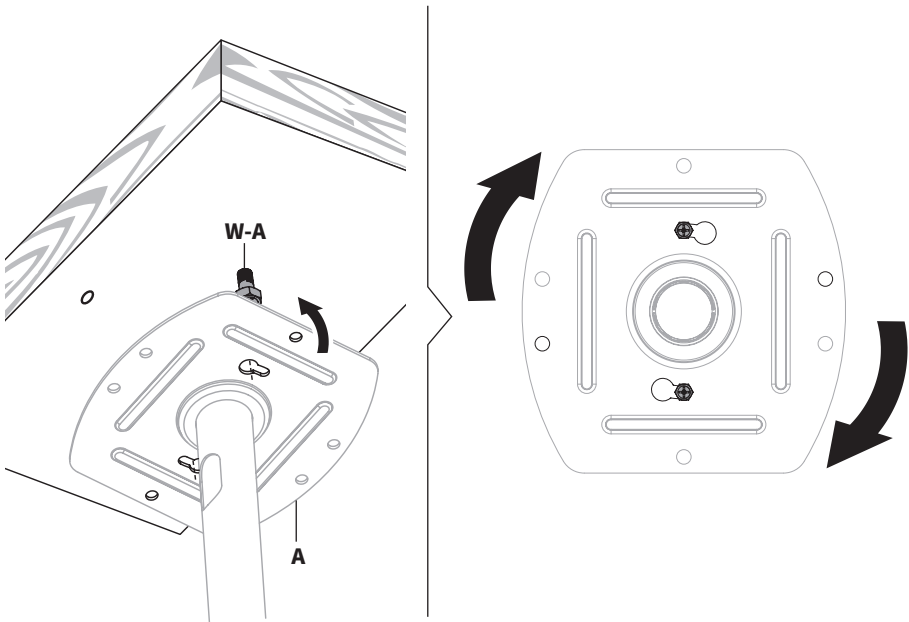

STEP 3

Tighten previously installed ST6.3x55mm Screws (**W-A**). Install ST6.3x38mm Screws (**W-D**) with M6 Washers (**W-C**) into the side holes.



Do **NOT** use included
Concrete Anchors (**W-B**)
for wood or drywall.

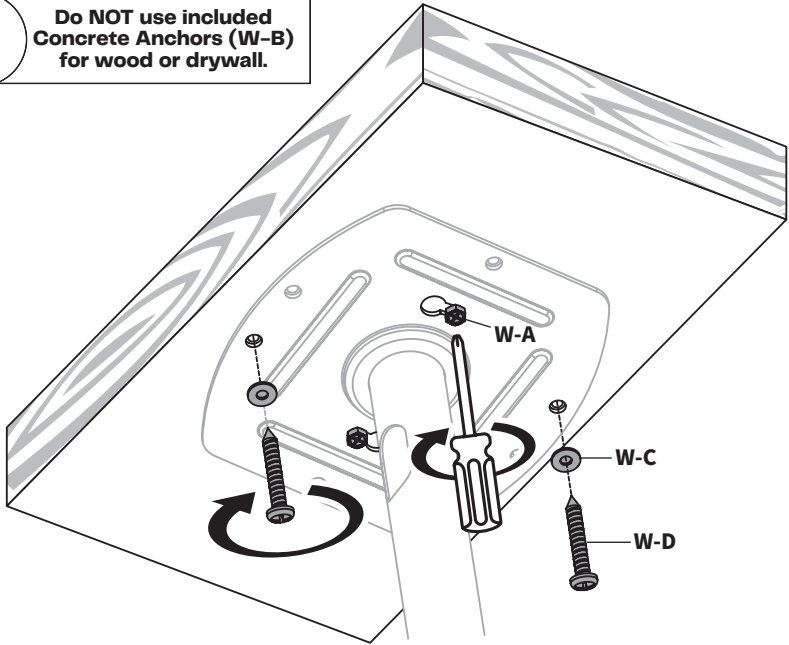

Proceed to STEP 4 on [Page 14](#)

Option 3: Concrete Mounting

STEP 1

Hold Template (**T-E**) onto your desired mounting location, and mark drilling locations in a diamond pattern using the two inner holes and two opposite side holes. Use of a stud finder is recommended.

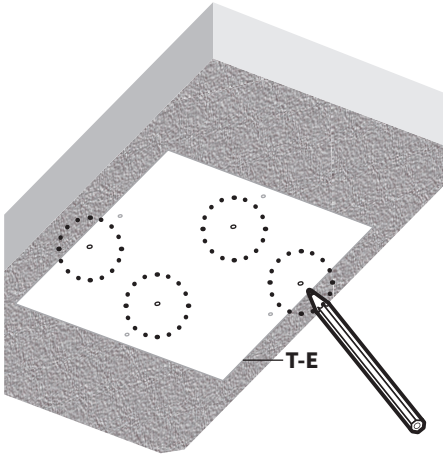

Pre-Drilling Instructions

Drill the center mounting holes using the illustration shown

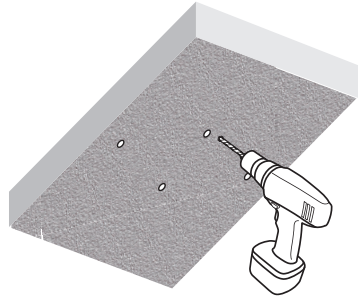

Drill Bit: 3/8" (10mm)

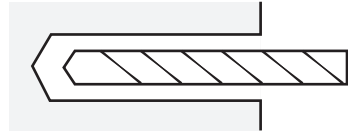

Hole Depth:
2.4" (60mm)

Insert Concrete Anchors (**W-B**) into the drilled holes. Install two ST6.3x55mm Screws (**W-A**) into the center two holes using a Phillips screwdriver leaving a 4mm gap.

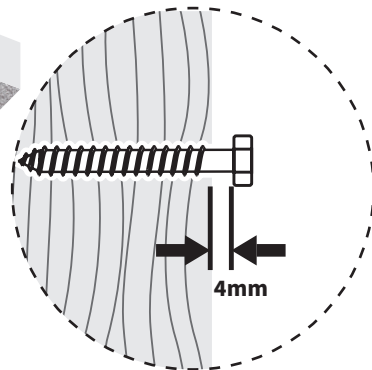
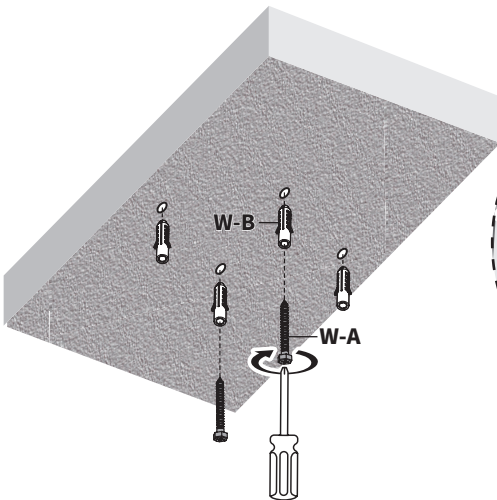

STEP 2

Place Mounting Pole (**A**) onto the ST6.3x55mm Screws (**W-A**), then rotate so that Mounting Pole is resting on the screw heads.

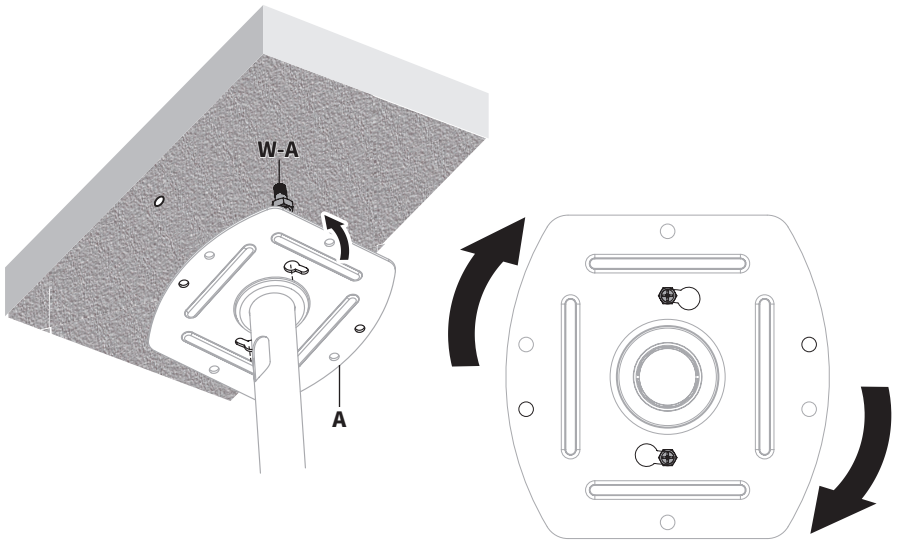

STEP 3

Tighten previously installed ST6.3x55mm Screws (**W-A**), then install two additional ST6.3x55mm Screws with M6 Washers (**W-C**) using a Phillips screwdriver.

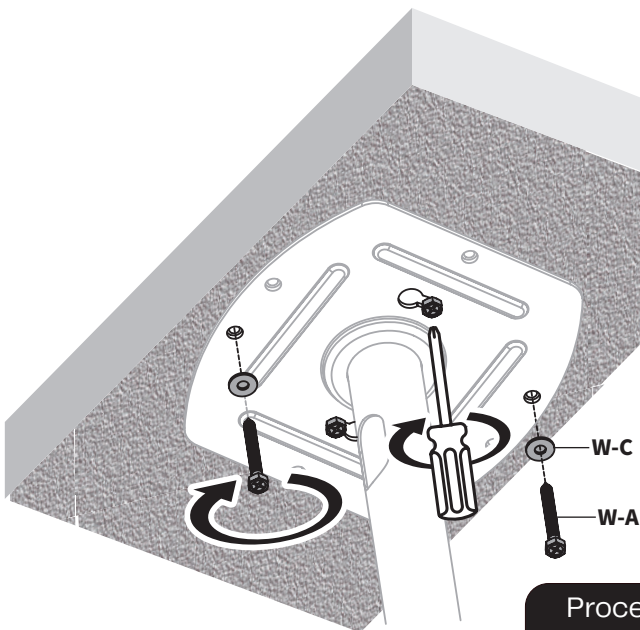

Proceed to STEP 4
on **Page 14**

STEP 4

Feed cables down through the opening in Mounting Pole (A).

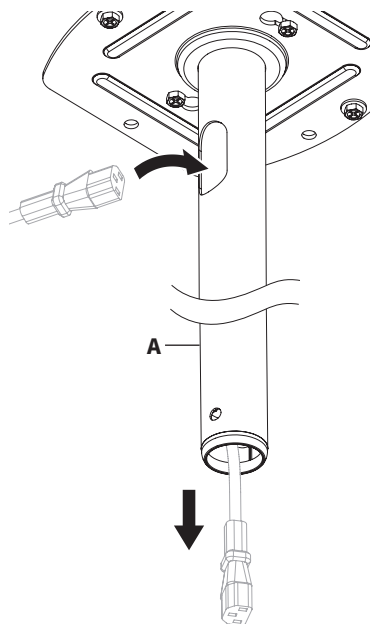

Slide Arm Support (C) up onto the Mounting Pole (A) at the desired height. Secure by tightening the screw on the back using 6mm Allen Wrench (T-B).

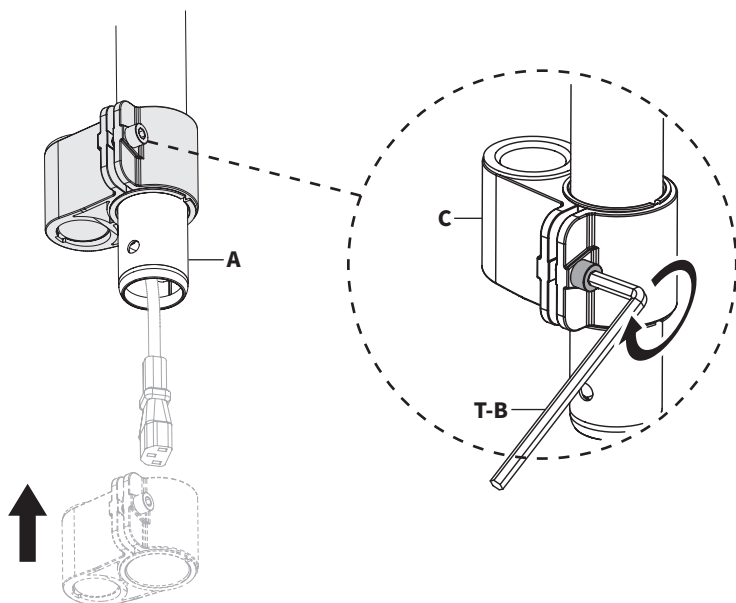

STEP 5

Install M8x50mm Screw (**S-E**) and M8 Nut (**S-G**) to the bottom of Mounting Pole (**A**). Tighten using 6mm Allen Wrench (**T-B**) and 10-13mm Wrench (**T-D**).

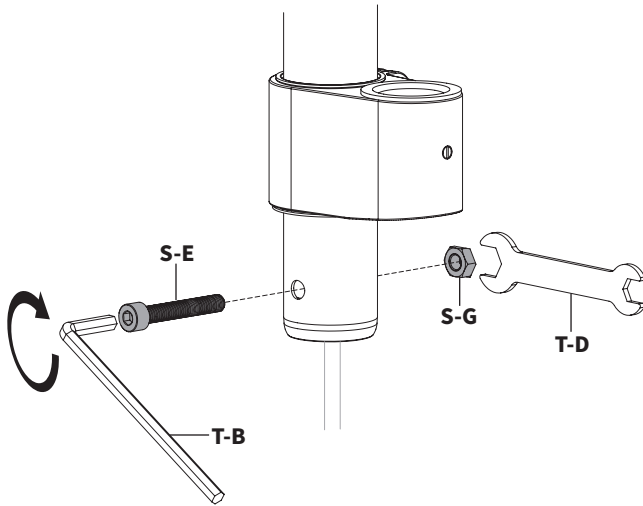

STEP 6

Attach VESA Bracket (**D**) to Arm (**B**) using M8x25mm Screw (**S-B**), Arm Spacer (**S-A**) and 6mm Allen Wrench (**T-B**).

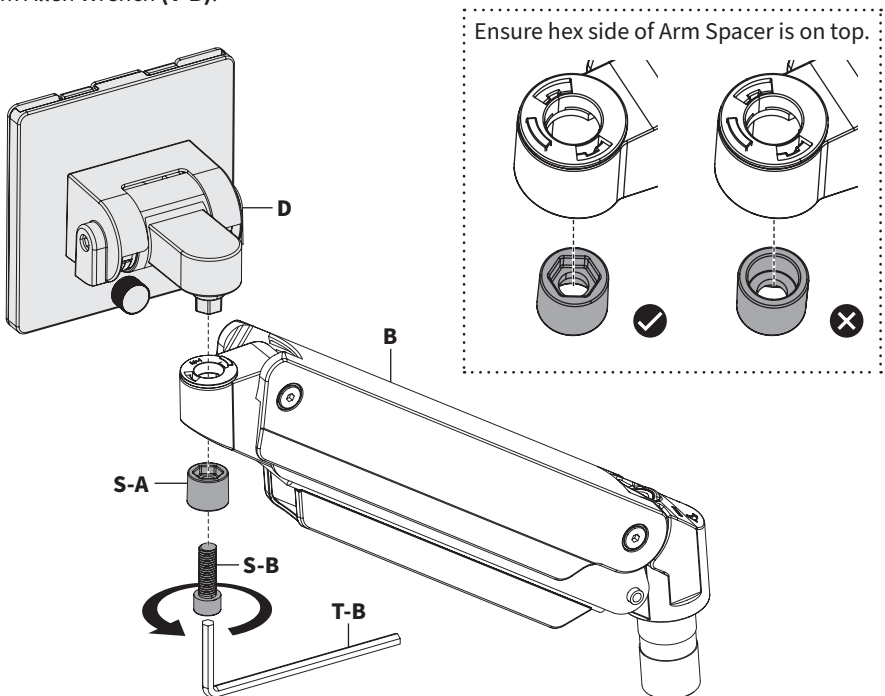

STEP 7

Remove Thumbscrew (**D1**) and separate Small VESA Plate (**D2**) from VESA Bracket (**D**).

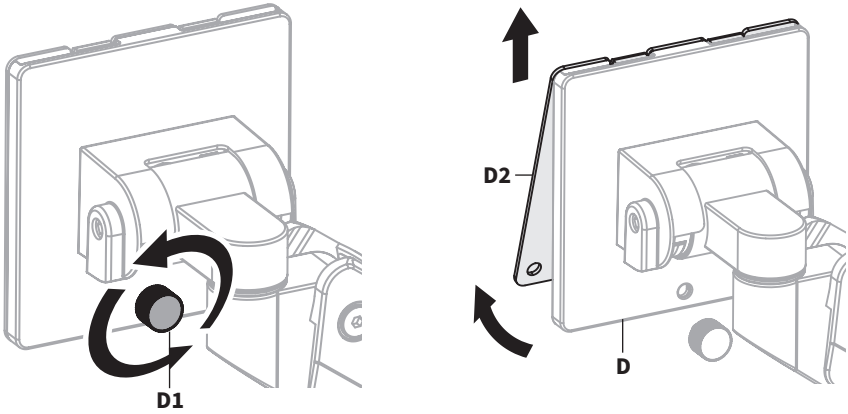

Insert Arm (**B**) into Arm Support (**C**) and secure by tightening the set screw on Arm Support using 3mm Allen Wrench (**T-A**).

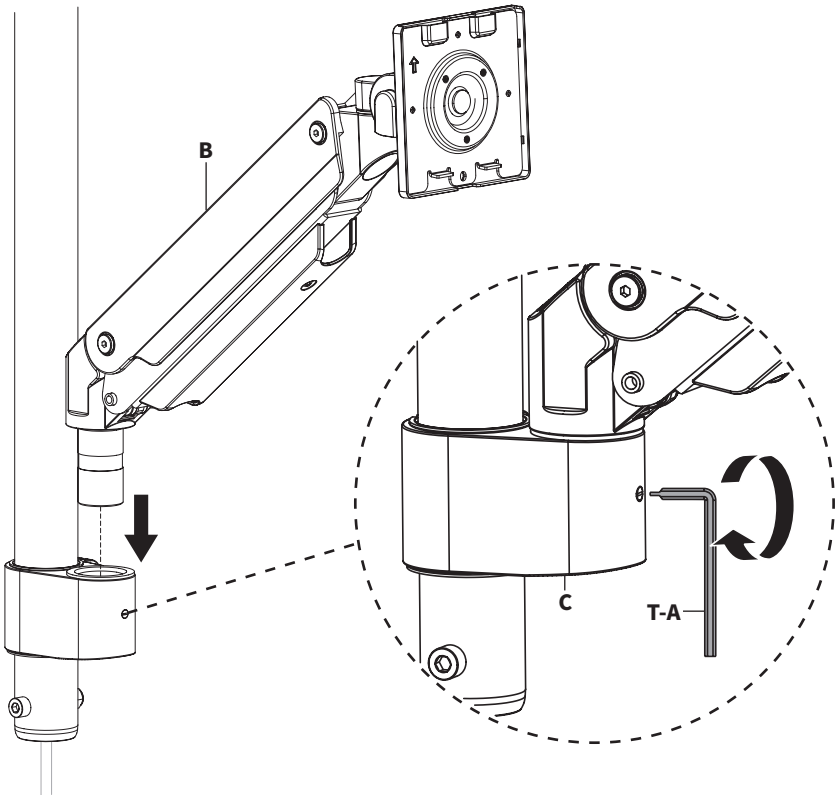

**** PLEASE READ ******7 VESA Assembly Options**

Please choose one of the following options that match the VESA pattern of your monitor or TV and follow the appropriate instructions.

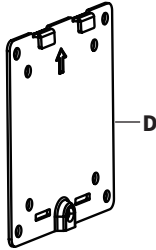

Small VESA Plate Only
75x75mm & 100x100mm

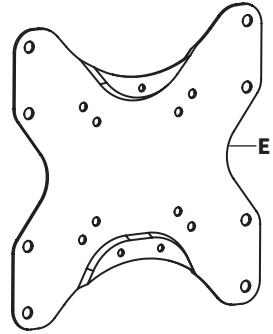

Large VESA Plate Only
200x100mm [pg. 18]
200x200mm [pg. 18]

*Please Note: 75x75mm & 100x100mm
VESA patterns do not require additional assembly.*

Proceed to Page 22 for Securing

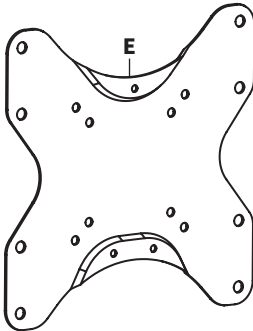

+

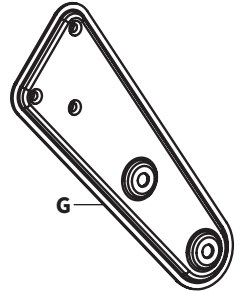
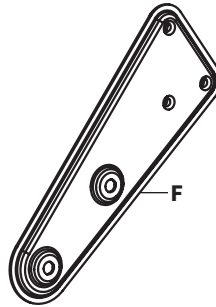

Large VESA Plate with VESA Extensions

300x300mm [pg. 19]
400x400mm [pg. 19]
400x200mm [pg. 20]

Large VESA Plate Only

200x100mm or 200x200mm Patterns

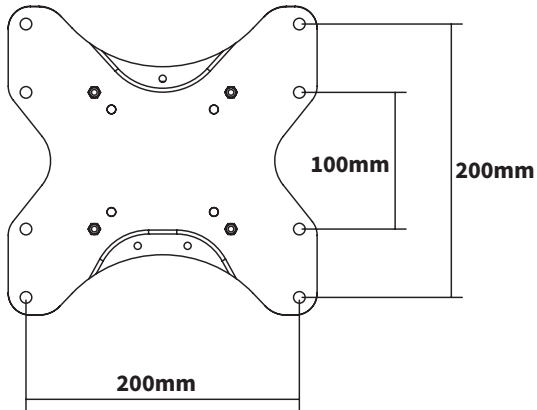

Attach Large VESA Plate (**E**) to Small VESA Plate (**D2**) using M5x8mm Screws (**S-D**) and M5 Nuts (**S-F**). Tighten using Phillips screwdriver and 8-10mm Wrench (**T-C**).

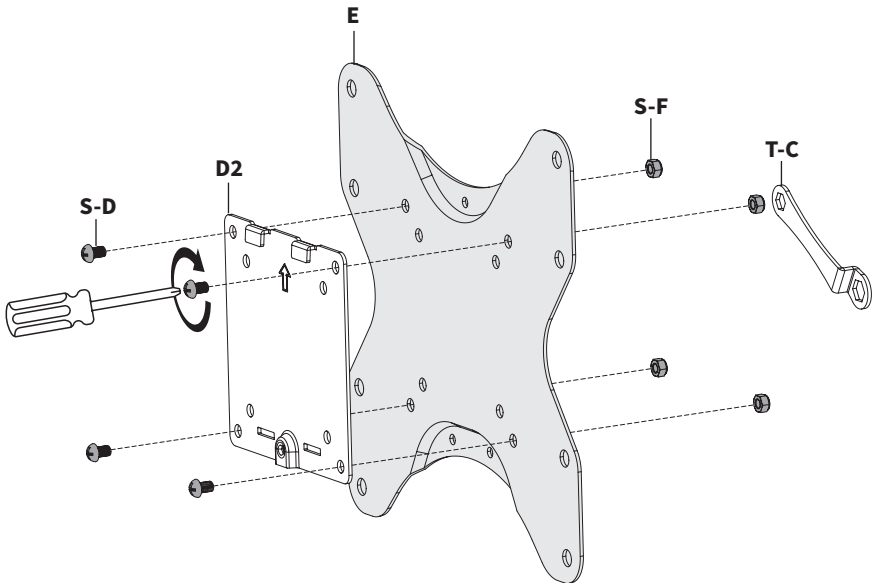

Proceed to Securing VESA Plates
on **Page 21**

VESA Extension Assembly Option 1

300x300mm or 400x400mm Patterns

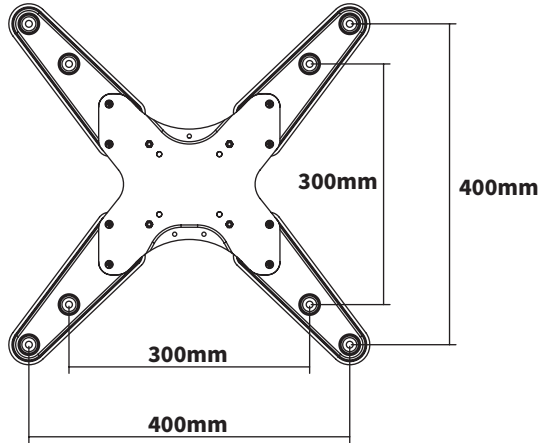

Securing VESA Extensions

Secure VESA Extensions (**F,G**) to Large VESA Plate (**E**) using M6x8mm Screws (**S-C**) and a Phillips screwdriver according to the diagram shown.

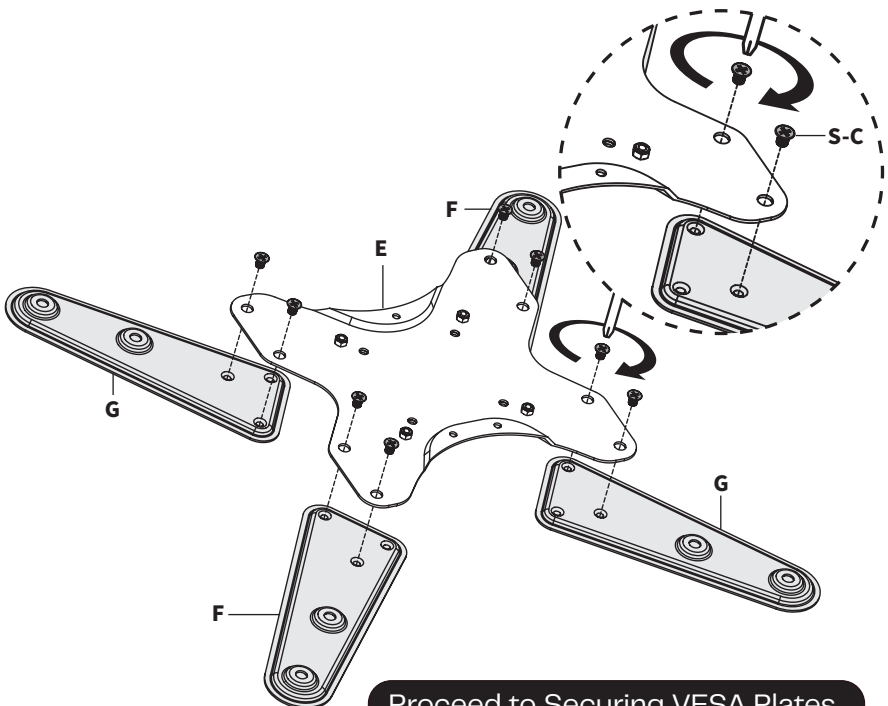

Proceed to Securing VESA Plates
on **Page 21-22**

VESA Extension Assembly Option 2

400x200mm Pattern

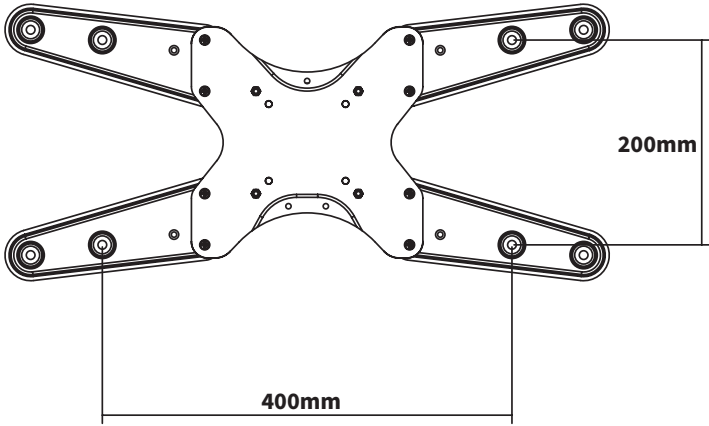

Securing VESA Extensions

Secure VESA Extensions (**F,G**) to Large VESA Plate (**E**) using M6x8mm Screws (**S-C**) and a Phillips screwdriver according to the the diagram shown.

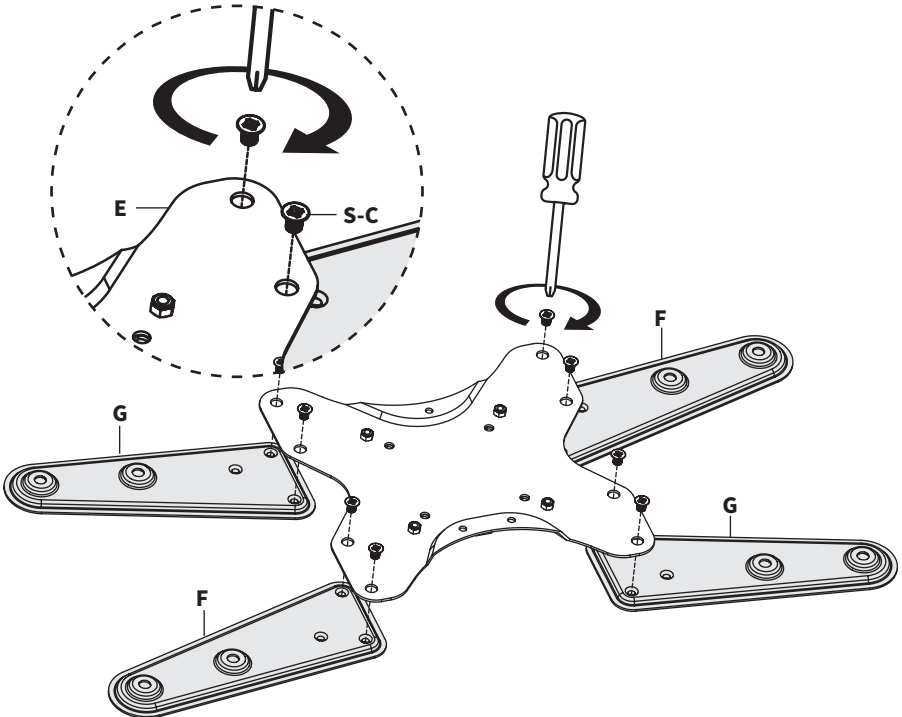

STEP 9

Securing VESA Plates

Secure Large VESA Plate (E) to the back of TV or monitor using appropriate Screws (M-C thru M-F), M8 Washers (M-H) and a Phillips screwdriver. Spacers (M-I, M-J) can be used if needed.

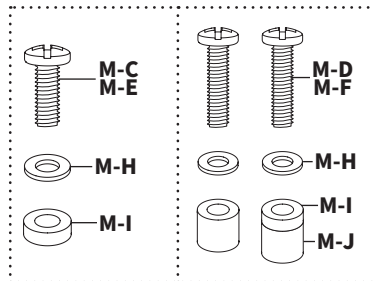
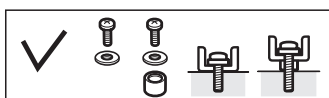
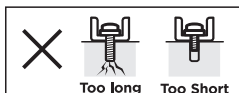
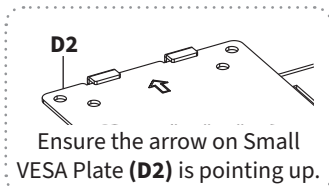

Large VESA Plate Only

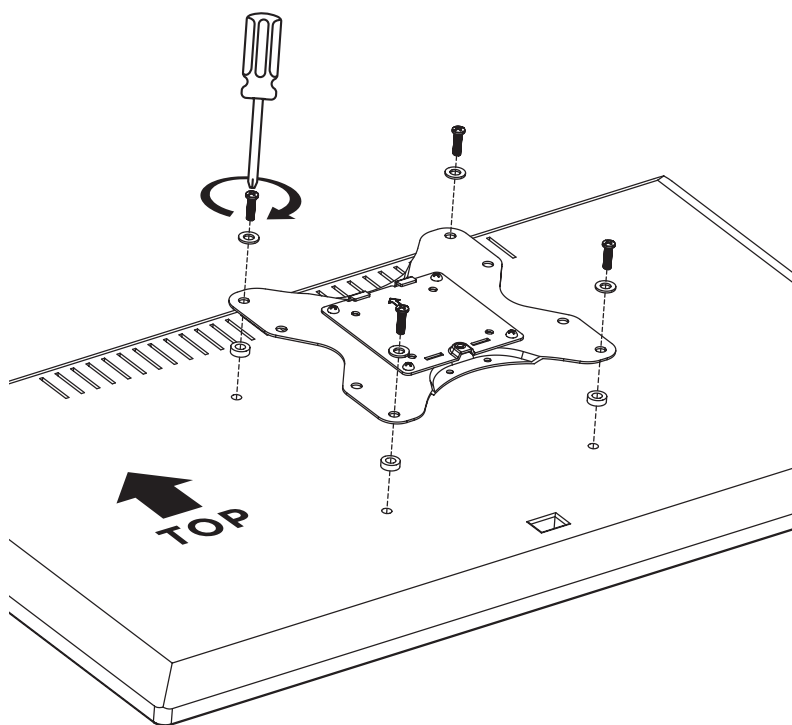

Large VESA Plate w/ Extensions

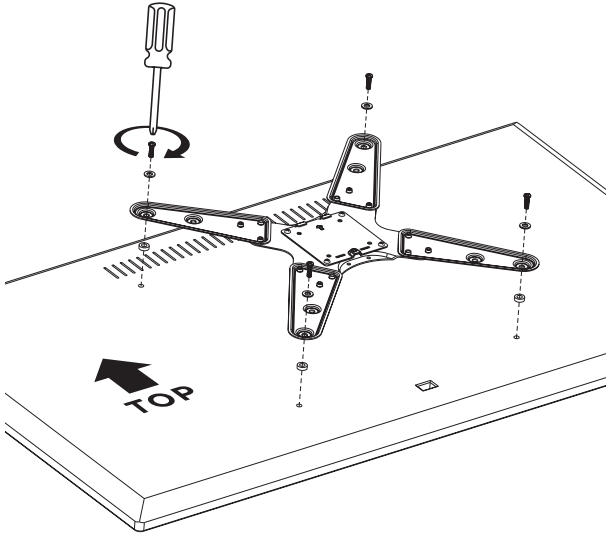

For Small VESA Plate Assemblies:

Secure Small VESA Plate (**D2**) to the back of TV or monitor using appropriate Screws (**M-A**, **M-B**), M5 Washers (**M-G**) and a Phillips screwdriver.

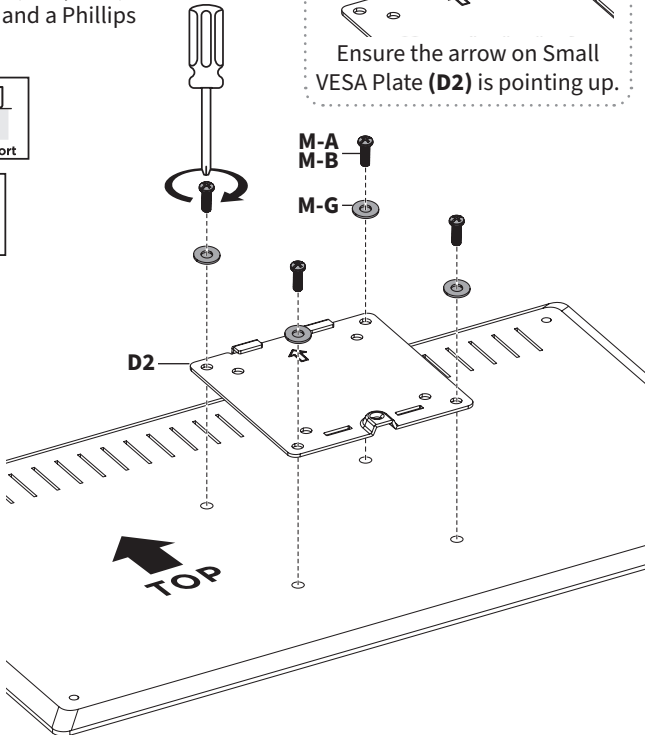
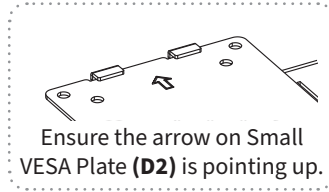
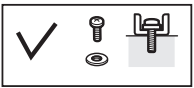
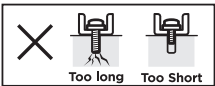

STEP 10

NOTE

Manual will proceed with **VESA Extension Assembly 1**.
Assembly steps will be the same unless otherwise specified.

Gently insert tabs on Small VESA Plate (**D2**) into the slots on VESA Bracket (**D**). Gently release the monitor into the VESA Bracket and secure using previously removed Thumbscrew (**D1**).



**2 Person Mounting
Recommended**

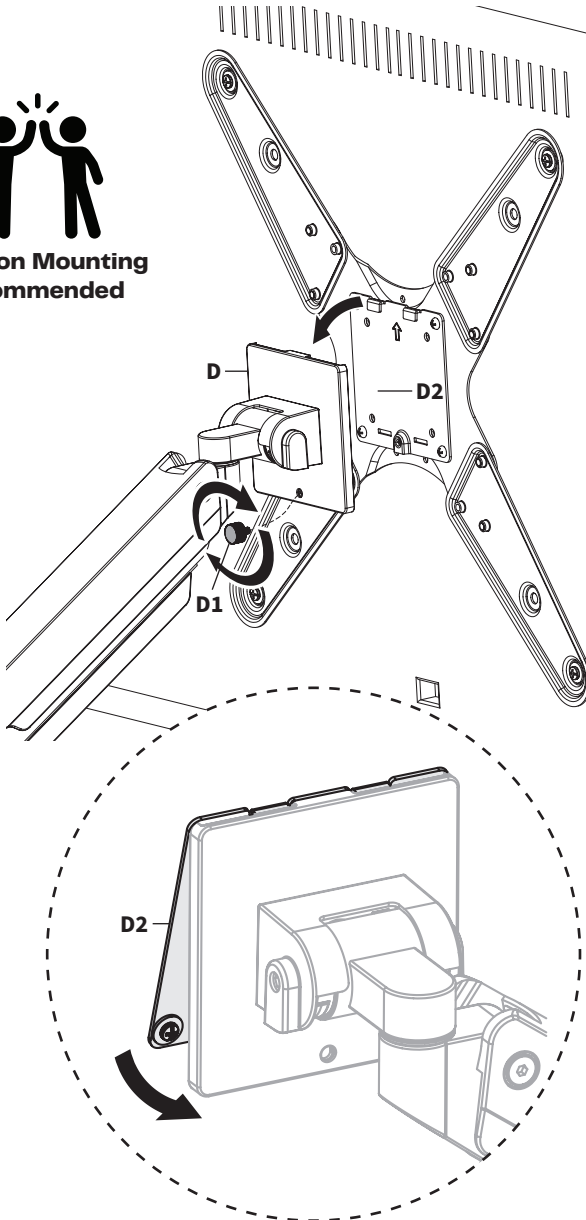

Adjusting Monitor Height

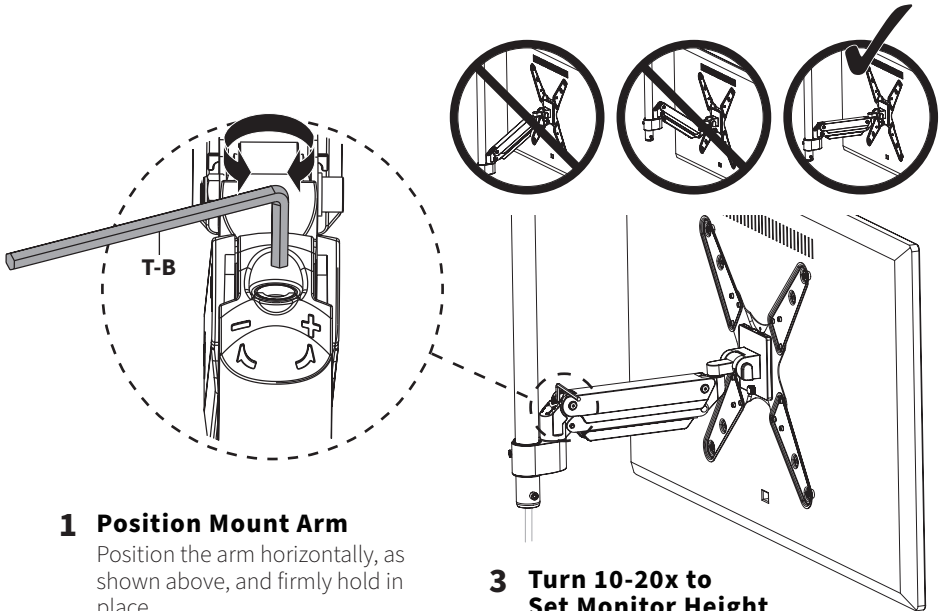

1 Position Mount Arm

Position the arm horizontally, as shown above, and firmly hold in place.

2 Insert 6mm Allen Wrench (T-B) Into Adjustment Screw

Insert the 6mm Allen Wrench (**T-B**) in to the adjustment screw on the back of the monitor arm.

3 Turn 10-20x to Set Monitor Height

Turn 6mm Allen Wrench (**T-B**) 10-20 times to obtain proper support for your monitor. Use the guide below to adjust the tension according to the amount of counterbalance needed to support the monitor.

Tension Adjustment Guide

Clockwise:
Decrease Support
[if monitor will not lower]

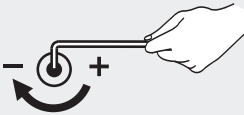

Turn the adjustment screw **clockwise** to **decrease** the support for your monitor, allowing it to be lowered.

Counter-Clockwise
Increase Support
[if monitor will not raise]

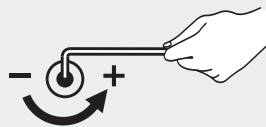

Turn the adjustment screw **counter-clockwise** to **increase** the support for your monitor, allowing it to be raised up.

Note: Requires 10-20 Turns

Fine Tune Tilt Angle

If the monitor is angled further than intended...



Heavy Weighted/ Ultrawide Monitors

[22lbs - 44lbs]

1 Firmly Hold Monitor

Firmly grasp and hold the monitor in place. Do NOT release monitor until you have completed steps below.

2 Loosen Tilt Joint:

With a hand still on the monitor, use 6mm Allen Wrench (**T-B**) to loosen the tilt joint **Adjustment Screw**, located on the side of VESA Bracket (**D**).

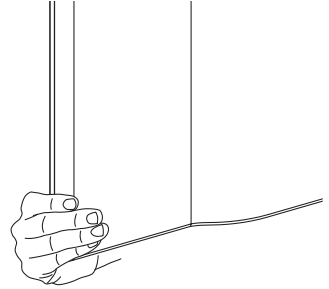

3 Set & Lock Angle

Adjust screen slightly past your desired viewing angle, then tighten the screw as much as possible using 6mm Allen Wrench (**T-B**).

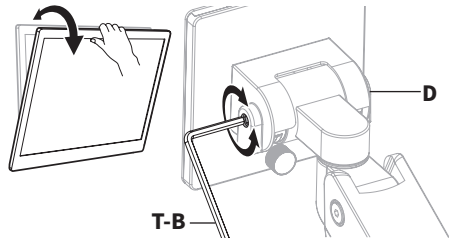

4 Straighten Angle

Slowly adjust the monitor down until your desired angle is reached. Release monitor and check angle. Repeat process as necessary

2 Person
Adjustment is
Recommended

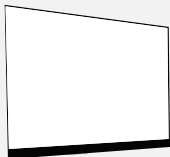

Ultra Thin Monitors



ALWAYS REMOVE MONITOR BEFORE RE-ADJUSTING

To prevent accidental damage to your screen, remove monitor and then follow Tilt Adjustment instructions. Reinstall monitor when desired angle is reached.

STEP 12

Remove the preinstalled Cable Cover (**B1**) on Arm (**B**) using a Phillips screwdriver. Organize cable then reinstall the Cable Cover.

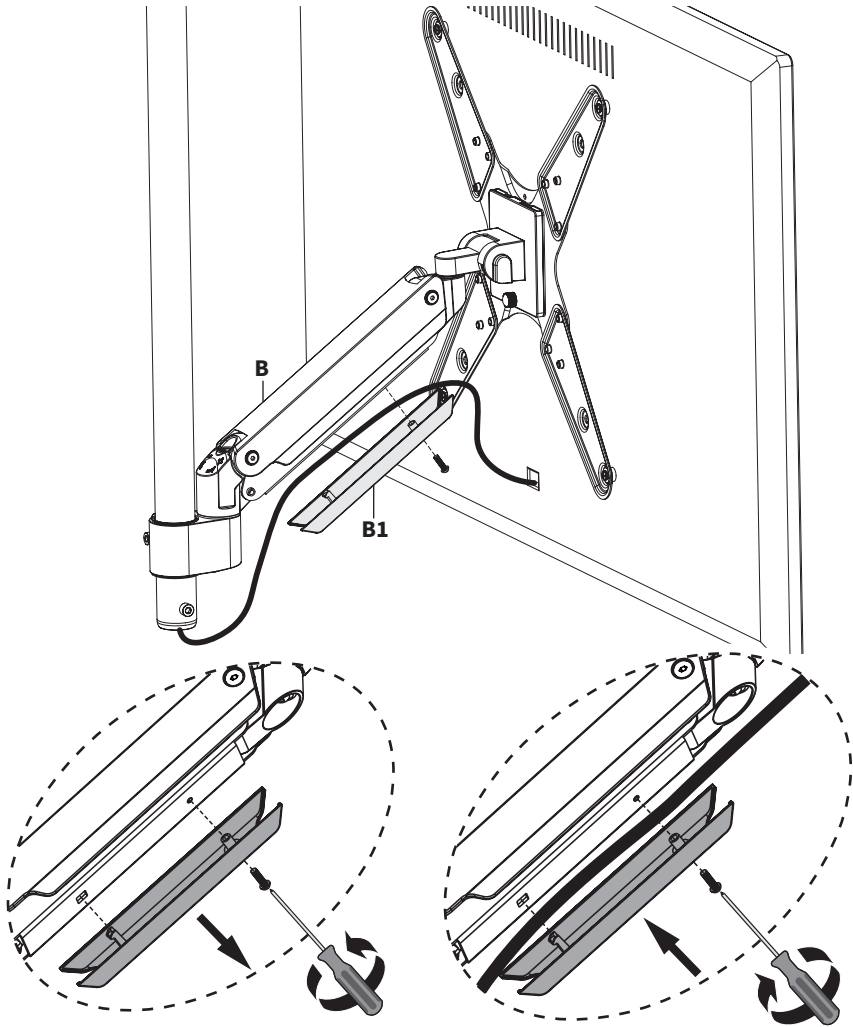

Adjust as Desired

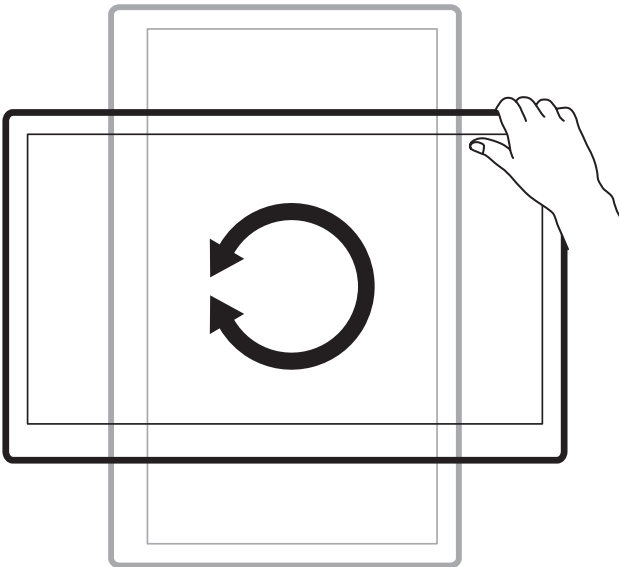
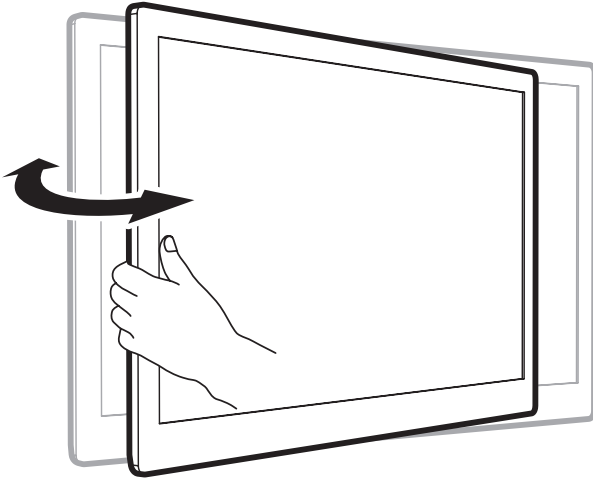



Need Help? **We're Here For You**

Monday-Friday from 7am-7pm CST
Saturday 8am-4pm CST



Email Us
help@vivo-us.com



Chat with Live Agent
www.vivo-us.com



Give Us a Call
309-278-5303 ext. 1



VIVO-us



@vivo_us



@VIVOus



VIVO