

SIDE TABLE CHARGING STATION

ASSEMBLY INSTRUCTIONS

Before assembling your side table, please read through these instructions carefully and familiarize yourself with the different parts.

ATTENTION! If you receive a damaged or defective item, please contact our customerservice.

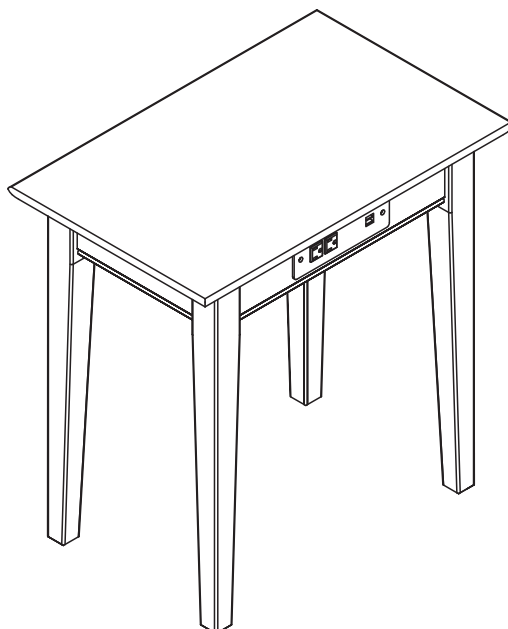

NOTE: WE INCLUDE SPARE HARDWARE IN CASE DAMAGE OCCURS DURING ASSEMBLY.

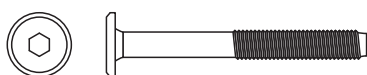

A JCB M8 X 45mm - 4 pcs
Spare - 1 pc



B Flat washer - 4 pcs

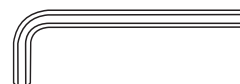

C Allen wrench - 1 pc

PARTS LIST

PO:

01 TOP PANEL 1 PC

02 LEG 4 PCS

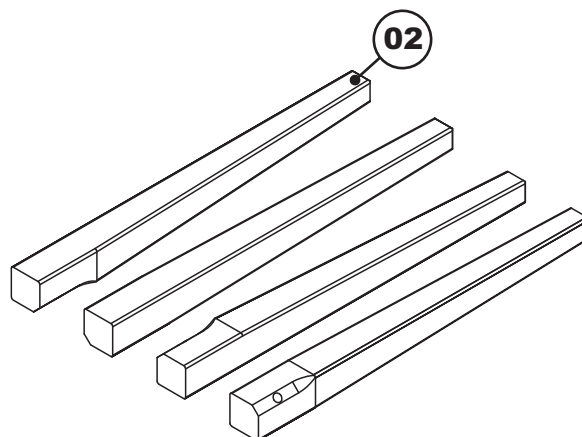
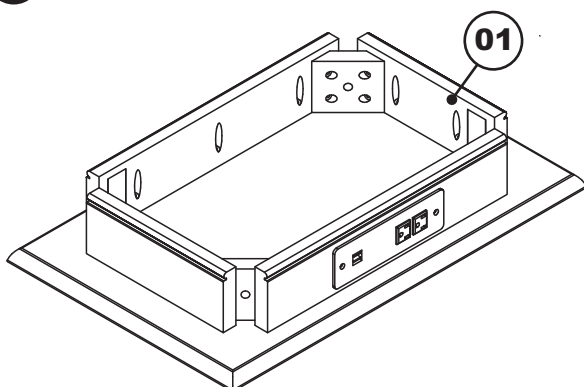

STEP 1

Attach the legs (02) to the top panel (01) using flat washers (B) and JCB (A), tighten with Allen wrench (C), as shown below.

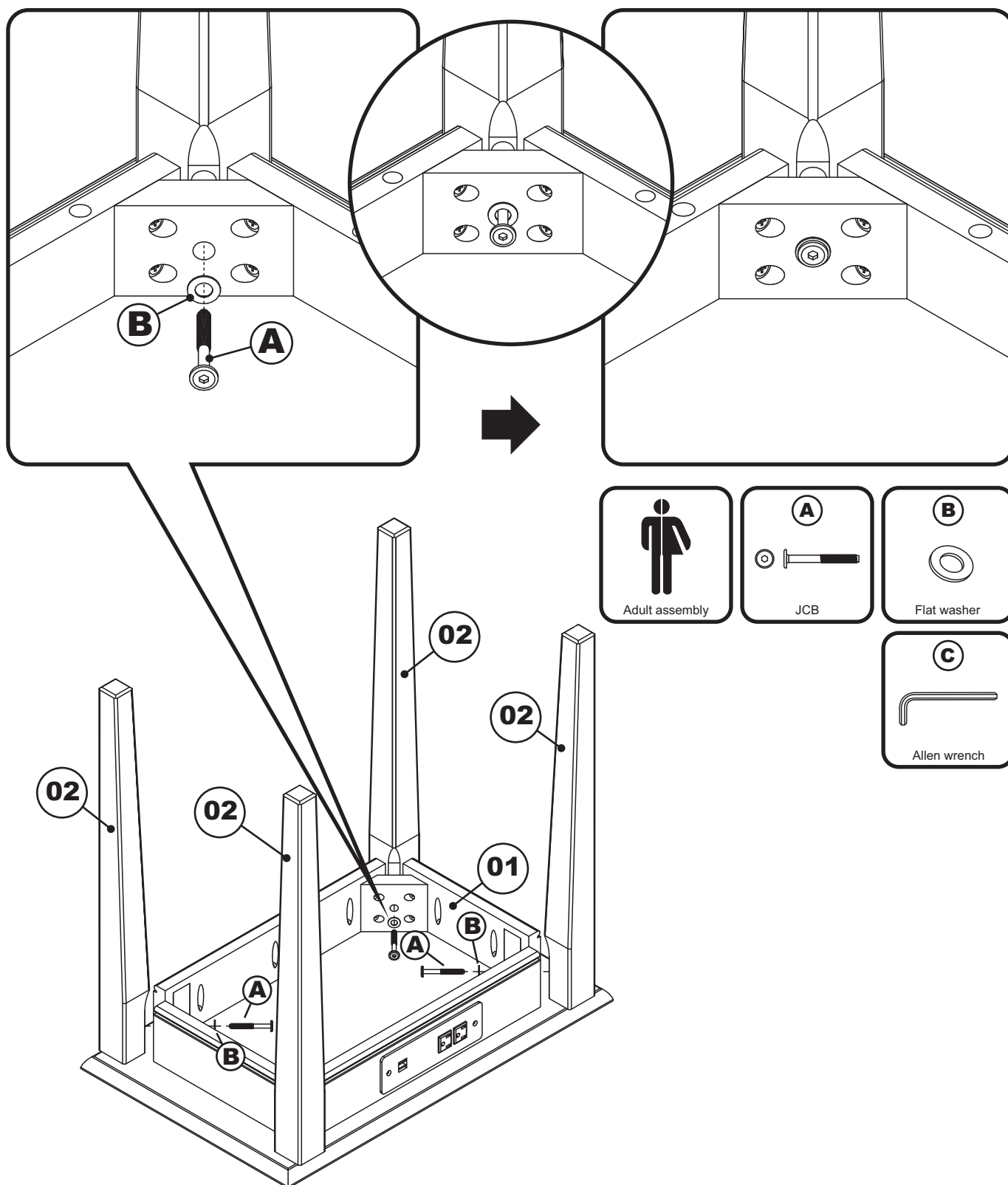

Congratulations!

Your Side table is now ready for use.

To ensure lasting safety, we recommend that you periodically check that all screws are tight and all parts are secure.