

ASSEMBLY INSTRUCTIONS

MODEL #

CM4401S

Questions?

GIVE US A CALL: 1-888-980-5122
MON – FRI 8:30AM – 5:30PM (PST)

TOOLS REQUIRED



Allen Wrench

(Included)

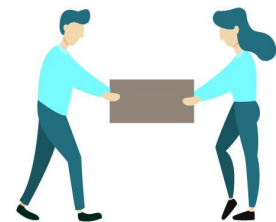
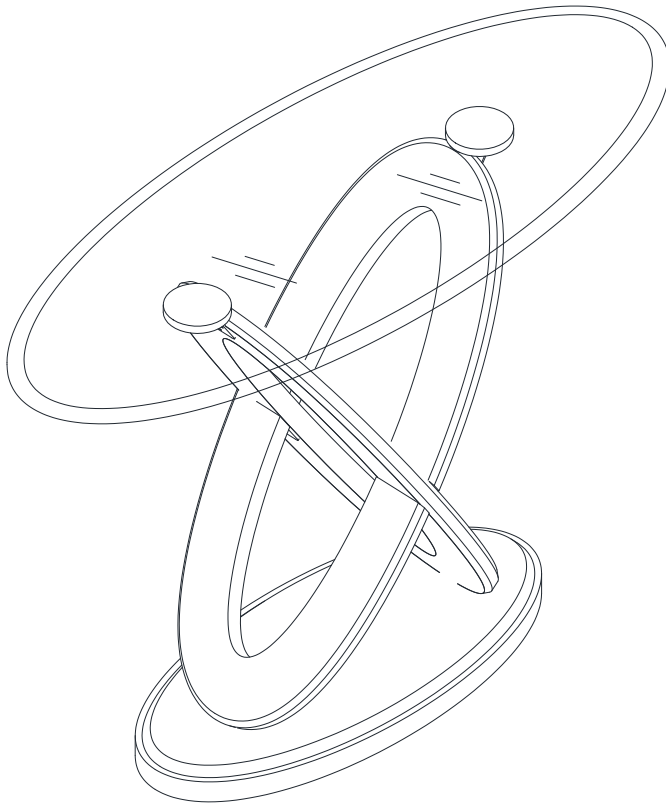

**2 - Persons
Recommended**

ASSEMBLY RATING



EASY —————> DIFFICULT

The Assembly Rating is a 5-point system showing the level of effort needed to assemble a specific product.



FOA Intro

Thank you for your purchase!

We hope you enjoy this new addition to your home for many years to come.

Our commitment to providing quality products does not simply end when you purchase our product. We fully stand behind our products from start to finish. Our customer service department is available Monday – Friday 8:30 AM – 5:30 PM Pacific and can help with assembly questions as well as, if necessary, replacing damaged or missing parts. To help expedite our service, please have these assembly instructions readily available, along with your order receipt.



Consumer Hotline
Toll-Free 1-888-980-5122



WEBSITE
www.foagroup.com



Monday to Friday
8:30AM- 5:30PM (PST)



E-MAIL
cs.ec@foagroup.com



foagroup



FurnitureOfAmerica



CHECK BEFORE STARTING



Are you missing anything?

Double-check all parts, hardware and accessories listed on Page 6 are accounted for.



Check out our Quick Tips!

We recommend reviewing the pre-assembly handouts. Even experts need a refresher now and then!



Should we send any replacements?

Are there any irregularities or flaws in the parts? We can send replacements!



Prep Time!

Please review the assembly instructions and all diagrams prior to assembling. Set up your work-space by laying the parts and hardware out separately, then begin!

PRE ASSEMBLY INTRODUCTION

We understand building ready-to-assemble furniture can be a challenging experience for some. To help avoid confusion, we have provided some helpful tips that may speed up the process.

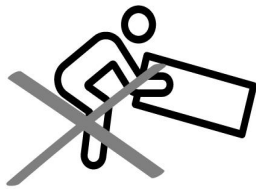

Teamwork

ALWAYS have at least two people to help with transporting and assembling the product to avoid potential injury and/or damage.

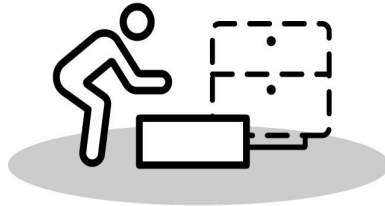
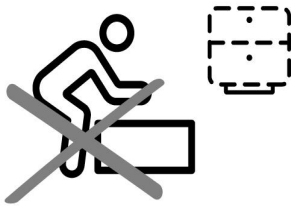

Suitable Location

Assembling near the area of the intended location is highly recommended.



Sufficient Space

Make sure you have enough space to move around during the assembly.



Avoid Scratches

Use cardboard, blankets or a carpeted area while assembling furniture to prevent scratches.

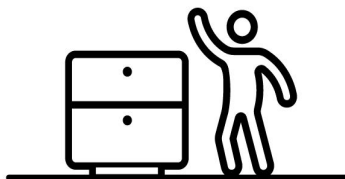
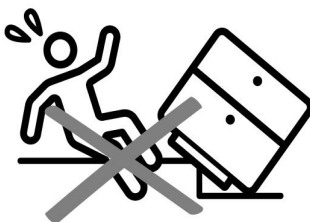

Flat Surface

Make sure the furniture rests on a flat and level surface with each leg evenly touching the floor.

ASSEMBLY AND CARE ADVICE



**FAILURE TO FOLLOW THE GUIDELINES BELOW MAY
RESULT IN INJURY AND/OR PROPERTY DAMAGE.**



Position each part correctly
and insert screws or bolts into
their respective holes.

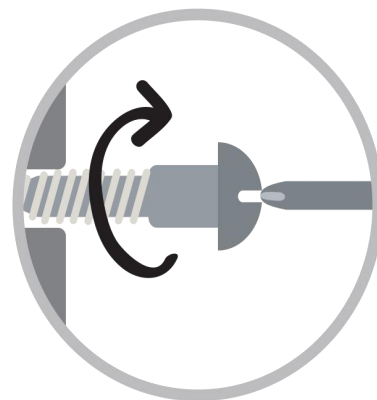

Turn clockwise to tighten and
only tighten when step is
completed or when instructed
to do so.



Save the instructions and store
any supplied tools for later
maintenance.

Use the appropriate hand tools
or power tools for assembly.
Select steps, such as tightening
screws and/or bolts, may require
hand tools to avoid causing
damage during assembly.

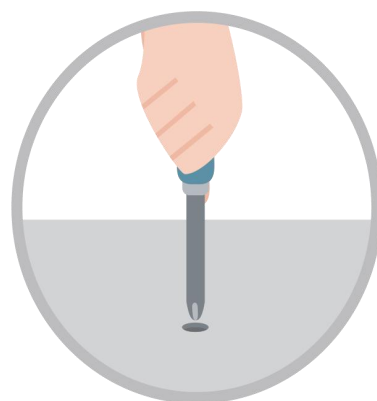

After two weeks, check and
tighten any loose hardware and
repeat again every six months
thereafter.

IT IS THE USER'S RESPONSIBILITY TO MAINTAIN THE FURNITURE. THE HARDWARE MAY LOOSEN OVER TIME AND MAY CAUSE THE FURNITURE TO BE WOBBLY AND UNABLE TO SUPPORT ITS INTENDED WEIGHT CAPACITY. THIS MAY LEAD TO COLLAPSE AND MAY CAUSE SERIOUS INJURY.

SOFA TABLE

CM4401S



- Please keep instructions for future reference.
- Check the quantity and irregularity of parts and hardware before you start.

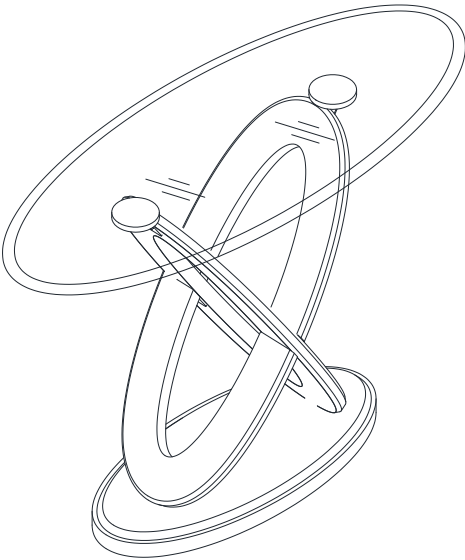

PARTS

#1 1pc



Glass Top

#2 1pc



Leg (A)

#3 1pc



Leg (B)

#4 1pc



Bottom

HARDWARE

#A 6pcs

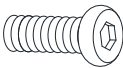

Bolt \varnothing 5/16" x 1/2"

#B 10pcs

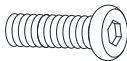

Bolt \varnothing 5/16" x 3/4"

#C 4pcs

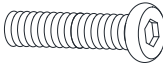

Bolt \varnothing 5/16" x 1-1/4"

#D 20pcs



Lock Washer \varnothing 5/16"

#E 20pcs



Flat Washer \varnothing 5/16"

#F 1pc



Allen Wrench

#G 2pcs



Metal Plate

#H 1pc

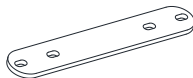

Bracket

ASSEMBLY INSTRUCTIONS

1

Remove the bolts on the bracket (#I) that is attached to leg B (#3) by using an Allen wrench (#F), then remove the bracket (#I) from leg B (#3).

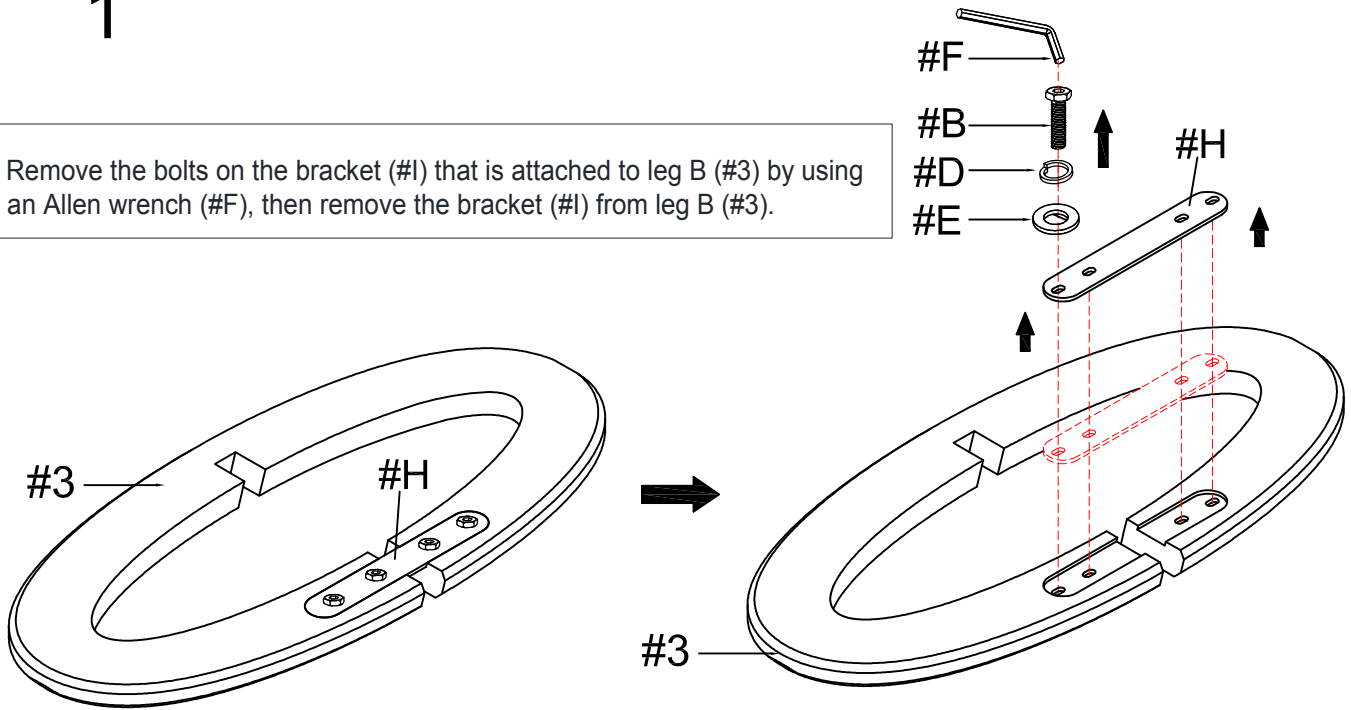

2

Part #2 x1pc

Part #3 x1pc

Hardware #B x 10pcs

Hardware #D x 10pcs

Hardware #E x 10pcs

Hardware #G x 2pcs

Hardware #H x 1pc

1) Prepare 10 bolts assembly by inserting lock washer (#D), then flat washer (#E) onto bolts (#B).

3) Insert bracket (#H) through leg A (#2), then secure bracket (#H) with bolts (#B).

2) Attach leg A (#2) to leg B (#3).

5) Align metal plate (#H) to the holes of leg (#2,3), then secure with bolts (#B).

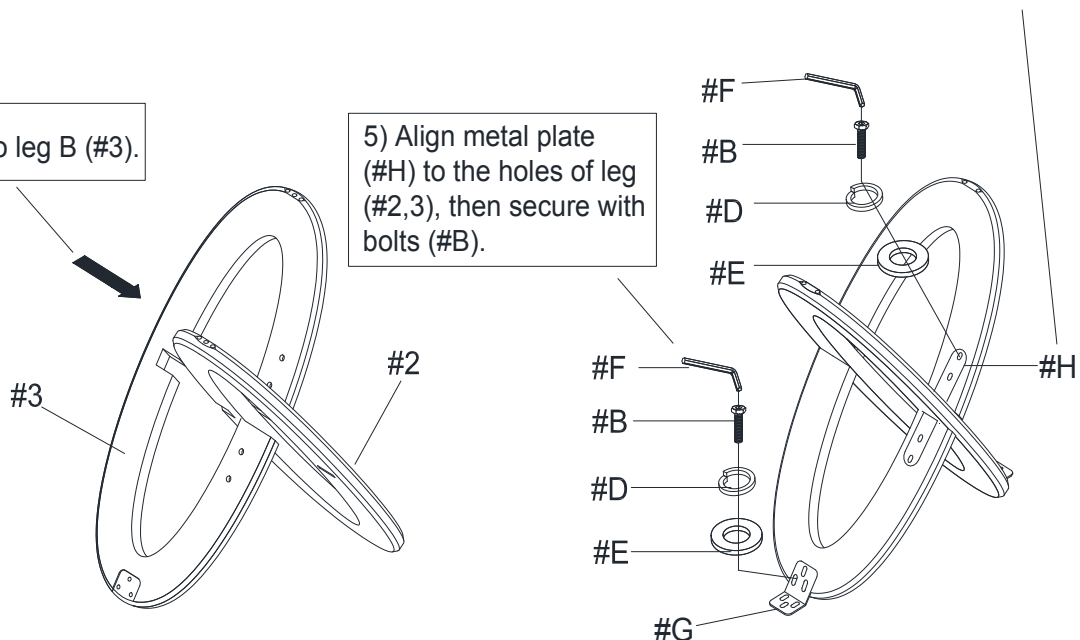

ASSEMBLY INSTRUCTIONS

3

- Part (#4) x1pc
- Hardware (#C) x4pcs
- Hardware (#D) x4pcs
- Hardware (#E) x4pcs

Align bottom (#4) to the holes of the legs (#2,3), then secure with bolts (#C).

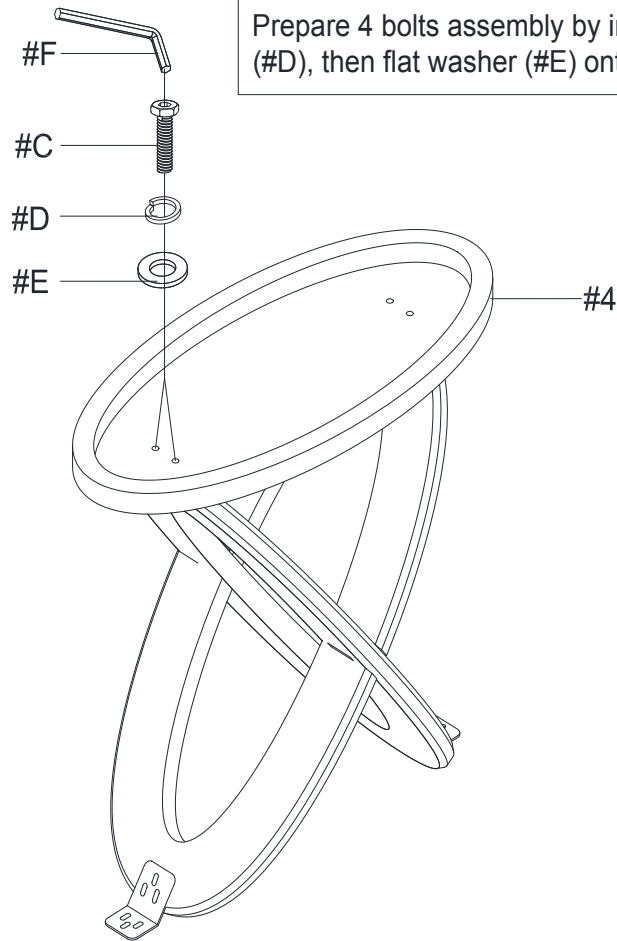

Prepare 4 bolts assembly by inserting lock washer (#D), then flat washer (#E) onto bolts (#C).

4

- Part (#1) x1pc
- Hardware (#A) x6pcs
- Hardware (#D) x6pcs
- Hardware (#E) x6pcs

Align the metal plate on the base to the holes of the glass top (#1). Secure with bolts (#A).

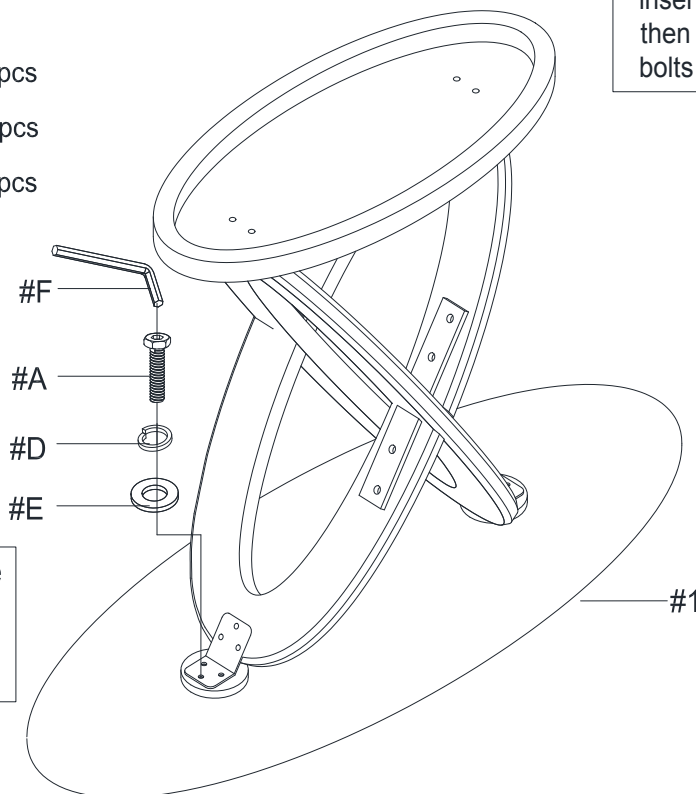

Prepare 6 bolts assembly by inserting lock washer (#D), then flat washer (#E) onto bolts (#A).

ASSEMBLY COMPLETED



Please ensure the furniture rests on an even and flat surface. If the product wobbles or feels loose, double-check all bolts and/or screws are properly tightened and secured.



Keep this handy!

Please retain this instruction manual and any order-related information for future reference.