

# Ezetek

## Instruction Manual

### Vacuum Cleaner

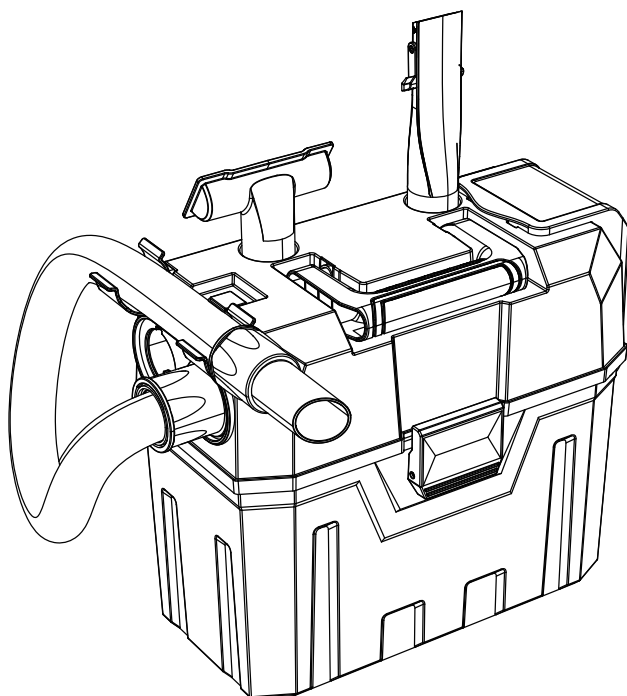

For any questions and malfunctions of the appliance during use, please contact our customer service email: [ezetek.service@outlook.com](mailto:ezetek.service@outlook.com)



# CONTENT

Specification .....	01
Introduction of Components .....	02
Operating Instructions .....	03
Important Safety Instructions .....	06
Troubleshooting .....	08
Recycling(Disposal of the product) .....	08
Warranty .....	09



# Specification

Product	Wet & Dry Vacuum Cleaner
Model	A20
Adapter Input Voltage	100-240 V, 50/60 HZ
Battery Capacity	2000 mAh
Dust Tank Volume	7 L

# Introduction of Components

## Overview :

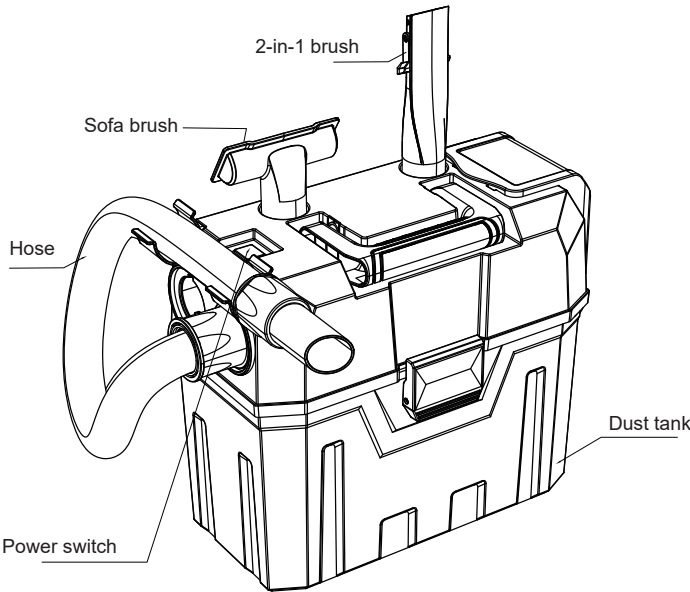

# Operating Instructions

## I. Assemble the main body and attach the battery pack

a) Press the main body onto the dust tank and buckle it up.

Open up the battery slot lid, make sure to attach the battery pack onto the slot. A "click" would be heard and close the lid.

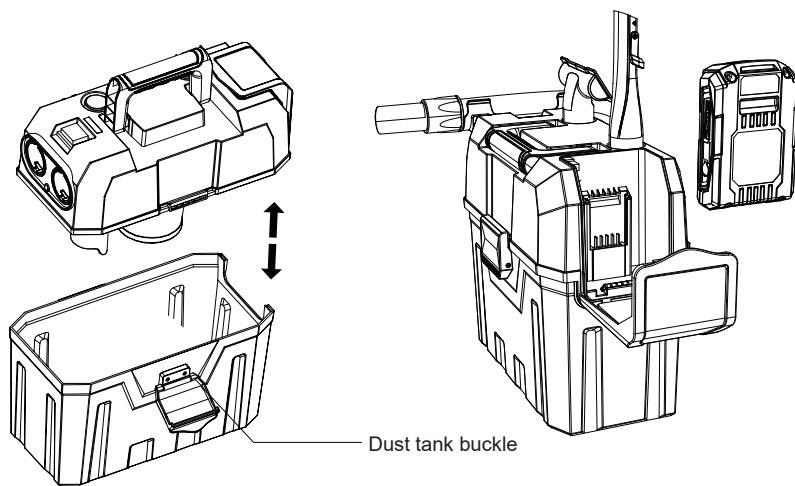

b) Connect the hose to the main body as below, and rotate to lock.

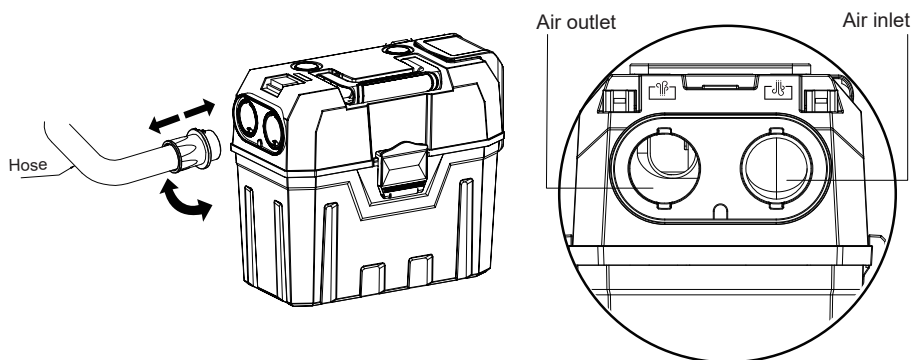

c) Press the switch to work.

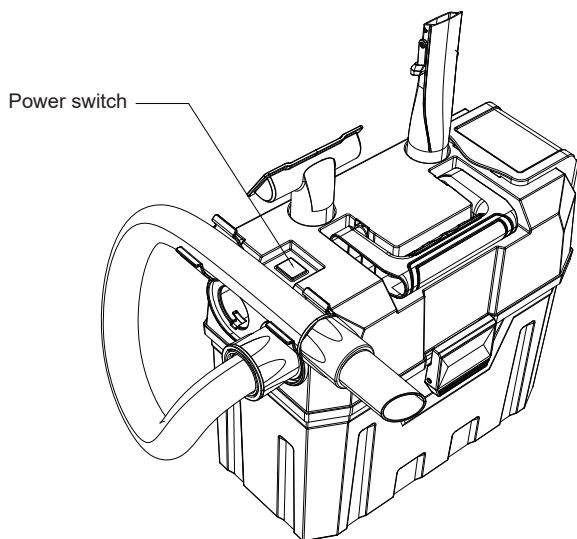

## II. Accessory assembling

Insert the accessory (2-in-1 brush or sofa brush) to body as below:

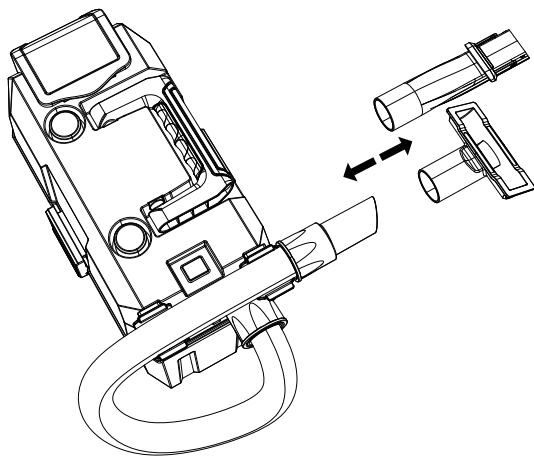

### III. Battery charging

When the power switch turns red and blinking, please turn off the appliance, and charge it as photo showed(The battery pack must stay on its groove when charging. )

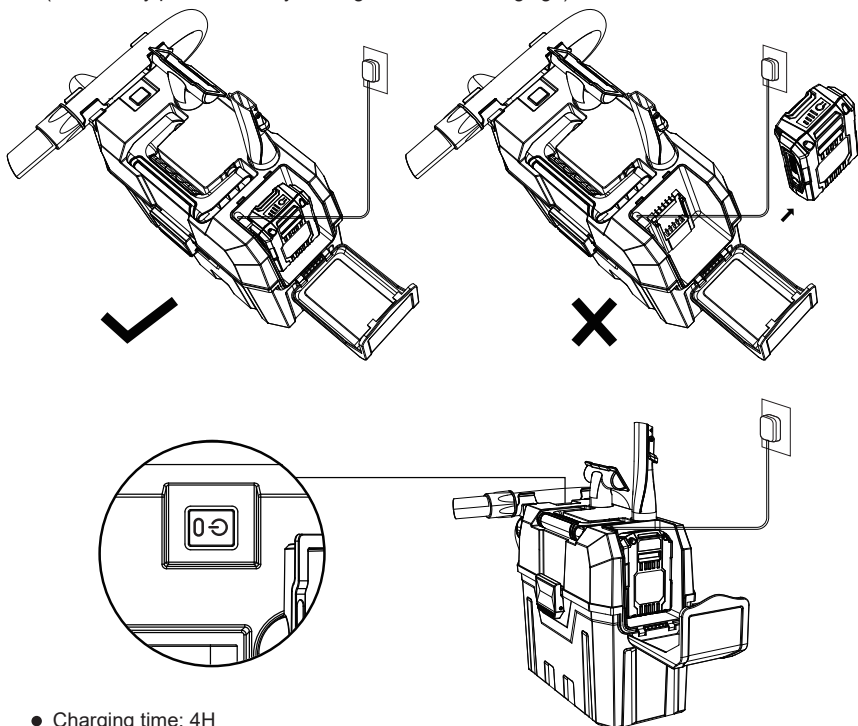

- Charging time: 4H
- When charging, the blue light grows to the full and fade repeatedly.
- When fully charged, the blue light is always on.

### IV. How to empty the dust tank

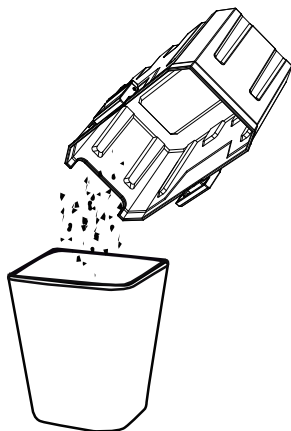



## V. Maintain the filter

1. Press the battery pack buckle to remove the battery.

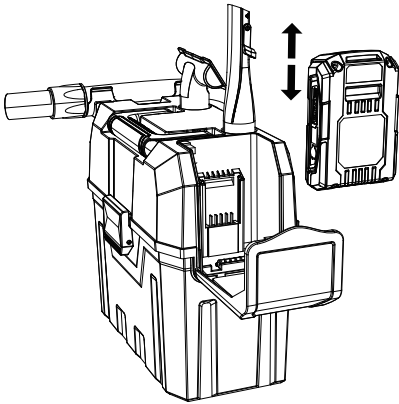

2. Open the dust tank as below:

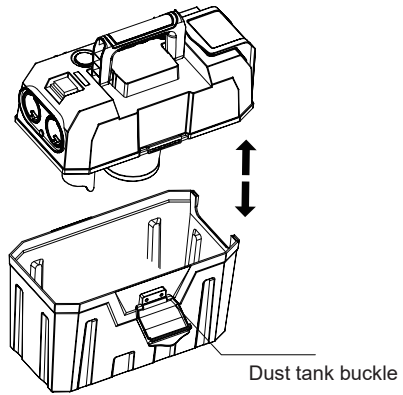

3. Take out the filter case, then take out the HEPA filter.

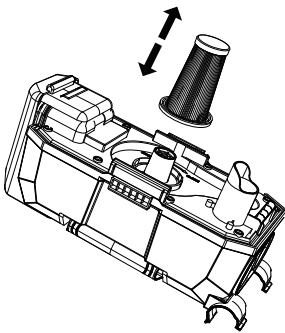

4. Rinse the filter case under tap.

**NOTE: Assemble it back when it is totally dry**

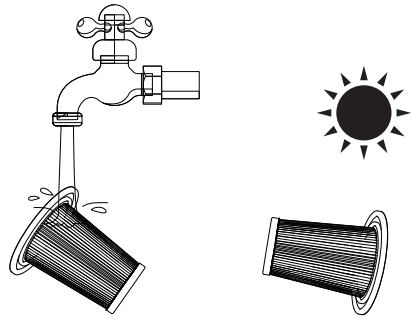

## Important Safety Instructions

**WARNING:** Basic safety precautions should always be observed when using an electrical appliance, including the following to reduce the risk of fire, electrical shock, or injuries.

Read this user manual carefully before first use. Keep this manual for further guidance in case.

## Personal Safety

1. Store it indoors in a dry place and out of the reach of children.
2. Always use responsibly. This appliance can be used by children aged from 10 years and above and persons with reduced physical, sensory or mental capabilities or lack of experience and knowledge if they have been given supervision or instruction concerning use of the appliance in a safe way and understand the hazards involved.
3. Do not let children play with the appliance. Supervision should be strictly taken when children are using or maintaining the appliance.
4. Use only manufacturer's recommended attachments as described in this manual. Misuse or use of any accessory or attachment other than those recommended, may present a risk of personal injury.
5. Take extra care when cleaning stairs.
6. Keep the appliance and accessories away from hot surface.
7. Do not block the appliances openings or hinder air flow, keep openings free of any objects including dust, lint, clothing, fingers (and all parts of the body).

## Electrical Safety

1. Only use batteries and chargers supplied by the manufacturer in case of causing fire.
2. Never modify the charger in any way.
3. Always check that the voltage stated on the rating plate corresponds to the local household voltage.
4. Before using, check the power cord for signs of damage or ageing. A damaged or entangled power cord increases the risk of fire and electric shock.
5. Never carry the charger by the cord.
6. Do not pull the cord to unplug it from a socket, grasp the plug to unplug in case of damaging the power cord.
7. Don't wrap the cord around the charger when storing.
8. Keep the power cord away from hot surfaces and sharp edges.
9. The power cord cannot be replaced. If the cord is damaged the charger should be discarded and replaced.
10. Do not handle the charger or the appliance with wet hands.
11. Do not store or charge the appliance outdoors.
12. The charger must be removed from the socket before removing the battery, cleaning or maintaining the appliance.

## Battery Safety

1. This appliance includes Li-ion batteries, do not incinerate batteries or expose it to high temperatures, as they may explode.
2. Leaks from the battery cells can occur under extreme conditions. Do not touch any liquid that leaks from the battery. If the liquid that gets on skin, wash it immediately with soap and water. If the liquid gets into the eyes, flush them immediately with clear water for at minimum of 10 minutes and seek medical help. Wear gloves to handle the battery and dispose it immediately in accordance with local regulations.
3. Shorting the battery terminals may cause burns or fire.
4. When the battery pack is not in use, keep it away from paper clips, coins, keys, nails, screws or other small metal objects that could make a connection from one terminal to another.
5. When you dispose of the appliance, remove the battery and dispose of the battery safely in accordance with local regulations.

## Service

1. Before using the appliance and after any impact, check for signs of wear of damage and repair as necessary.
2. Do not use the appliance if any part is damaged or defective.
3. Repairs should be carried out by a service agent or a suitably qualified person in accordance with relevant safety regulations. Repairs by unqualified persons could be dangerous.
4. Never modify the appliance in any way as this may increase the risk of personal injury.
5. Only use replacement parts or accessories provided or recommended by customer service.

## Intended Use

1. The appliance is for household use only.
2. Do not pick up anything that is flammable, burning or smoking.
3. Use only as described in this manual.

## Warning

1. Do not use water, solvents, or polishes to clean the outside of the appliance. Wipe it clean with a dry cloth.
2. Never immerse the unit in water and do not clean in a dish washer.

## Troubleshooting

Problem	Possible reasons	Potential solutions
Machine does not work	<ol style="list-style-type: none"> <li>1. Machine is in charging</li> <li>2. Switch is not turned on</li> </ol>	<ol style="list-style-type: none"> <li>1. Stop the appliance charging</li> <li>2. Turn on the power switch</li> </ol>
Suction gets weak	<ol style="list-style-type: none"> <li>1. Dust tank is full</li> <li>2. HEPA filter is too dirty</li> </ol>	<ol style="list-style-type: none"> <li>1. Empty the dust cup</li> <li>2. Clean the HEPA filter</li> </ol> <p>Check if the dust tank is installed correctly</p>
Battery can not get charged on the charger holder	<ol style="list-style-type: none"> <li>1. The charger is not connected well to the appliance</li> <li>2. The indicator light malfunctions</li> </ol>	<ol style="list-style-type: none"> <li>1. Check if the charger &amp; charging base is connected correctly</li> <li>2. If the indicator light is not on during charging, please contact the seller for help</li> </ol>
The power switch indicator light does not shine	The battery pack is not installed or is not attached properly	Check and attach the battery pack to the vacuum, a "Click" would be heard if it fits properly
The power switch's red indicator light flashes quickly (three times per second)	Misuse of the adapter	Please use the original adapter for charging only
The power switch's red indicator light flashes slowly (once per second)	The battery runs out	Please charge the vacuum according to the manual

## Recycling (Disposal of the product)



The symbol on this appliance indicates that this appliance may not be recycled as common household rubbish. Waste electrical products should not be disposed along with household waste. Please recycle according to local regulations.

# Warranty

## CUSTOMER CARE

The 1-year Limited Warranty is valid for products purchased from our Ezetek only, starting from the date of the original retail purchase. We will provide customer service for any defects in quality or materials under normal, non-commercial use.

1. According to the requirements outlined in this instruction manual, the warranty is subject to the following conditions and exclusions.
2. This warranty provides, at no extra cost to you all labor and parts necessary to ensure your machine is in proper operating condition during the warranty period.
3. We provide the repair or replacement of your Ezetek appliance if your Ezetek appliance is found to be defective due to faulty materials, workmanship function within 1 year of purchase or delivery. ( If any part is no longer available or out of manufacture, we will replace it with a functional replacement part).

## WHAT IS NOT COVERED

1. Under your Ezetek guarantee, Ezetek shall not be liable for costs of repair or replacement of a product incurred as a result of: Accidental damage, faults caused by negligent use or care, misuse, neglect, careless operation or handling of the Ezetek appliance which is not in accordance with this Ezetek Operation Manual.
2. Machines purchased from an unauthorized dealer.
3. Use of parts and accessories other than those produced or recommended by Ezetek.
4. Repairs or alterations carried out by unauthorized parties or agents.
5. Use of the machine other than for normal domestic purpose, e.g. for commercial or rental purposes.
6. Reduction in battery run time due to battery age or use.

## WARRANTY SERVICE

1. If you have a query about your Ezetek appliance, please contact the Ezetek customer service email: [ezetek.service@outlook.com](mailto:ezetek.service@outlook.com)
2. Please inform us your model name/number, purchase date, order number, machine problem and your requirement.
3. Your model number can be found on rating plate. For information on your rating plate see the inside front cover.
4. Please keep your purchase receipt in a safe place to ensure you have this information.
5. Service under this warranty will not extend the available time of warranty.





Contact us:  
24 hours feedback guarantee



[ezetek.service@outlook.com](mailto:ezetek.service@outlook.com)

# Ezetek

**TECHNOLOGY MAKES LIFE EASIER**