

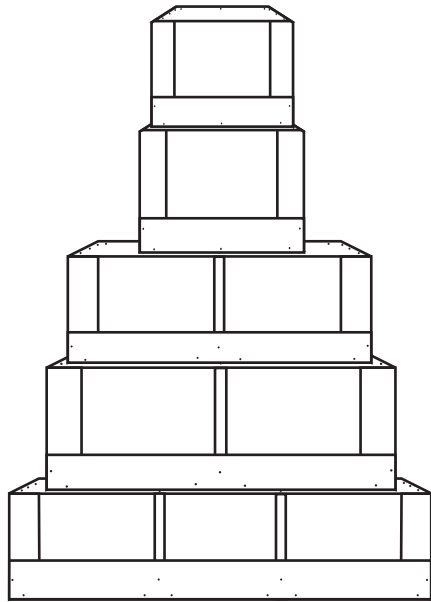

Nesting Box Assembly Instructions



Important Notes:

Lay out all components prior to start of assembly.

Flat level surface recommended for assembly.

If any components are missing or damaged do not return to retailer.
Please call Rugged Ranch Products at:
760-734-3748

Please visit our website to see our complete line of Rugged Ranch Products.
www.ruggedranch.com

Studio & XL Studio

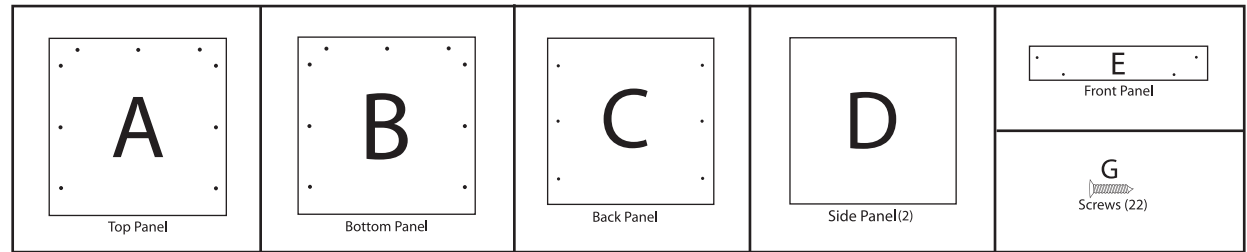

Duplex & XL Duplex

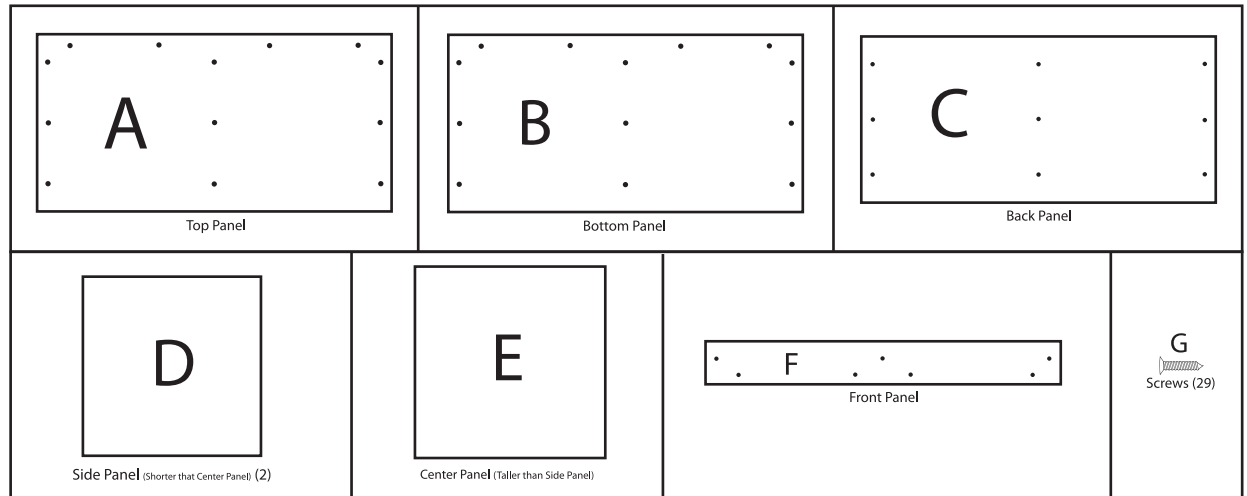

Triplex

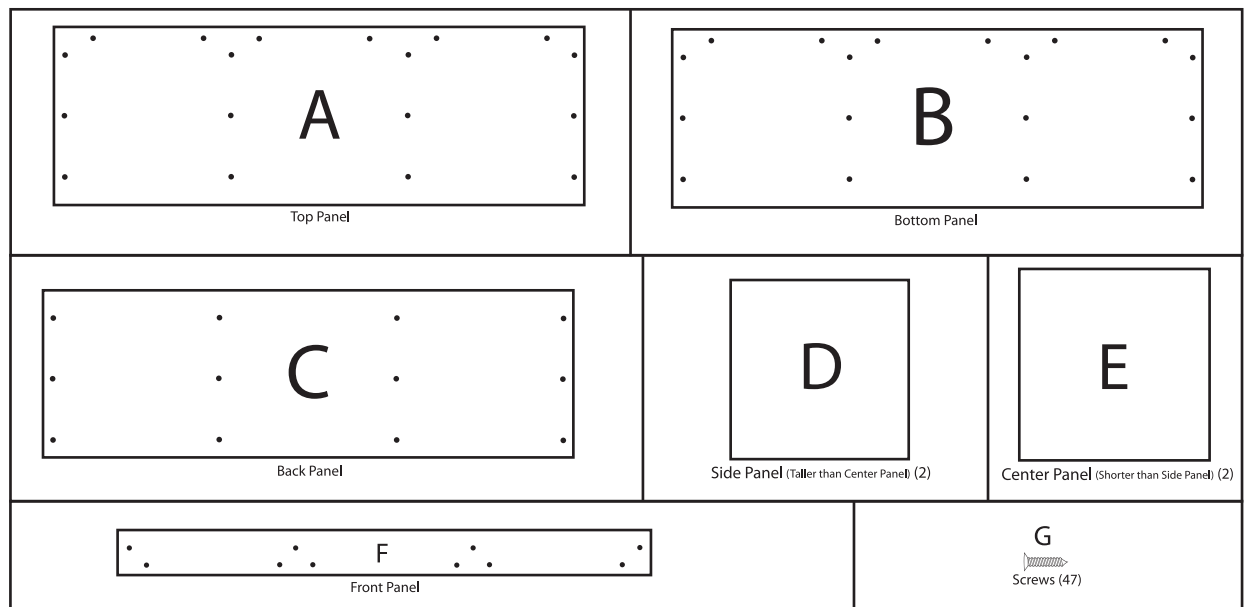

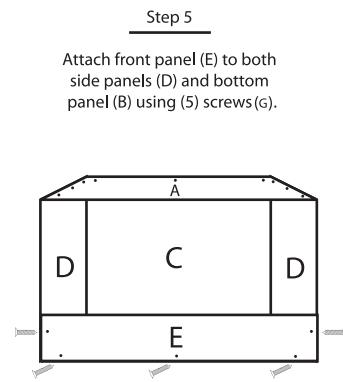
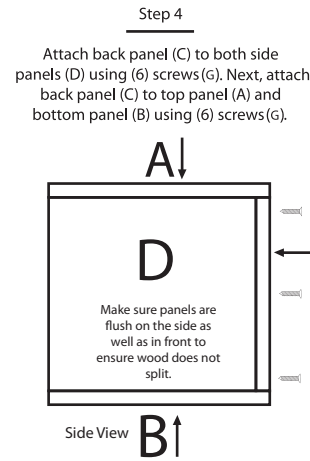
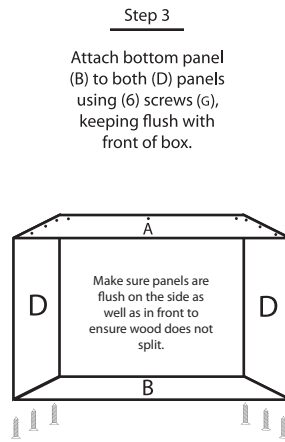
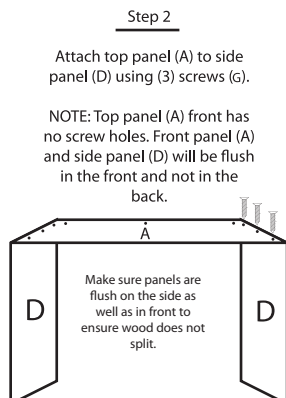
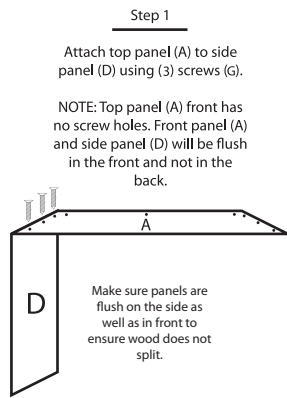

NOTE: Wood does tend to have a natural bend in it when stored in packaging. If you experience any splitting, don't worry. We have provided extra pre-drilled holes as well as screws. It is not necessary to use all three holes on each side.

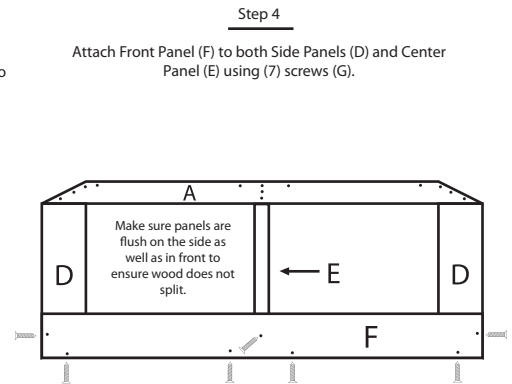
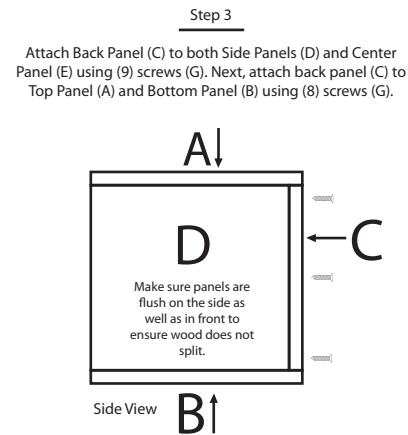
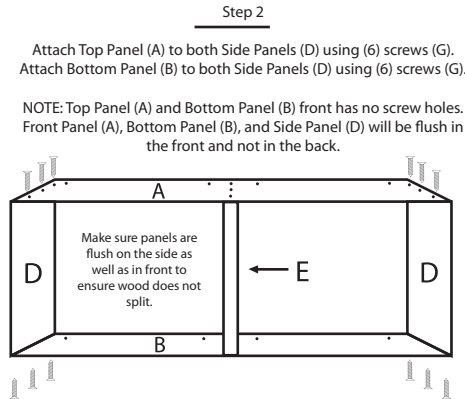
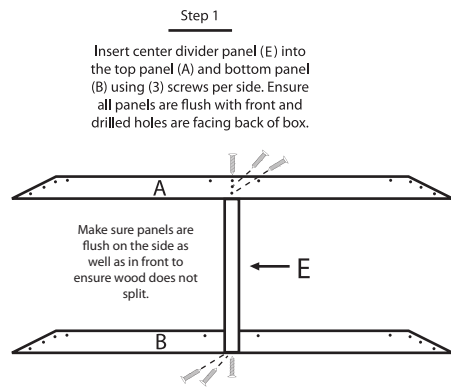

When inserting the center divide for any of the following: Duplex, XL Duplex, or Triplex: Slide Center Panel(s) through grooves to clear any possible debris that may be built up. This ensures the tightest and straightest possible fit.

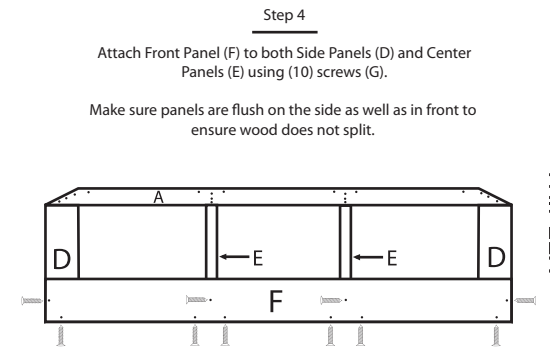
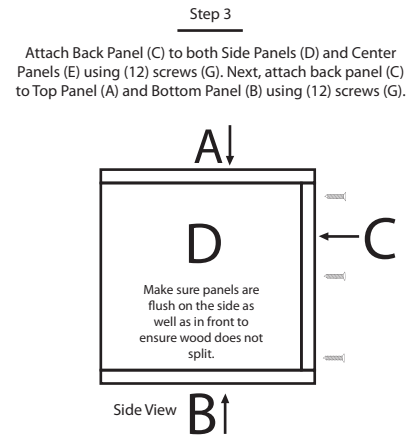
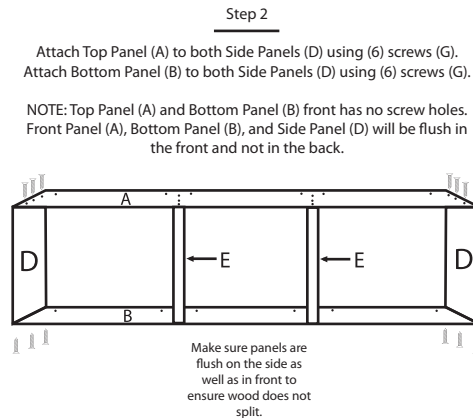
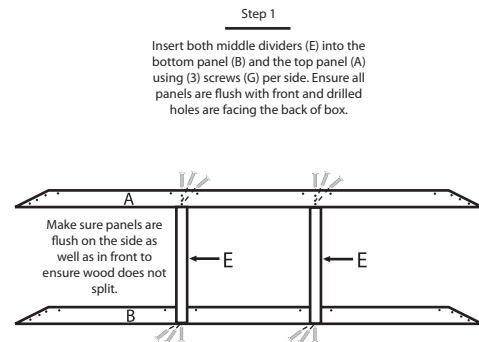

When inserting the center divide for any of the following: Duplex, XL Duplex, or Triplex: Slide Center Panel(s) through grooves to clear any possible debris that may be built up. This ensures the tightest and straightest possible fit.