

# **INSTALLATION**

## *Product Manual*



### **IMPORTANT INFORMATION!**

please read the entire manual before starting to assemble and/or using this product. follow the manual thoroughly and keep it for further reference.



### **AVOID SCRATCHES!**

In order to avoid scratching this furniture should be assembled on a soft layer-could be a rug.



### **IMPROVE EFFICIENCY !**

Try to find a partner to install with you, which can speed up the installation efficiency and shorten the time.



### **ANTI-TOPPLE WARNING !**

Overturned furniture can cause serious or fatal crush injuries. To prevent tipping over, be sure to use the wall attachment, if not included with this product. Please purchase the wall attachment that fit your wall. If unsure, seek professional advice. Please read and follow each step of the instructions carefully.

### **IMPORTANT !**

It is important that any product which is assembled using any kind of screw is re-tightened 2 weeks after assembly, and once every 3 months - in order to assure stability through-out the lifespan of the product.

For regular maintenance and cleaning of the product, for the frame, please use a rag dipped in neutral detergent to fully wipe it, and then dry it with a clean rag. For glass materials, wipe with a rag dampened with water glass cleaner, and then dry with a dry rag.

Do not use an electric screwdriver, and do not use too much force when installing, because the board is easy to break.

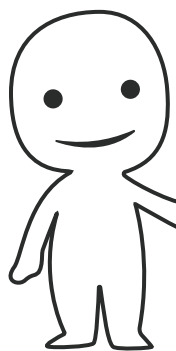

Please prepare the following tools

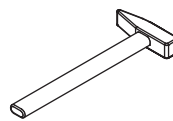
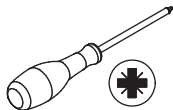

When installing, please carefully confirm whether each screw corresponds to the manual, accessories with similar shapes can be distinguished by size

A x 51



CRB1295A

B x 51

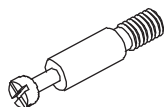

CRA0640A

C x 12

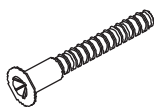

CRC0540A

D x 4

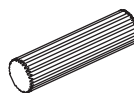

CRF0640A

E x 8

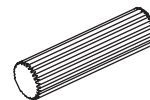

CRF0840A

F x 18

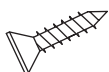

CRD0312A

G x 56



CRD3512A

H x 4



CRD3520A

J x 2



CRD3525A

K x 1

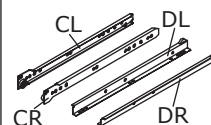

WX0810A

L x 1

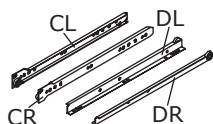

WX0812A

M x 2

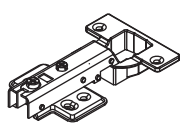

DGA861A

N x 4

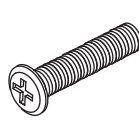

CRE0615A

P x 2

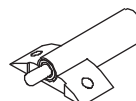

Q x 1

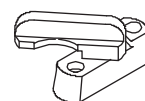

R x 2

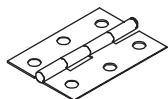

L = 44 mm

S x 4

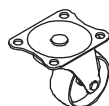

H = 48 mm

T x 2

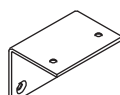

U x 2



V x 4



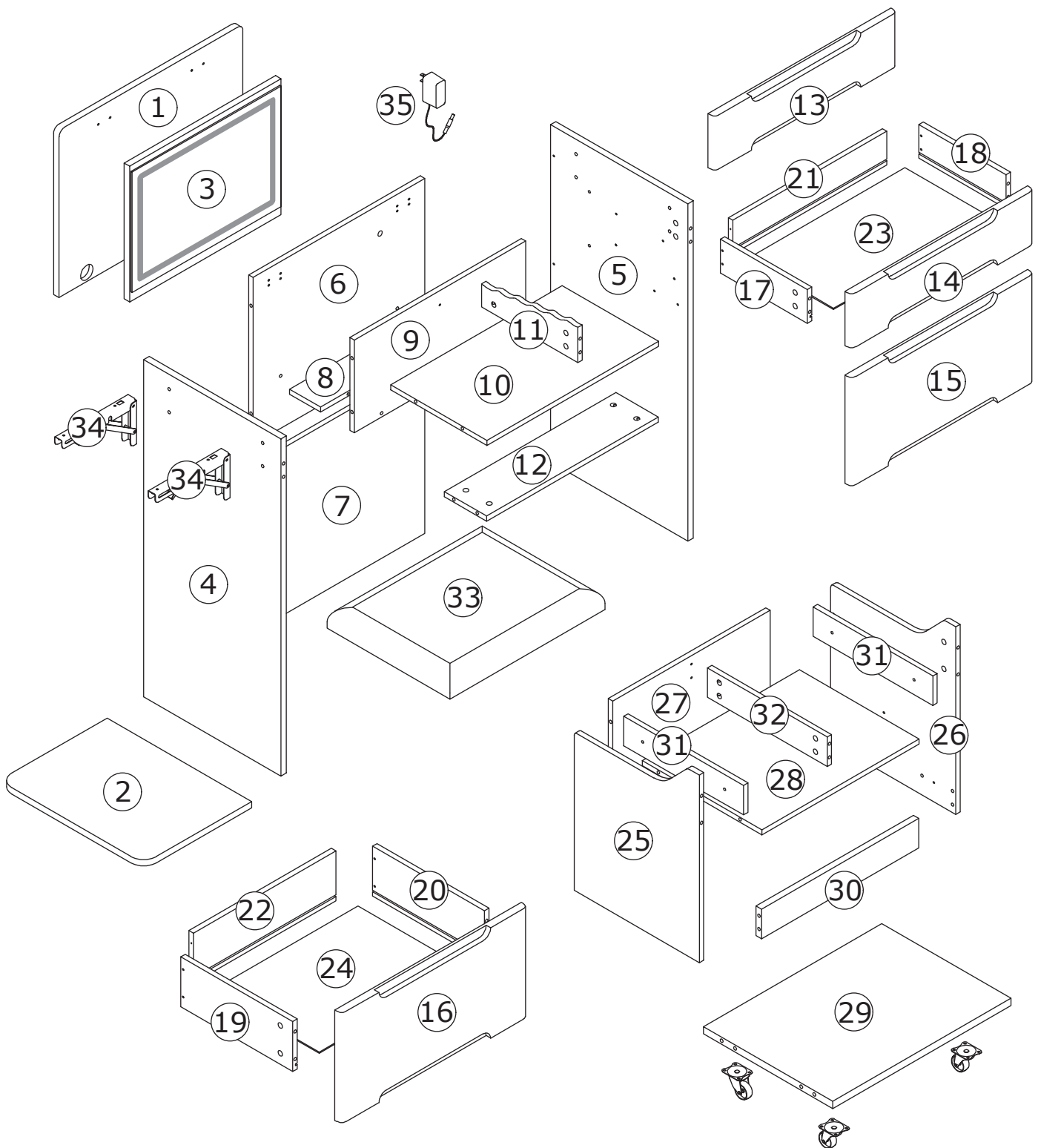

## ⚠ WARNING



**Children have died from furniture tipover. To reduce the risk of furniture tipover:**

- ALWAYS install Anti-tip device provided.
- NEVER put a TV on this product.
- NEVER allow children to stand, climb or hang on drawers, doors, or shelves.
- NEVER open more than one drawer at a time.
- Place heaviest items in the lowest drawers.

*This is a permanent label.  
Do not remove!*

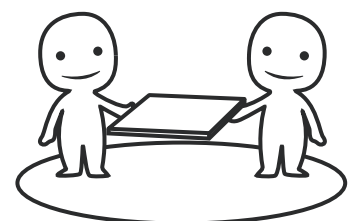

ASSEMBLED BY 2 ADULTS

# 1

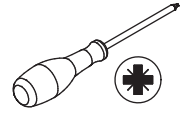
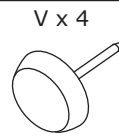
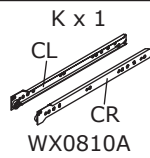
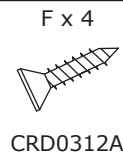
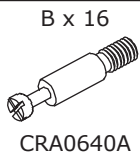

Fix rail(K-CL) and (K-CR) to board 4 and 5 with screw(F) at first.  
Screw eccentric rod(B) into board 4 and 5, knock foot peg(V) into bottom as shown.

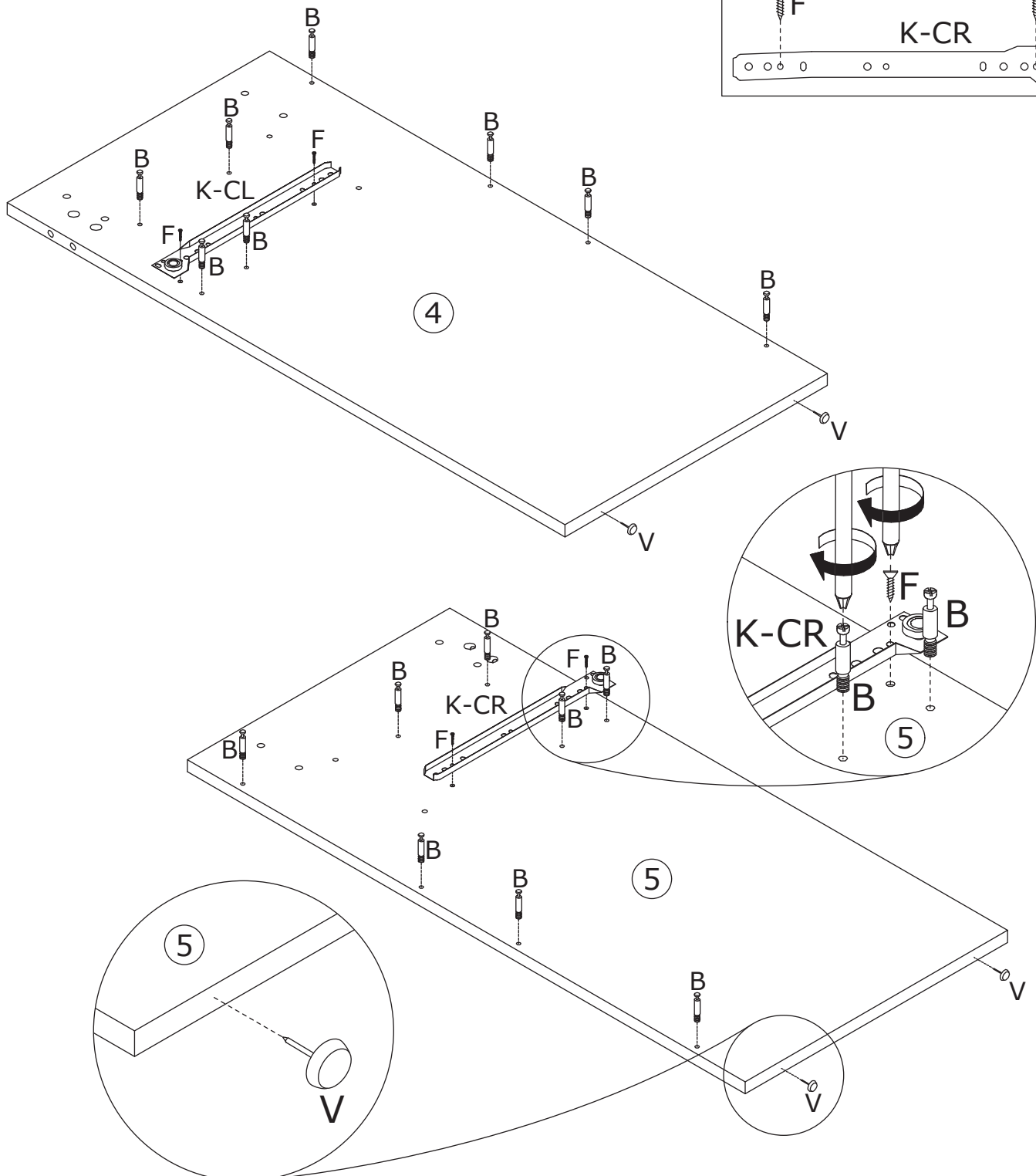
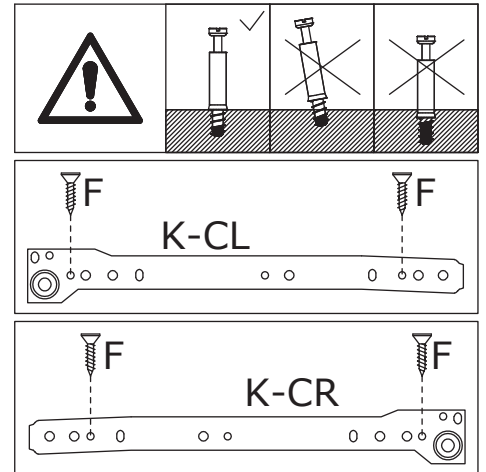

2

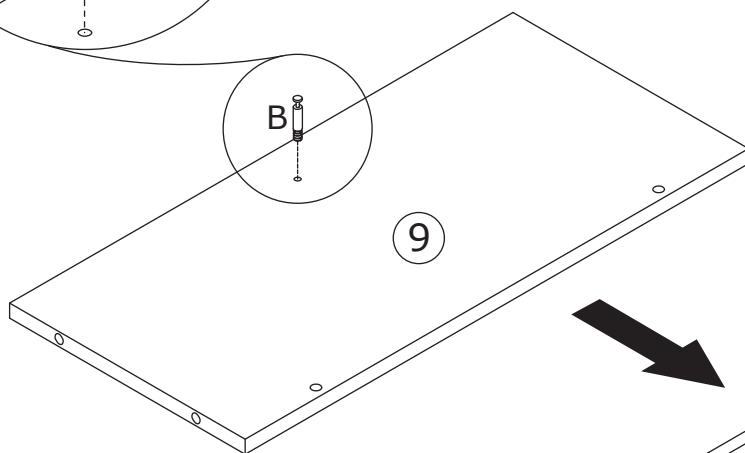
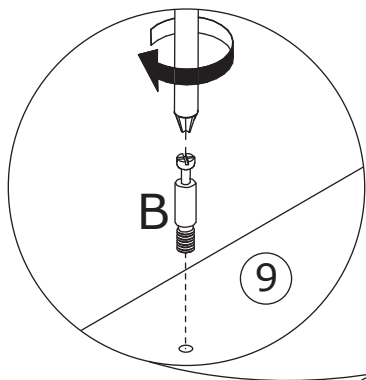
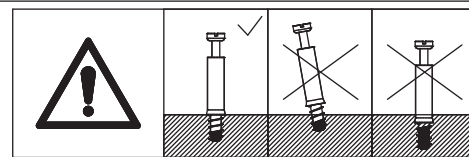
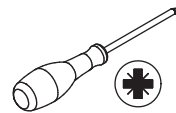
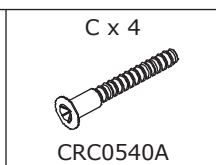
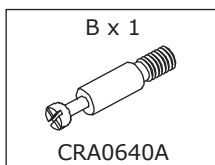

Screw eccentric rod(B) into board 9 at first.  
Fix board 8 to board 6 and 9 with screw(C) as shown.

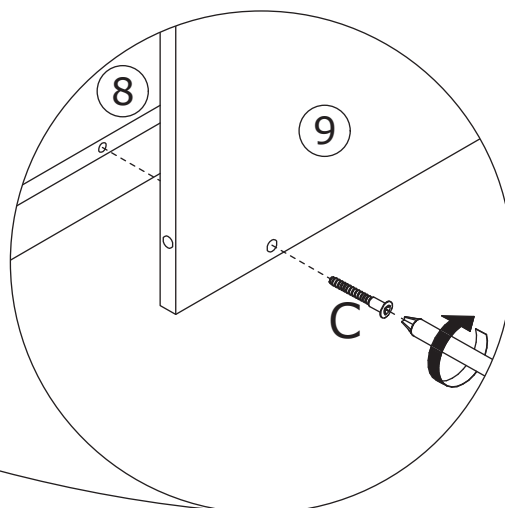
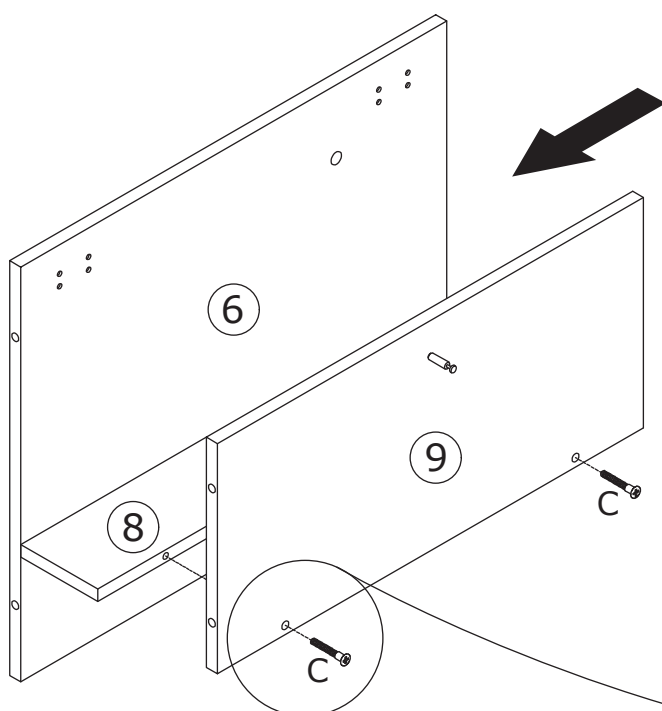
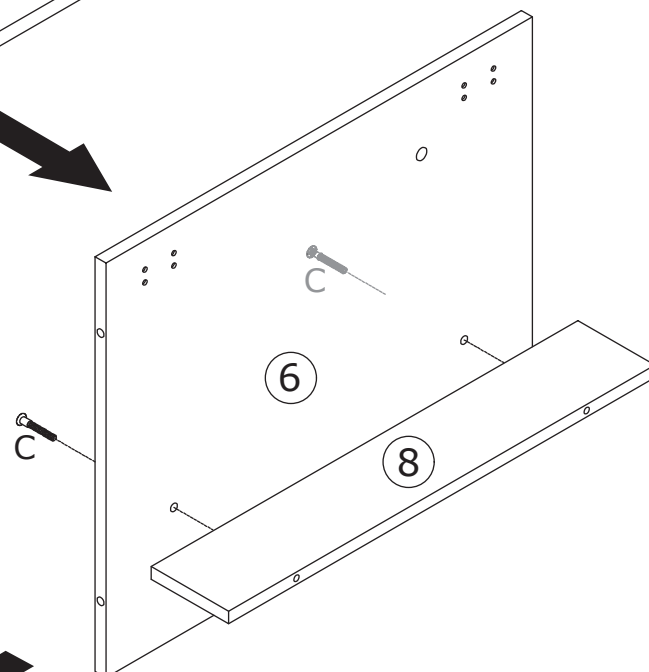

# 3

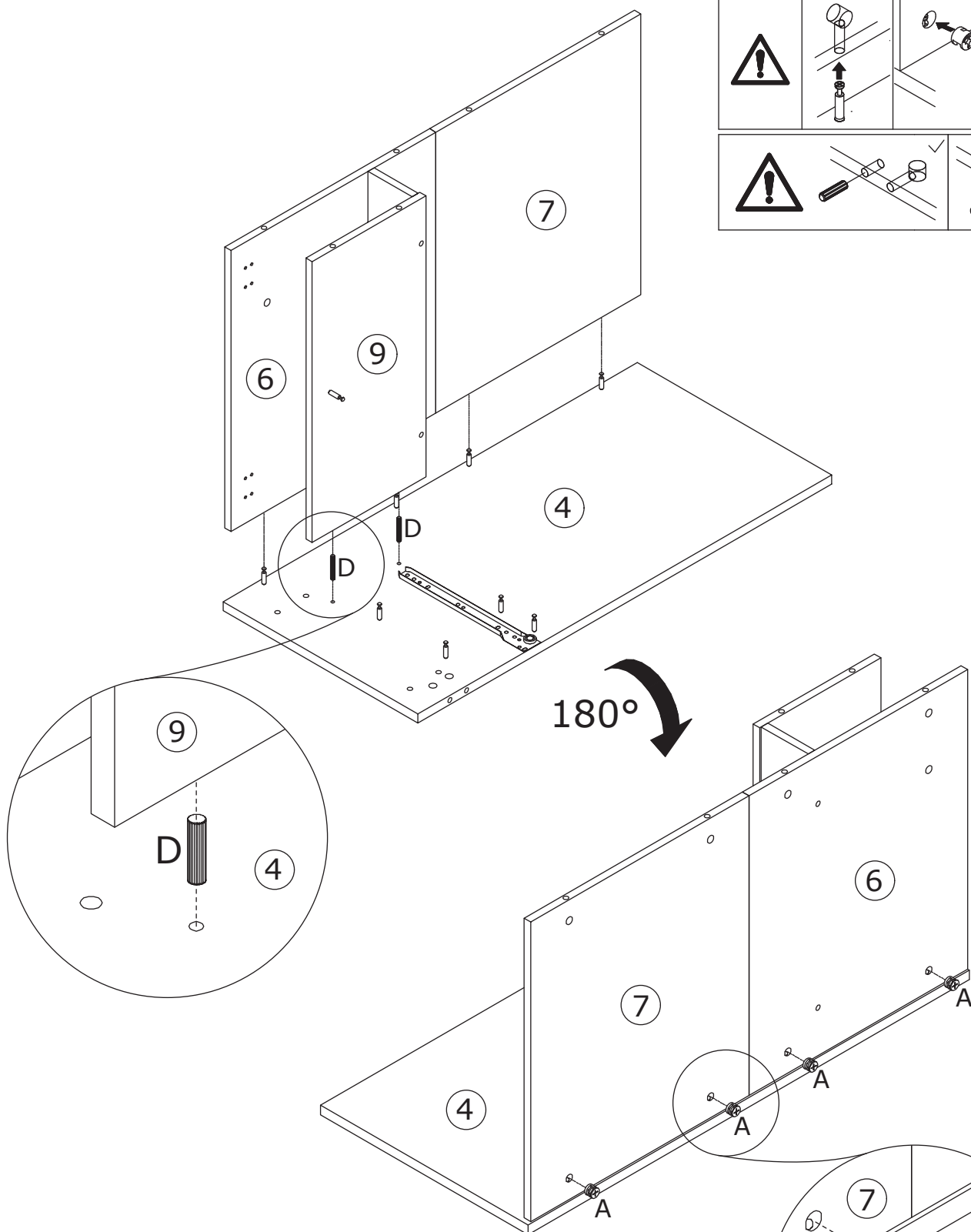
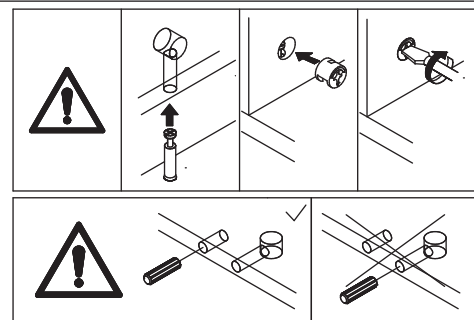
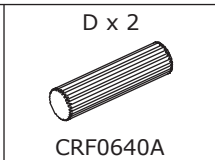
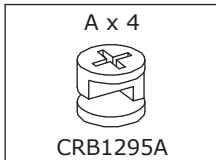

Insert wooden dowel(D) into board 9 at first. Attach board 6, 9 and 7 to board 4, add cam lock(A) into board 6,7 and turn clockwise to tighten as shown.

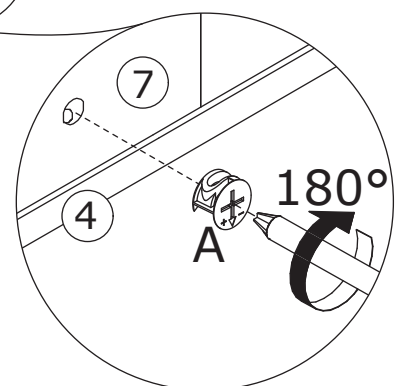

# 4

A x 2



CRB1295A

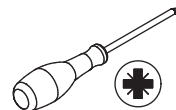

Attach board 10 to board 4, add cam lock(A) into board 10 and turn clockwise to tighten as shown.

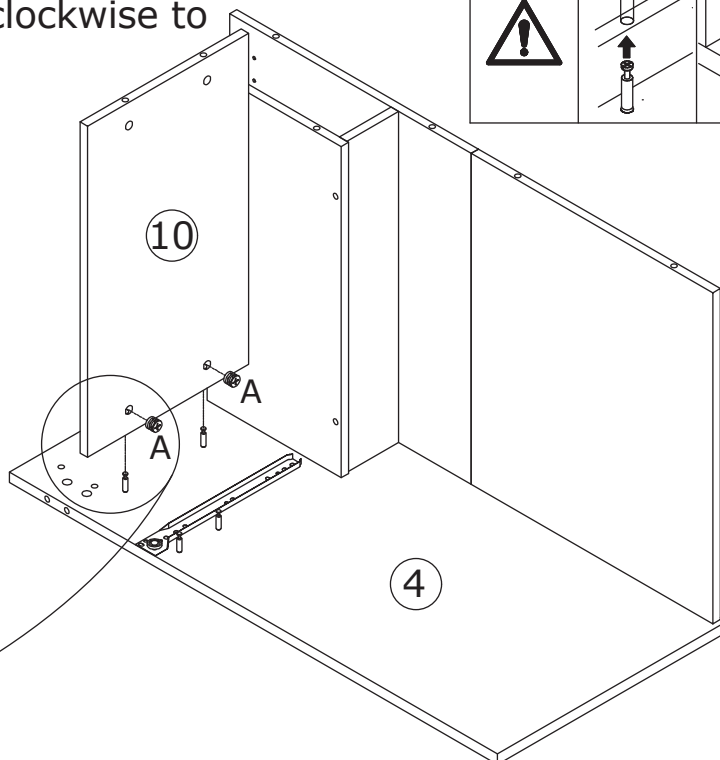
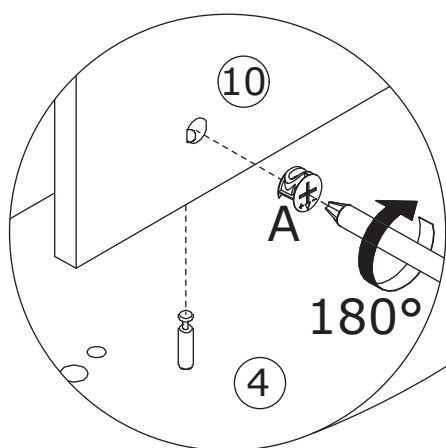
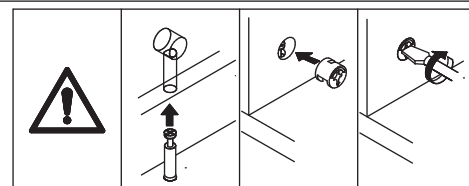

# 5

A x 2



CRB1295A

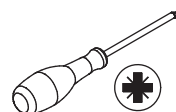

Attach board 12 to board 4, add cam lock(A) into board 12 and turn clockwise to tighten as shown.

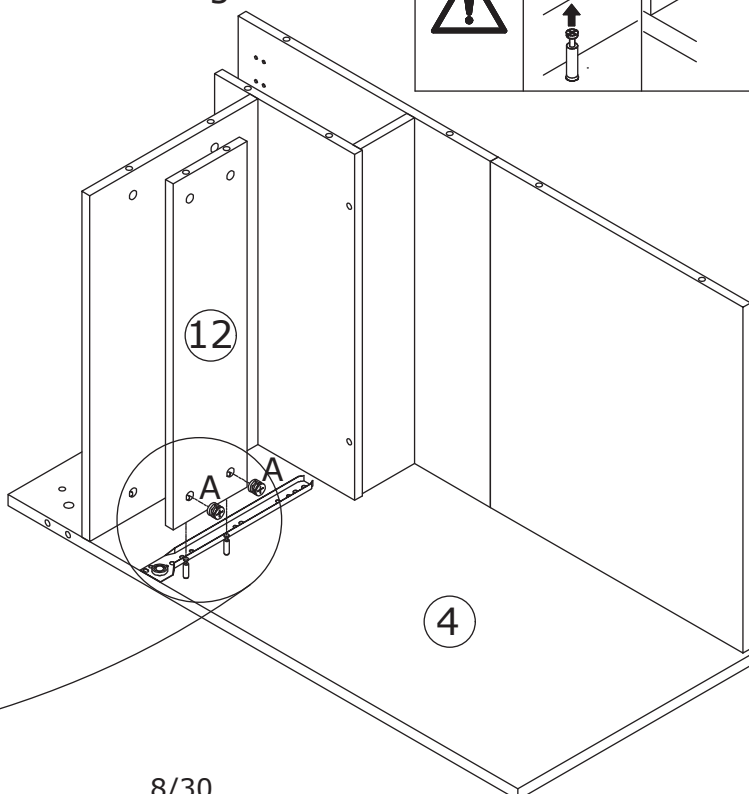
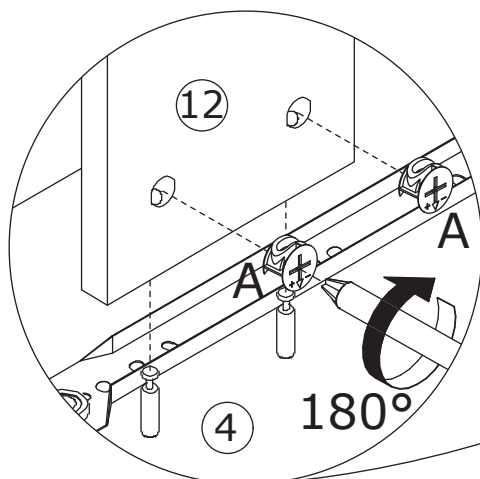
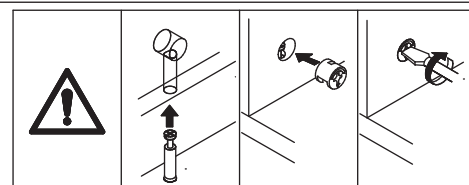



6

A x 8



CRB1295A

D x 2

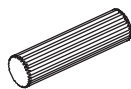

CRF0640A

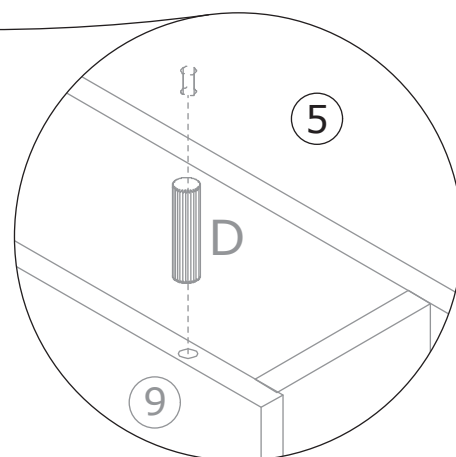
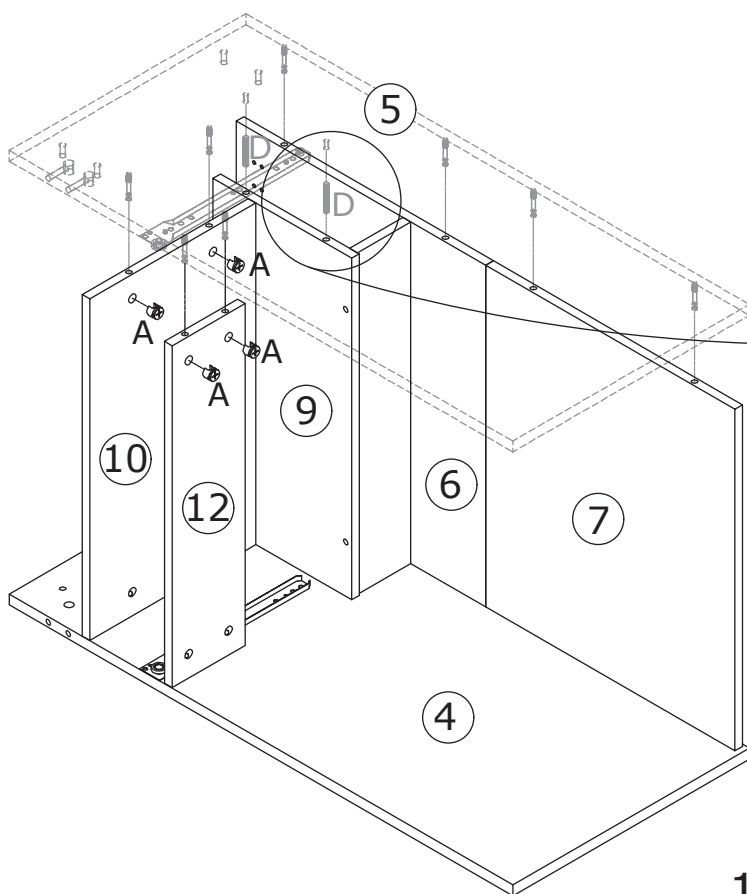
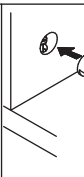
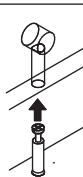
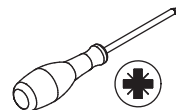

180°

Insert wooden dowel(D) into board 9 at first.  
Attach board 5 to the component, add cam  
lock(A) into board 6,7,10,12 and turn  
clockwise to tighten as shown.

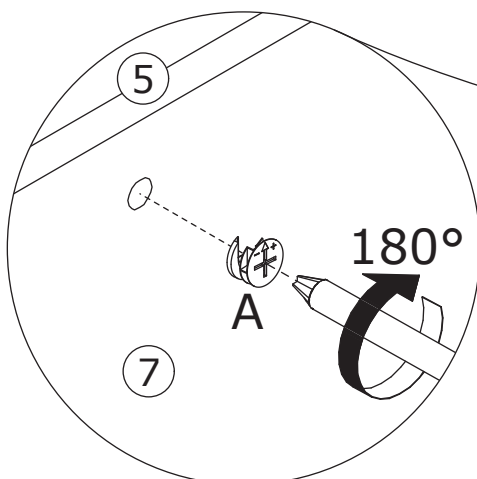
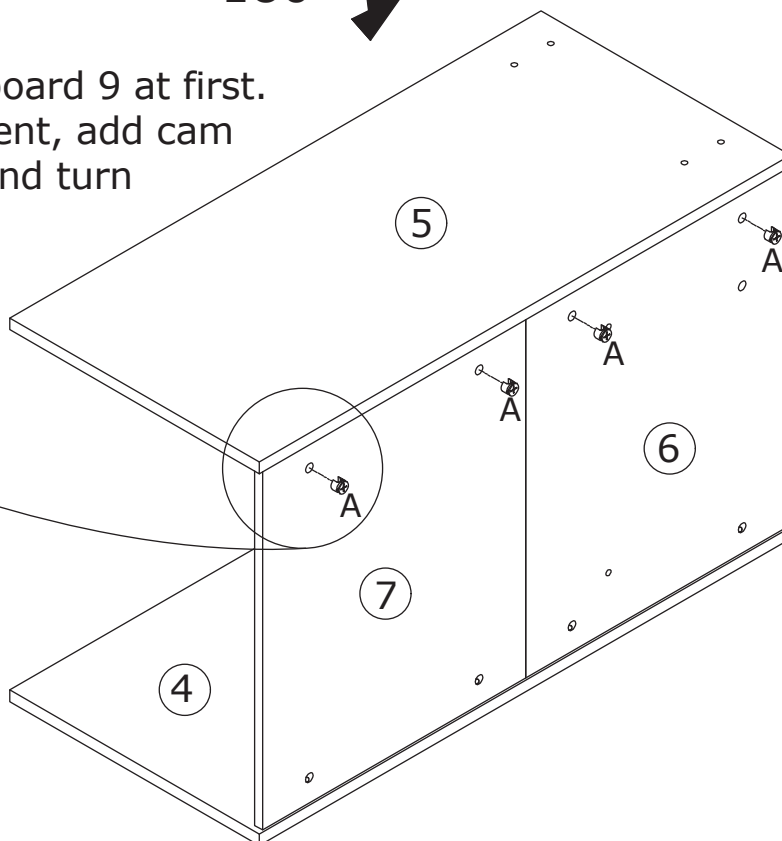

7

A x 1  
CRB1295A

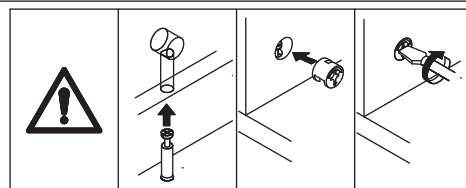

Attach board 11 to board 9, add cam lock(A) into board 11 and turn clockwise to tighten as shown.

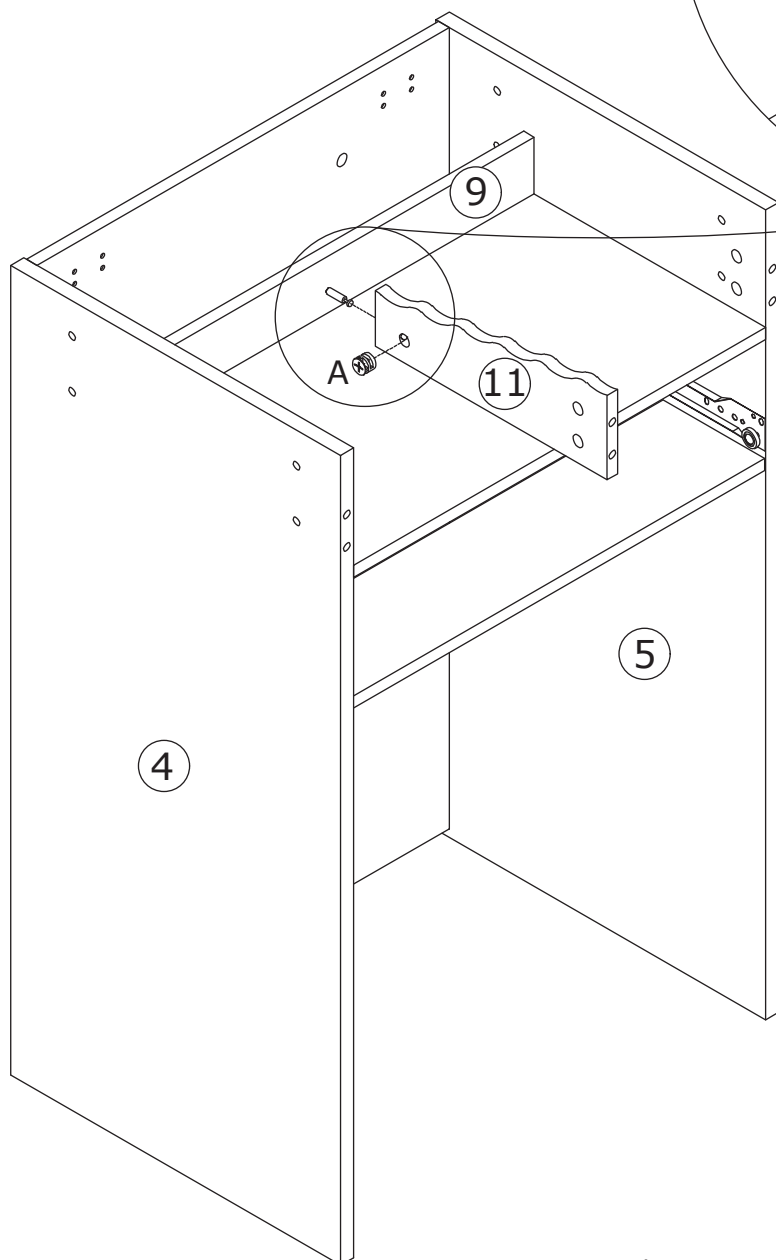
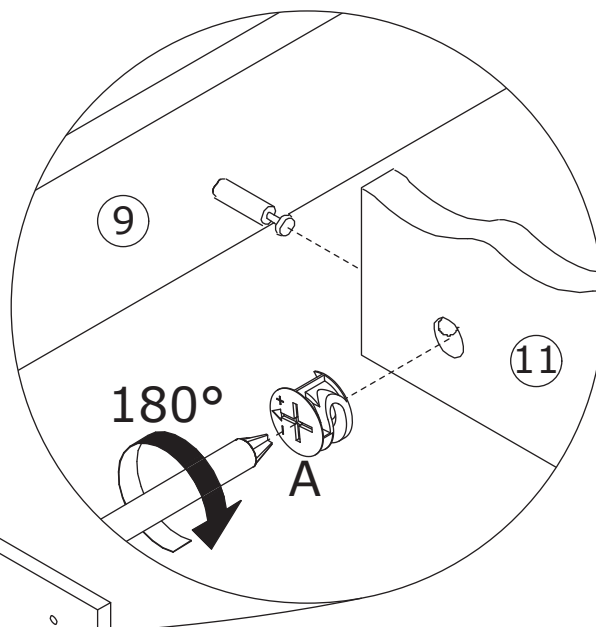

8

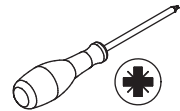
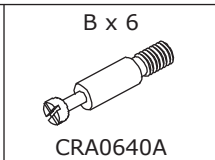
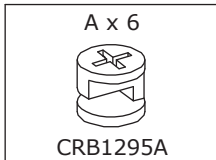

Screw eccentric rod(B) into board 13 as shown. Attach board 13 to board 4, 11 and 5, add cam lock(A) into and turn clockwise to tighten as shown.

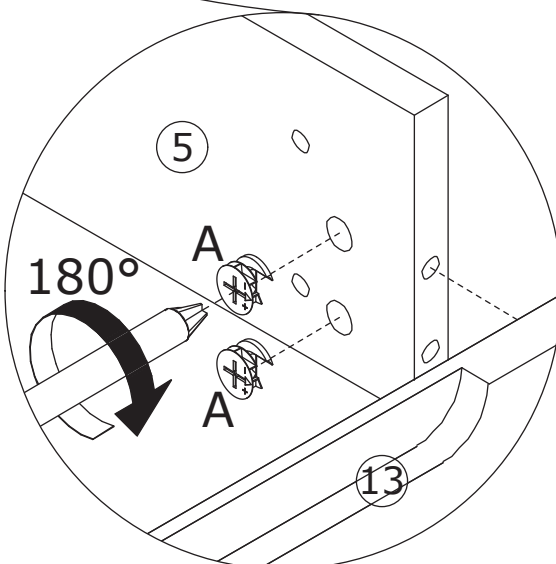
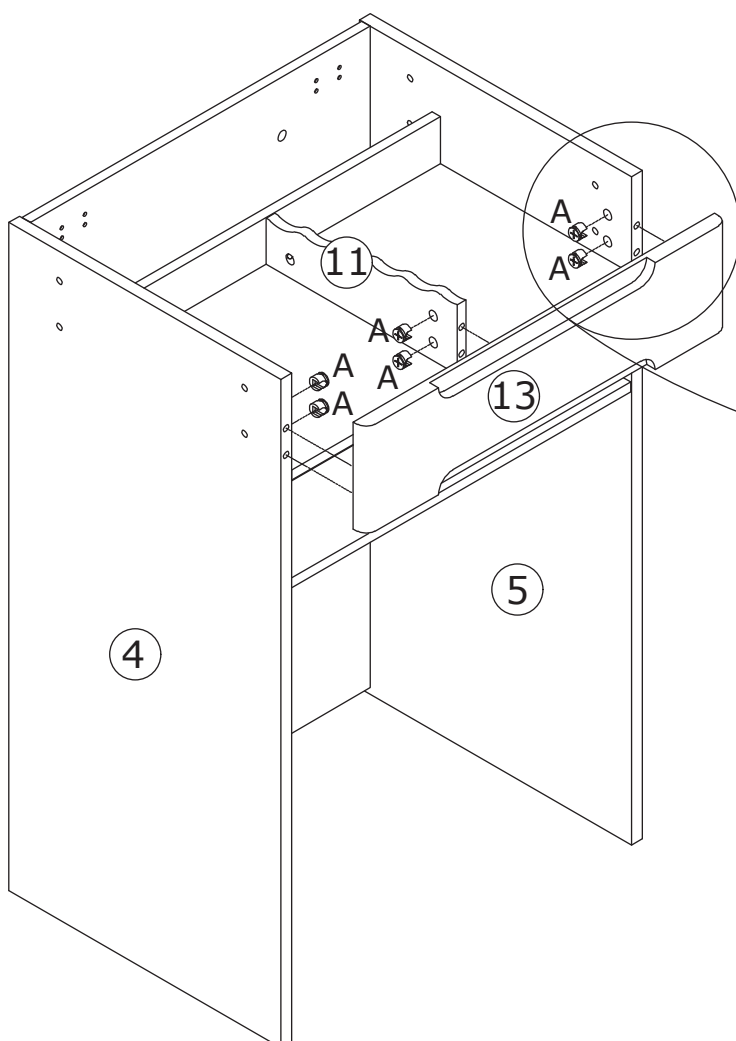
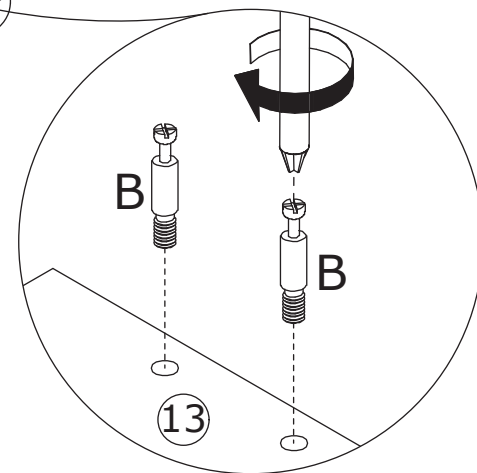
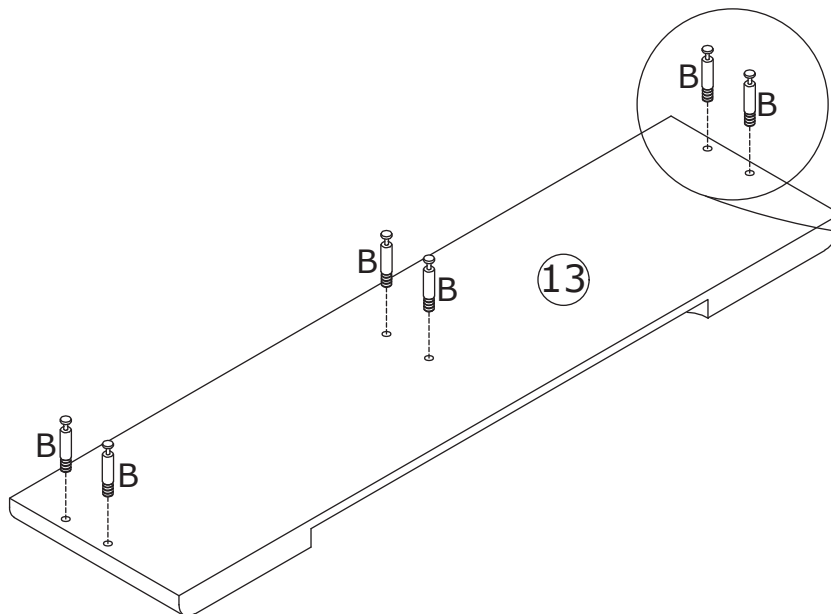
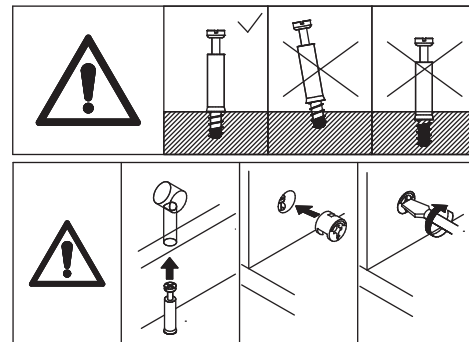

9

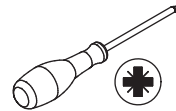
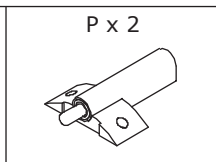
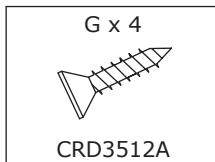

You will need to use self tapping screws to secure the parts, making sure that the parts are flush with the two panels.

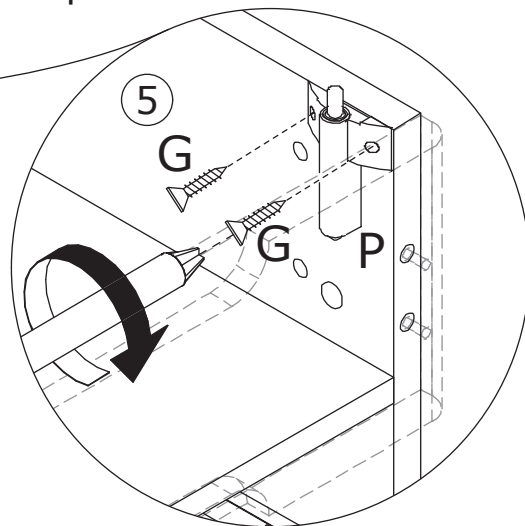
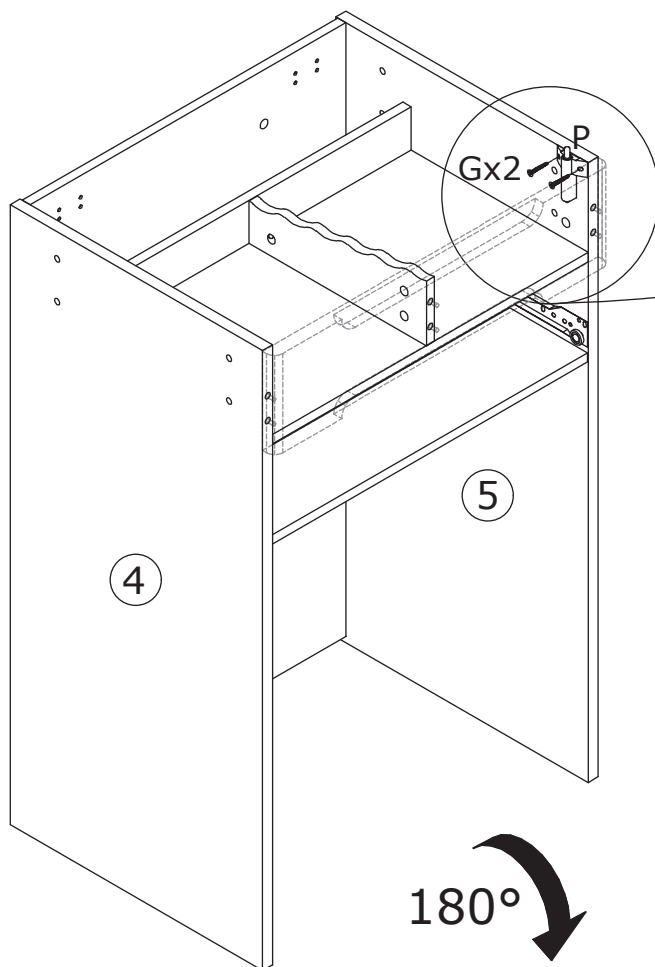

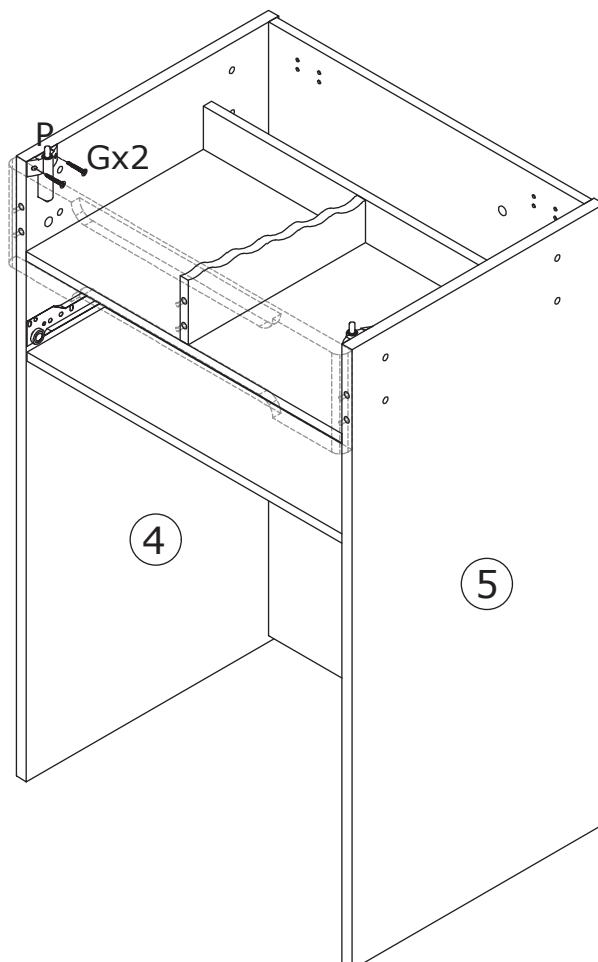

180°

Fix part(P) to 4 and 5 with screw(G) as shown.

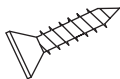

# 10

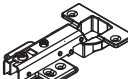
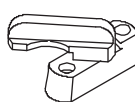
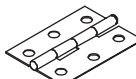
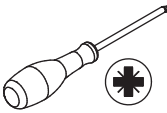
<p>G x 8</p>  <p>CRD3512A</p>	<p>J x 2</p>  <p>CRD3525A</p>	<p>M x 2</p>  <p>DGA861A</p>	<p>Q x 1</p> 	<p>R x 2</p> <p>L = 44 mm</p> 	
--	--	---	---	---	---

Fix hinge(R) to board 3 with screw(G) as shown.

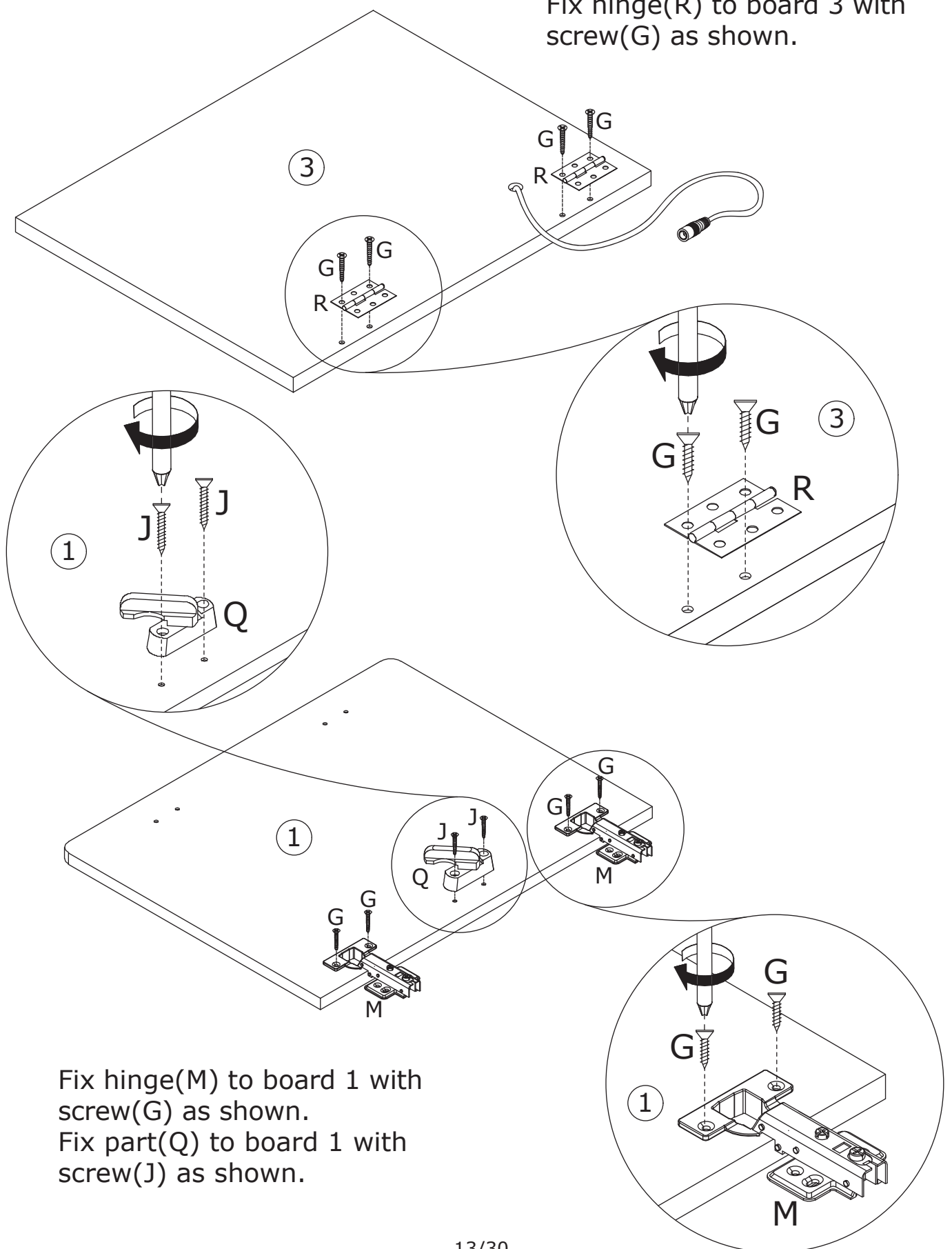

# 11

F x 2

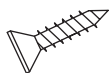

CRD0312A

G x 4

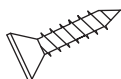

CRD3512A

U x 2

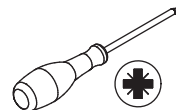

Attach board 3 to board 1 by fixing hinge as shown.  
Fix the power cord to board 1 using buckle(U) and screw(F) as shown.

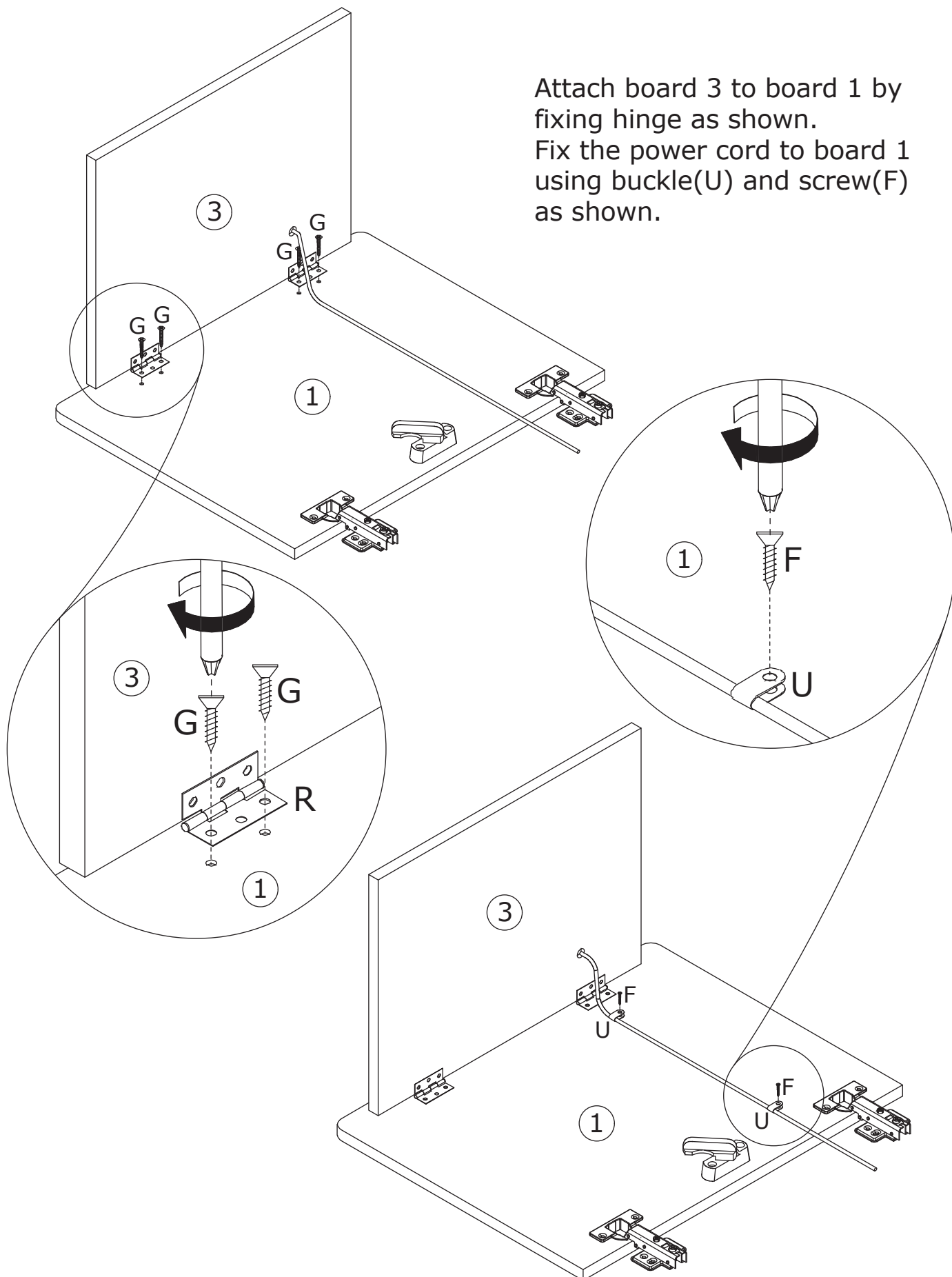

# 12

G x 8

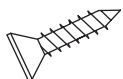

CRD3512A

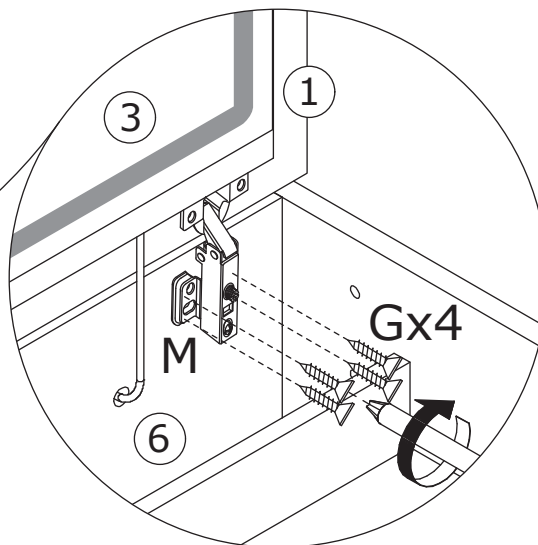
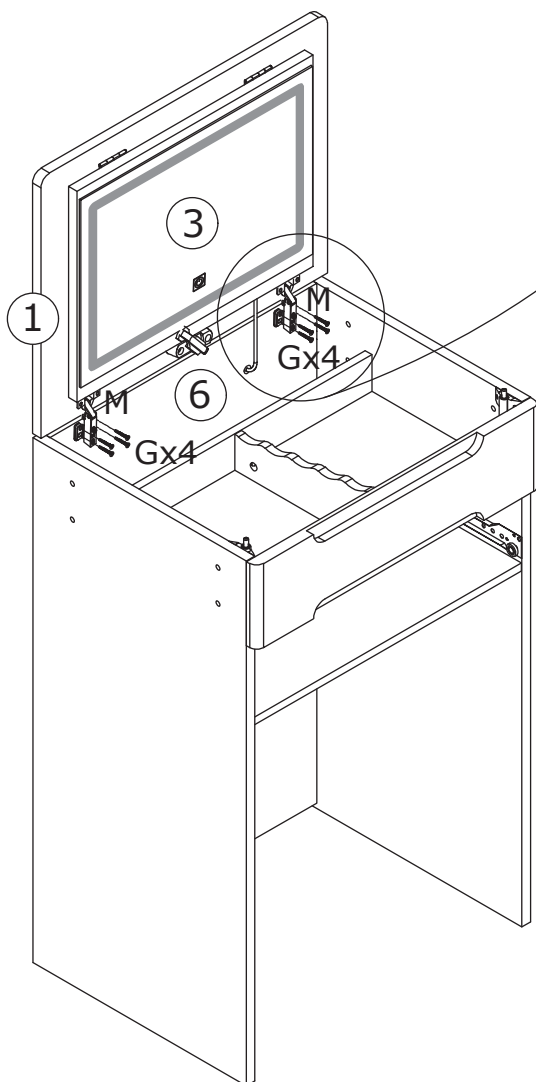
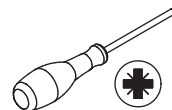

Attach board 1 to board 6 by fixing hinge as shown.

180°

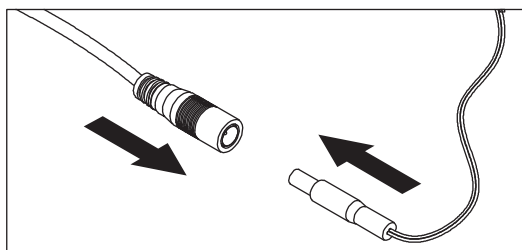
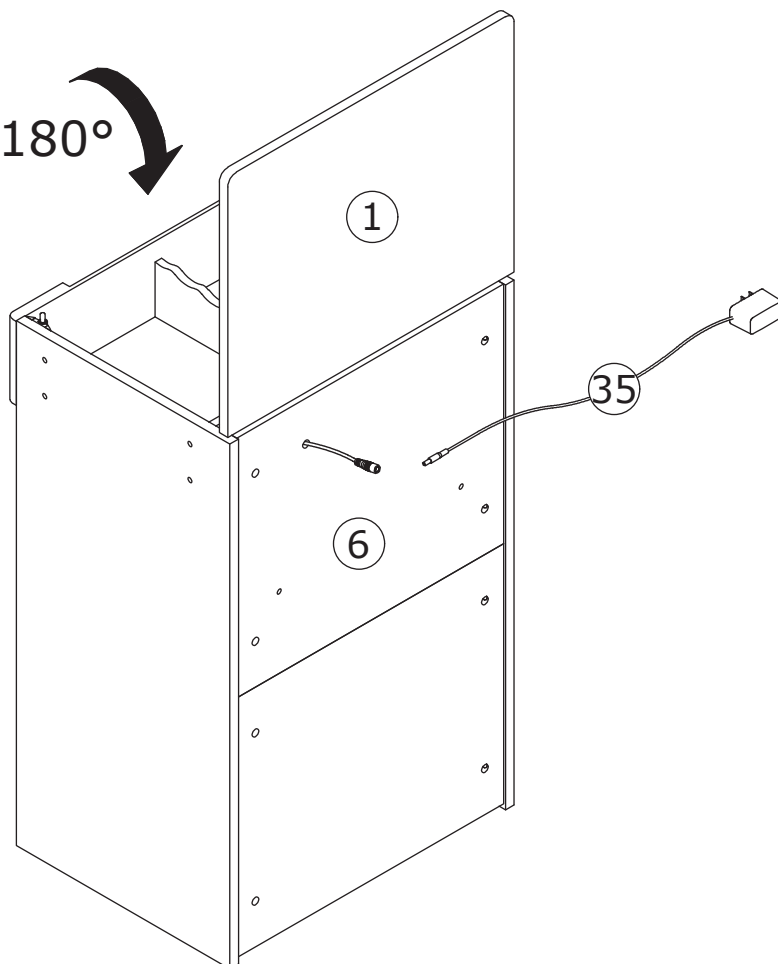

Route the cord through the backplane hole, and then connect to the power adapter.

# 13

G x 4  
CRD3512A

N x 4  
CRE0615A

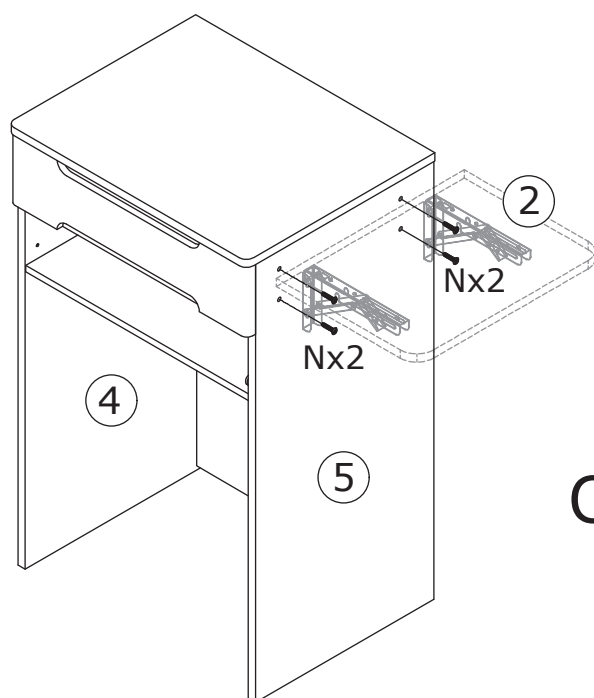
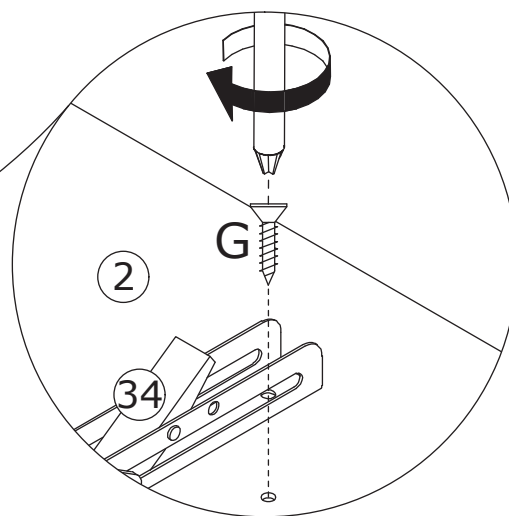
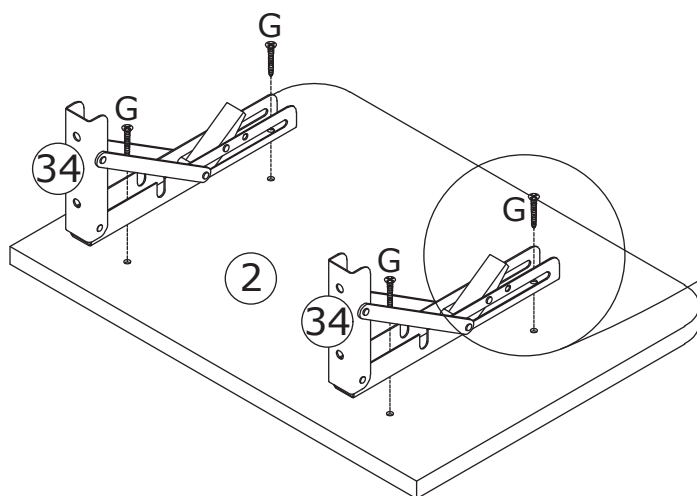
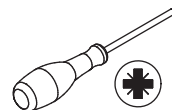

Fix part 34 to board 2 with screw(G) at first. Fix board 2 to the unit with screw(N) as shown.

OR

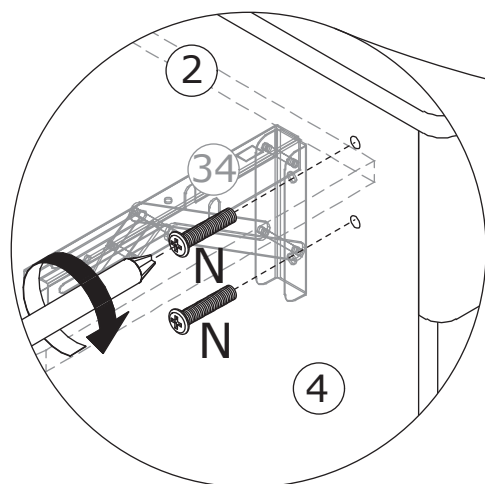
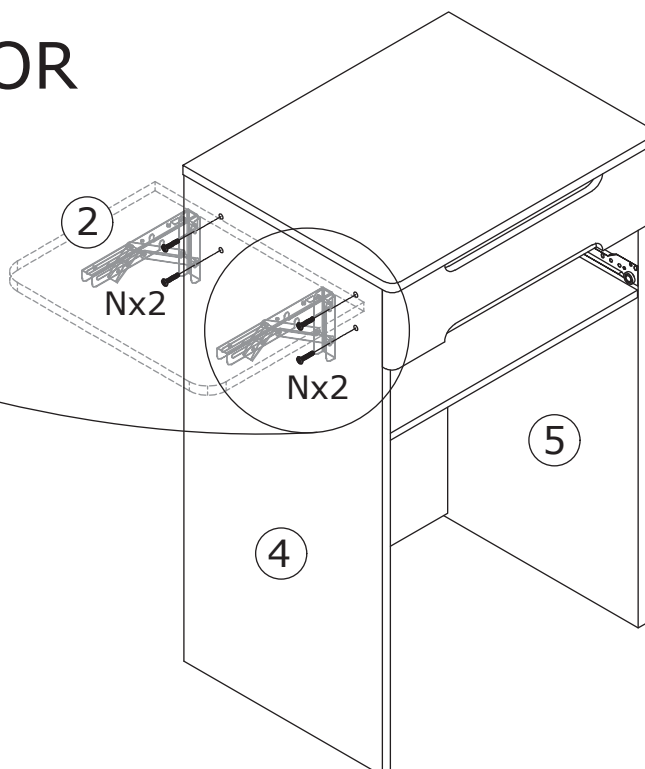



# 14

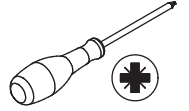
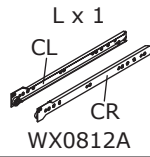
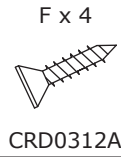

Fix rail(L-CL) and (L-CR) to board 25 and 26 with screw(F) at first.  
Screw eccentric rod(B) into board 25 and 26 as shown.

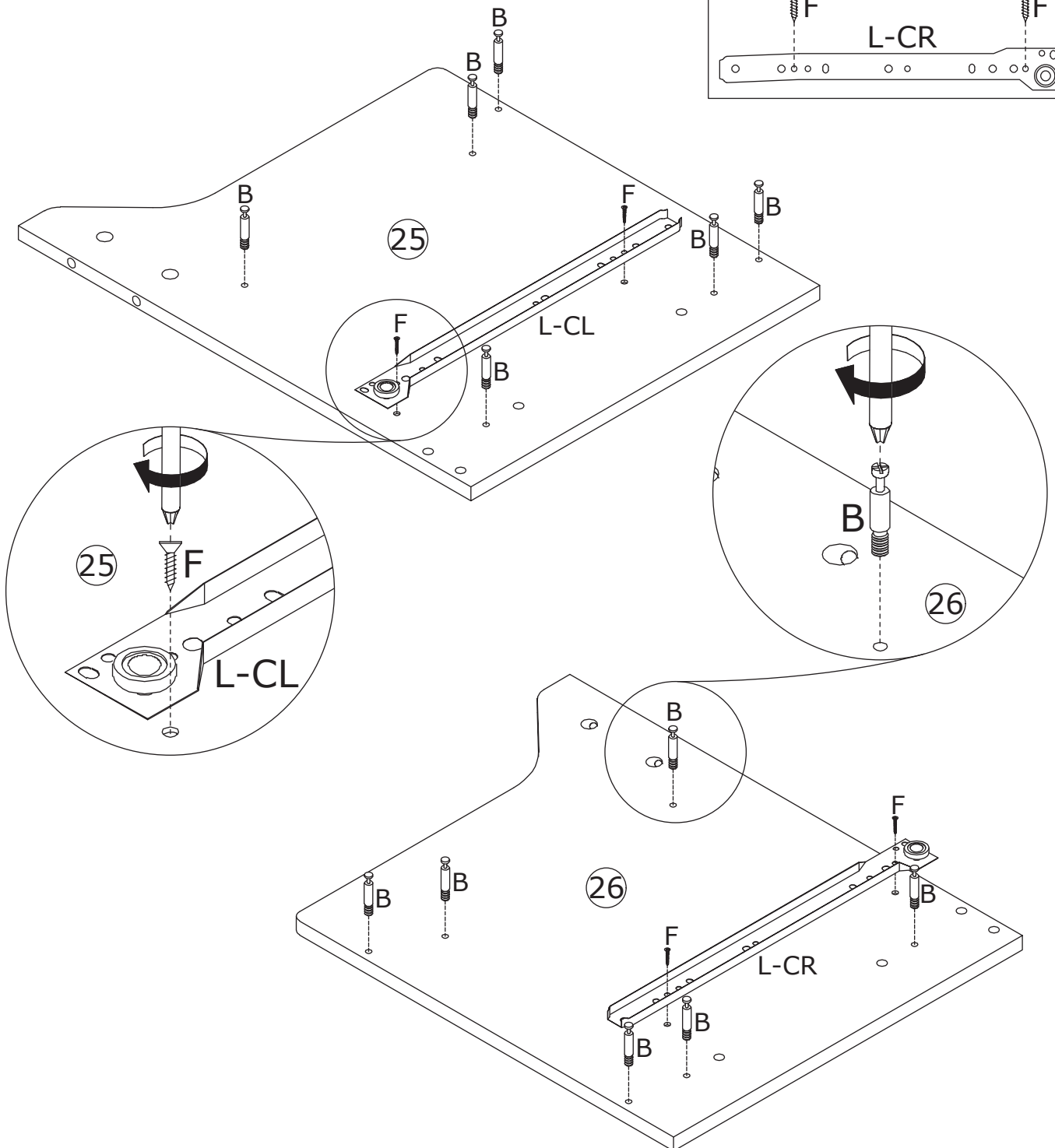
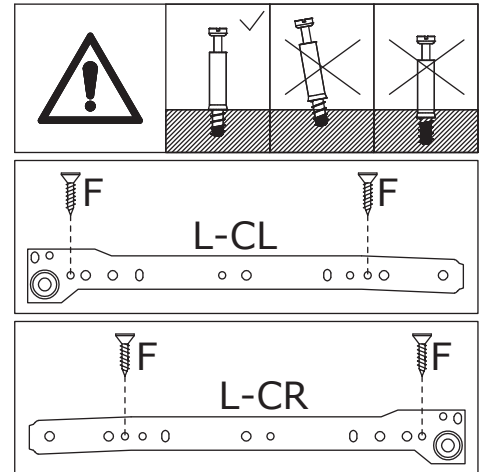

# 15

A x 2  
CRB1295A

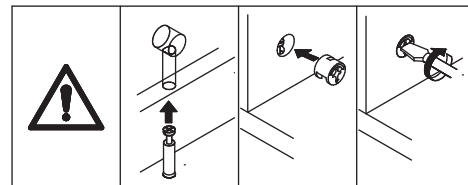
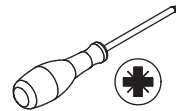

Attach board 28 to board 25,  
add cam lock(A) into and turn  
clockwise to tighten as shown.

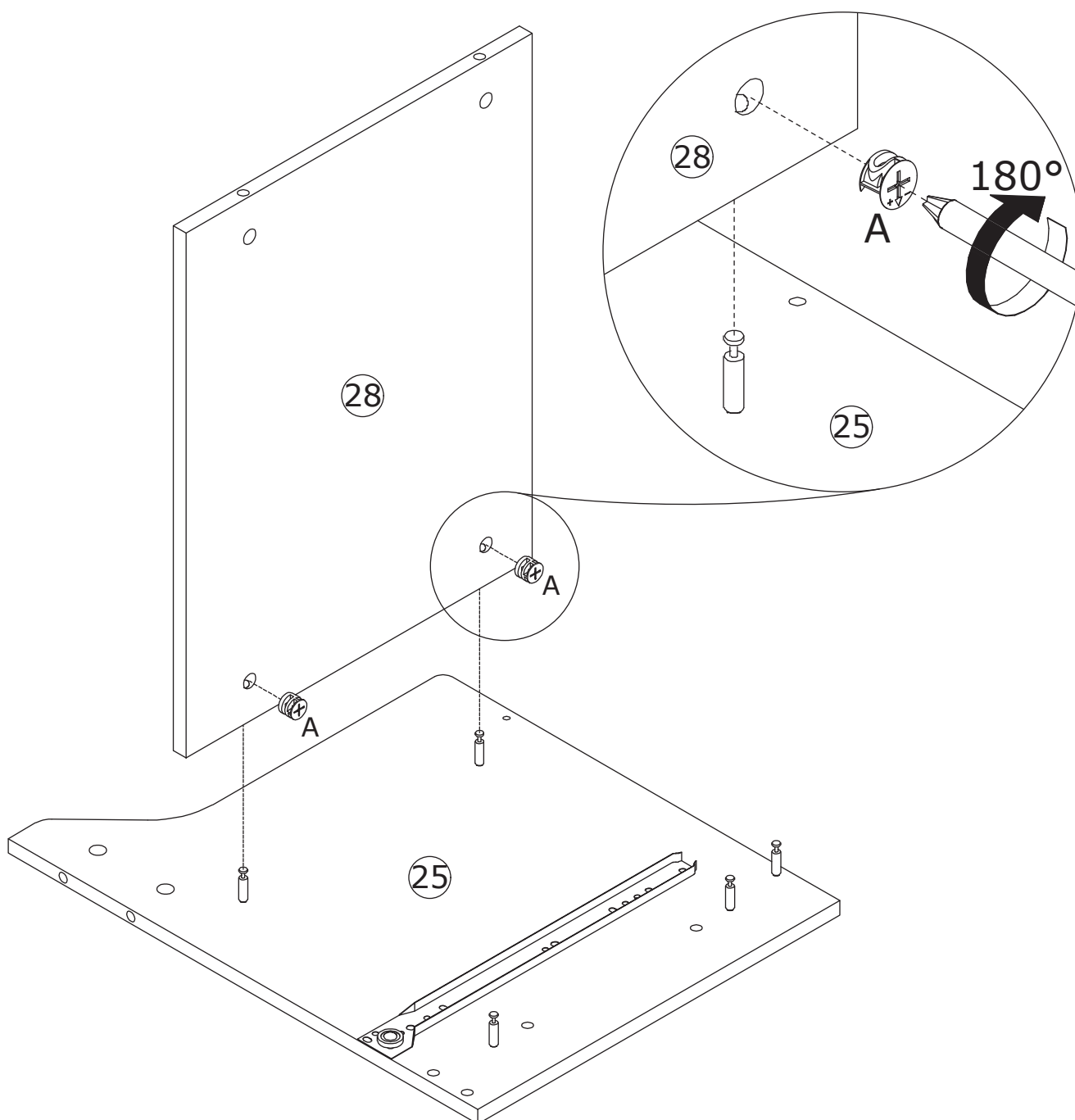

# 16

A x 2  
CRB1295A

E x 4  
CRF0840A

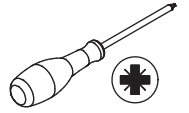

Insert wooden dowel(E) into board 29 and 30 at first.

Attach board 29 and 30 to board 25, add cam lock(A) into board 29 and turn clockwise to tighten as shown.

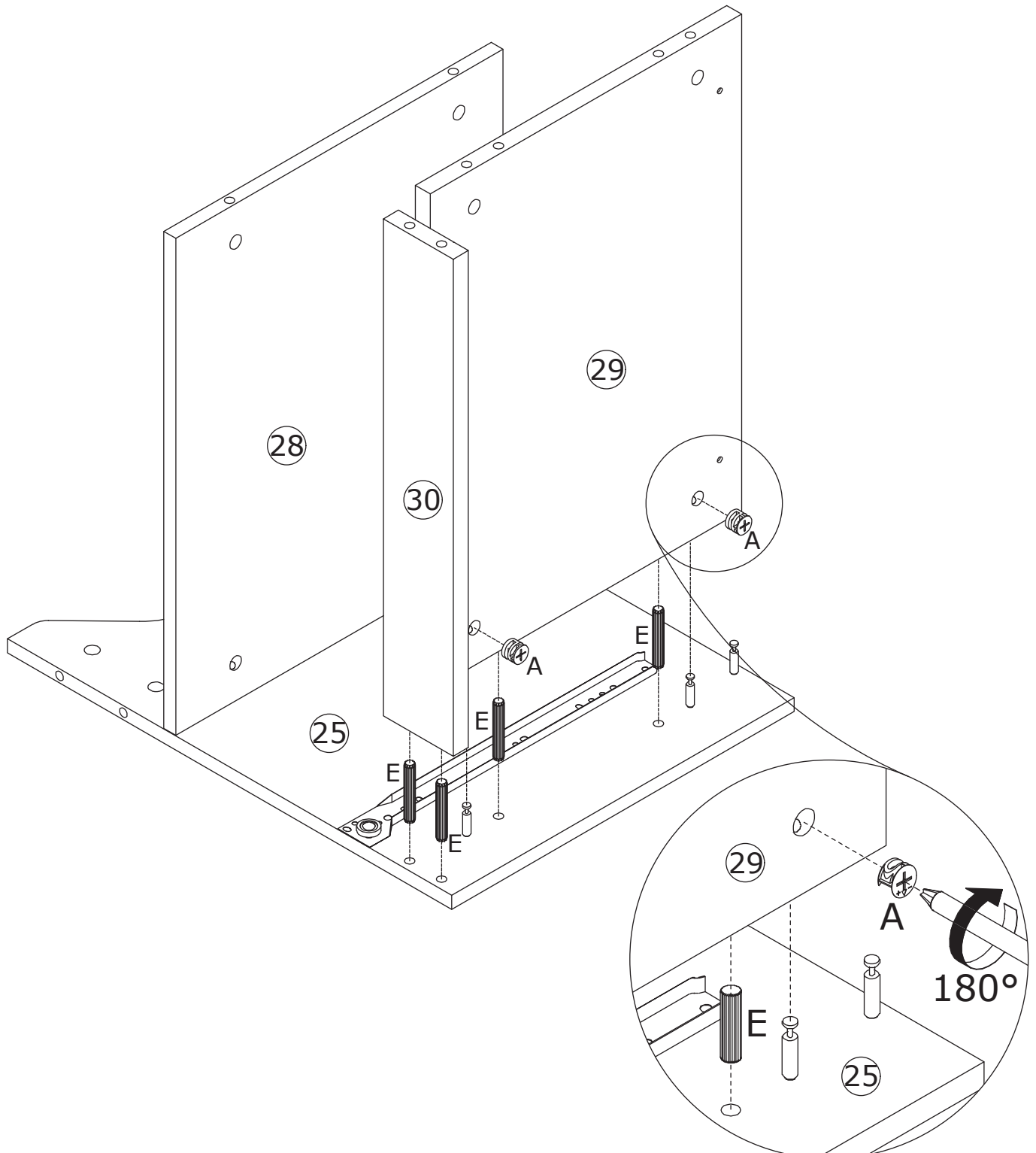
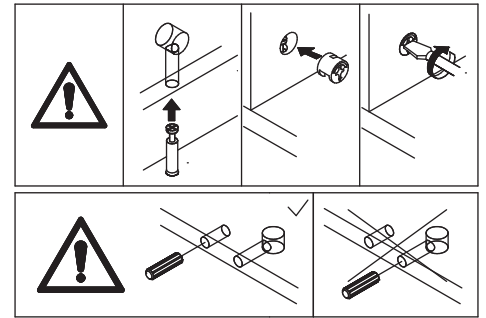

# 17

A x 2  
CRB1295A

B x 2  
CRA0640A

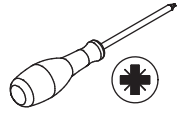

Screw eccentric rod(B) into board 27 as shown. Attach board 27 to board 25, add cam lock(A) into board 27 and turn clockwise to tighten as shown.

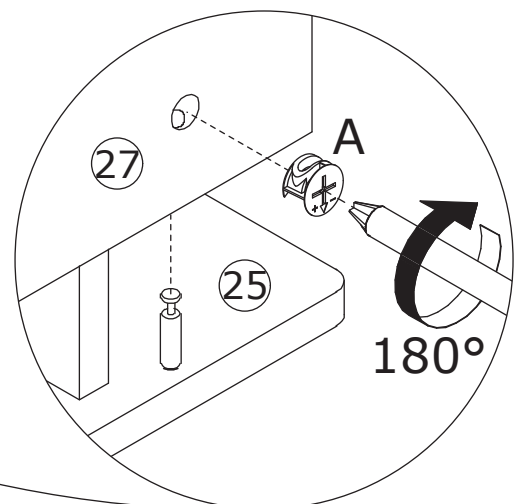
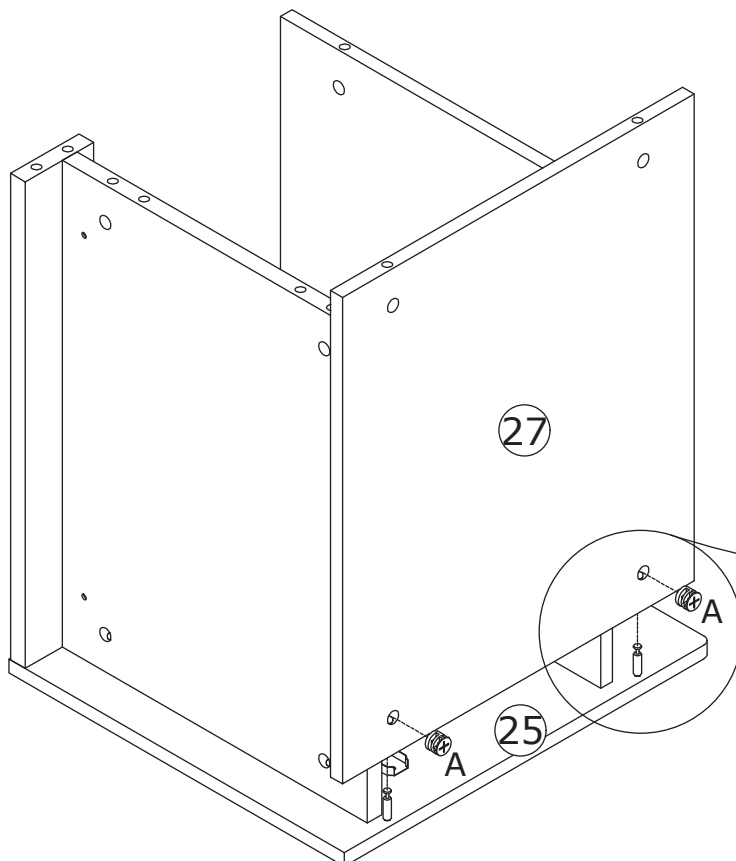
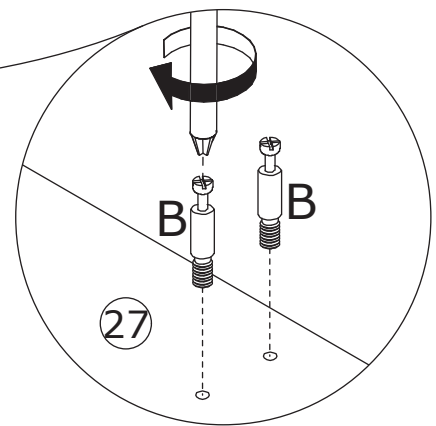
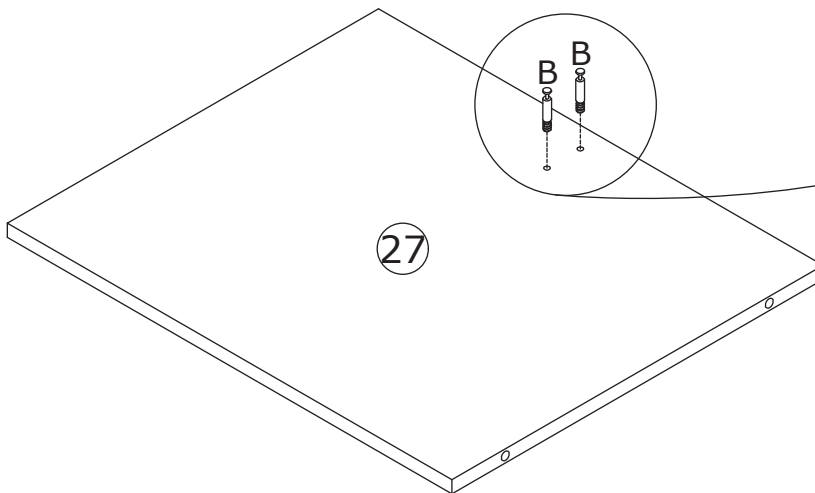
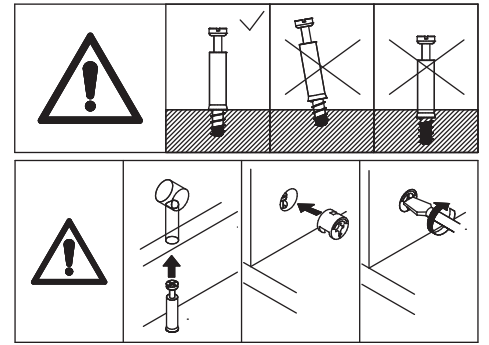

# 18

A x 6



CRB1295A

E x 4

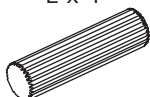

CRF0840A

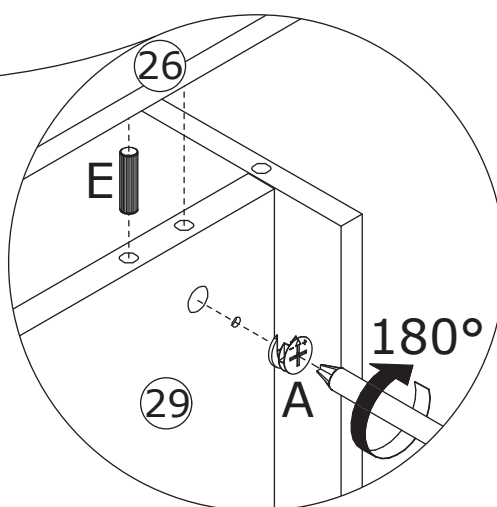
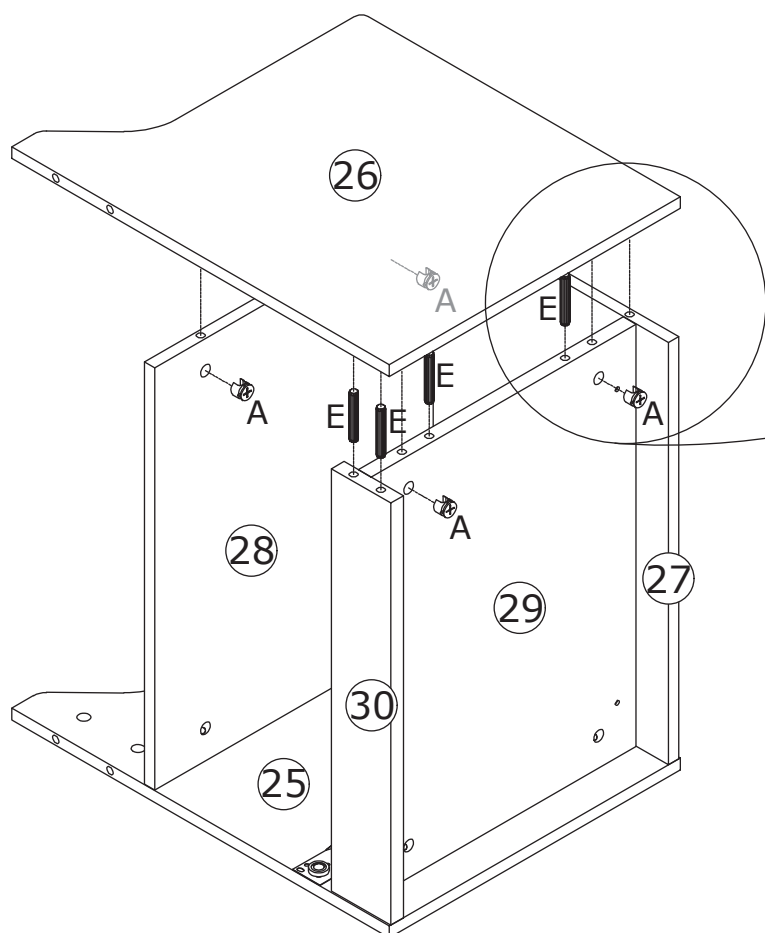
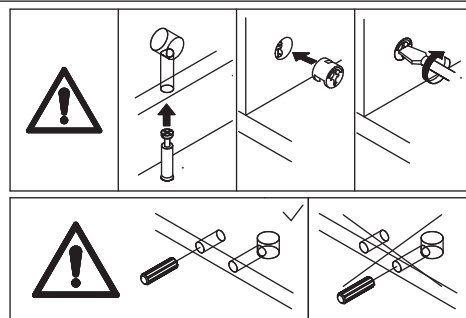
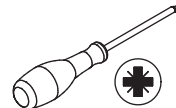

Insert wooden dowel(E) into board 29 and 30 at first. Attach board 26 to the component, add cam lock(A) into and turn clockwise to tighten as shown.

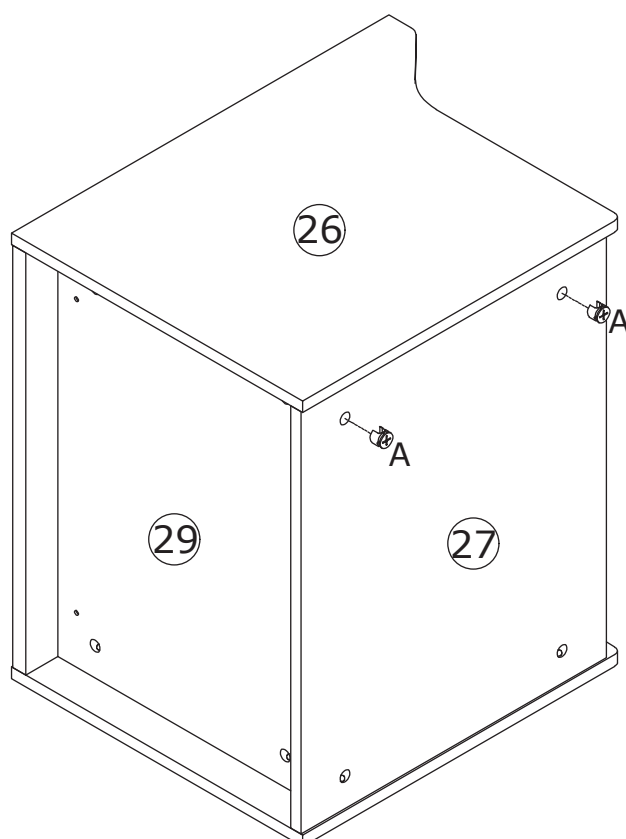

# 19

G x 16  
CRD3512A

S x 4  
H = 48 mm

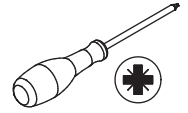

Fix wheel(S) to board 29  
with screw(G) as shown.

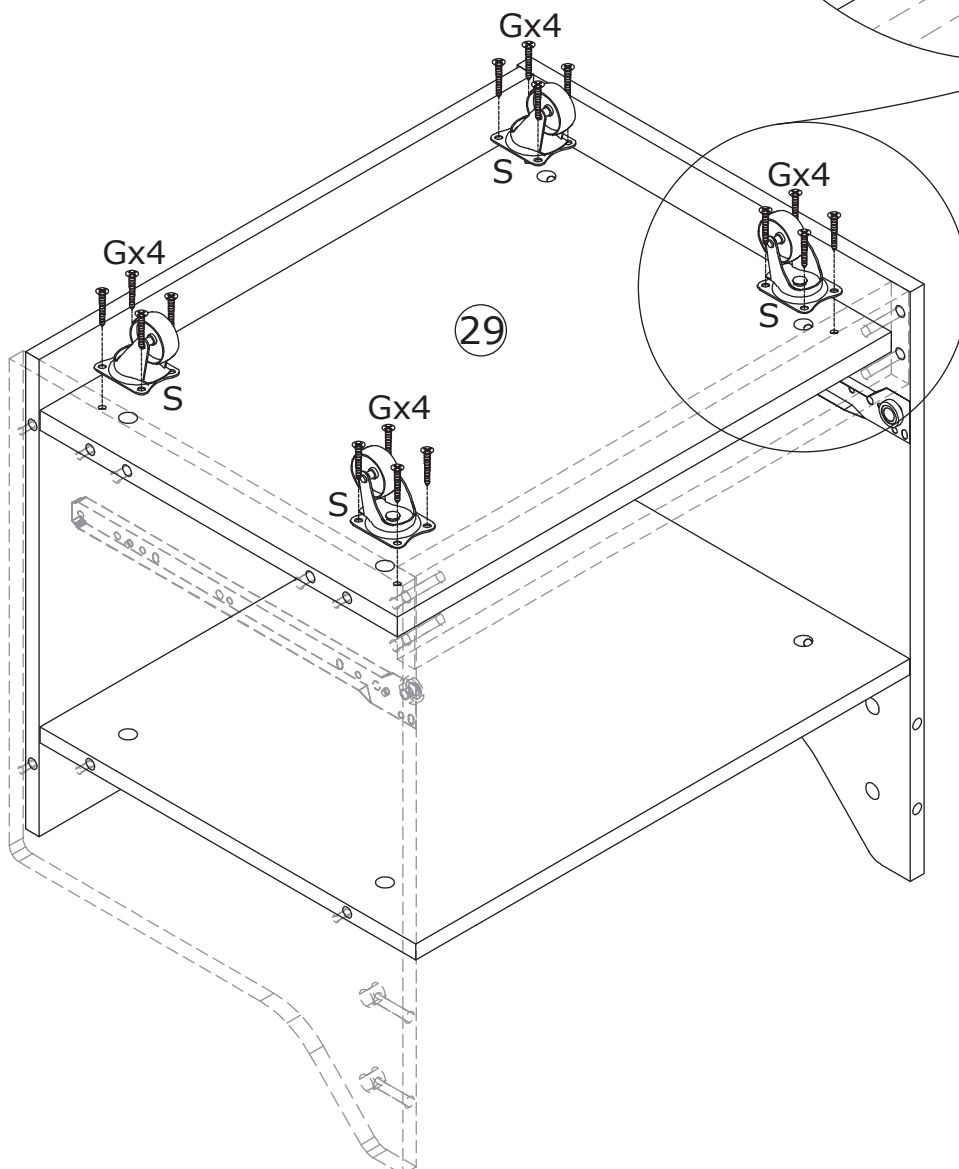
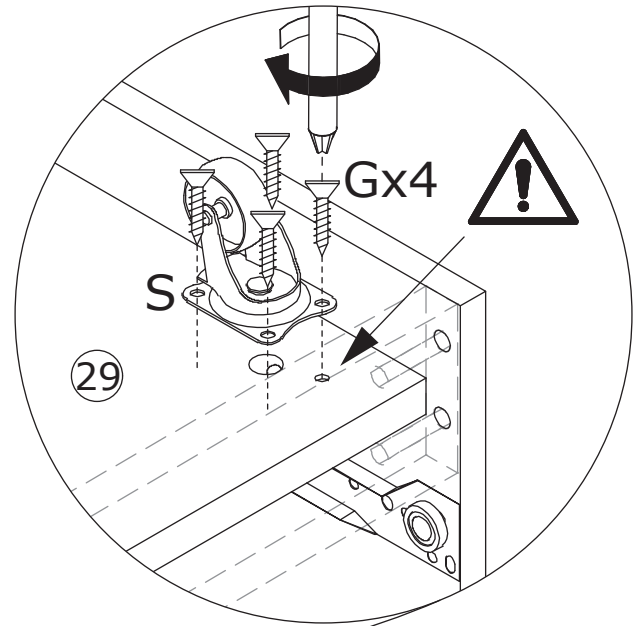

20

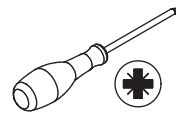
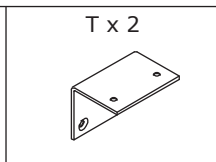
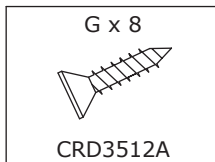

Fix part(T) to board 29, 25 and 26 with screw(G).

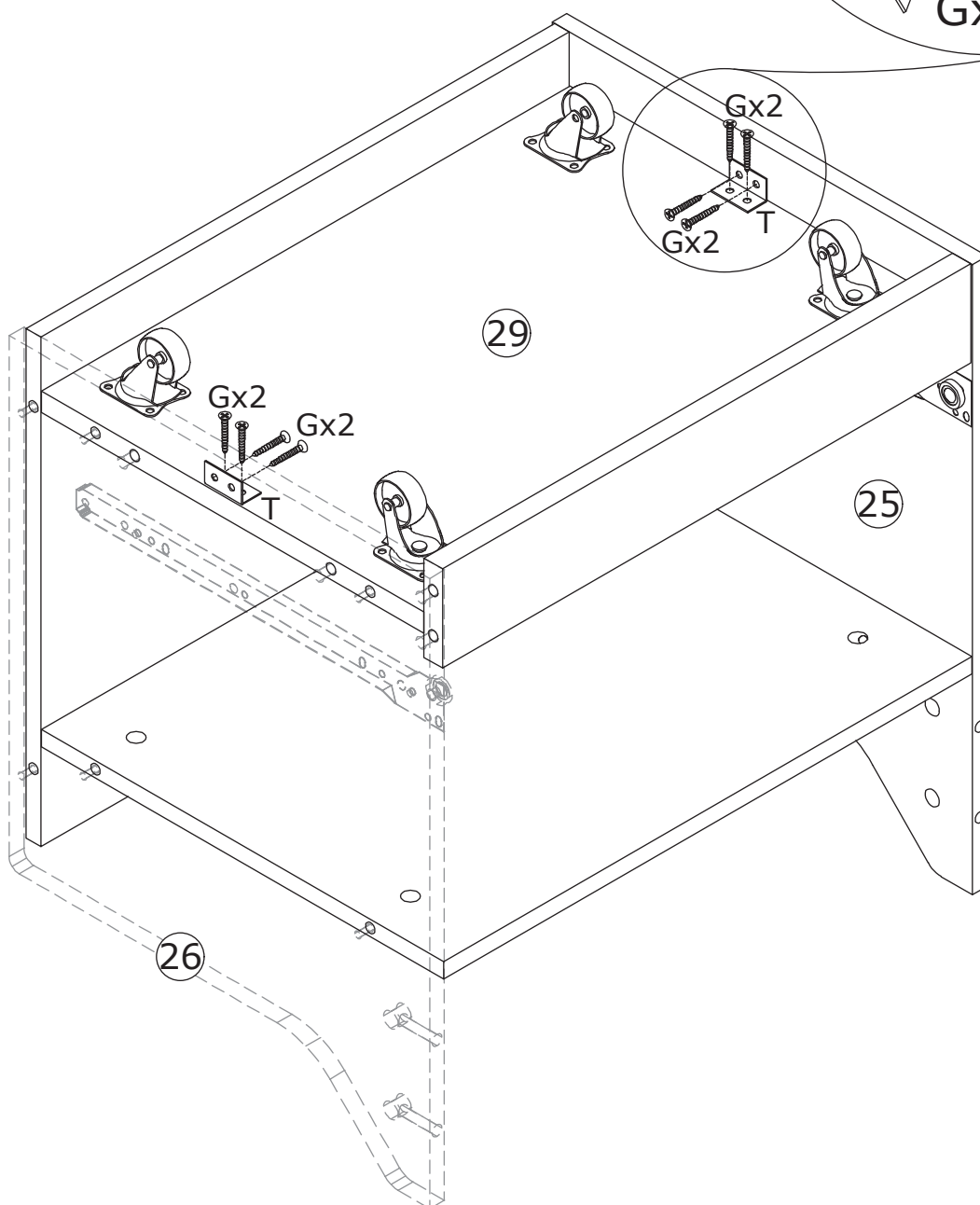
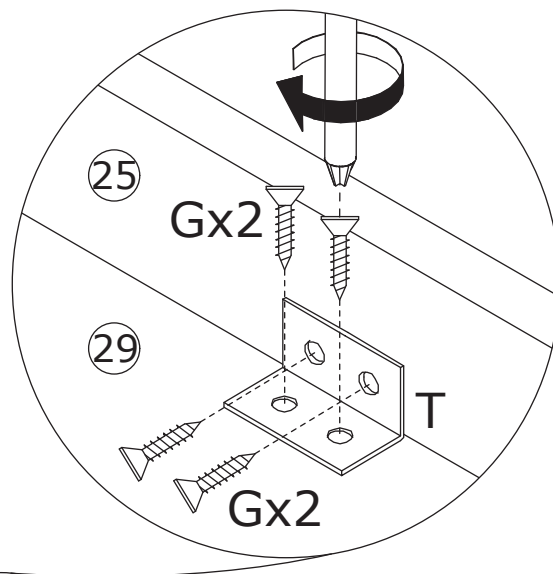

# 21

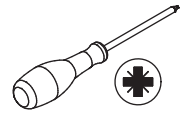
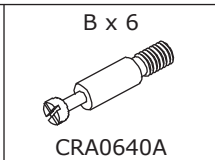
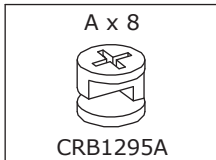

Screw eccentric rod(B)  
into board 15 as shown.

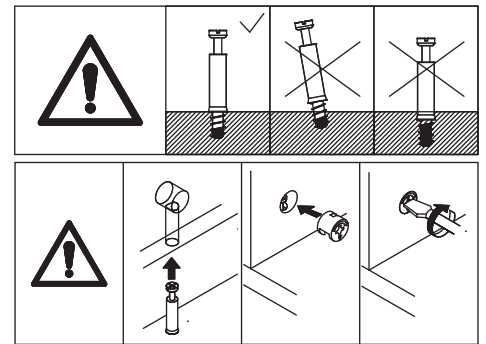
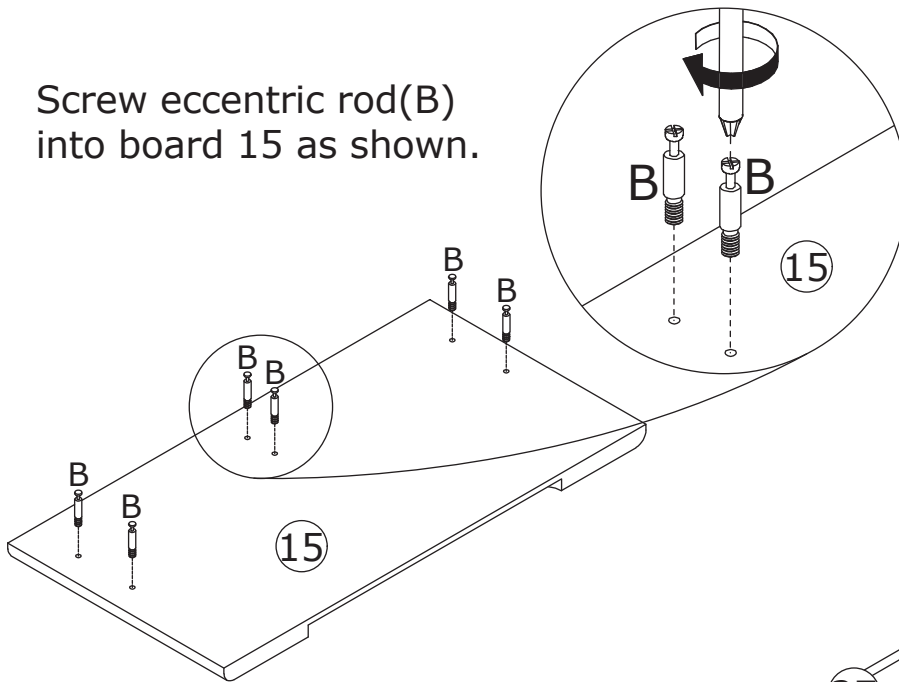

Attach board 32 to board 27, add  
cam lock(A) into and turn clockwise  
to tighten as shown.

Attach board 15 to board 26, 32  
and 25, add cam lock(A) into and  
turn clockwise to tighten as shown.

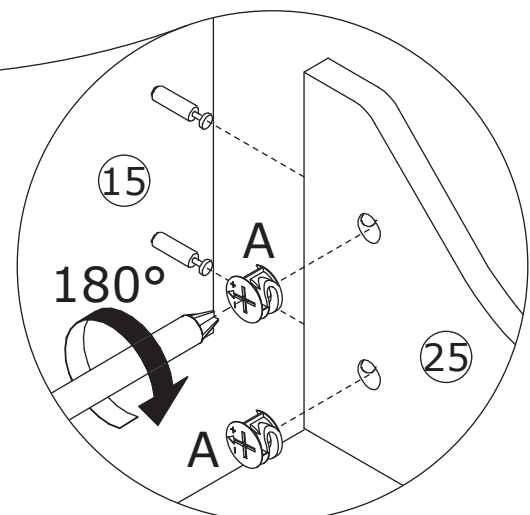
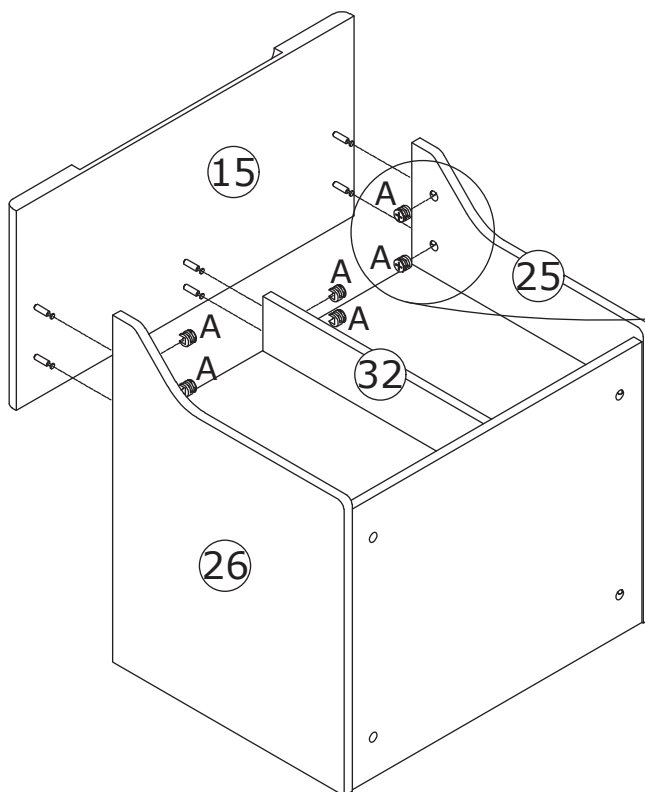
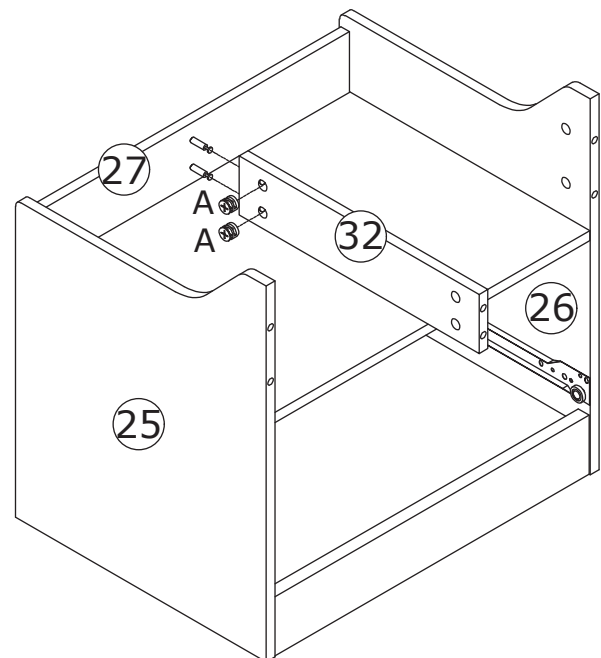



22

H x 4  
CRD3520A

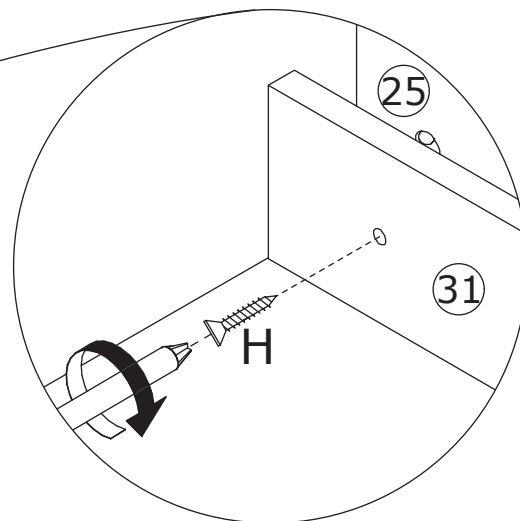
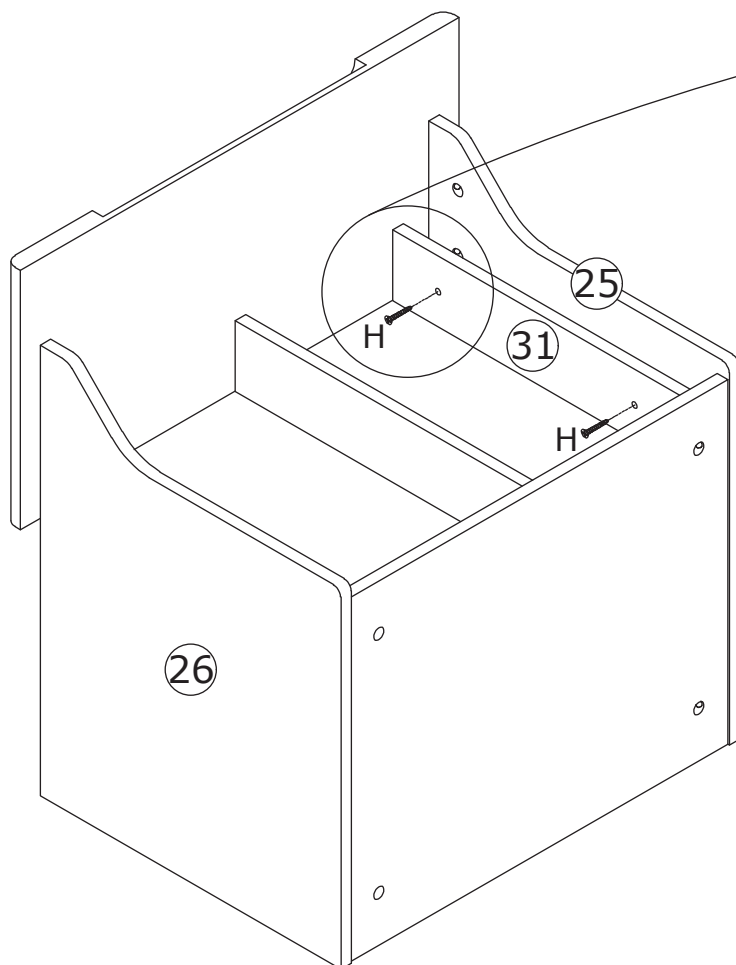
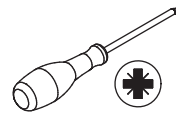

Fix board 31 to board 25 and 26 with screw(H) as shown.

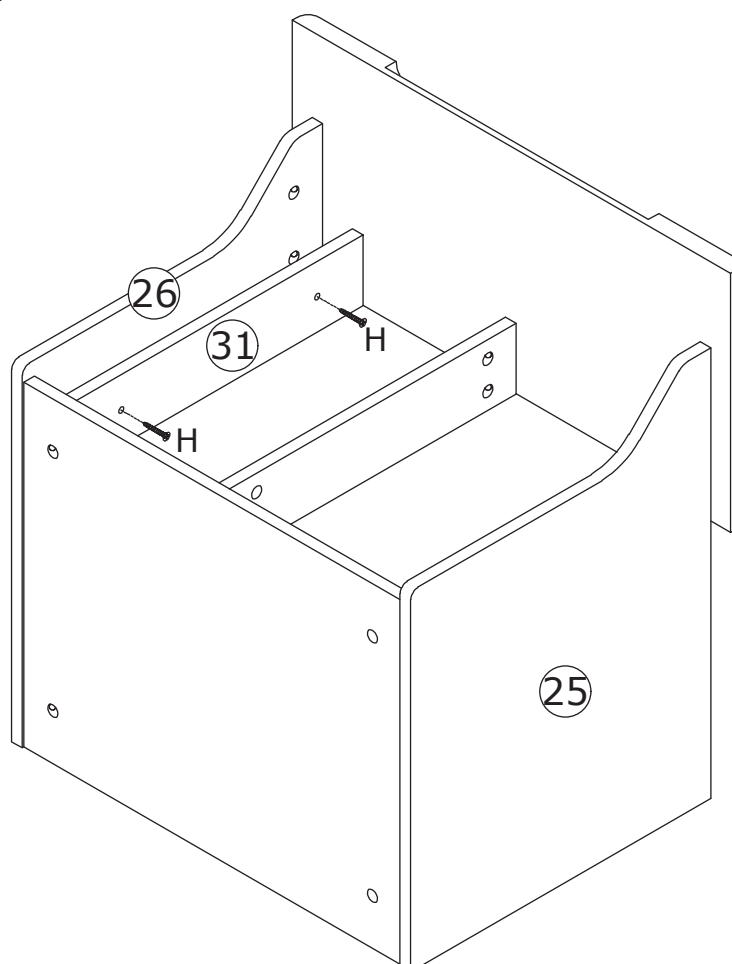

23

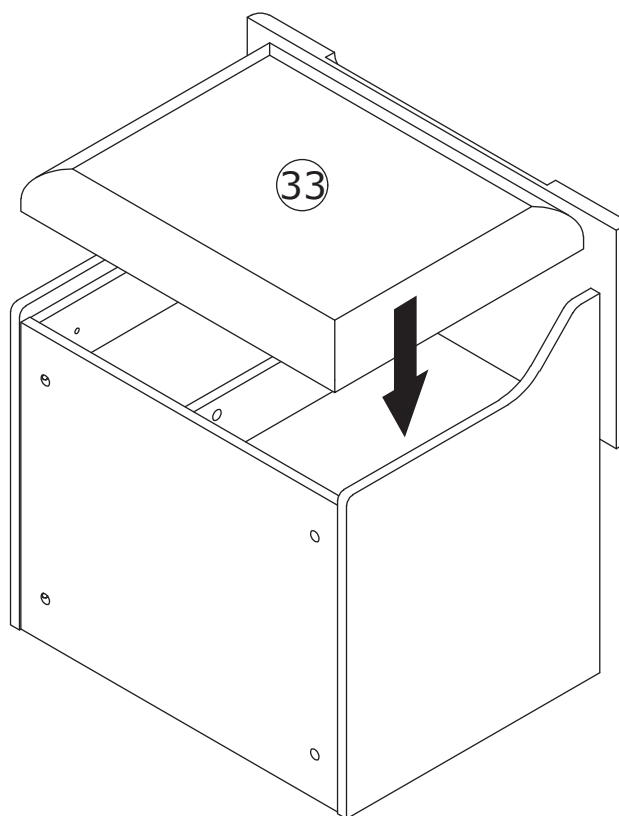

24

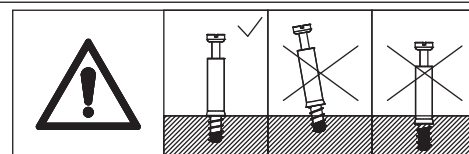
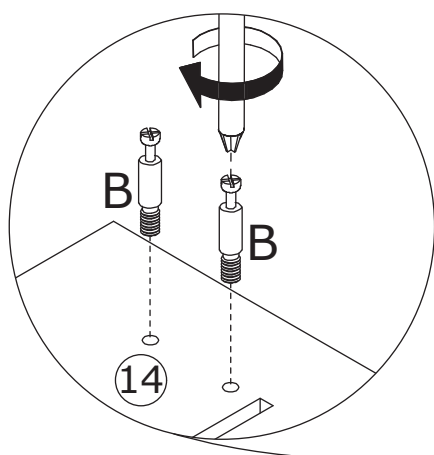
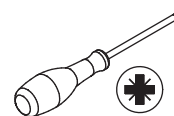

Screw eccentric rod(B) into board 14 and 16 as shown.

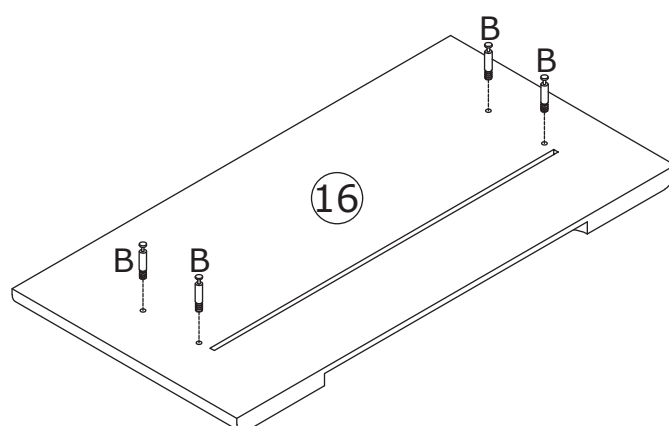
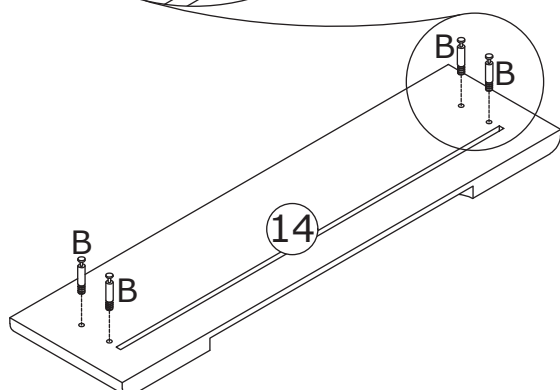

# 25

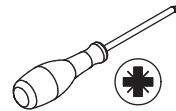
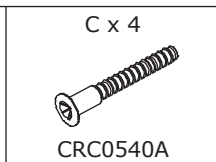
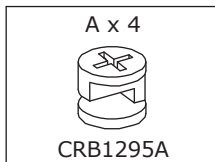

Attach board 14 to board 17 and 18, add cam lock(A) into and turn clockwise to tighten as shown.

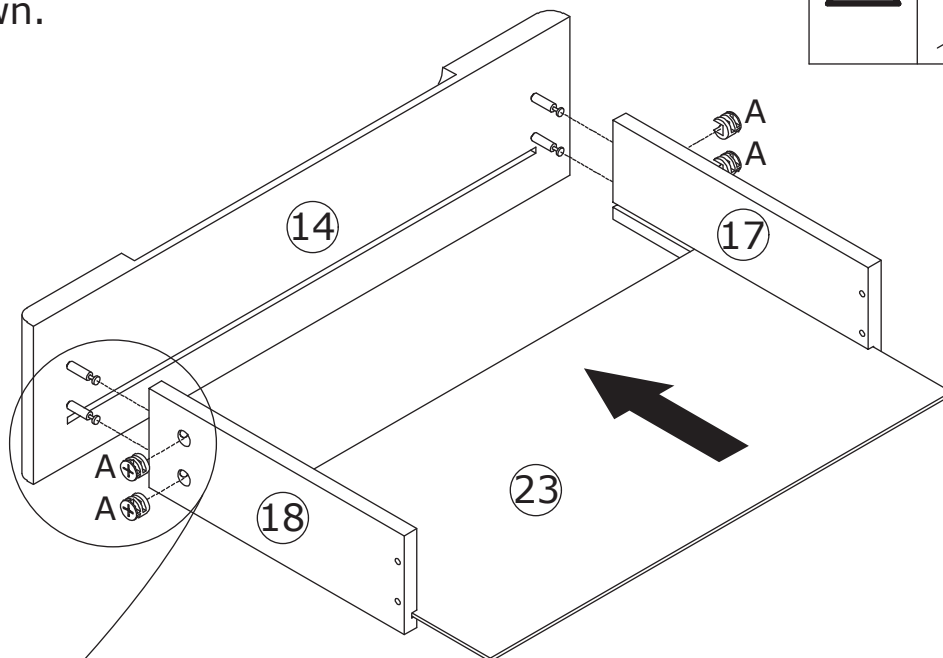
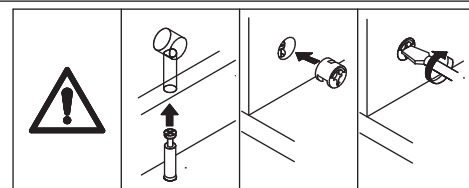

Insert board 23 along grooves as shown. Fix board 21 to board 17 and 18 with screw(C) as shown.

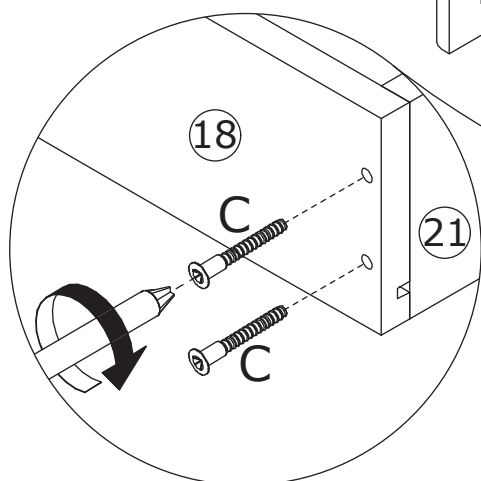
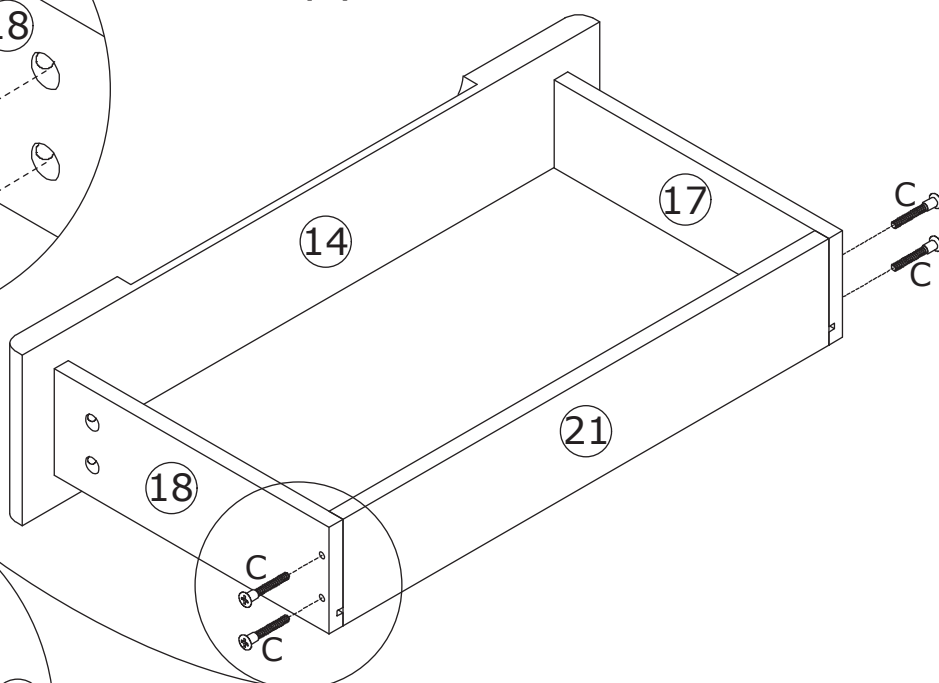
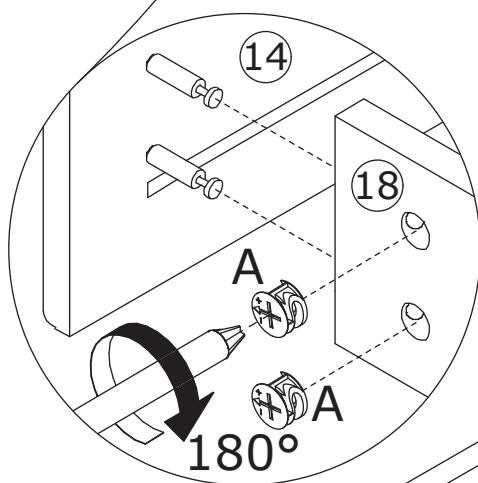

# 26

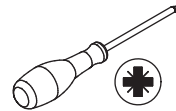
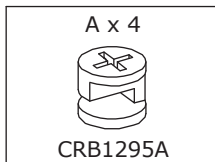

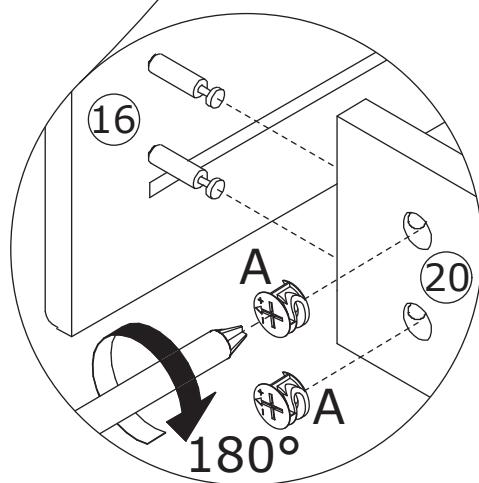
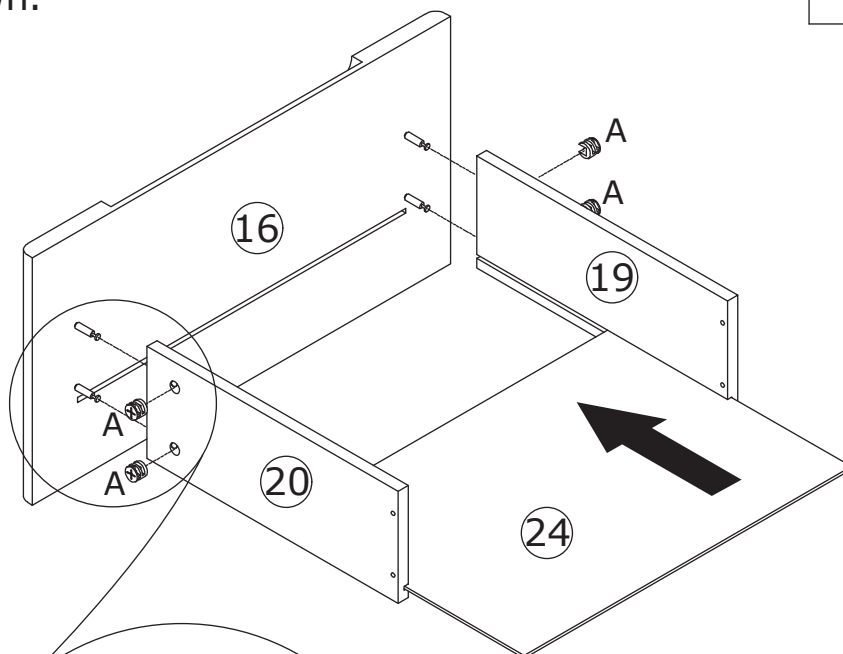
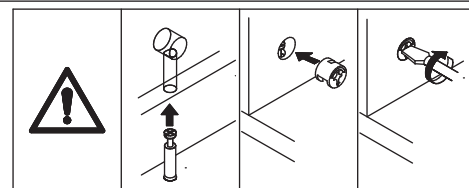

Attach board 16 to board 19 and 20, add cam lock(A) into and turn clockwise to tighten as shown.

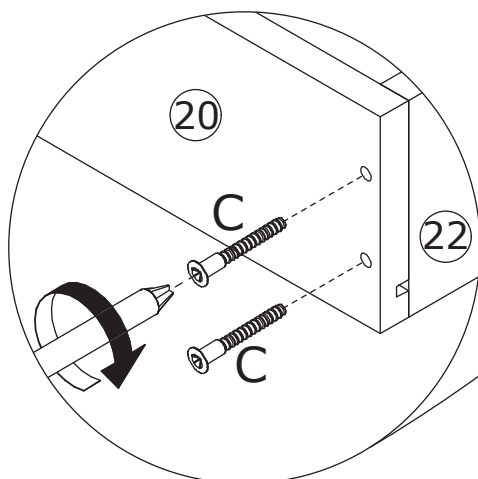
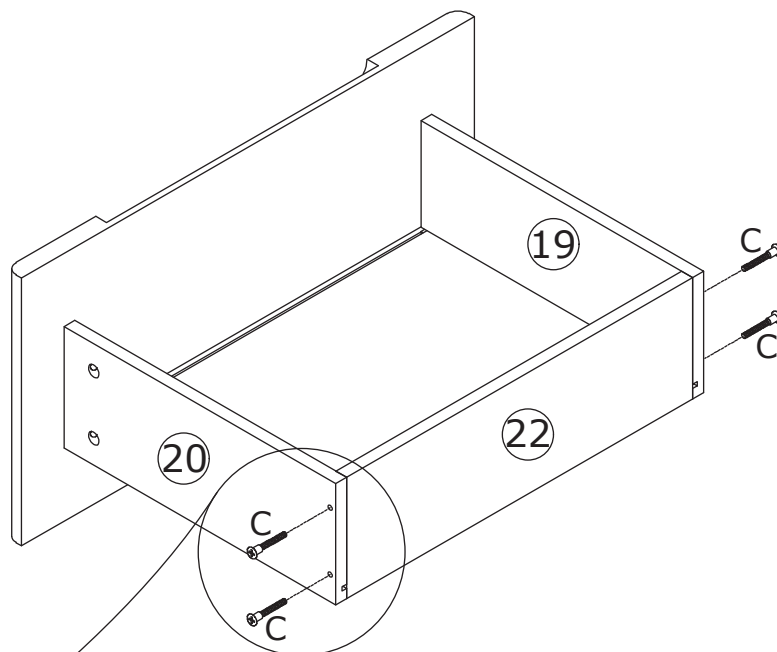

Insert board 24 along grooves as shown. Fix board 22 to board 19 and 20 with screw(C) as shown.

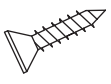
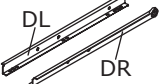

# 27

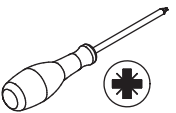
<p>F x 8</p>  <p>CRD0312A</p>	<p>K x 1</p>  <p>DL DR WX0810A</p>	<p>L x 1</p>  <p>DL DR WX0812A</p>	
--	---	---	---

Fix track(K-DL) and (K-DR) to drawer side boards 17 and 18 with screw(F) as shown.

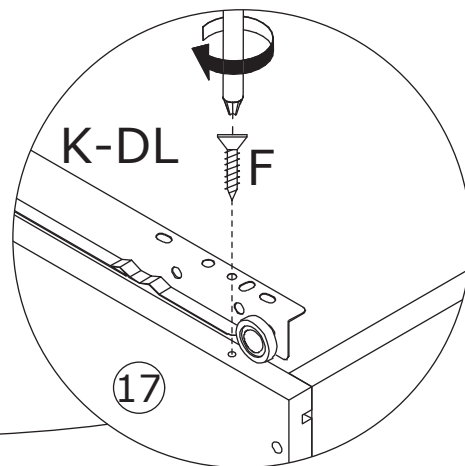
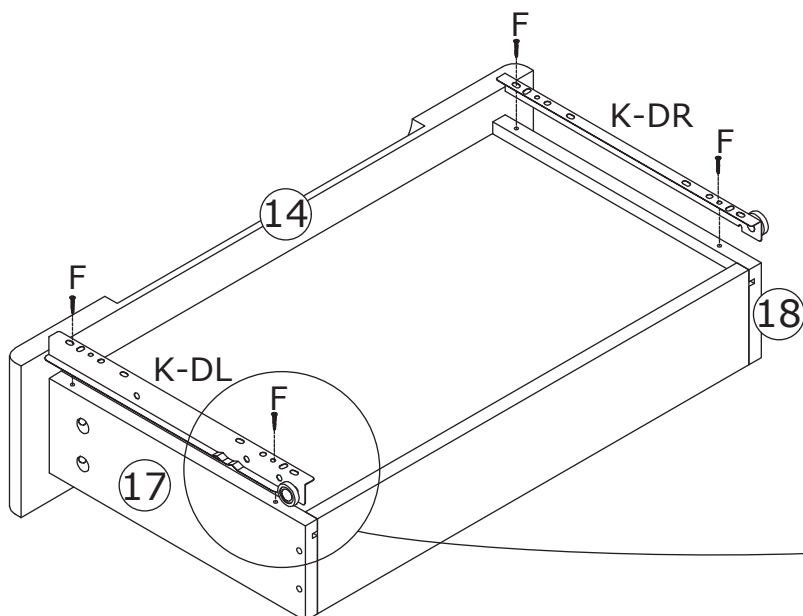
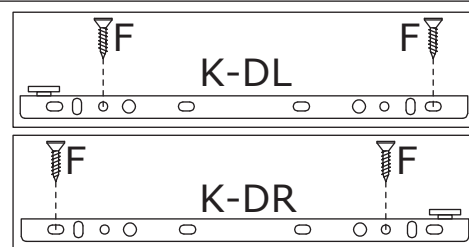

Fix track(L-DL) and (L-DR) to drawer side boards 19 and 20 with screw(F) as shown.

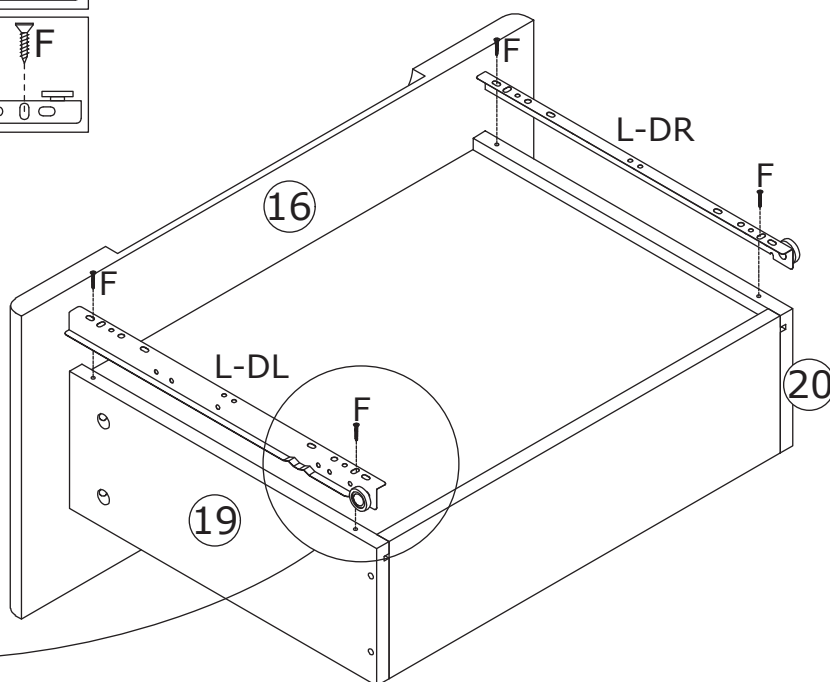
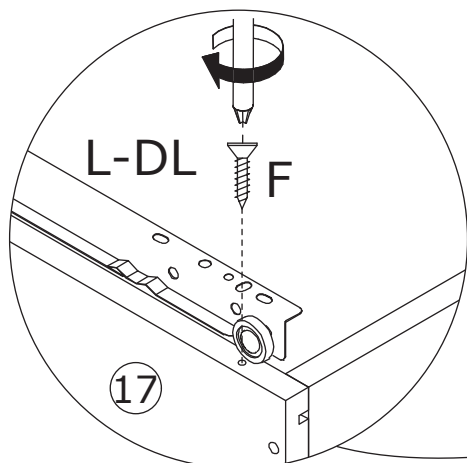
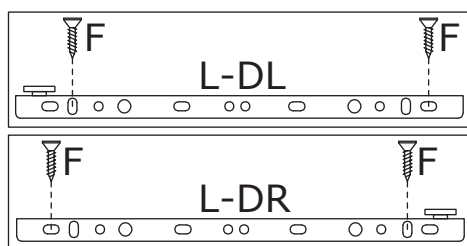

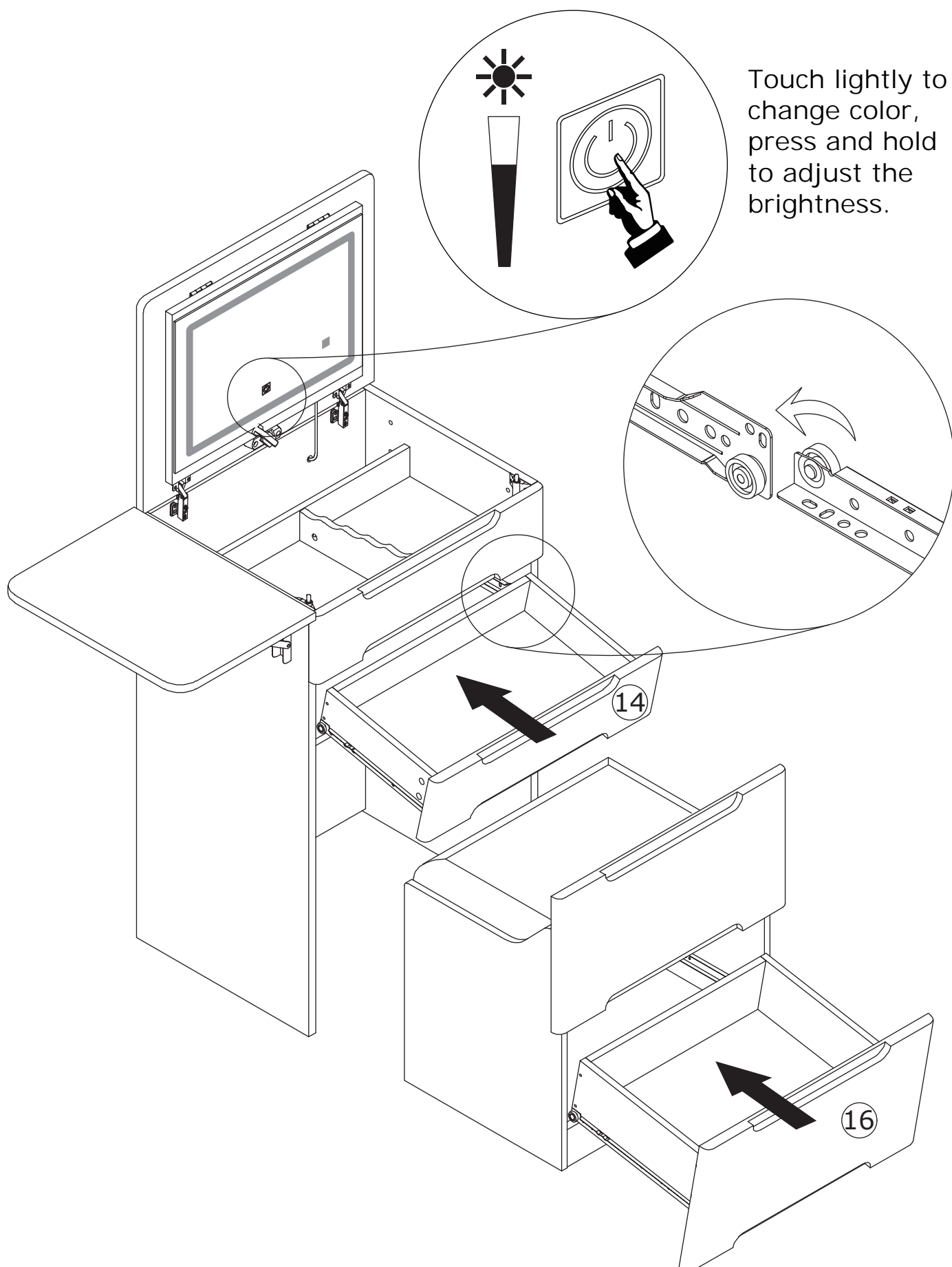

# WARRANTY

## WARRANTY CLAIMS

- There is a 30-day warranty for broken furniture or any other problems that do not work properly. The warranty will start from the date of purchase which must be verified by proof of purchase.
- Before making a claim, we may be able to answer your query, simply call us. Please leave your purchase order number, along with some details of the problem, if you want a replacement part. We will arrange within 48 hours. If there is out of stock, we will reply with a shipping date.
- The product must be used in accordance with the instructions provided. For health reasons.
- For other reasons, if the furniture needs to be returned, it must be cleaned and dried and operated within 30 days of receipt.

## Type of Warranty Claim

- Failure to follow the furniture instructions will invalidate the warranty. Attention please.
- Does not include damage during installation, but includes damage during transportation.

## Scope of responsibility

- Shall not bear any responsibility for misuse or user damage and / or loss of parts during the installation of furniture.
- After using, the damage and scratches of the furniture are not covered by the warranty.

## The Warranty Relates to All Bought in The Us and Covers The Following Areas

- Sheet parts: 1 month from the date of purchase.
- Electrical parts: 1 month from the date of purchase.