



Questions about your new *Super Combo?*

	Wash Times	Approximate Dry Times
Cycles	Mins	Mins
NORMAL	51	90
Prewash + Heavy	75	120
Heavy	61	120
ECO	31	80
Quick 20'	20	80
Delicate	36	80
Wool	36	TUMBLE ONLY NO HEAT
Quiet	31	80
Allergen 131°	59	120
Sanitize 165°	69	120
Winterize	02	NA
PET Cycle	46	90

DIAGNOSTIC MENU		
Code	Description	Component
E1	Door open	Door Switch
E2	Drain failure	Drain Pump
E3	Water inlet failure	Inlet Valves
E4	Water overfill	Inlet Valves
E5	Motor failure	Motor +Electronic Module
E7	Washing heater failure	Washing heater
E8	Dryer Malfunction	Temp. sensor (@rear-bottom of tub)
E9	Dryer Malfunction	Temp. sensor (@front of heater housing)
E10	Water level failure	Water level sensor
E11	Dryer Malfunction	Temp. sensor (near the blow fan motor)
E12	Dryer Malfunction	Fan Motor
E13	Dryer Malfunction	Drying heater
E16	Communication between display & electronic module	Communication Cable

QUESTIONS / SERVICE

Phone/Text : 1-800-776-3538

www.ApplianceDesk.com

QUICK START GUIDE FOR 4800 V

INSTALLATION



Unscrew shipping rods with phillips screw driver. Release red tag to free power cord



Pull out shipping rods (2)

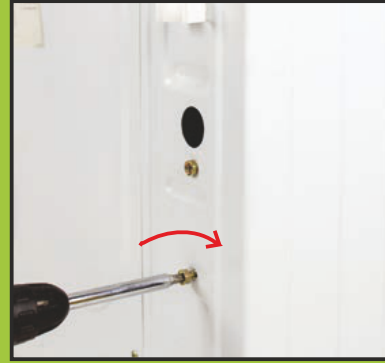

Re-install the 2 screws



Close the empty space with the blanking plug enclosed.

CONNECTIONS

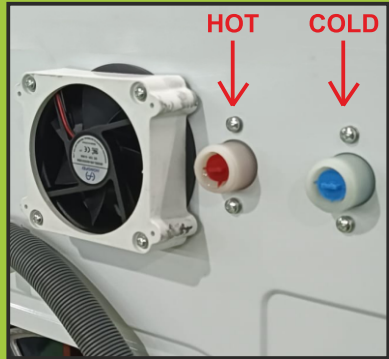

Connect Hot & Cold water hoses (included)



Insert hose into U-connector and insert into standpipe or over sink 24" - 40" high



1. Remove exhaust vent plate
2. Attach 10 cm vent hose to exhaust fan using vent adapter included



Plug power cord into 110V / 60Hz / 15 Amp outlet

LAUNDRY PREP



Load the machine to a maximum 2/3 full



Use liquid fabric softener. Items tumble more freely and dry faster

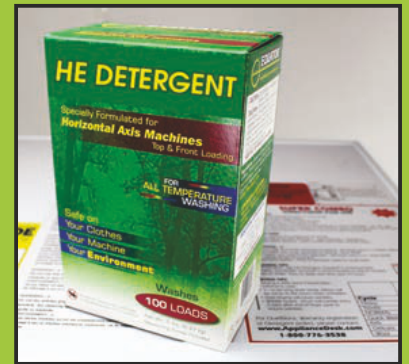

Important:
Use High-Efficiency(HE) Detergent-approx. 1 tablespoon

OPERATIONS



WASH & DRY:

1. Press POWER button
2. Press START

(Default cycle is NORMAL
Turn knob to select cycle)

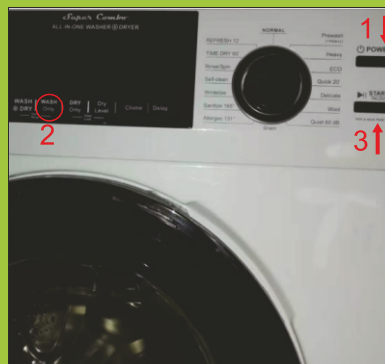

WASH Only:

1. Press POWER button
2. Press WASH Only button
3. Press START

(Default cycle is NORMAL)

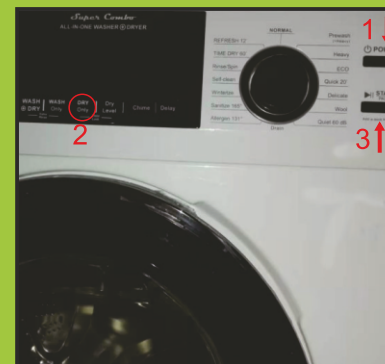

DRY Only:

1. Press POWER button
2. Press DRY Only button
3. Press START

(Default cycle is NORMAL)

MAINTENANCE



1. Open coin trap door
2. Rotate handle anti-clockwise. Clean interior. Fix cover back. Close flap.