

What's in the Box

- 1 x ShoppingAll Desk Lamp (SA-DL1W)
- 1 x Cleaning Cloth
- 1 x Power Adapter
- 1 x User Manual

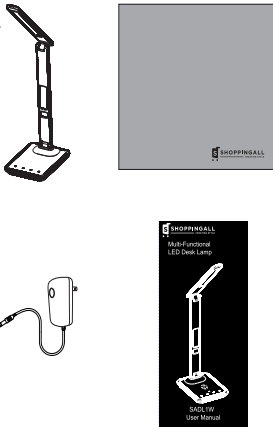

Specifications

| | | | |
|------------------------|---|---------------|--------|
| Model | SA-DL1W | Light Source | LED |
| Voltage | DC 12V/ 2.5A | Power Wattage | 9W |
| Lumens | 400lm | CRI | > 80Ra |
| Lamp Color Temperature | Cold Light: 5500K±500K, Warm Light: 3000K±280K, Natural Light: 4200K±400K | | |

Flexible Angles

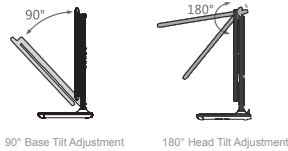

CAUTION

- Do not repair, disassemble, or modify the product under any circumstances.
- Place and operate the product on a flat and secure surface.
- Do not use the product with frayed or damaged electrical cords.
- Keep all the components of the product dry and clean.
- Clean with soft and dry cloth and do not use any solvents or cleaning solutions.
- Avoid extreme heat sources or direct sunlight.
- Use the DC power adapters included in the box only.
- Do not touch electrical parts with wet hands.
- Do not look into the LED light source directly.
- Unplug the adapter when not in use.
- Never overload electrical circuits.

Setting Up

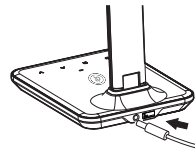

Plug the power adapter into the base of the lamp

⚠ [Notice] The DC Power Adapter is included in the box. Please do not use other adapter for this product.

Operation Guide

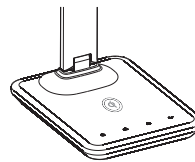

ON/OFF LIGHT MODE UP DOWN

Power Button
Tap on the power ON/OFF button to turn on/off the lamp.

Light Color Temperature Adjustment
Tap on the LIGHT MODE button to adjust the light color temperature in 3-levels Cold White Light, Warm Yellow Light, and Neutral Light.

Brightness Control
Tap on the UP and DOWN button for 5-level brightness adjustments.

USB Port
Use the integrated USB 2.1A port located at the back of the base to charge most USB charging devices.



Multi-Functional LED Desk Lamp

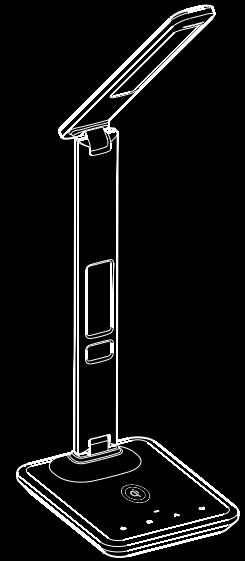

SA-DL1W User Manual

Back Buttons

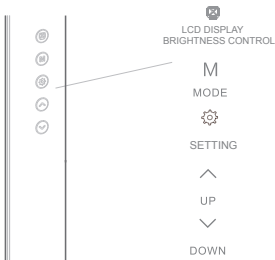

Setting Up Time & Date

1. Press "SETTING" button to activate setting mode.
Hour-Minute-Year-Month-Day.
2. Press "SETTING" button again to toggle next sequence.
3. Press "UP" and "DOWN" key to change time/date in each sequence.
4. In setting mode, press "MODE" button to exit menu. The setting mode automatically turns off after 1 minute of no input.

Setting Up Alarm

1. Press "MODE" button to activate Alarm setting.
Hour- Minute-Snooze-Music-Exit.
2. Press "SETTING" button to toggle next sequence.
3. Press "UP" and "DOWN" key to change time in each sequence.
4. Press "SETTING" button one time after Alarm Music setting to exit Alarm setting menu.
5. The alarm goes off for 1 minute, press any key to stop snooze.

Display Settings

Adjust LCD Display Brightness
• Press "LCD DISPLAY BRIGHTNESS CONTROL" for 3-level brightness adjustment.

Change Between 12H and 24H Time Display
• Press UP button

Change Between Fahrenheit (F) and Celsius (C) Display
• Press DOWN button

WIRELESS CHARGING INSTRUCTIONS

Place your Qi wireless charging compatible device on the charging station on the base of the lamp.

Charging Indicator Light:
Red Light: Charging
Green Light: Complete

*Note that the charging indicator light would not work on some devices.

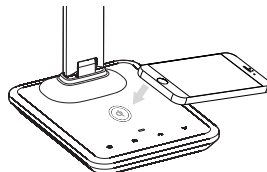

Make sure the lamp is plugged in to a power source, place your phone on the charging station.

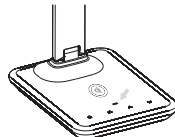

When the device is being charged, a red light lights up.

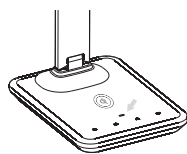

When the device finishes charging, a green light lights up.

BATTERY REPLACEMENT

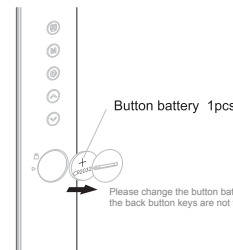

Button battery 1pcs

Please change the button battery CR2032 if the back button keys are not functioning.

DISPLAY SCREEN BRIGHTNESS ADJUSTMENT

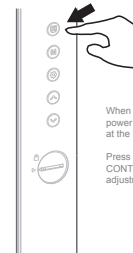

When the lamp is first connected to the power adapter, the LCD Screen will display at the highest brightness as default.

Press the LCD DISPLAY BRIGHTNESS CONTROL button for 3-level brightness adjustment.

Product Functions

Qi Wireless Charger
Power the smart watches and smartphones with Qi certified wireless charging base.

3 Lighting Mode
Choose from 3 color temperature modes (Cold Light, Warm Light, Natural Light)

Dimmable Light Adjustment
Features 5 brightness adjustments, the LED Desk Lamp has no flickering and can be dimmed to suit your ideal office or bedroom lighting environment

Intelligent LCD Display (Calendar, Clock, Thermometer)
The comprehensive intelligent LCD display interface makes for a modern look while always displaying the current time, temperature and date for quick and convenient reference. This lamp eliminates desk clutter with multi-functional practicality.

Alarm Feature
Toggle snooze function that can be set up within a few touches.

Touch Control
Button-free design for easy control over power, lightness and color temperature with the touch-sensitive panel.



Support Information

Email: Support@ShoppingAll.com
Toll-Free: +1(855) 266-9166
(Monday-Friday: 8:00am - 9:00pm Eastern Time)

Thank you for choosing our product. ShoppingAll is dedicated to providing the highest level of quality and service to our customers. If you have any questions or concerns regarding the product, please do not hesitate to contact us. Our friendly and knowledgeable support staffs will respond to your queries promptly.

