

# INSTALLATION & ASSEMBLY

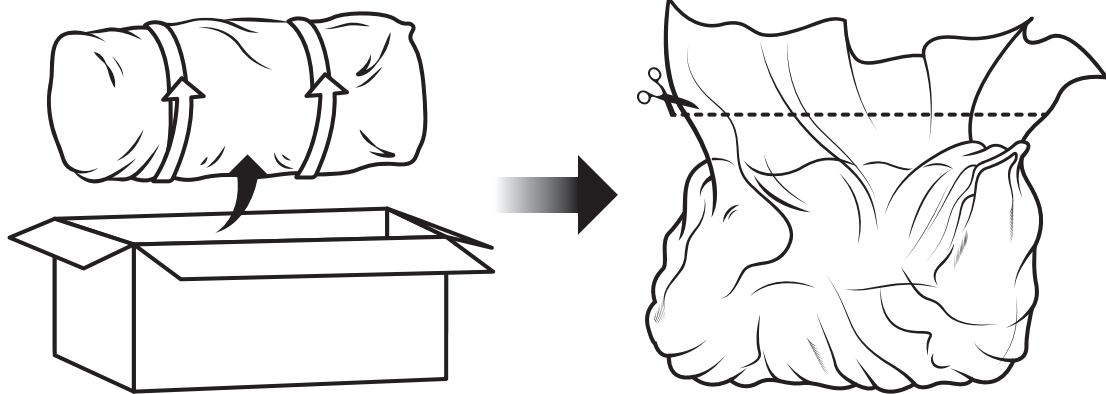

Let it “grow” for 48 hours

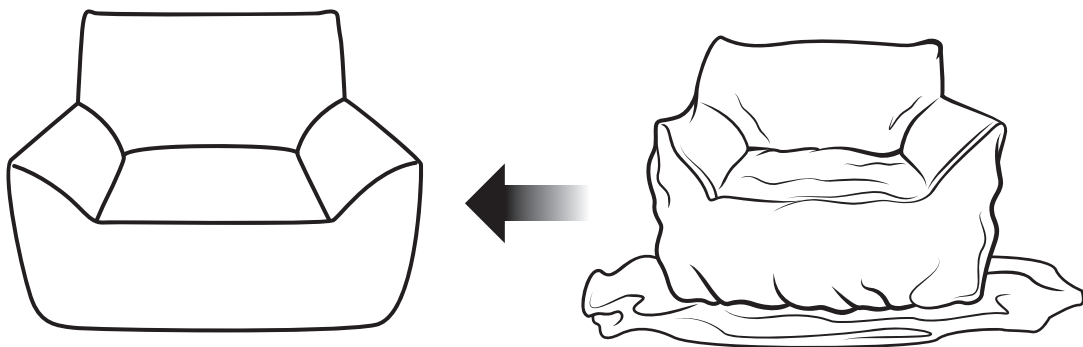

Notes : Please remain still for 48 hours after dismantling without other additional movements. Even better after 72 hours.

After 3 days of standing, you'd better reshape the sofa by tapping and squeezing it. Knock hard to help the sponge expand and distribute nicely inside.



(Knock and Tap)



(Knock and Tap)



(Knock and Tap)

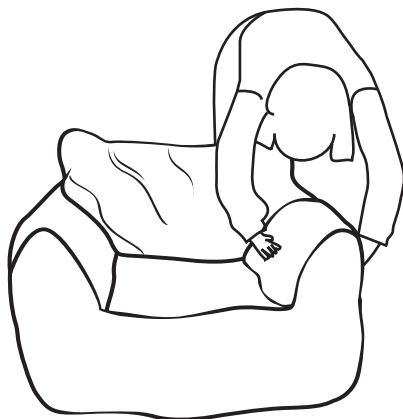

(Knock and Tap)



(Shake)



(Squeeze)

### **IMPORTANT - READ CAREFULLY - RETAIN FOR FUTURE REFERENCE**

#### **WARNING:**

Children must stay away from the assembly zone, preventing children from potential asphyxia because of plastic bag and foam breathing in nose; The product is designed for adults use, domestic use and indoor use only.

#### **WARM TIPS:**

After one month or a longer period of use, you can manually tap to adjust the overall shape for a more comfortable sitting experience.