

# ASSEMBLY INSTRUCTIONS

## CALIFORNIA KING (4+8)

### (Box 1)

#### BOX OF HEADBOARD

No	ITEM	Qty
A	Headboard	1 pc

### (Box 2)

#### BOX OF FOOTBOARD

No	ITEM	Qty
B	Footboard	1 pc
C	Bed Slat	4 pcs
D	Slat Support	8 pcs

### (Box 3)

#### BOX OF SIDE RAIL

No	ITEM	Qty
E	Side Rail	2 pcs

### (Box 1)

#### BOX OF HEADBOARD

No	ITEM	Qty
1	ALLEN KEY m5x65mm Bk	1 pc
2	12V-12W-1A Adaptor With ETL Certificate (US) (INSIDE THE BOX WITH RED LABEL)	1 pc

### (Box 1)

#### BOX OF HEADBOARD

No	ITEM	Qty
3	Pan head Chipboard Screw M3.5 x 16mm	16 pcs
4	L-Bracket	8 pcs

**STEP 1 :** Hook SIDE RAIL (E) TO HEAD BOARD (A) closely and push down to fit. repeat step 2 with other end of rail to hook onto FOOTBOARD (B).

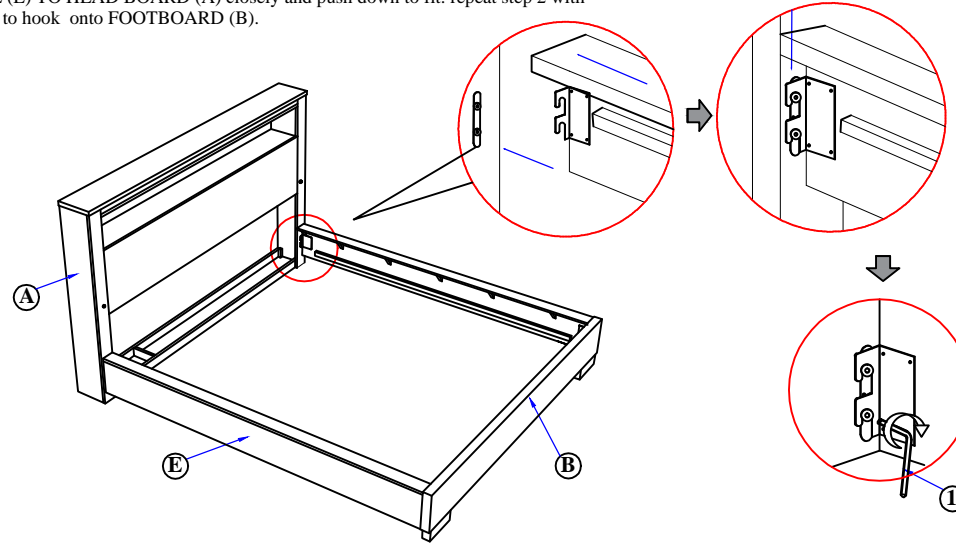

**STEP 2 :** Tighten the 4 Corner with Allen Key (1). Fix the Bed Slat Support Leg (D), to Bed Slat (C) as shown. Tighten the bed slat (C) with L Bracket (4) and tighten with PAN HEAD Screw (3) as shown, loosen and tighten the adjuster for stability of bed.  
(NOTE: THE SETUP MUST BE DONE AT THE DECIDED LOCATION FOR THE BED TO OBTAIN PERFECT STABILITY)

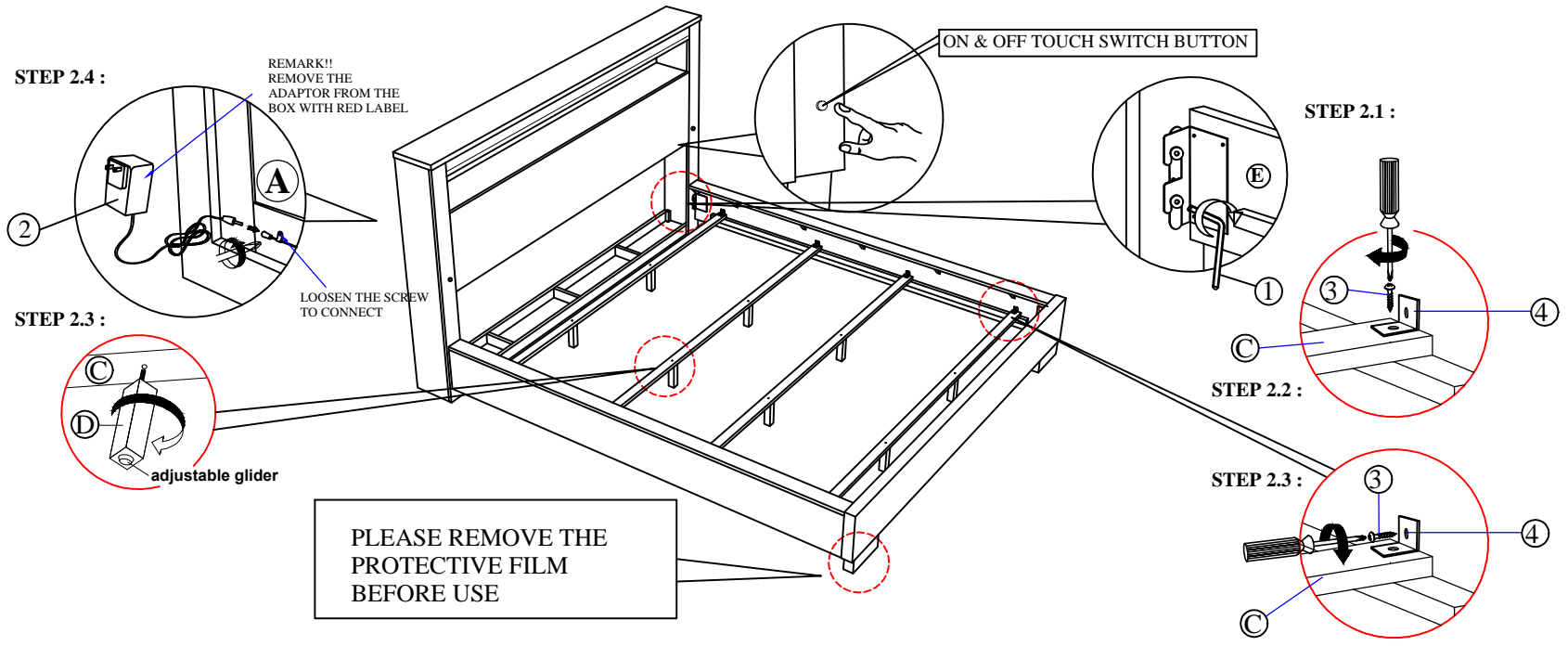

NOTE : MUST TIGHTEN SCREWS PERIODICALLY OR USE SCREW WILL BECOME LOOSE. CHECK TIGHTNESS OF ALL SCREW EVERY 6-8 WEEKS.