

Bookcase

bibliothèque

---

estantería

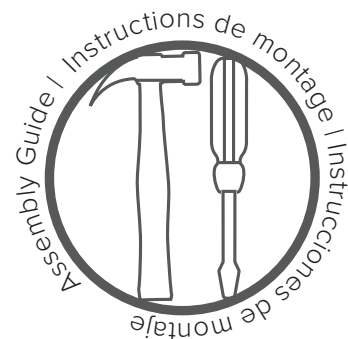
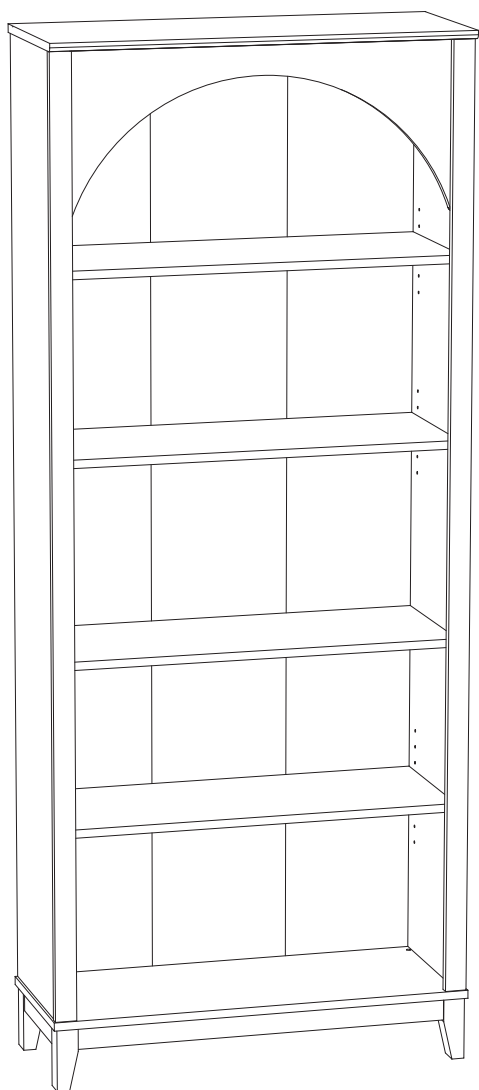

---

## Tools

Vous aurez besoin / Necesitarás

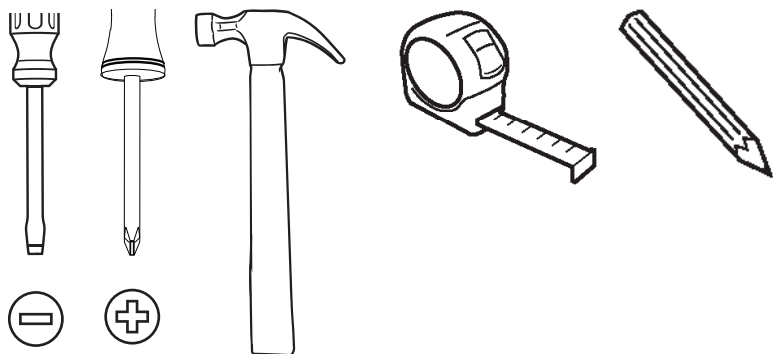

---

## 2 person recommended

2 personnes recommandées /

2 personas recomendadas

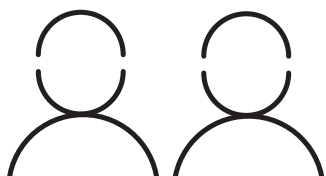

# Parts

Pièces

Piezas

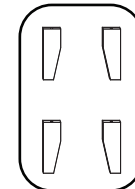
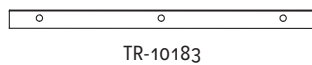
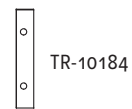
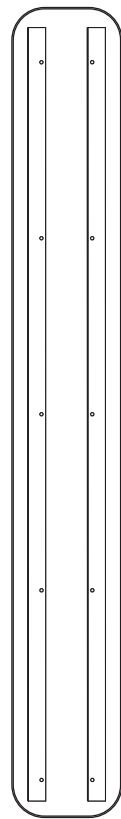
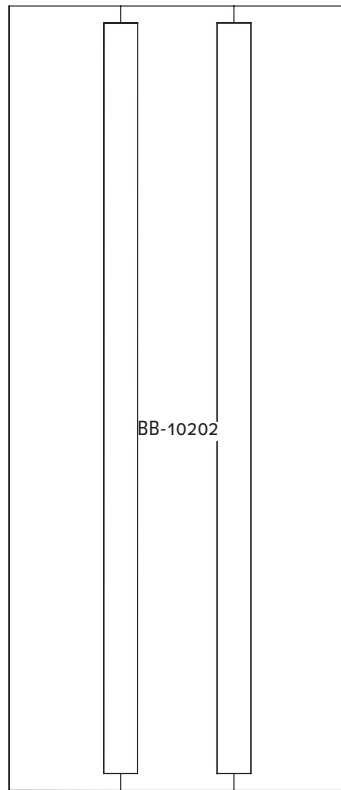
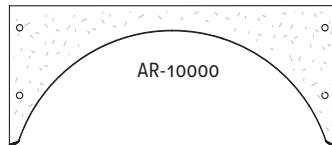
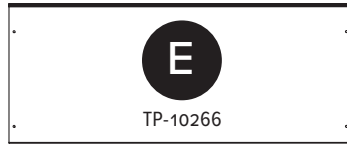

TR-10182 x2

RM-8012 x4

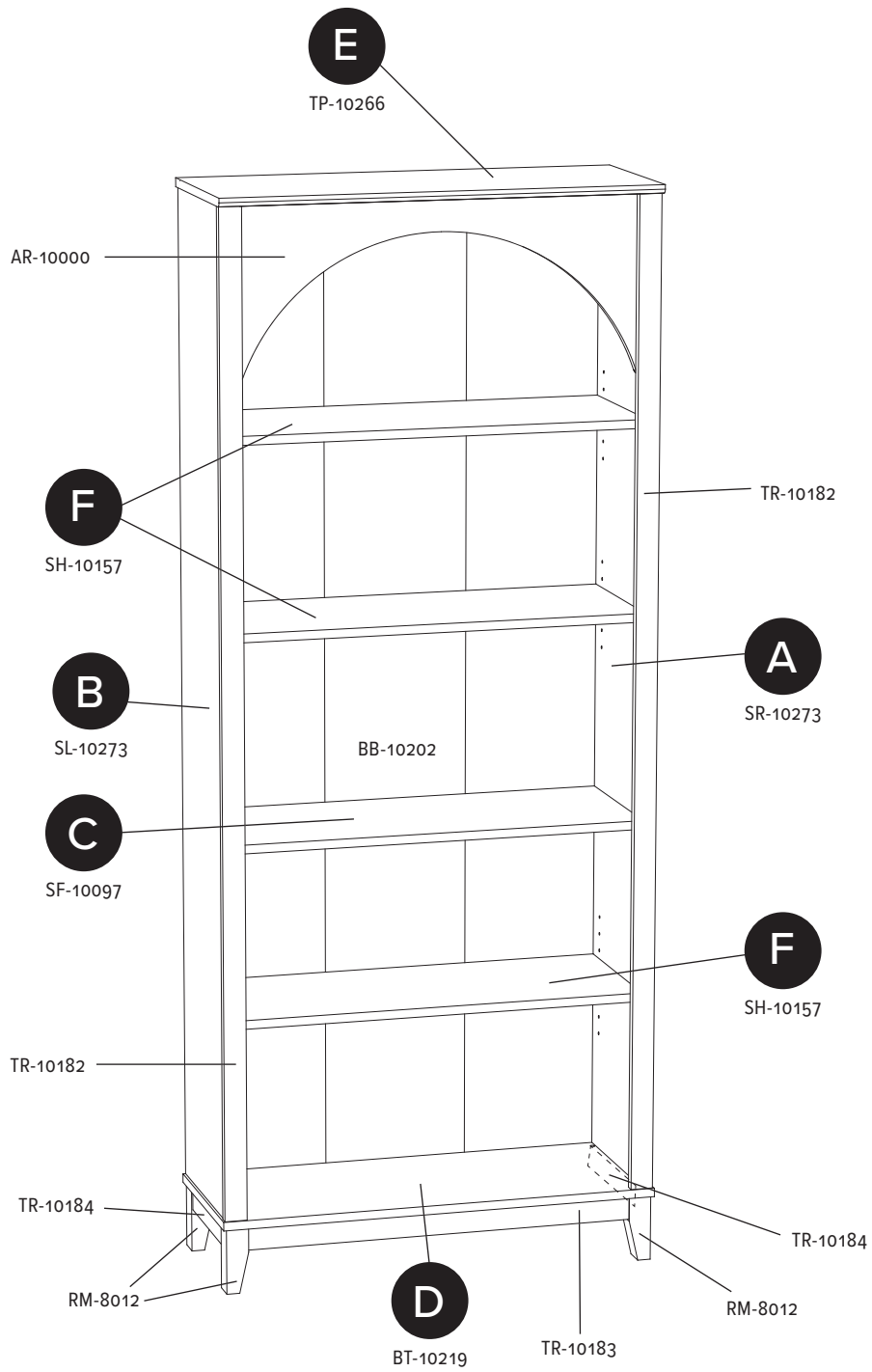

# Hardware

Quincaillerie

Piezas de Conexión

**25 X**



RM-0103

**42 X**



RM-0022

**8 X**



RM-0001

**12 X**

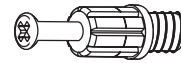

RM-0501  
GREEN

**12 X**



RM-0010-COLOR

**8 X**



RM-0069

**13 X**

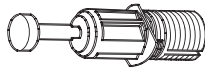

RM-0583  
BLUE

**4 X**



RM-0008-COLOR

**6 X**



RM-0802 COLOR

# Hardware

## Quincaillerie

## Piezas de Conexión

**1X**

### Tipover Restraint Kit

Kit anti-basculement

Kit de sujeción contra  
volcaduras

HP-1088

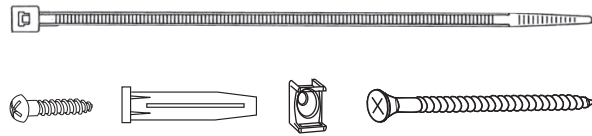

# Assemble in 16 steps

Assemblage en 16 étapes

Montar en 16 pasos

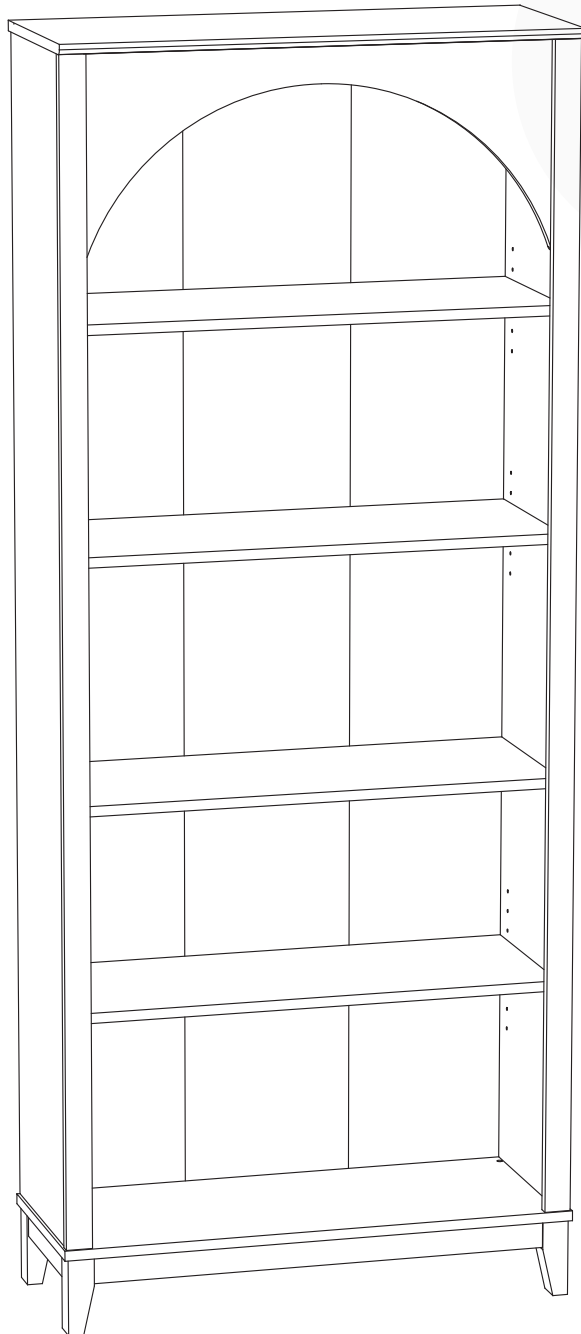

**Let's  
start!**

Commençons!

¡Comencemos!

# 1

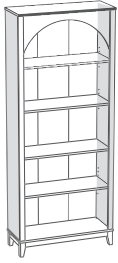

RM-0103



**10X**

RM-0501  
GREEN

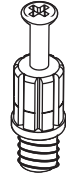

**8X**

RM-0069



**4X**

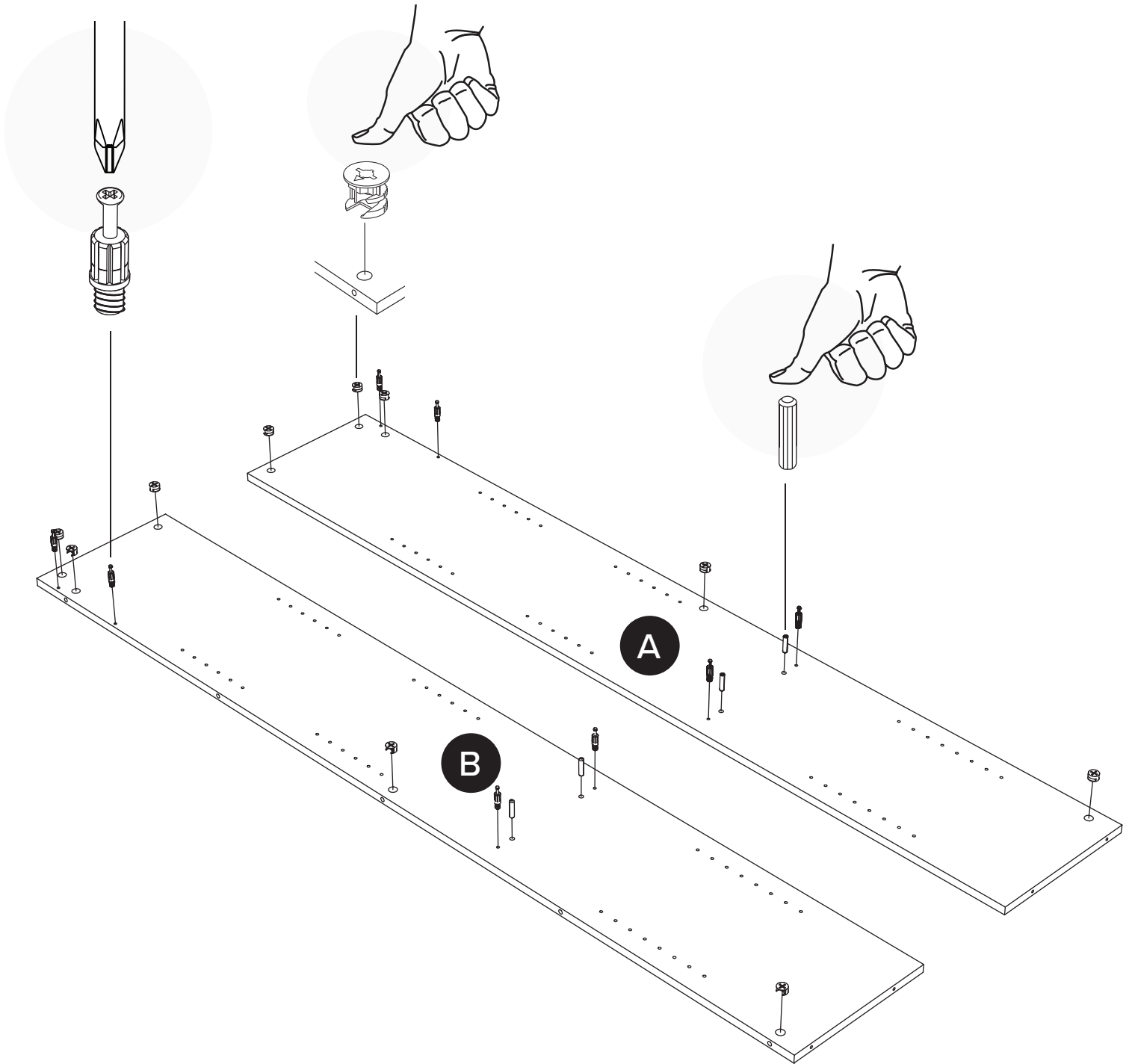

**2**

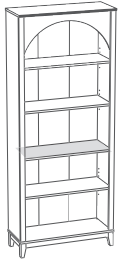

RM-0103



**4X**

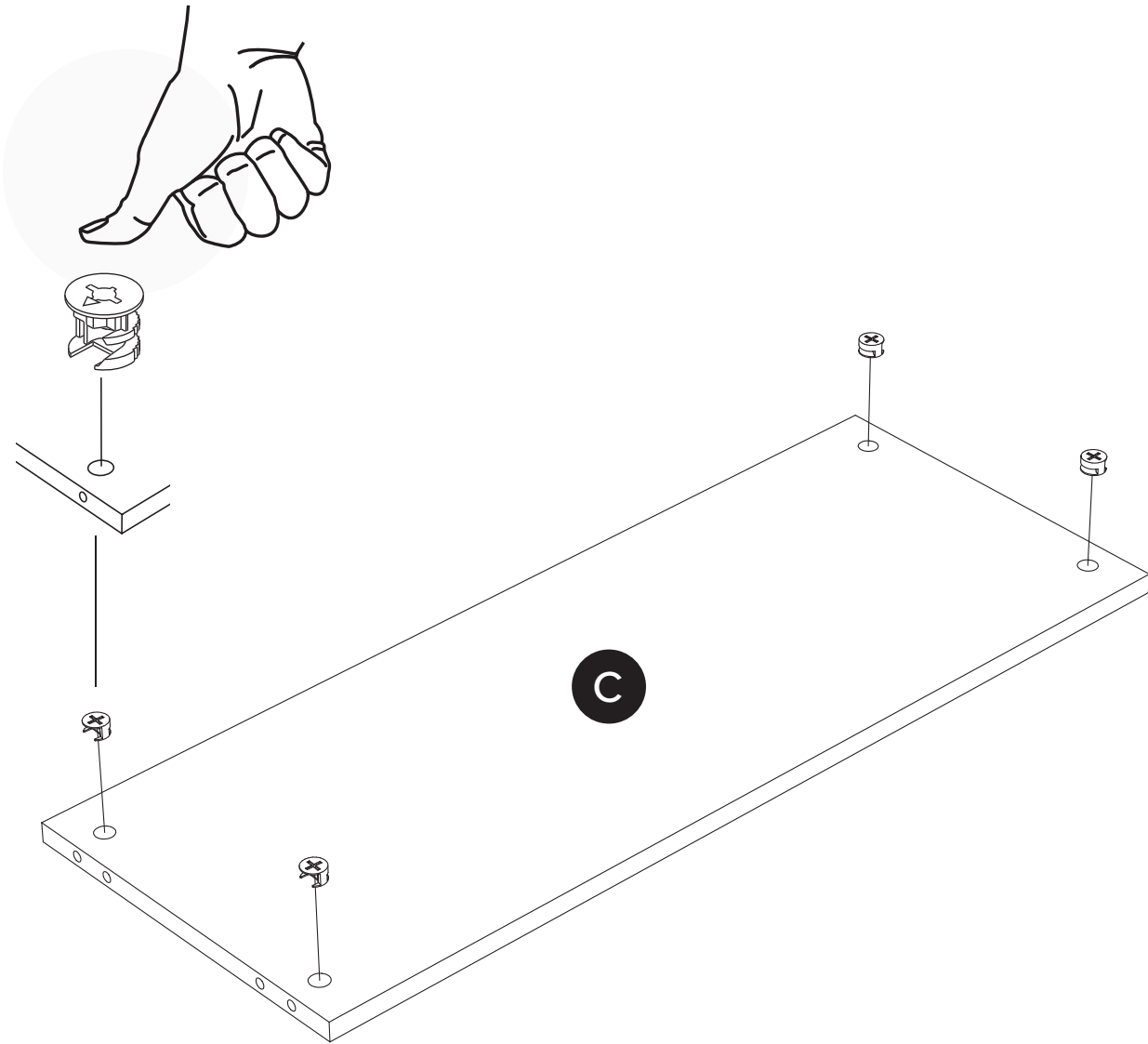

**3**



RM-0103



**4X**

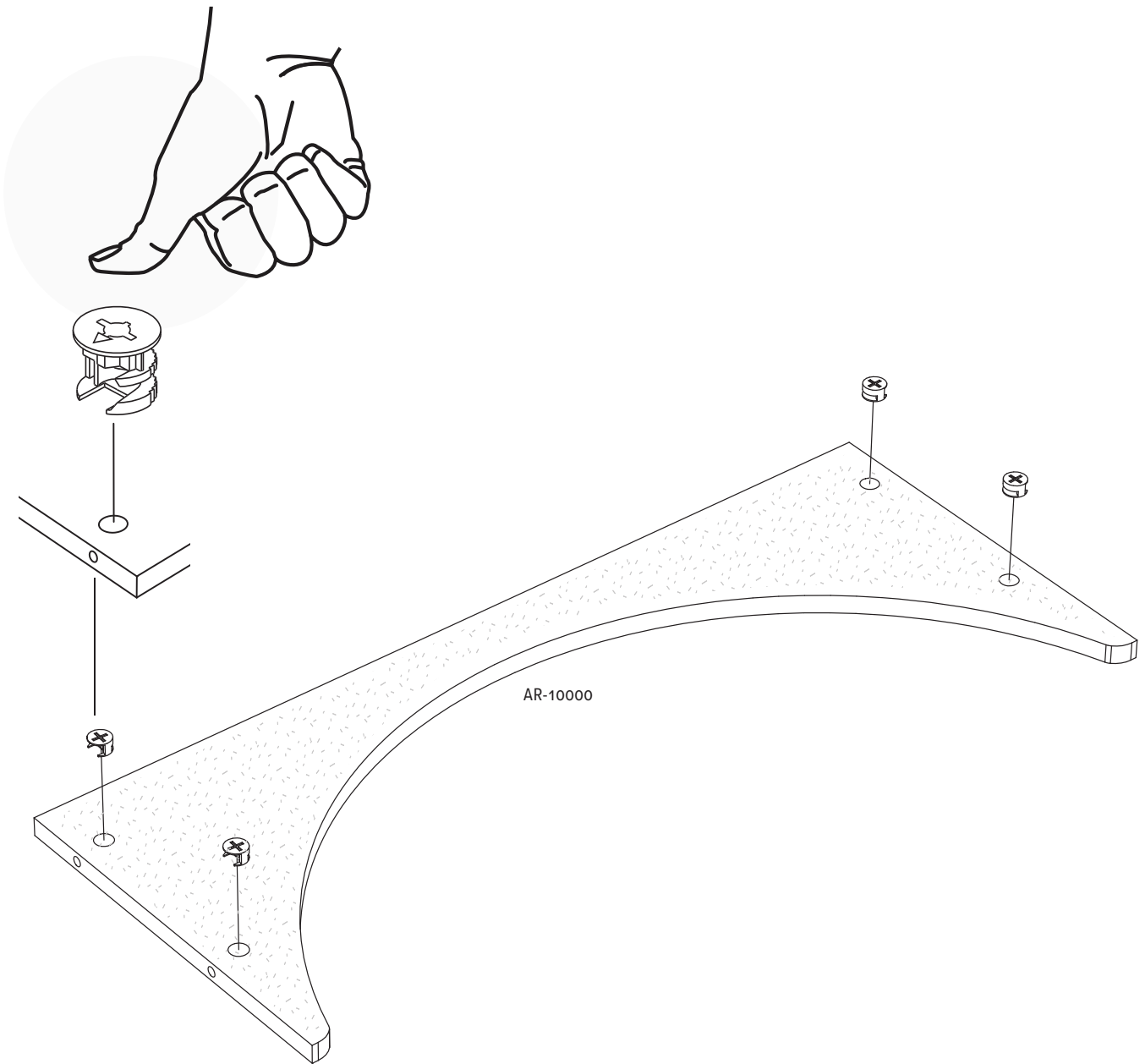

4

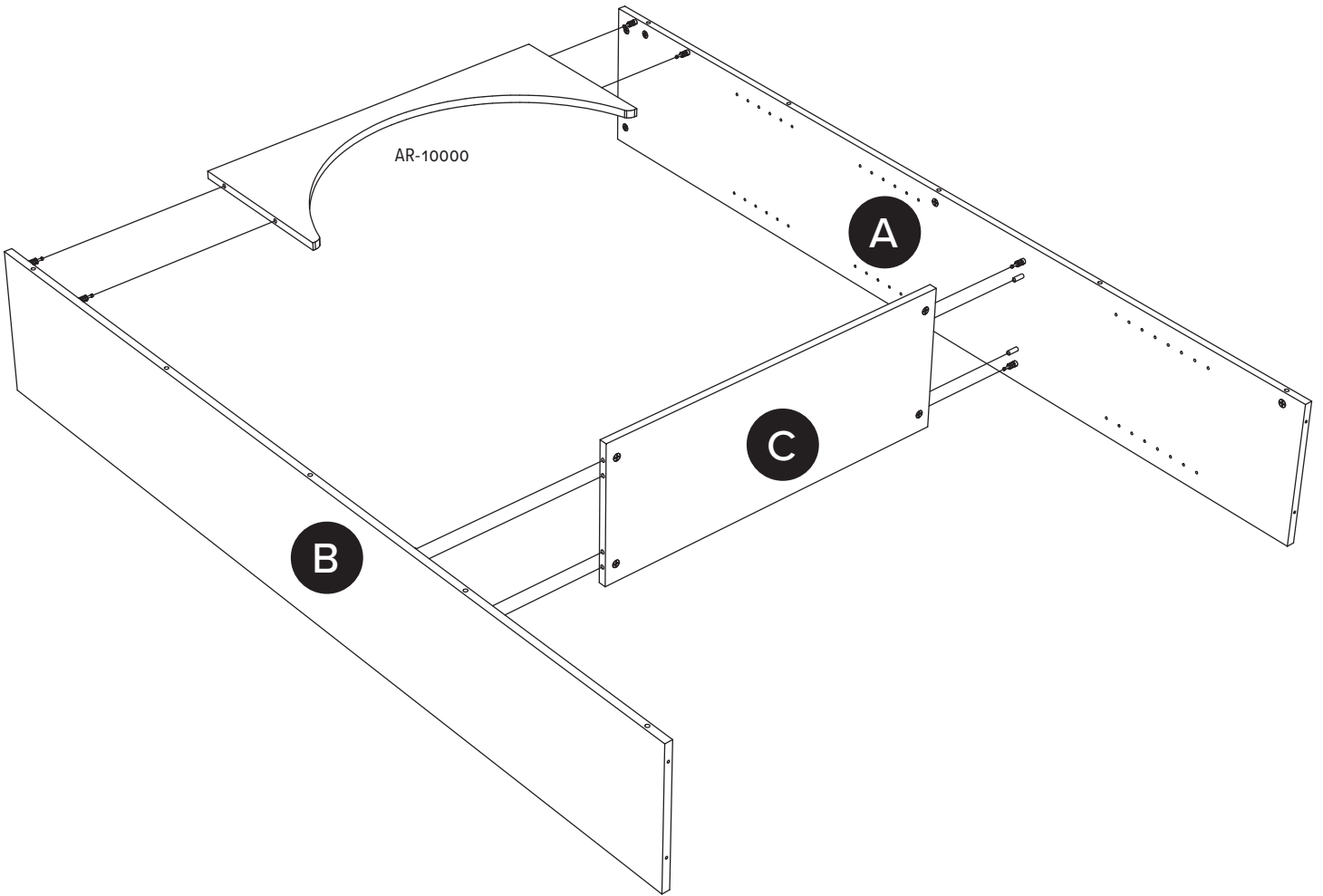
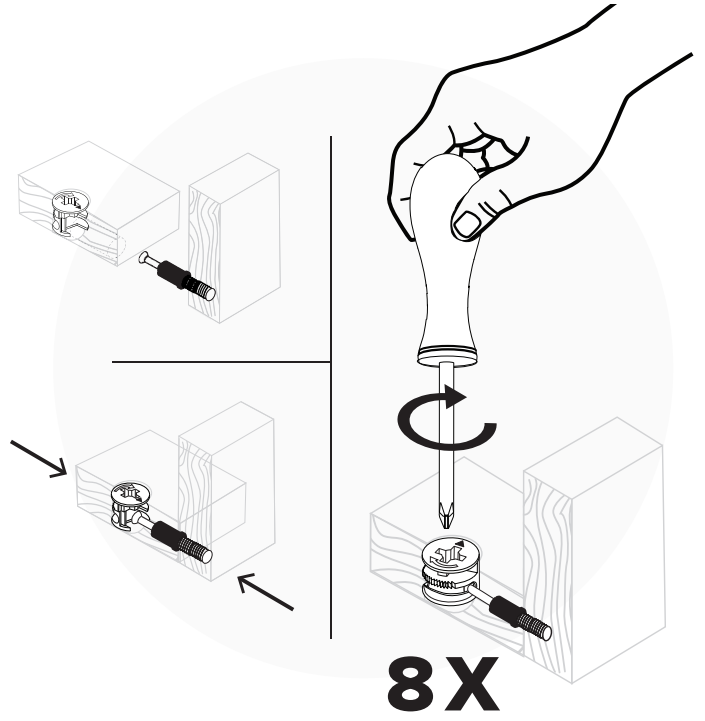
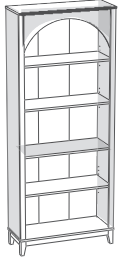

**5**

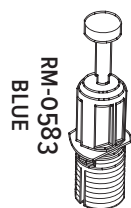

**7X**

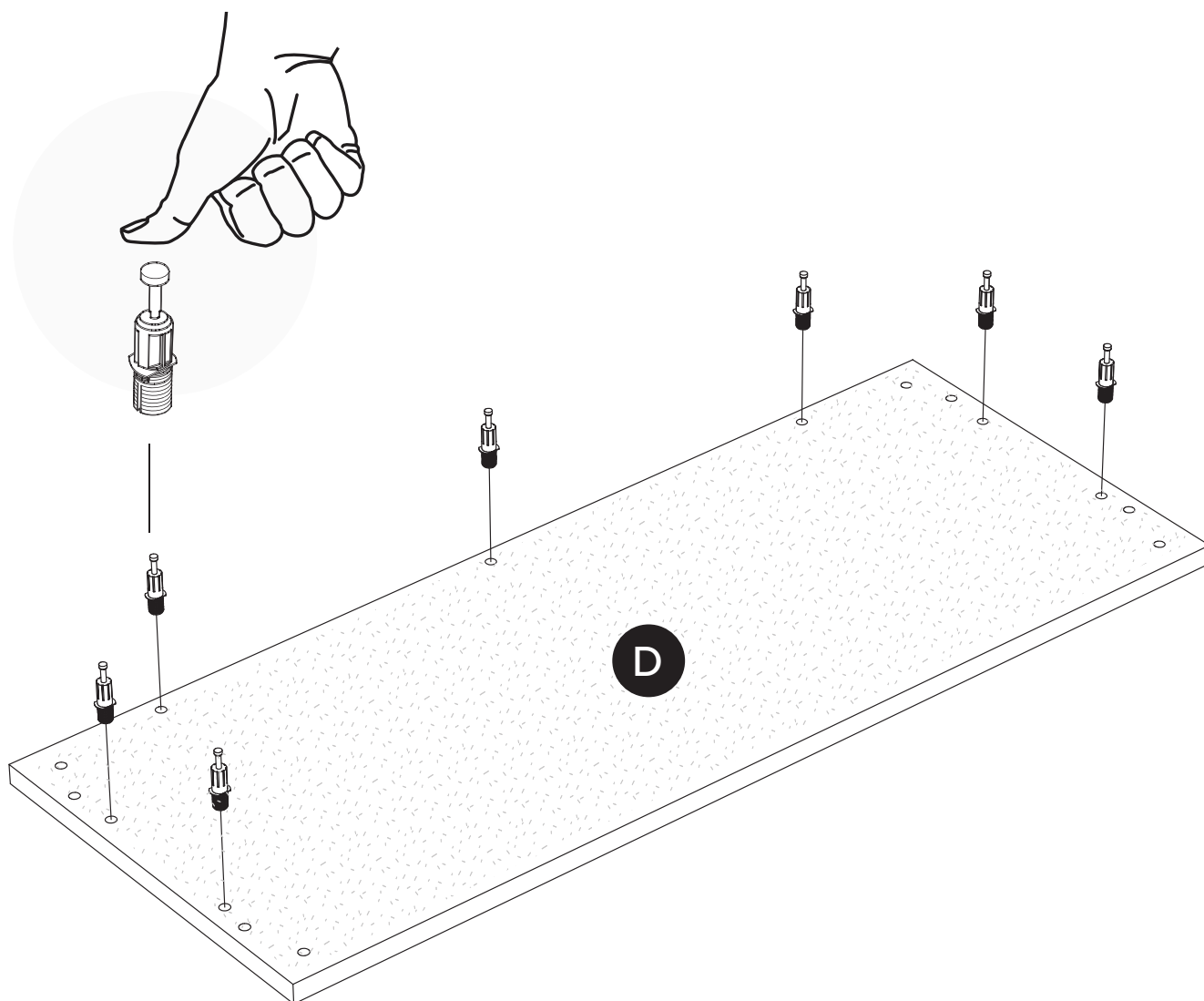

# 6

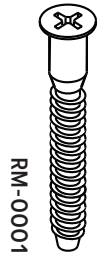
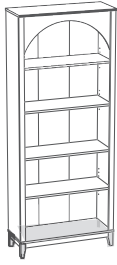

RM-0001

## 4X

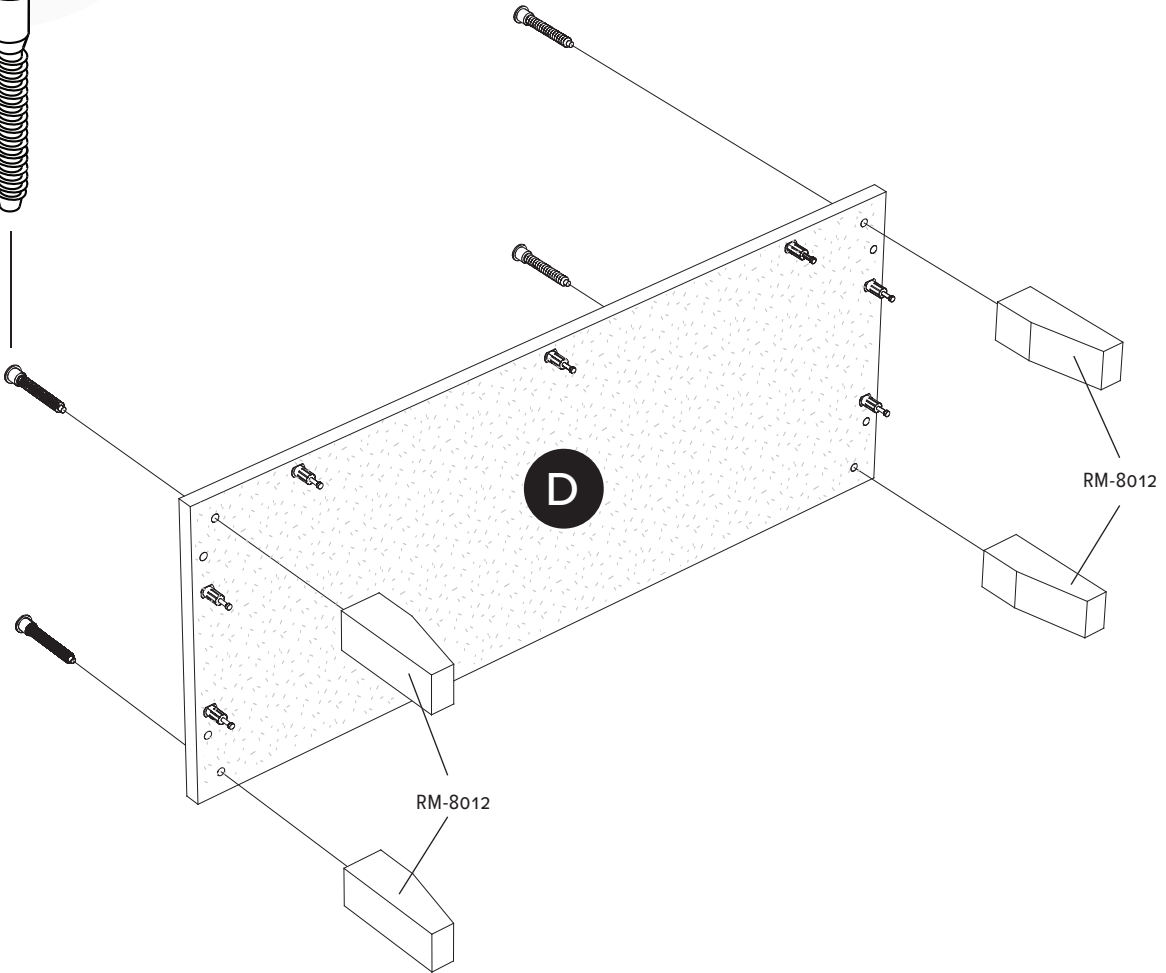
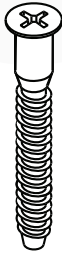
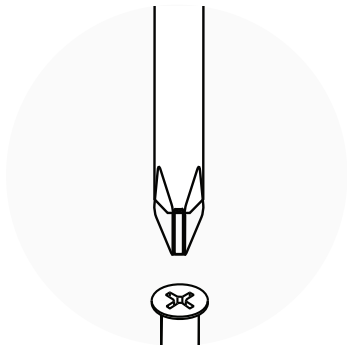

7

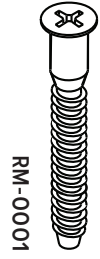
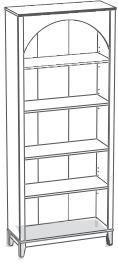

4X

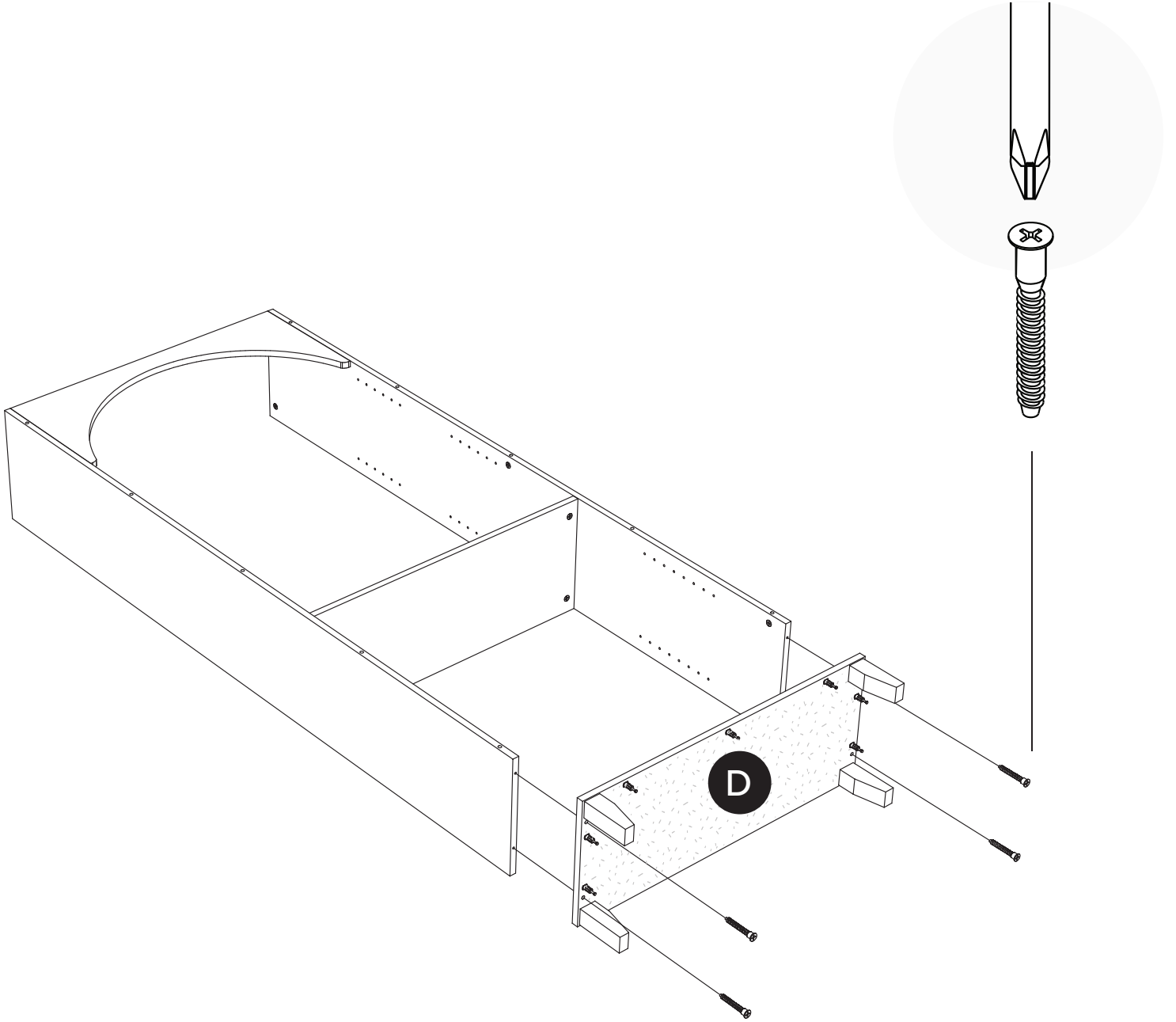

8



RM-0103



7X

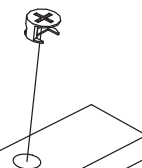
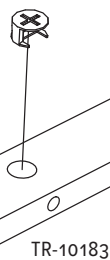
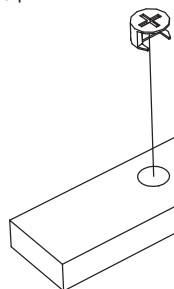
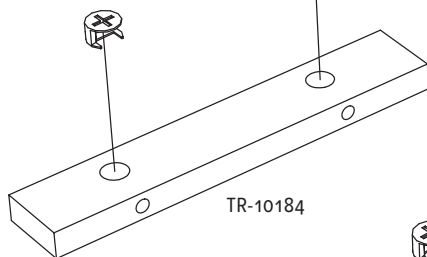
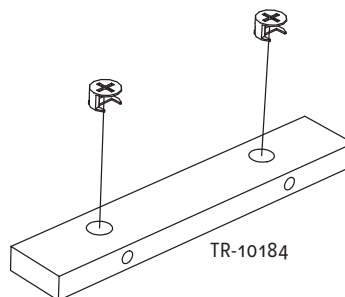
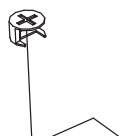
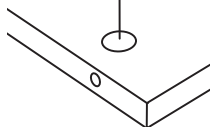

9

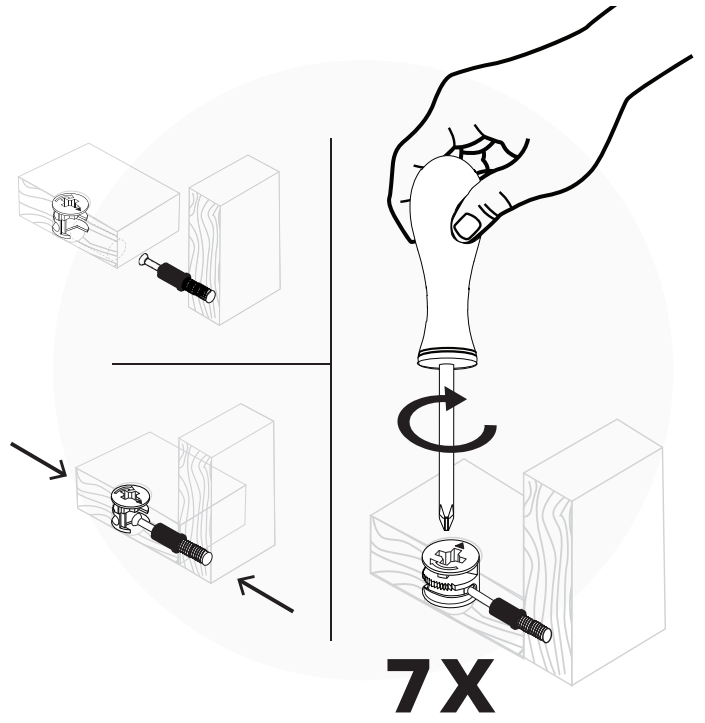
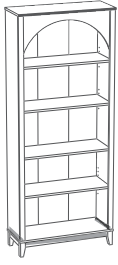

7X

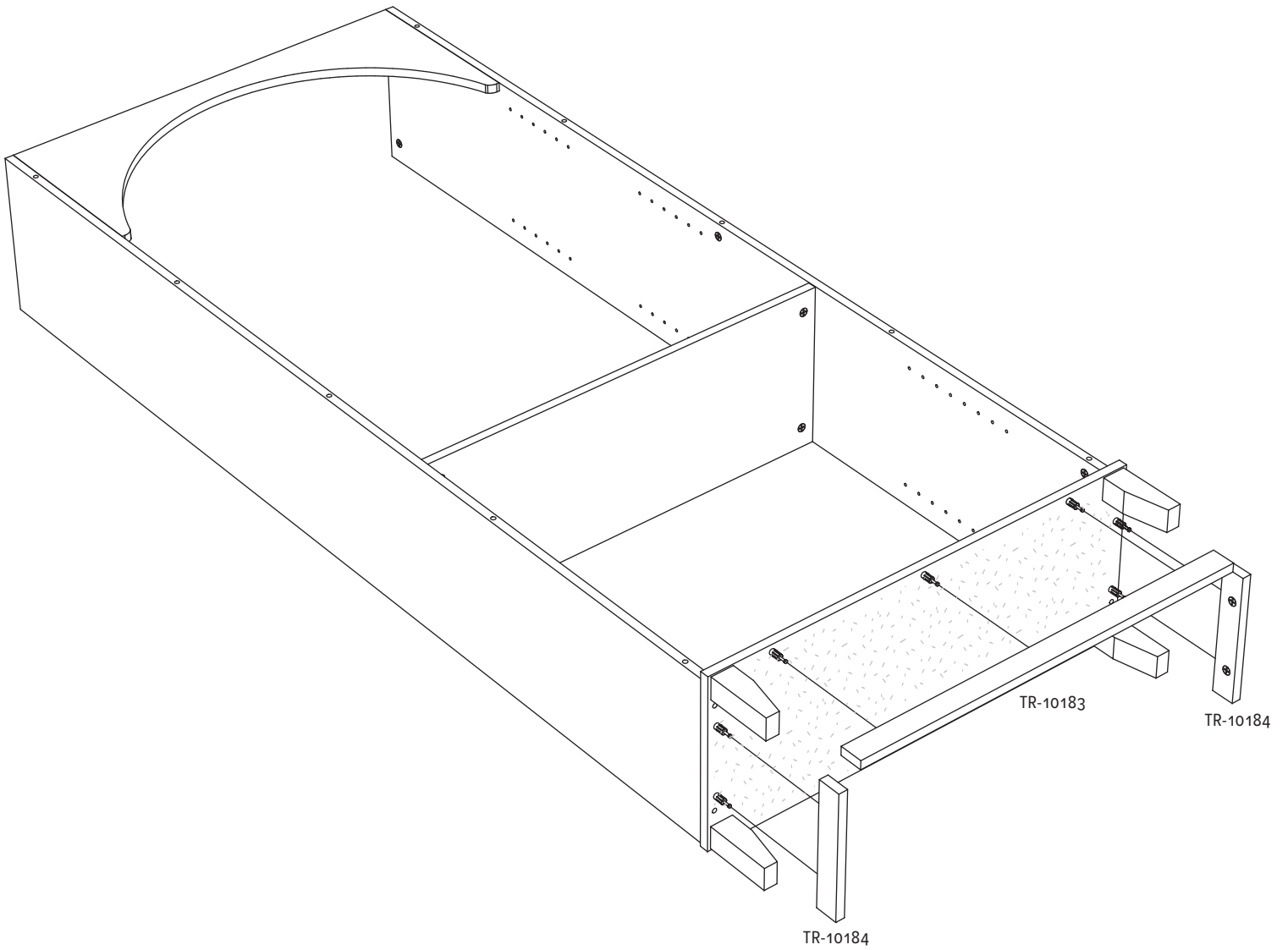

# 10

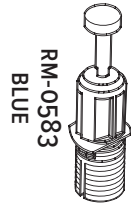
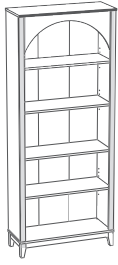

**6X**

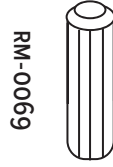

**4X**

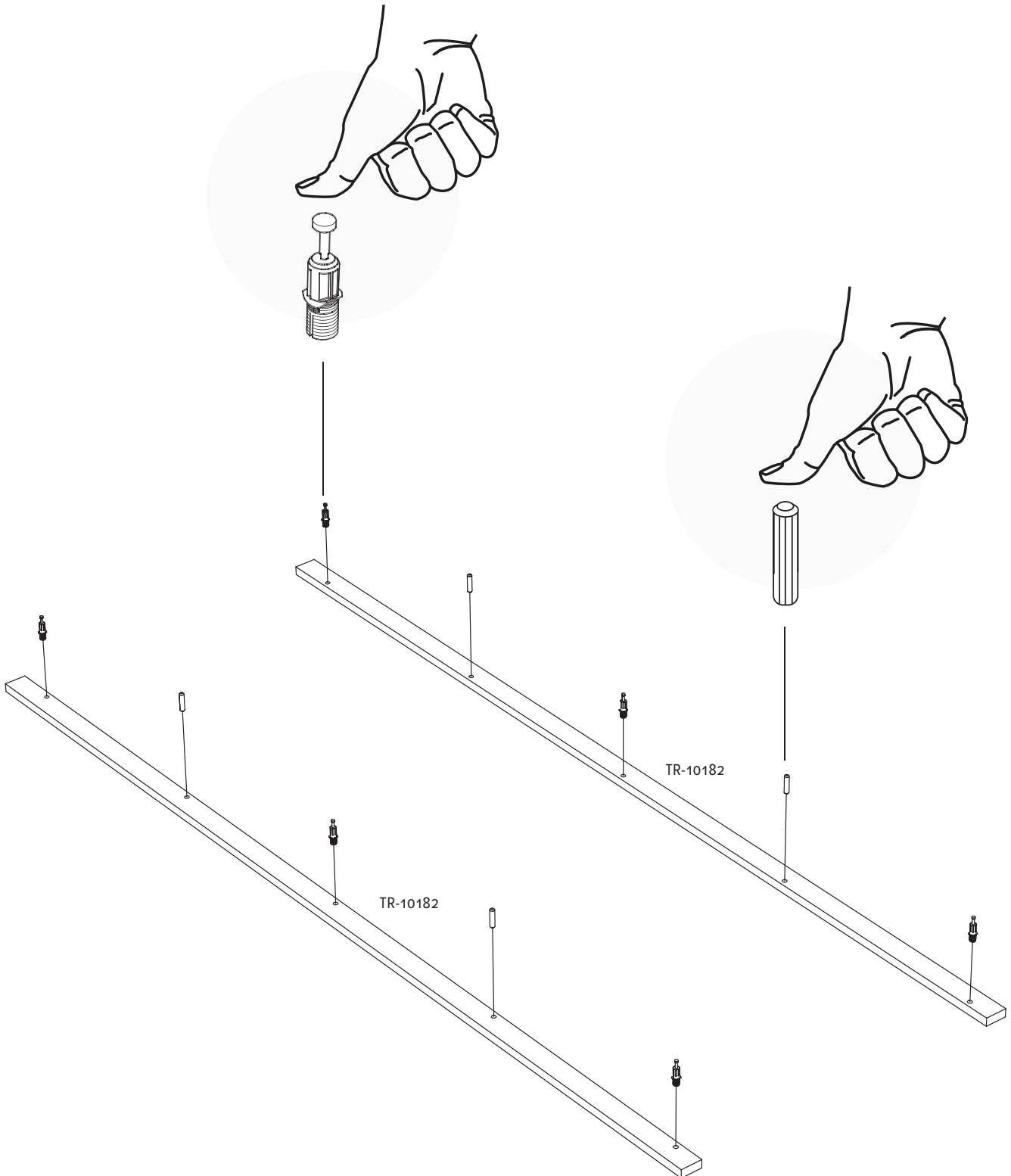

# 11

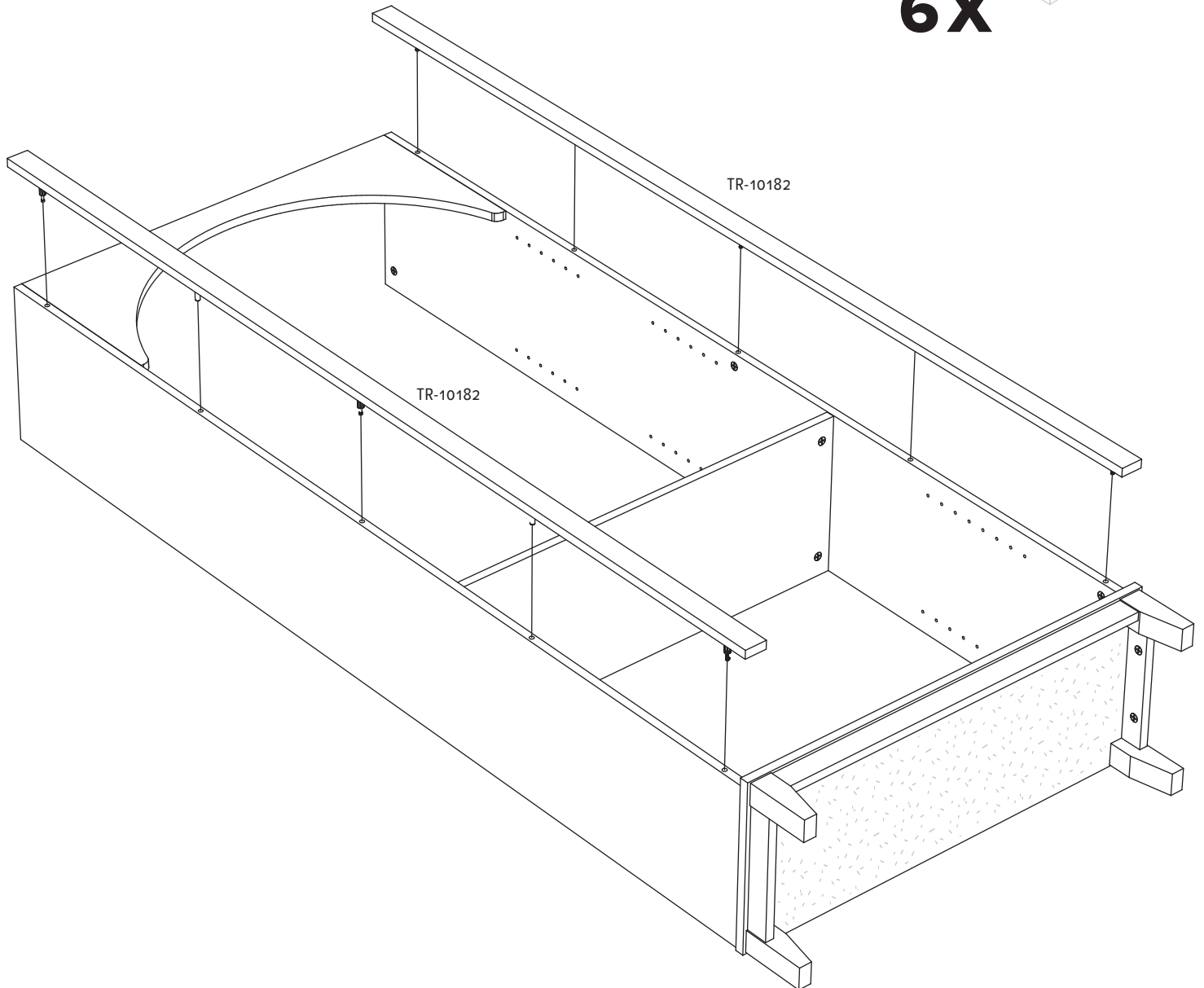
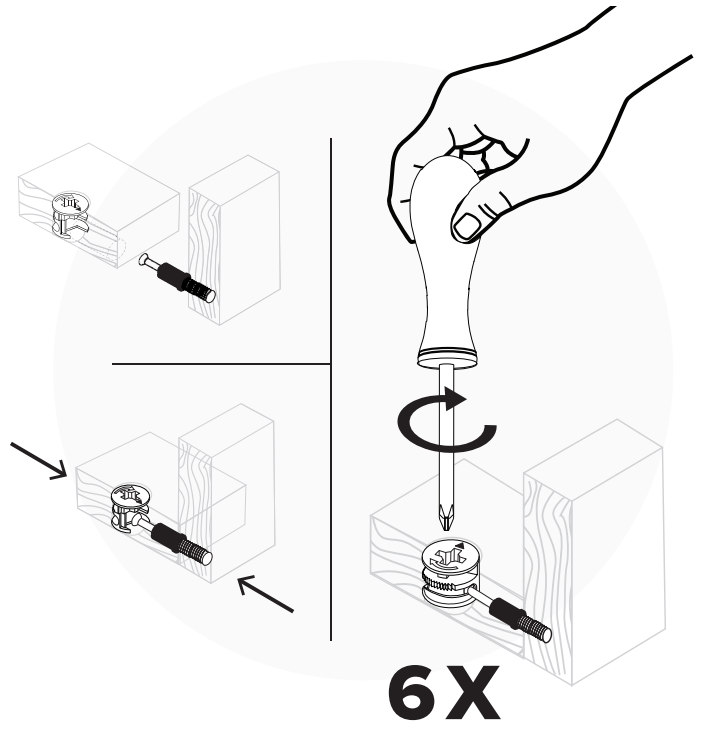
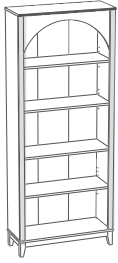

# 12

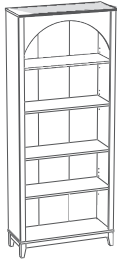

RM-0501  
GREEN

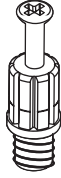

# 4X

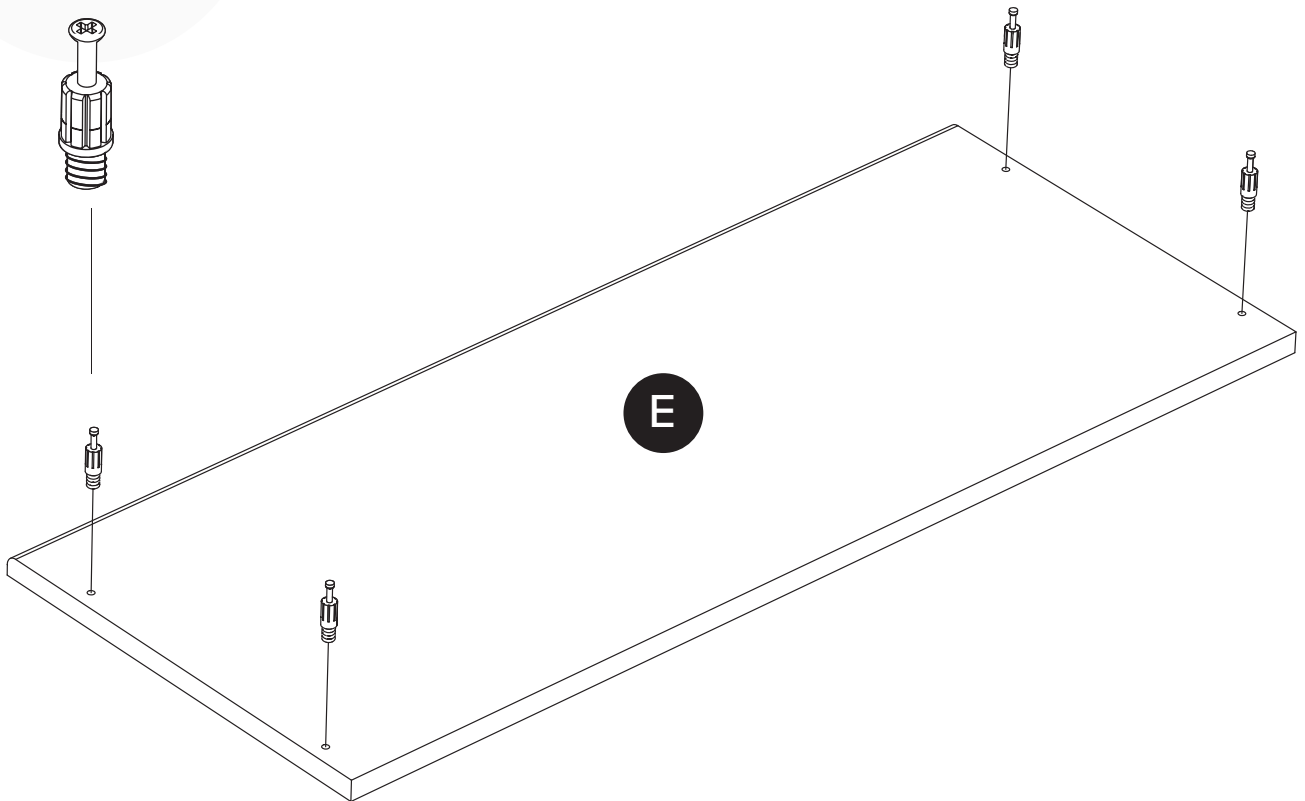
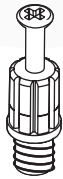
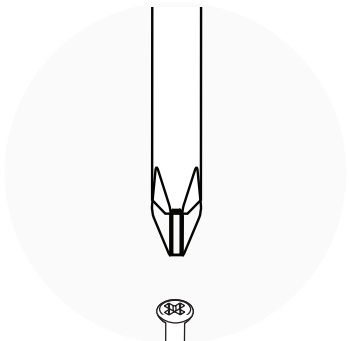

# 13

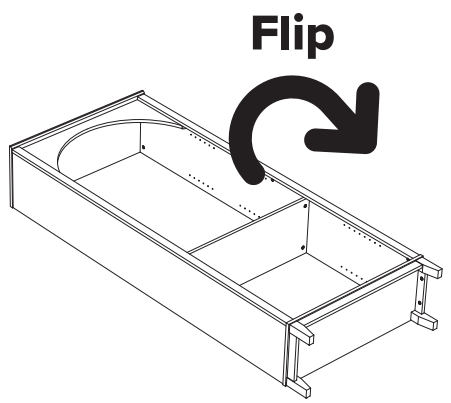
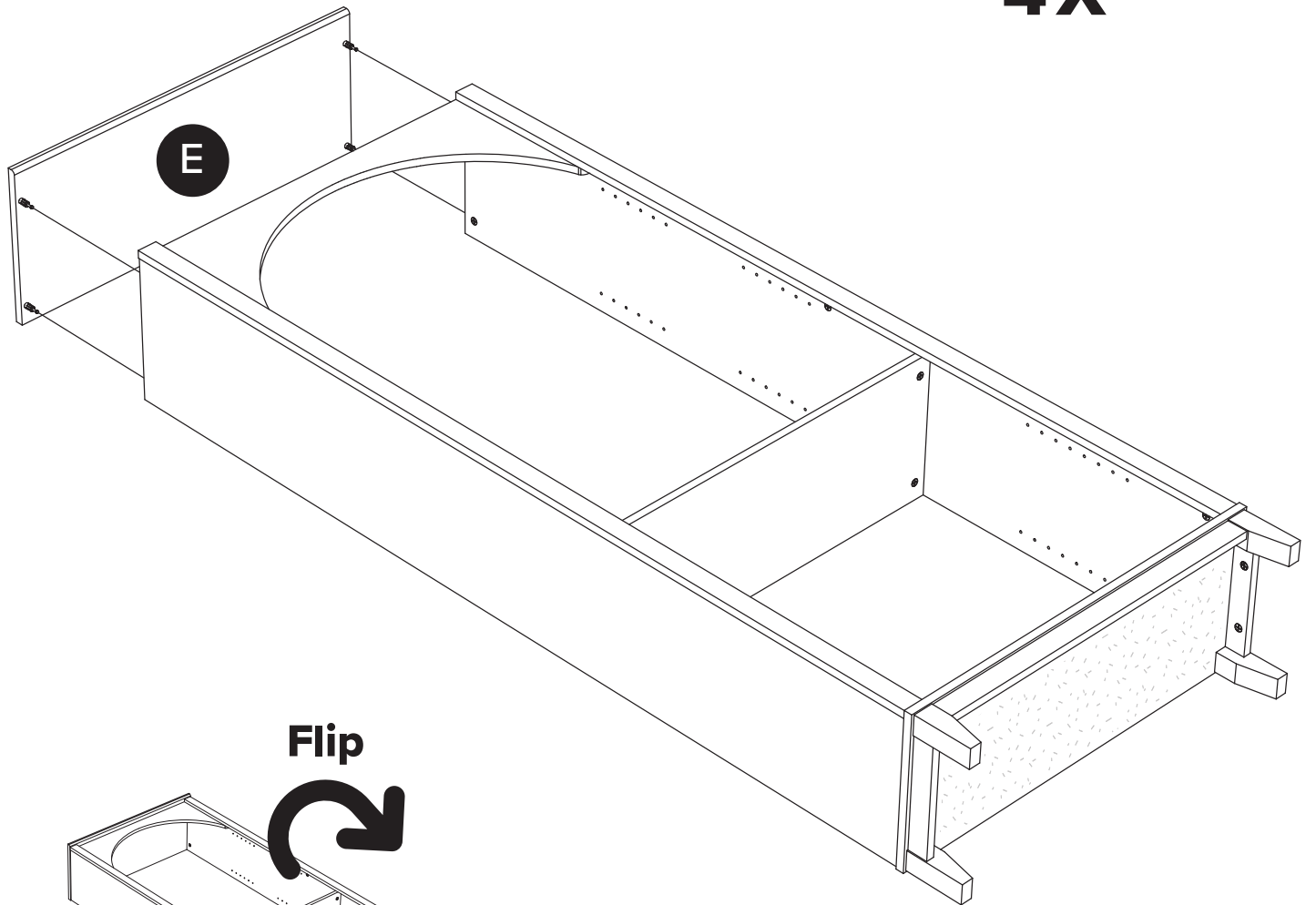
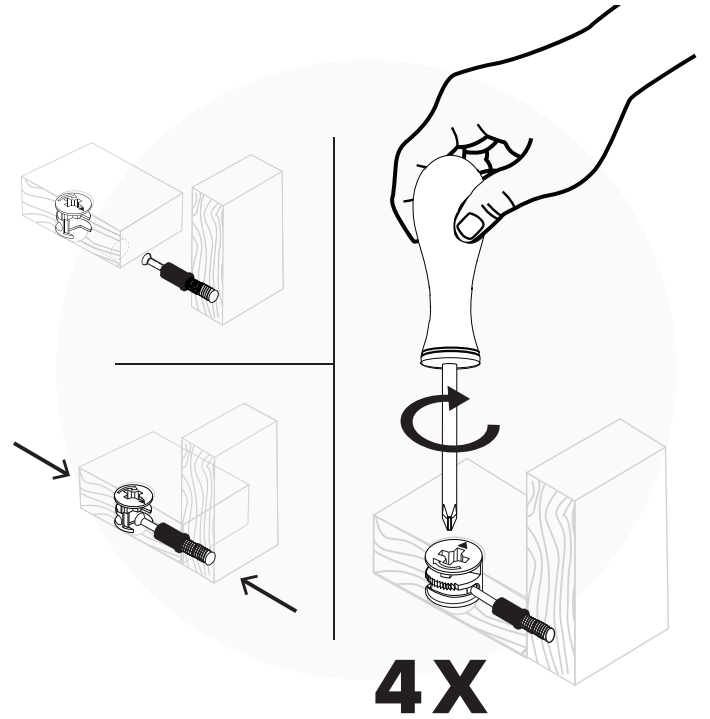
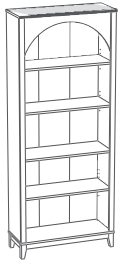

# 14

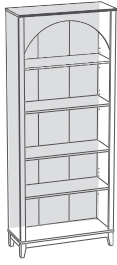

## 36 X

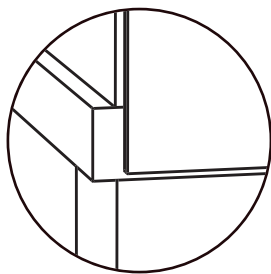
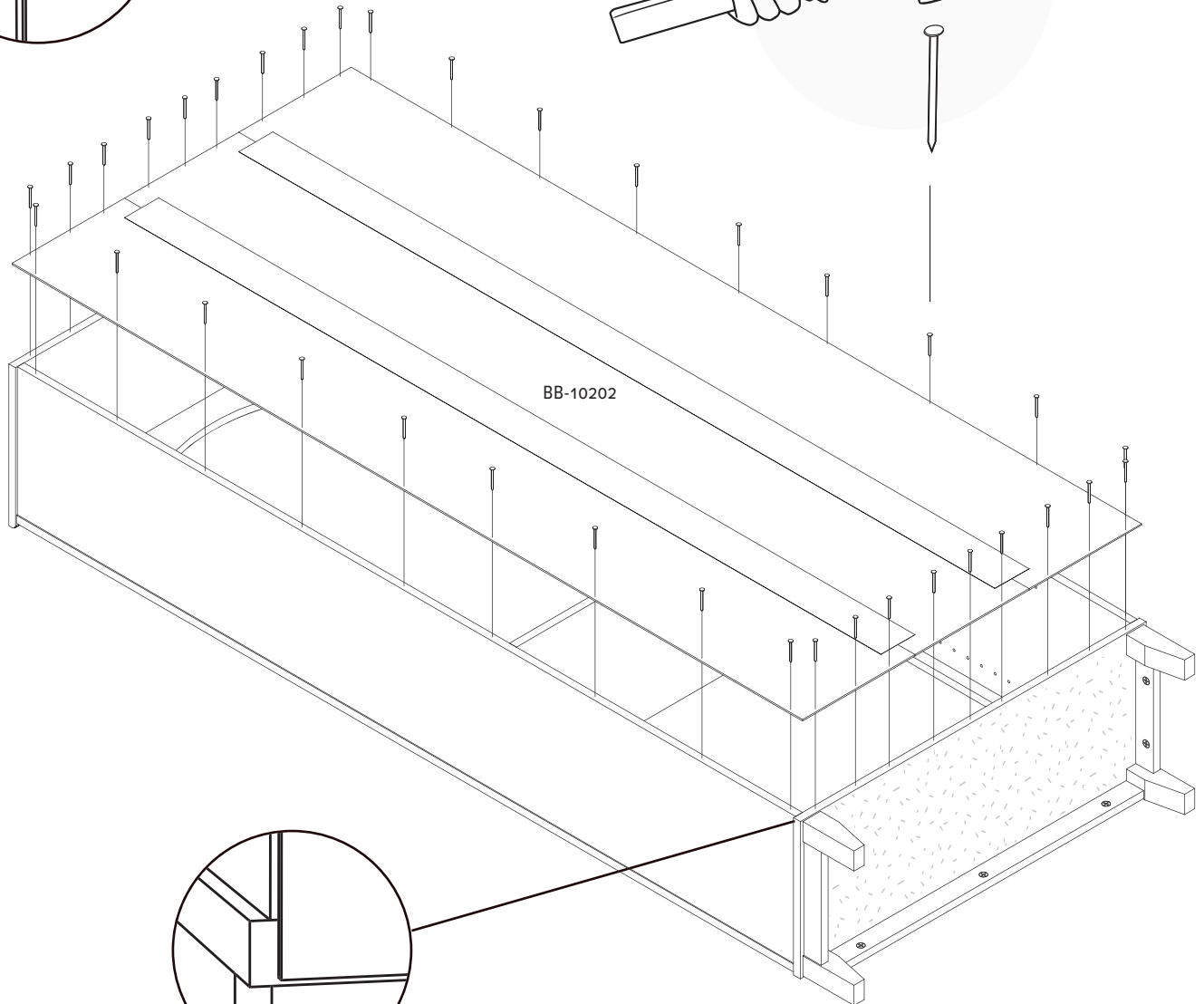
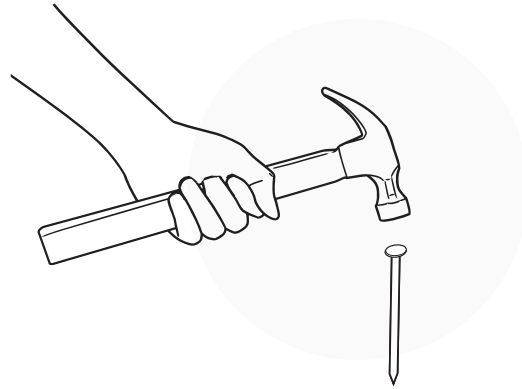
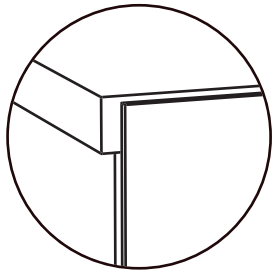

# 15

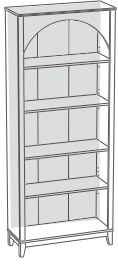

RM-0022



# 6X

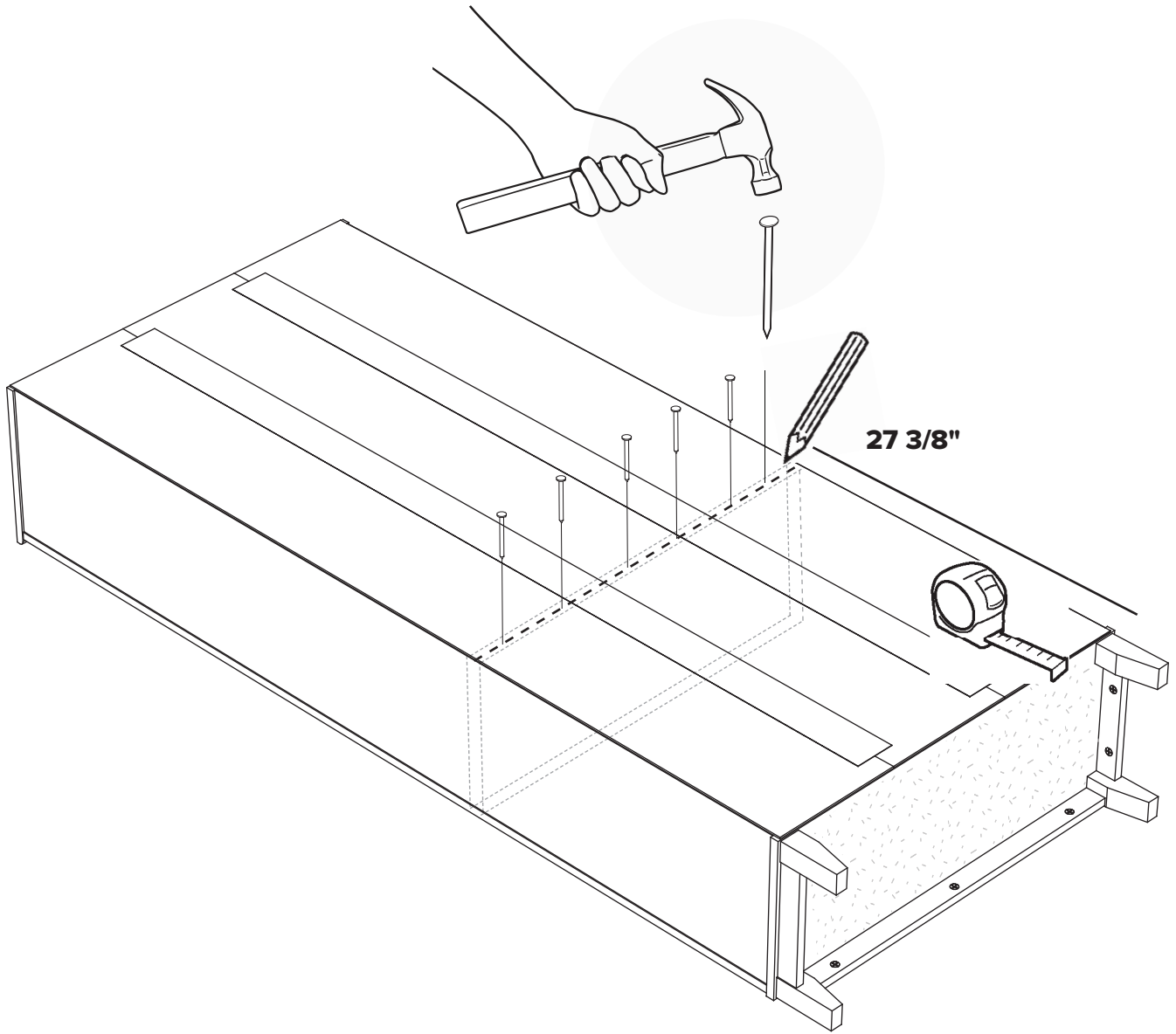

# 16

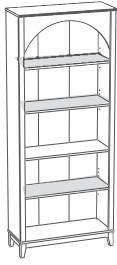

RM-0010-COLOR



**12X**

RM-0802 COLOR

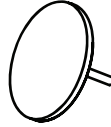

**6X**

RM-0008-COLOR



**4X**

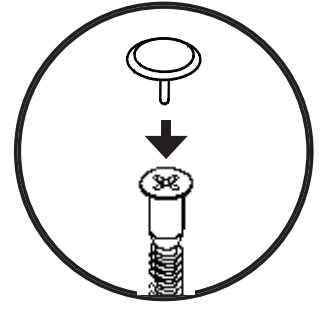
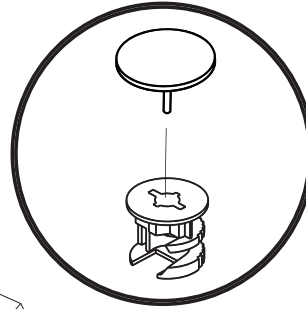
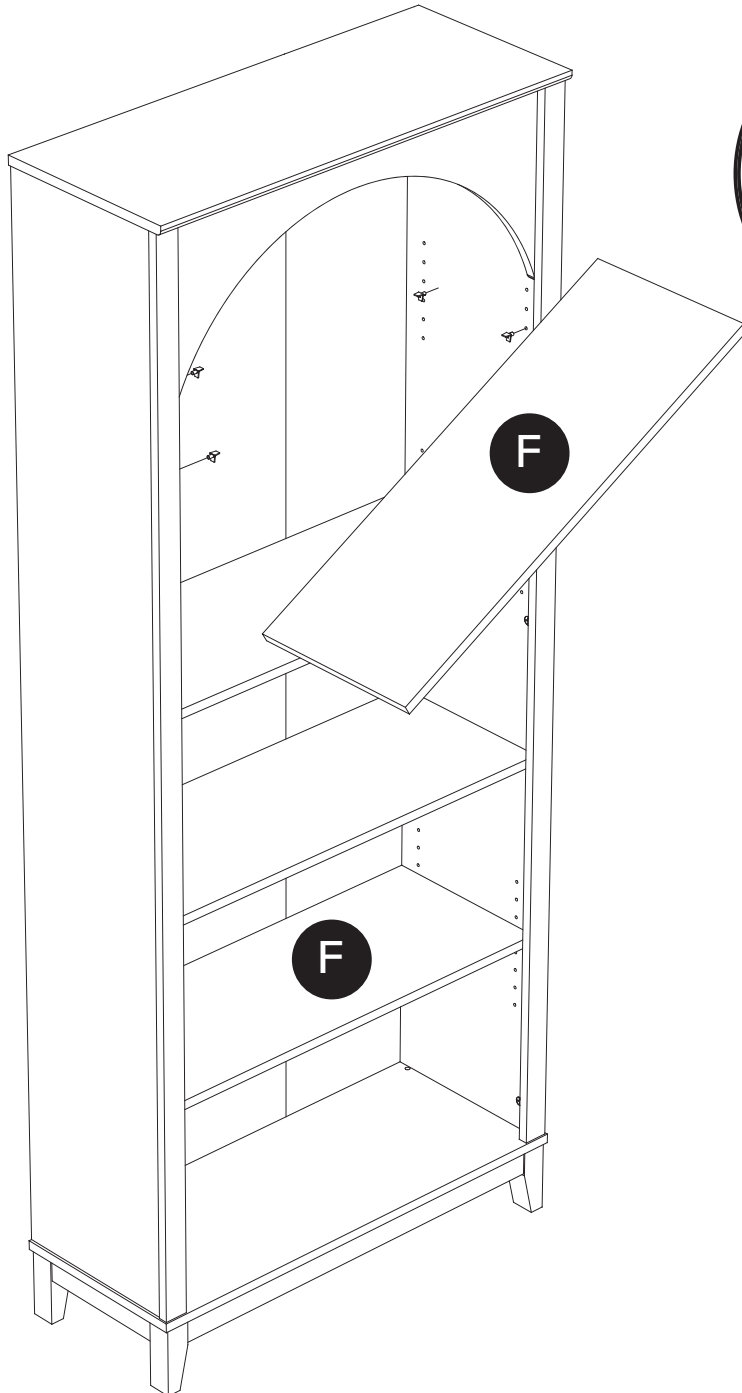

**All done!**  
**Good job!**

---

Tout est fait! Bon travail!

¡Todo listo! ¡Buen trabajo!

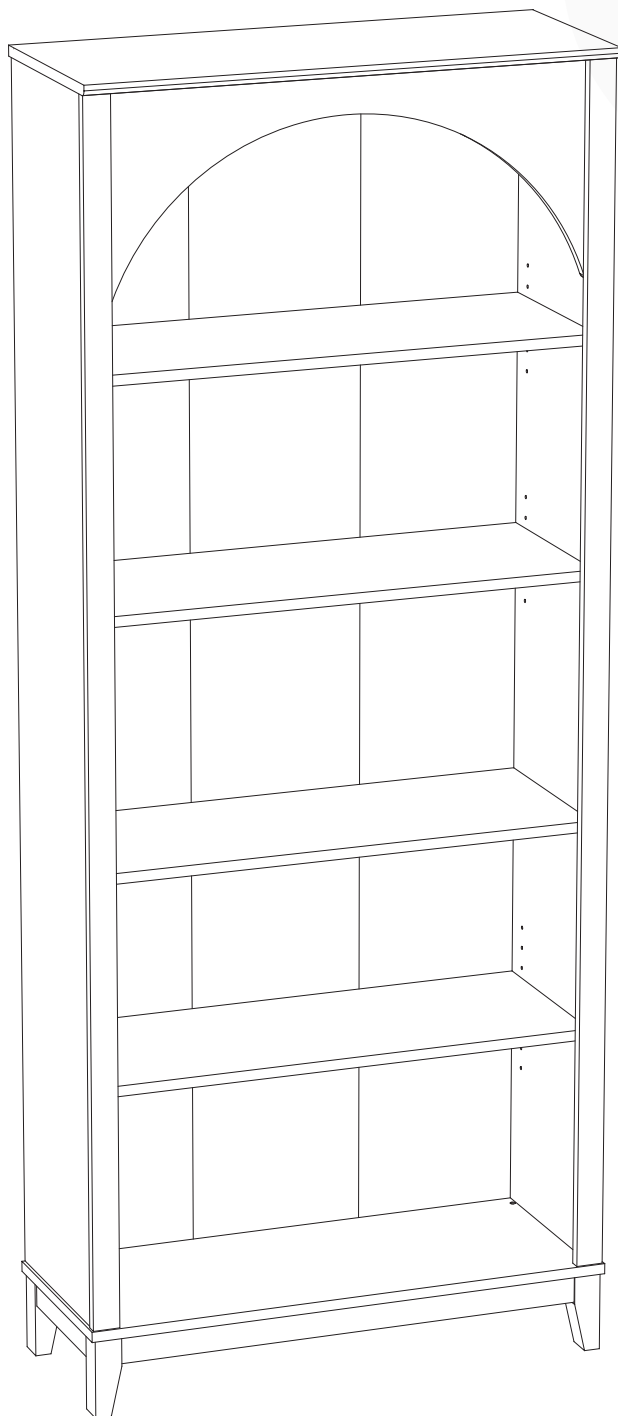

# Tipover Restraint Device

Fixation du dispositif de retenue  
Instalando la correa de seguridad

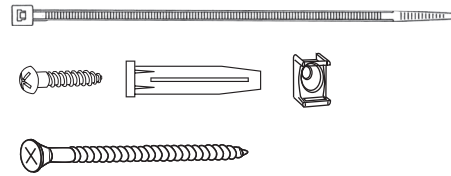

## Safety Notice

We recommend anchoring the furniture in homes where children live or visit. We have included an easy-to-install safety device for this purpose. Please make sure that it is installed according to the following instructions.

## Noticia de seguridad

Recomendamos anclar los muebles en hogares donde viven niños o donde son visitantes. Hemos incluido un dispositivo de seguridad de fácil instalación. Por favor, asegúrese de que esté instalado de acuerdo con las siguientes instrucciones.

## Avis de sécurité

Nous recommandons l'ancrage des meubles dans les domiciles où habitent ou visitent des enfants. C'est pourquoi nous avons inclus un dispositif de sécurité facile à installer. Veuillez vous assurer que ce dernier est installé conformément aux présentes instructions.

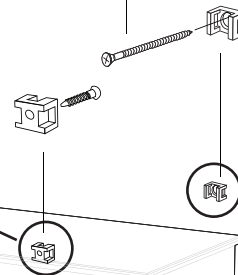
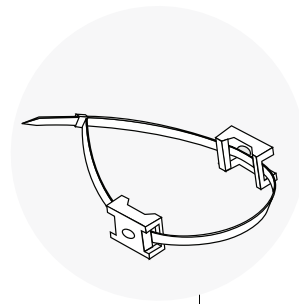
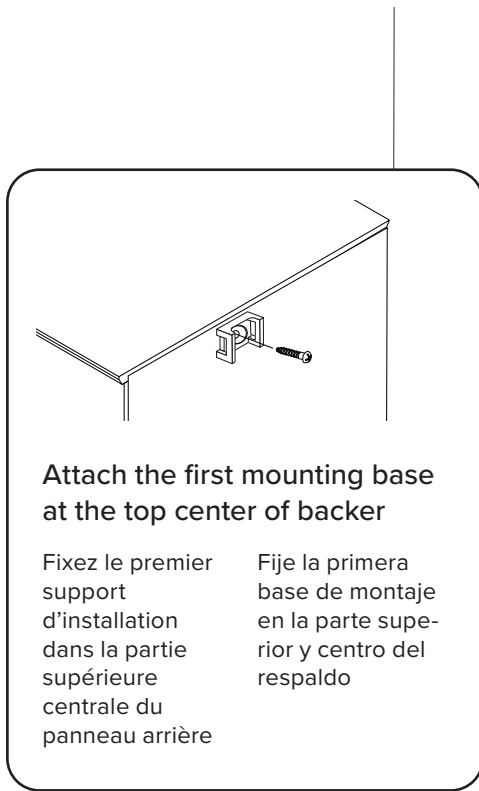

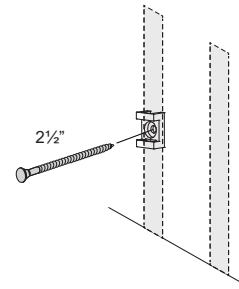
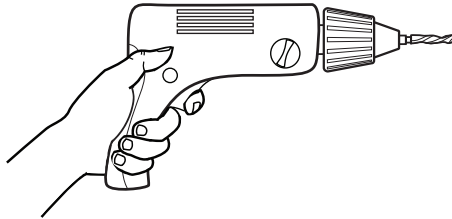
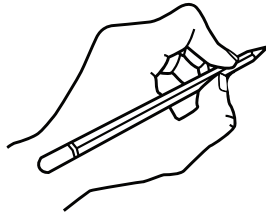

## For walls constructed of wood with drywall

Pour les murs en cloison sèche avec montants en bois  
Para paredes construidas de madera con paneles prefabricados

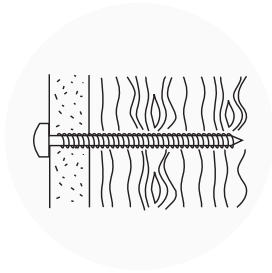

1. With a pencil mark location of second mounting base position
2. Drill pilot hole using an 1/8 inch drill bit 2 inches deep
3. Attach mounting base to wall using the 2 1/2 inch screw provided

1. À l'aide d'un crayon, marquez l'emplacement du deuxième support
2. Percez un avant-trou de 2 po de profondeur avec une mèche de 1/8 po
3. Vissez le support dans le mur à l'aide des vis de 2 1/2 po fournies

1. Con un lápiz marcar la ubicación de la segunda base de montaje
2. Perforar el agujero usando una broca de 1/8 pulgadas 2 pulgadas de profundidad
3. Montar el soporte a la pared utilizando los 2 tornillos de 2 1/2 pulgadas proporcionados

## For walls constructed of drywall (unable to hit a stud)

Pour les murs en cloison sèche (où il est impossible de visser dans un montant en bois)  
Para muros construidos de drywall (Sin travesaño)

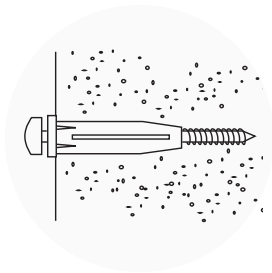

1. Drill pilot hole using a 5/16 inch drill bit only to the depth of drywall thickness
2. Using a rubber mallet or hammer insert wall anchor into drywall
3. Attach holder to wall anchor using 2 1/2 inch screw provided

1. Percez un avant-trou à l'aide d'une mèche de 5/16 po sans dépasser la profondeur de la cloison sèche
2. À l'aide d'un maillet en caoutchouc ou d'un marteau, insérez l'ancrage mural dans la cloison sèche
3. Vissez le support dans l'ancrage mural à l'aide des vis de 2 1/2 po fournies

1. Perforar el agujero utilizando una broca de 5/16 pulgadas solo a la profundidad del grosor del panel de yeso
2. Utilizando un martillo de goma o un martillo insertar el anclaje en pared de yeso
3. Fije el soporte de anclaje a la pared utilizando el tornillo de 2 1/2 pulgadas incluido

## For walls constructed of concrete

Pour les murs en béton  
Para muros construidos de hormigón

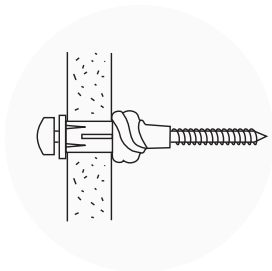

1. Drill pilot hole using a 5/16 inch drill bit 2 3/4 inches deep
2. Using a rubber mallet or hammer insert wall anchor into predrilled hole
3. Attach holder to wall anchor using 2 1/2 inch screw provided

1. Percez un avant-trou de 2 3/4 po de profondeur avec une mèche de 5/16 po
2. À l'aide d'un maillet en caoutchouc ou d'un marteau, insérez l'ancrage mural dans le trou
3. Vissez le support dans l'ancrage mural à l'aide des vis de 2 1/2 po fournies

1. Perforar un agujero de 2 3/4 de profundidad utilizando una broca de 5/16 pulgadas
2. Utilizando un martillo de goma o un martillo insertar el anclaje en el agujero preperforado
3. Fije el soporte de anclaje a la pared utilizando el tornillo de 2 1/2 pulgadas incluido

Bookcase

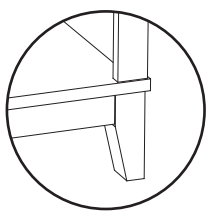
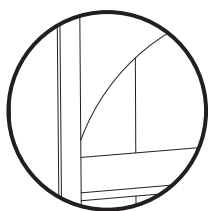
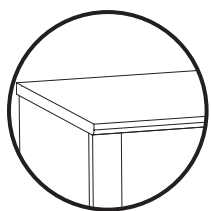

bibliothèque  
estantería

