

ASSEMBLY INSTRUCTIONS

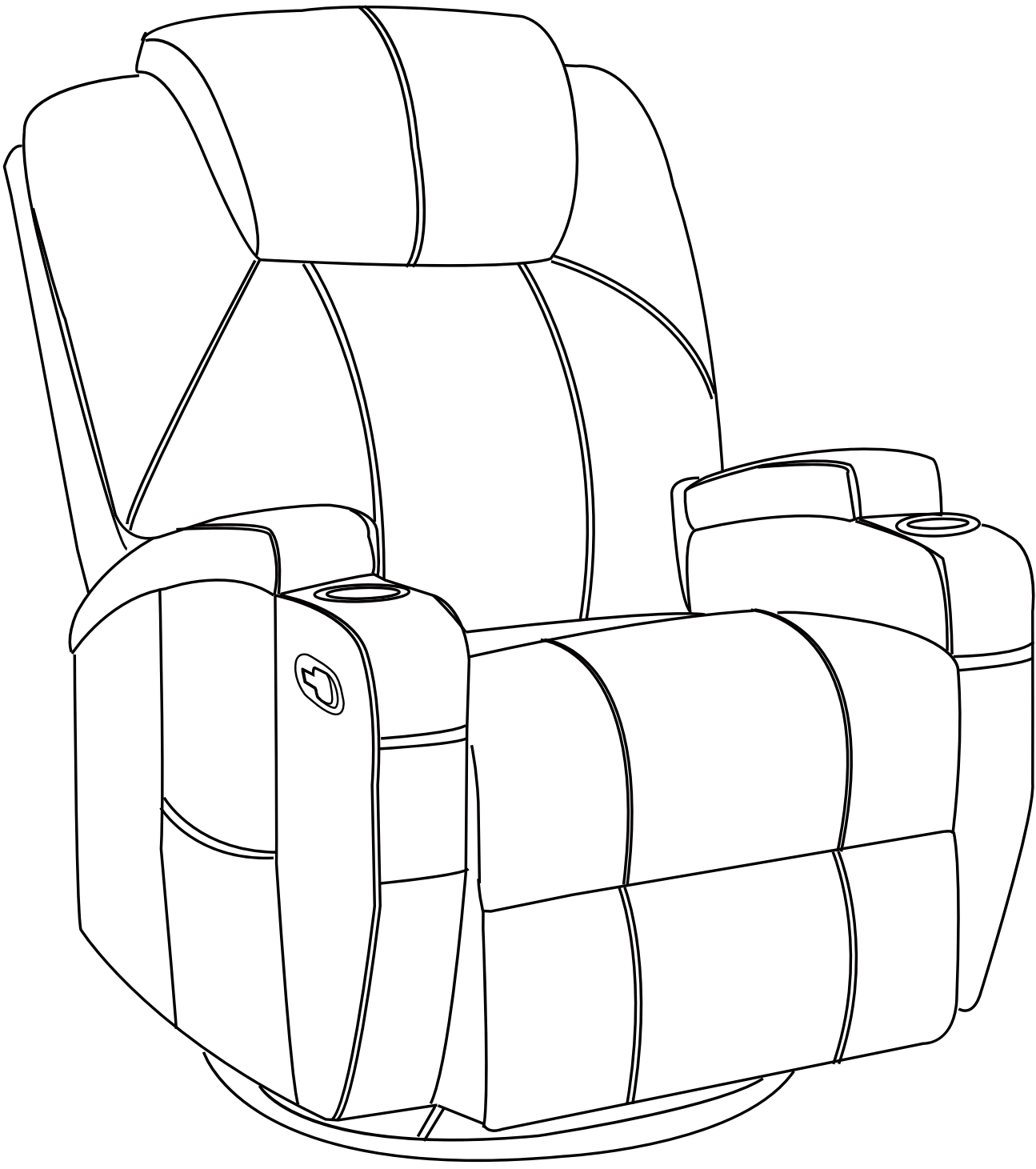

WARNING !

Please read the instructions line by line carefully before assembly, and assemble the item step by step according to the instructions. Don't use the item before all the components are put together. For any damage or defective parts, please contact our online after-sale service for help.

* The features and specifications of the products are subjects to changes without prior notice.

* To avoid item damage and personal injury, please strictly observe the instructions when assembling.

* To avoid product damage and personal injury, please check the loading capacity.

* To avoid personal injury, put the item on the flat ground.

* Do not stand on the item. Older people or people mobility impairments and children need to use the product with an adult or guardian

* To avoid personal injury, stop using a damaged item and get it disposed properly.

* Indoor use only

*Capacity: one person only.

*Check all bolts, screws and knobs on a regular basis.

*There is potential risk of personal injury not to follow the instructions when in use, please use it in strict accordance with the instructions.

* Please keep the instructions in case of further use.

NOTICE: The remotes are placed in the small box under the chair bottom.

WARNING !

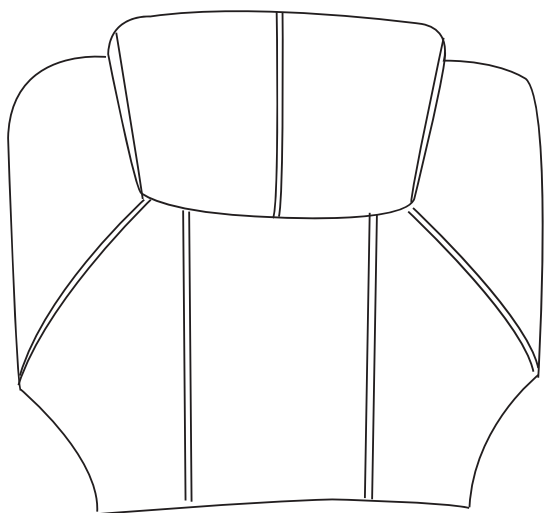

Backrest



Power
cable

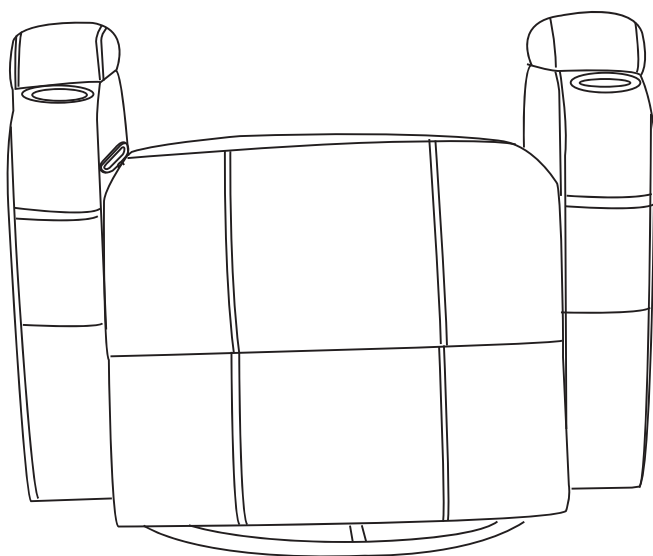

Seat

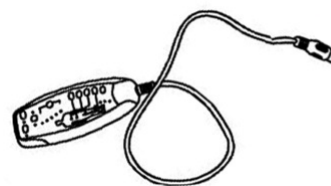

Remote
control

Assembly steps

1

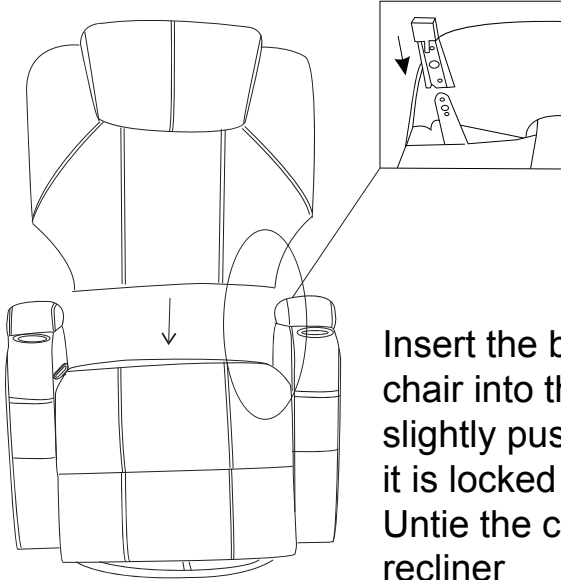

Insert the back of the chair into the seat and slightly push it down till it is locked in position. Untie the cord under the recliner

2

Connect the switching power wire to the plug wire.



3

Connect the switching power wire to the remote control.

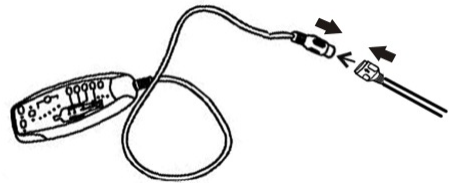

4

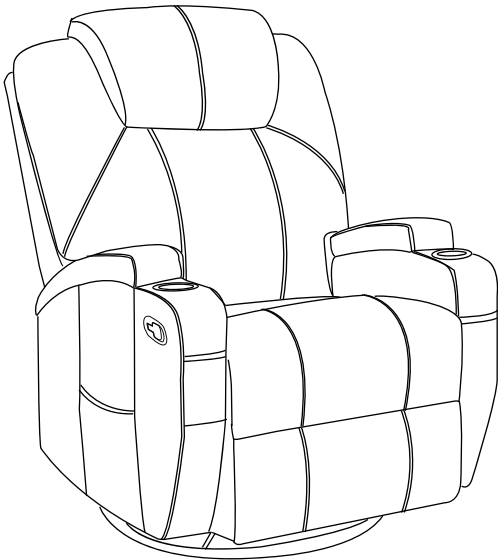

The recliner is completed

5

MASSAGE CHAIR

REMOTE CONTROL
Function of remote

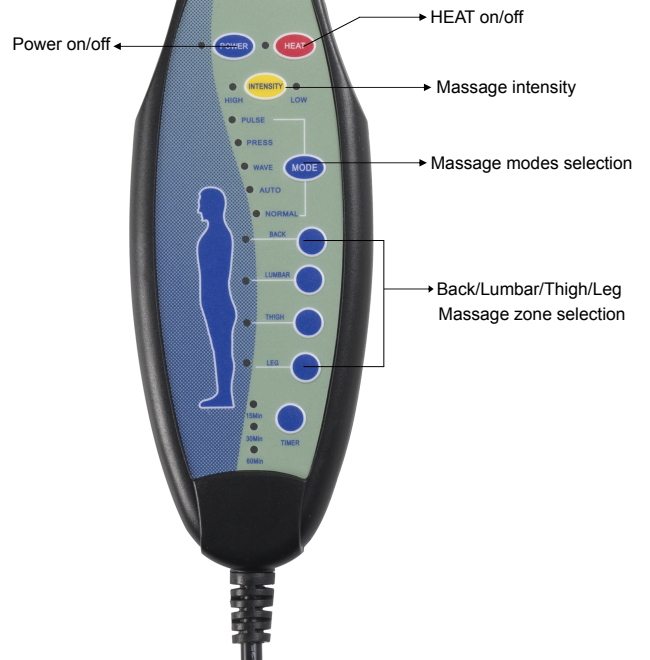

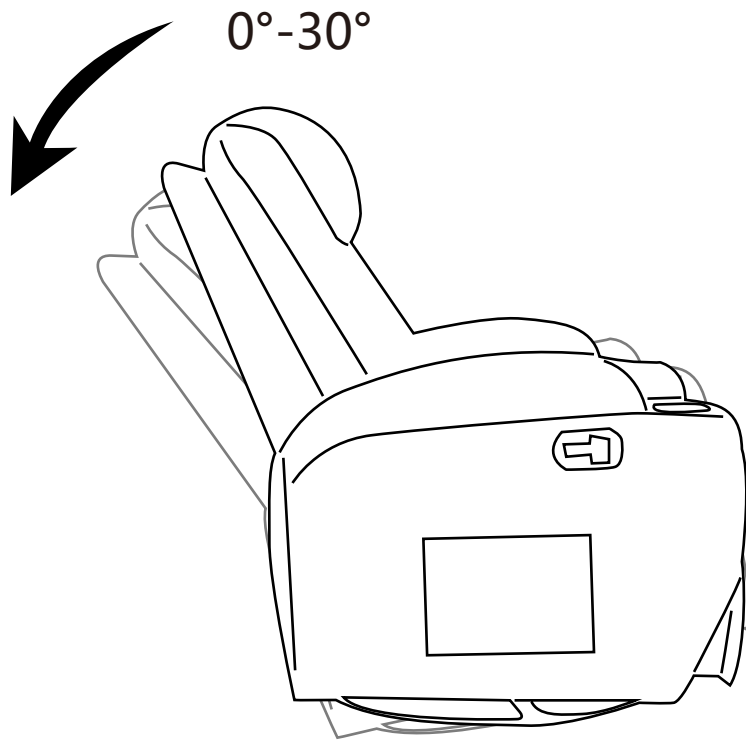

Rocking Function

Notice:

*Please do not use rocking function and swing function when the chair is reclining!

*Please don't rock it forth and back more than 30°!

*Maximum weight Capacity 260LB



360 Degree Swivel

Function

Reclining Function

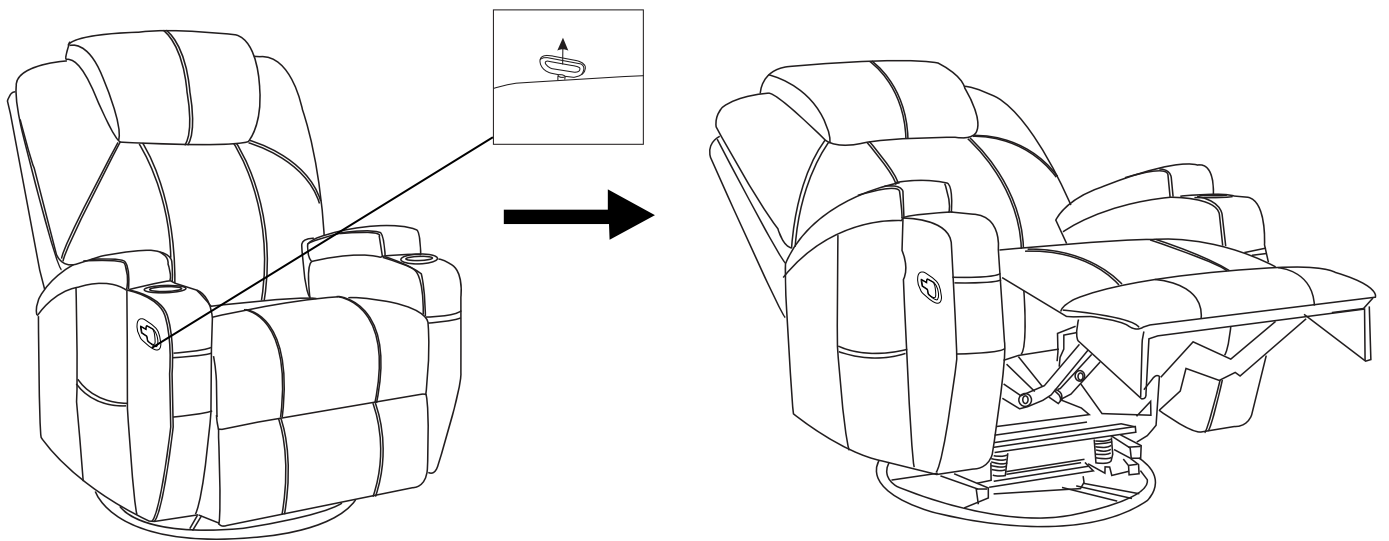

You can recline chair through pull the buckle at side, the footrest also can be extended when you pull the buckle.

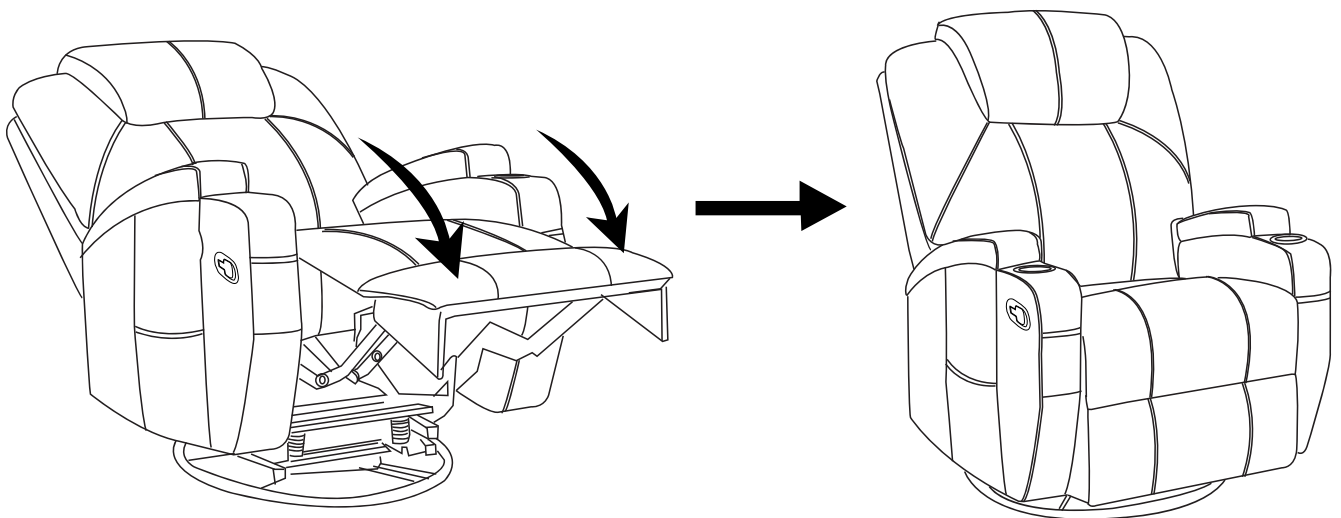

When you want to retract the footrest and resume the chair to sitting, you need to support the left and right armrests with both hands, and then buckle the footrest back to chair firmly with both feet.

Notice:

Children or people with limited mobility need to be accompanied by a guardian when they use the chair.

Massage Function

REMOTE CONTROL Function of remote

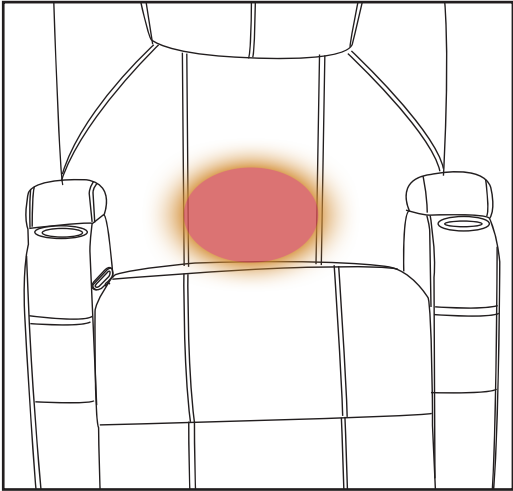
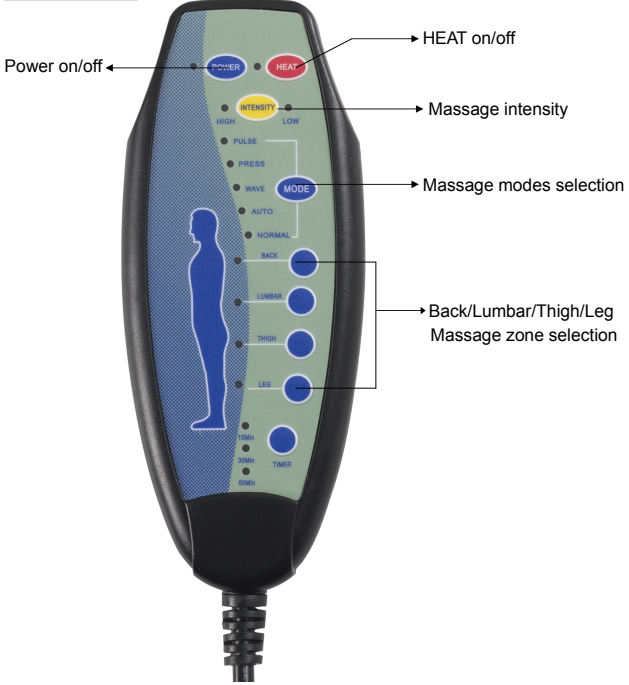

Waist heating

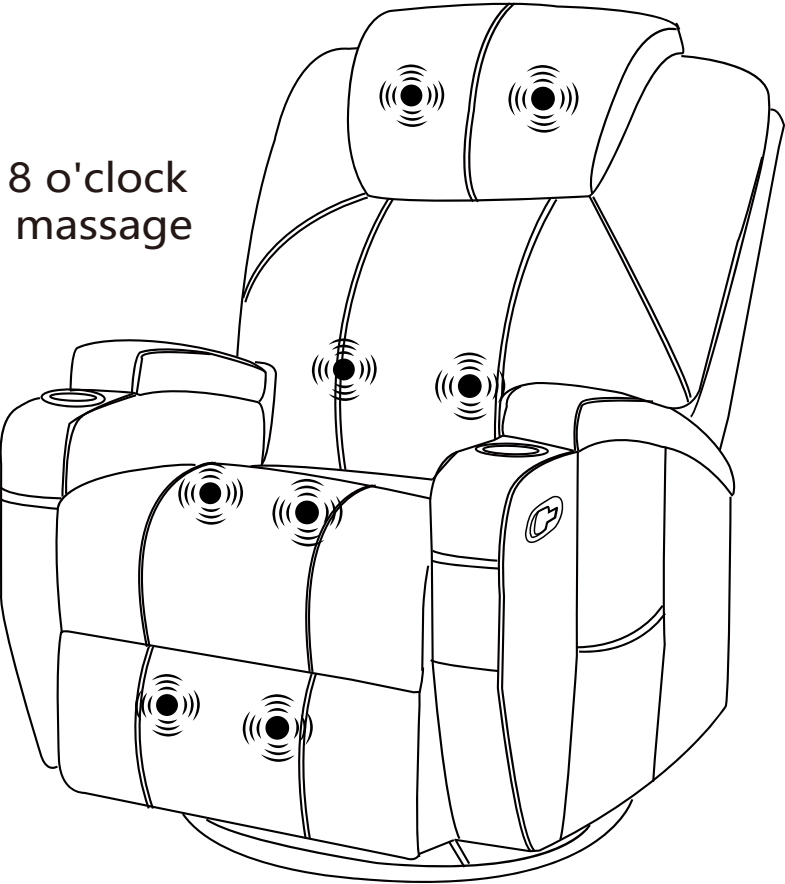

8 o'clock
massage

The eight points massage (back, lumbar, thigh, leg)