

Chair

IMPORTANT

Carefully remove all the parts from the carton and place them individually on a soft cloth to prevent scratches or other damage.

Carefully and strictly follow these assembly instructions to ensure a completed product as designed.

Do not use power tools above 8 volts to assemble.

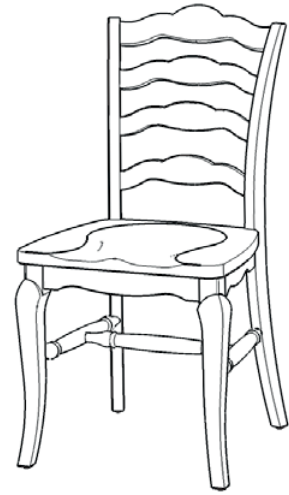

Part List

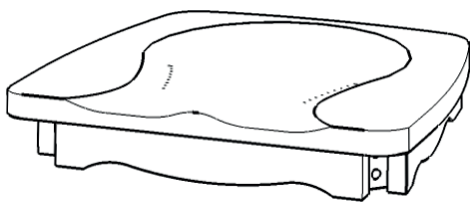

A.
Seat
1 pc.

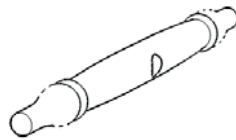

B.
Side Stretcher
2 pc.



C.
Center Stretcher
1 pc.



D.
Leg
1 pc.



E.
Leg
1 pc.

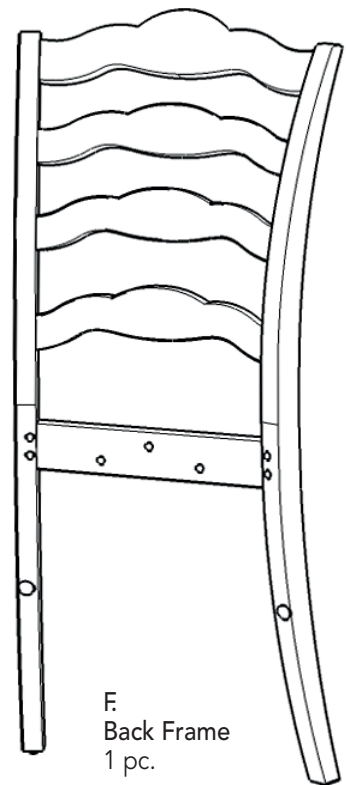

F.
Back Frame
1 pc.

Hardware List



Key Wrench
1 pc.



Small
Key Wrench
1 pc.



M3.5 x 40
Wood Screw
4 pcs. (+1 extra)



M6 x 40
Head Cap Bolt
(short)
3 pcs. (+1 extra)



M6 x 50
Head Cap Bolt
4 pcs. (+1 extra)



M6 x 70
Head Cap Bolt
(long)
4 pcs. (+1 extra)



Spring Washer
11 pcs. (+1 extra)



Flat Washer
11 pcs. (+1 extra)

Tool(s) required for assembly: Phillips screwdriver

Assembly Instructions 2/3

IMPORTANT

Use a soft cloth between these parts and the floor.
Do not use power tools above 8 volts to assemble.
Do not tighten all the bolts and wood screws until each part is properly assembled.
Keep Hex Wrench in a safe place as the bolts may need to be tightened up in the future.

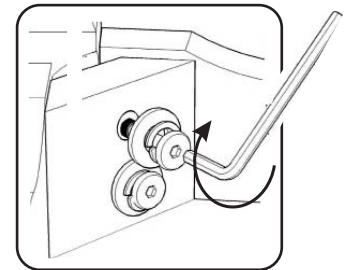
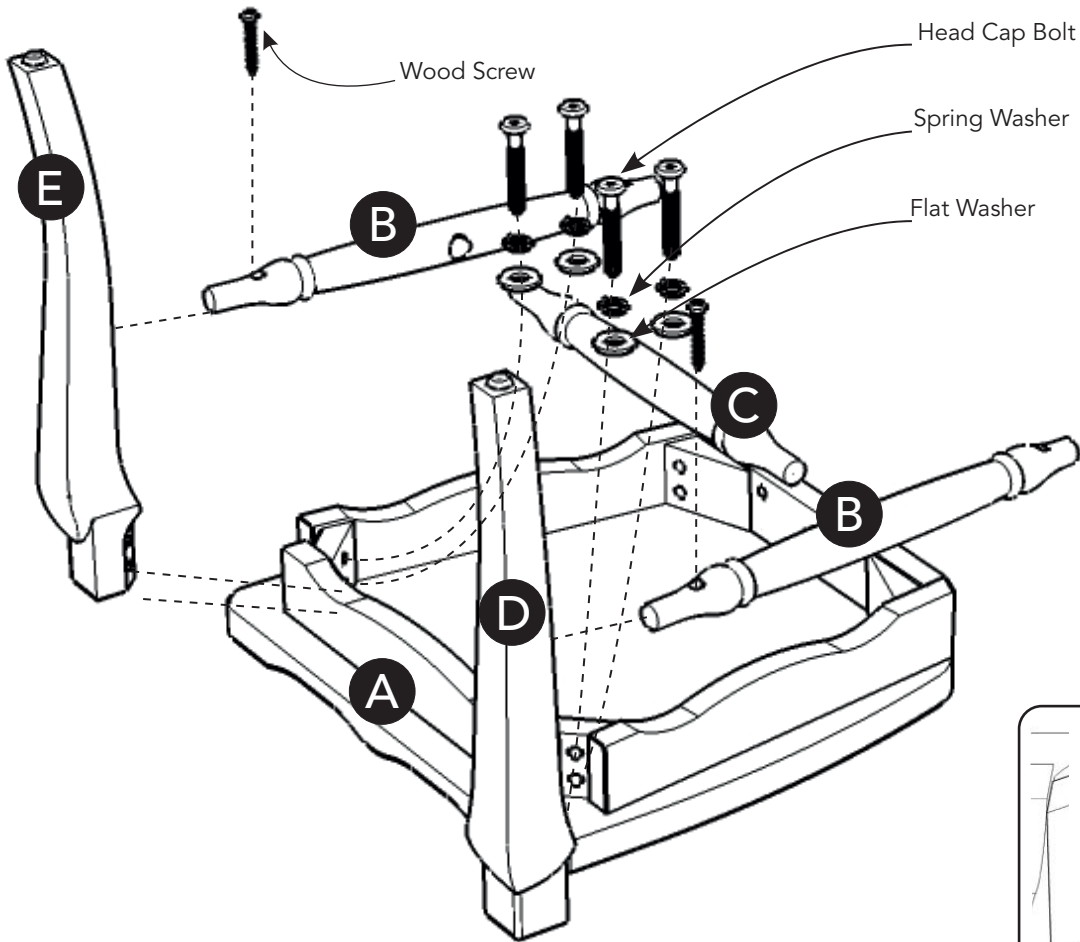

Figure 1

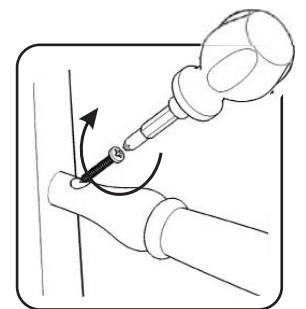

Figure 2

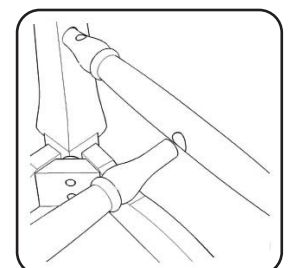

Figure 3

STEP 1

Attach Legs (D) and (E) to Seat (A) with Flat Washers, Spring Washers and Head Cap Bolts, tightening the bolts only half way.
(See Figure 1)

Attach Side Stretcher (B) to Leg (D) with Wood Screw.
(See Figure 2)

Slide the ends of Center Stretcher (C) into the pre-drilled holes in the middle of Side Stretchers (B).
(See Figure 3)

Attach Side Stretcher (B) to Leg (E) with Wood Screw.

Assembly Instructions 3/3

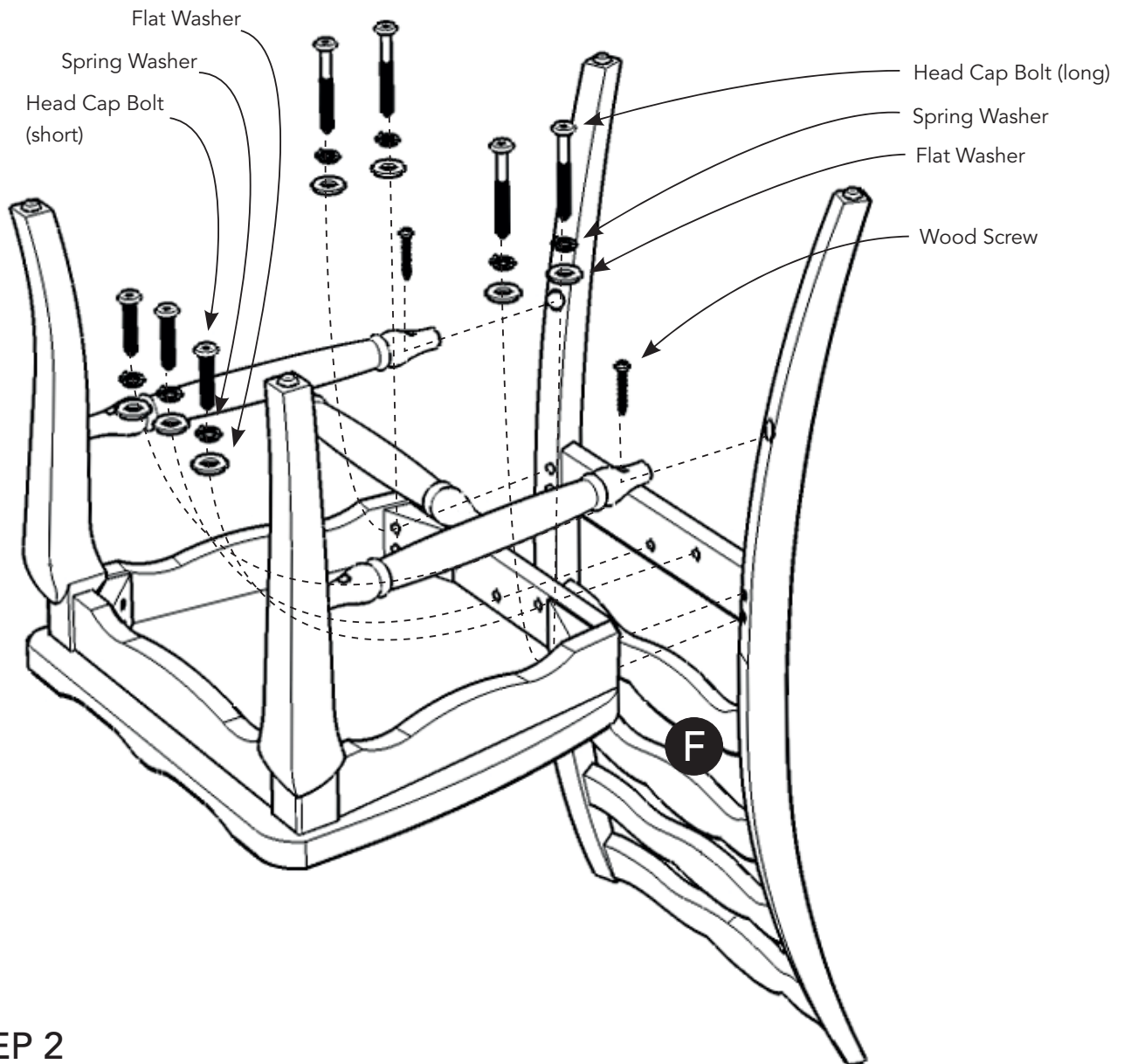

STEP 2

Attach Back Frame (F) to the unit with Flat Washers, Spring Washers, Head Cap Bolts (short), Head Cap Bolts (long) and Wood Screws, tightening the bolts only halfway. (See Figures 4 and 5)

Tighten bolts used in all steps.

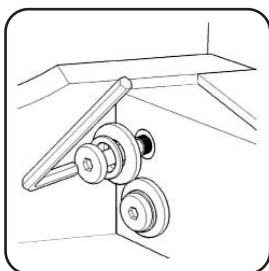

Figure 4

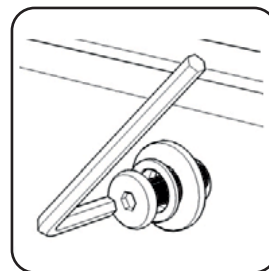

Figure 5

CARE INSTRUCTIONS

NEVER

allow liquids to remain on furniture.
Absorption causes parts to warp
and split and finishes to delaminate.

NEVER

use glass cleaners on
finished furniture. Ammonia
chemically attacks the finish.



Do not use power tools
above 8 volts to assemble.
**PREVENT
CRACKING**



Do not place
in direct sunlight.
**PREVENT
FADING**



Do not write
directly on surface.
**PREVENT
MARKING**



Do not place hot
objects on surface.
**PREVENT
FINISH DAMAGE**

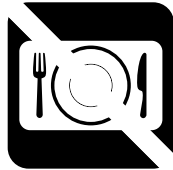

Do not use rubber
based placemats.
**PREVENT
DISCOLORING**



Do not use commercial
waxes and polishes.
**PREVENT
YELLOWING**

CLEAN

with a soft cloth moistened
in lukewarm soap and water.
Buff with a dry clean cloth.

