

MultiFlex Floor Magnifier Instructions

ASSEMBLING THE MAGNIFIER

Step 1

Remove protective washers from the poles.

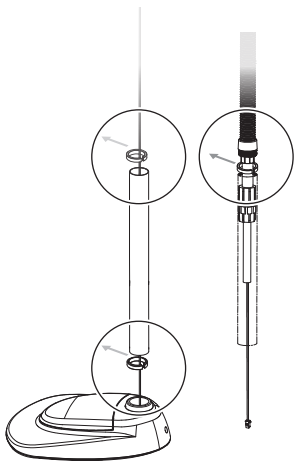

Step 2

2a. Screw the lower (long) pole clockwise into the base until fully tightened and securely attached.

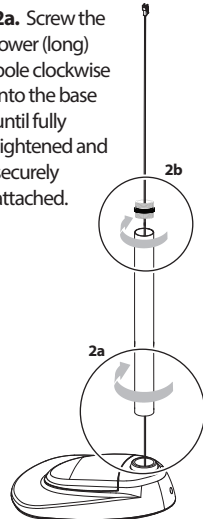

2b. Slide the wire through the threaded metal pole connector and hand tighten it.

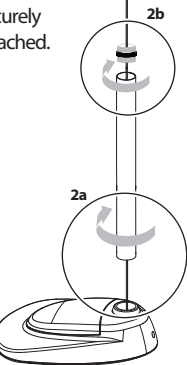

Note: Multiple rotations required.

Step 3

3a. Thread the power cord through the upper (short) pole and insert the flexible arm (Do not fasten! See step 4).

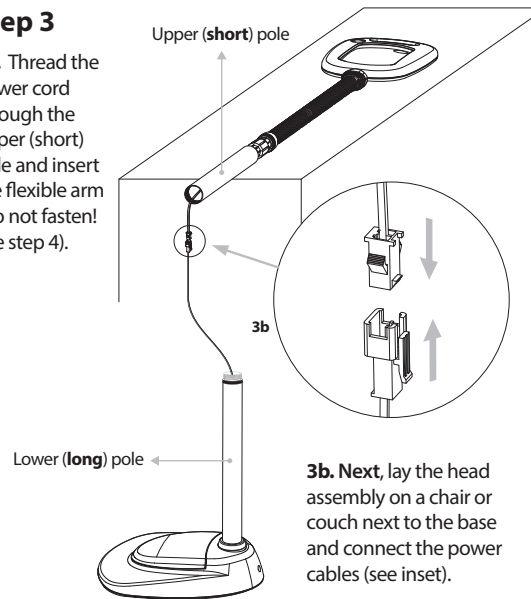
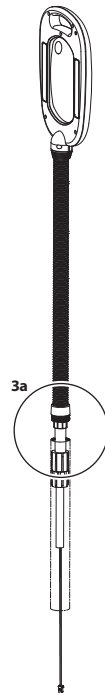

3b. Next, lay the head assembly on a chair or couch next to the base and connect the power cables (see inset).

Step 4

4a. Position the head assembly onto the base pole, inserting excess power cord into either pole.

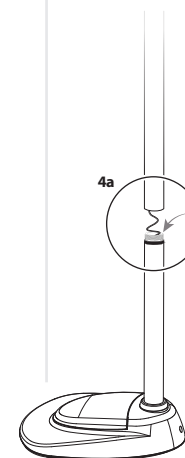

4b. Holding the upper pole in place, lift the flexible arm slightly (no more than 1") with your other hand and rotate the pole clockwise until it is securely attached (head should not turn).

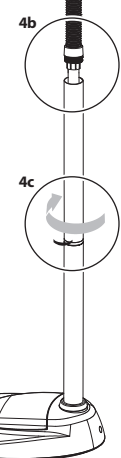

Align the magnifier head to face in the same direction as the base.

4c. Push the flexible arm back into the upper metal pole and screw the threaded joint clockwise back into the upper metal pole until it is tightened.

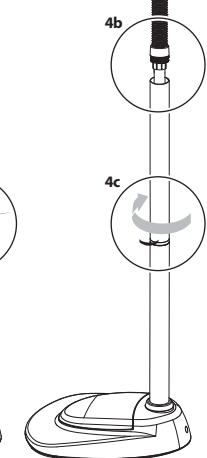

What's in the box

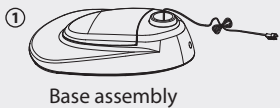

Base assembly

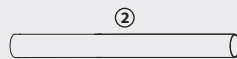

Lower (long) pole

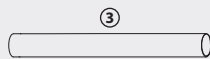

Upper (short) pole



Threaded pole connector



Magnifier head assembly



110v AC adapter

MultiFlex Floor Magnifier Instructions

INSERTING BATTERIES

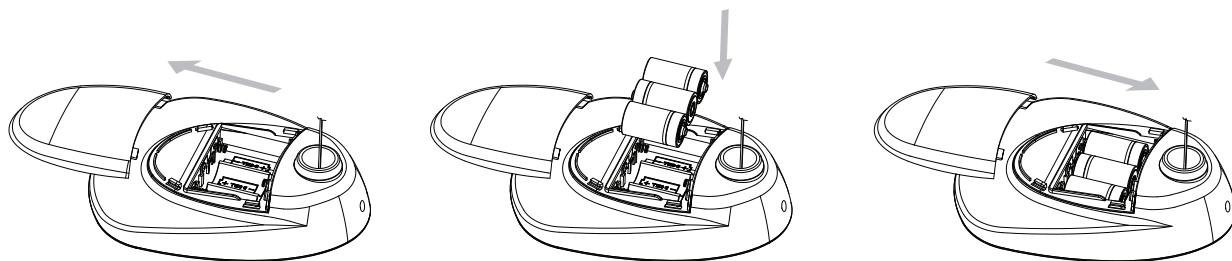

SPECIFICATIONS

Lamp	COB LED x 2 (6000K)	Lens Material	Acrylic
Lumens (high/low) – battery mode	200 - 20 LM	Magnification	
Lumens – 110v adapter	500 - 50 LM	• Lens	X2.5
Smart Dimmer	Variable memory setting	• Inset	X6
Battery Type	D Cell x3 (not incl)	Lens Dimensions	6" x 4"
AC Adapter	ETL#: 5003784	Magnifier Dimensions	11" x 9" x 53"
• Input	AC100 - 240 V, 50 - 60 HZ	Magnifier Weight	8.5 lb
• Output	5V DC, 2A		

USING THE AC ADAPTER

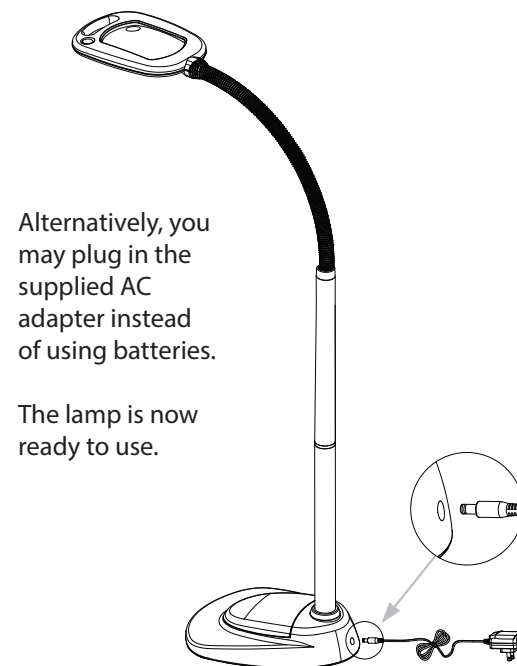

Alternatively, you may plug in the supplied AC adapter instead of using batteries.

The lamp is now ready to use.

No tools required

Operation

- Press power button to turn lamp on and off

Smart Dimmer

- Press and hold power button
- Light will flash once at highest setting and again at lowest
- Release power button at desired illumination level
- Smart dimmer will remember light level until it is reset

Assembly

Please review instructions carefully before assembling the magnifier. To avoid damage, perform all work on a carpeted or padded surface. If you have questions or need assistance, please contact us at:

Email: info@lighthitLED.com or

Phone: (503) 274-1227

Note : Remove all protective washers before installing the poles.

Care & Maintenance

- ✓ Clean magnifier with a soft, dry microfiber cleaning cloth
- ✓ If necessary, use an approved acrylic eyeglass cleaner
- ✗ Do not expose lens to direct sunlight (fire hazard!)
- ✗ Do not look directly into the light.
- ✗ Indoor Use only
- ✗ Do not mix battery types and use new batteries



Note : Using harsh chemicals or dirty cloths may scratch the lens.