

ASSEMBLY INSTRUCTIONS

E-mail: unchairofficial@gmail.com

If you encounter any problems during installation
or use, please feel free to contact us by email
and we do happy to help you.



MODEL NO(JX-8012)

NOTE:

If there is any issue with our chair, please contact After-Sales Support with your order number at unchairofficial@gmail.com, we will solve it for you immediately !



Executive Office Chair JX8012 Installation Video

No one is watching · 2 minutes ago

Best Office Chair

up to date

Search "Executive Office Chair JX8012 Installation Video" on YouTube Or through the link

<https://youtu.be/t2zo2NZ32as>

find the installation video to make your installation more convenient.

NOTE: When installing screws, please gently tighten the screws to the screw holes (do not completely tighten them). After all screws are installed to the corresponding screw holes, then completely tighten them one by one.

Components



ITEM	DESCRIPTION	QUANTITY
A	Leg	1
B	Backrest	1
C	Seat	1
D	Armrest	2
E	Seat Plate	1
F	Caster	5
G	Cylinder	1
H	Base	1
J	Screw (M6x20mm)	10
K	Screw (M8x25mm)	4
L	Screw (M8x30mm)	8
N	Screw (M6x25mm)	2
O	T Allen Wrench	1
P	Decoration Cap	8

Hardware



step 1.

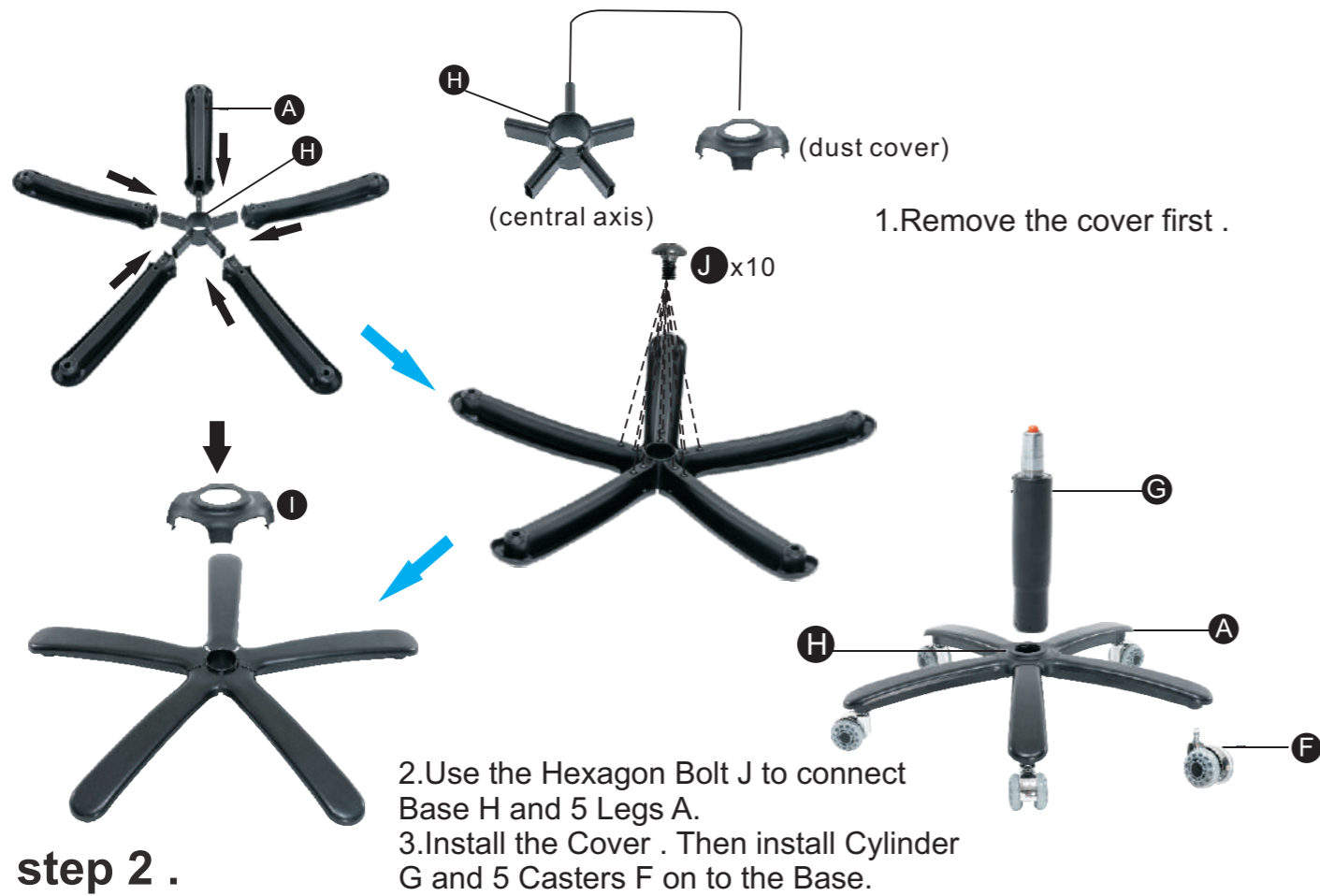

step 2.

For rear screw hole

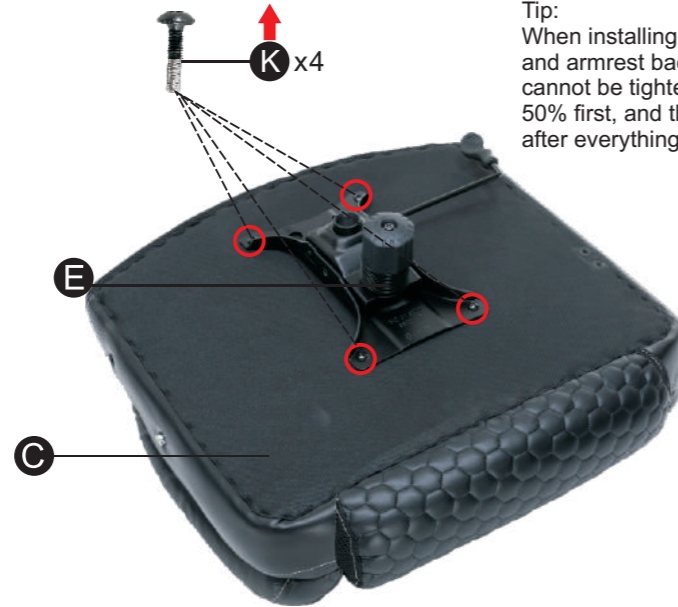

4. Use the Hexagon Bolt K to connect Seat Plate E and Seat C.

step 3.



step 4.

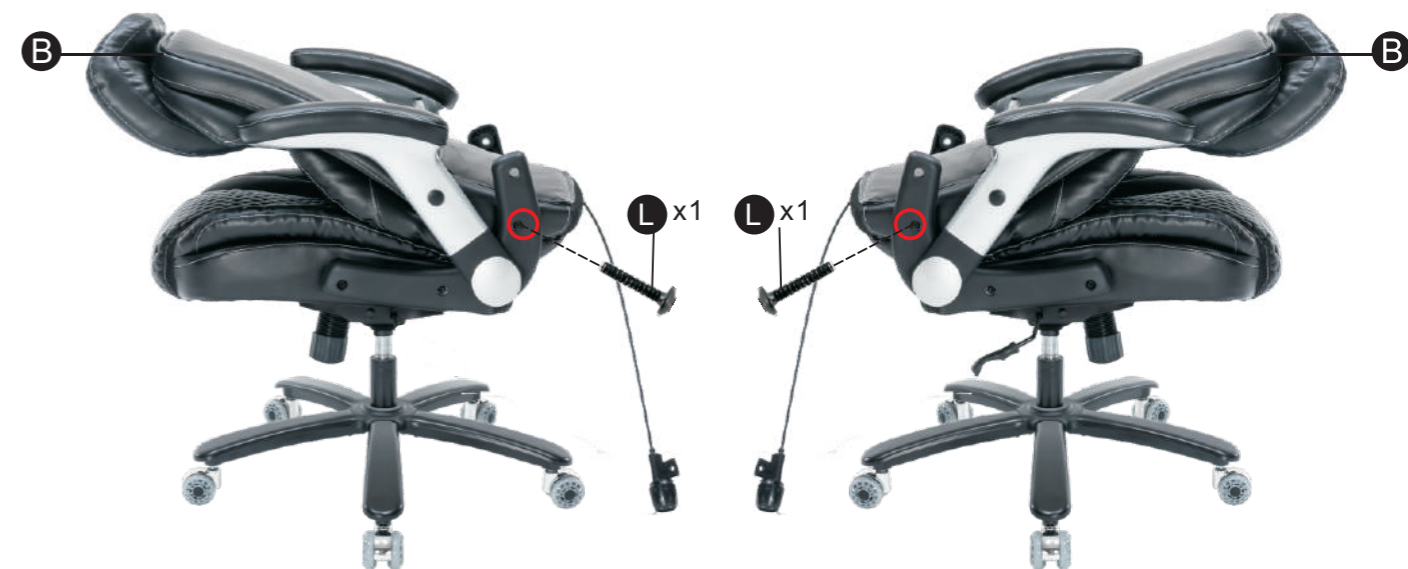

7. Put down the Backrest. Use the Hexagon Bolt L to connect Backrest B and Seat. (Install the screw holes near the armrest first. Do not tighten the screws.)

step 5.



8. Pull up the backrest. Use hexagonal bolts L to connect backrest B and seat.
(Install the screw hole near the outside)



9. Install the lumbar support rotating button under the chair with hexagonal bolts N.



step 6.



10. Install Cover B to the screw hole next to the armrest.

Function

Adjustable Armrest:

The armrest can be flipped up 90 degrees for easy storage, or press the button to adjust armrest height, adjustable height range of 2.56 inches.

Lumbar Support:

The rotating knob that adjusts the lumbar region of the chair to protrude forward, providing support tailored to different heights of individuals' lower backs. This feature helps maintain proper spinal alignment and comfort during extended periods of sitting.

Rocking Mode:

Pull out the lever to enter rocking mode with the backrest. Push in the lever to lock the backrest to 90°

Adjustable Height

An adjustable height range of 3.94 inches, support shoulder & back relaxation. You can adjust the height by pulling up on the proper lever if you are already in the chair.



Adjustable Headrest:

Hold both ends of the headrest with your hand, lift the headrest up or press the headrest down to adjust the height (adjustable height range of 3.15"), provide head support for people of different heights.

Tension Device

Support the rocking function
When you sit on the chair
Twist clockwise to loosen
Twist anticlockwise to tighten

Q&A

Q: Does the chair have a warranty? What if parts are missing or damaged?

A: Dear customer, we have 5-year warranty. If there are problems such as missing parts, product damage, or other unsatisfactory issues, please feel free to contact us.

Customer Service Email: unchairofficial@gmail.com

Q: How to adjust the seat height?

A: When you sit on the chair. To raise the seat height, please lift your body slightly while lifting the adjustment lever. To lower the seat height, please increase the pressure down on your body while lifting the adjustment lever.

Q: How to adjust the tightness of the backrest?

A: When you are taking a rest. Loosen the tension knob (under the seat), pull out the adjustment lever, and you can turn on the rocking mode. Lean back, and the backrest angle swings from 90° to 110°.

When you are working, you can push in the adjustment lever to lock, keeping the backrest angle at 90°

Q: If you feel the seat cushion is a little hard when you receive the chair.

A: Because of the compression of the packaging, there is gas inside the cushion, and you can press the cushion with your hands, and the cushion will become soft.