

# INSTALLATION INSTRUCTIONS

---

## Bathroom Wall Cabinet

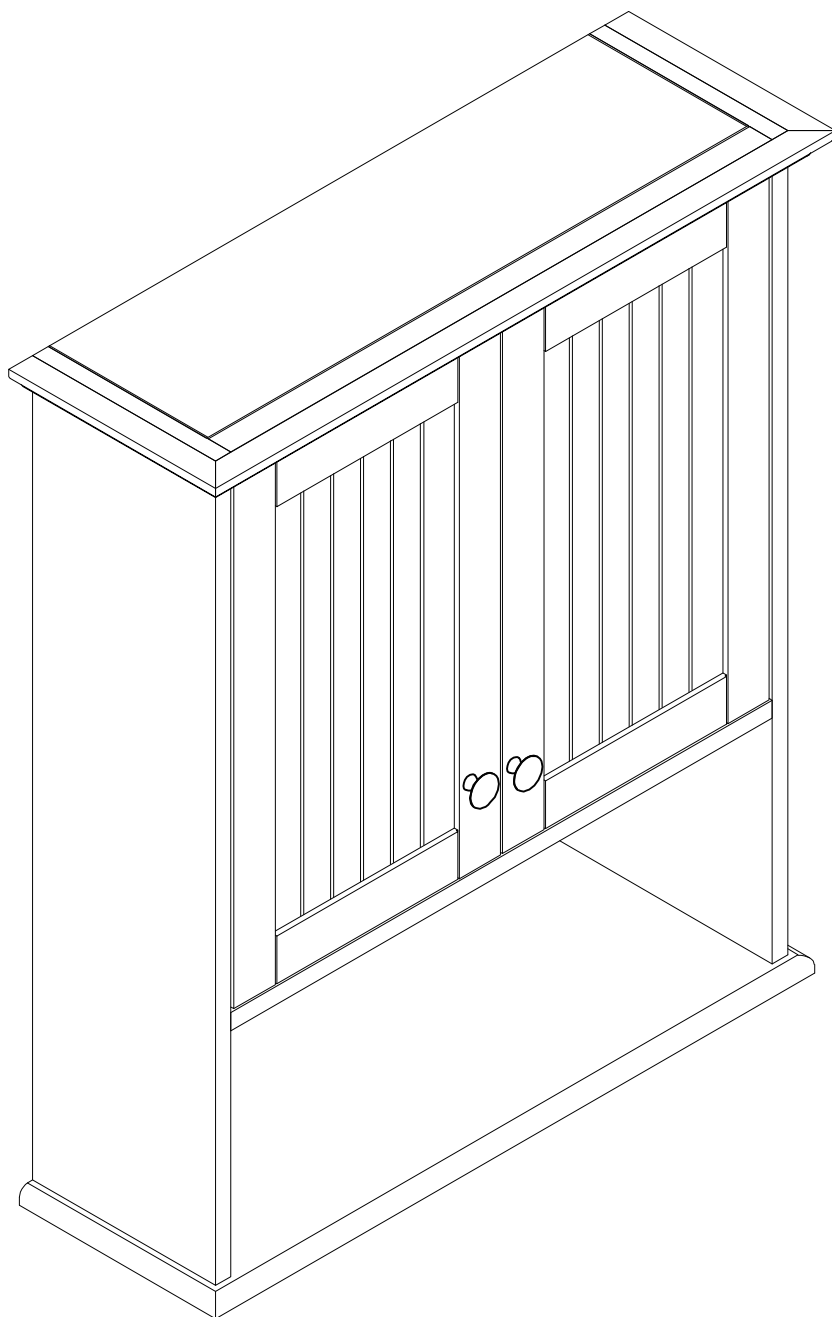

Drawings may not accurately depict product contours.



## Prior to Installation:

- **Ensure all necessary accessories are included. If any parts are missing, contact us immediately.**
- **Due to the size and weight of the cabinet, we recommend that two adults handle it on a carpeted or padded area in the intended room.**
- **Only use the tools provided or recommended in these instructions.**

### **General Recommendations:**

Spend a few moments familiarizing yourself with this manual before proceeding with the instructions. Always use the appropriate tools and wear necessary safety gear to protect yourself.

# INSTALLATION INSTRUCTIONS

## PRODUCT DIMENSIONS

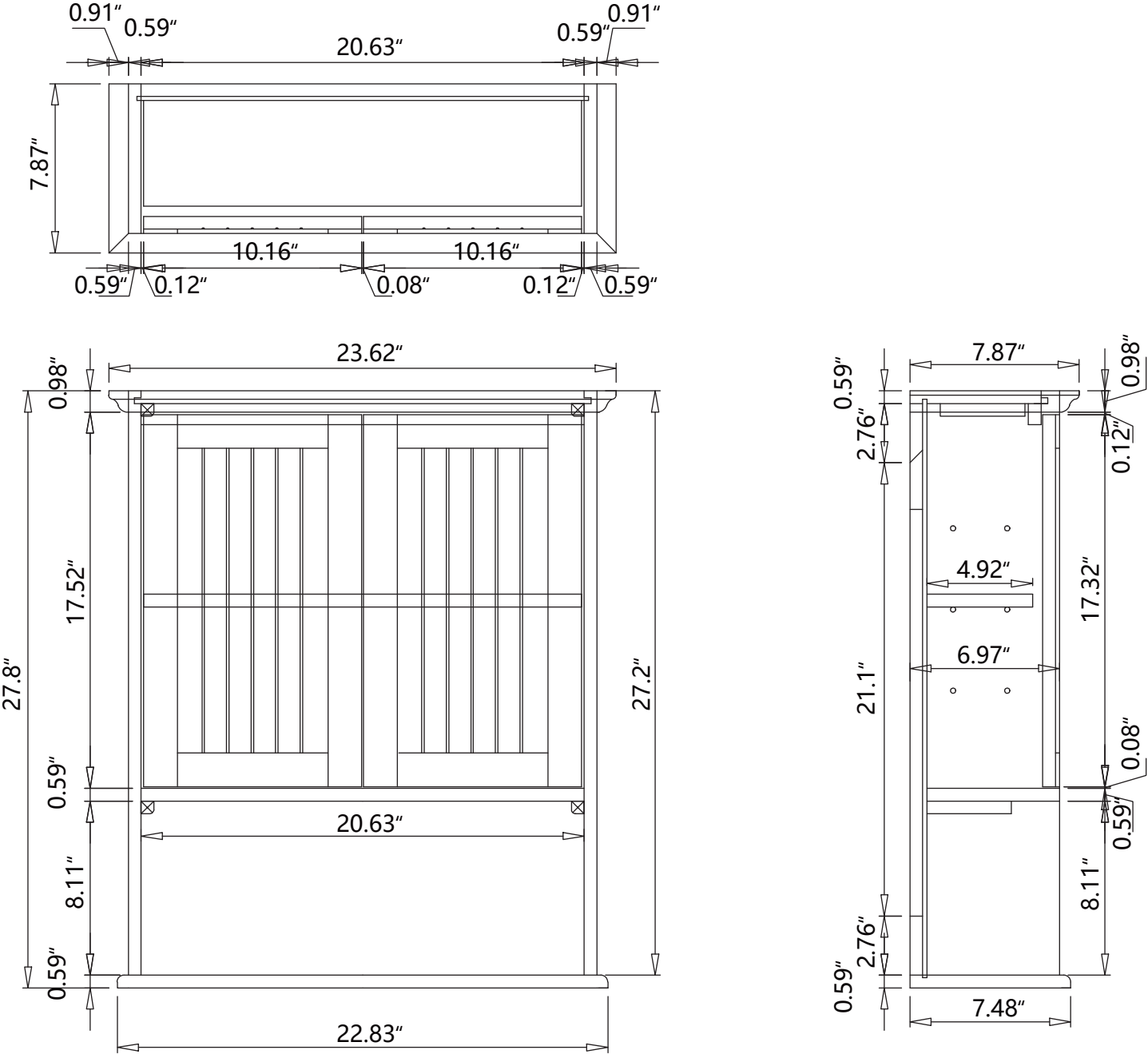

# INSTALLATION INSTRUCTIONS

## INSTRUCTIONS

### ● Recommended Tools

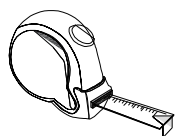

Tape measure



Pencil

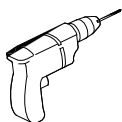

Electric screwdriver

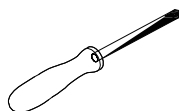

Screwdriver

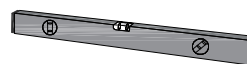

Level

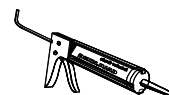

Caulking gun

### ● Installation Steps

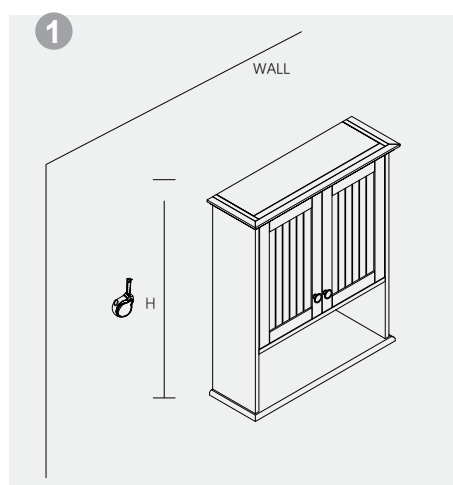

Measure the height (H) of the cabinet and the wall where the cabinet is to be installed. Mark the location with a pencil.

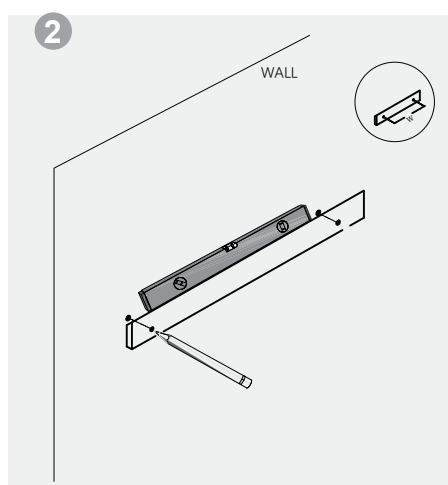

Position the bracket on the wall at the marked height. Use a level to make sure it's straight. Mark the screw locations through the holes in the bracket.

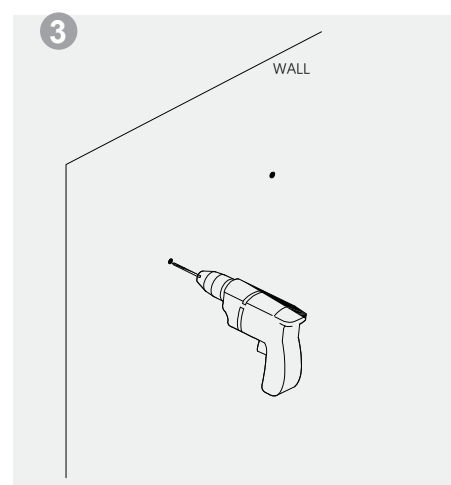

Use the electric screwdriver to drill holes at the marked positions for the screws.

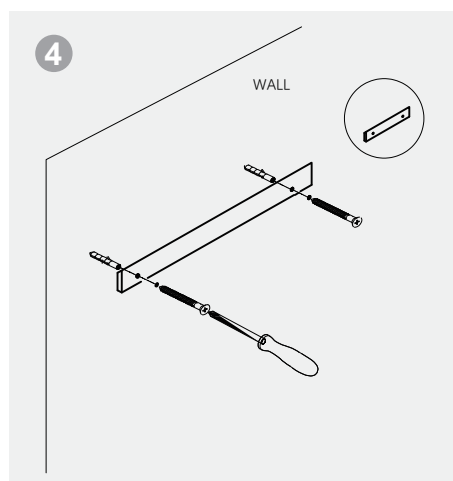

Secure the mounting bracket to the wall with screws.

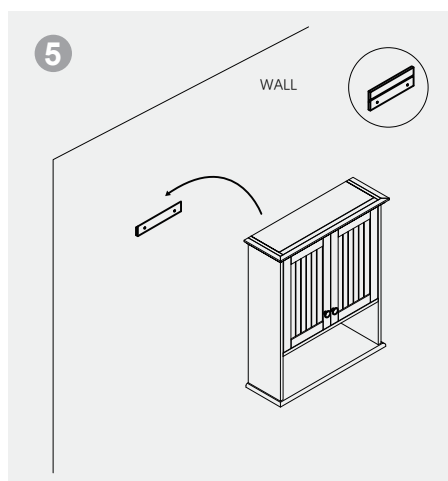

Carefully lift the cabinet, align it with the bracket on the wall, and securely hook it in place.

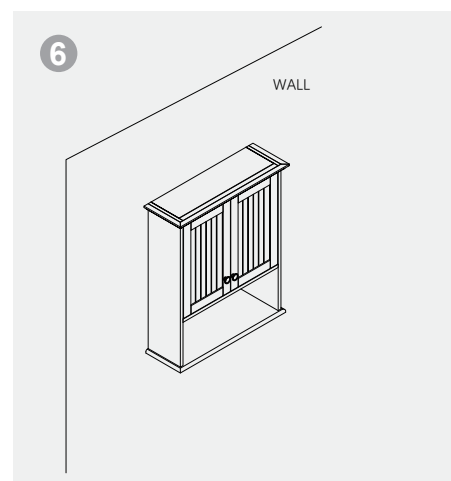

After placing the cabinet, check if it's level and adjust if needed to make it straight and secure.

Drawings may not accurately depict product contours.

# INSTALLATION INSTRUCTIONS

---

## CABINET CARE GUIDE

- **Regular Dusting:** Use a soft, dry cloth to dust the exterior and interior surfaces regularly.
- **Wipe with a Damp Cloth:** For routine cleaning, wipe the cabinet with a damp cloth. Ensure the cloth is not too wet to avoid damaging the finish.
- **Mild Detergent:** For stubborn stains or dirt, mix a small amount of mild detergent with water, dampen a cloth with the solution, and gently wipe the affected areas. Rinse with a clean, damp cloth afterward.
- **Avoid Harsh Cleaners:** Do not use abrasive cleaners, bleach, or strong chemicals as they can damage the cabinet's finish.
- **Dry Immediately:** After cleaning, always dry the cabinet with a soft, dry cloth to prevent moisture damage.
- **Check Hardware:** Periodically check and tighten any loose screws or brackets to ensure the cabinet remains securely mounted.
- **Avoid Excess Weight:** Do not overload the shelves with heavy items to prevent damage or warping.

Drawings may not accurately depict product contours.