



Outdoor
Living Today

ASSEMBLY MANUAL

6x3 Garden Chalet

Stock Code:

GGC63-FJ-CEDAR

GGC63-FJ-METAL

Version #28.8

Nov 4, 2025



CONTACT

ADDRESS

9393 287th Street,
Maple Ridge, British Columbia,
Canada V2W 1L1

PHONE & FAX

Toll Free: 1-888-658-1658

Fax:

ONLINE

Email: olmsupport@outdoorlivingtoday.com

Web: www.outdoorlivingtoday.com

What You Need to Know

Thank you for purchasing a 6x3 Garden Chalet

Please take the time to identify all the parts prior to assembly.

IMPORTANT INFORMATION

It is the sole responsibility of the customer to check with your local municipal or county by-laws before ordering this product to confirm it complies with building codes in your area.

If the product is elevated, any structural and building code requirements are solely the customer's responsibility, and should be abided by.

Snow load ratings vary by geographical location. If heavy or wet snowfall occurs, it is advisable to sweep snow off roof frequently. In areas with high or gusty wind conditions, it is advisable to install the structure securely to the ground.

Have a regular maintenance plan to ensure screws, doors, windows and parts are tightly affixed.

All structures purchased from Outdoor Living Today are covered for a period of one year for defects in manufacturing and workmanship. Costs incurred for customer installations are not included.

Failure to use supplied parts included in this kit could result in poor product performance and may void your warranty. Please contact Outdoor Living Today's Customer Toll Free Line if you plan to deviate from our written instructions.

Warranty

In the event of a missing or broken piece, please contact Outdoor Living Today **Customer Support at olmsupport@outdoorlivingtoday.com within 30 days of the delivery of your purchase.** It is our commitment to you to courier replacement parts, free of charge, **within 10 business days of this notification.** Replacement parts will not be provided free of charge after the 30 day grace period.

Customer agrees to hold Outdoor Living Today and any Authorized Dealers free of any liability for improper installation, maintenance and repair.

What to do Before my Shed Arrives?



Become familiar with this assembly manual and determine if you can complete the project yourself or will require a professional contractor.



One helper is recommended to assist in constructing your chalet. It generally takes two people less than a day to assemble a chalet. If you're hiring a contractor, their rate should be in line with that duration of work.



Clear the construction area and ensure a clear pathway for delivery when the freight company arrives. Remove all debris: roots, grass, rocks, etc.



Excavate the site. Contact your local utilities company to ensure there are no gas or electric lines buried in the area before digging.

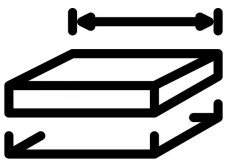

Decide on the type of foundation you will be using:
- Concrete slab, or
- 4-6 inches of crushed gravel with paver stones or 4x4 stringers.

You can find the footprint for your shed on Page 3 of your Assembly Manual.

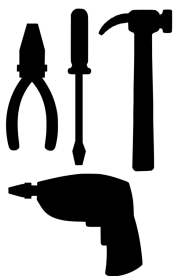

If doing the assembly yourself, have all the necessary tools ready to go and in working condition. A list of required tools can be found after the parts list.

Foundation Types for 6x3 Garden Shed

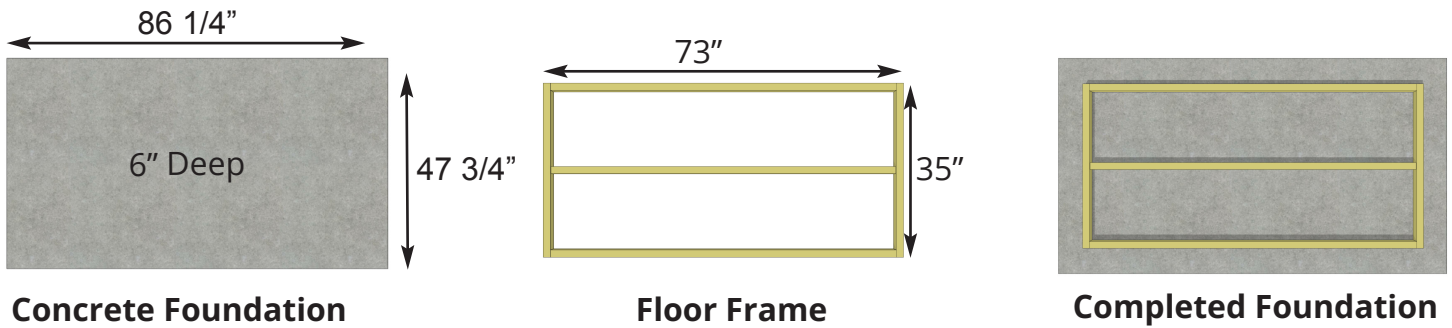

Concrete Slab Foundation:

- Slab must be at least the same size as assembled floor frame (35" x 73") or larger.
- 6" Deep foundation.
- 0.6 Cubic Yards of concrete required.
- A concrete slab will have the longest durability out of your foundation options.

Once level, a concrete slab is the easiest surface to build on.

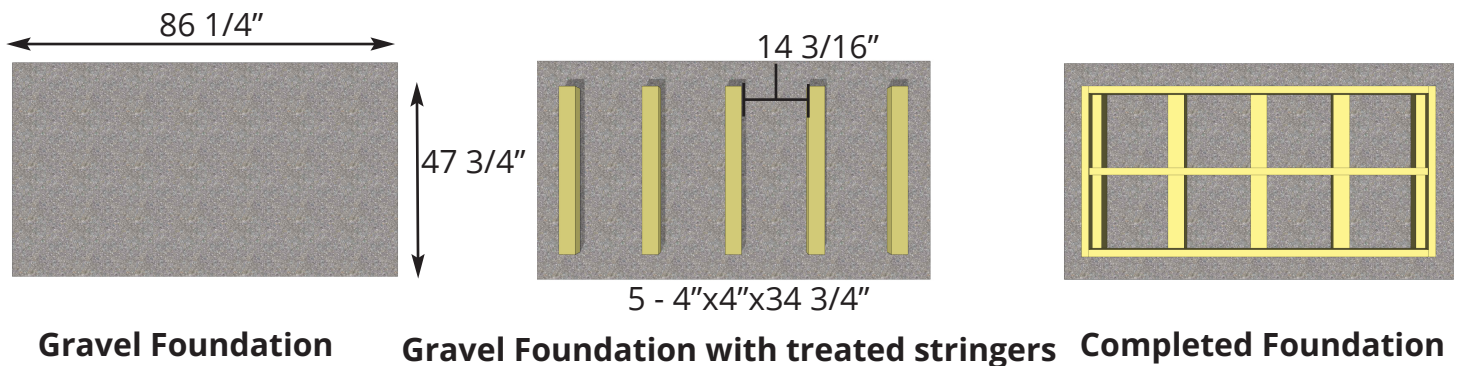

Gravel with 4x4 Pressure Treated Stringers:

- Excavate at least 6" deep, and 6" wider than floor frame on each side.
- 0.6 Cubic Yards of gravel required, approximately 6 wheelbarrows.
- 5 - 4x4 Pressure Treated Stringers 34 3/4" long required.
- Evenly spaced, with one at each end of floor frame.

Saves money on materials, easy to level and work with.



Gravel with Patio Paver Stones:

- Excavate at least 6" deep, and 6" wider than floor frame on each side.
- 0.6 Cubic Yards of gravel required, approximately 6 wheelbarrows.
- 8 patio pavers (8" x 8" or larger).
- Center patio paver stones underneath floor runners and underneath seams in floor joists.

Patio paver stones are widely available from most landscape stores.

Thank you for purchasing our 6x3 Grand Garden Chalet. Please take the time to identify all the parts prior to assembly.

Parts List	Steps	D. - Trim / Misc. Section Cont.	
A. - Floor Section Floors 1 - Floor Section - 35" x 73" 1 - Mid Floor Joist - 1 1/2" x 2 1/2" x 70" (Floor Joist may be pre installed)	A1	Outer Wall Trim and Fascia 2 - Horizontal Trim - 1/2" x 2 1/2" x 75 1/2" 2 - Side Fascia Trims - 1/2" x 2 1/2" x 36 7/8" - Angle Cut Ends 2 - Metal Drip Edge - 60" 2 - Rear Wide Corner Trims - 1/2" x 3 1/2" x 70 3/8" 2 - Rear Side Corner Trims - 1/2" x 2 1/2" x 70 3/8" - Angle Cut End 2 - Front Wide Corner Trims - 1/2" x 3 1/2" x 65 1/4" 2 - Front Side Corner Trims - 1/2" x 2 1/2" x 65 1/2" - Angle Cut End 1 - Rear Center Trim - 1/2" x 2 1/2" x 70 3/8" 2 - Vertical Door Frame Trim - 1/2" x 2 1/2" x 64 1/4"	D7 - D14
B. - Wall Section Main Wall Panels 4 - Rear/Side Walls - 35" x 63 1/4" 4 - Wall Plates - 1 1/2" x 1 1/2" x 35" 2 - Front Narrow Walls - 12 1/2" x 61 3/4" Header/Wall Extenders 1 - Front Header - 1 1/2" x 1 1/2" x 70" 1 - Interior Door Header - 1 1/2" x 1 1/2" x 44 7/8" 2 - Left/Right Side Angle Gables - 6 1/2" x 35" 2 - Wall Extenders - 6 1/4" x 35" 1 - Front Top Plate - 1 1/2" x 1 1/2" x 70" Shelves 2 - Storage Shelf Supports Short - 3/4" x 2 1/2" x 12 1/2" 2 - Storage Shelf Supports Long - 3/4" x 2 1/2" x 35" 2 - Storage Shelves - 1 1/2" x 31 7/8"	B1 - B10 B11 - B22 B23 - B24	Door System 1 - Door Threshold (Bevel) - 1/2" x 2 5/8" x 44 7/8" 2 - Left/Right Doors - 22 1/4" x 61 3/8" 1 - Door Flange - 1/2" x 2 1/2" x 61 3/8" 4 - Interior Vertical Door Stops - 3/4" x 3/4" x 29 7/8"	D15 - D19
C. - Cedar Roof Section Roof 1 - Cedar Shingle Roof Panel - 39 1/2" x 78 1/4"	C1 - C2		
C. - Metal Roof Section Roof 3 - Metal Roof Panels - 39" Length 3 - Battens - 3/4" x 3 1/2" x 73" 4 - Batten Spacers - 3/4" x 1 1/2" x 12 3/8" 6 - Foam Enclosures	C1 - C9		
D. - Trim / Misc. Section Lower Skirting 4 - Lower Skirting - 1/2" x 2 1/2" x 35" 2 - Front Skirting Short (2 - 1/2" x 2 1/2" x 12 3/4") Long (1 - 1/2" x 2 1/2" x 47 1/2") Filler Trim 8 - Front/Rear Filler Trims - 3/4" x 1 1/2" x 30" 1 - Header Finish - 3/4" x 2 1/2" x 69 1/2"	D2 D3 - D6	E. - Roof Cap Section Roof 2 - Roof Ridge Caps - 1/2" x 3 1/2" x 39 1/4"	E1
		E. - Metal Cap Section Roof 2 - Metal Peak Cap - 60" 1 - Metal Roof Edge Trim - 96"	E1 - E2
		Note: We recommend you drill a 1/8" pilot hole for each screw to avoid splitting wood. The hole depth should be equal to 3/4 the length of screw. ** Plus 2 Cedar Shingle Shims - discard after shimming doors	

Note: Trim and Skirting pieces are graded with the best face being rough sawn. Rough sawn cedar is much easier to paint and stain.

6x3 Garden Chalet Hardware Sheet

Hardware Kit (Provided)

2 1/2" Brown Screw

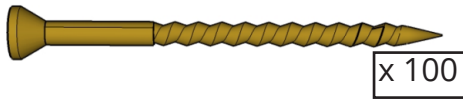

1 1/2" Bolt with Nut and Washer



1 1/4" Brown Screw

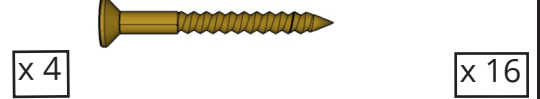

1" Silver Screw



3/4" Silver Screw



2" Blackheaded Screw



3/4" Blackheaded Screw



1 1/2" Finishing Nail

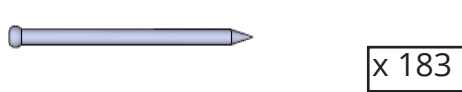

Square Drive Bit

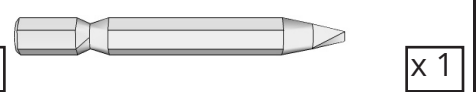

2 1/2" x 2 1/2" Plywood Spacer



Door Handle



Tee Hinge



Barrel Bolt

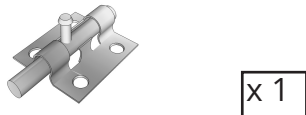

Drop Latch



Hardware Kit - CEDAR ROOF (Provided)

2"  x 15

1 1/2"  x 12



90° Metal Brackets
x 2

Hardware Kit - METAL ROOF (Provided)

1 1/4"  x 29

 x 1
Silicon Caulking

1/4" x 1 1/2"  x 14
Metal Roof Screw

 x 1

Tools Required (Not Provided)

Hammer



Screw Gun/Drill

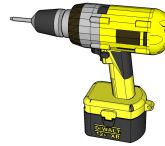

Tape Measure



Wood Clamp



Caulking Gun



Level

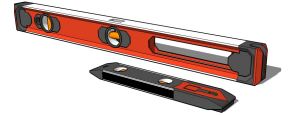

Pliers



Ladder



1/8" & 3/8" Drill Bits

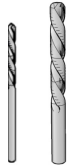

Safety Equipment Required (Not Provided)

Safety Glasses



Work Gloves



in Assembly Manual shows instructions for the Garden Chalet with Painters Choice (FJ) Siding and 2 different roof options. Please proceed to correct roof section depending on your selected roof type after rafter installation.



Regular Maintenance & Tips to Prolong the Life of Your Shed.

Before/During Assembly:

- 1.) Paint each face and edge of your plywood floor with a latex exterior paint.
- 2.) Caulk wall seams if gaps appear.
- 3.) Caulk around window framing (if applicable).
- 4.) Caulk perimeter between floor plywood and bottom wall plate.
- 5.) Caulk channels in lap siding at the top of your door above the trim, just a drop in each channel.
- 6.) Caulk edge of door threshold (if applicable).
- 7.) Optional: Install a Sill Gasket between floor runners and foundation.
- 8.) Optional: Install an 8" strip of roofing paper below Cedar Ridge Caps for Cedar Roof Sheds.

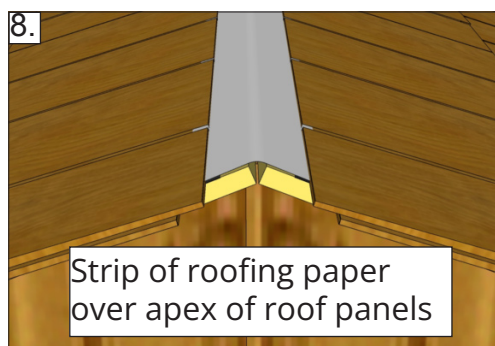
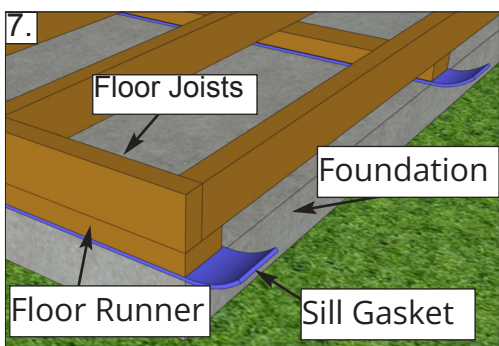
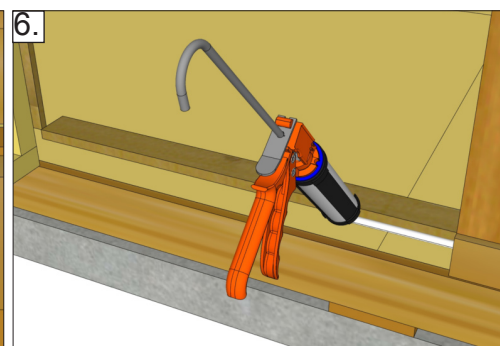
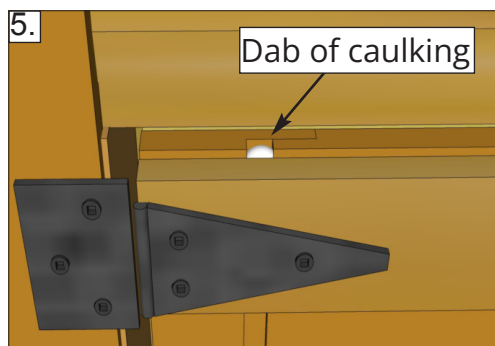
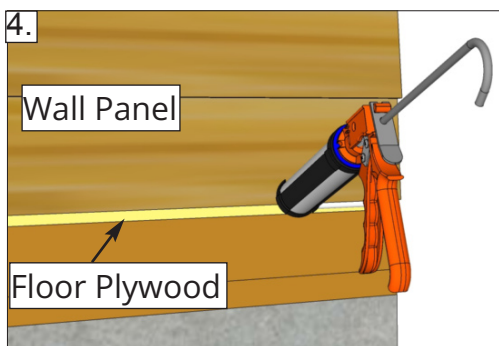
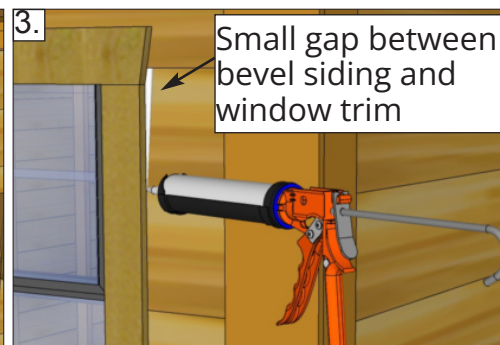
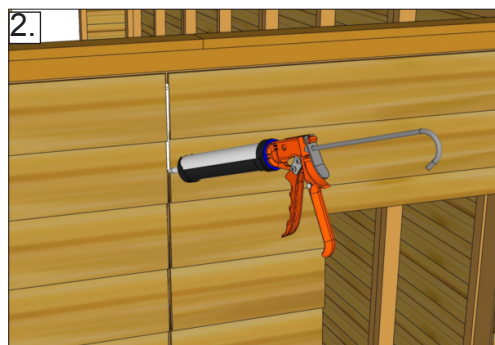
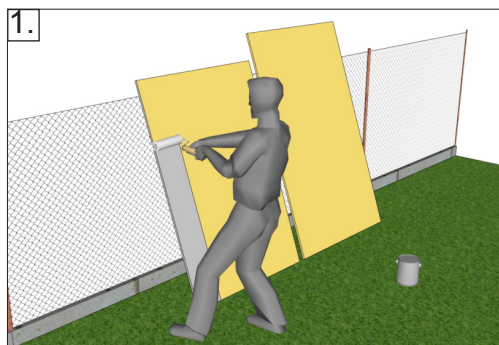

Routine Maintenance:

- Routinely check all fasteners are tight (ex. Door Hinges, Nails)
- Brush off dirt from walls.
- Brush off snow from roof regularly.
- Routinely remove needles and leaves from roof.

Painting/Staining

- Your cedar shed, if left untreated, will weather to a silvery grey colour.
- Painting or staining your structure is highly recommended and will prolong the life of your shed.
- You do not need to wait to paint or stain your shed, the wood in your kit has been dried and can be stained or painted immediately.
- Consult your local paint store for the best paint or stain for cedar.
- Optional: stain the inside of your shed. (Note: this will remove the fresh cedar smell.)

A. Floor Section

Exploded view of all parts necessary to complete the Floor Section.
Identify all parts prior to starting.

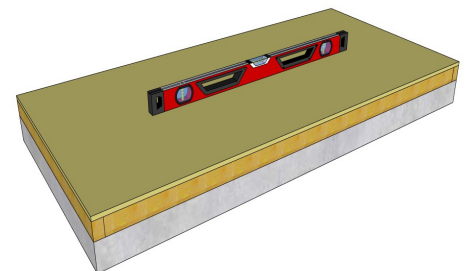
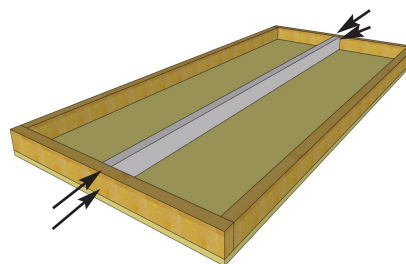
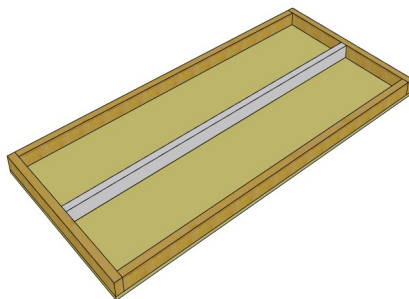
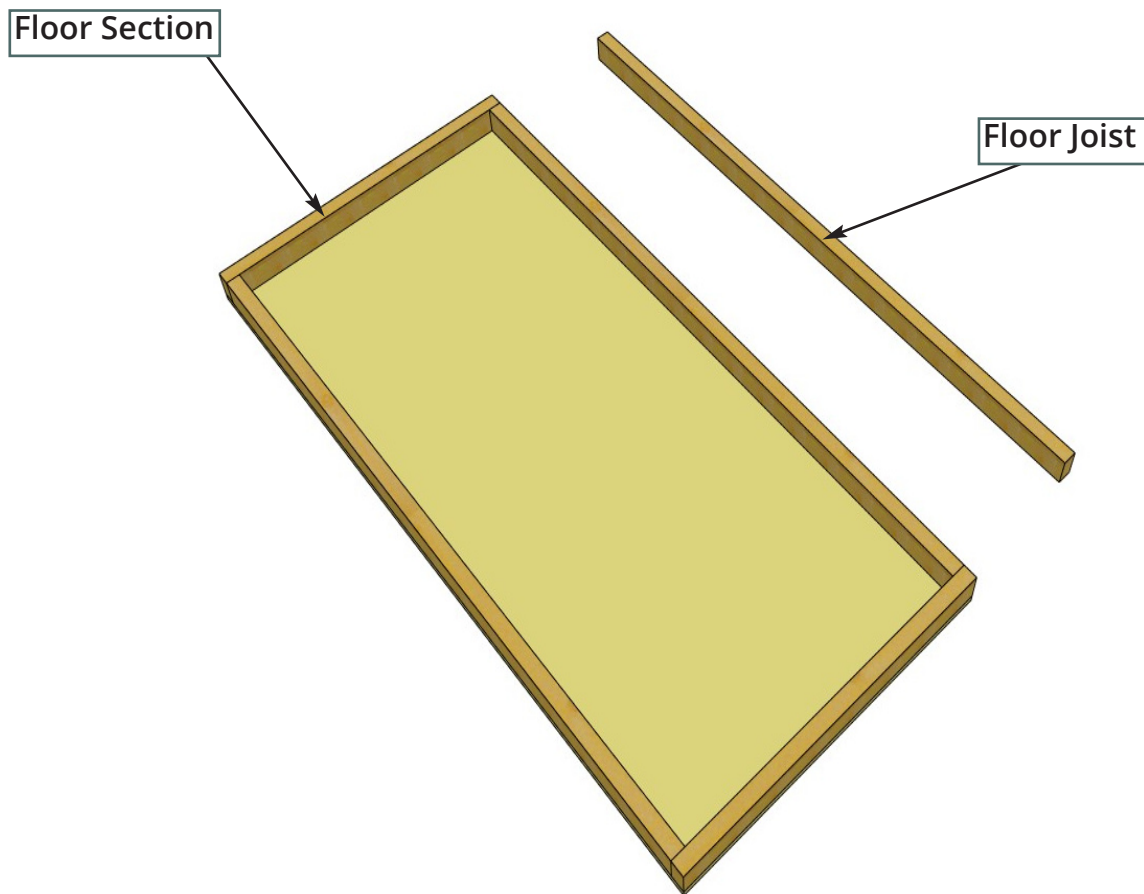

A1. Locate **Floor Joist** and position at center of **Floor Section** and flush with framing as illustrated above. Attach with **2 - 2 1/2" Brown Screws** per end. Flip over and lay Floor Section on a level foundation only. Patio Stones or a Concrete Slab both make excellent foundations. (See **Page 4** for more information on foundations). Use a level to confirm and shim Floor Joist as required. **On some units floor joist may come pre-installed**

Parts
Floor Joist
(1 1/2" x 2 1/2" x 70") x 1
Floor Section
(35" x 73") x 1

Hardware
2 1/2" Brown Screws
x 4 total

B. Wall Section

Exploded view of all parts necessary to complete the Wall Section.
Identify all parts prior to starting.

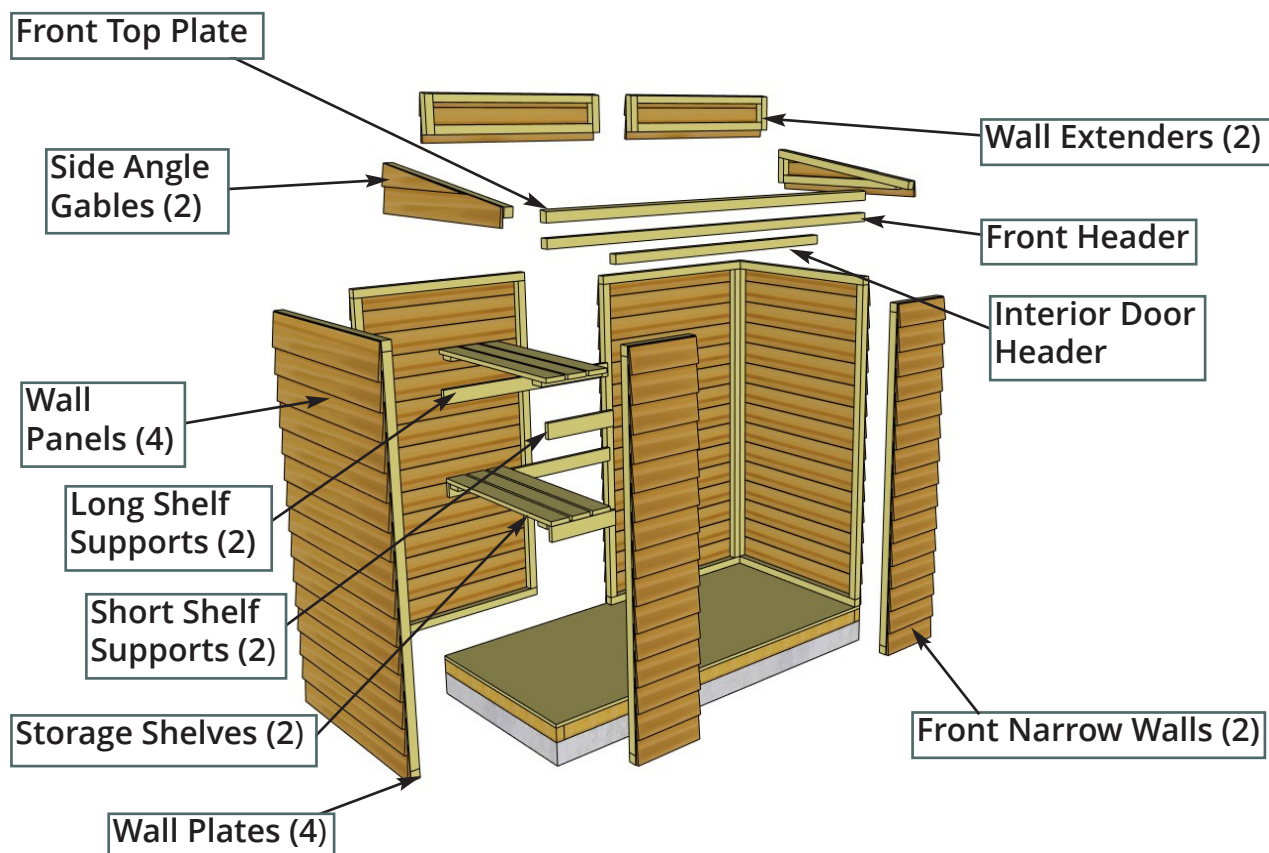

Important: Install Bottom Wall Plates before positioning wall panels.

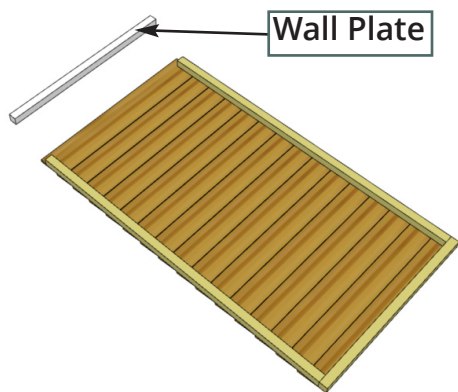

Important:
Pilot hole ALL 2x2 Wall Studs with 1/8" drill bit prior to screwing. This will make it much easier to attach together.

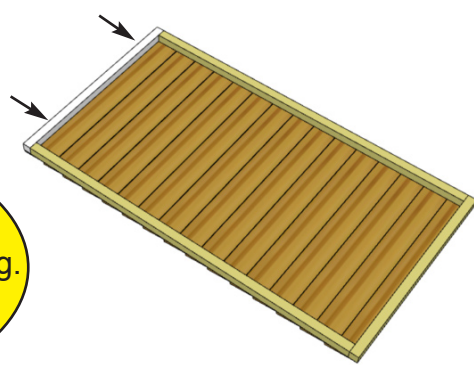

B1. For each **Rear and Side Wall Panel**, carefully lay panel face down. Position and attach a **Wall Plate** to bottom of wall studs of each Wall Panel with **2 - 2 1/2" Brown Screws**. Position so Plates are flush with framing.

Parts	Hardware
Rear/Side Wall Panels (35" x 63 1/4") x 4 Wall Plates (1 1/2" x 1 1/2" x 35") x 4	2 1/2" Brown Screws x 8 total

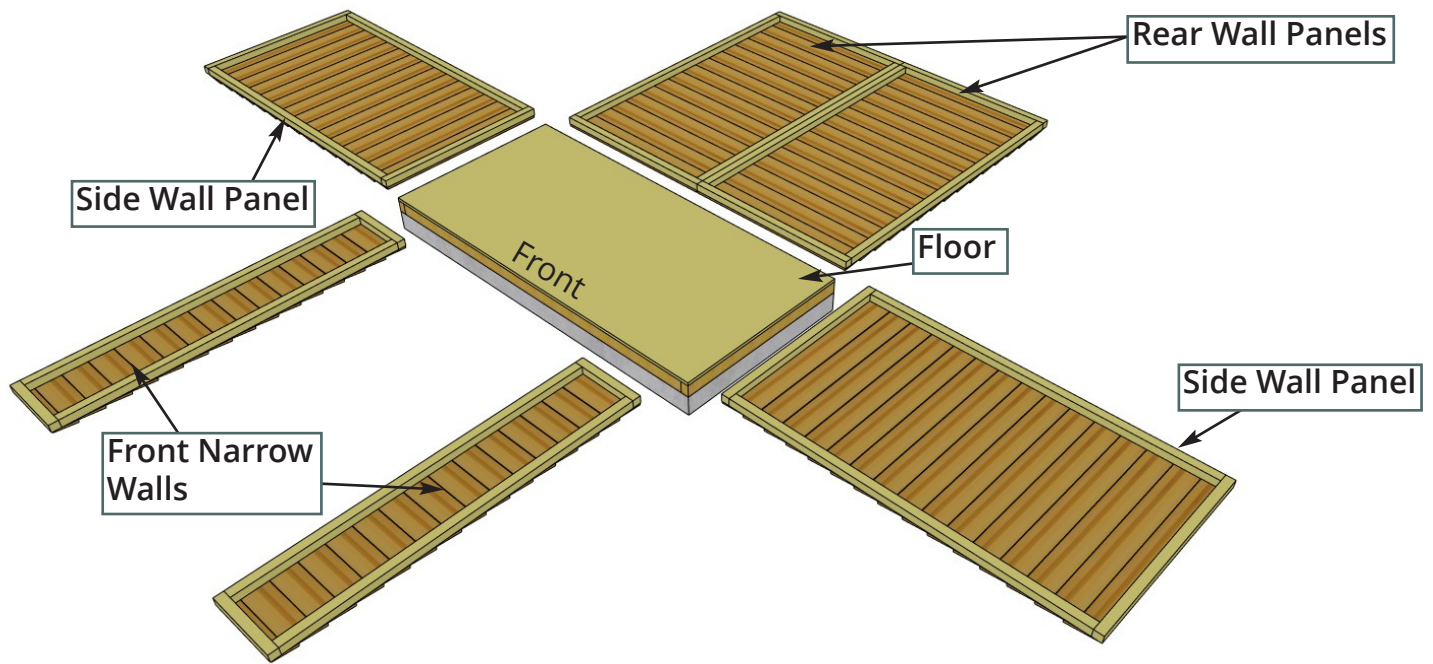

B2. With Wall Plates properly attached, orientate completed Walls around the Floor. Be sure to leave room to work. **Front Narrow Walls** will be required in this section.

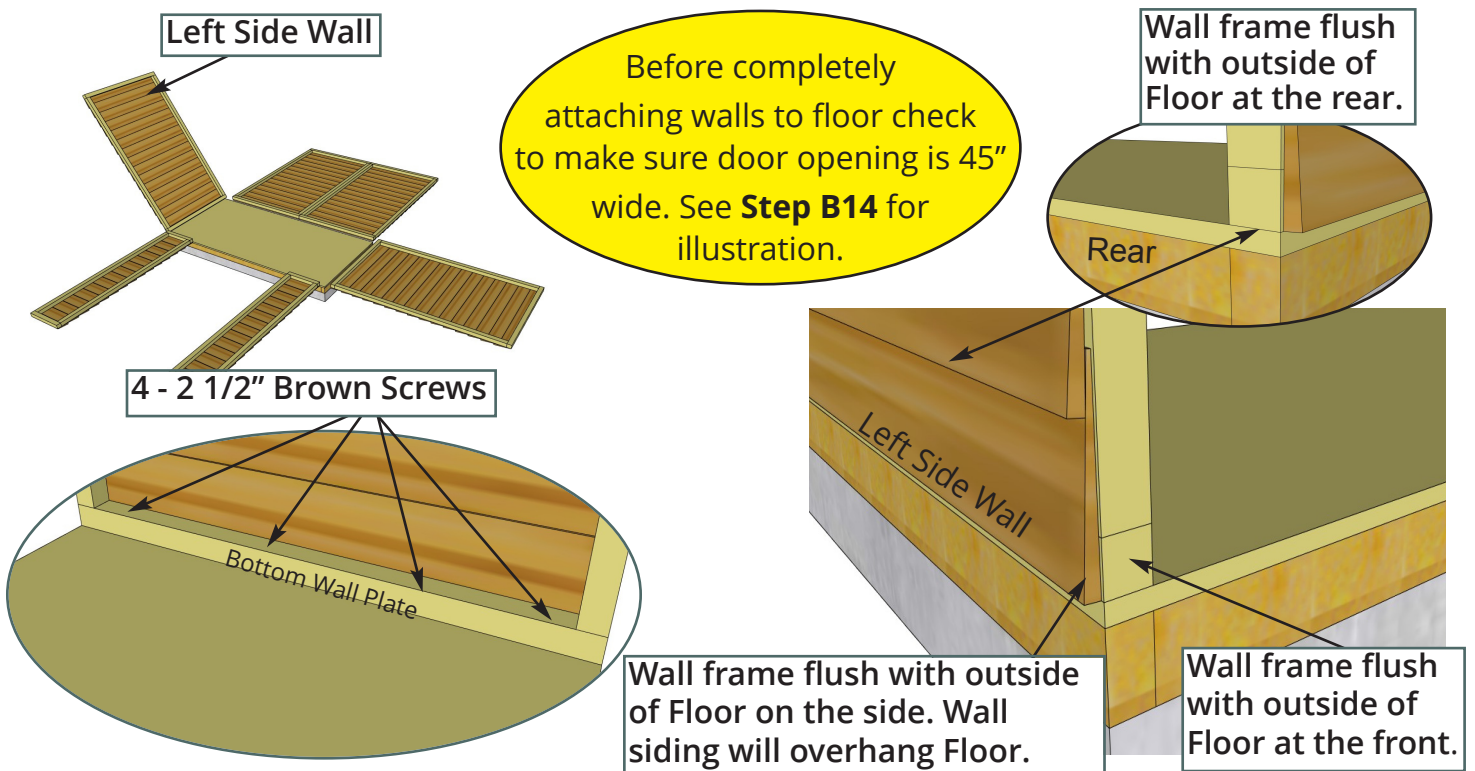

B3. Starting with **Left Side Wall**, lift up and position so framing is flush with Floor at both front and rear of shed. Make sure Wall frame is flush with outside of Floor on the side. When Wall is positioned correctly, secure Bottom Wall Plate to Floor with **4 - 2 1/2" Brown Screws**.

Hardware (Steps B3 - B7)
2 1/2" Brown Screws
 x 25 total

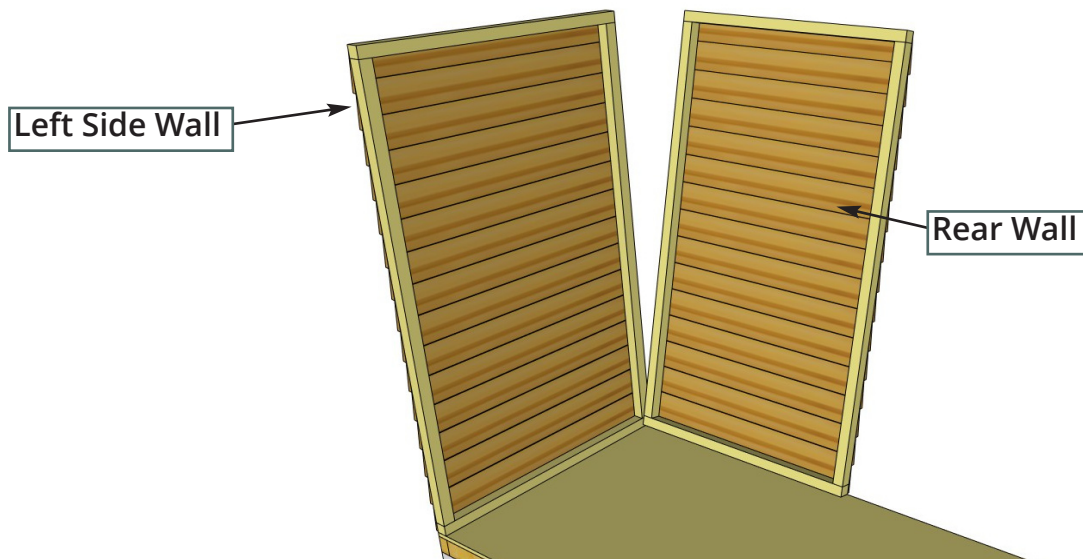

B4. With your helper holding the Side Wall Panel, position a **Rear Wall Panel** in rear corner. **Important: Align Wall Framing Flush with Floor Framing.**

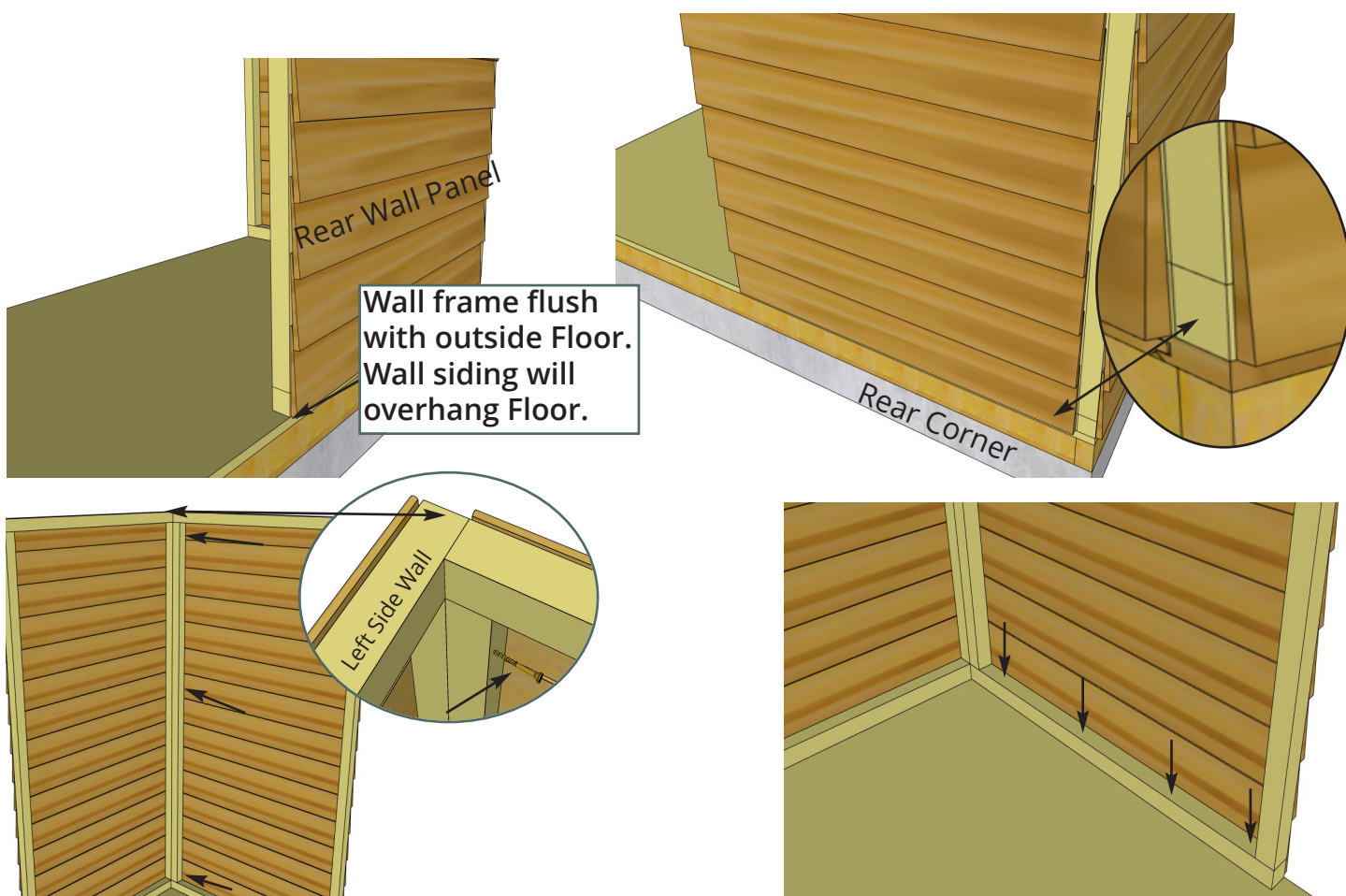

B5. When Side and Rear Walls are aligned in corner correctly, Wall framings will be flush. Attach Wall framings together with **3 - 2 1/2" Brown Screws**. Secure Bottom Wall Plate to Floor with **4 - 2 1/2" Brown Screws**.



B6. Position second **Rear Wall Panel** on Floor. Attach Wall frames together at top, middle and bottom with **3 - 2 1/2" Brown Screws**. Secure Bottom Wall Plate to floor with **4 - 2 1/2" Brown Screws**. **Important: Confirm Siding on Rear Wall Panels are aligned.**

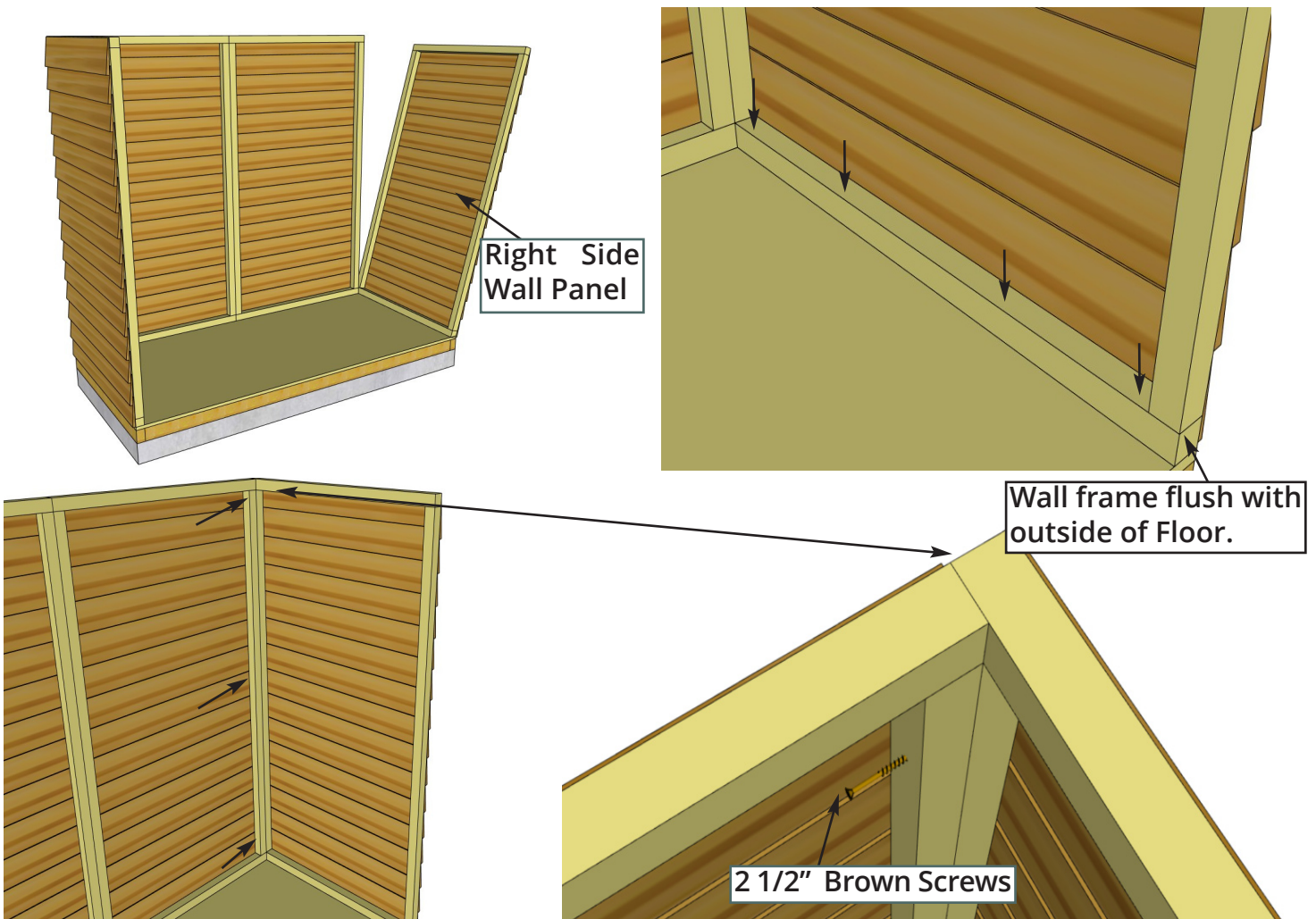

B7. In the corner, align and attach Right Side Wall framing to Rear Wall framing with **3 - 2 1/2" Brown Screws** as per **Step B5**. Secure Bottom Wall Plate of Side Wall to Floor with **4 - 2 1/2" Brown Screws**.

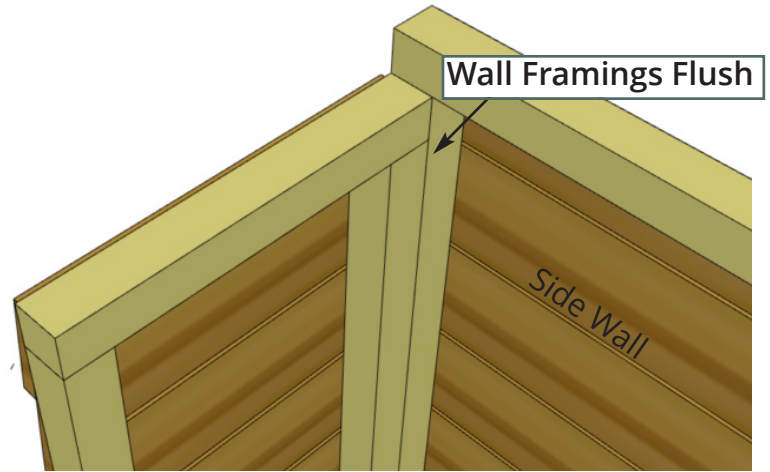
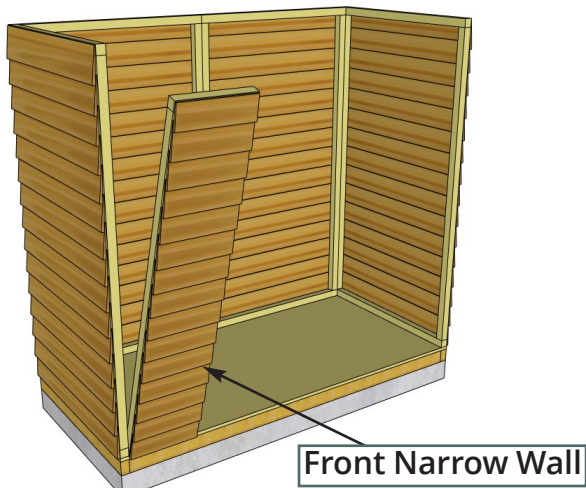

B8. Locate **Front Narrow Walls** and position Wall framing flush with Side Wall framing in corner. **Important: Make sure Narrow Wall is positioned right side up.**

Parts (Steps B8 - B10)
Front Narrow Wall Panels
 (12 1/2" x 61 3/4") x 2

Hardware (Steps B8 - B10)
2 1/2" Brown Screws
 x 10 total

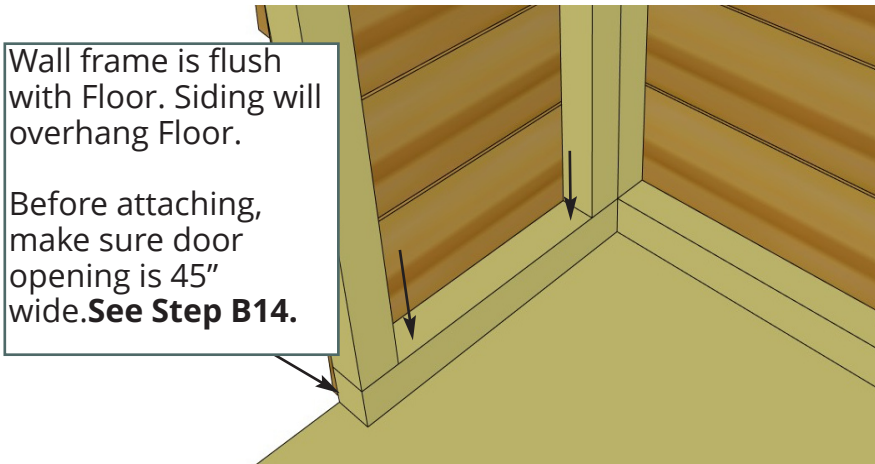

B9. Align Wall framing flush with outside of Floor framing. When correctly positioned, secure Bottom Wall Plate to Floor with **2 - 2 1/2" Brown Screws**. Attach vertical Wall framings together at top, middle and bottom with **3 - 2 1/2" Brown Screws**.

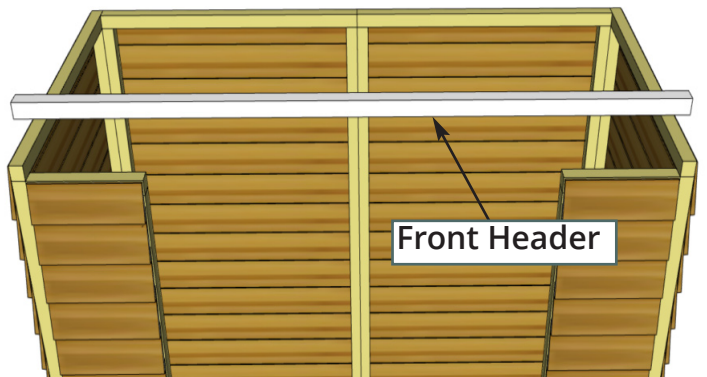

B10. Align and attach the second **Front Narrow Wall Panel** as per **Step B9**.

B11. Locate **Front Header** and place on top of Front Narrow Wall framings.

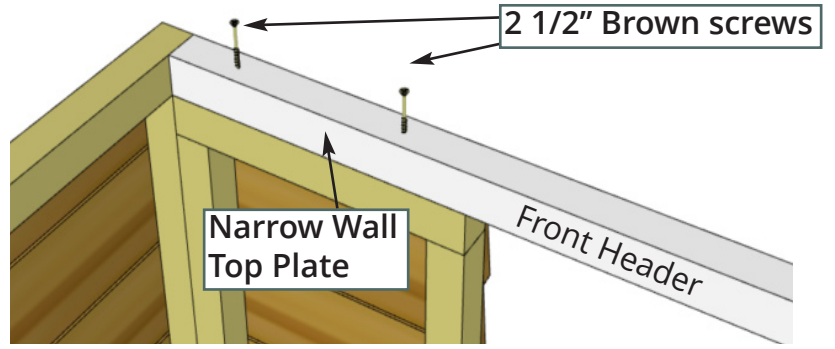
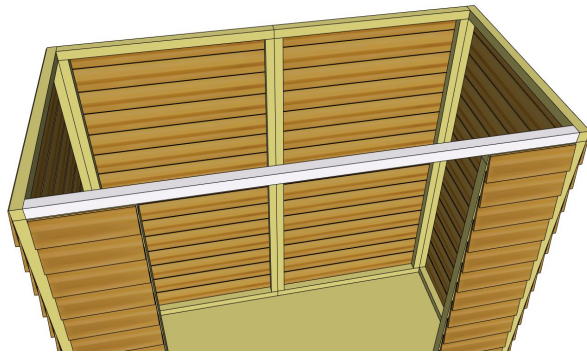

B12. With Front Header positioned evenly on Narrow Wall top plates and flush against Side Wall top framing, secure using **4 - 2 1/2" Brown Screws** screwing down from the top of Front Header down into the upper Narrow Wall plates. Have your helper push side walls against end of Front Header to achieve tight fit.

Parts
Front Header
(1 1/2" x 1 1/2" x 70")

Hardware
2 1/2" Brown Screws
x 4 total

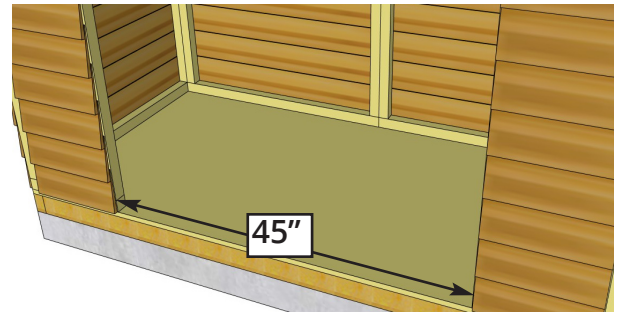
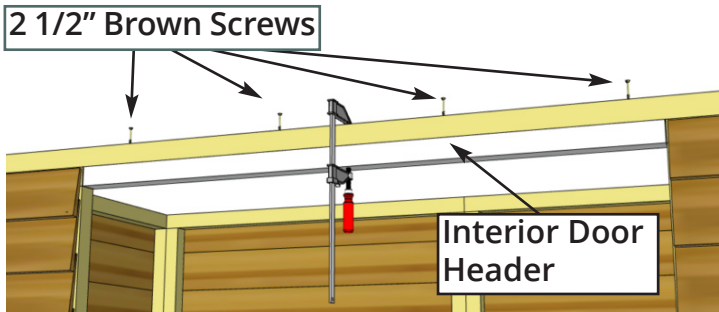

B13. Position **Interior Door Header** underneath and flush with Front Header. Attach with **4 - 2 1/2" Brown Screws**. Screw down from the Front Header into Interior Door Header. Use Clamp to hold Interior Door Header.

<u>Parts</u>	<u>Hardware</u>
Interior Door Header (1 1/2" x 1 1/2" x 44 7/8")	2 1/2" Brown Screws x 4 total

B14. When all Walls are attached together, check door width at top and bottom. Door width should be 45" wide. If required, loosen Narrow and Side Wall plate screws, adjust door width and re-secure. There can be an 1/8" tolerance in the width but top and bottom width should be the same.

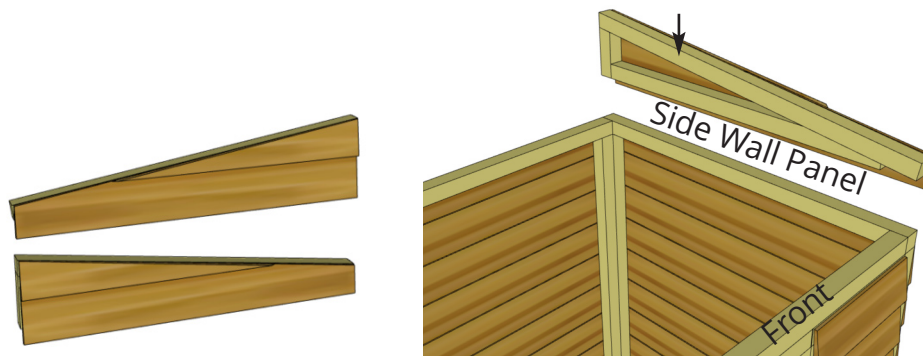

B15. Locate both **Left/Right Side Angle Gables**. Place Right Side Angle Gable on Side Wall Panel frame. **Note:** Bottom siding of Gable will overhang and cover siding of Side Wall.

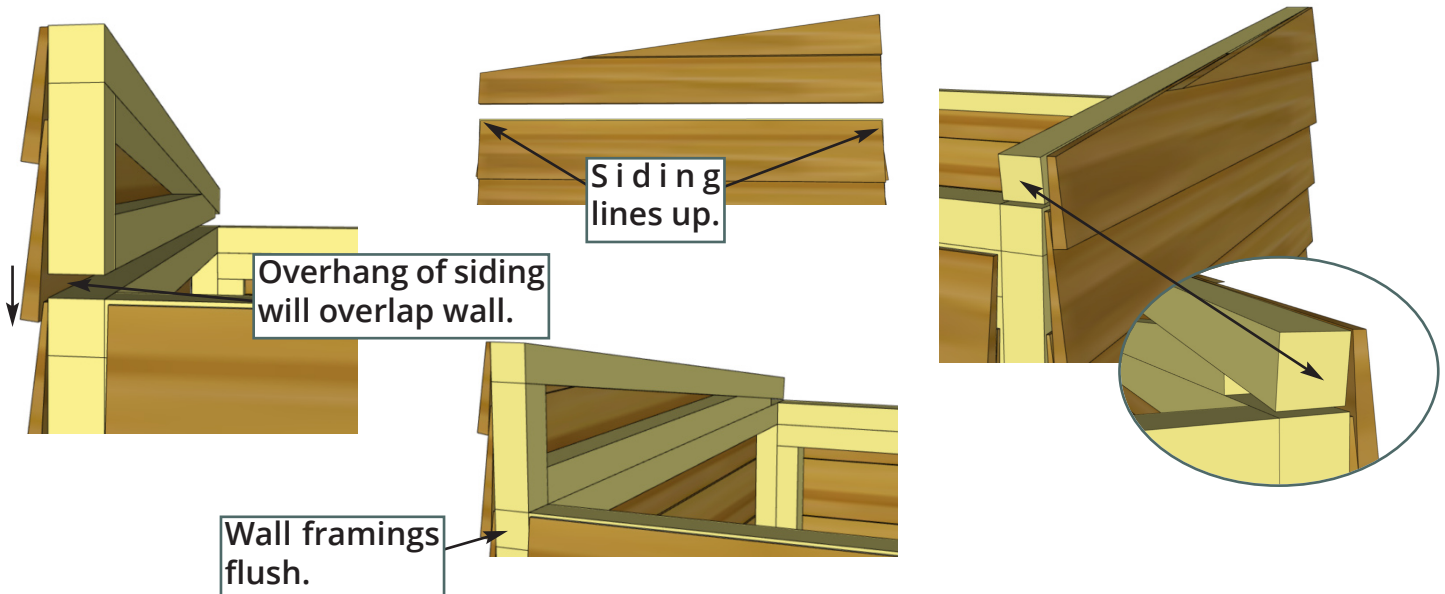

B16. Align Wall framing of Right Side Angle Gable and Side Wall so they are flush at the rear. The siding for both Walls should also align evenly from front to back.

Parts (Steps B16 - B18)
Left/Right Side Angle Gables
 (6 1/2" x 35")

Hardware (Steps B16 - B18)
2 1/2" Brown Screws
 x 8 total

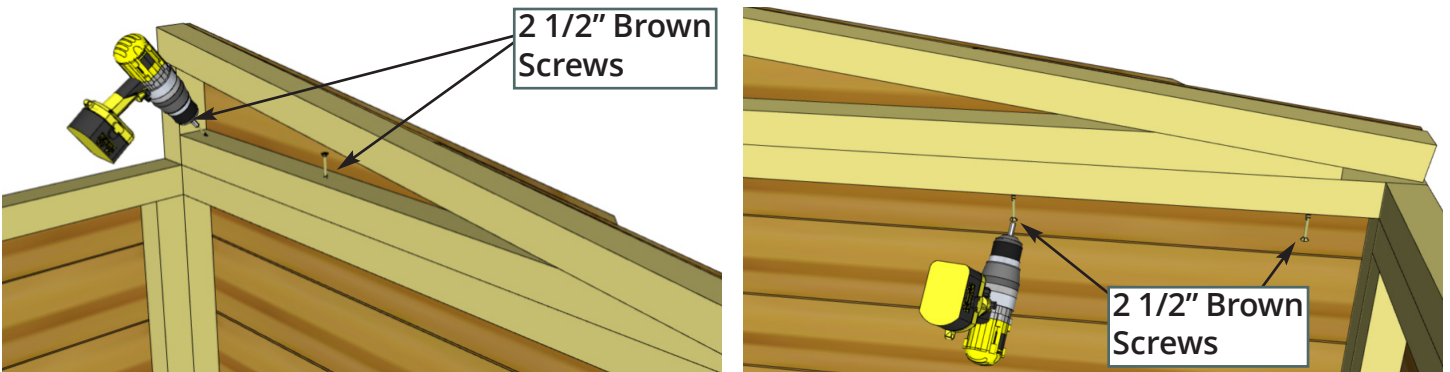

B17. With Right Side Angle Gable and Side Wall aligned correctly, secure together from the inside with 4 - 2 1/2" Brown Screws.

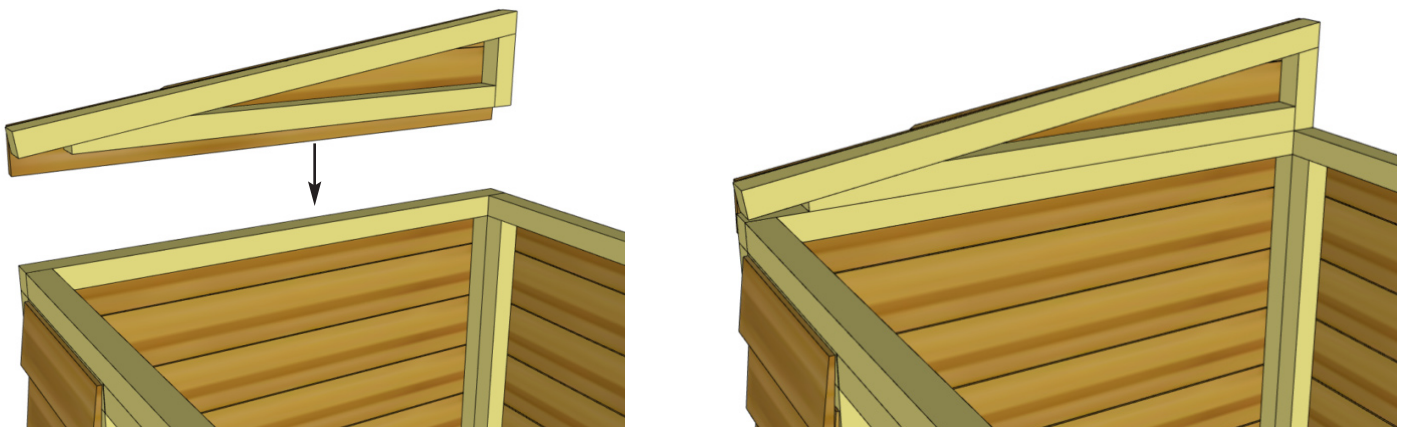

B18. Attach opposite **Left Side Angle Gable** as per **Steps B15 & B17.**

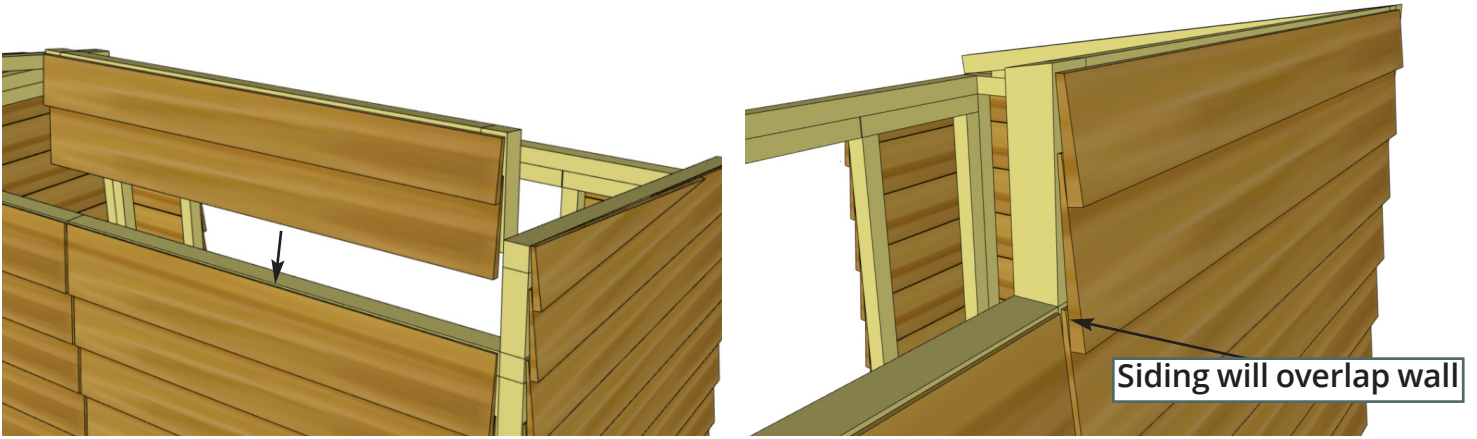

B19. Locate one **Wall Extender** and place on Real Wall. Siding of Wall Extender will align with siding of Rear Wall.

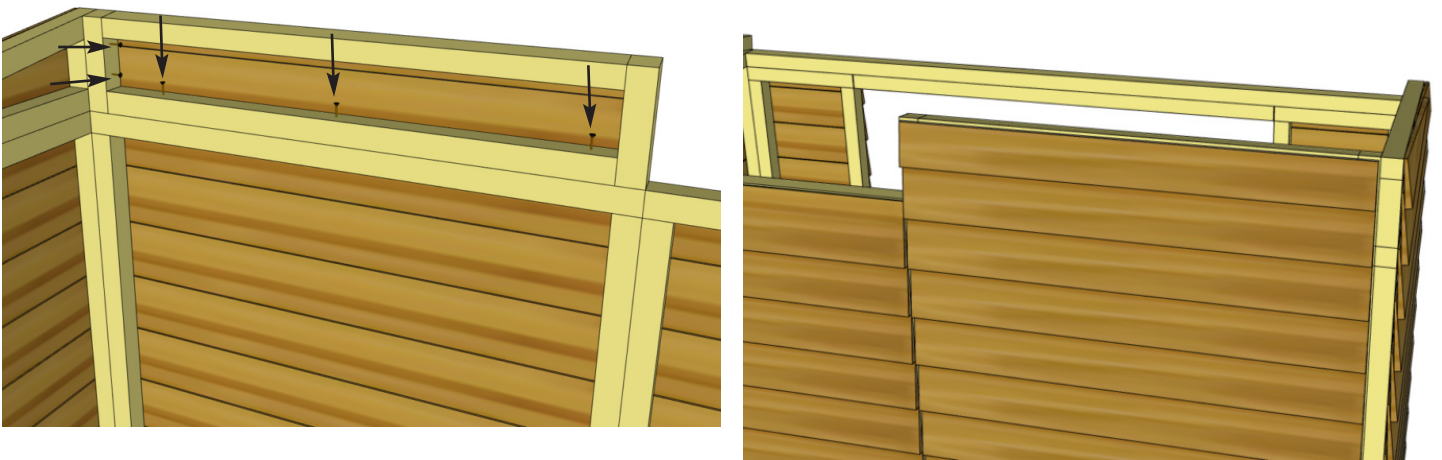

B20. With Wall framing aligned, attach Wall Extender to both the Side Angle Gable framing and the Real Wall framing with **5 - 2 1/2" Brown Screws**.

<p><u>Parts (Step B20 - B21)</u> Wall Extenders (6 1/4" x 35") 2 total</p>	<p><u>Hardware (Step B20 - B21)</u> 2 1/2" Brown Screws x 12 total</p>
---	---

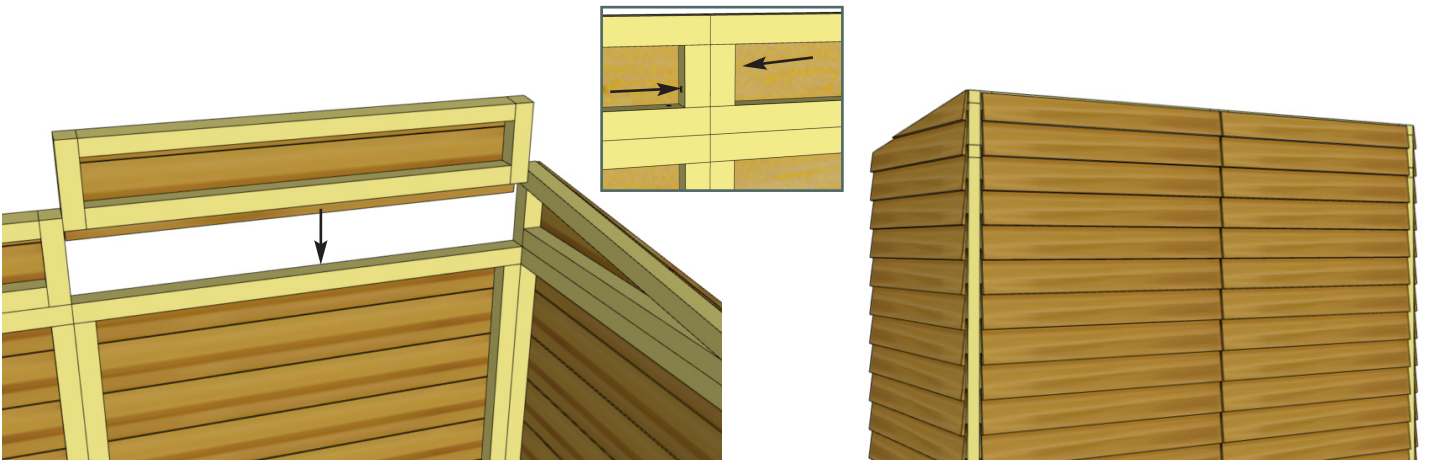

B21. Position and secure second **Wall Extender** as per **Steps B19 & B20**. Additionally, attach to first Wall Extender with **2 - 2 1/2" Brown Screws**.

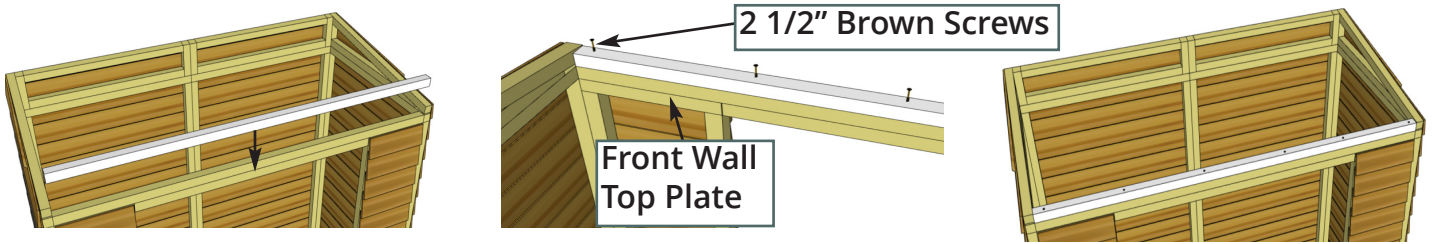

B22. Locate **Front Top Plate** and place on top of Front Header. With Front Top Plate positioned evenly and flush against Front Header, secure using **6 - 2 1/2" Brown Screws** screwing down from the top of Front Top Plate down into Front Header.

<u>Parts</u> Front Top Plate (1 1/2" x 1 1/2" x 70")	<u>Hardware</u> 2 1/2" Brown Screws x 6 total
---	--

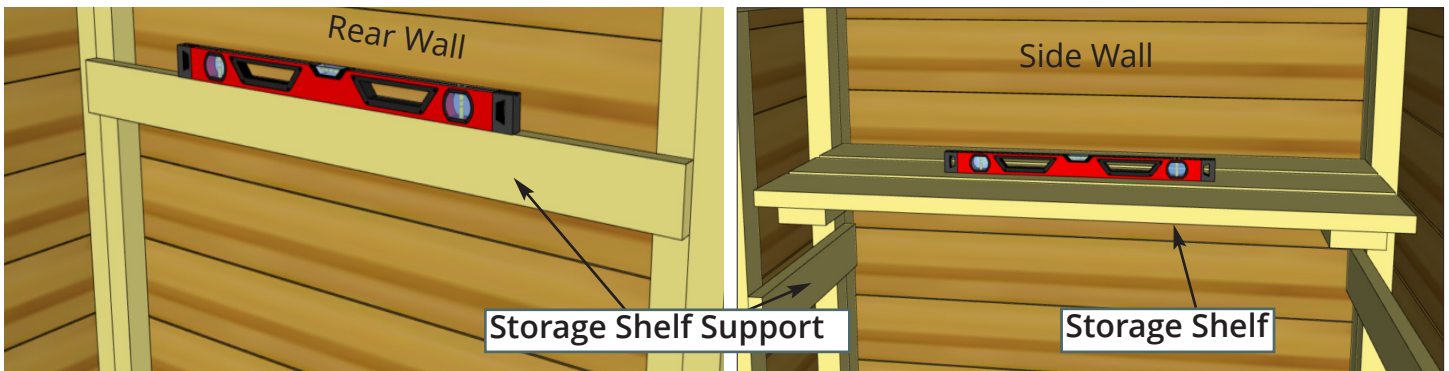

B23. Storage Shelf positioning is flexible so decide what height configuration suits your needs. Gather your **Storage Shelf Supports**. The short Support (12 1/2") attaches to the Narrow Wall, the long (35") to the Rear Wall. Position using a Level, and drill Pilot Holes to prevent ends of Supports from splitting. Attach first Support using **2 - 1 1/4" Brown Screws**. Place **Storage Shelf** on attached Support, Level, and mark position of second Support. Pilot Hole and secure second Support.

<u>Parts (Steps B23 - B24)</u> Short Storage Shelf Supports (3/4" x 2 1/2" x 12 1/2") x 2 Long Storage Shelf Supports (3/4" x 2 1/2" x 35") x 2 Storage Shelves (11 1/2" x 31 7/8") x 2	<u>Hardware Parts (Steps B23 - B24)</u> 1 1/4" Brown Screws x 8 total 1 1/2" Finishing Nails x 8 total
--	--

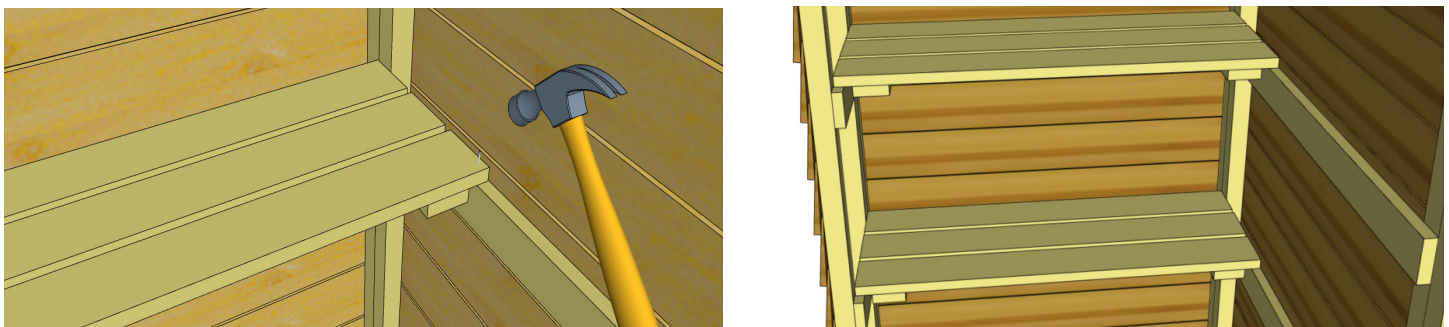

B24. Place **Storage Shelf** on top of supports and secure with **4 - 1 1/2" Finishing Nails**. Complete 2nd Shelf (if desired) as per **Steps B23 & B24**.

C. Roof Section - Cedar

Exploded view of all parts necessary to complete the Roof Section.
Identify all parts prior to starting.



Cedar Shingle Roof Panel

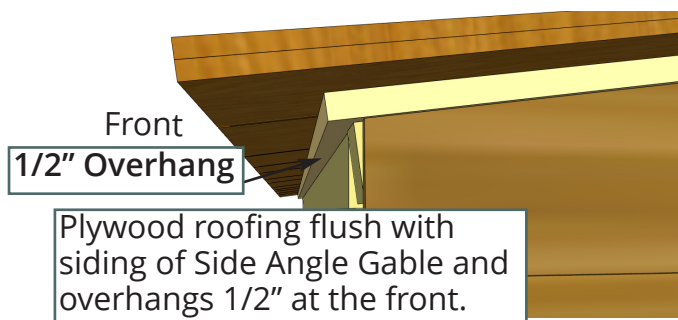
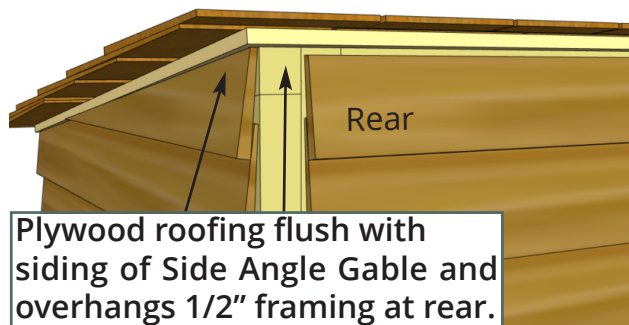
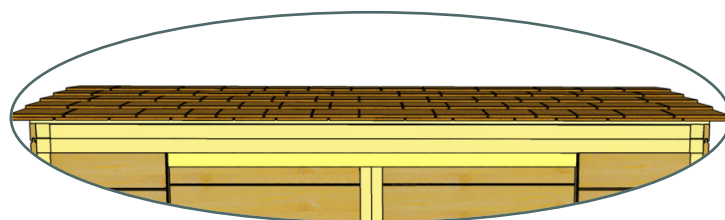
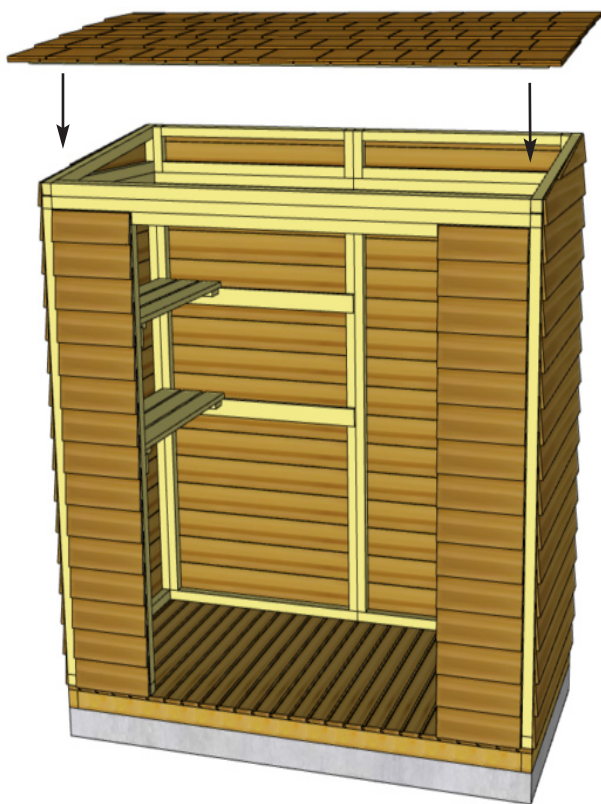

C1. Lift up completed **Cedar Shingle Roof Panel** and place on upper wall framing. Align the roof plywood so it is flush with the siding on both sides of the angled gables. Center the roof so the plywood overhangs the front and back of the shed framing by 1/2".

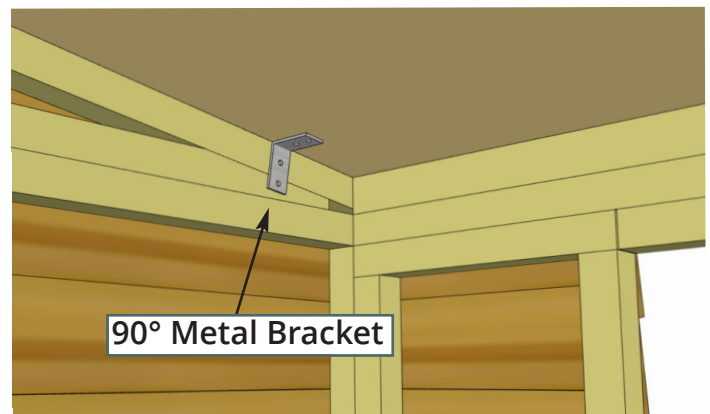
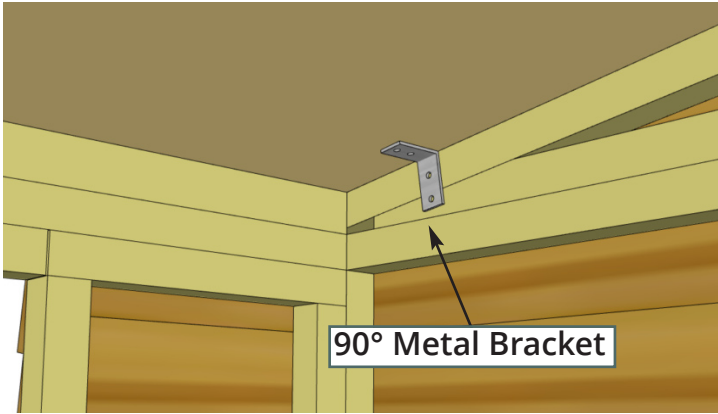
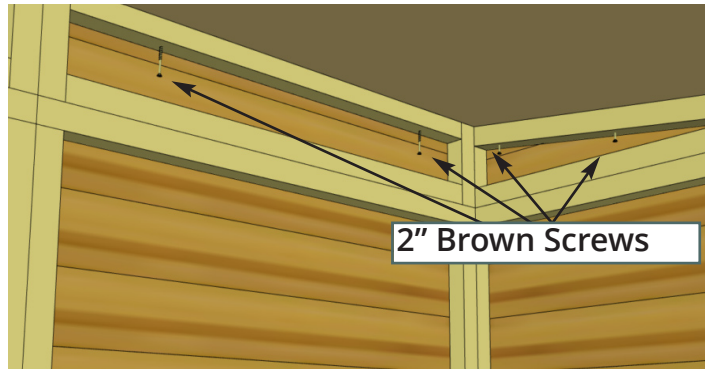
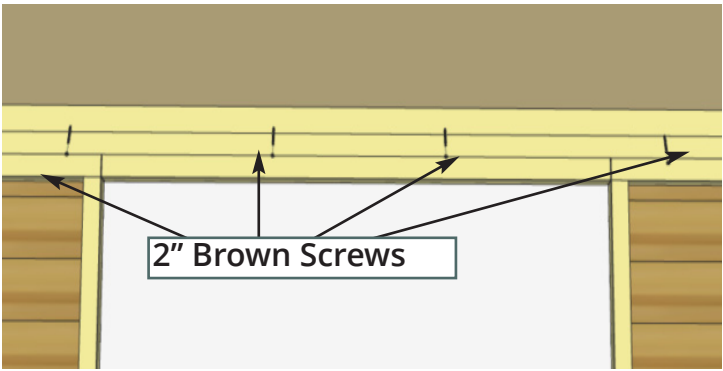

C2. From inside the shed, start securing the Roof by screwing through Front Top Plate into Roof Panel on an angle with **4 - 2" Brown Screws**. Make sure screw tips do not go completely through Roof Panel. At the sides, screw from upper framing into Roof Panel. Use **2 - 2" Brown Screws** per Side Angle Gable. Screw on an angle and make sure screw tips do not go completely through Roof Panel. At the rear, secure the Roof by attaching the Wall Extenders to Roof Panel on an angle with **4 - 2" Brown Screws**. Further secure Roof Panel to Walls at sides by positioning **2 - 90° Metal Brackets** onto Roof Plywood and Side Angle Gables where Gable meets front Wall. Secure with **4 - 3/4" Silver Screws** per bracket.

<u>Parts</u>	<u>Hardware</u>
Cedar Shingle Roof Panel (39 1/2" x 78 1/4")	2 1/2" Brown Screws x 12 total 90° Metal Brackets x 2 total 3/4" Silver Screws x 8 total

C. Roof Section - Metal

Exploded view of all parts necessary to complete the Roof Section. Identify all parts prior to starting.

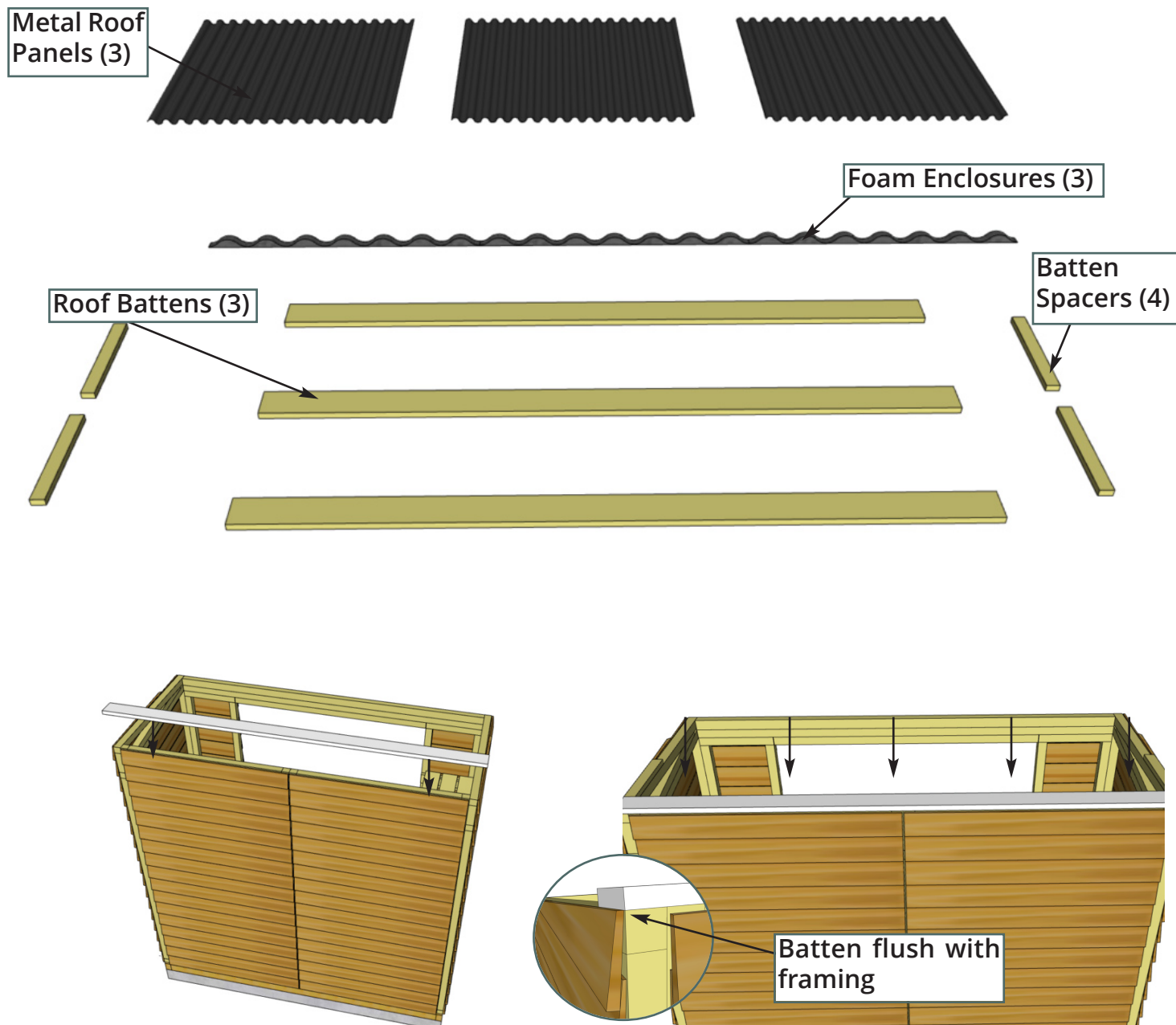

C1. Locate first row of **Roof Battens** and position on top of Side Angle Gables and Wall Extenders at the rear. When centered the batten will be flush with the framing of the Side Angle Gable at each end. Attach **Batten** with **6 - 1 1/4" Brown Screws**, one at each end into top of Side Angle Gable, and into framing of Wall Extenders. **Important** pre-drill pilot hole with 1/8" drill bit first to prevent from splitting.

Parts (Step C1 - C4)

Battens (3/4" x 3 1/2" x 73") x 3
Batten Spacers (3/4" x 1 1/2" x 12 3/8") x 4

Hardware (Step C1 - C4)

1 1/4" Brown Screws
x 22 total

Important: Pre-drill Batten Spacers with 1/8" bit before fastening.

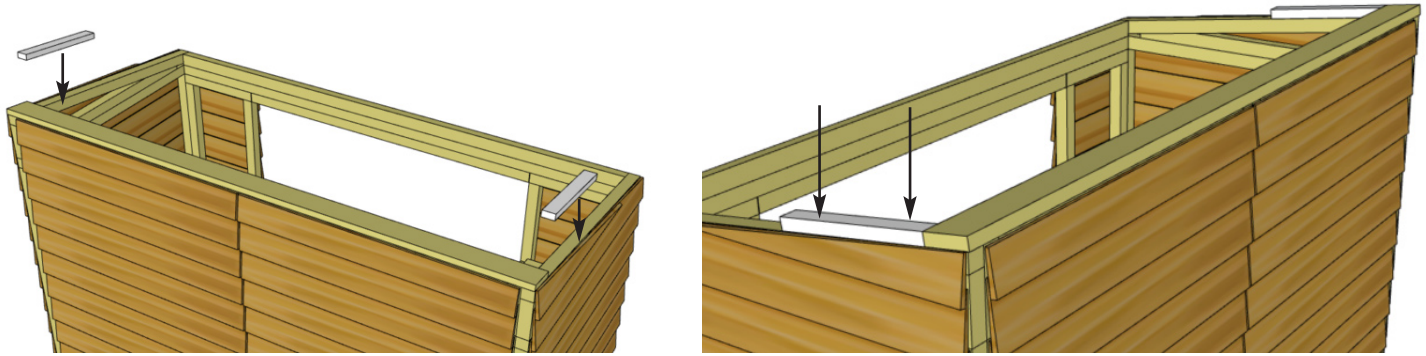

C2. Place 2 **Batten Spacers** below each end of the attached Batten, lengthwise along Side Angle Gable. Ensure Batten Spacer is tight with Batten. Attach Batten Spacer to top of Side Angle Gables using 2 - 1 1/4" **Brown Screws**.

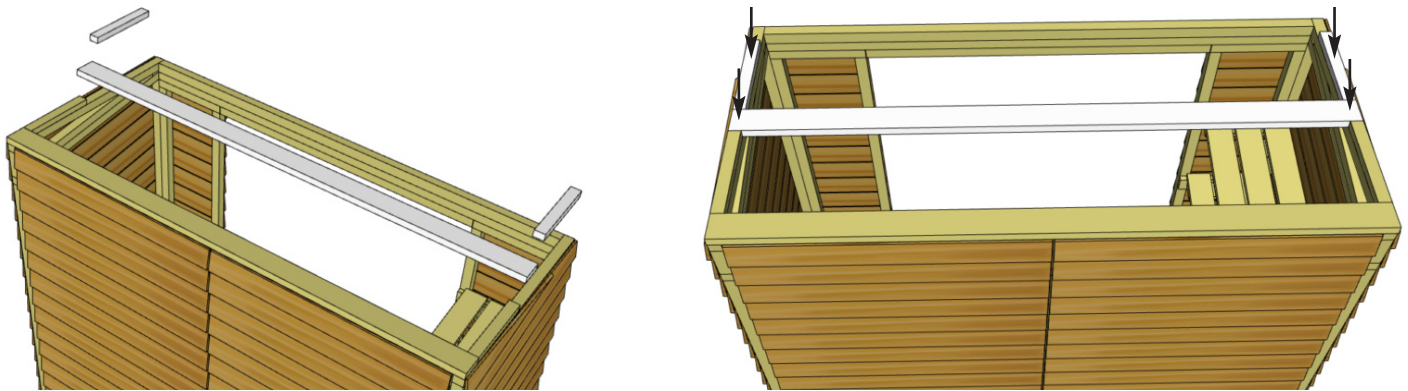

C3. Locate another **Roof Batten** and position flush with previously attached Batten Spacers. Attach with 2 - 1 1/4" **Brown Screws**, one at each end into framing of Side Angle Gables. Attach a second row of **Batten Spacers** flush with the bottom edge of this middle Batten row via the same method as **Step C2**.

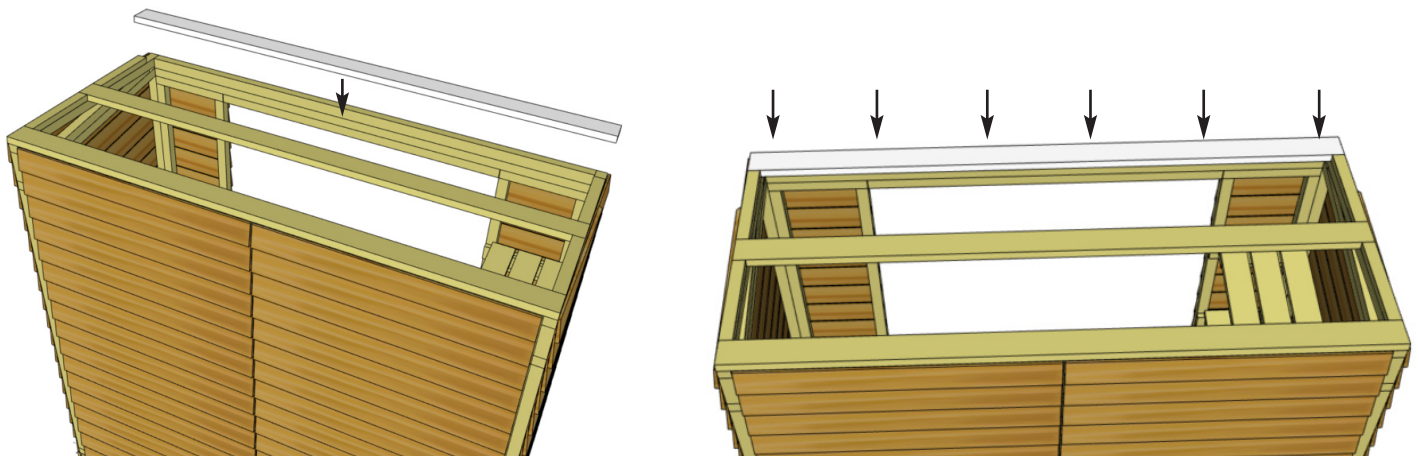

C4. Locate the last **Roof Batten** and attach flush with previously attached **Batten Spacers** via the same method as **Step C3**, using a total of 6 - 1 1/4" **Brown Screws**.

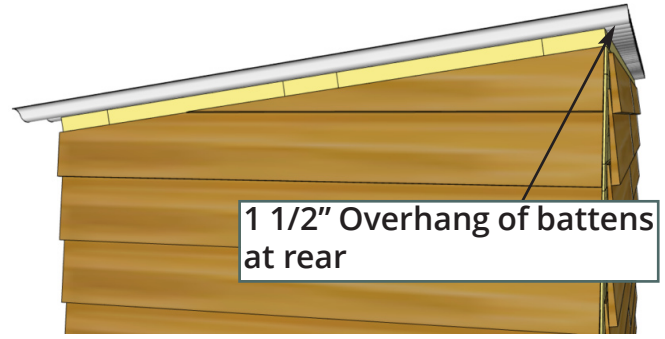
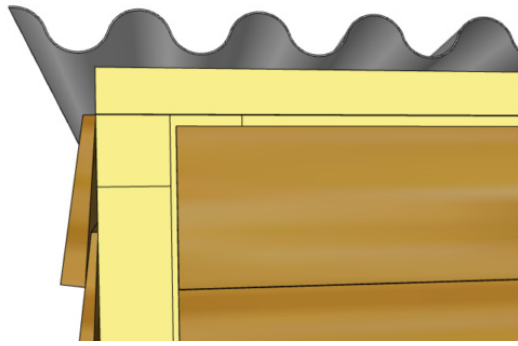

1 1/2" Overhang of battens at rear

C5. Locate first **Metal Roof Panel** and place on Battens. Metal Roof Panels overhang the rear battens 1 1/2" to be flush at the rear when Side Fascia and Rear Corner Trims are attached in later steps.

Parts (Steps C5 - C6)
Metal Roof Panel (39") x 3

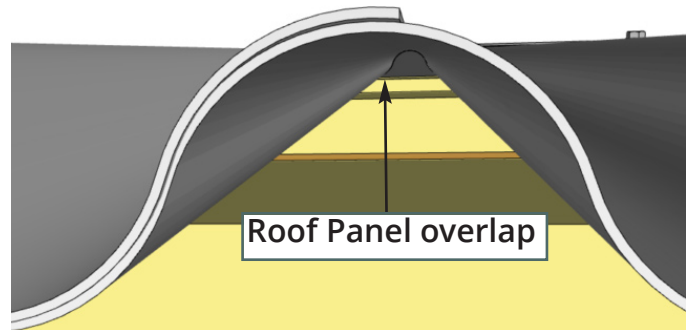
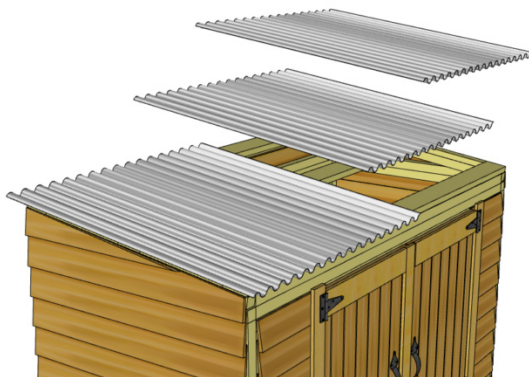

Roof Panel overlap

Bead of Caulking



C6. Make sure Metal Roof Panels are overlapping. Adjust the position of remaining Metal Roof Panels on Battens as per **Step C5**. Overlap Metal Roof Panels to achieve desired overall width. Overall width past the end of Battens can vary from 1" to 3" depending on your personal preference. Once Metal Roof is spaced correctly from side-to-side and top-to-bottom, lift panels up and run a bead of caulking down the overlapping seams of each panel to seal the joints. You will likely need assistance from a helper in this step.

Screw into center of Battens.

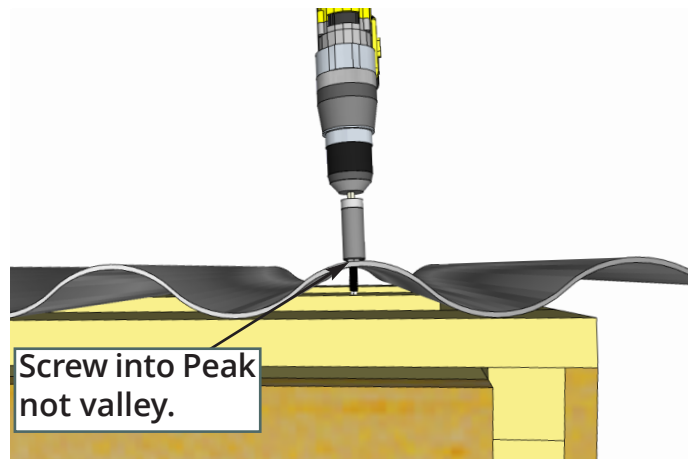
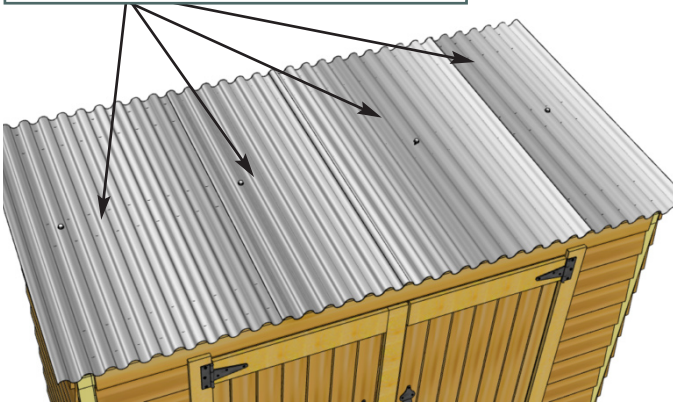

Screw into Peak
not valley.

C7. Using 4 - 1 1/2" Metal Roof Screws and 1/4" Nut Driver (included), secure Metal Roof Panels down to middle Batten row. Metal screw is self-tapping, do not overtighten. Screw through Roof Panels, into center of Battens. Eight more 1 1/2" Metal Screws will be required to further secure Metal Roof Panels and complete Metal Peak Caps in later steps.

Hardware
1 1/2" Metal Roof Screws x 4
1/4" Nut Driver x 1

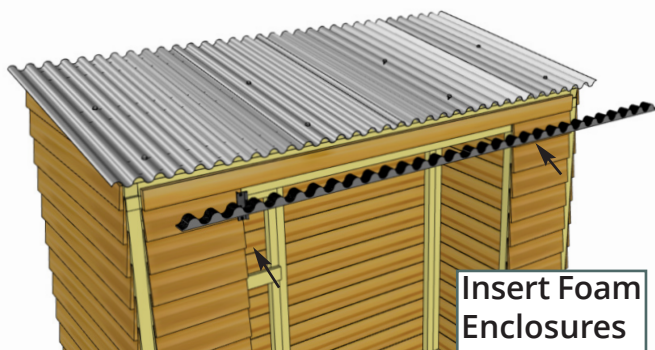

Insert Foam
Enclosures

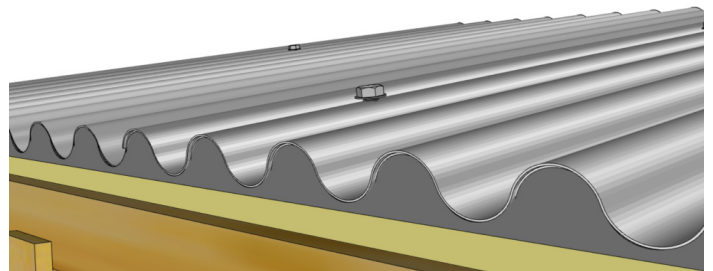

C8. Insert **Foam Enclosures** between Metal Roof Panels and Battens at the front. Enclosures may need to be snipped down in length to fit. Enclosures will prevent moisture and unwanted bugs, etc. from entering your shed through here.

Parts
Foam Enclosures x 3

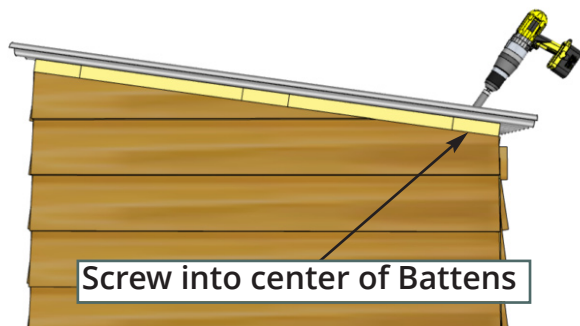

Screw into center of Battens



C9. Using 4 - 2" Metal Roof Screws and 1/4" Nut Driver, secure Metal Roof Panels down to lower/front Battens. Metal screws are self-tapping, do not overtighten!

Hardware
2" Metal Roof Screws x 4
1/4" Nut Driver x 1

D. Miscellaneous Section

Exploded view of all parts necessary to complete the Misc. Section.
Identify all parts prior to starting.

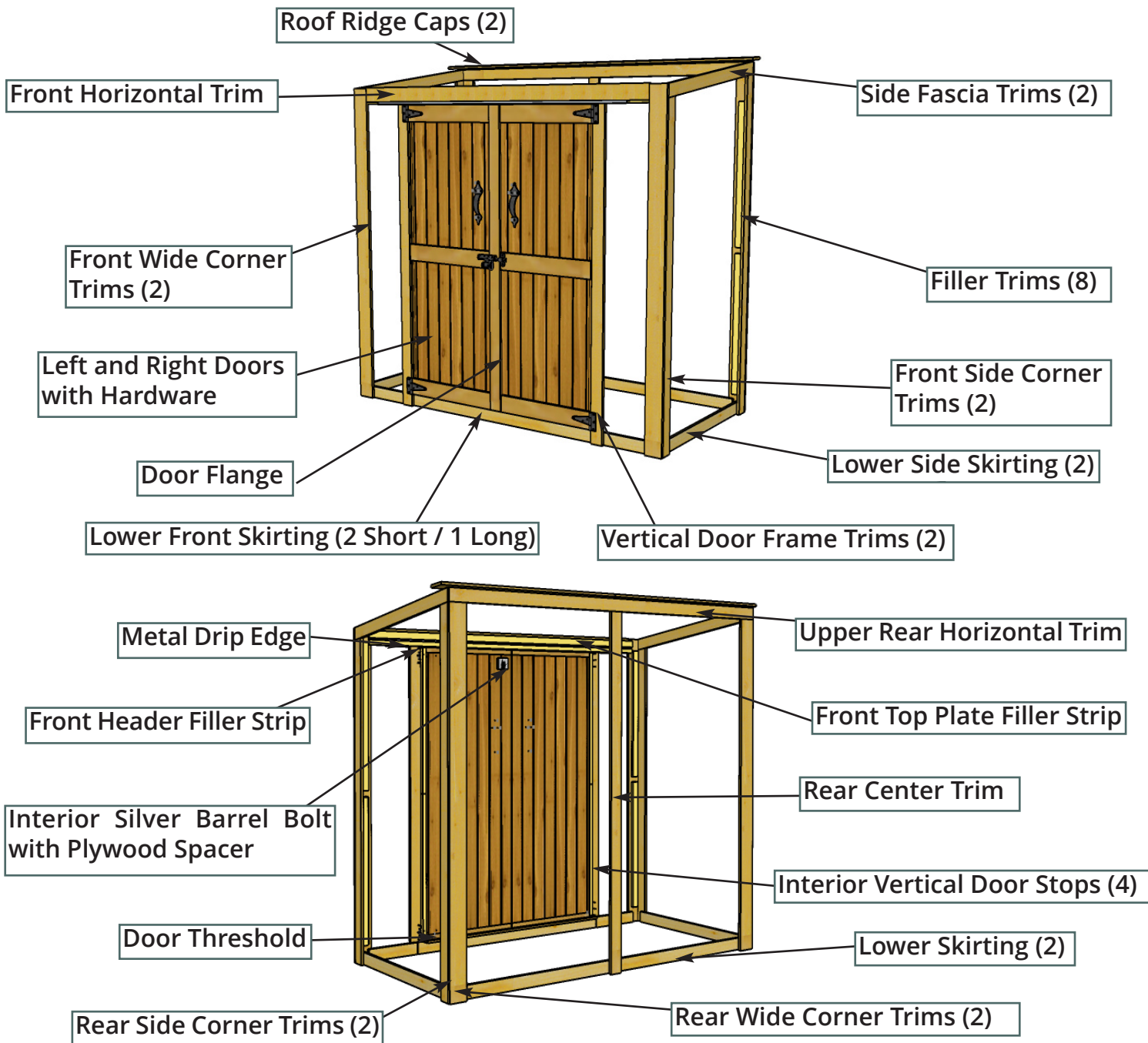

D1. Check the wall seams for visible gaps prior to attaching Filler Trim and apply caulk where needed. Caulking gaps will help prevent moisture from entering and will help the longevity of your shed. **Caulking not included in kit.**

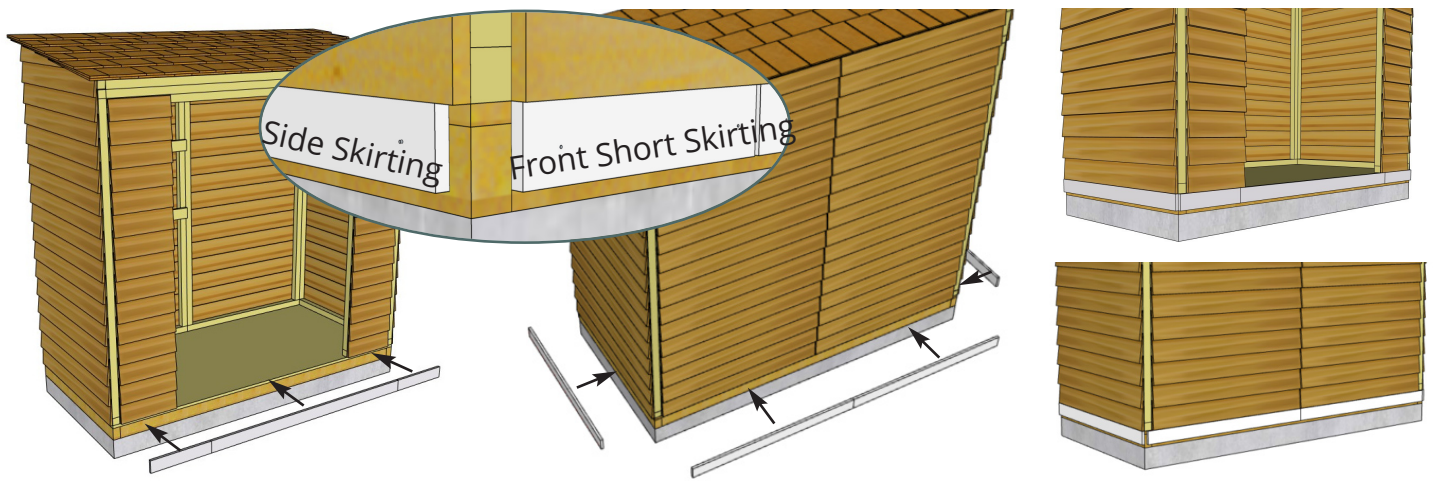

D2. Locate **Lower Front Skirting (2 Short and 1 Long)**. Skirting will hide floor framing. Gaps will be covered by Wide Trim pieces later. Attach 2 Lower Short Front Skirting pieces with **2 - 1 1/2" Finishing Nails** per piece. Attach Lower Front Long Skirting with **4 - 1 1/2" Finishing Nails**. Locate **Lower Skirting** and attach with **4 - 1 1/2" Finishing Nails** per piece.

Parts	Hardware
Lower Front Skirting Short (1/2" x 2 1/2" x 12 3/4") x 2 Long (1/2" x 2 1/2" x 47 1/2") Lower Skirting (1/2" x 2 1/2" x 35") x 4	1 1/2" Finishing Nails x 24 total

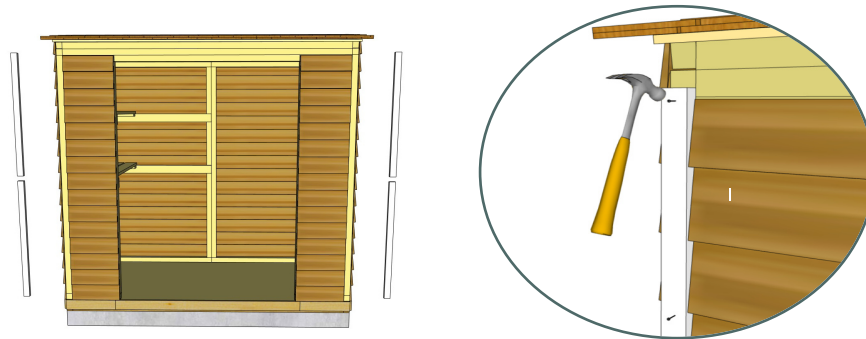

D3. Locate 4 **Front Filler Trims**. Filler trims will be covered by Corner Trim in later steps. Attach in each front corner with **3 - 1 1/2" Finishing Nails** per piece.

Parts (Step D3 - D4)	Hardware (Step D3 - D4)
Front/Rear Filler Trims (3/4" x 1 1/2" x 30") x 8	1 1/2" Finishing Nails x 24 total

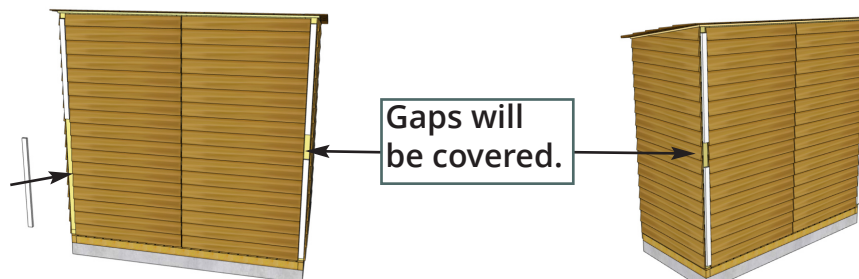

D4. Position and attach **Rear Filler Trims** in the rear as per **Step D3**.

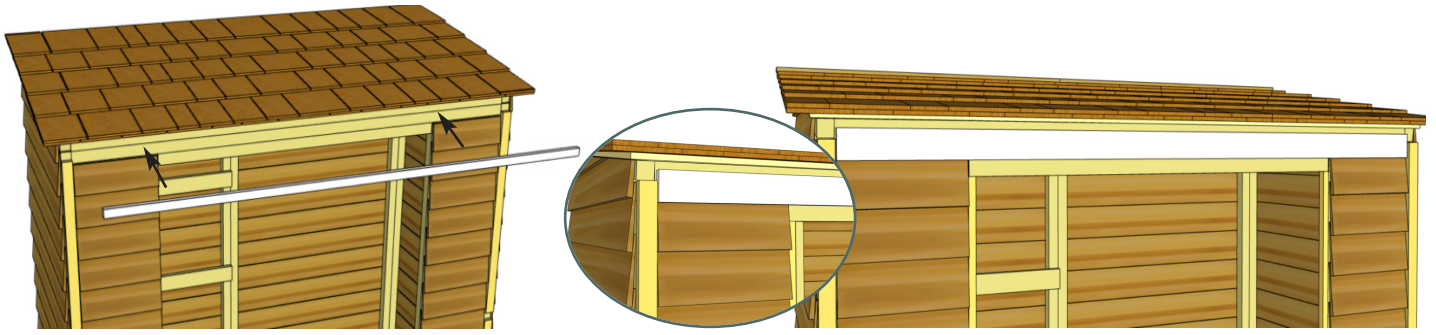

D5. Locate **Header Finish**. Position Header Finish above Front Narrow Walls with the smooth side facing out. Evenly space from side to side. Secure with **6 - 1 1/2" Finishing Nails** into the Front Header.

<p><u>Parts</u> Header Finish (3/4" x 2 1/2" x 69 1/2")</p>	<p><u>Hardware</u> 1 1/2" Finishing Nails x 6 total</p>
--	--

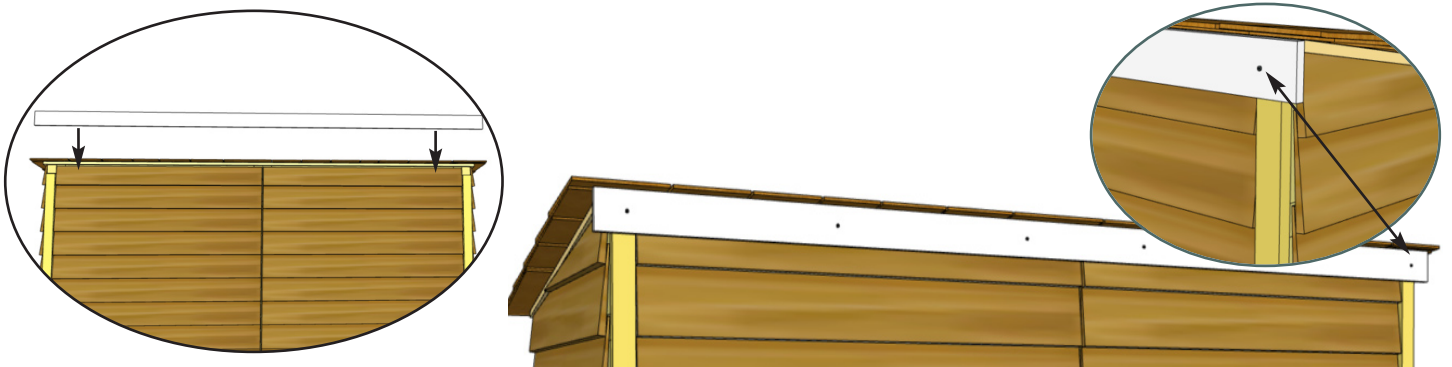

D7. Locate **Upper Rear Horizontal Trim** and position underneath Roof Panel. Evenly space from side to side. Secure with **6 - 1 1/2" Finishing Nails** into Wall Extenders.

<p><u>Parts</u> Horizontal Trim (1/2" x 2 1/2" x 75 1/2")</p>	<p><u>Hardware</u> 1 1/2" Finishing Nails x 6 total</p>
--	--

Expert Advice: Do a dry run with Front and Rear Corner trims before attaching. Confirm the rough face is configured correctly and small trim gaps are satisfactory before attaching.

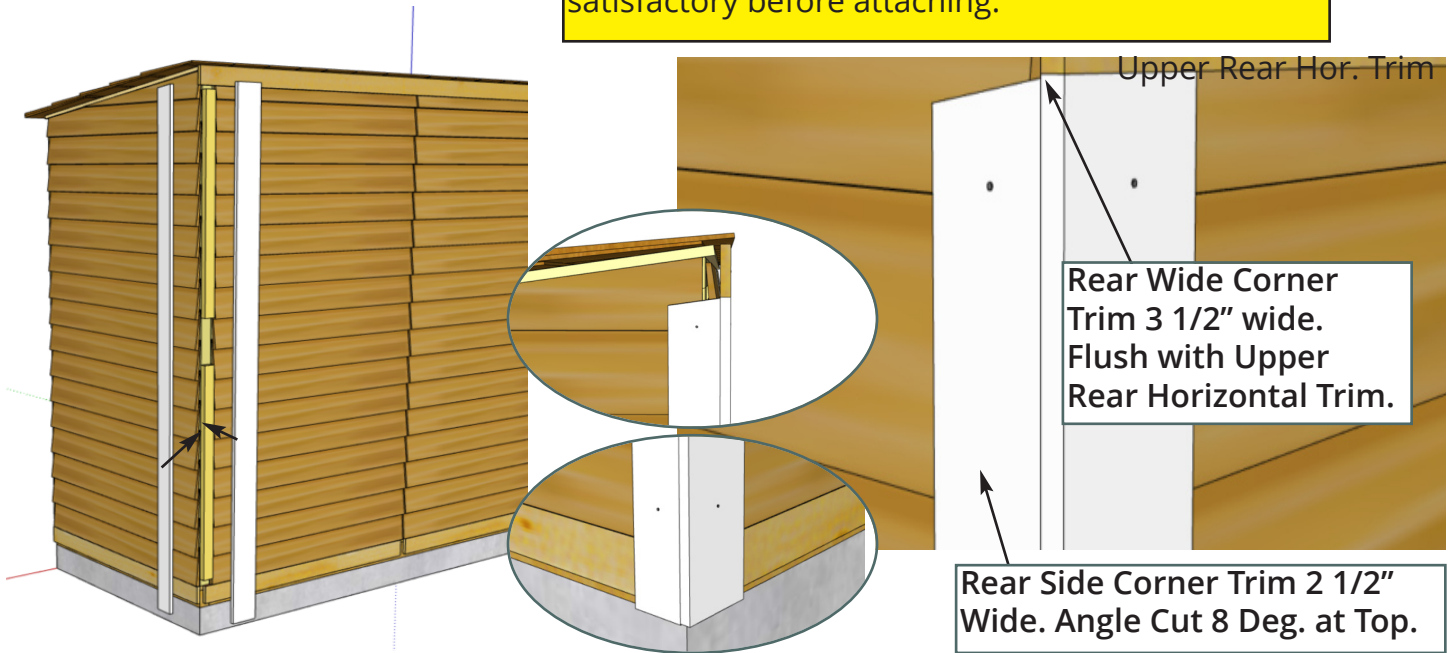

D8. Locate a **Rear Wide Corner Trim** and **Rear Side Corner Trim**. Angled Side Trim pieces are unique to each corner and are attached **rough side out**. Starting in one corner, position both Trims up tight underneath Upper Rear Horizontal and Side Fascia Trims. Align Rear Wide Corner Trim flush against the Horizontal Trim. Rear Wide Corner Trim will cap Rear Side Corner Trim. When correctly aligned, attach each piece with **6 - 1 1/2" Finishing Nails**.

Parts	Hardware
Rear Wide Corner Trim (1/2" x 3 1/2" x 70 3/8") Rear Side Corner Trim (Angle Cut At Top) (1/2" x 2 1/2" x 70 3/8")	1 1/2" Finishing Nails x 12 total

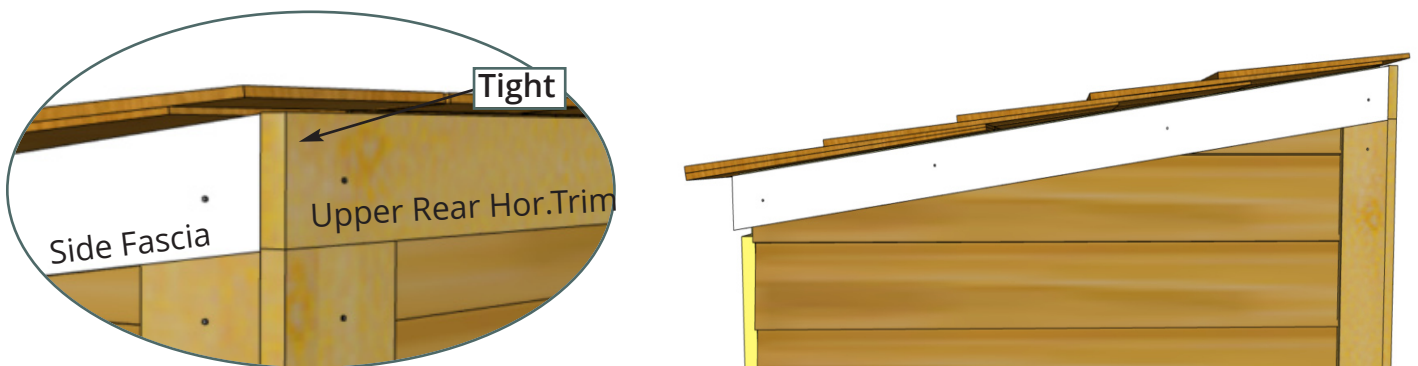

D9. Continuing around the shed, place a **Side Fascia Trim** tight against the rear Horizontal Trim and underneath Cedar Roof. Align Side Fascia Trim to Rear Side Corner Trim. Attach Side Fascia Trim to Side Angle Gable with **4 - 1 1/2" Finishing Nails**.

Parts	Hardware
Side Fascia Trim (Angle Cut Both Ends) (1/2" x 2 1/2" x 37 5/8")	1 1/2" Finishing Nails x 4 total

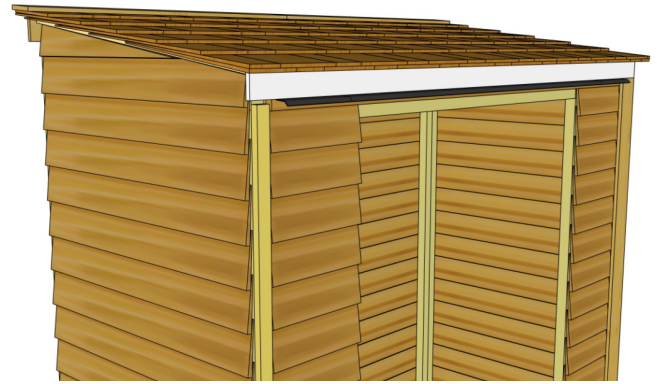
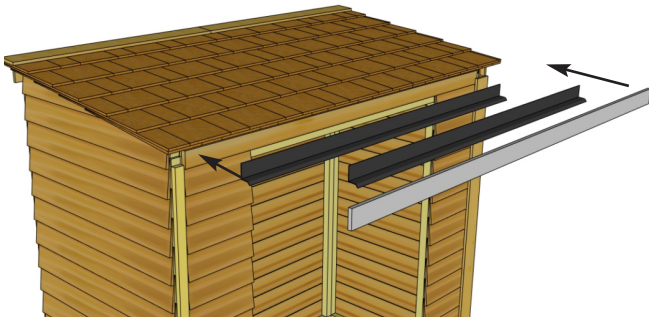

D10. Locate **Front Horizontal Trim** and **2 - Metal Drip Edge**. Position the Metal Drip Edge behind the Trim. Evenly space from side to side. Overlap Metal Drip Edges and Front Horizontal Trim, secure with **6 - 1 1/2" Finishing Nails** into the Header Finish.

<p><u>Parts</u></p> <p>Horizontal Trim (1/2" x 2 1/2" x 75 1/2")</p> <p>Metal Drip Edge x2 (60")</p>	<p><u>Hardware</u></p> <p>1 1/2" Finishing Nails x 6 total</p>
--	---

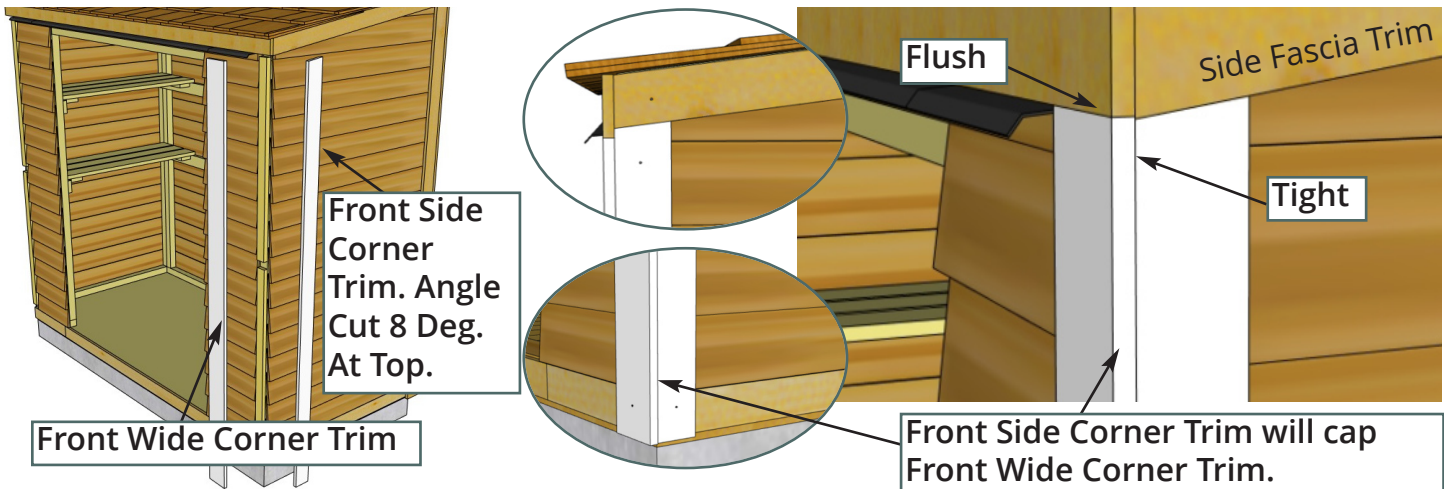

D11. Locate a **Front Side Corner Trim** and **Front Wide Corner Trim**. Once again, angled Side Trim pieces are unique to each corner and are attached **rough side out**. Position Front Side Trim tight underneath Side Fascia Trim. Align Front Wide Corner Trim underneath Cedar Roof Shingles and flush with Side Fascia Trim. Front Wide Corner Trim will cap Front Side Corner Trim. Attach each piece with **6 - 1 1/2" Finishing Nails**.

<p><u>Parts</u></p> <p>Front Wide Corner Trim (1/2" x 3 1/2" x 67 3/4")</p> <p>Front Side Corner Trim (Angle Cut At Top) (1/2" x 2 1/2" x 65 1/2")</p>	<p><u>Hardware</u></p> <p>1 1/2" Finishing Nails x 12 total</p>
--	--



D12. Complete other Front Corner, Side Fascia and Rear Corner Trims as per **Steps D8 - D11.**

Parts

- Front Wide Corner Trim**
(1/2" x 3 1/2" x 67 3/4")
- Front Side Corner Trim (Angle Cut At Top)**
(1/2" x 2 1/2" x 65 1/2")
- Side Fascia Trim (Angle Cut Both Ends)**
(1/2" x 2 1/2" x 36 7/8")
- Rear Wide Corner Trim**
(1/2" x 3 1/2" x 70 3/8")
- Rear Side Corner Trim (Angle Cut At Top)**
(1/2" x 2 1/2" x 70 3/8")

Hardware

- 1 1/2" Finishing Nails**
x 28 total



Rear Center Trim

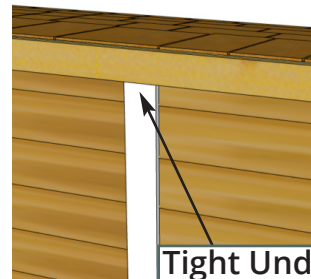

Tight Underneath Upper Rear Trim

D13. Locate **Rear Center Trim**. Align tight against Upper Rear Horizontal Trim and attach with **6 - 1 1/2" Finishing Nails**.

Parts

- Rear Center Trim**
(1/2" x 2 1/2" x 70 3/8")

Hardware

- 1 1/2" Finishing Nails**
x 6 total

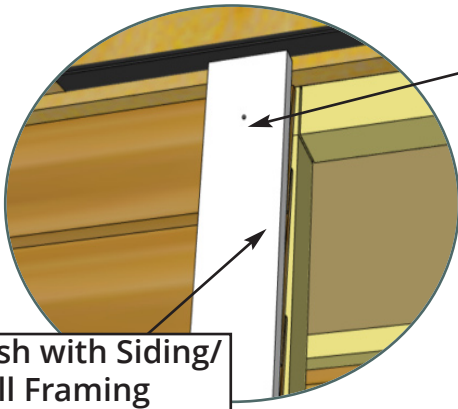

Flush with Siding/
Wall Framing

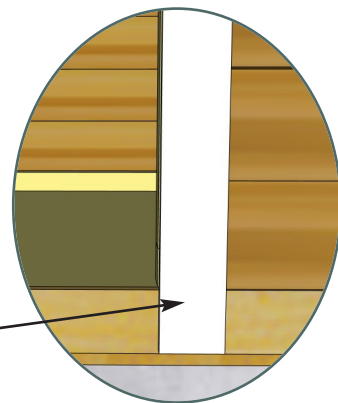
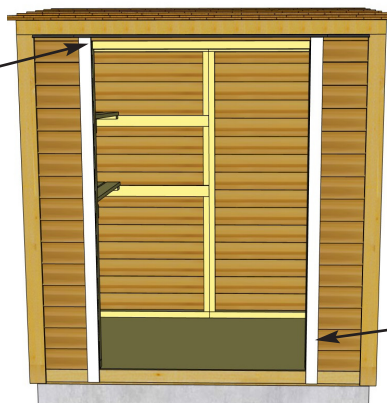

D14. Locate 2 **Vertical Door Frame Trims**. Position on Front Narrow Wall flush with Wall siding/ framing and underneath the **Metal Drip Edge**. Attach with **6 - 1 1/2" Finishing Nails**.

Parts

- Vertical Door Frame Trims**
(1/2" x 2 1/2" x 64 3/4") x 2

Hardware

- 1 1/2" Finishing Nails**
12 total

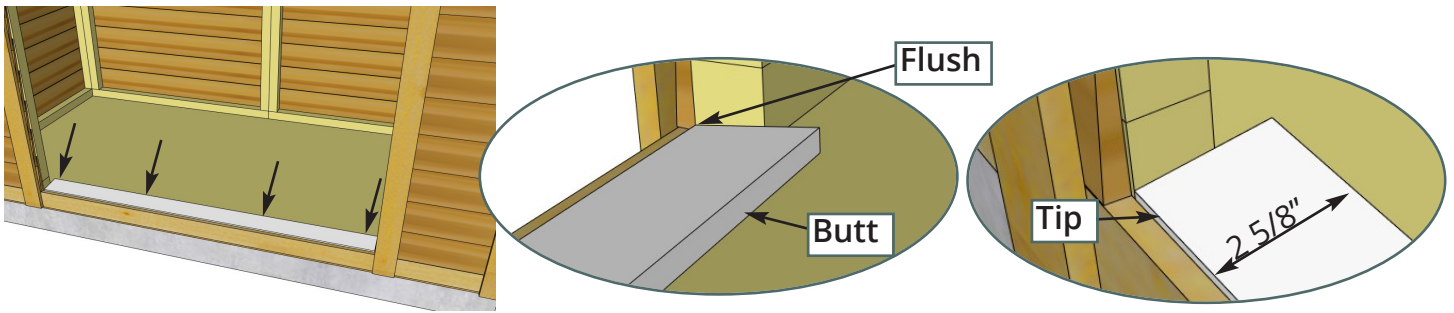

D15. Locate **Door Threshold** and position on Floor at the opening. Align tip of the bevel flush with the outside of the Bottom Wall Plate. Attach with **4 - 1 1/4" Brown Screws**.

Parts	Hardware
Door Threshold (Bevel) (1/2" x 2 5/8" x 44 7/8")	1 1/4" Brown Screws x 4 total

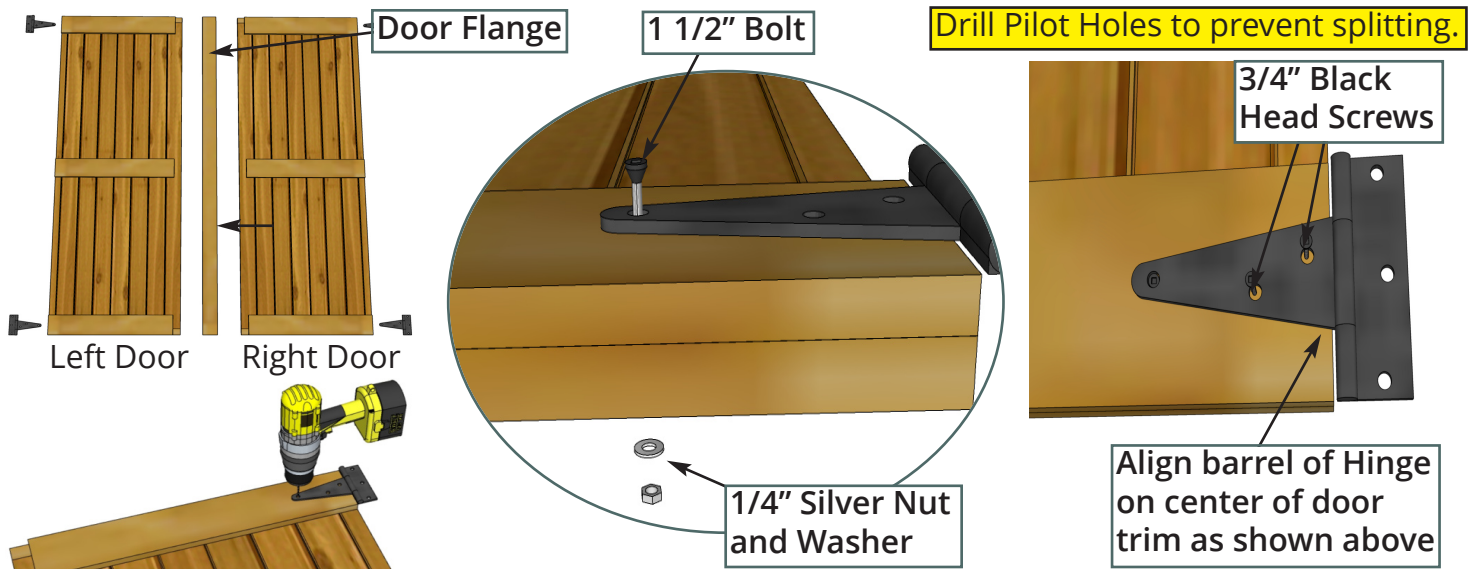

D16. Locate **Left and Right Doors** and **Door Flange**. Orientate Doors so the outside of each Door is facing up. Locate **Black T Hinges**. Prior to attaching, position Hinges equally on Door trim as shown above and with a 1/8" drill bit, drill a hole through the tip of the Hinge and all the way through the Door. Complete for all 4 hinges. Attach each Hinge to the Door as above with **1 - 1 1/2" Black Headed Bolt**, and a **1/4" Silver Nut and Washer**, using a 3/8" wrench. Finish Hinge by securing with **2 - 3/4" Black Headed Screws**. Drill small pilot holes first to prevent wood from splitting. Complete both Doors (4 Hinges).

Parts (Step D16 - D20)	Hardware (Step D16 - D20)
Left and Right Doors (22 1/4" x 61 3/8") Door Flange (1/2" x 2 1/2" x 61 3/8")	Black T Hinge x 4 total 1 1/2" Black Headed Bolt x 4 total 1/4" Silver Nut and Washer x 4 total 3/4" Black Headed Screws x 8 total 1" Silver Screws x 6 total 2" Black Headed Screws x 12 total

Hor. Door Trim Flush with Outside/ Gap Inside



Flip Left Door Over

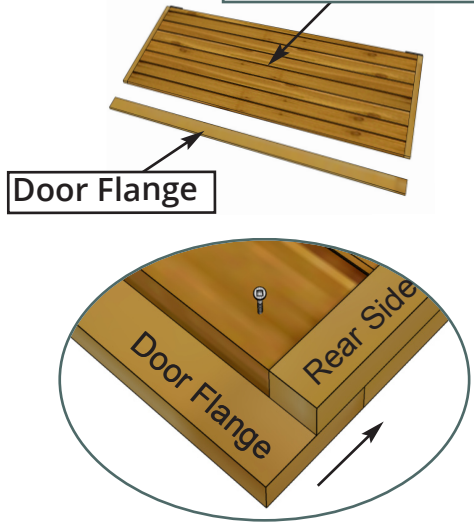

6 - 1" Silver Screws. Pre-drill to prevent splitting.

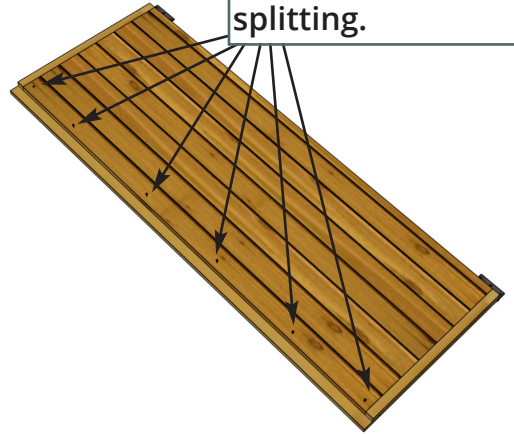

D17. Flip Left Door over to attach **Door Flange**. Position Door Flange tight against horizontal trim and even with trim on top and bottom. If out slightly, make sure top horizontal trim and Flange are even. Pre-drill with 1/8" bit to prevent wood from splitting. Attach with **6 - 1" Silver Screws**.

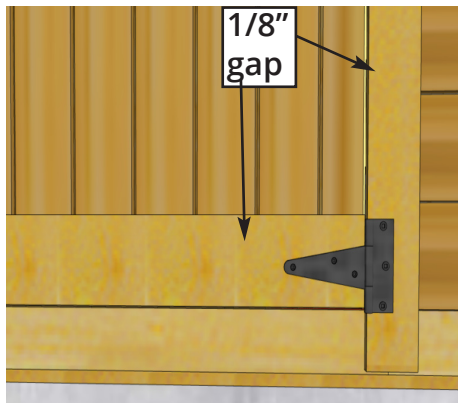

1 - 2" Screw per Hinge Initially.

D18. Starting with Right Door first, lift and position Door in opening. Leave a 1/8" gap on right side and 1/8" gap on the bottom. Use a **Cedar Shingle Shim** to shim the Door at bottom to help position door evenly. When Door is aligned correctly, screw Hinge into Vertical Door Frame Trim with **1 - 2" Black Headed Screws**. Use only 1 screw initially per Hinge until both Door alignments are confirmed. Drill pilot holes to prevent wood from splitting.



D19. Position Left Side Door (with Flange) as per **Step D18**. Once again, use only **1 - 2" Black Headed Screw** per Hinge initially to secure door to Vertical Door Frame Trim.

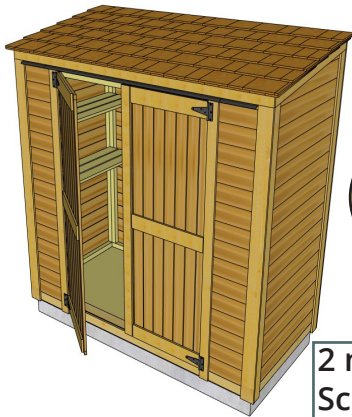

2 more - 2" Black Headed Screws per Hinge



D20. With both Doors partially attached, check to see Doors open and close correctly. Make any necessary adjustments and when satisfied, completely secure Hinges to Vertical Door Frame Trim with **two more 2" Black Headed Screws** per Hinge. Drill pilot holes to prevent wood from splitting.

D21. Attach **Door Handles** to Doors with **4 - 3/4" Black Headed Screws** per Handle. Choose desired Handle height.

Hardware
Black Handle x 2 total
3/4" Black Headed Screws x 8 total

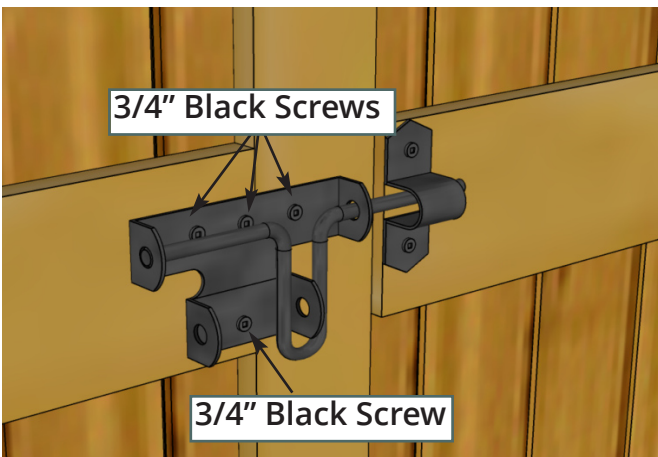

Important: Drill shallow Pilot Holes to prevent splitting.

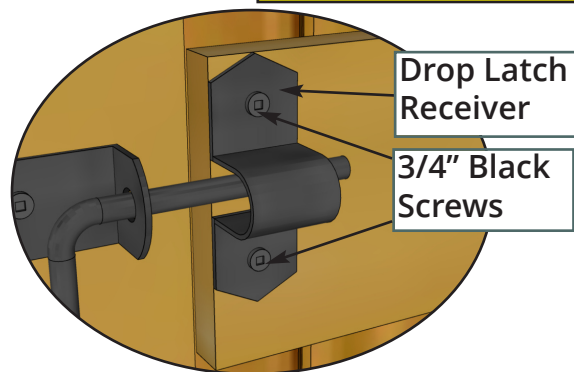

D22. Attach **Black Drop Latch** as illustrated above with **6 - 3/4" Black Headed Screws**. **Note:** Black Drop Latch receiver is positioned higher than male. Do a dry run first to position Black Drop Latch correctly. **Important** - Drill pilot holes with 1/8" drill bit prior to securing with screws to prevent wood splitting.

Hardware
Black Drop Latch
3/4" Black Headed Screw x 6 total

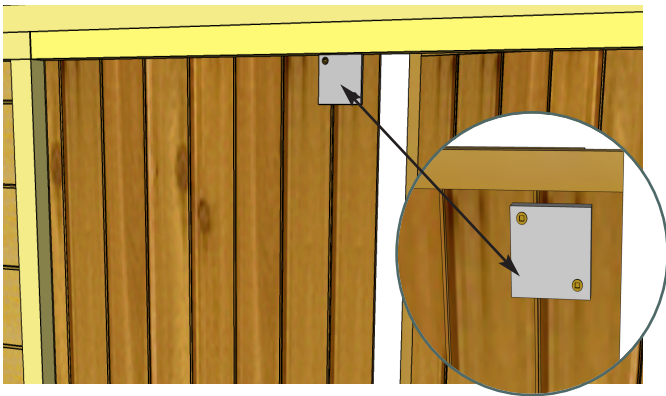

D23. Install the **Plywood Spacer** to interior door frame approximately 1 1/2" from top of door frame and 1" from edge, as pictured. Use **2 - 1 1/4" Brown Screws** to secure. Plywood Spacer should fit flush underneath Interior Door Header when Door is closed.

Hardware

Plywood Spacer (1/2" x 2 1/2" x 2 1/2")
1 1/4" Brown Screws x 2 total

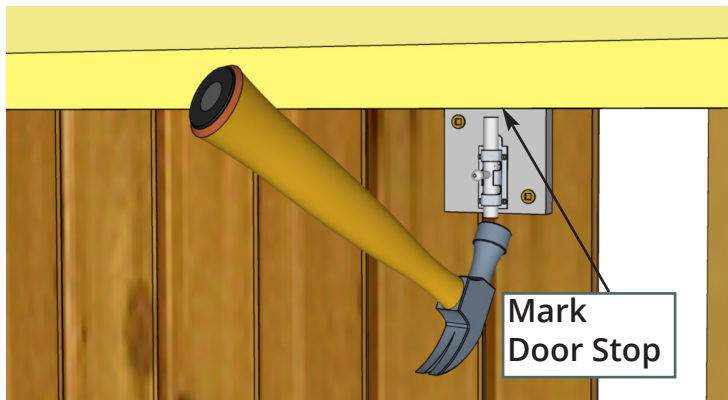
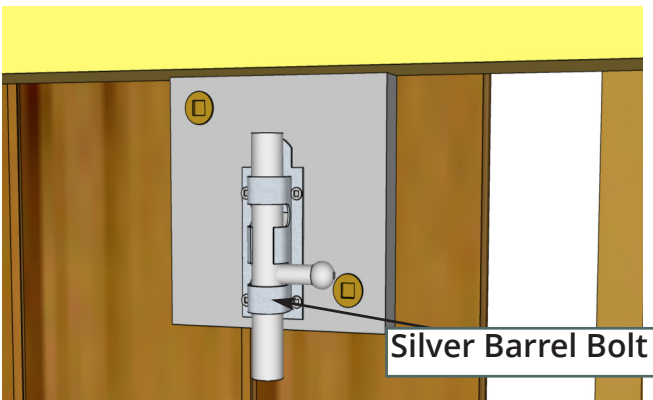

D24. Position the **Interior Barrel Bolt** on the Plywood Spacer and attach with **4 - 3/4" Silver Screws**. Tap Barrel Bolt with hammer on underside of Interior Door Header to mark location.

Hardware

Interior Silver Barrel Bolt
3/4" Silver Screws x 4 total

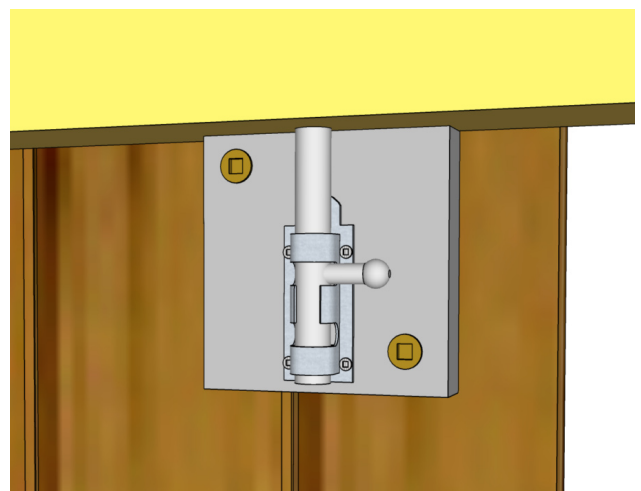
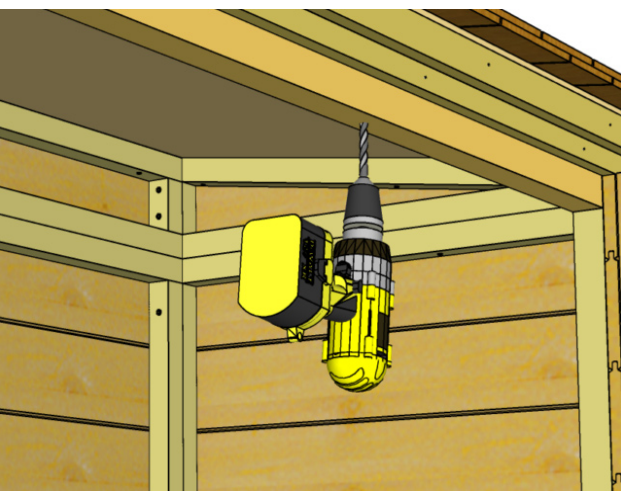

D25. Open door and drill out marked Silver Barrel Bolt impression with a 3/8" Drill Bit. Close door, slide Interior Barrel Bolt in drilled hole to confirm fit.

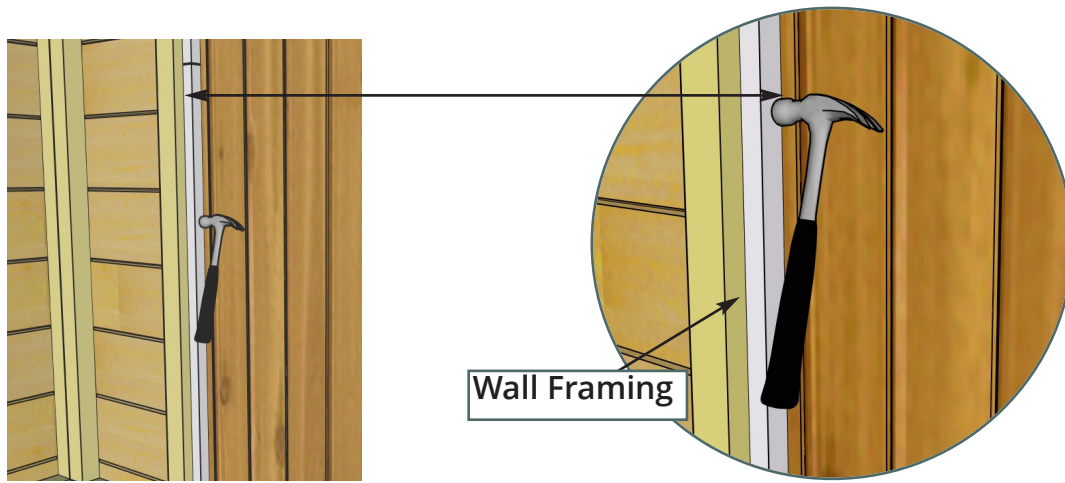

D26. Attach **Interior Vertical Door Stops** to inside Wall framing with **4 - 1 1/2" Finishing Nails** per piece. To align correctly, close door to make sure Stops are close to the door but don't interfere with their closing. Attach bottom piece first with hammer.

<u>Parts (Step D26 - D27)</u> Interior Vertical Door Stops (3/4" x 3/4" x 29 7/8") x 4	<u>Hardware (Step D26 - D27)</u> 1 1/2" Finishing Nails x 16 total
---	---

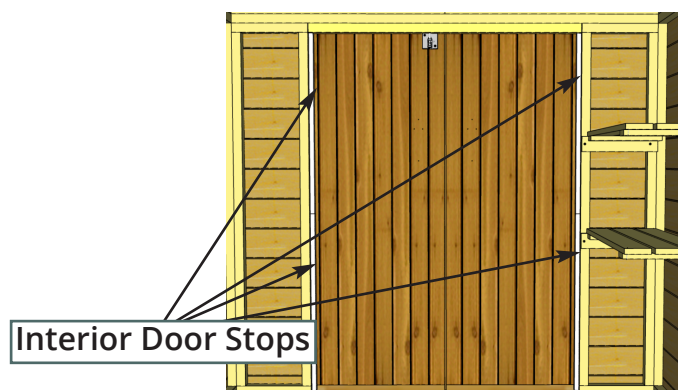
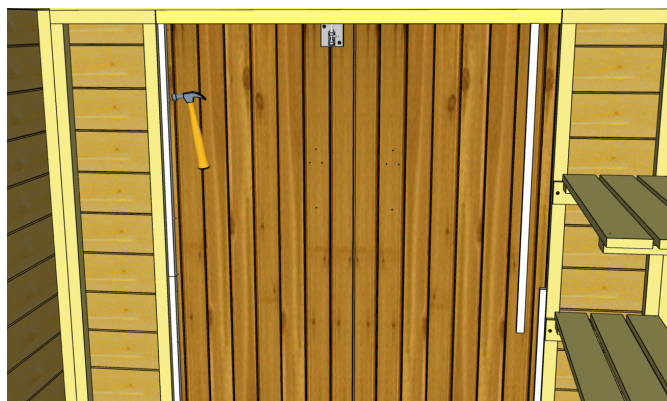

D27. Attach top Interior Door Stop as per **Step D26** and then complete the opposite side.

E. Roof Cap Section - Cedar

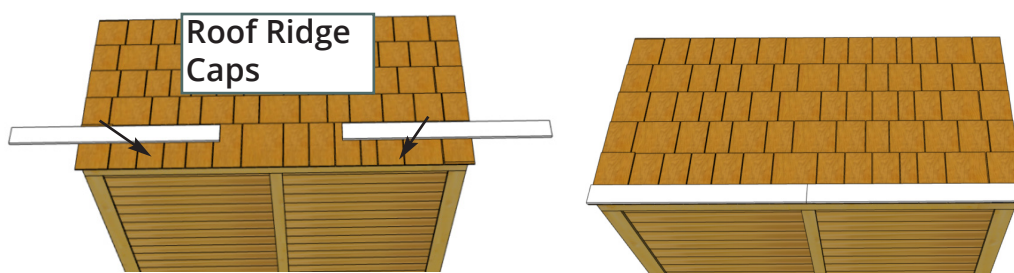

E1. Using a Step Ladder, place both **Roof Ridge Caps** on front row of Roof Shingles. Attach each piece with **4 - 1 1/2" Finishing Nails**.

<u>Parts</u> Roof Ridge Caps (1/2" x 3 1/2" x 39 1/4") x 2	<u>Hardware</u> 1 1/2" Finishing Nails x 8 total
---	---

E. Roof Cap Section - Metal

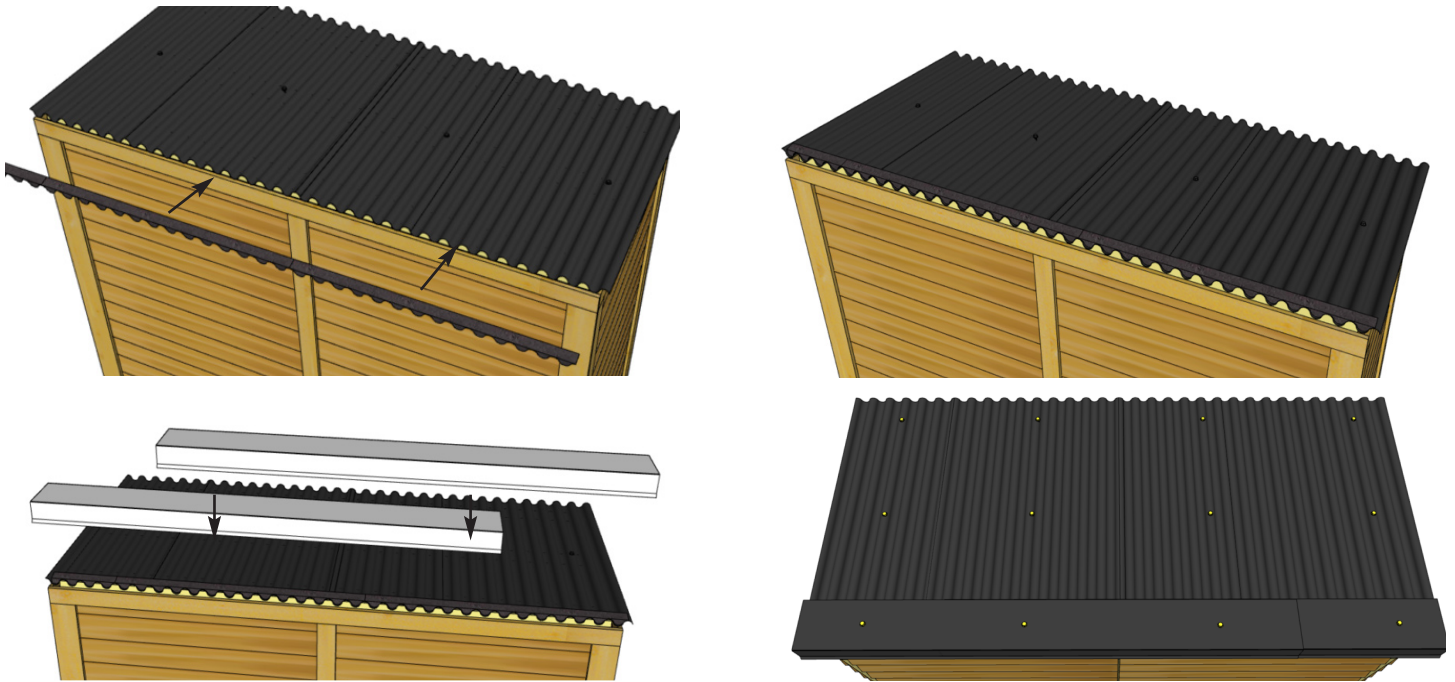

E1. Locate **Foam Enclosures** and place 3 pieces on top of Metal Roof at the rear, to go underneath the **Metal Peak Caps**. Place Metal Peak Caps on top of Foam Enclosures and evenly space from side-to-side, allowing the Peak Caps to overlap each other. Overhang each cap approximately 1" on each end. When Peak Caps are correctly positioned, secure with **4 - 2" Metal Screws**, using 1/4" Nut Driver. Screw into top most Batten. Metal screws are self-tapping, do not overtighten!

<p><u>Parts</u> Metal Peak Caps x 2 (60") Foam Enclosures x 3</p>	<p><u>Hardware</u> 2" Metal Screws x 4 total</p>
---	---

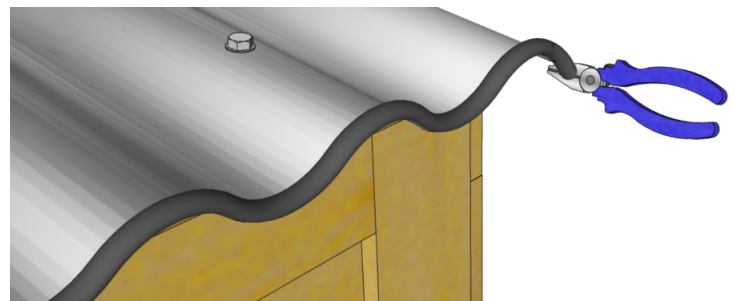
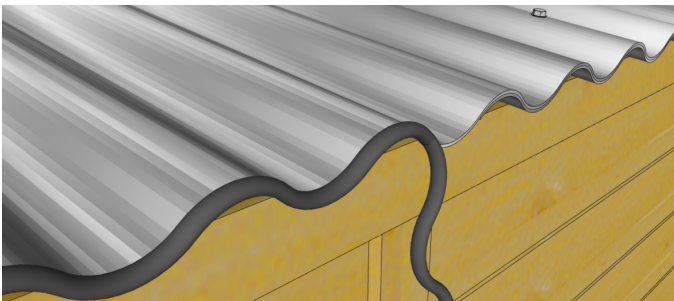

E2. Locate **Metal Roof Edge Trim** and fit along the lower edge of the Metal Roof. When the edging is in place, use pliers to cut the end to the desired length.

<p><u>Parts</u> Metal Roof Edge Trim (96")</p>
--



Outdoor Living Today

Congratulations on assembling your 6x3 Grand Garden Chalet!

Note: Our Sheds are shipped as an unfinished product. If exposed to the elements, the lumber will weather to a silvery-gray color. If you prefer to keep the lumber looking closer to the original color, we suggest that you treat the wood with a good oil base wood stain. You may also wish to paint your new shed rather than stain it. In both cases we recommend that you consult with a paint and stain dealer in your area for their recommendations.



We hope your experience constructing our **6x3 Grand Garden Chalet** has been both positive and rewarding. We value your feedback and would like to hear back from you on how well we are doing in the following areas:

- 1. Customer Service**
- 2. On Time Shipping**
- 3. Motor Freight Delivery**
- 4. Quality of Materials**
- 5. Assembly Manual**
- 6. Overall Satisfaction**

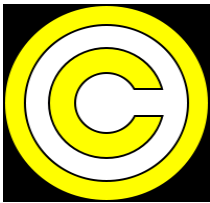

The materials contained in this Assembly Manual may be downloaded or copied provided that ALL copies retain the copyright and any other proprietary notices contained on the materials. No material may be modified, edited or taken out of context such that its use creates a false or misleading statement or impression as to the positions, statements or actions.

Please call, write or email us at:

Canadian Address
9393 287th Street
Maple Ridge, British Columbia
Canada V2W 1L1

United States Address
P.O. Box 96
Sumas, Washington
USA 98295

Toll Line: 1.888.658.1658

Fax: 1.604.462.5333

sales@outdoorlivingtoday.com

Toll Free 1-888-658-1658

www.outdoorlivingtoday.com

sales@outdoorlivingtoday.com