

5-SHELF STEEL STORAGE UNIT

Important Safety Information



Read through this entire manual for important guidelines and instructions prior to assembly. Failure to follow these guidelines and instructions can result in property damage or serious personal injuries.

This unit should be placed on a level surface. Failure to do so can result in poor product performance or create a possible safety hazard. **DO NOT CLIMB, STAND or USE THIS UNIT AS A LADDER. TO PREVENT TIPPING, ALWAYS SECURE TO A WALL WITH SUITABLE FASTENERS, NOT INCLUDED. DO NOT USE THIS UNIT TO STORE AQUARIUMS. CAUTION: CONTAINS SMALL PARTS, KEEP CHILDREN AWAY DURING INSTALLATION. USE TWO OR MORE PEOPLE TO ASSEMBLE AND MOVE THE UNIT TO AVOID INJURY.** Do not use this unit for anything other than the manufacturer's intended purpose. Use care when working with metal parts, wear gloves for protection. Periodically inspect the unit to ensure brace/beam rivets are properly seated into post slots. Keep this manual for future reference.

Do not exceed the maximum weight capacity of 1,000 lbs (453 kg) for each shelf, not to exceed 5,000 lbs (2,267 kg) for the entire shelving unit. Evenly distribute weight loads across entire shelf surface. Always store larger, heavier items on the bottom levels and small lighter items on the upper levels.



Warranty

products are guaranteed for a period of one (1) year from the date of purchase. The **SOLE AND EXCLUSIVE REMEDY** for such defects is the repair or replacement of a defective product or parts thereof refund of the purchase price upon return of the item . This warranty shall not apply in the event the products are damaged as a result of misuse, neglect, accident, moisture, improper application,

Parts List

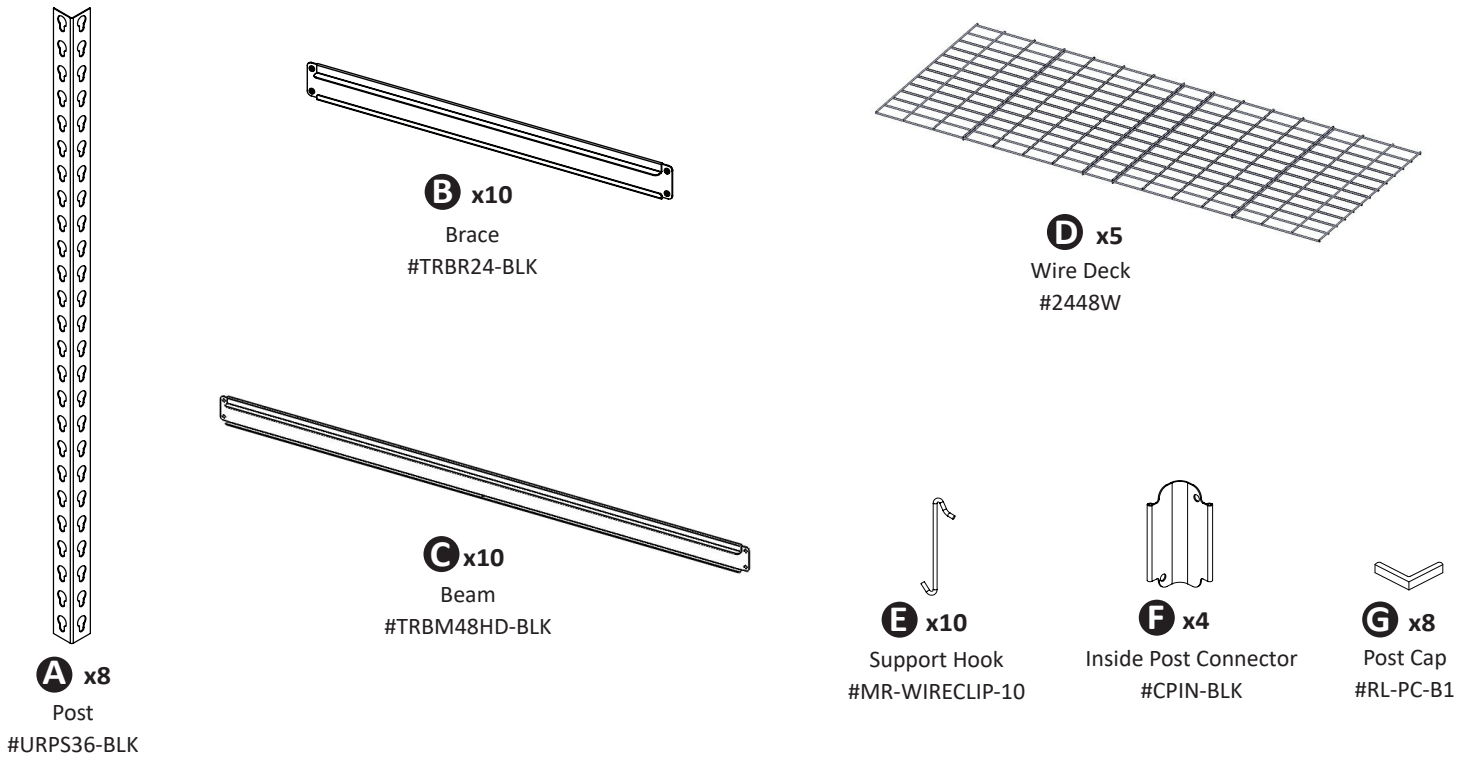

Preparation

Before beginning assembly, read through the instructions and make sure all parts are present. Assembly of this unit is done by fitting the two rivets of the braces (B) and beams (C) into the keyhole slots of the post (A). The narrow end of the keyhole slots from the post must face down (see FIG.1). Braces and beams must be installed with the longer ledge facing up on the inside. Assemble the unit from bottom to top. It is recommended that the bottom shelf assembly be installed into the second keyhole slots at the bottom of the posts and the top shelf assembly should be installed into the first keyhole slots at the top top of the posts. The middle shelves should be evenly spaced. A rubber mallet may be used to tap down on the top of the braces and beams to properly seat the rivets down into the narrow end of the keyhole slots (see FIG. 2 and FIG. 3). A visual inspection should be made to ensure that the rivets are properly engaged into the keyhole slots.

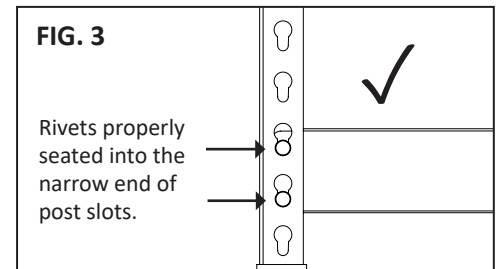
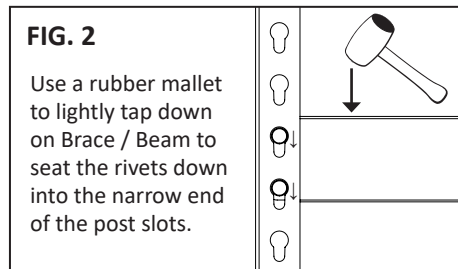
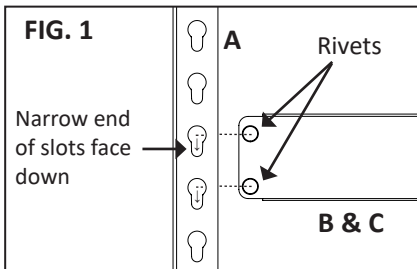

ALTERNATE ASSEMBLY

This unit can also be assembled as two separate 36 in. high units (see FIG. 4). One unit will have three shelves and the other will have two shelves. If choosing this option, follow assembly steps 2, 3, 4, 5, 6 and 10 until all shelf levels are completed for both units. Note: Use all 8 of Post Caps (G) in final step 10. Inside Post Connectors (F) are not used for this setup.

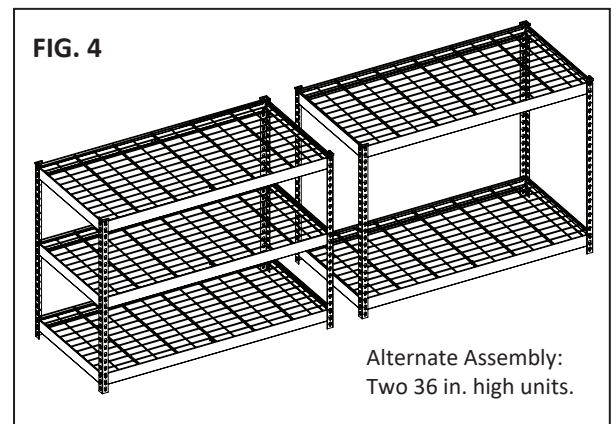

HELPFUL TOOLS/ITEMS FOR ASSEMBLY (NOT INCLUDED):



Rubber Mallet



Gloves

Assembly

1 Assemble A (x4) and G (x4)

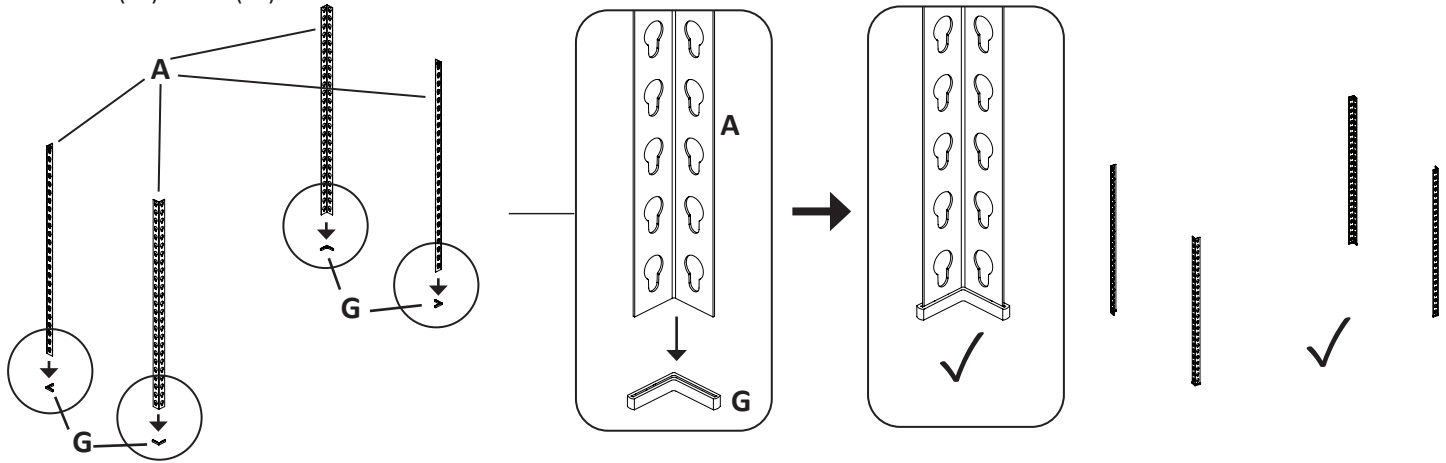

2 Assemble B (x2)

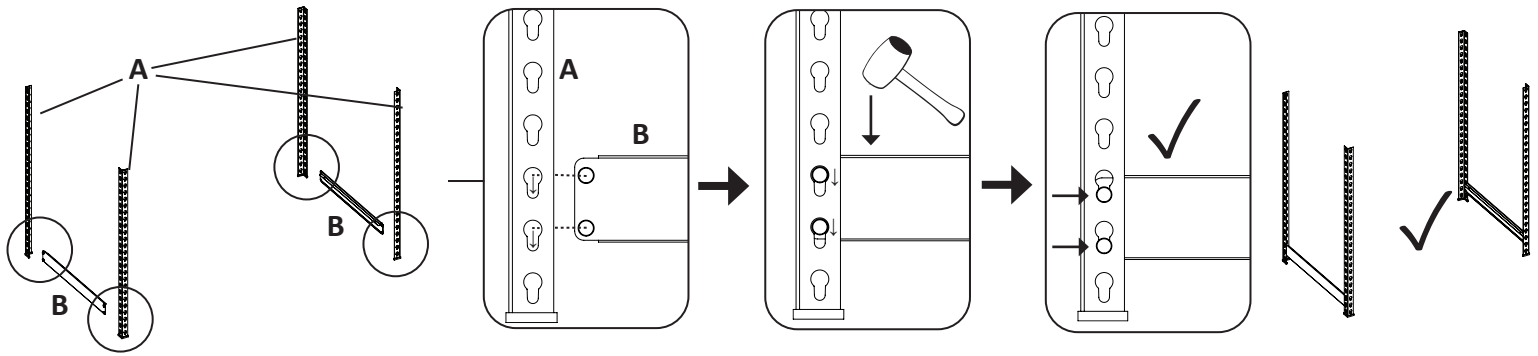

3 Assemble C (x2)

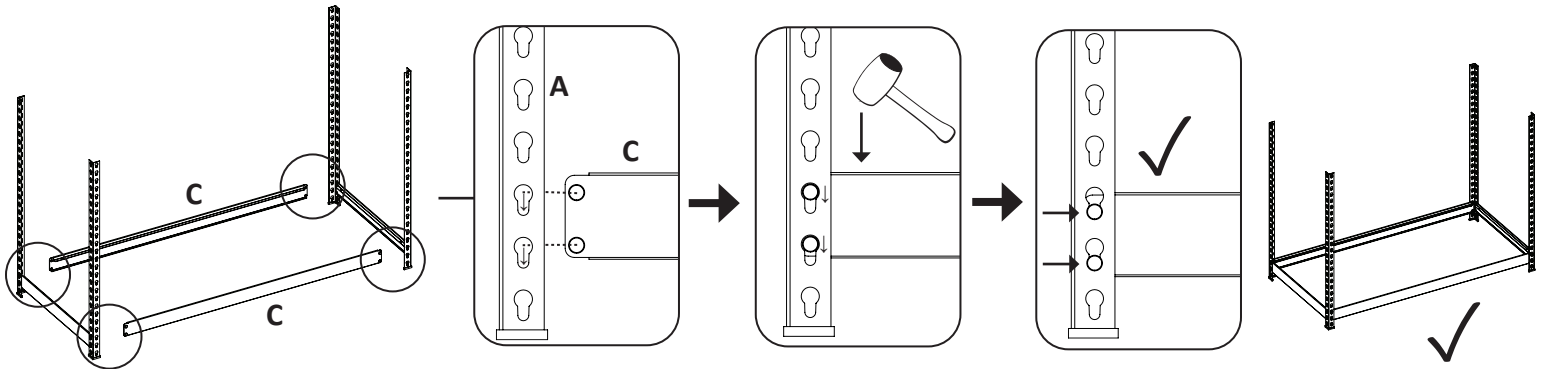

4 Assemble D (x1)

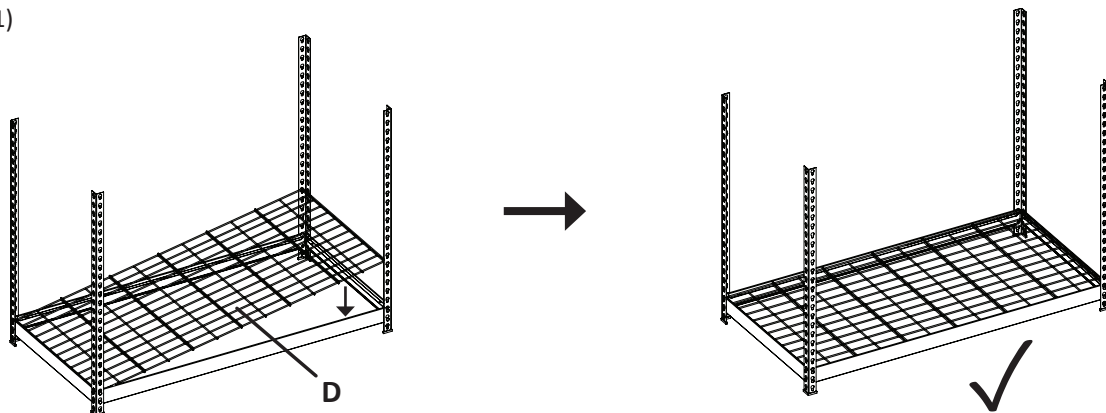

Assembly

5 Assemble E (x2)

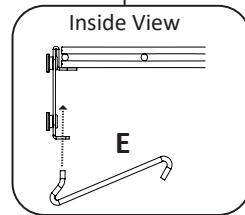
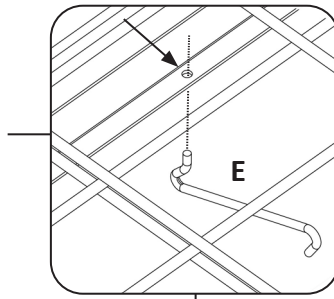
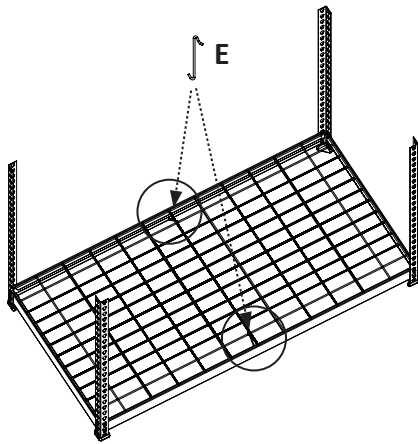

Insert Hook (E) into the hole located in center of beam's bottom ledge.

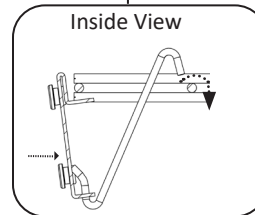
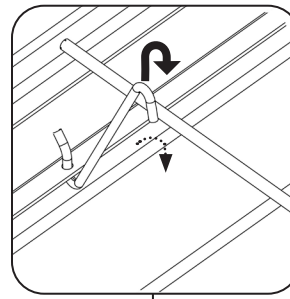

Attach the top of the Hook over the wire deck. Push the beam slightly inward if needed.

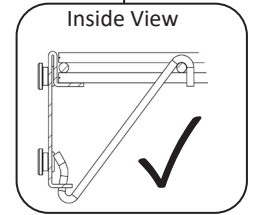
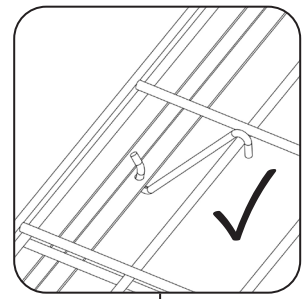

Hook correctly engaged into the beam and on the wire deck. Repeat for other side.

6 Assemble next shelf level by repeating same steps as 2, 3, 4 and 5 at the desired location

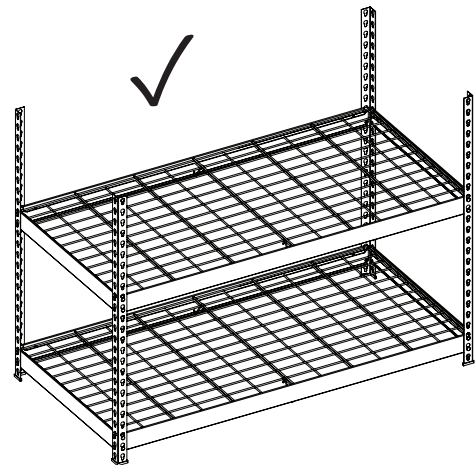
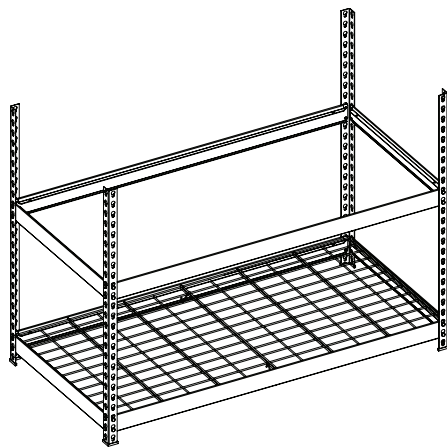

7 Assemble F (x4) to the assembled four posts

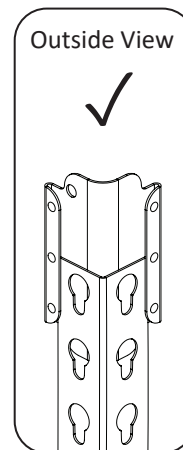
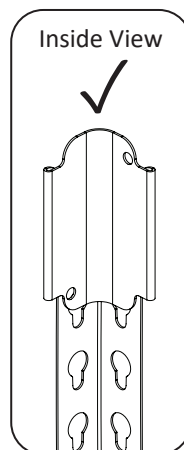
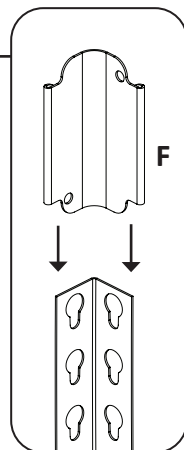
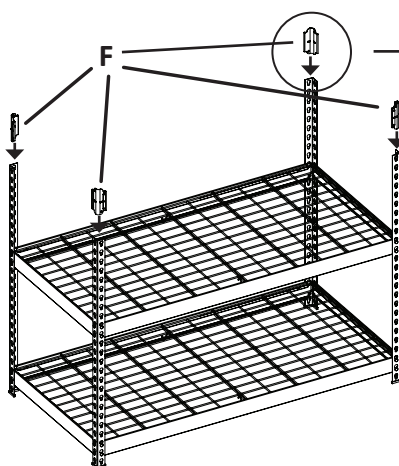

Note: A rubber mallet may be used to help secure the post connectors halfway onto the posts by **lightly** tapping down on the post connector once it is attached to the post.

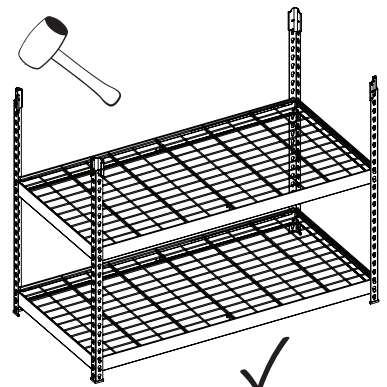

Assembly

8 Assemble A (x4) to the four assembled inside post connectors

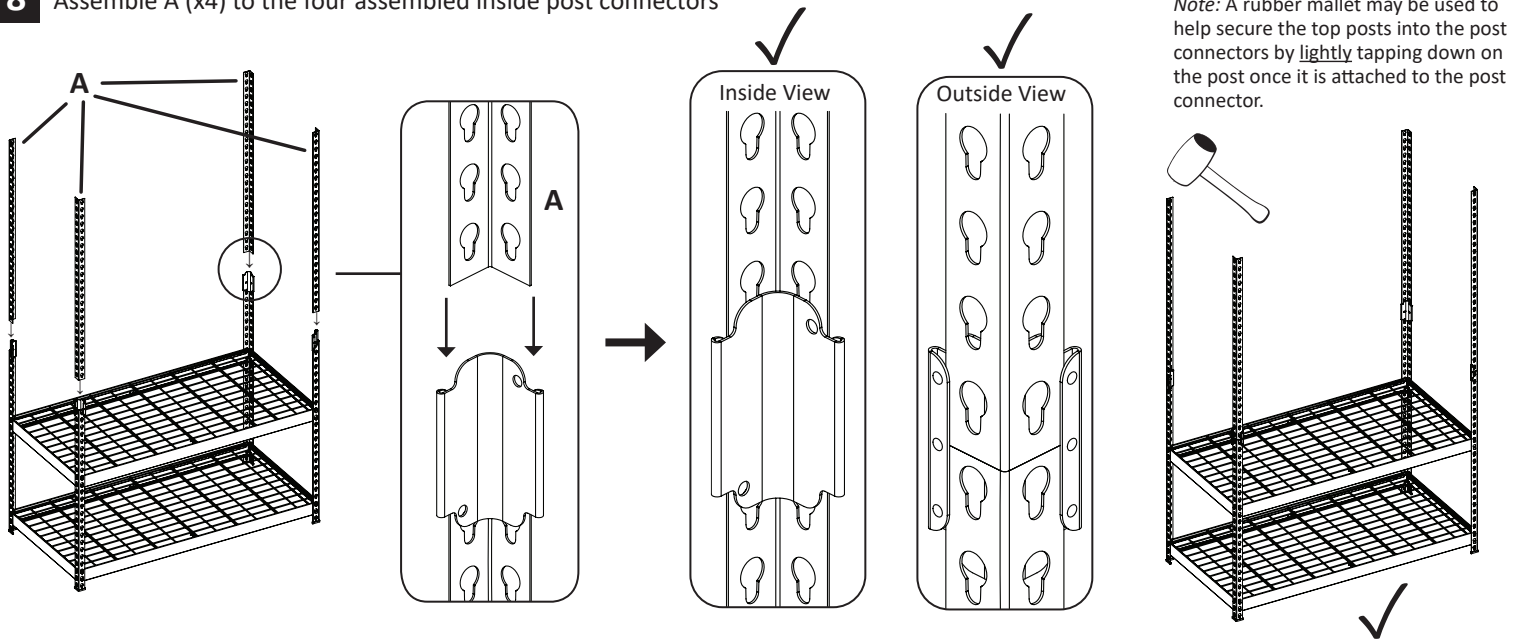

9 Assemble the final three shelf levels by repeating same steps as 2, 3, 4 and 5 at the desired location, using B (x2), C (x2), D (x1) and E (X2) per level

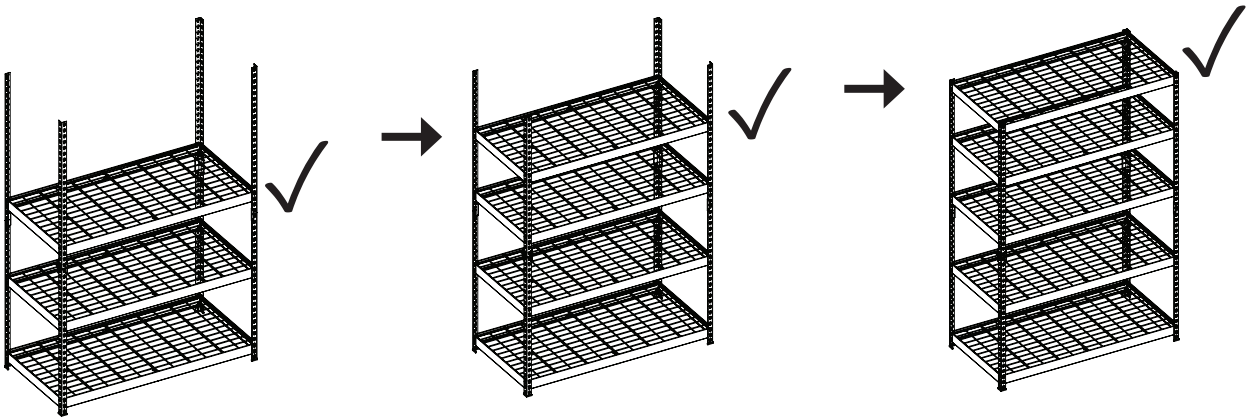

10 Assemble G (x4) to the top of the assembled four posts

