

ASSEMBLY INSTRUCTIONS: CHAIRS

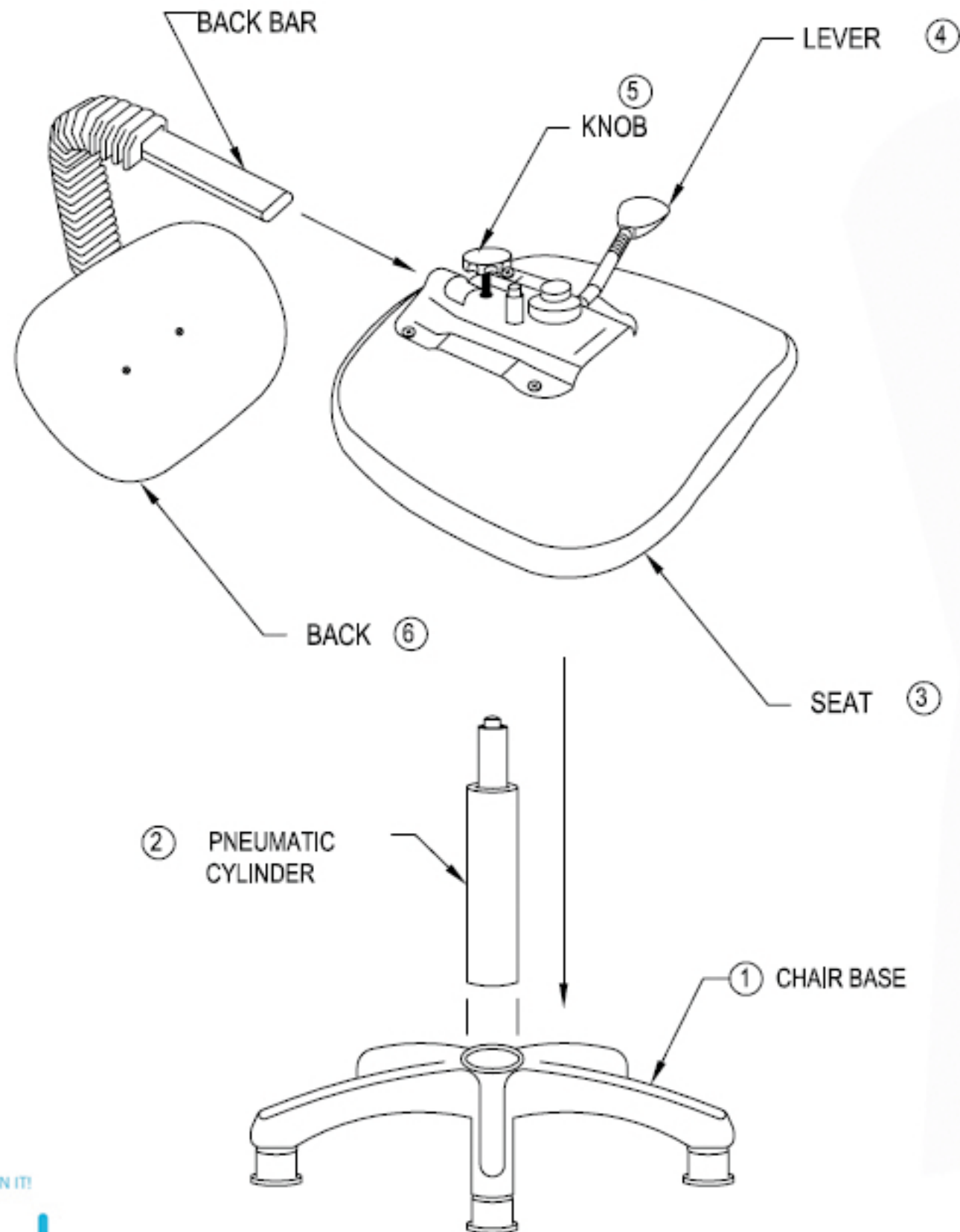

Figure 1

- 1) Remove base, pneumatic cylinder, and seat from box.
- 2) Place base with legs on hard level surface (see figure 1).
- 3) Insert pneumatic cylinder as shown in (figure 1) into center hole of base and lightly push down.
- 4) Turn seat upside down to assemble back.
- 5) Loosen knob (5) counter clockwise slightly just to allow the back extension plate to slide into the mounting plate of the seat. Push in until you here it click. Then tighten by turning knob (5) clockwise, do not overtighten.
- 6) Turn seat and back over and align the center hole on the bottom of the seat with the top of the extension rod and lightly push down. With the weight of your body, carefully sit on the seat. This will press the base, extension rod, and seat together.
- 7) To raise the height of the chair simply pull up on lever (4). No weight or force is required.
- 8) To lower the height of your chair, while seated on chair, pull up on lever (4).
- 9) Get on it! Enjoy!