

Assembly Instructions

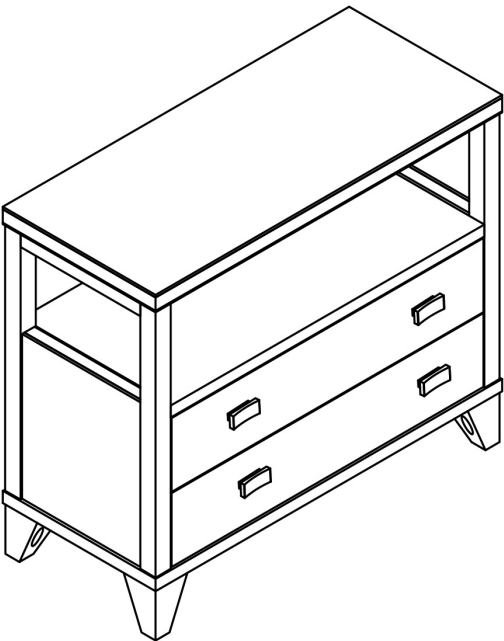

ITEM	DESCRIPTION	QUANTITY
A	Table	1
B	Legs	4

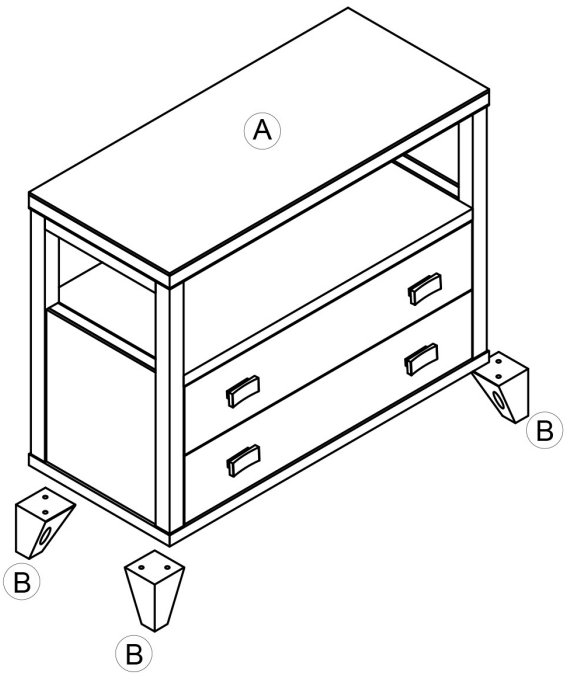

hardware



H1 x 8
bolts M6 x 45mm



H2 x 8
flat washers



H3 x 1
hex key #4

Step 1

1. For Installation of this table, two people are needed until the assembly is complete.
2. Attach the  drawer.
3. Remove the feet from the drawer.

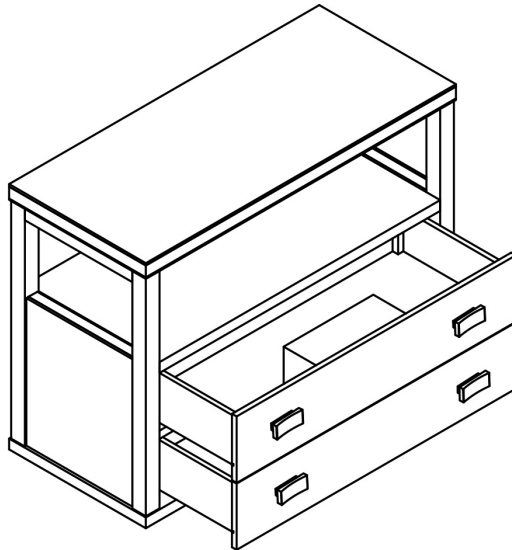

Step 2

1. To attach the legs, insert bolts through washers and into pre-drilled holes on legs and tighten using the hex (allen) key.

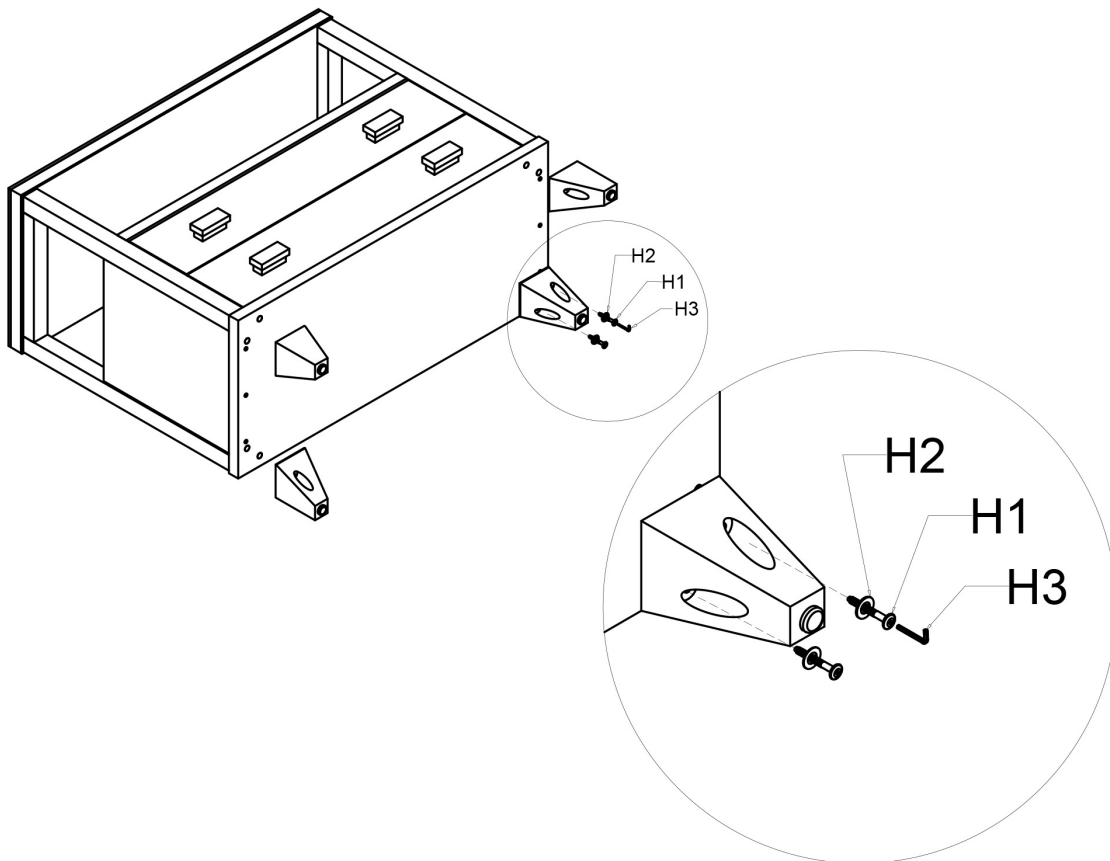

Step 3

1. After completing installation of the legs, turn the table right-side up.

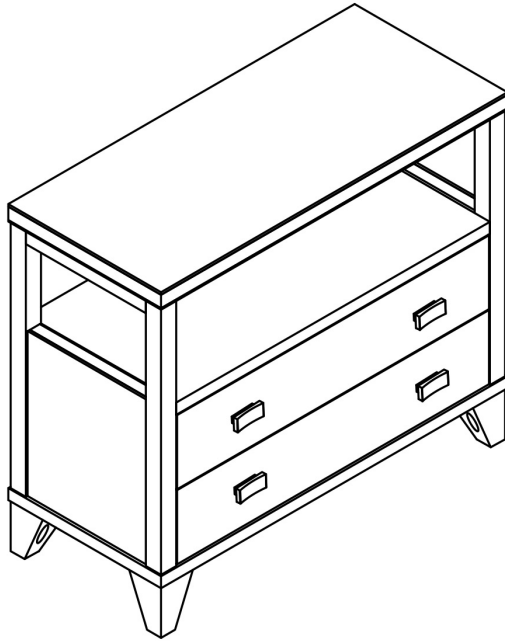

Step 4

1. Install Belt (A) to back of table (A) using one (1) Washer (D) and the short Screw (E)
(see picture).
2. Pre-drill two pilot holes into drywall, aligned with top holes of Belt (A). Holes should be the same diameter as the Drywall Anchor (B).
3. Insert Drywall Anchors (B) into pilot holes.
4. Insert Long Screws (C) into top holes on Belt (A) and into Drywall Anchors (B), tighten Long Screws to secure to wall.

