

ASSEMBLY MANUAL

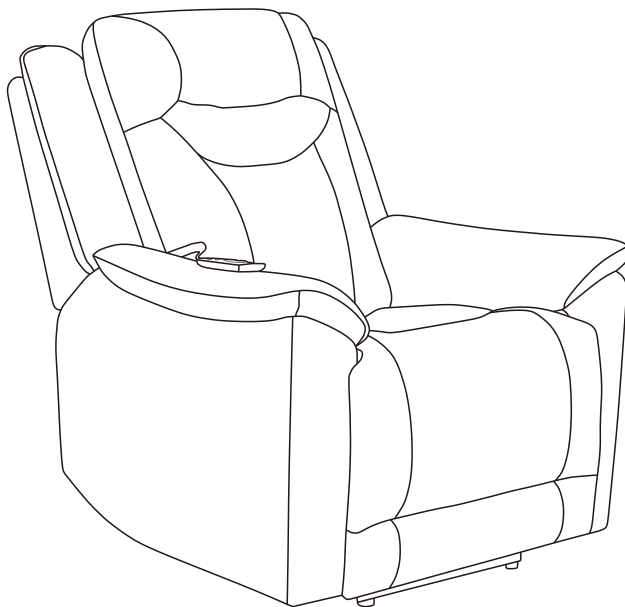

▲ CAUTION

This Assembly Manual Contains Important Safety Information.
Please Read and Keep for Future Reference

Hardware List

A

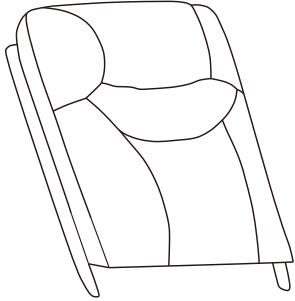

x1

B

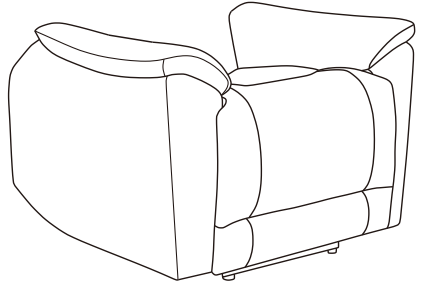

x1

C

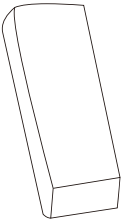

x2

D

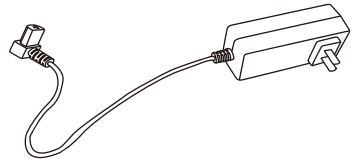

The power box is located on the bottom of the item.

x1

1

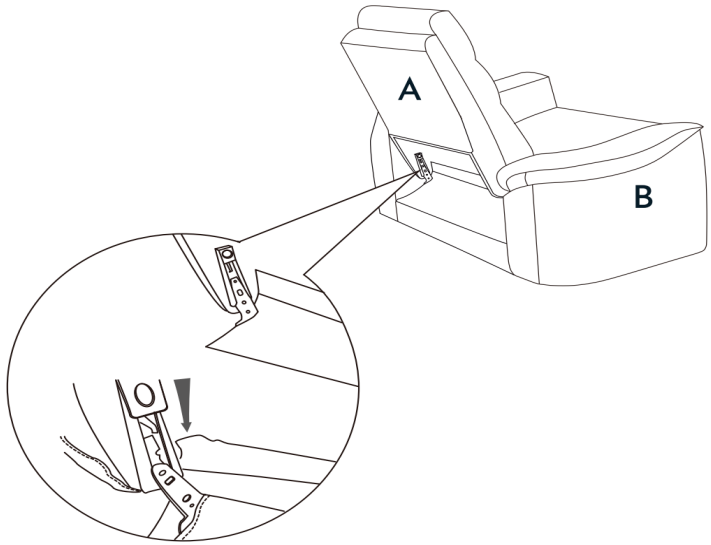

2

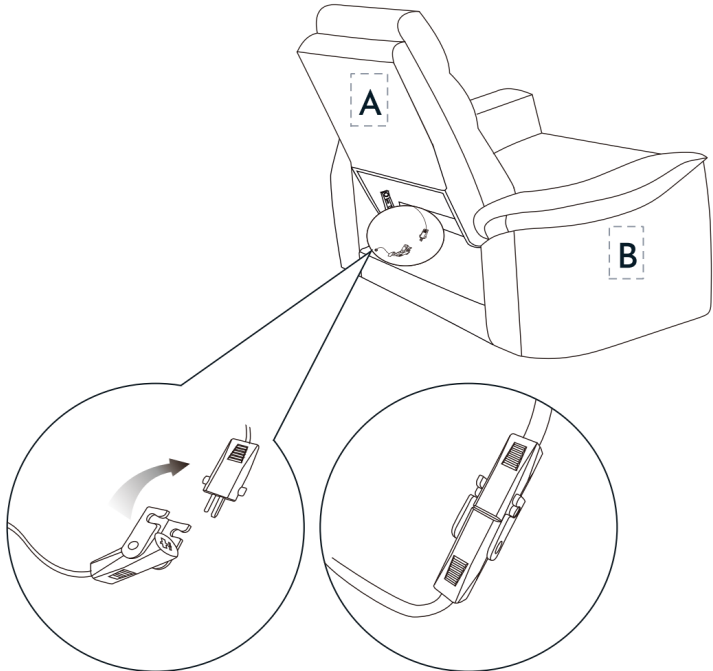

3

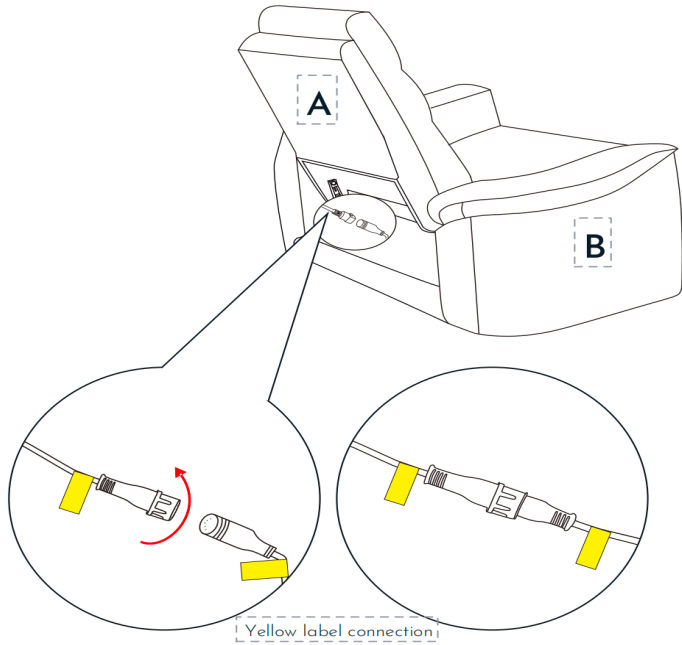

4

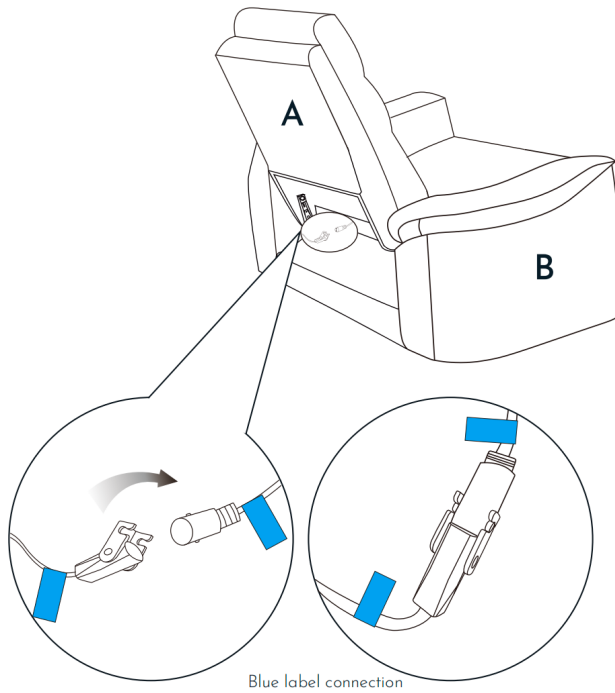

5

Affix back cover to bottom of the frame using the built in hook and loop fastener strip.

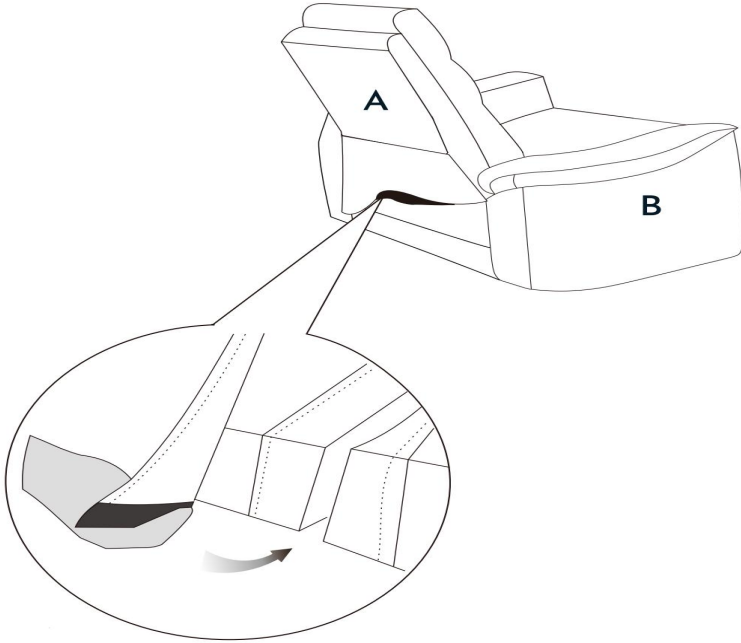

6

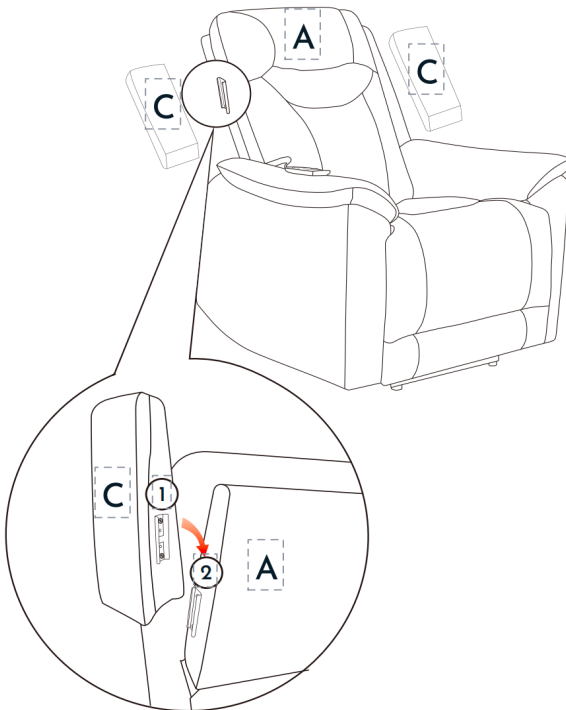

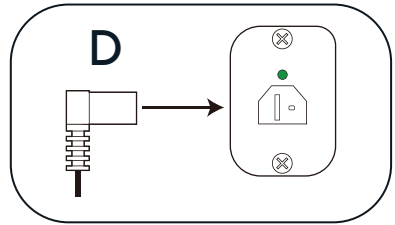
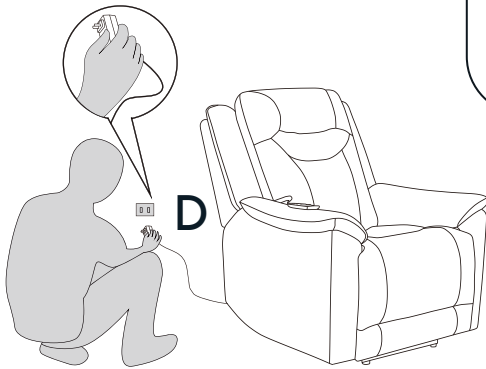

Manual Controller

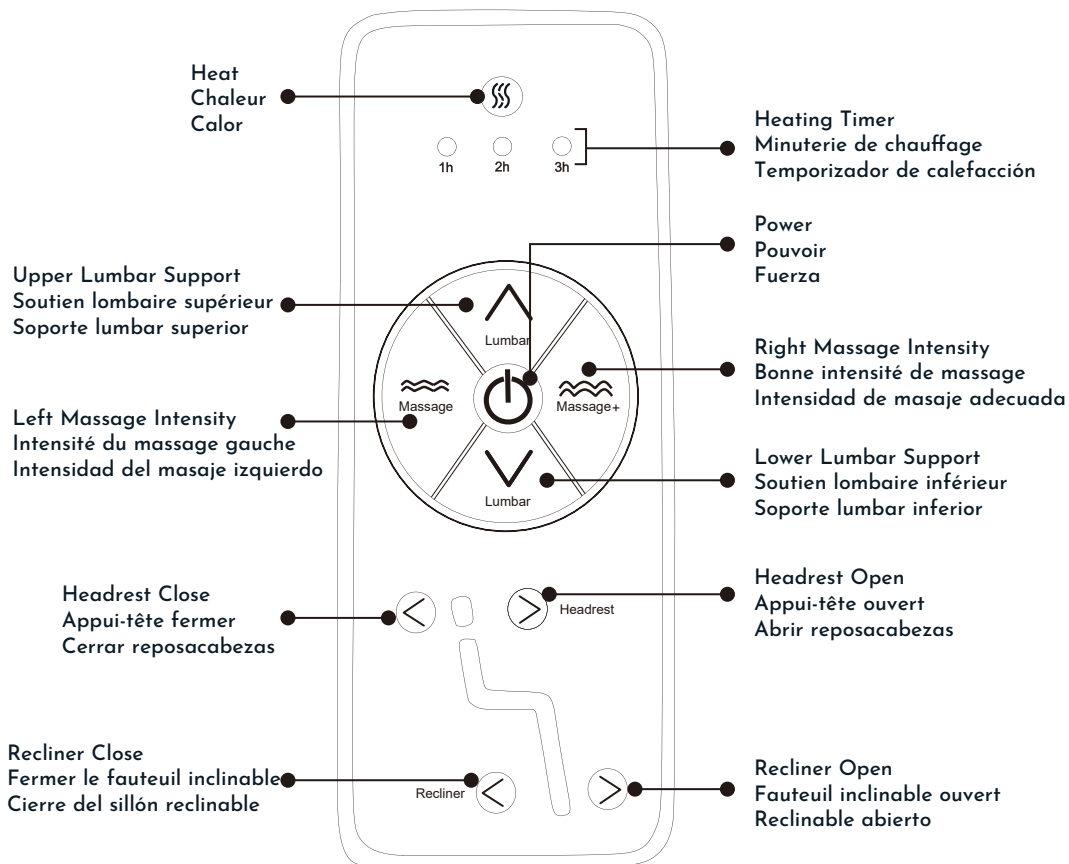

PRODUCT WARRANTY

- 1-year limited on leather against splitting, peeling, and/or tearing
- 1-year limited on internal and external frame structure.
- 1-year limited on cushioning material, seat springs and mechanism.

CARE & MAINTENANCE

- Periodic dusting will prolong the life of your leather.
- General cleaning can be done with a damp, clean, soft white cloth.
- Periodically, a mild leather cleaner can be used on the headrests and armrests. This will help prevent buildup of body and hair oils which can harm the leather over time.
- For more stubborn stains, a mild leather cleaner can be used or consult a professional leather technician.