

# ASSEMBLY AND INSTALLATION INSTRUCTIONS

**WARNING:** TO AVOID RISK OF ELECTRICAL SHOCK, BE SURE TO SHUT OFF POWER BEFORE INSTALLING OR SERVICING THIS FIXTURE.

AA  
3X

BB  
2X

CC  
2X

DD  
2X

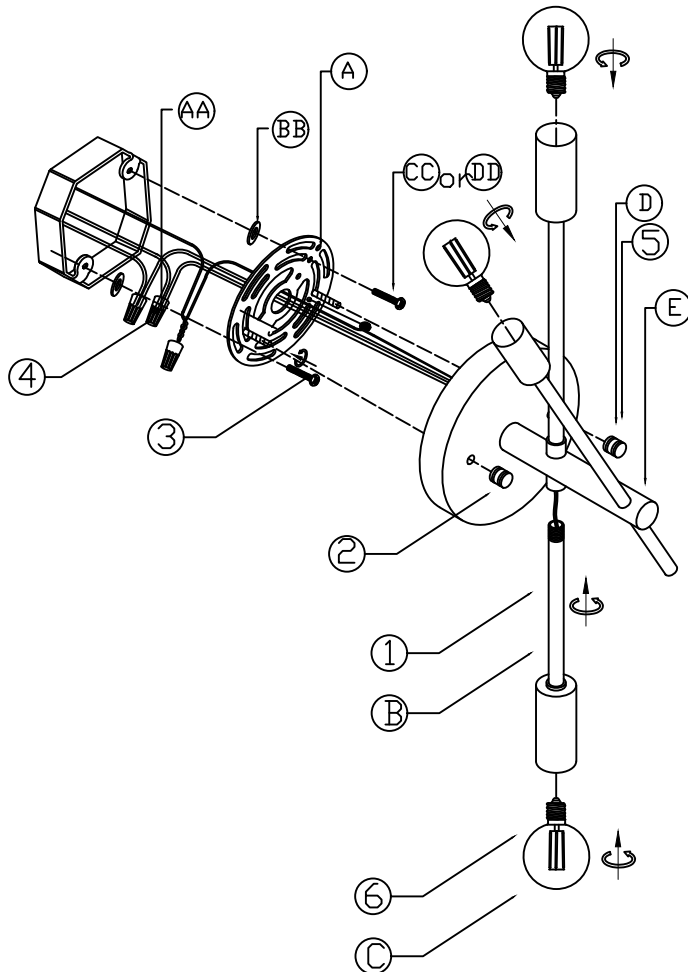

## Before You Begin:

- Ensure power is turned off at the circuit breaker before installation.
- Read all instructions carefully.
- Installation should be performed by a qualified electrician if you are unfamiliar with wiring.

## Step-by-Step Installation:

1. Secure the lamp arm: Tighten the lamp arm (B) onto the lamp body (E).
2. Remove the mounting plate: Rotate the lock bead (D) to detach the mounting plate (A) from the lamp body (E).
3. Fix the mounting plate: Use the provided screws (CC or DD, selected based on your junction box depth) and washers (BB) to secure the mounting plate (A) to the electrical box.
4. Connect the wires: Use the wire connectors (AA) to connect the incoming and outgoing wires. (Note: Connect positive to positive (live), negative to negative (neutral), and ground to the grounding terminal. Ensure no wires are exposed during connection.)
5. Secure the lamp body: Rotate the lock bead (D) to fix the lamp body (E) onto the mounting plate (A).
6. Install the light source: Install the light source (C) (fixtures only, bulbs not included).

## Safety Instructions:

**To avoid fire, shock, and serious personal injury, follow all instructions carefully.**

1. Do not install or use the light fixture if any part is missing or damaged.
2. To avoid possible electrical shock, be sure electricity is turned off at the main fuse or circuit breaker box before wiring.
3. Make certain no bare wires are exposed outside the wire connectors.
4. All wiring must conform to national and local electrical codes.
5. Follow the recommended instructions for the proper method of wiring your new light fixture. If you feel you do not have enough electrical wiring knowledge or experience, have your light fixture installed by a licensed electrician. Any electrical work not described in this manual should be performed by a licensed electrician.