

# Assembly Instruction

<b>A</b> 	<b>B</b> 	<b>C</b> 	<b>D</b> 	<b>E</b> 
Chair base	Backrest	Armrest	Remote control	Power cord

## STEP 1

Connect the two armrests to the zippers of the armrests, making sure the zippers are in place

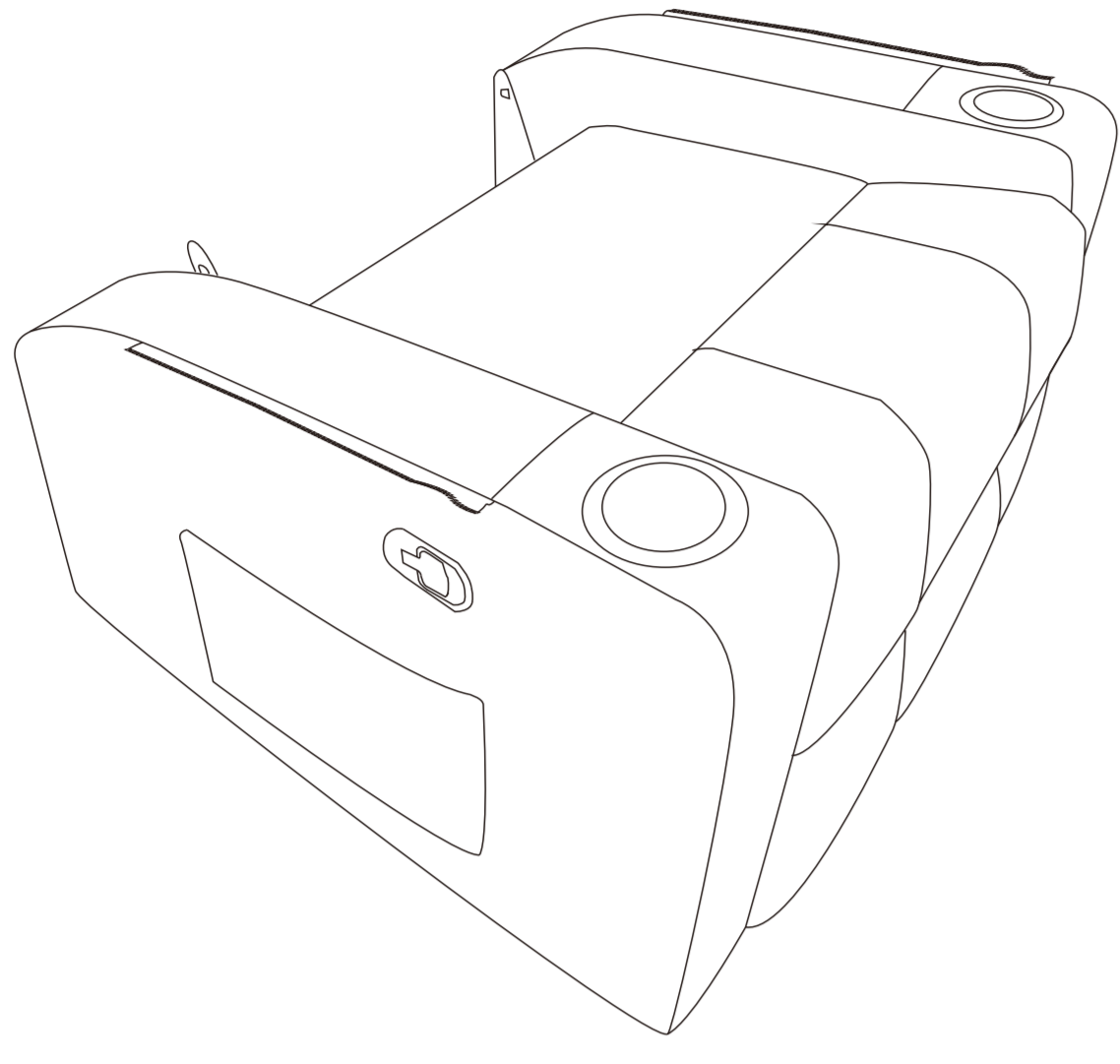
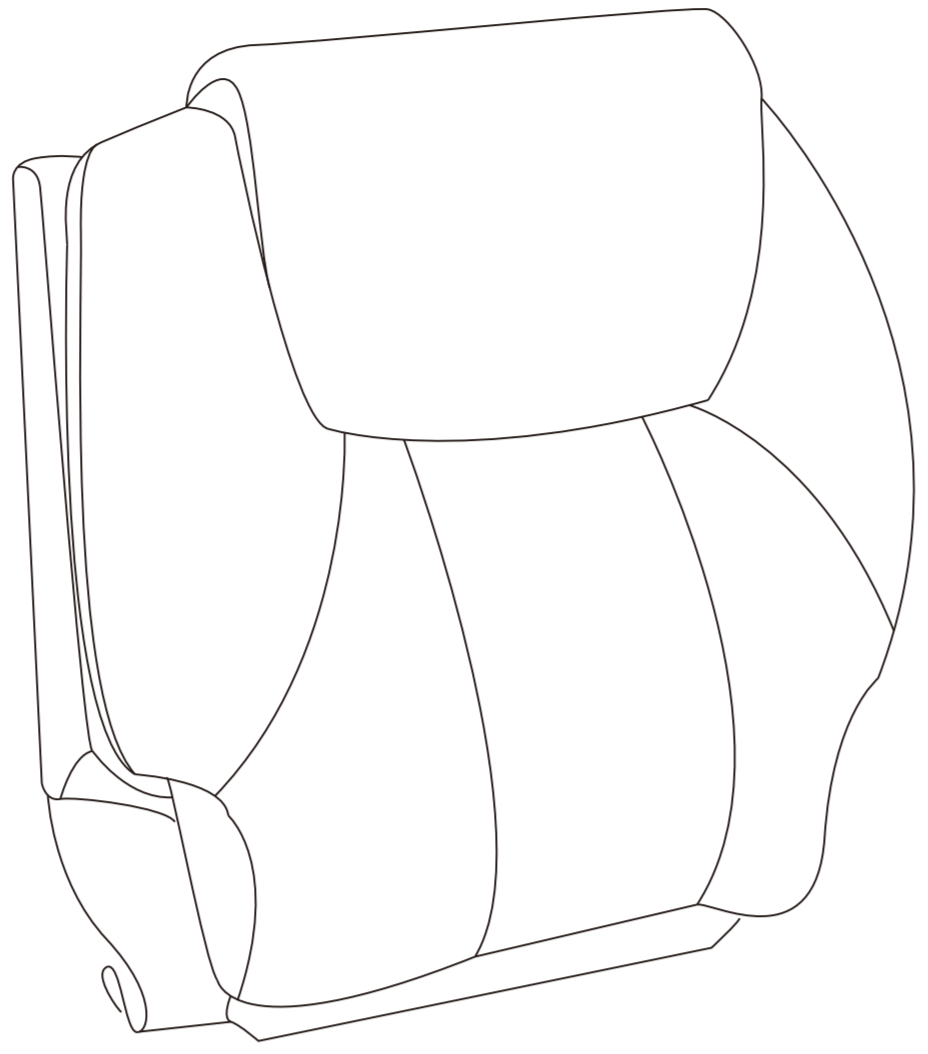
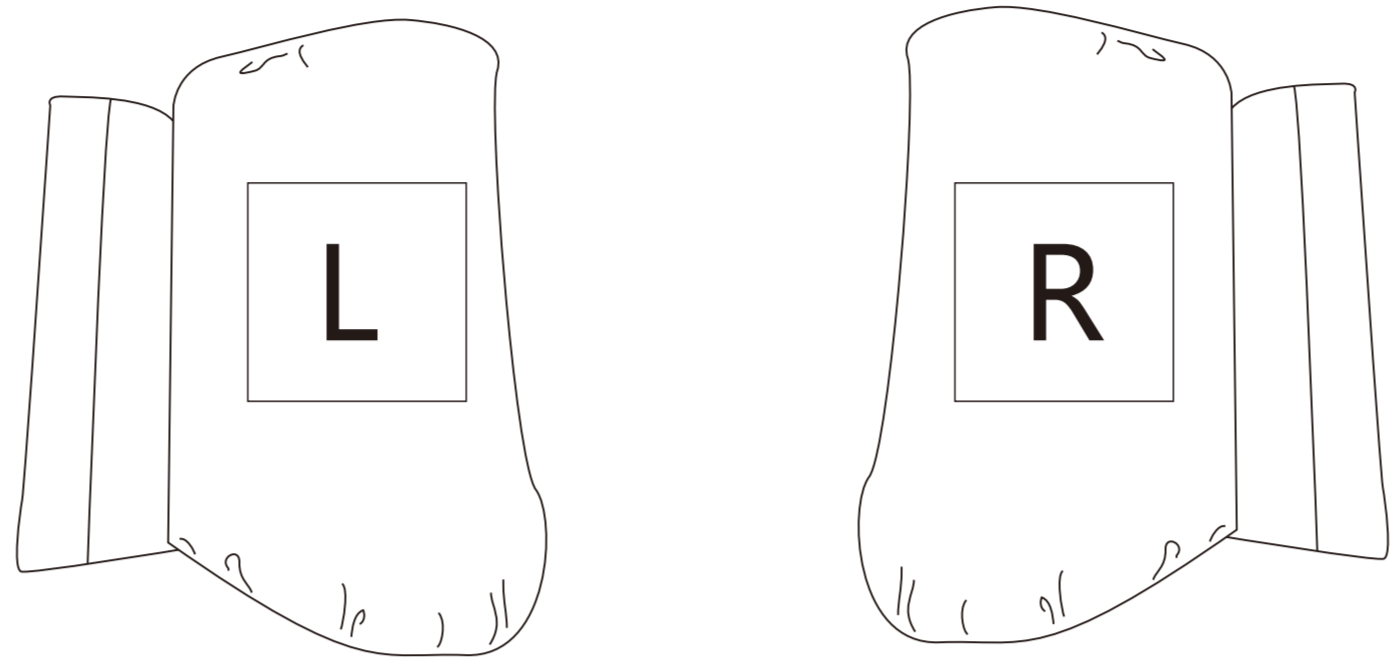
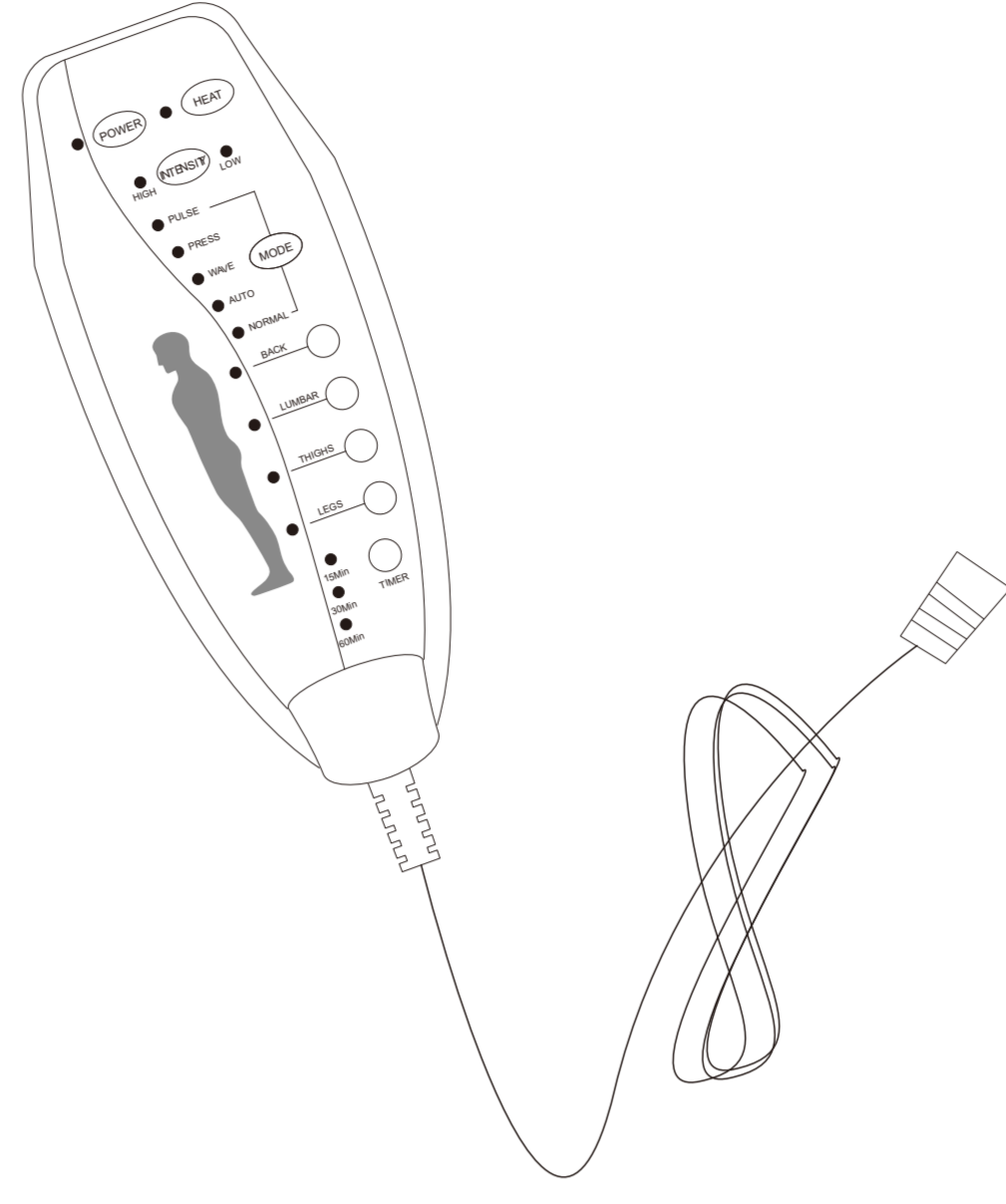
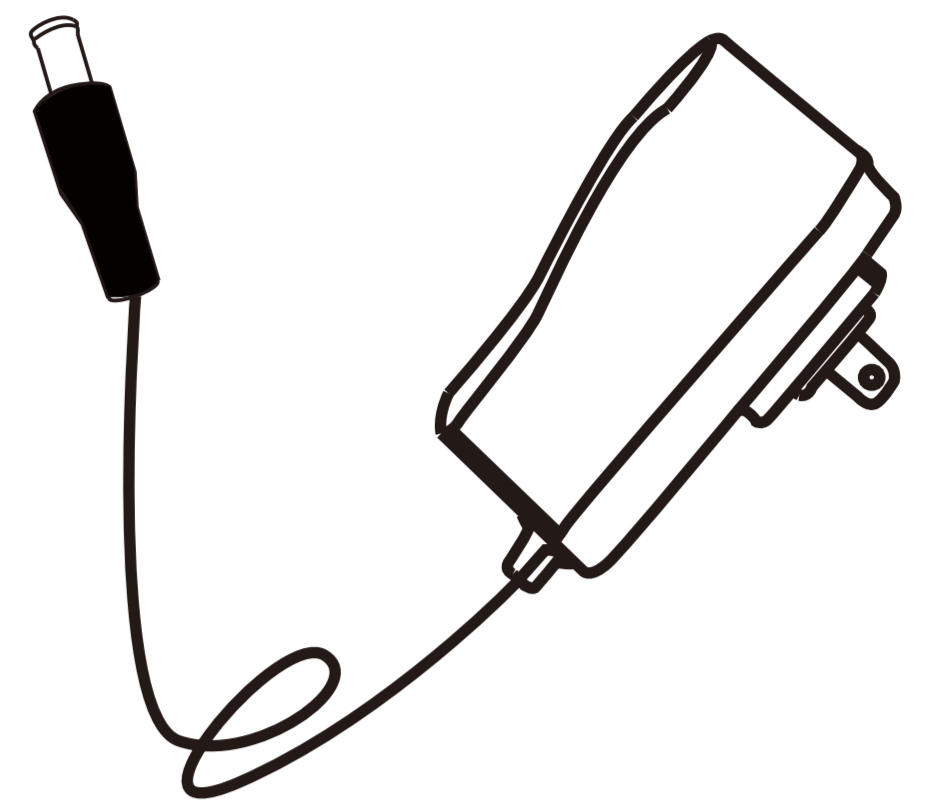
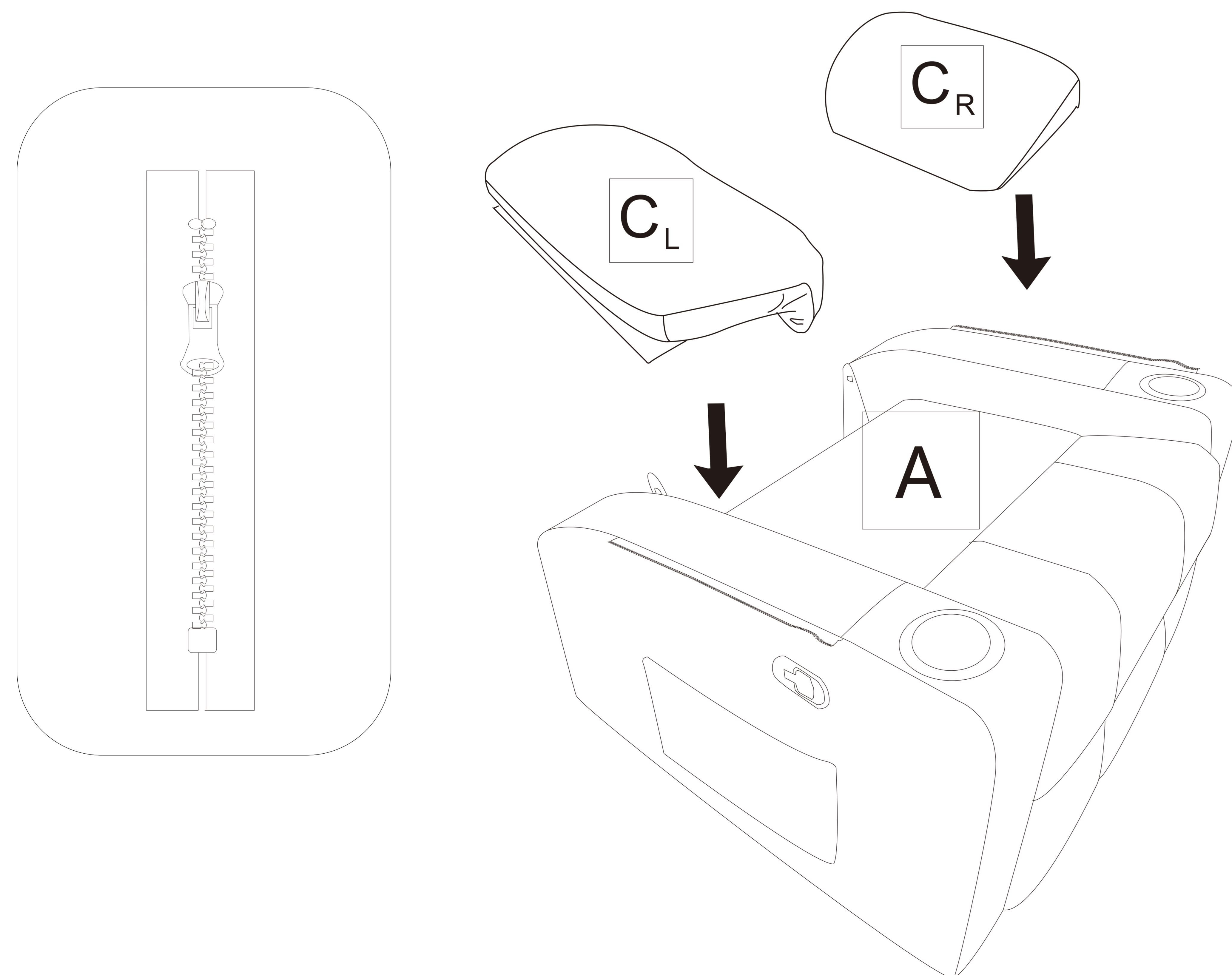

## STEP 2

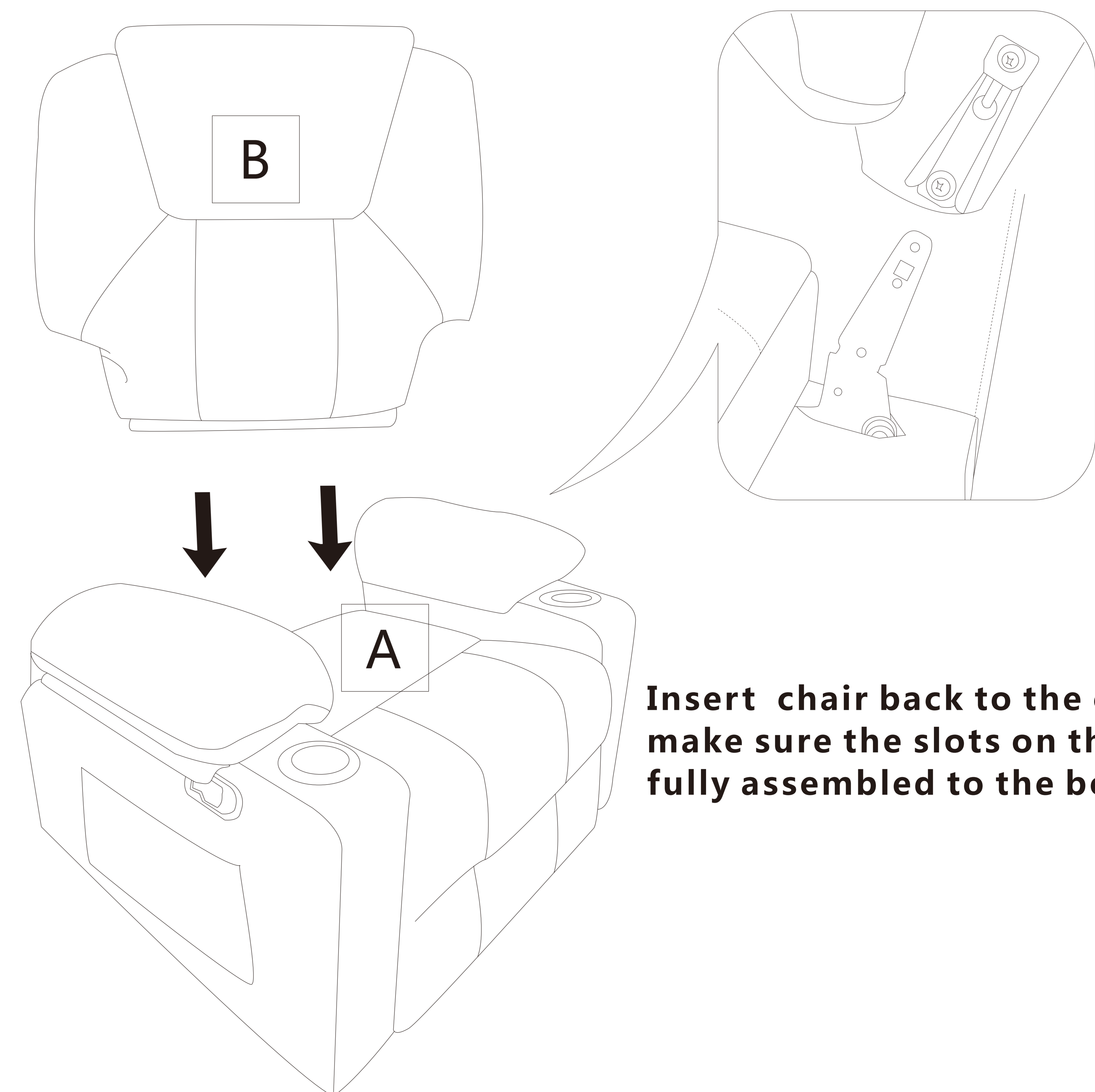

Insert chair back to the chair base, make sure the slots on the back fully assembled to the bottom part.

# Assembly Instruction

## STEP 3

**No.1 and No.2 wire connect with the backrest and chair base.  
No.3 wire connects with backrest and power cord(E).  
No.4 wire connects with backrest and remote control(D).**

**NOTE: Two same color wires connect.**



# Assembly Instruction

## How to recline?



## How to get footrest latch down and stand?

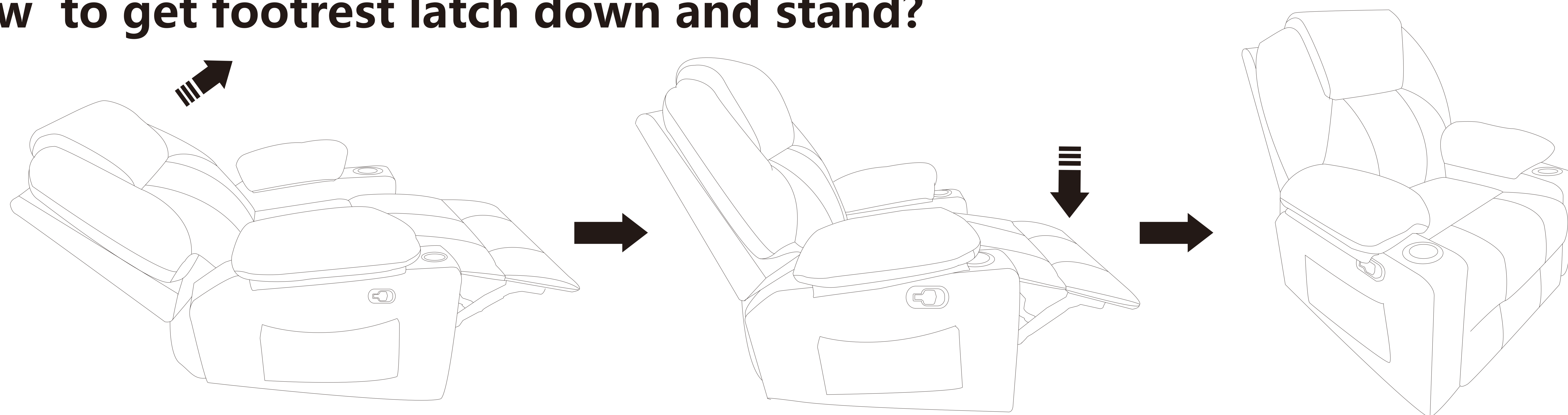

Maximum bearing capacity:350lbs

# Assembly Instruction

## How to use remote control?

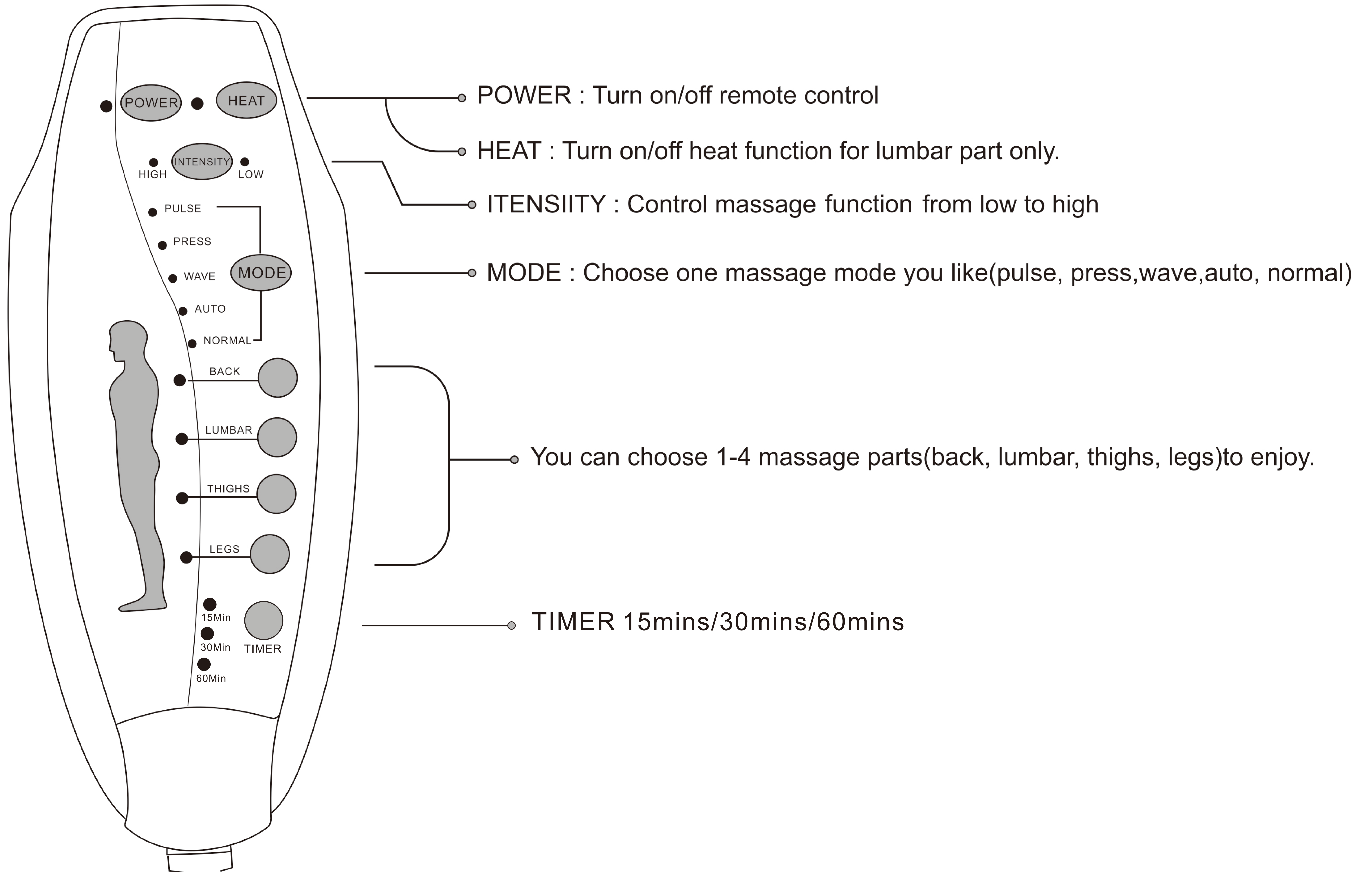

# Assembly Instruction

---

## FAQ

1.Q: Some parts damaged when arrived.

A: Please send clear photos about damaged part to us as attachment, we will check and offer you best solution soon.

2.Q: The massage function does not work.

A: Please check if all wires connect correctly, the power cord (D) may be defective if indicator does not light on, or if the lights doesn't turn on when you press "POWER" button on the remote, that means the remote is defective. Please kindly send messages with clear photos to describe the problem, then we will send necessary replacement to you.

3. Q: The chair is stuck in a tilted position and there is no response when pulling down the buckle

A: Please check if there are any defects in the buckle (5). If you can confirm that the buckle (5) is defective, please contact us for replacement

4. Q: The Heat function does not work or can't feel.

A: Please check all wires connection the same as question 3 first. If the remote also works well, you will need wait for 5-10 mins after you press the "HEAT" button. The heating function only works at lumbar position and the heat temperature isn't very hot.