

Assembly Picture

Item: BS1169 Barstool Series

Assembly Instruction

Item: BS1169 Barstool Series

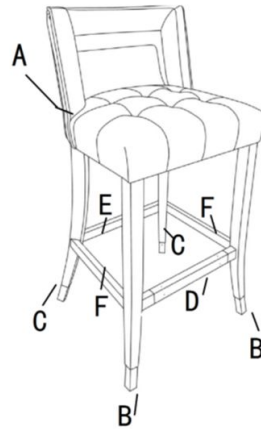
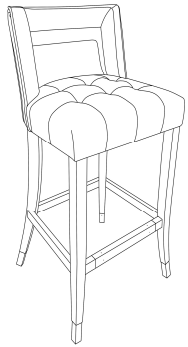

Components

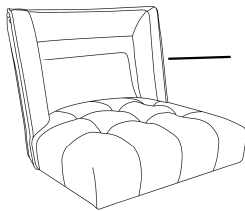

A x1



B x2

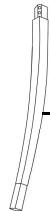

C x2



D x1

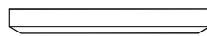

E x1



F x2

Hardware



G x8

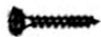

H x8



I x8



J x8



K x1

**Tools Required Screwdriver
(Not Included)**

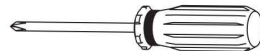

Carefully unpack all parts before attempting to assemble.

This page lists all the contents included in the box. Please take time to identify the hardware as well as the individual components of this product.

As you unpack and prepare for assembly, place the contents on a carpeted or padded area to protect them from damage.

Parts List

Code and Description	Q'ty
A - Barstool seat	1
B - Front legs	2
C - Back legs	2
D - Front Slat with metal	1
E - Back Slat	1
F - Side Slats	2
G - Bolts M8*60MM	8
H - Screws Φ 4.2*50MM	8
I - Lock washer	8
J - Flat washer	8
K - Allen key	1

Assembly Picture

Item: BS1169 Barstool Series

Assembly Instruction

STEP 1

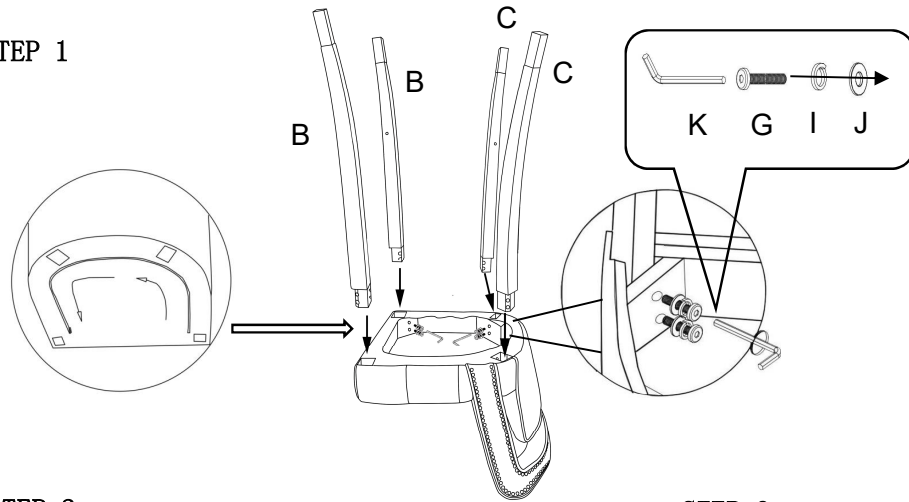

STEP 2

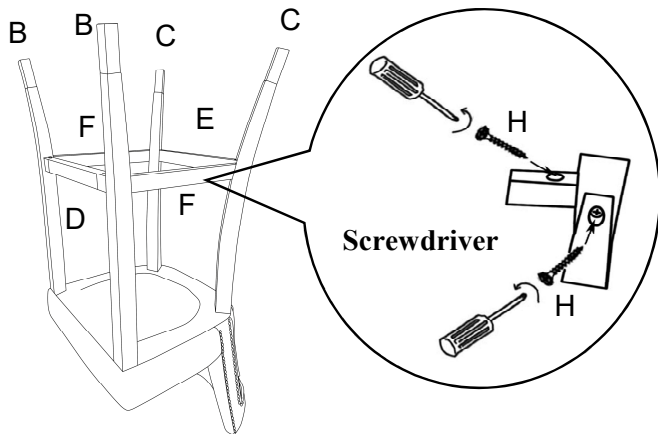

STEP 3

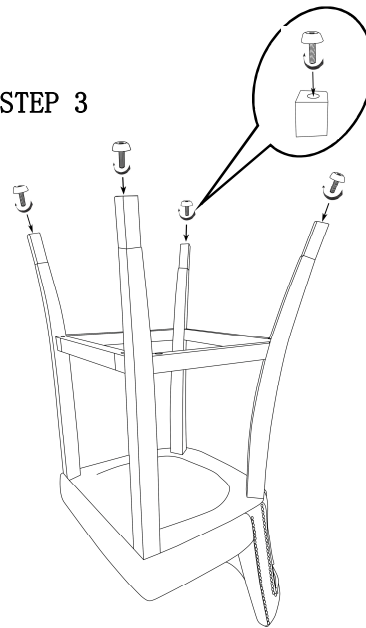

Carefully unpack all parts before attempting to assemble.

STEP ONE Open zipper bag on the bottom, Attach the legs (Bx2 & Cx2) & into the seat holes, by inserting the bolts into the leg holes, Not tighten with the Allen key too much.

STEP TWO Attach Slats (Dx1 & Ex1 & FX2) into the Legs holes, by inserting the Screws H into the legs holes, then tighten with your own Screwdriver.

STEP THREE Level the barstool on the floor, you can adjust the adjustable nails under the legs to Level the chair. After this action, Please tighten all bolts with the Allen key like Step 1.

