

Installation Instruction

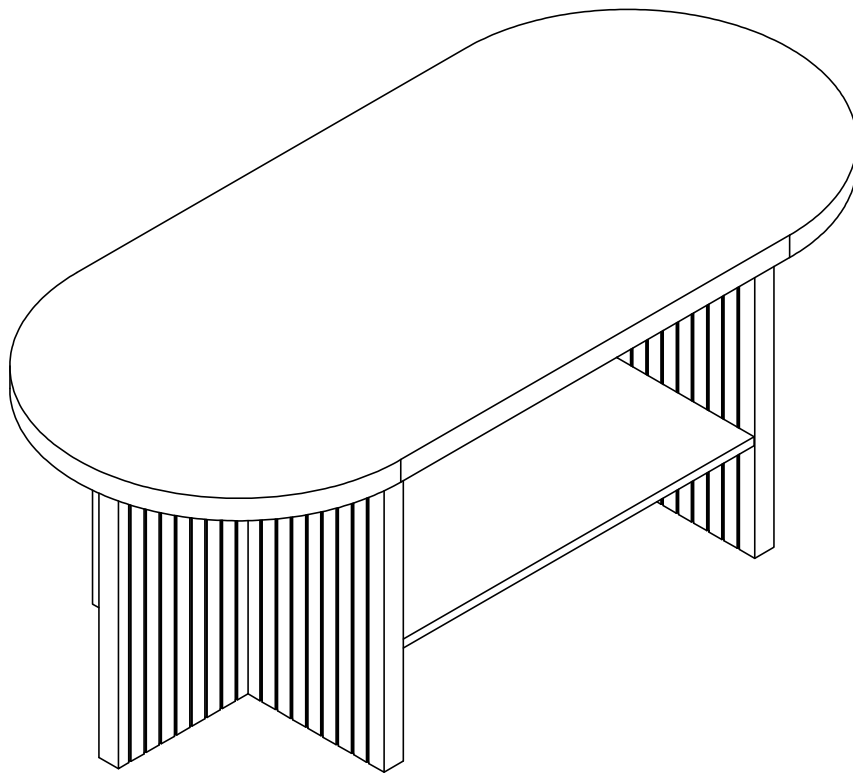

Assembling

Estimated time for assembly



45 : 00

What you need

- Use the packaging carton as a working surface to prevent product damage during assembly
- Phillips head screwdriver

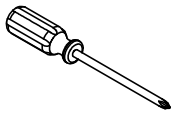

Weight Limitation



100 | **35**
lbs table top lbs per

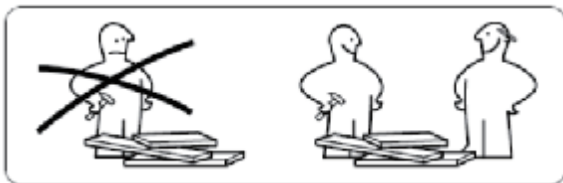

What' included

Code Description	Qty
A Cam Bolt M6X35MM	26
B Cam Lock 15X9MM	26
C Wooden Dowel M8X30MM	16
D EVA foot mat	6
E Circular hole Decals	26

The Hardwares

(A)

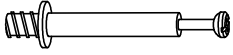

(B)



(C)

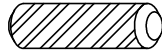

(D)

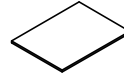

(E)

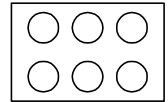

IMPORTANT:

1. Do not tighten bolts / screws completely until all bolts / screws are lined up and inserted into holes.
2. Do not over tighten screws and bolts to avoid stripping
3. Please use hand tools to assemble this product. Do not use power tools.

Included Accessories

Code	Description	Qty
1	Cabinet Top	1
2	Laminated plate	1
3	Reinforcing strip	1
4	Reinforcing strip	1
5	Left and right panels	2
6	Left vertical plate	1
7	Right vertical plate	1

The Accessoriess

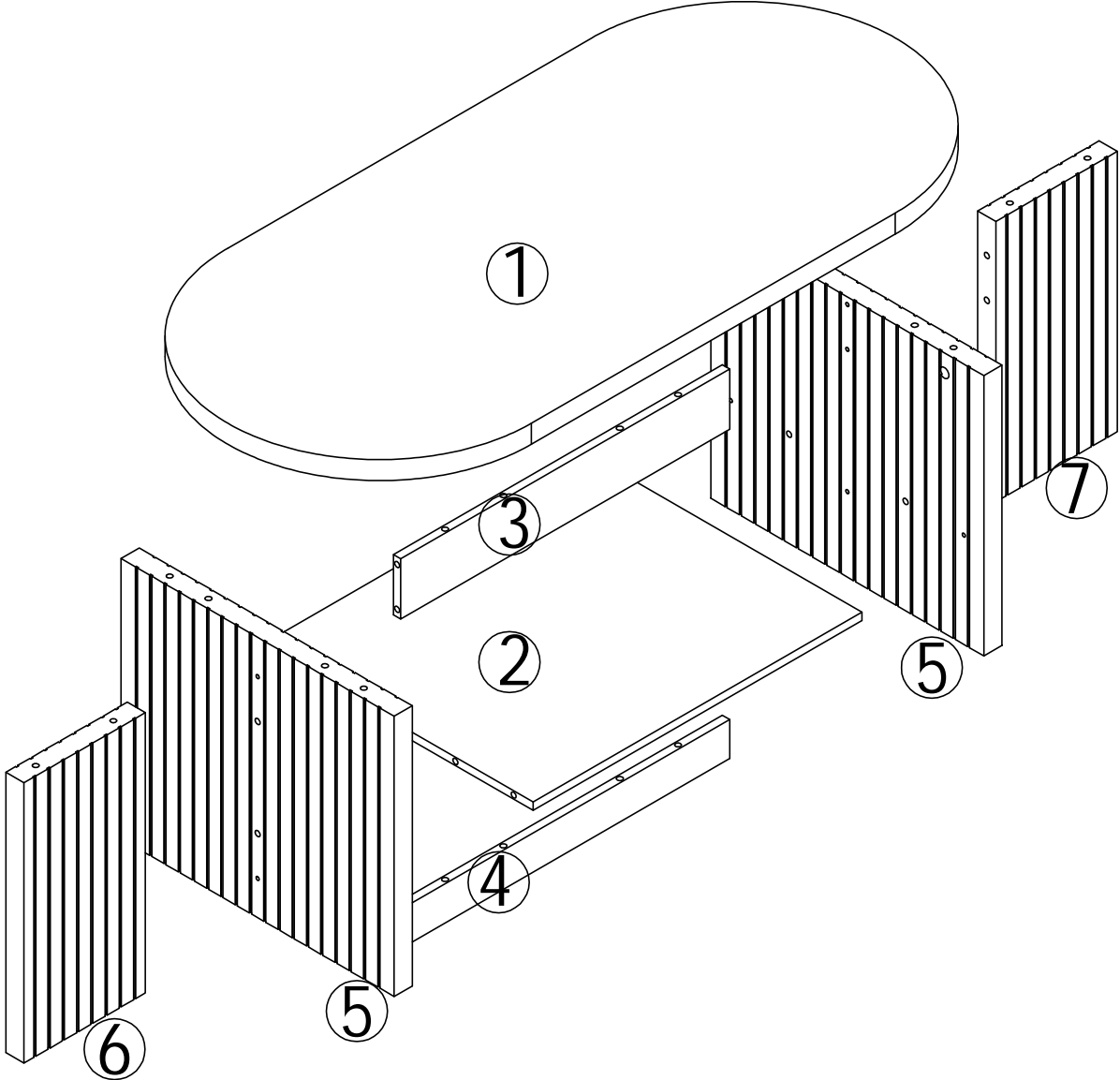

Step 1

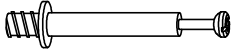
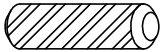
A	x 2
	
C	x 2
	

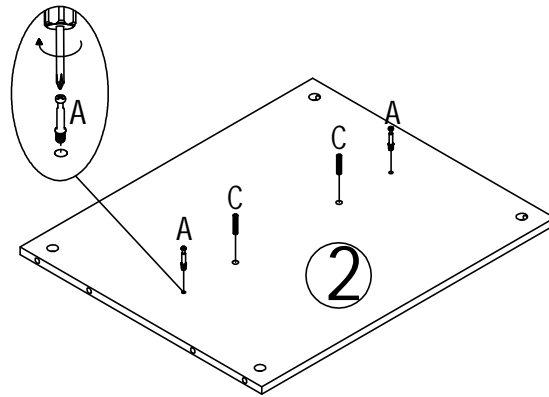

Step 2

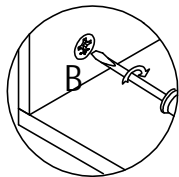
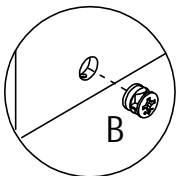
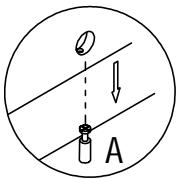

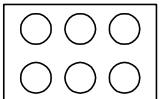
E	x 2
	

B	x 2
	

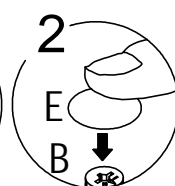
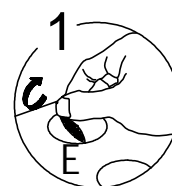
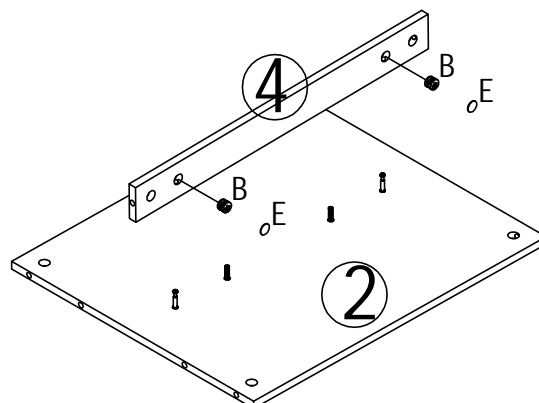

Step 3

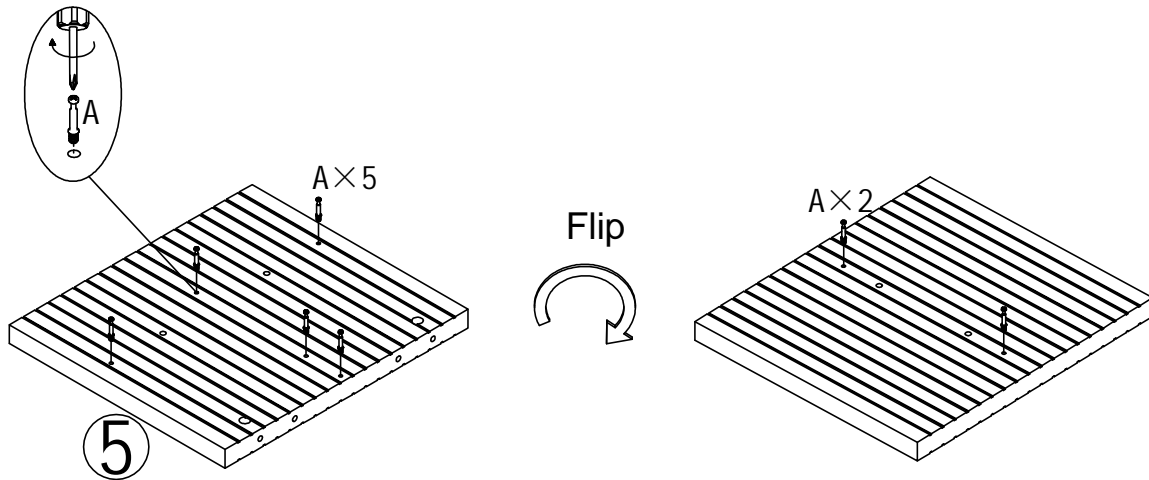
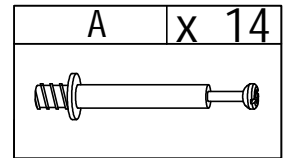

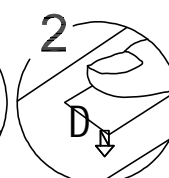
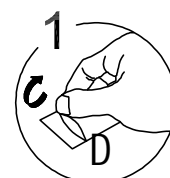
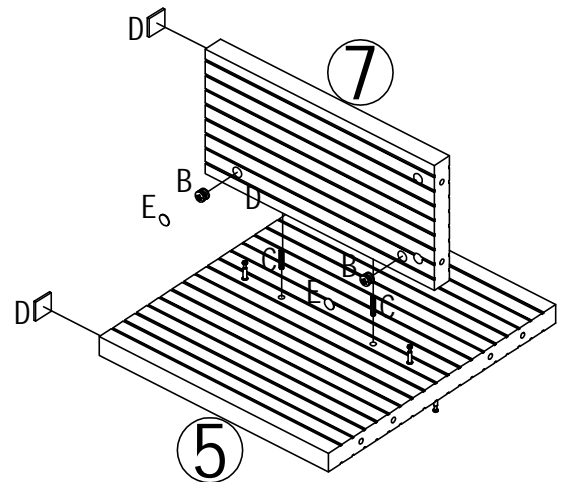
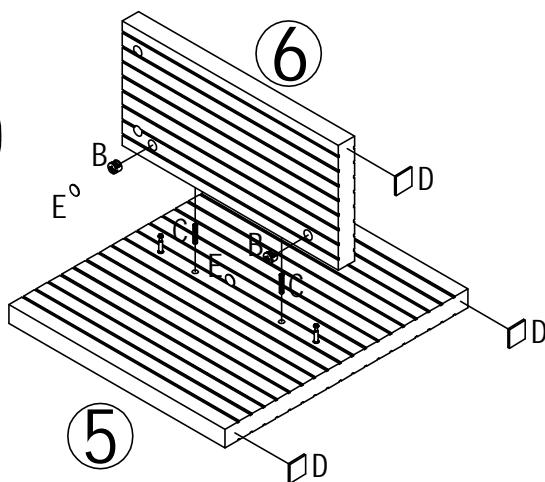
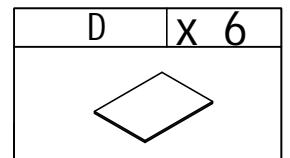
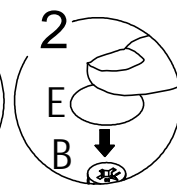
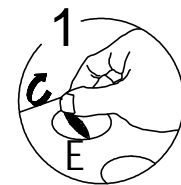
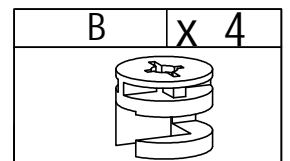
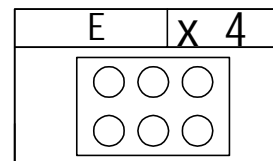
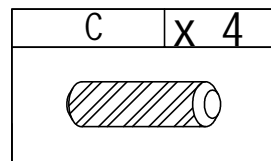
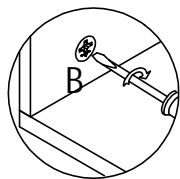
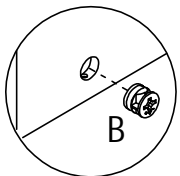
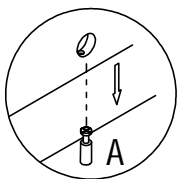

x2

Step 4

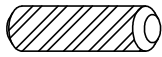
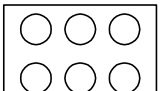

Step 5

C	x 4	E	x 10	B	x 10
					

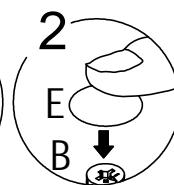
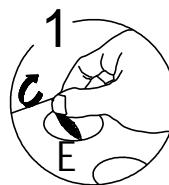
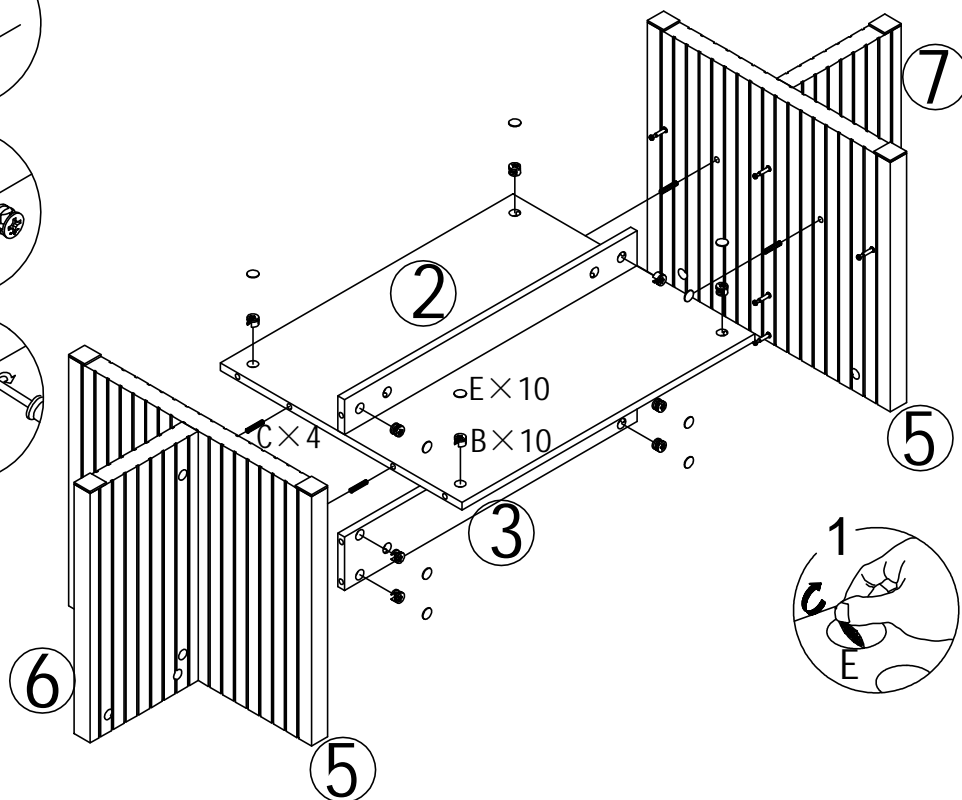
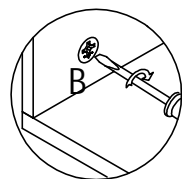
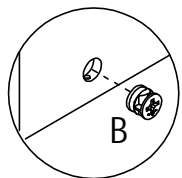
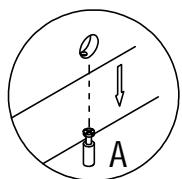

Step 6

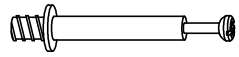
A	x 10
	

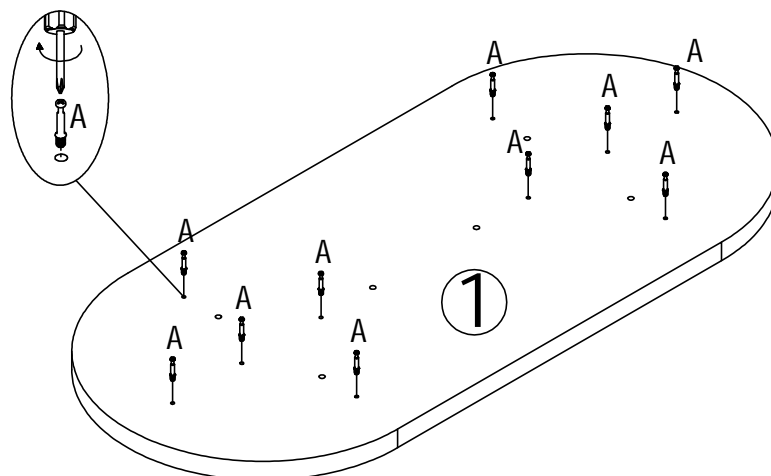

Step 7

