

Lift Top Coffee Table Instruction Manual

Note: There is also a more detailed installation video on the product detail page on website.

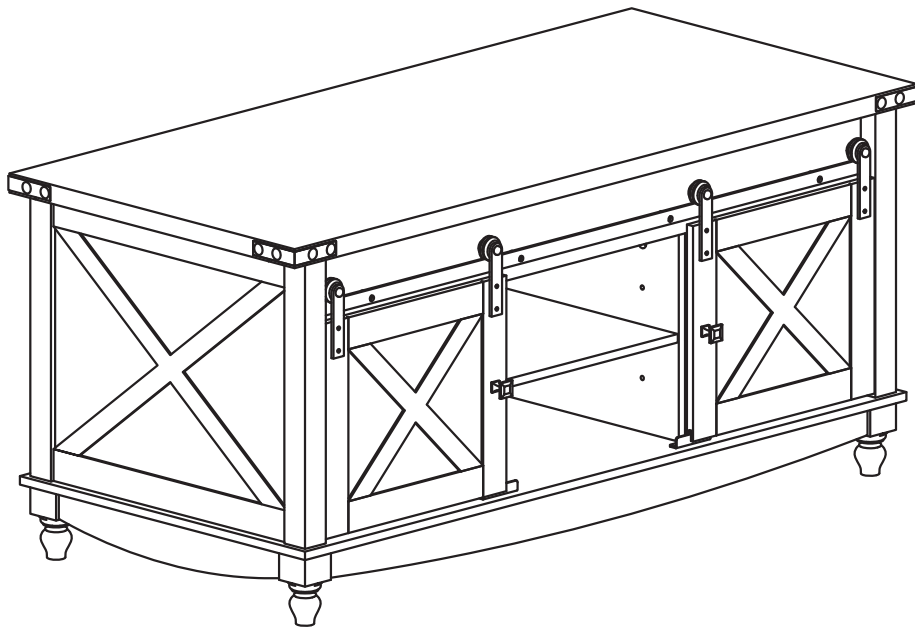

ASSEMBLY INSTRUCTION

Decomposition of Components

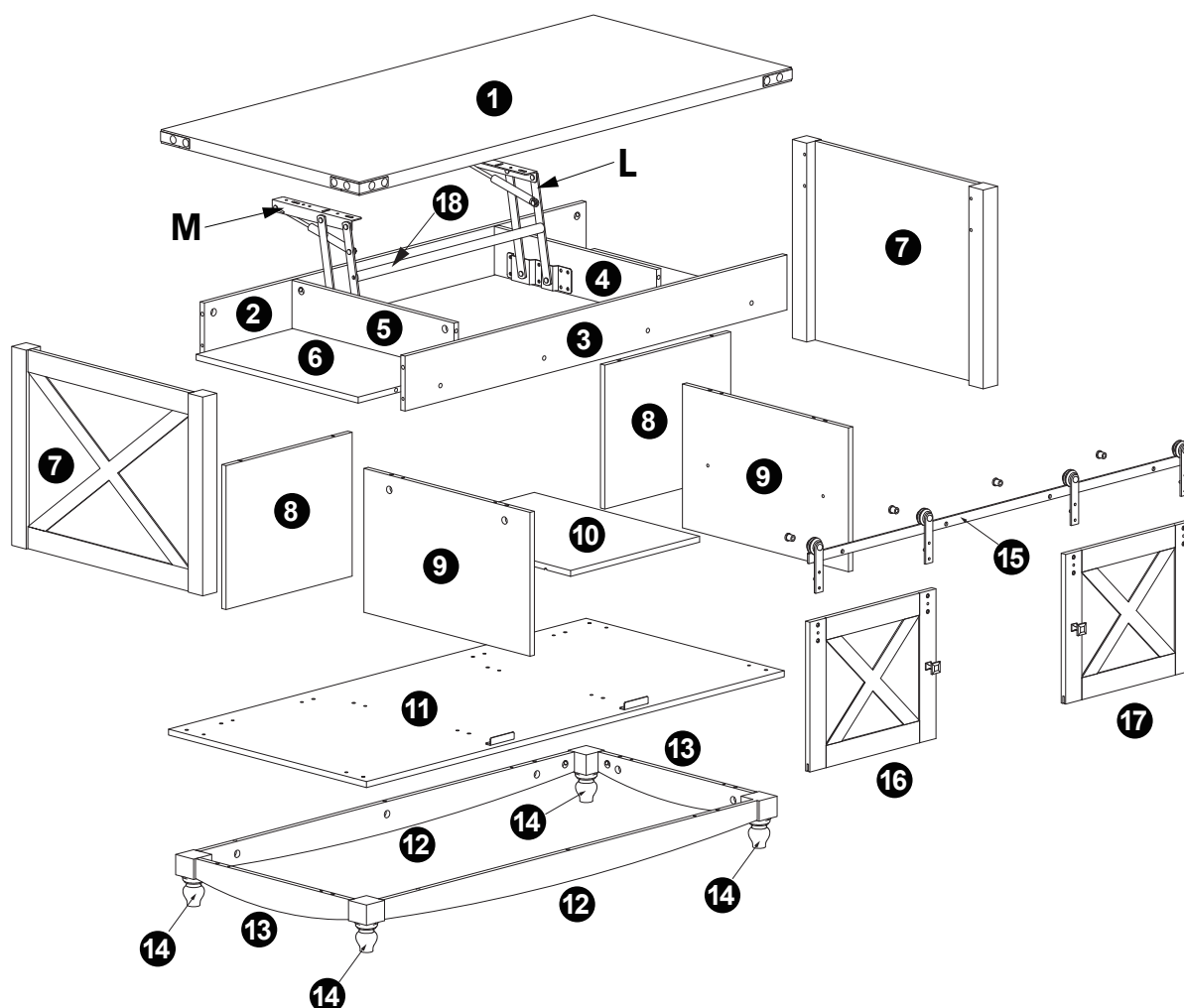

Please read the following instructions carefully:



1. We offer customers a free lifetime warranty. If you need help regard product issues, after-sales service or other relevant problems, please contact us via the email provided on the cover.

2. If power drills for assembly, please be sure to adjust the appropriate speed and accessories, excessive rotational speed or unsuitable drill bits may cause damage to screws and boards.

3. Some parts of the Coffee Table have sharp edges, so please be attentive to avoid scratches when installing.

4. Due to the small size of the hardware, please put them in a safe position when installing them to avoid accidental.

5. In order to avoid giving you a bad installation experience, please follow the steps in the instruction manual to install and carefully distinguish screws and steel strips. If you have a helper, the installation will be certainly easier.

1

x 1

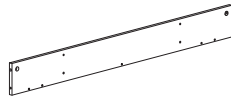
2

x 1

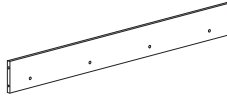
3

x 1

4

x 1

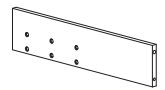
5

x 1

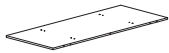
6

x 1

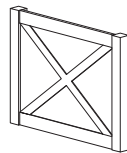
7

x 2

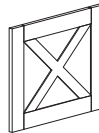
8

x 2

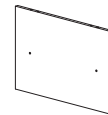
9

x 2

10

x 1

11

x 1

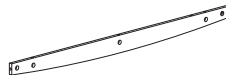
12

x 2

13

x 2

14

x 4

15

x 1

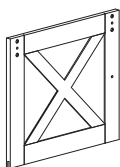
16

x 1

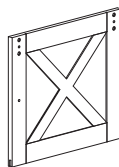
17

x 1

18

x 1

A

Ø15*10mm

x36 +3

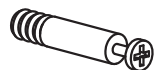
B

Ø6*34mm

x36 +3

C

Ø6*30mm

x44 +3

D

Ø5*38mm

x16 +1

E $\frac{5}{32}$ "*12mm

x26 +2

F

3.5*12mm

x4

G $\frac{1}{4}$ "*28mm

x6

H

Ø6*17

x4

I

x2

J

x4

K

x4

L

x1

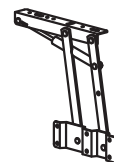
M

x1

N

x2



Installation tools



x4

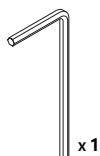

x1



x1

STEP 1

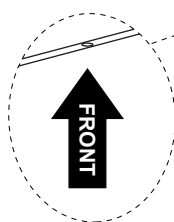
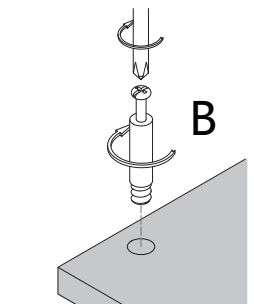
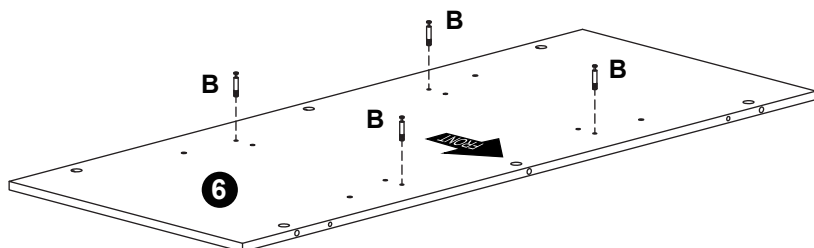

Note: Please place the board 6 strictly according to the direction of the arrows

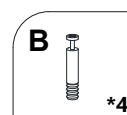
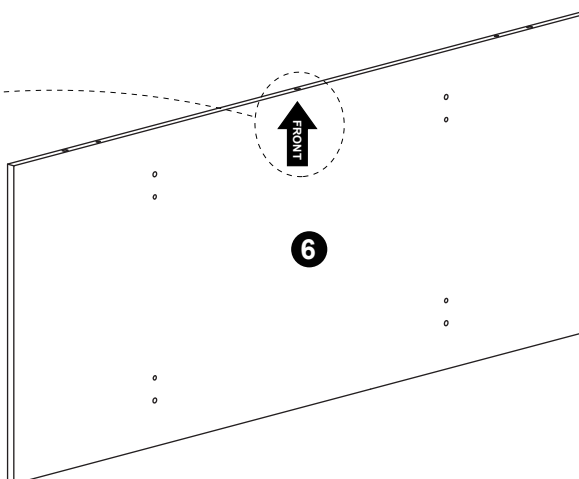

*4

STEP 2

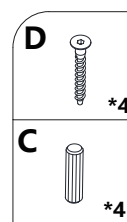
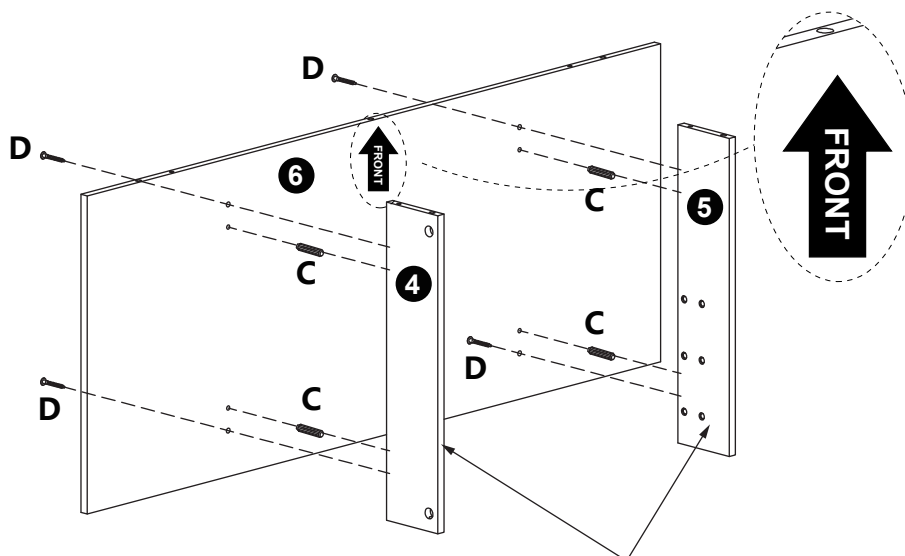

*4

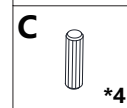

*4



Note: Please strictly install boards 4 and 5 as shown in step 2

STEP 3

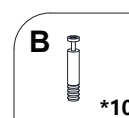
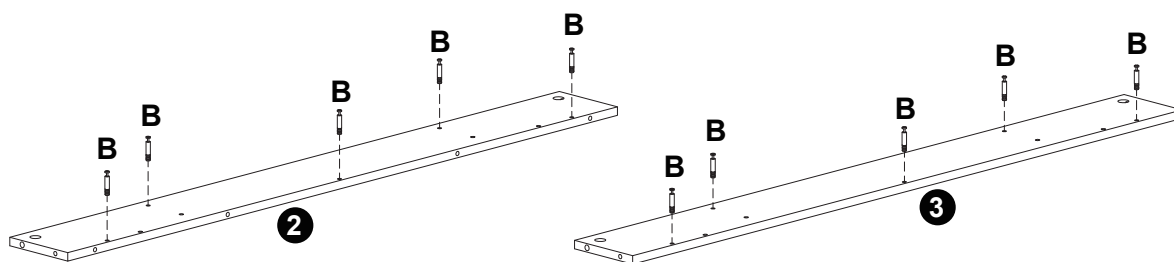

STEP 4

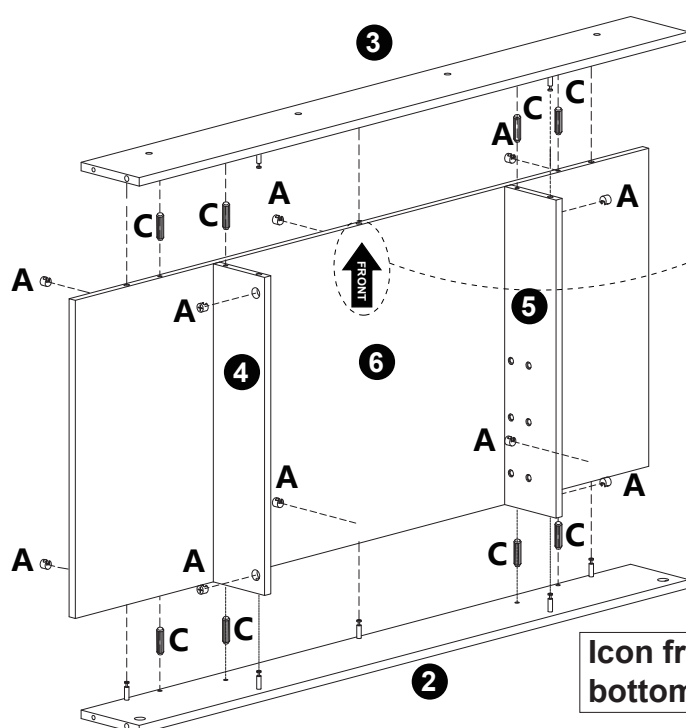

Note the front icon facing up

Icon front top is board 3, bottom is board 2

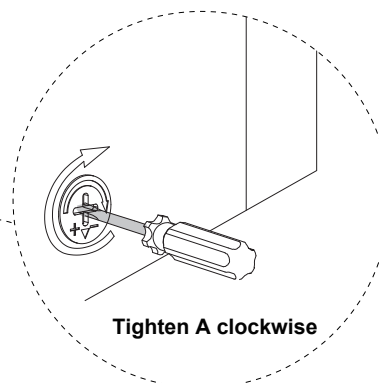
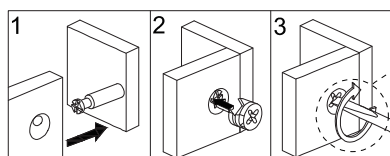

Tighten A clockwise

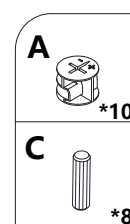

STEP 5

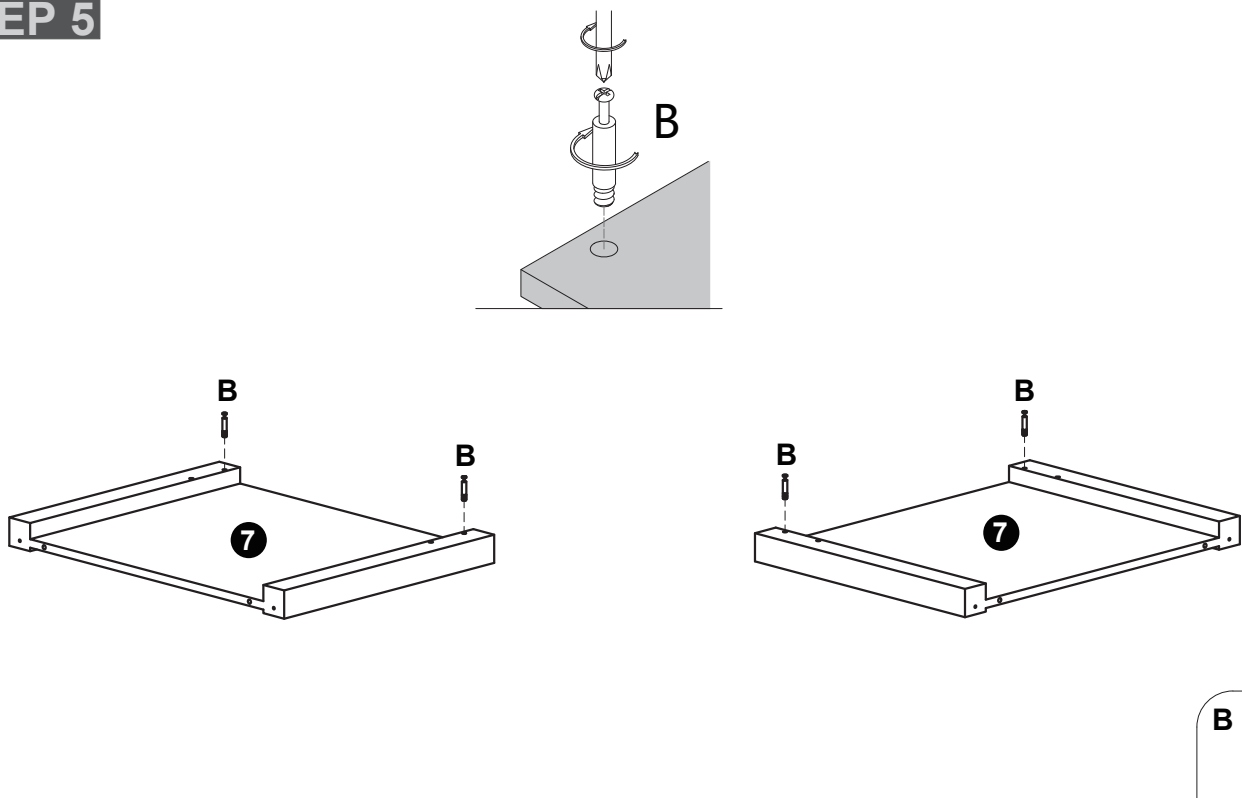

STEP 6

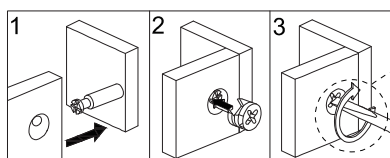
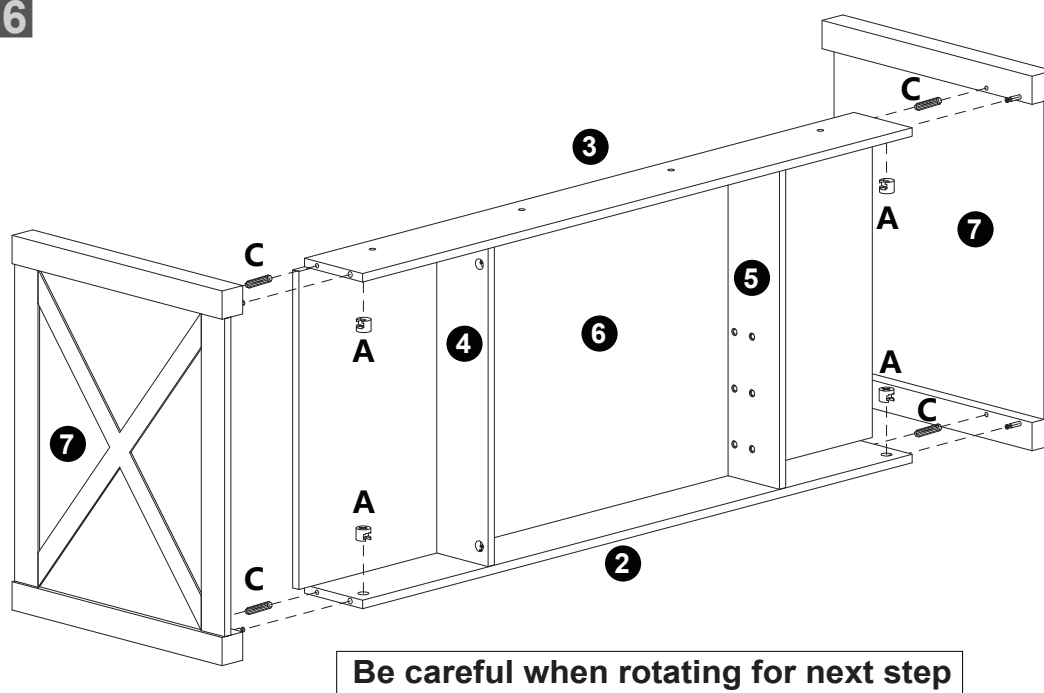

Tighten A clockwise

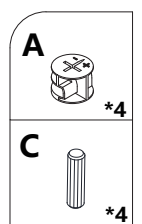

STEP 7

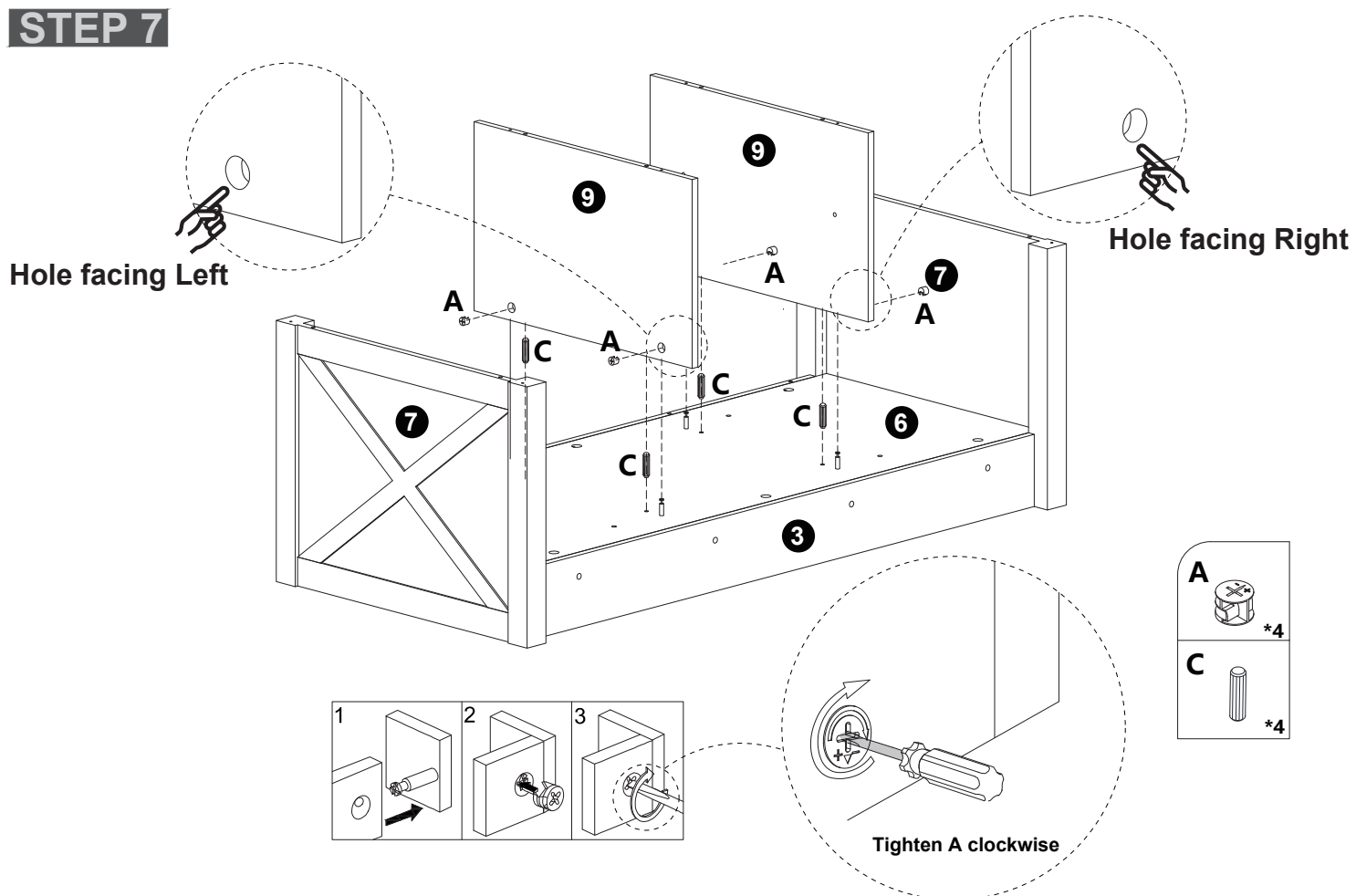

STEP 8

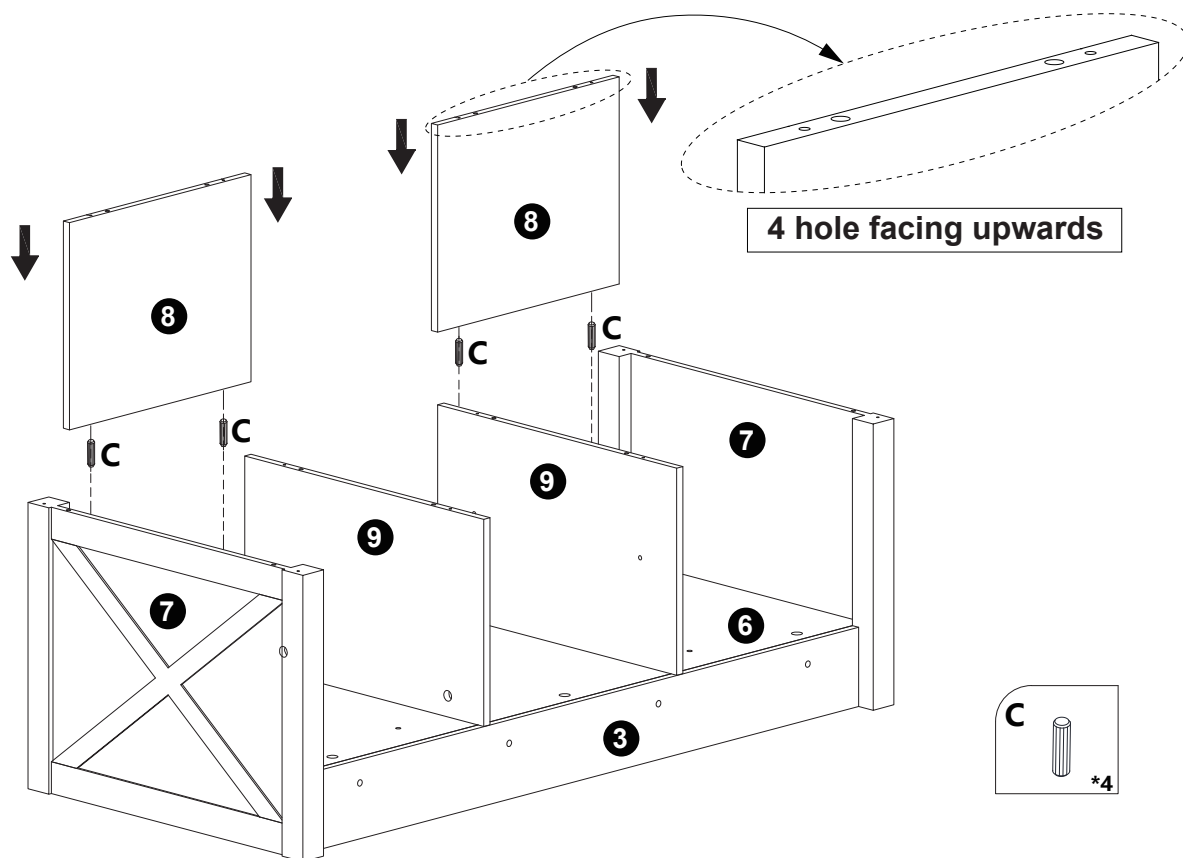

STEP 9

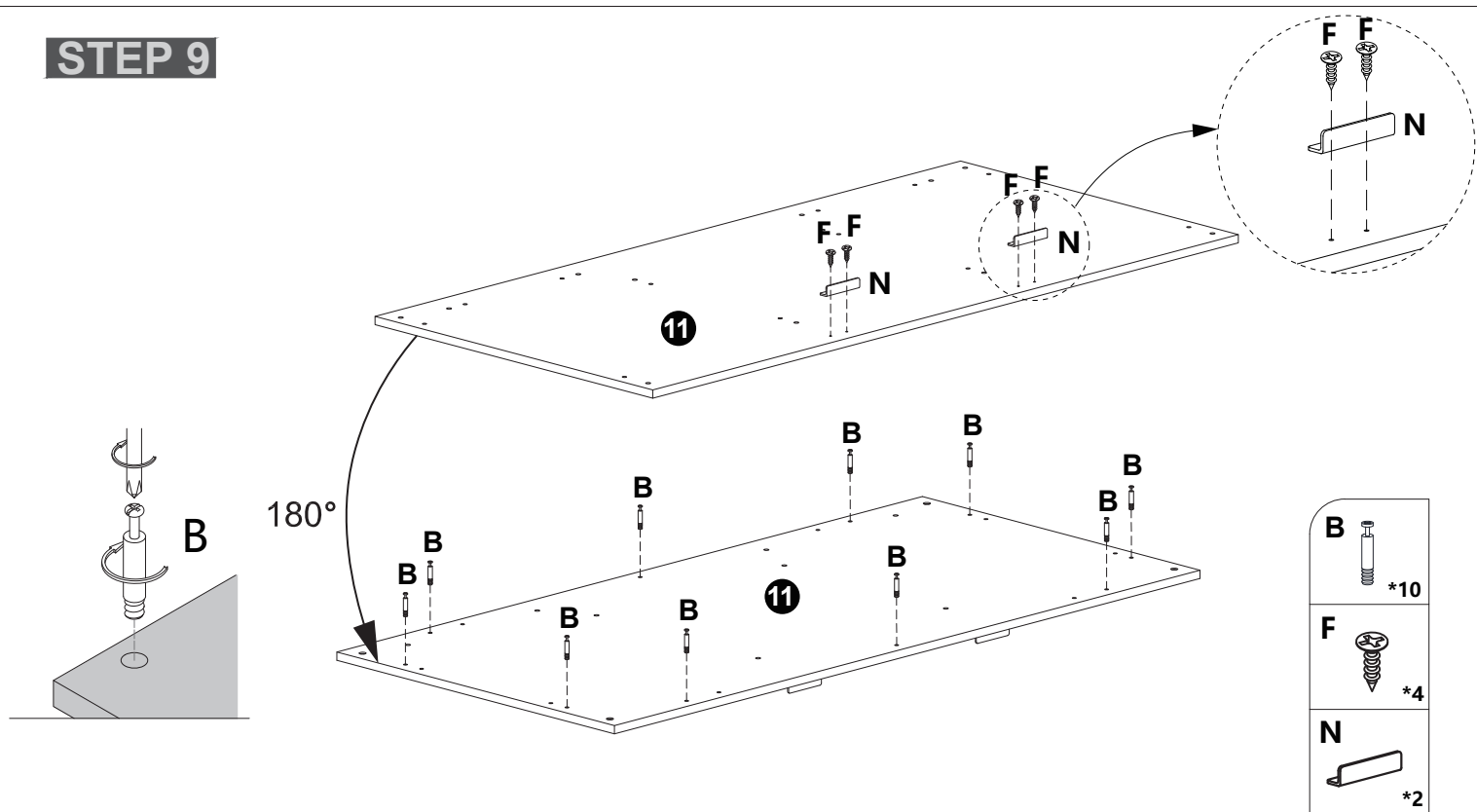

STEP 10

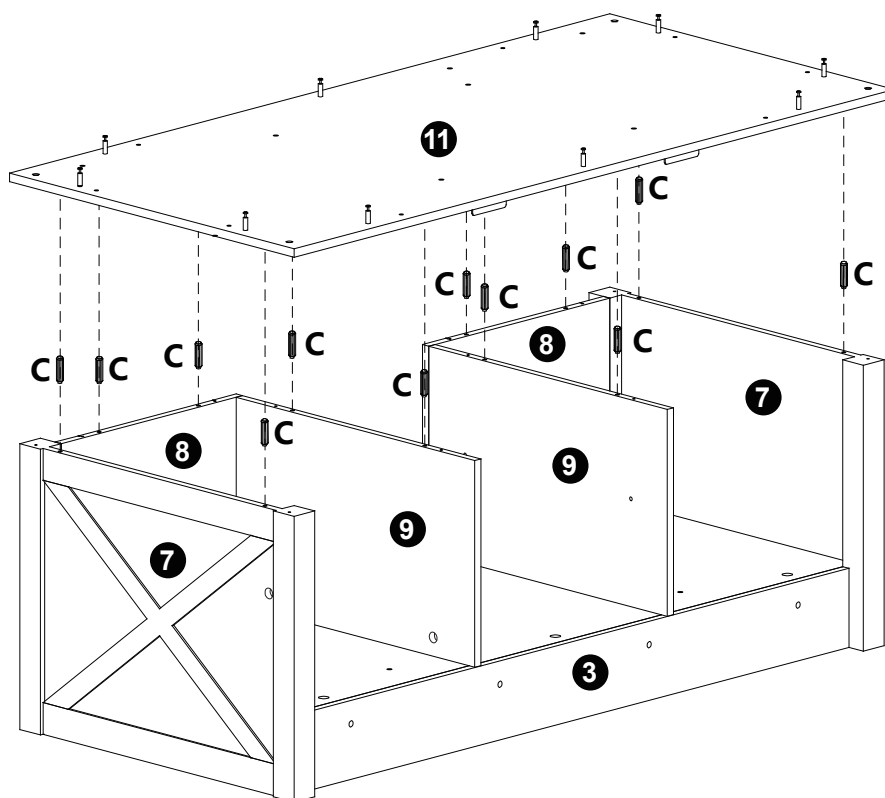

STEP 11

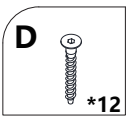
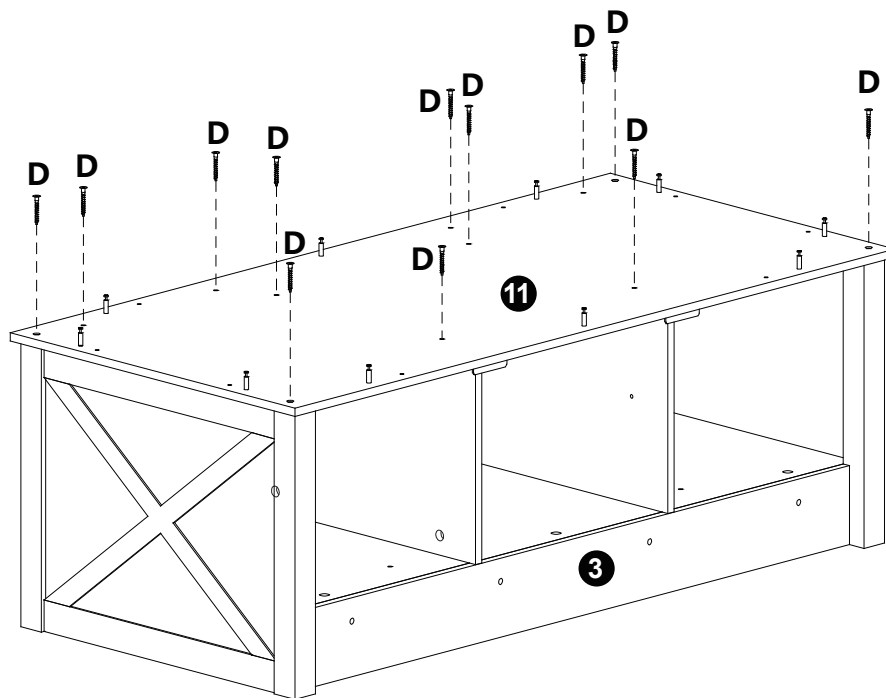

STEP 12

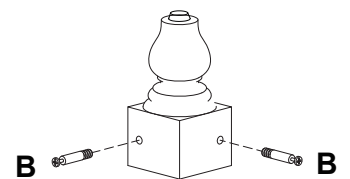

14 X 4PCS

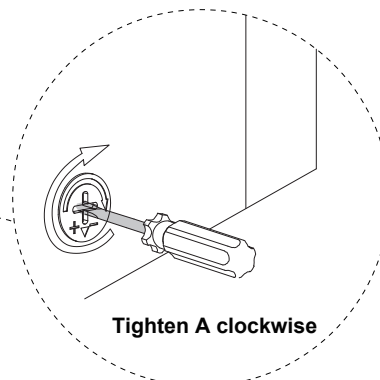
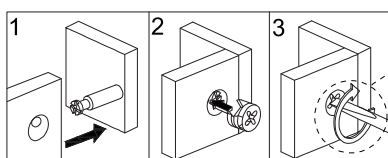
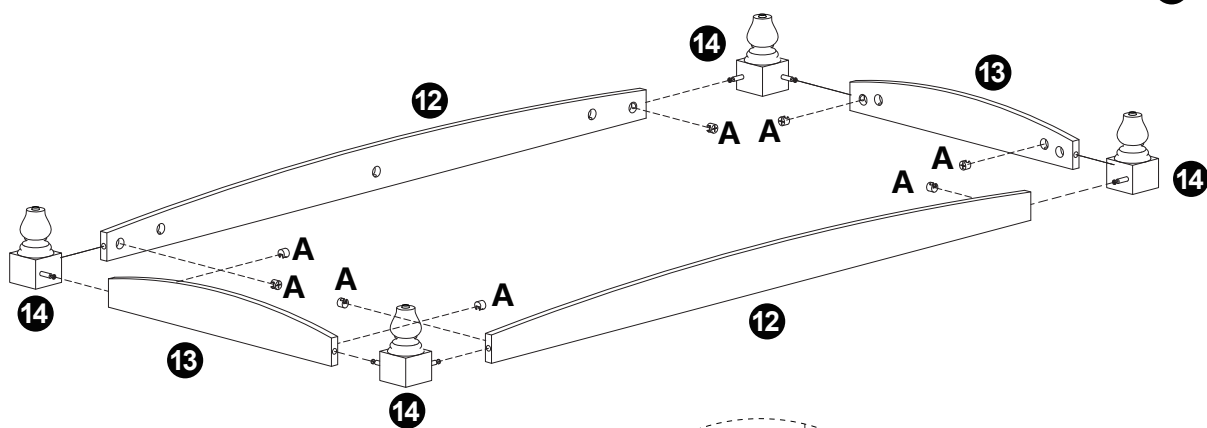

Tighten A clockwise

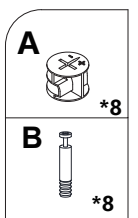

STEP 13

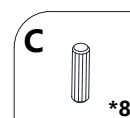
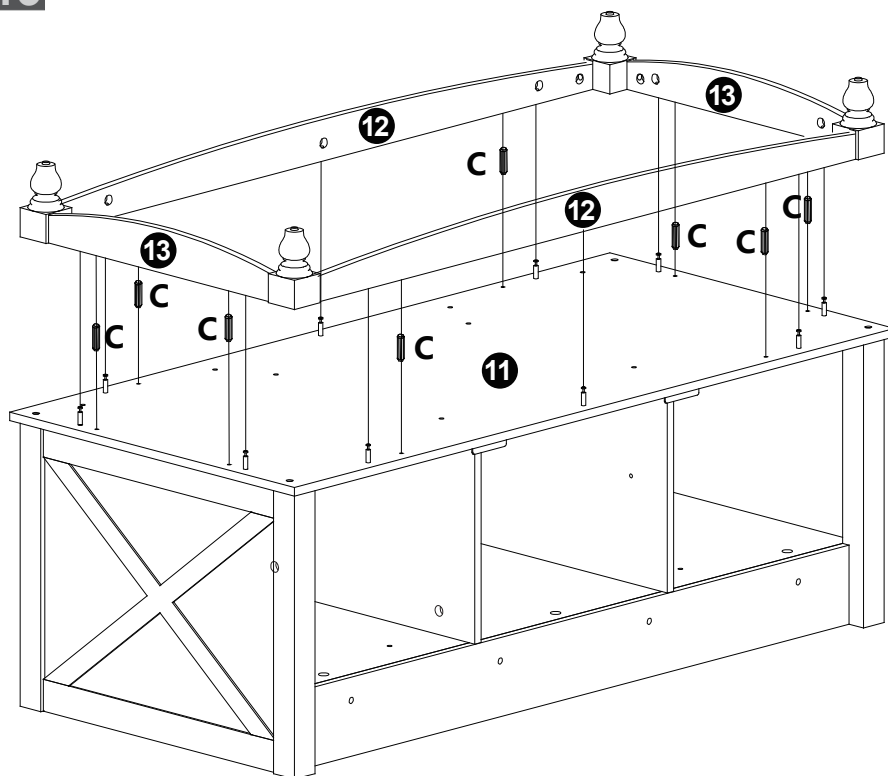

STEP 14

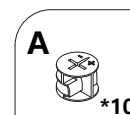
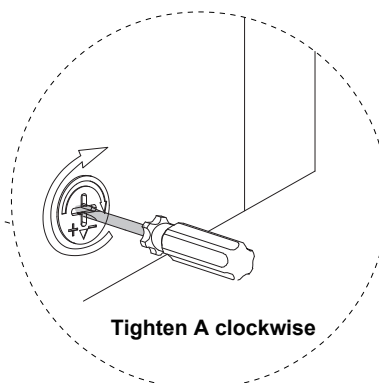
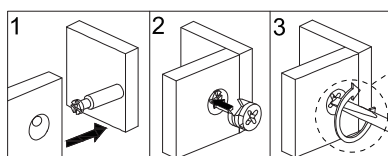
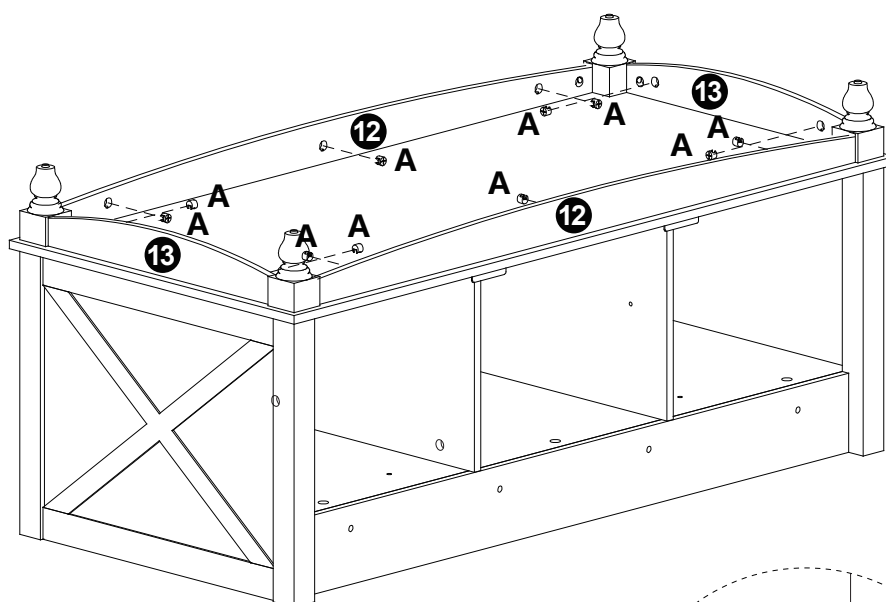

STEP 15

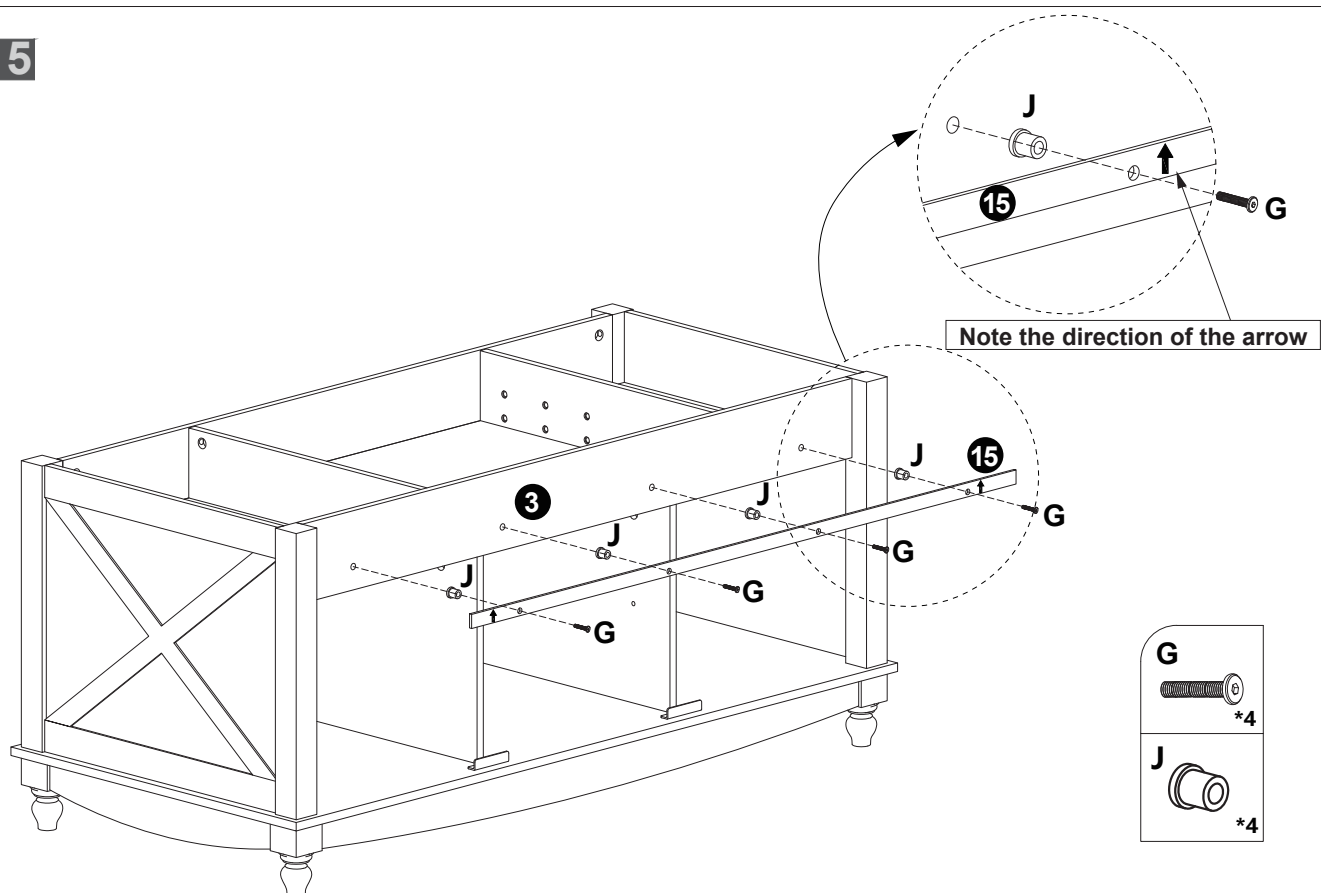

STEP 16

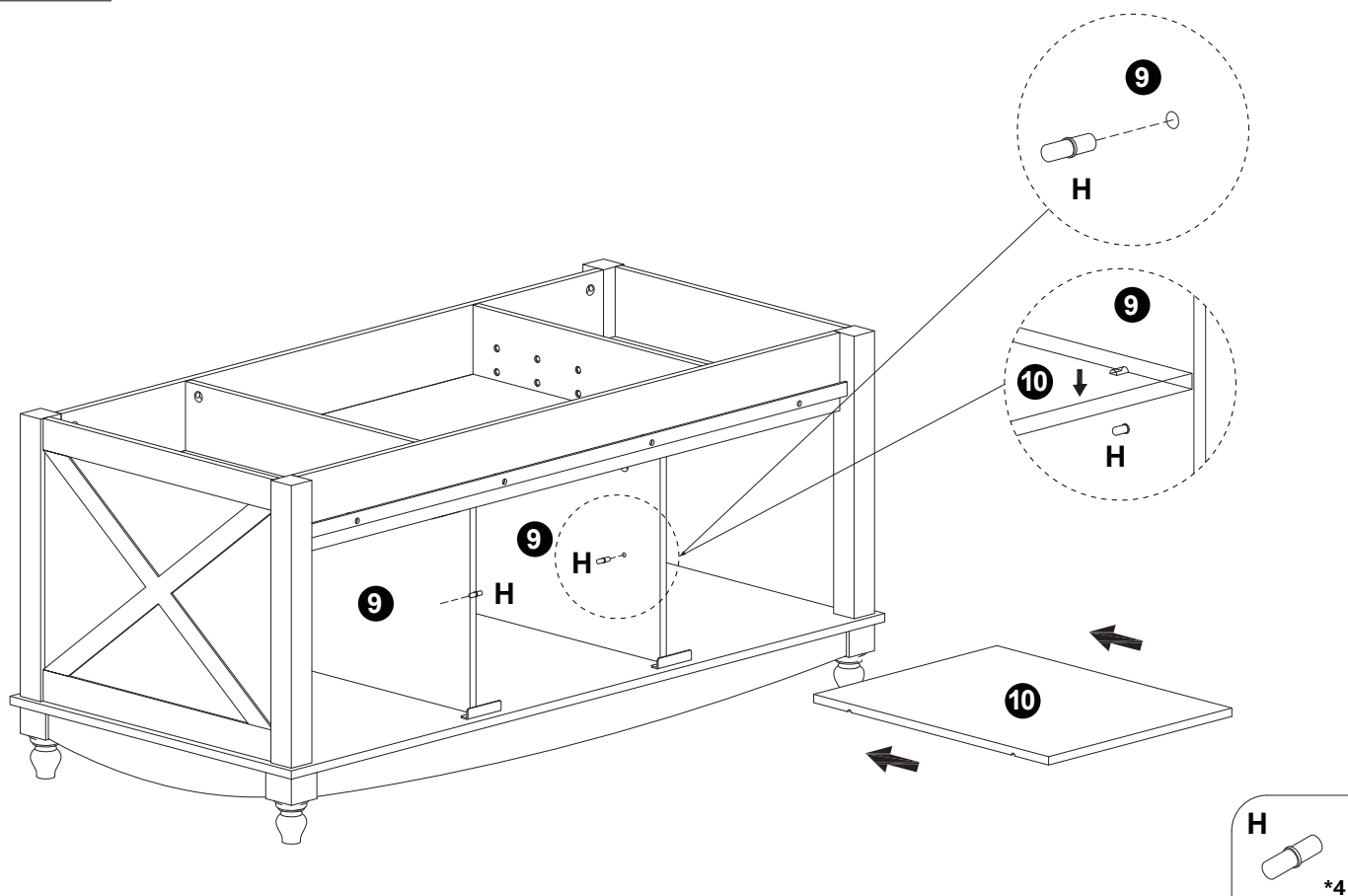

STEP 17

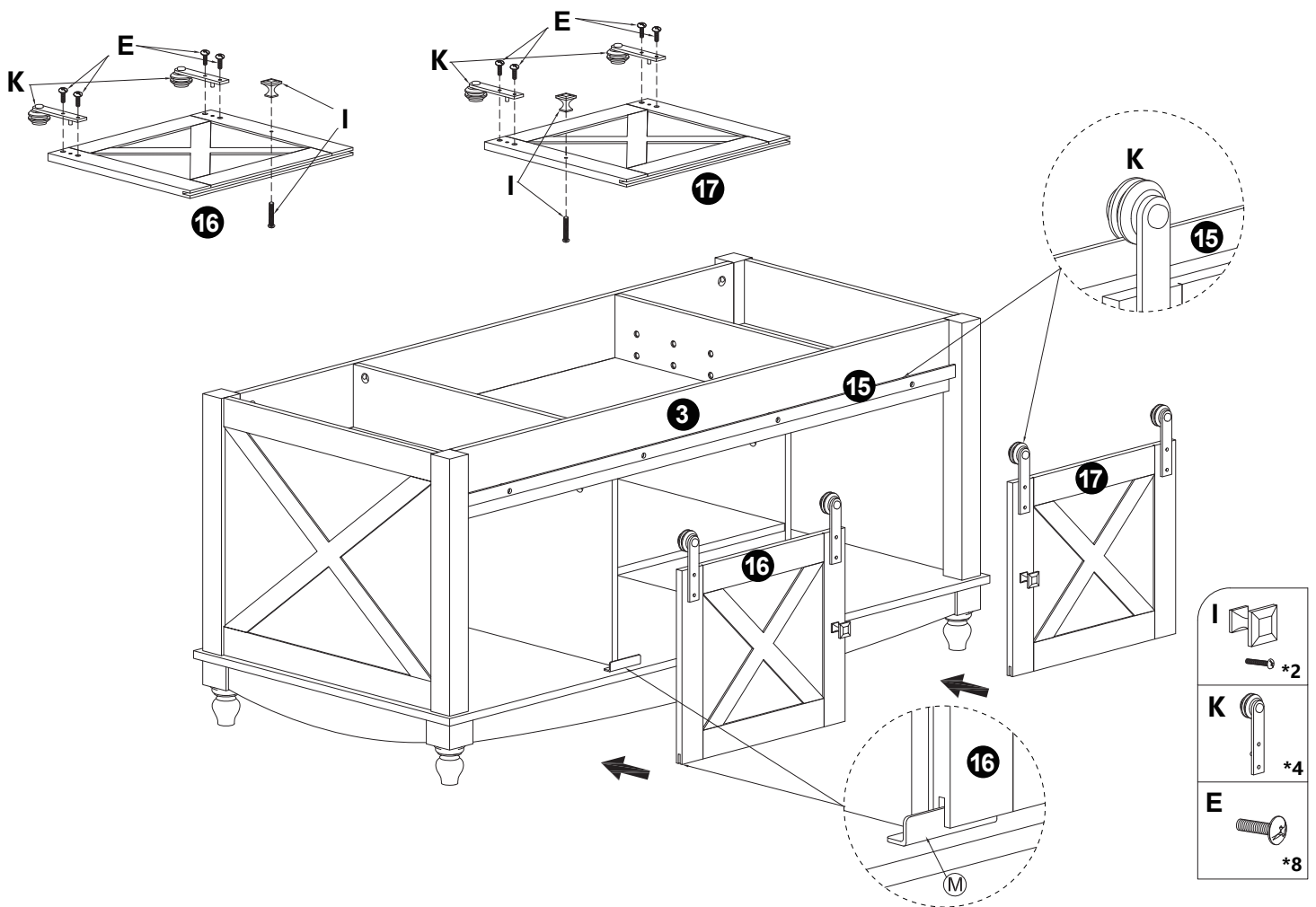

STEP 18

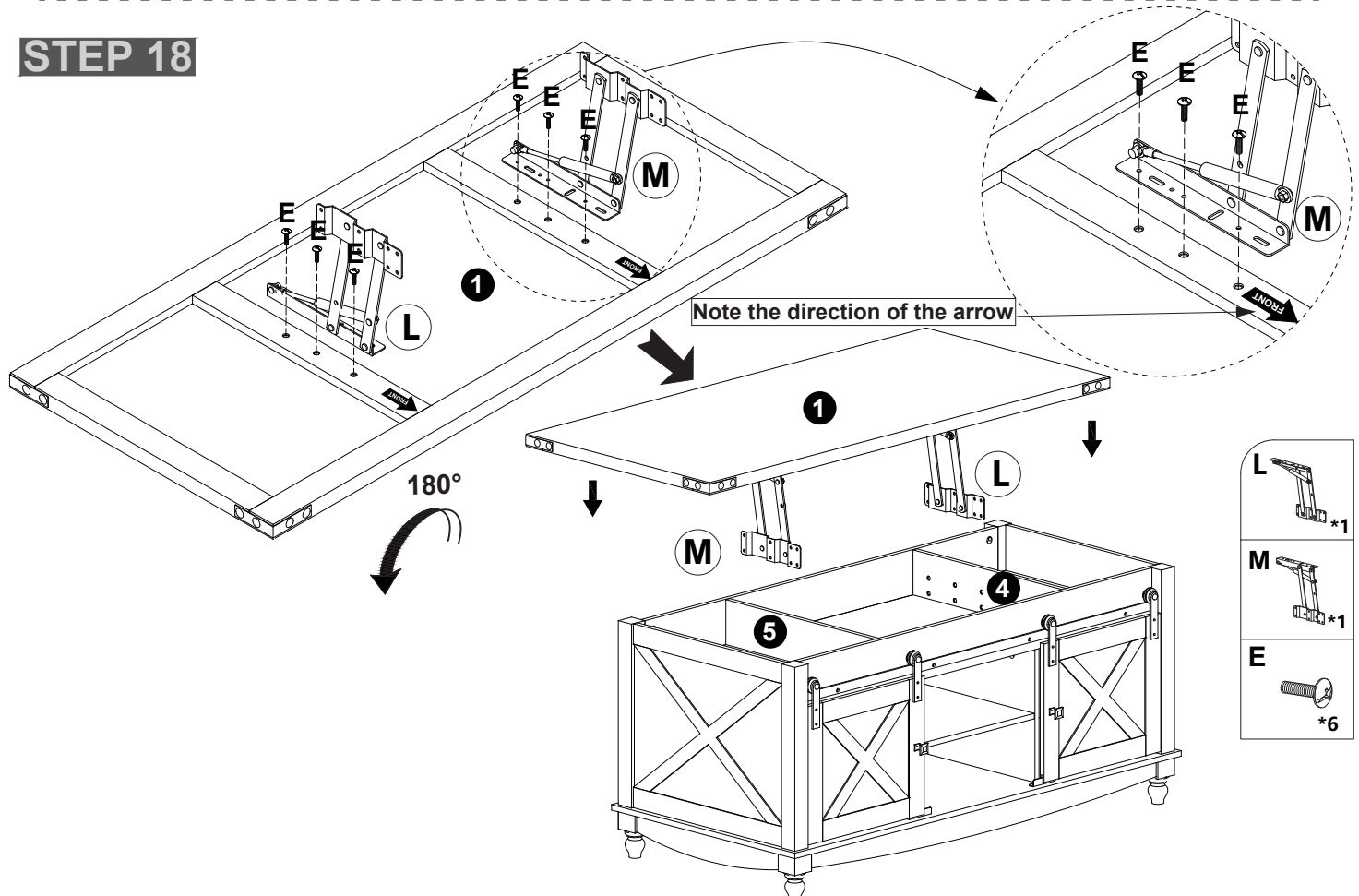

STEP 19

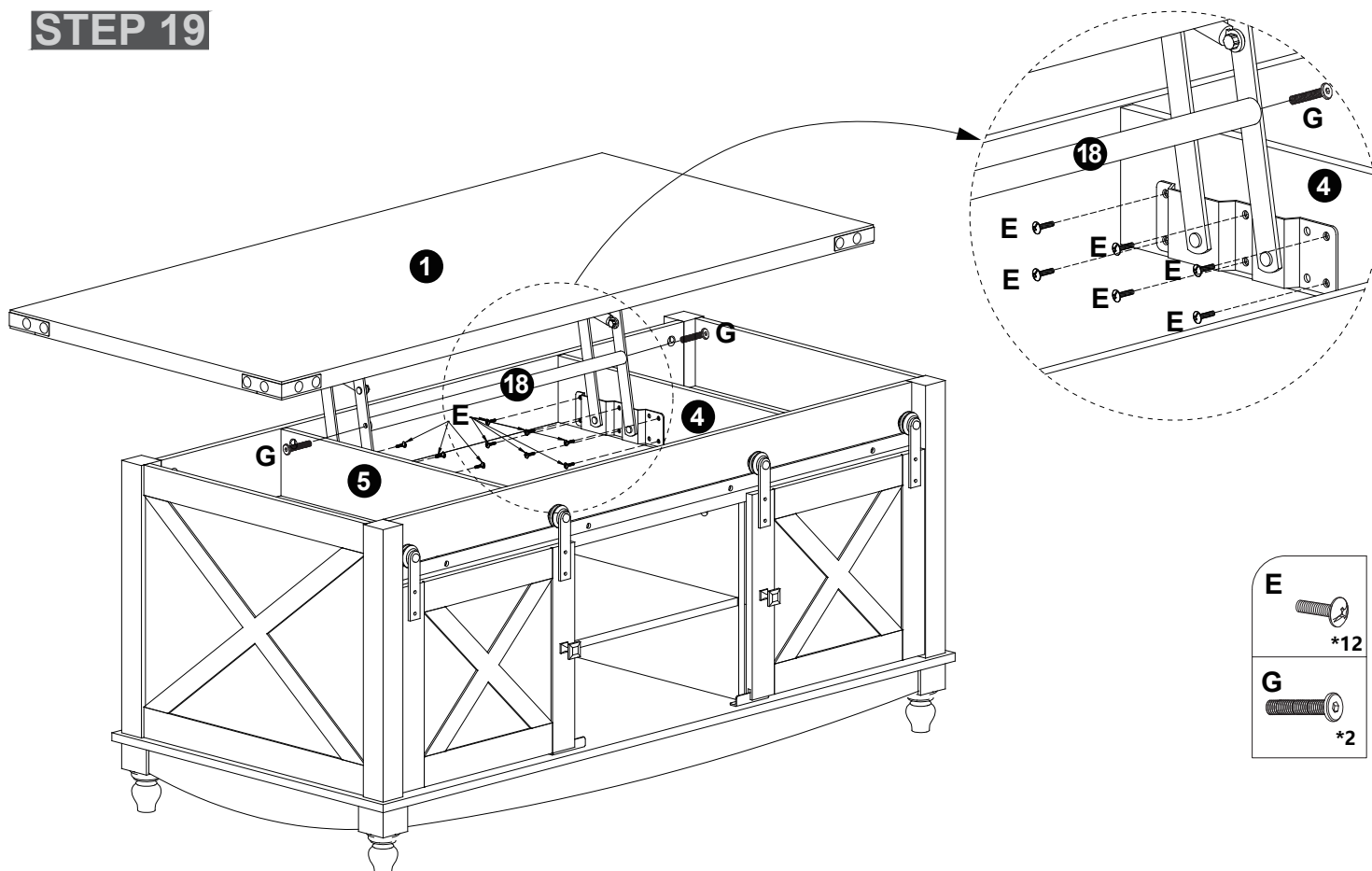

STEP 20

