

Pull Out Drawer - Side Mount

The accessory pack should include the following.

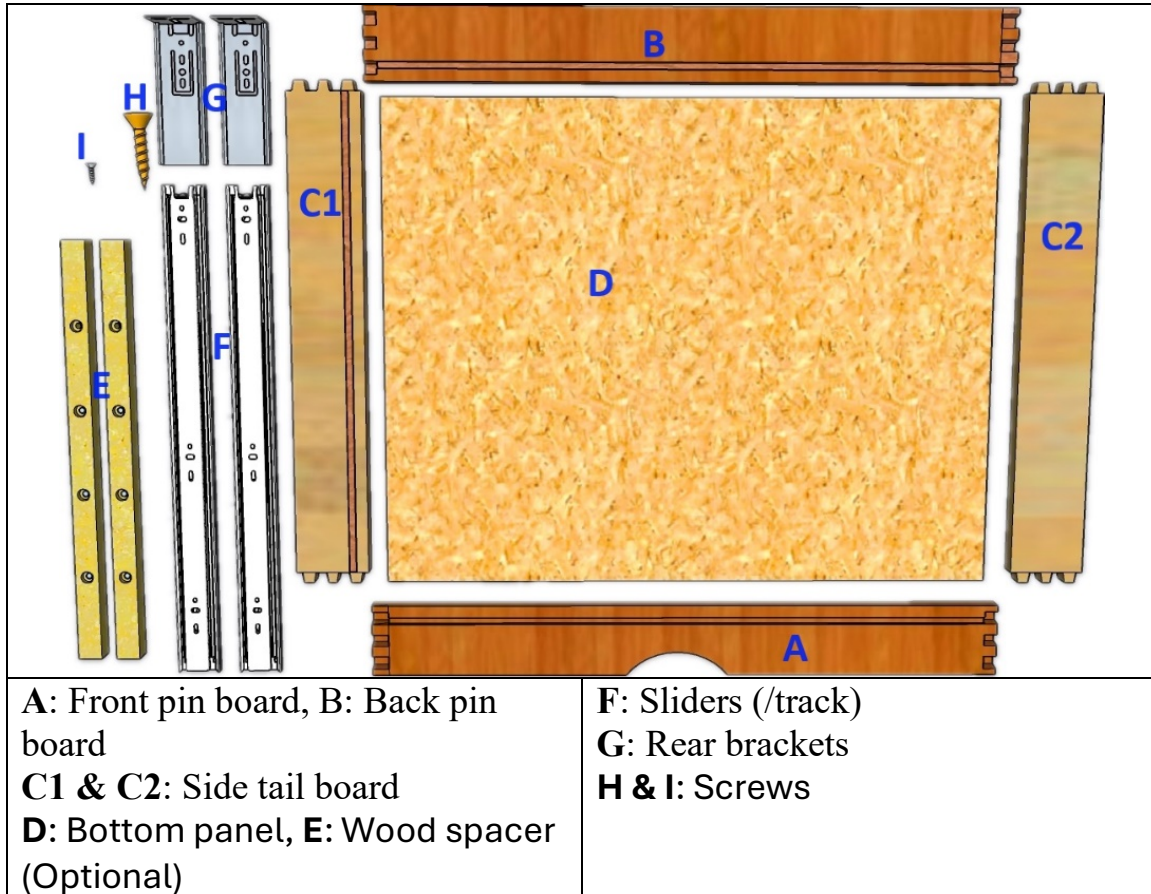

Tools Required

Drill With 1/16'' bit for Drilling pilot Holes, Tape measure, Phillips Head Screwdriver, Rubber Mallet, Level

About the track (Slider)

press and hold this black locking tab ,
then pull out the second section
with force to separate them

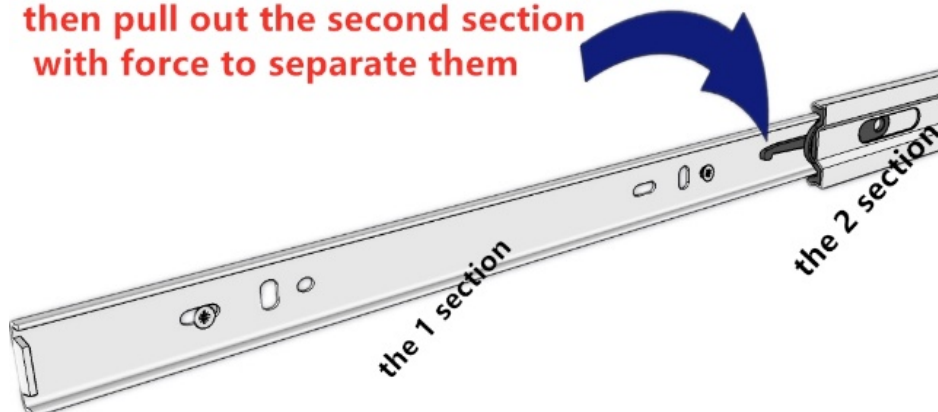

Drawer Box Assemble Instruction

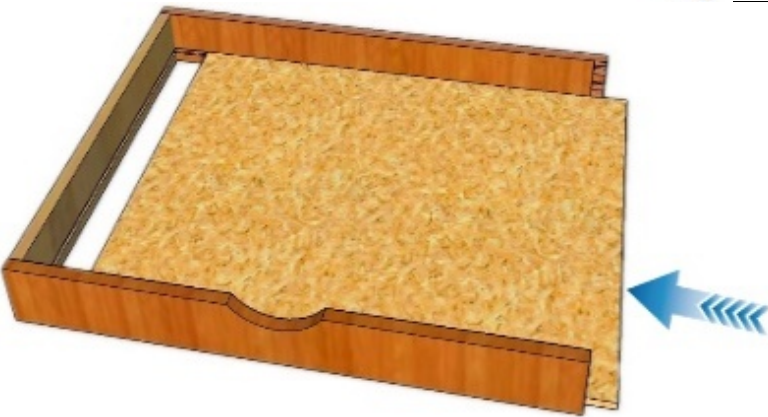
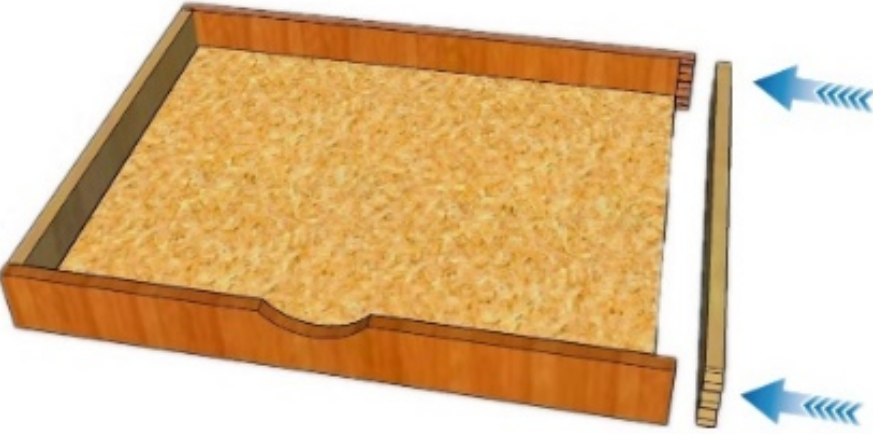
 An exploded view diagram showing three wooden components. Two long side boards (A and B) are positioned at the top and bottom, and a shorter tail board (C1) is positioned to the right. Blue arrows indicate the direction of assembly, pointing towards the center where the boards will meet.	<p>Step 1.</p> <p>Connect the 2 Pin Board (A and B) and 1 Tail board (C1) Together</p>
 A perspective view of the drawer box frame. The two side boards and the tail board are joined. A large, rectangular panel of particleboard (D) is being inserted into the frame from the right. A blue arrow points from the panel towards the frame.	<p>Step 2.</p> <p>Insert the Bottom Panel (D).</p>
 A perspective view of the drawer box with the bottom panel in place. A final, thin tail board (C2) is being inserted into the back of the box. Two blue arrows point from the board towards the back of the drawer box.	<p>Step 3.</p> <p>Insert the last Tail board (C2). use a rubber mallet gently.</p>

Pull Out Drawer Installation Instruction

1.

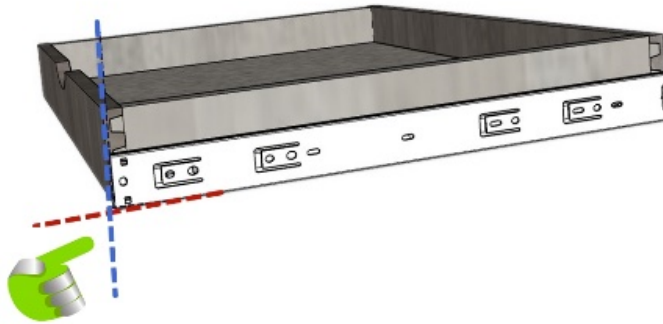

1. Place the drawer slide naturally on the side panel of the drawer, aligning the front of the slide with the front of the drawer and the bottom of the slide with the bottom of the drawer

2.

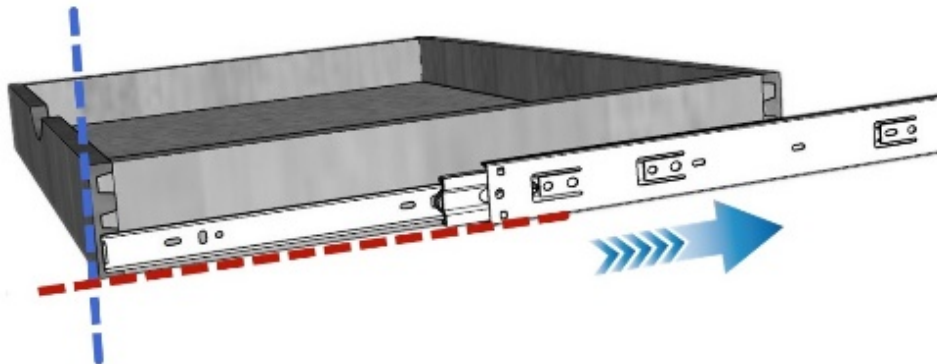

2. Continue to keep them aligned and slide the second and third sections of the drawer slides horizontally along the bottom of the drawer, exposing the first section of the slides.

3.

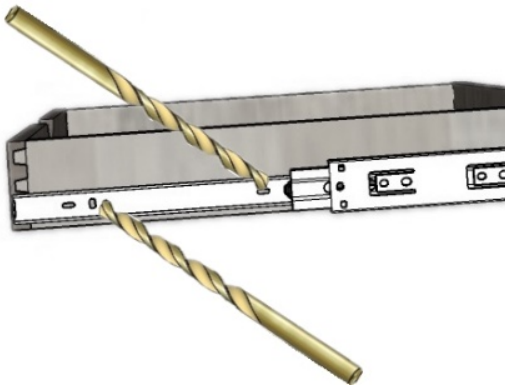

4.

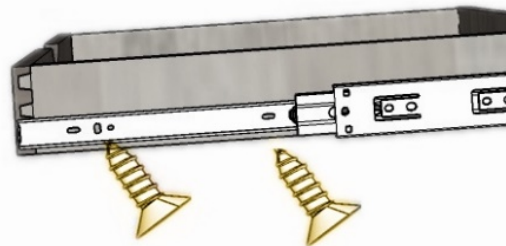

3.& 4 Before driving the screws into the drawer, first drill a pilot hole using a 1/16" drill bit. **This step is crucial.**

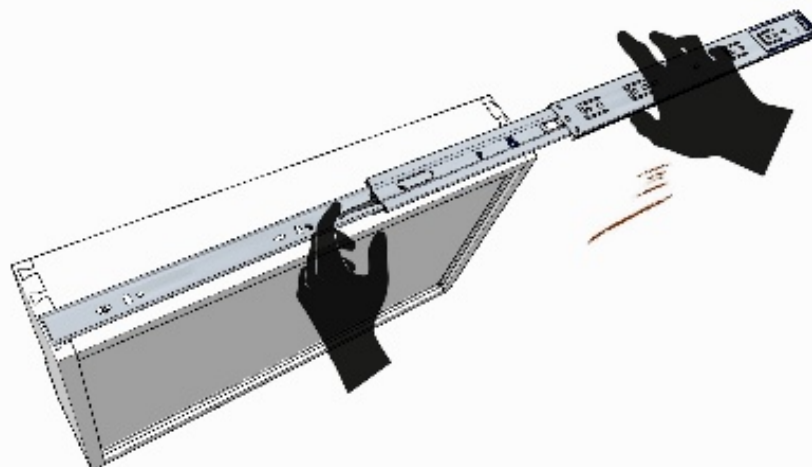

5.

5. Hold the black plastic latch and forcefully pull the second and third parts of the slide rail to separate them.

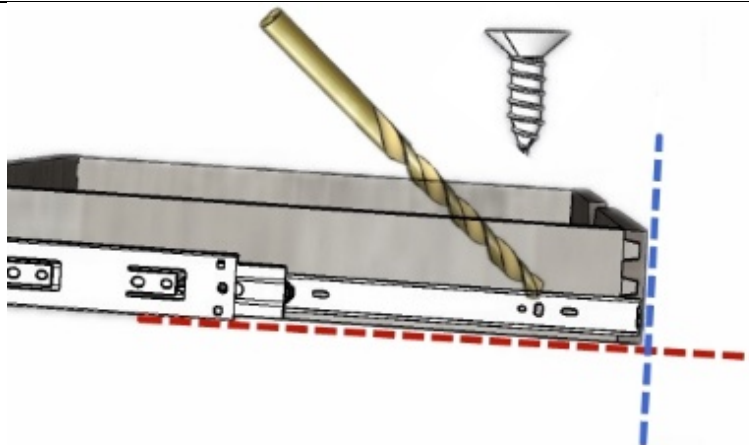

6.

6. Repeat steps 1 to 5 on the other side of the drawer.

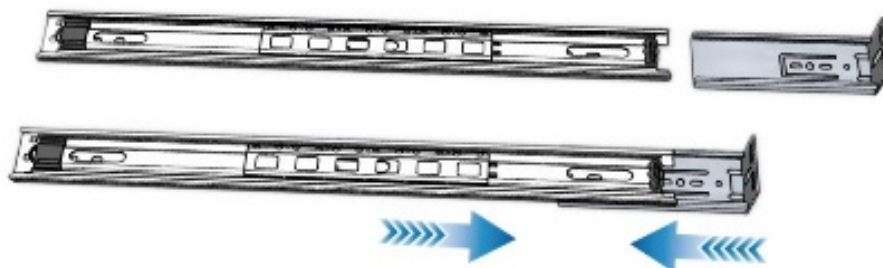

7.

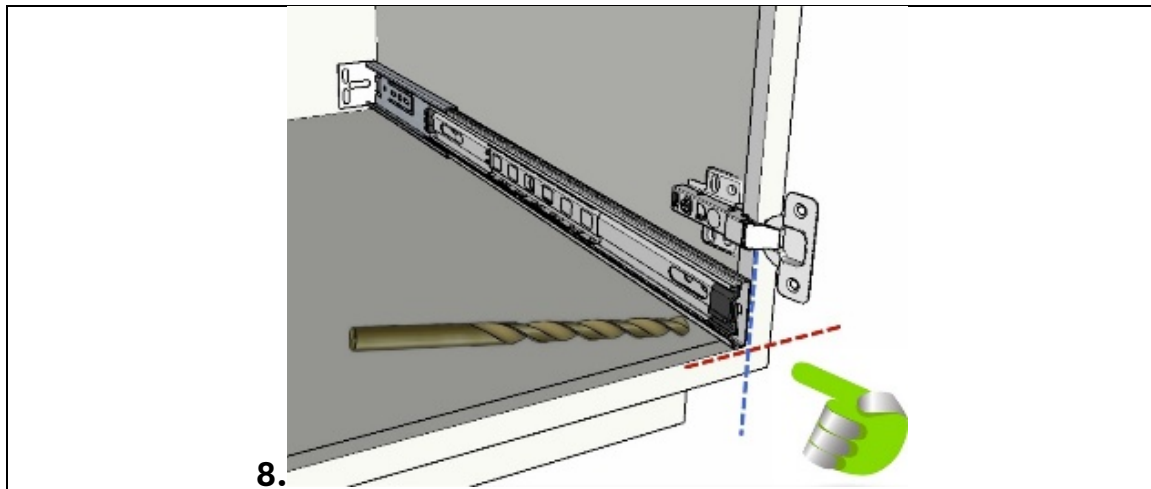

7. & 8 Place the rear bracket on the separate slide rail. Insert it on one side of the cabinet, ensuring the front of the rail is flush with the outer frame of the cabinet and does not extend beyond the cabinet's outer edge. use a 1/16-inch drill bit to drill a pilot hole in the cabinet and then use the screws.

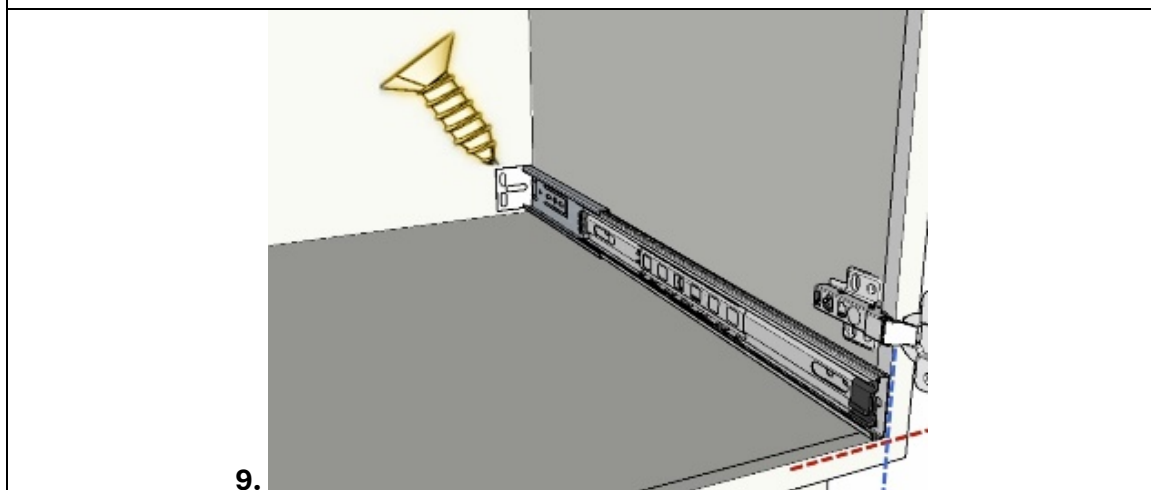

9. Adjust the rear bracket to the appropriate position and screw in the screws. Be careful not to tighten the screws too much, as the position may need to be slightly adjusted. Use a level to ensure the track is horizontal.

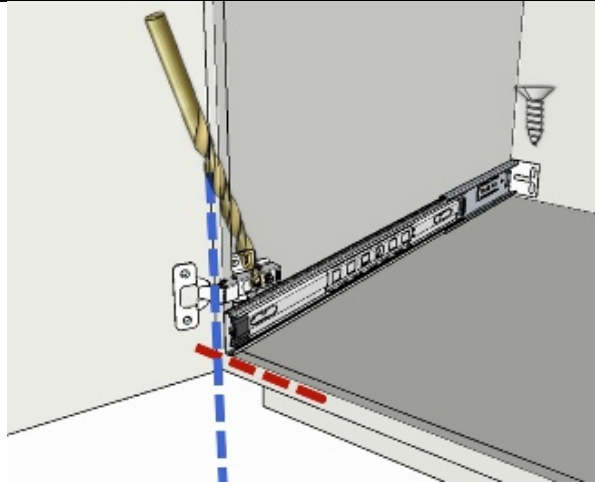

10.

10. Repeat steps 8 and 9 on the other side of the cabinet.

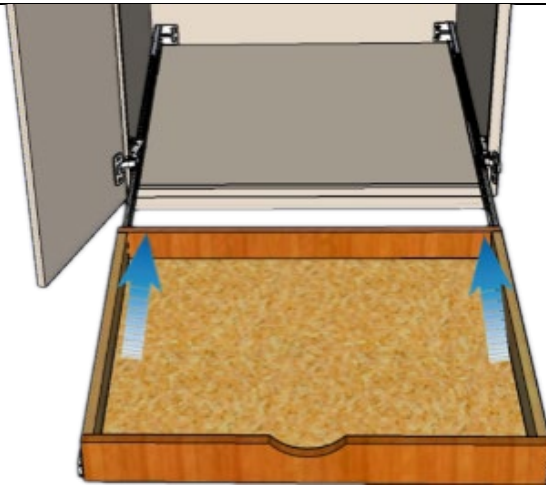

11.

11. Finally, connect the sliding track and insert the drawer all the way in. You will hear the plastic latch locking into place. It is recommended to pull it out two to three times to ensure it slides smoothly. If necessary, adjust and tighten the screws on the rear bracket.

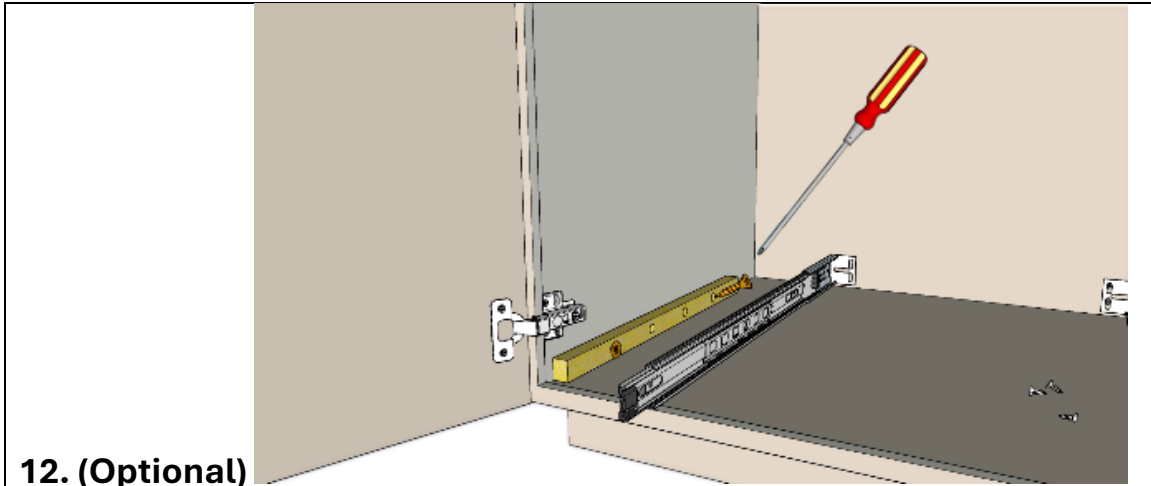

12. (Optional)

12. If necessary, wooden spacers can be used between the track and the cabinet.
(Optional)