

# Black Dual Monitor Desk Stand with Wood Base

SKU: STAND-V002FD-B/W  
Instruction Manual

---

Assembly Video & Product Info  
[www.vivo-us.com/products/stand-v002fd-b](http://www.vivo-us.com/products/stand-v002fd-b)



# ! CAUTION! !

If you do not understand these directions, or if you have any doubts about the safety of the installation, please contact our product support team at 309-278-5303 or help@vivo-us.com for further assistance. Check carefully to make sure there are no missing or defective parts. Improper installation may cause damage or serious injury. Do not use this product for any purpose that is not explicitly specified in this manual. Do not exceed weight capacity. We cannot be liable for damage or injury caused by improper mounting, incorrect assembly or inappropriate use.



## WARNING: CHOKING HAZARD

SMALL PARTS - NOT FOR CHILDREN UNDER 3 YEARS. ADULT SUPERVISION IS REQUIRED.



## DO NOT EXCEED WEIGHT CAPACITY

FAILURE TO DO SO MAY RESULT IN SERIOUS INJURY.

---

## We're Here for You

Open **Monday - Friday 7:00am - 7:00pm** CST, our dedicated support team can offer immediate assistance with rapid response times. If any parts are received damaged or defective, please contact us. We are happy to replace parts to ensure you have a fully functioning product.



Give us a Call:  
**309-278-5303**

AVG. RESOLUTION TIME (*within office hrs*): **5M 4S**



Chat Us:  
**www.vivo-us.com**

AVG. RESOLUTION TIME (*within office hrs*): **< 15 M**



Email Us:  
**help@vivo-us.com**

AVG. RESPONSE TIME (*within office hrs*): **1HR 8M**

- 23% within < 15m
- 38% within < 30m
- 61% within < 1hr
- 83% within < 2hr
- 92% within < 3hr

# Package Contents



**A (x1)**  
Pole

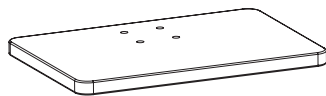

**B (x1)**  
Wood Base

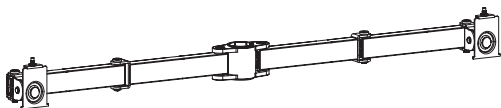

**C (x1)**  
Arm



**D (x2)**  
VESA Plate



**E (x1)**  
Pole Cap



**F (x1)**  
Grommet Soft Pad

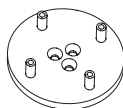

**G (x1)**  
Grommet Top  
Plate



**H (x1)**  
Pole Cover

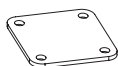

**I (x1)**  
Grommet Bottom  
Plate



**J (x4)**  
Foot



**K (x4)**  
Soft Pad

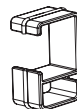

**L (x4)**  
Cable Clip



**M (x1)**  
Pole Cable Clip

# Included Hardware & Tools



**S-A** (x4)  
M6x20mm Screw



**S-B** (x3)  
M6x16mm Screw



**S-C** (x2)  
M6 Cap Nut

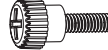

**M-A** (x8)  
M4x12mm  
Thumbscrew



**M-B** (x8)  
M4x30mm Screw



**M-C** (x8)  
Spacer



**T-A** (x1)  
3mm Allen  
Wrench



**T-B** (x1)  
4mm Allen  
Wrench



**T-C** (x1)  
5mm Allen  
Wrench

---

## Tools Needed:



**Phillips  
Screwdriver**

## Weight Capacity:



**Per Screen**

## ASSEMBLY STEPS

### STEP 1

Remove adhesive backing from Grommet Soft Pad (**F**) and apply it to the bottom of Grommet Top Plate (**G**).

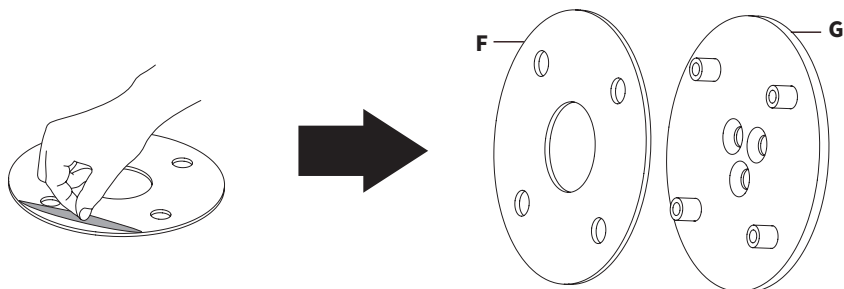

Assemble Grommet Top Plate (**G**) to the underside of Pole (**A**) using M6x16mm Screws (**S-B**) and 4mm Allen Wrench (**T-B**).

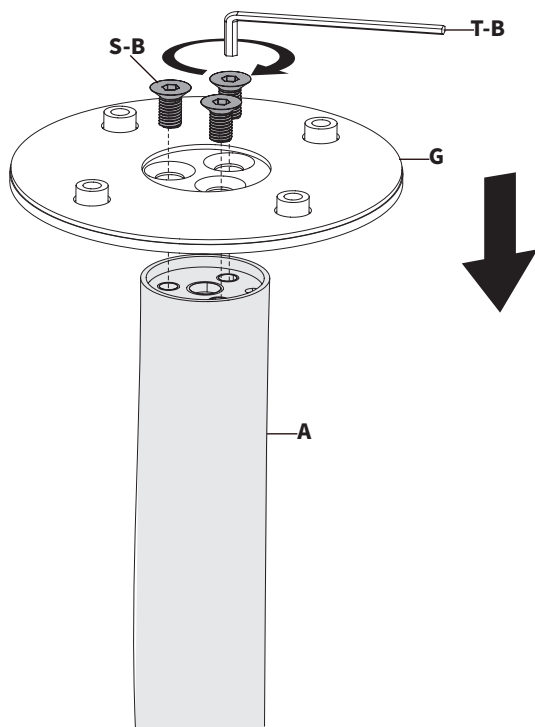

## STEP 2

Secure Grommet Top Plate (**G**) to Wood Base (**B**) with Grommet Bottom Plate (**I**) using the 4mm Allen Wrench (**T-B**) and M6x20mm Screws (**S-A**).

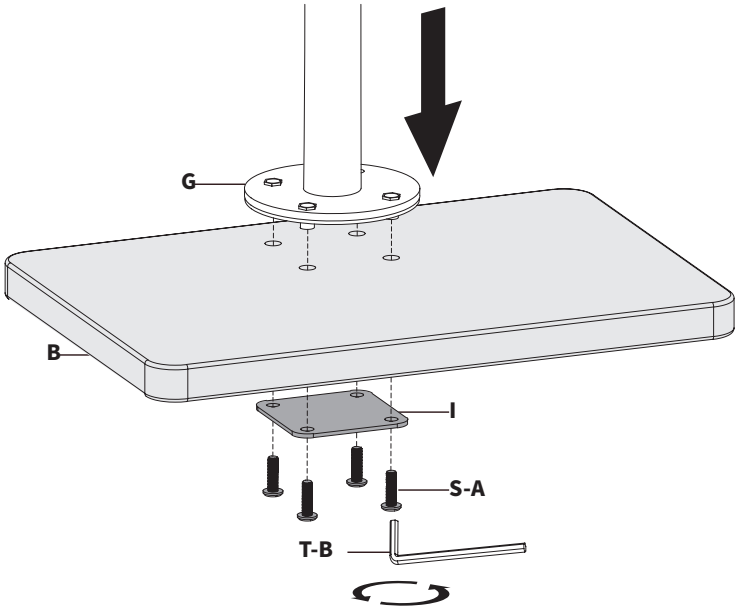

Remove adhesive backing from Feet (**J**) and apply them to the bottom of Wood Base (**B**), and then remove the adhesive backing from Soft Pads (**K**) and apply them on top of Feet.

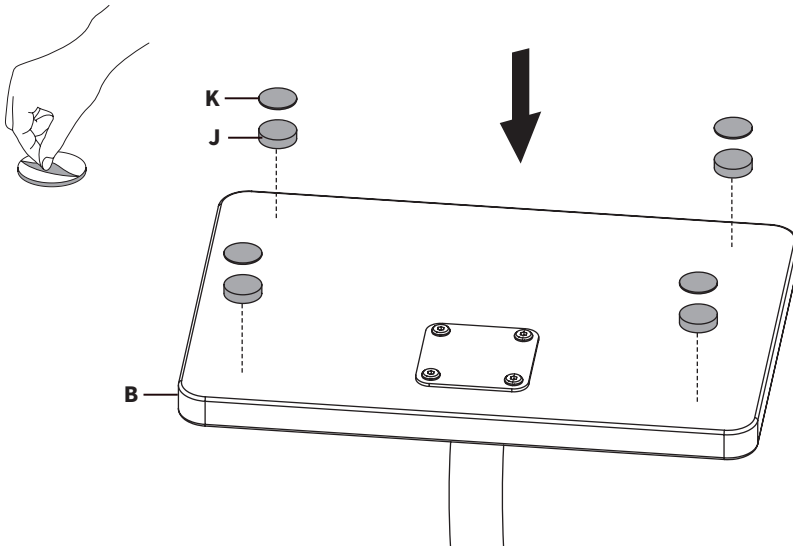

## STEP 3

1. Slide Pole Cover (H), Pole Cable Clip (M), and Arm (C) onto Pole (A).
2. Secure Arm in place using 5mm Allen Wrench (T-C).
3. Insert Pole Cap (E) into the top of Pole.

**NOTE:** Pole Cover is a decorative piece. The stand can be assembled without it.

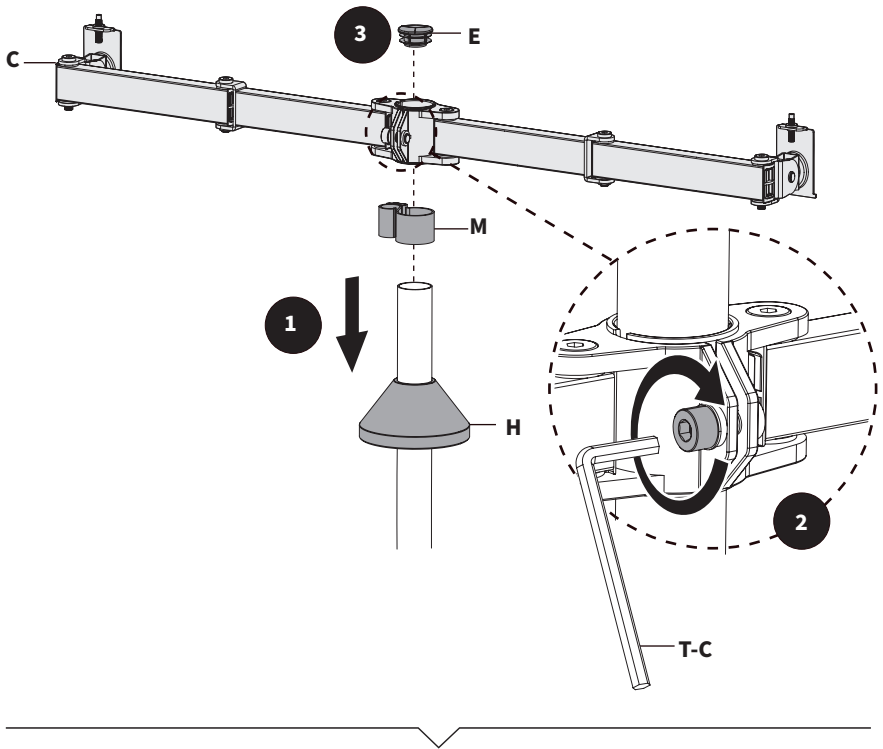

Attach Arm Cable Clips (L) onto Arm (C).

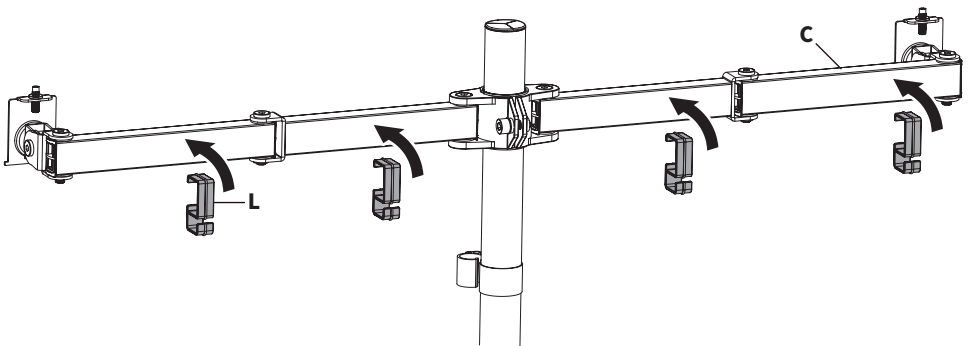

## STEP 4

Assemble VESA Plates (**D**) to the back of monitors using appropriate hardware for your screen type.

### FLAT BACK MONITORS:

If using a flatback monitor, use M4x12mm Thumbscrews (**M-A**) as seen in Fig. 1.

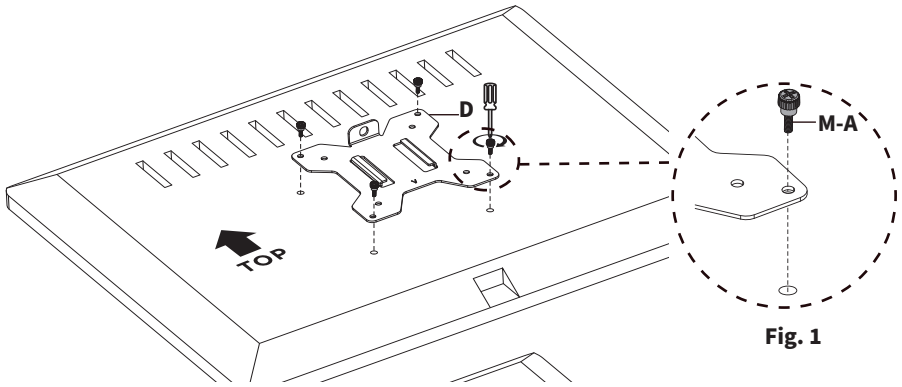

### CURVED/RECESSED MONITOR:

If using a curved/recessed back monitor, use M4x30MM (**M-B**) with Spacers (**M-C**) as seen in Fig. 2.

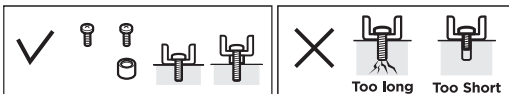
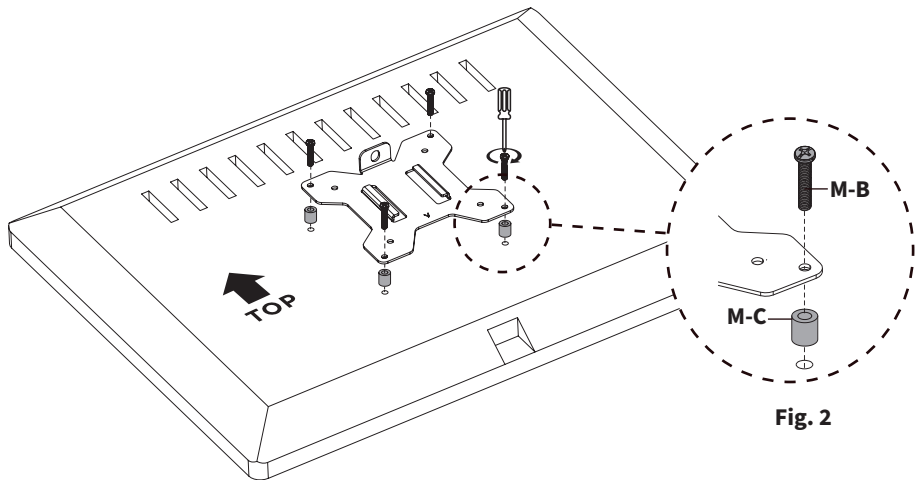

## STEP 5

Slide monitors with VESA Plates (**D**) onto Arm (**C**). Secure VESA Plates in place using M6 Cap Nuts (**S-C**).

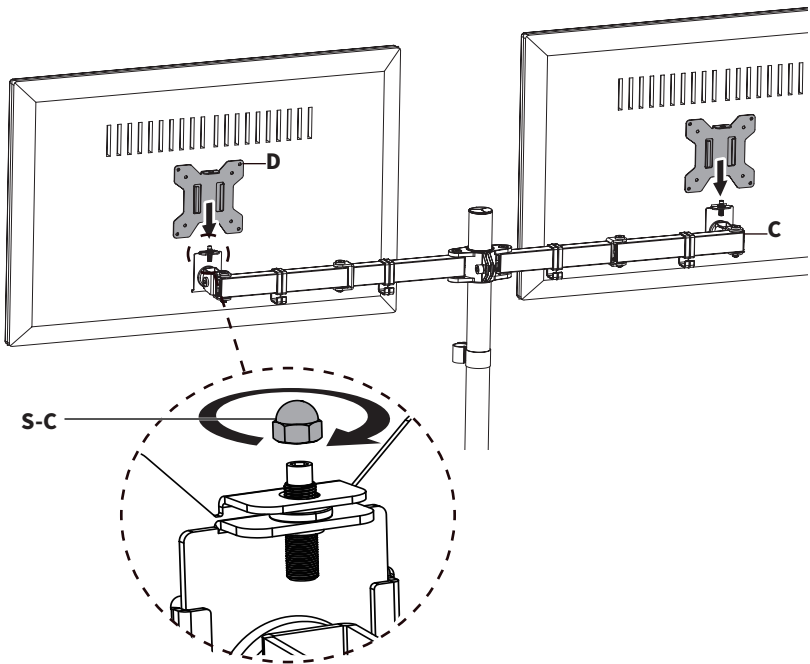

## STEP 6

Manage cables using Arm Cable Clips (**L**) and Pole Cable Clip (**M**).

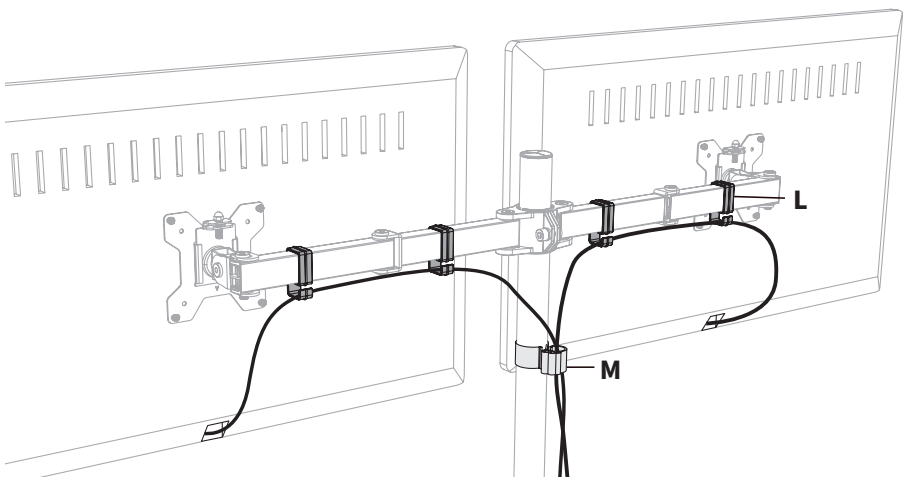

## STEP 7

Use caution when orienting your monitors. If the monitors are pulled too far forward or too far back it can result in the stand tipping over.



**CAUTION:**  
**DO NOT** use the display beyond the arrow range, avoid tipping.

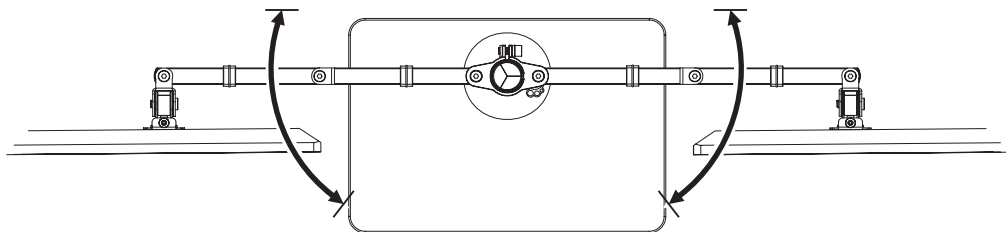

## STEP 8

To level monitors, remove M6 Security Nuts (**S-C**) and tighten or loosen adjustment screws using 3mm Allen Wrench (**T-A**). Once level, fasten M6 Security Nuts back into place.

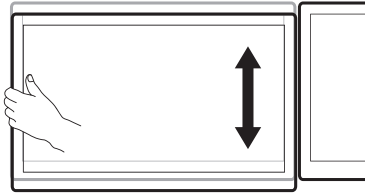
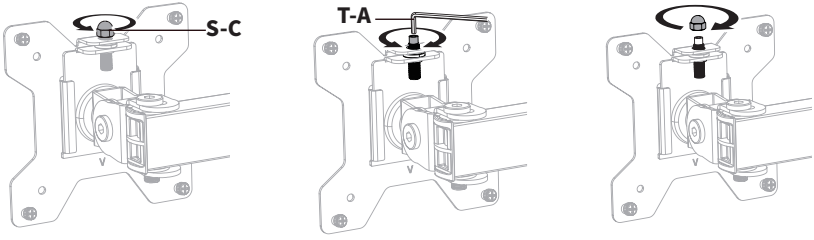

.....

Adjust the monitor tilt using 5mm Allen Wrench (**T-C**).

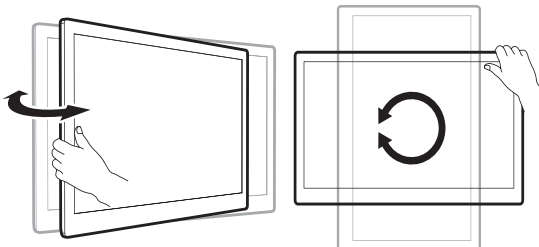
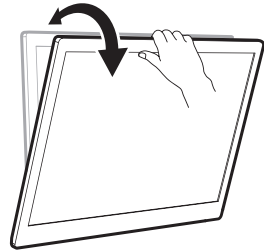
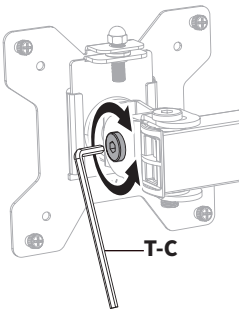



## Need Help? Get In Touch

Monday-Friday from 7:00am-7:00pm CST



[help@vivo-us.com](mailto:help@vivo-us.com)



[www.vivo-us.com](http://www.vivo-us.com)

*Chat live with an agent!*



309-278-5303



**VIVO-us** @vivo\_us

FOR MORE GREAT VIVO PRODUCTS,  
CHECK OUT OUR WEBSITE AT: [WWW.VIVO-US.COM](http://WWW.VIVO-US.COM)