

# Single Hole Bathroom Lavatory Faucet

Applicable faucets (including but not limited)



## TOOLS YOU WILL NEED



Adjustable wrench



Phillips screwdriver



Hex Wrench



Two Male Supply



pipe tape



Silicone sealant/Putty

## INSTALLATION

**Prior to installation:** Shut off water supply. Remove old faucet.  
Clean sink/countertop surface in preparation for new faucet

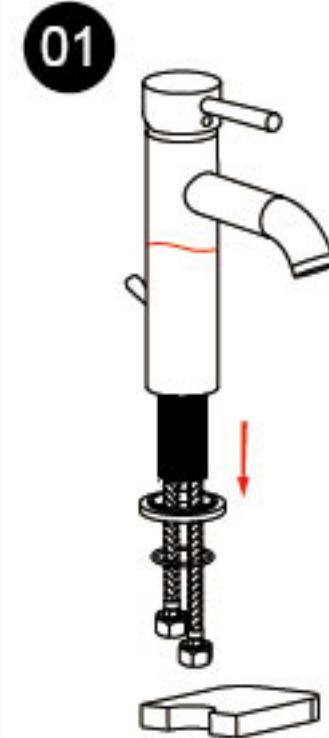

Slide the O-Ring to base. Insert the faucet through the sink.

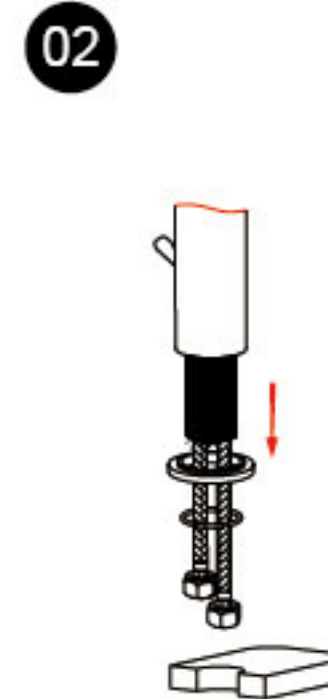

Ready to install underneath sink. Put the washer on mounting screw nut.

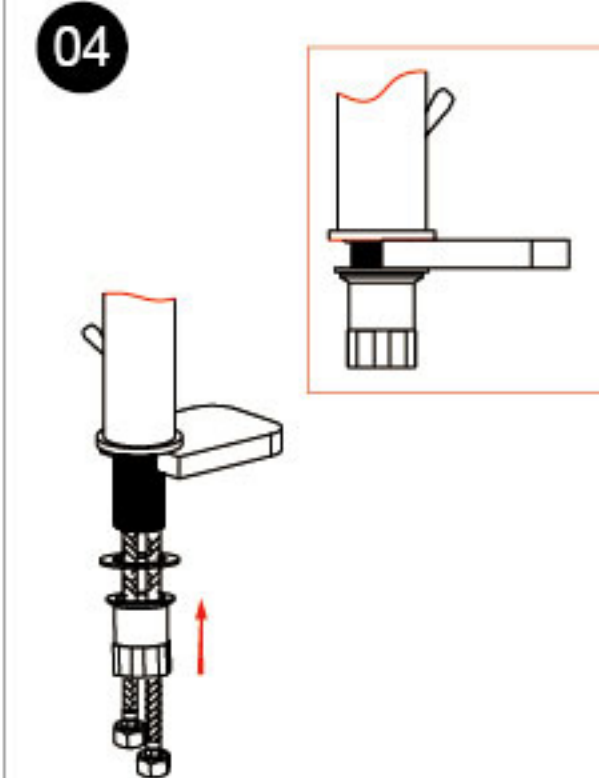

Screw the nut onto shank, leaving approximately 0.12" (3mm) between the ring and the sink.

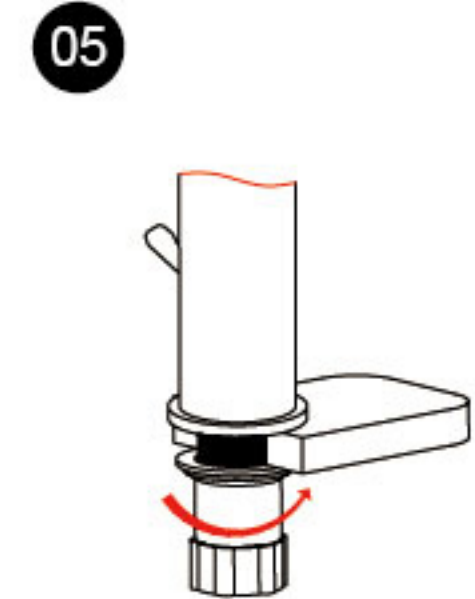

Hold the faucet mounting screw underneath, meanwhile, rotate the faucet mainbody to your desired direction from upside. Then tighten the mounting nut securely

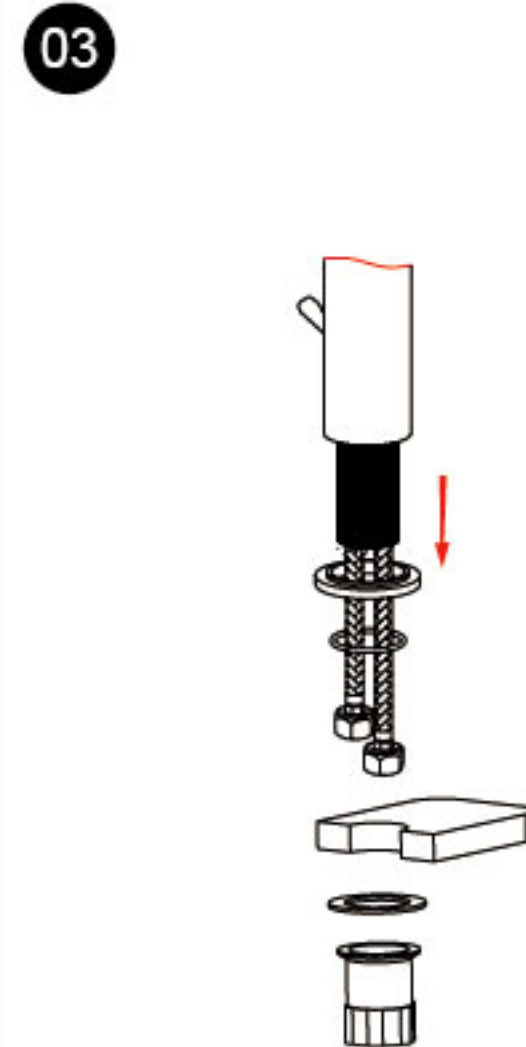

Partially thread screws into the ring

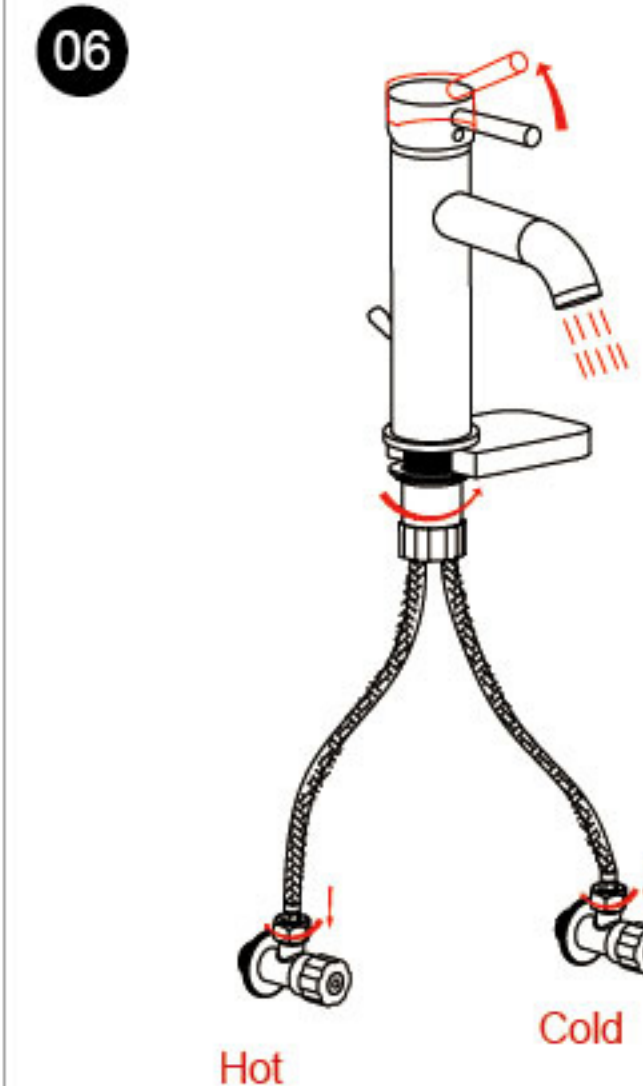

Connect and tighten the supply hoses.



# Single Hole Bathroom Lavatory Faucet

07

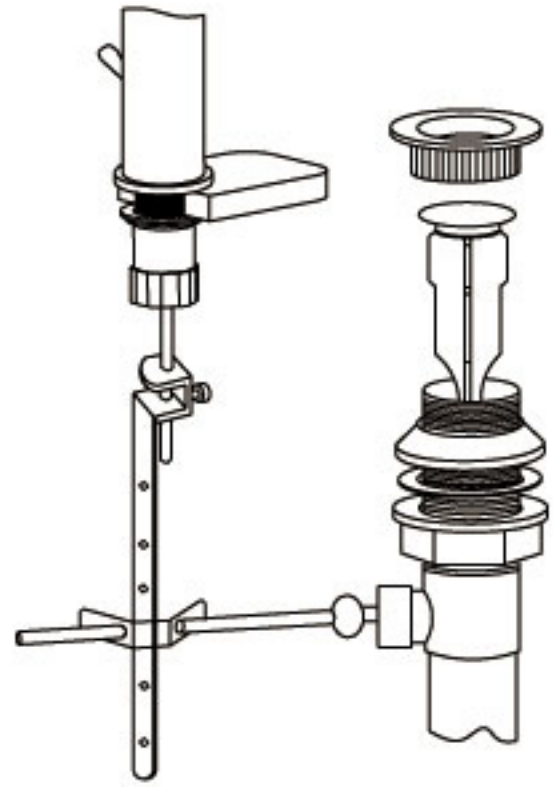

If included, install the drain and lift rod.

08

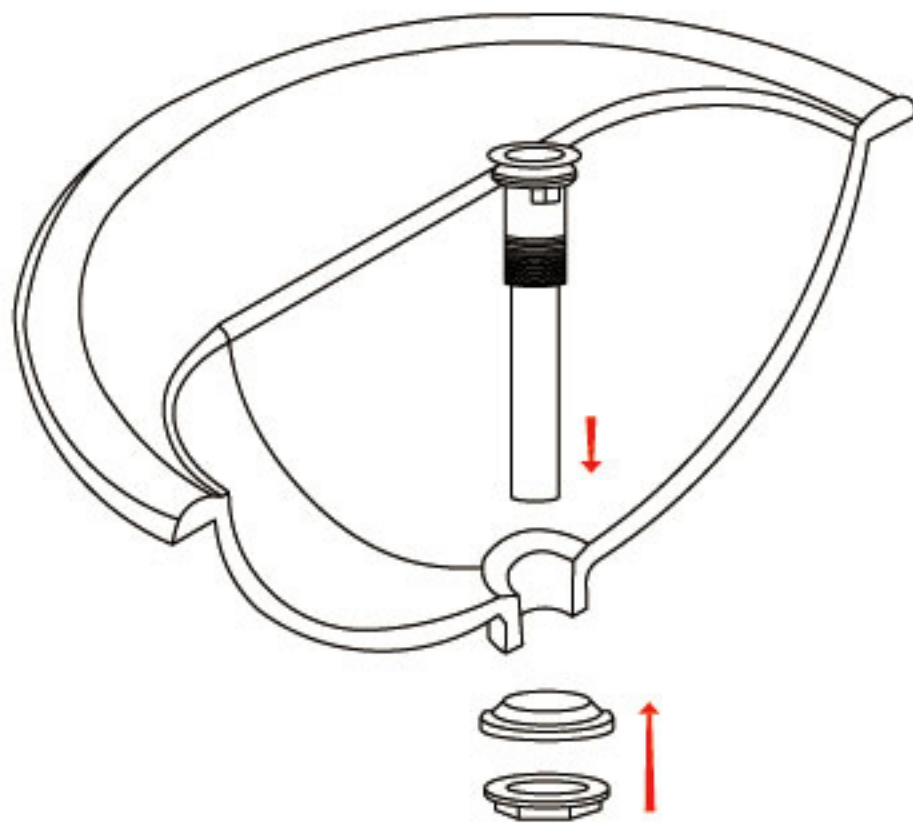

Disassemble the drain, apply plumbers putty to the underside of the flange. Install the flange. Tighten the nut. Wipe away excessive plumbers putty.

09

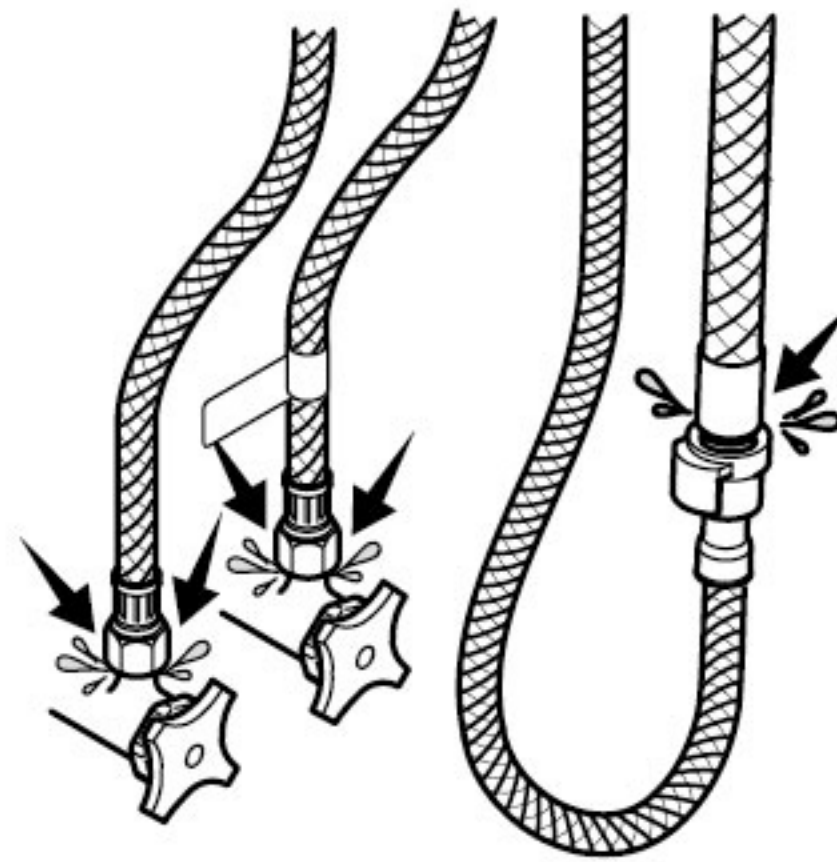

Check for leaks

10

## Care and Cleaning

For best results, keep the following in mind when caring for your VAPSINT product:

- Use a mild detergent such as liquid dishwashing soap and warm water for cleaning. Do not use abrasive cleaners that may scratch or dull the surface.
- Carefully read the cleaner product label to ensure the cleaner is safe for use on the material.
- Always test your cleaning solution on an inconspicuous area before applying to the entire surface.
- Do not allow cleaners to sit or soak on the surface.
- Wipe surfaces clean and rinse completely with water immediately after cleaner application. Rinse and dry any overspray that lands on nearby surfaces.

