

## FULL SIZE BED

---

### ASSEMBLY INSTRUCTIONS



# ASSEMBLY INSTRUCTIONS

## ASSEMBLY TIPS:

1. Remove hardware from box and sort by size.
2. Please check to see that all hardware and parts are present prior to start of assembly.
3. Please follow attached instructions in the same sequence as numbered to assure fast & easy assembly.



### Warning !

1. Don't attempt to repair or modify parts that are broken or defective. Please contact the store immediately.
2. This product is for home use only and not intended for commercial establishment.

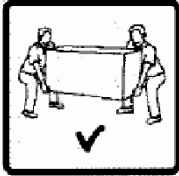

ASSEMBLY TIME

35 MINUTES

## PARTS IDENTIFICATION

### B1 (BOX 1)



HEADBOARD 1 PC

### B2 (BOX 2)

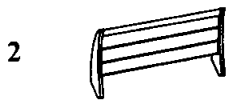

FOOTBOARD 1 PC

### B3 (BOX 3)

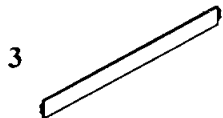

BED RAIL 2 PCS

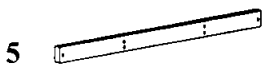

CENTER RAIL 1 PC

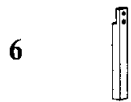

BED SLAT  
SUPPORT  
WITH LEVELER 2 PCS

### B4 (BOX 4)



ROLL SLAT 2 SETS  
(7 PCS)

## HARDWARE IDENTIFICATION

A  ALLEN WRENCH 1 PC

B  BOLT 6 PCS

C  LOCK WASHER 4 PCS

D  FLAT WASHER 4 PCS

E  LONG SCREW 28 PCS

F  SHORT SCREW 8 PCS

G  WRENCH 1 PC

H  HEXAGON NUT 2 PCS

I  U BRACKET 2 PCS

**NOTE :PHILLIPS HEAD SCREW DRIVER IS REQUIRED IN THE ASSEMBLY PROCESS;  
HOWEVER MANUFACTURER DOES NOT PROVIDE THIS ITEM.**

**NOTE :ALL HARDWARE WAS PACKED IN A BAG AND PUT IN HEADBOARD BOX (BOX 1)**

# ASSEMBLY INSTRUCTIONS

## BOX 1 TO BOX 3

### STEP 1

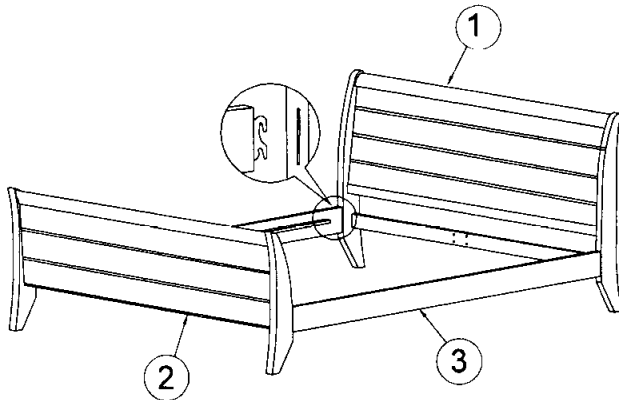

### STEP 2

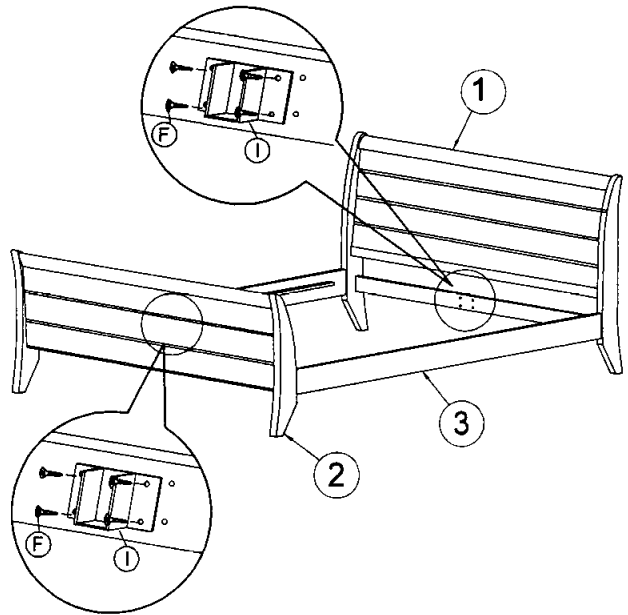

### STEP 3

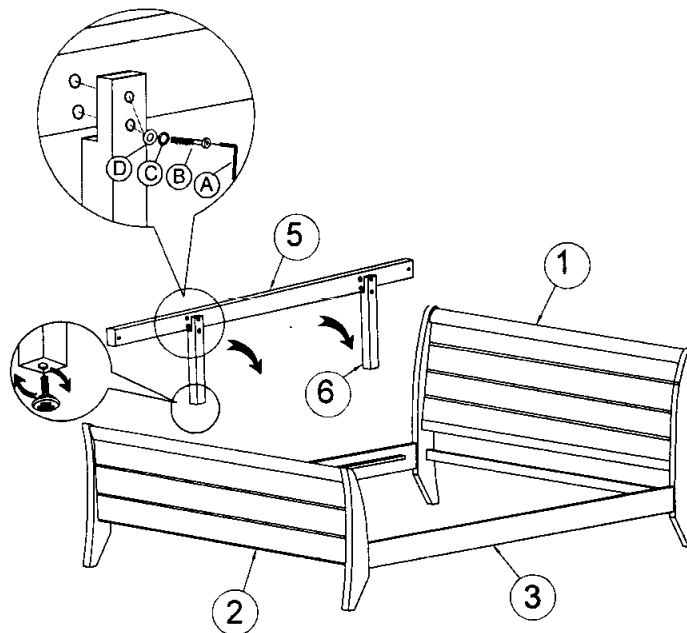

## ASSEMBLY INSTRUCTIONS

### STEP 4

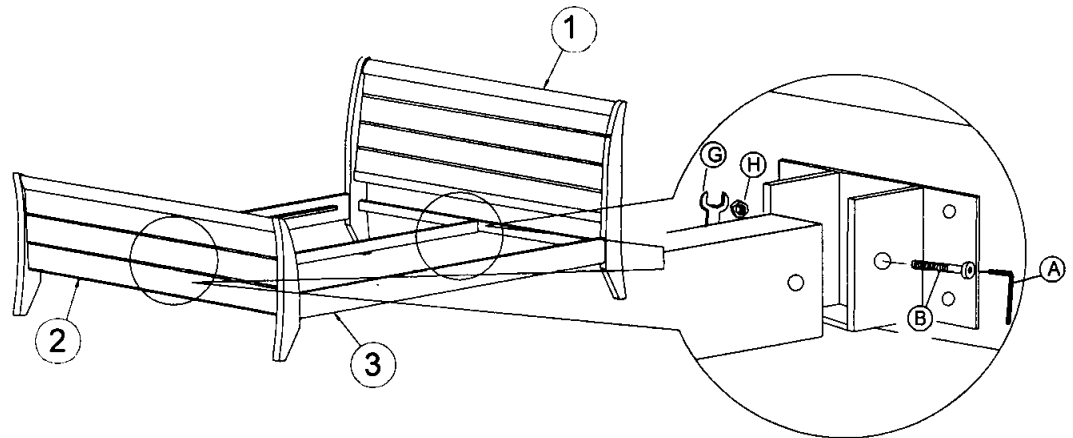

### BOX 1 TO BOX 4

### STEP 5

