

145.00 mm

145.00 mm

210.00 mm

# DC METAL DRUM JET FAN



## Instruction Manual

Model:HIFANSTANDRETRO7B

back cover

cover

## Important Safeguards

**When using electrical appliances, in order to reduce the risk of fire, electric shock and/or injury, these basic safety precautions should always be followed:**

## For Your Safety

**Read all instructions carefully, even if you are familiar with the appliance.**



- This appliance is not intended for use by persons (including children) with reduced physical, sensory and mental capabilities, or lack of experience and knowledge, unless they have been given supervision or instruction concerning use of the appliance by a person responsible for their safety.
- Children should be supervised to ensure that they do not play with the appliance.
- Switch off the power outlet and remove the plug when the appliance is not in use, when moving fan from one location to another and before cleaning.
- Do not operate any appliance with a damaged power cord or plug; if the appliance malfunctions; or if it is dropped or damaged in any manner.
- This appliance is intended for household use only and not for commercial, industrial or outdoor use. Other use not recommended may cause fire, electric shock or injury.
- Do not use any appliance for anything other than its intended use. This product is intended for household use only.
- This appliance is intended to be plugged in a 220-240V ac 50Hz power outlet.
- Do not misuse the power cord. Never carry the appliance by the power cord or pull to disconnect it from the outlet. Instead, grasp the plug and pull to disconnect.
- Do not attempt to repair, disassemble or modify the appliance. There are no user serviceable parts.
- Arrange the power cord away from traffic areas where it will not be tripped over.
- Ensure that the fan is unplugged before removing the guard.
- Never insert foreign objects such as fingers, pencils, etc. through the grille when fan is running as this may cause damage to the appliance and/or injury to the user.
- To prevent fire or shock hazard, DO NOT expose this appliance to rain or moisture.
- Do not use fan near curtains, plants, window treatment, or where other objects can become caught in the blades.
- Do not operate fan in the presence of explosive and/or flammable fumes. Do not place the fan near an open flame, cooking or other heating appliance.
- Do not place the fan close to an open window. Rain splashing on the fan could cause an electric shock hazard.
- Do not leave the appliance running or operable in a place where young children or animals could have access to it without supervision.
- Always unplug the fan when moving from one location to another, when removing grilles or for cleaning.
- Do not use the fan without fully assembled. The fan must operate standing upright.
- To protect against fire, electrical shock and injury to persons, do not immerse unit, plug or cord in water or spray with liquids.
- Ventilation should not be impeded by covering the ventilation openings. Slots and opening are provided for ventilation to ensure reliable operation of the product and to protect it from overheating.
- Place the fan on a stable level, even surface when operating to avoid overturning.
- DO NOT disassemble the fan and this fan cannot be disassembled.

## Using Remote Control

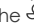
Press the  key to turn On the fan and the fan will by default operate at High (3) fan speed.

With the fan turned On, adjustment the fan speed by pressing the  key, the fan speed will increase the setting from low to high, repeat press this key, the setting changes will scroll from low to high.

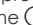
With the fan turned On, Press "+"key to adjust the fan speed setting from low to high; Press "-" key to adjust the fan speed setting from high to low.

If you wish to turn the unit off at a pre-determined time, Speedily press the  key, the fan can be set to turn off at any time between 1 Hour and 6 Hours from pressing the  key, the corresponding indicator light will flash with a short while.

If no time is selected, the fan will operate continuously. The time set can be incrementally in 1 Hour steps and the selected time is indicated by a combination of the indicator lights.

The time set and indicator lights relation shown as below:

- 1 H= Indicator light 1.
- 2 H= Indicator light 2.
- 3 H= Indicator light 3
- 4 H= Indicator light 1 & 3 together.
- 5 H= Indicator light 2 & 3 together.
- 6 H= Indicator light 1, 2 & 3 together.

E.g. 5 Hours are indicated by the No.2 LED and No.3 LED being flash simultaneously with a short time.

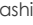
To cancel the timer function, speedily press  key scroll until 6 hours time indicator light flashing, then press  key again.

**Note: The indicator light will not illumination while timer has set and it will always shown the selected speed setting.**

Press the oscillation control key . The fan head will oscillate from left or right.

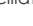
To stop oscillation, press the oscillation control key  again.

Each press of any function key you will hear a "beep" sound.

Turn off and unplug the fan from the electrical outlet when it is not in use or is left unattended. Do not leave this fan unattended while it is in use.

## Care and Cleaning

Always switch the fan off and unplug it before cleaning.

The fan head has no dis-assembly part, do not dis-assemble the fan. Wipe fan housing with soft damp cloth. Allow to dry.

If necessary, use a soft brush to remove dust from the guards.

Clean other parts using a damp cloth and a mild detergent and ensure that all detergent residues are removed.

Never use abrasive cleaning agents or solvents. Do not immerse in any form of liquid or splash with any other liquids.

## Storage

If the fan will not be used for a long period, store in a cool dry, safe place and away from heat and the sunlight.

## Technical Specifications

Supply Voltage: 120V~ 60Hz





Power Consumption: 30W

**NOTE: As a result of continual improvements, the design and specifications of the product within may differ slightly to the unit illustrated on the packaging.**

145.00 mm

145.00 mm

To have the fan head oscillate in a gentle lateral motion, Press the oscillation control key . The fan head will oscillate from left or right.

To stop oscillation, press the oscillation control key  again.

Each press of any function key will create a "Beep" sound.

## Operating The Fan with Remote Control



All available functions on the fan control panels can similarly operated via the remote control.

### Before Use Remote Control

- One CR2025 button cell battery is included in the remote control. In order to operate the remote control for the first time, remove the insulating tab away from the battery compartment.
- Remove the Battery if you do not require the use of your remote control for a long period of time.
- Respect the environment, dispose of Battery in accordance with local requirements. Do not put the battery into fire.

#### WARNING:

**There is a button cell battery in the remote control. The button cell battery is not a toy, Keep the button cell battery out of reach for children and Children Do not play with the batteries.**

#### WARNING:

**Ensure at anytime that coin cell battery will not be accessible and be kept out of reach from children.**



DANGER if swallowed

**WARNING:** This product contains a coin/button cell battery inside. Keep batteries out of reach of children. Swallowing may lead to serious injury or death in as little as 2 hours due to internal burns.

If swallowed, immediately call the 24-hour Poison Information Centre on 13 11 26 (in Australia) or 24-hour National Poisons Centre on 0800 764 766 (in New Zealand) for fast, expert advice. Dispose of used batteries in an environmentally friendly manner in accordance with local council regulations immediately.

This product has been designed so that the coin/button cell battery is not accessible to young children, as the battery compartment cover is secured with a screw or mechanical fastener. Always ensure that the compartment is secured before use.

## Warning

Do not operate without the fan grilles properly in place. Do not use if grille becomes deformed, damaged or loosen to avoid injury to persons.

## Compulsory Warning

If the supply power cord is damaged, the power cord must be replaced by the manufacturer, its service agent or similarly qualified persons in order to avoid a hazard.

This product has not been designed for any uses other than those specified in this booklet.

## Save These Instructions

## Features of Your Dc Metal Drum Jet Fan

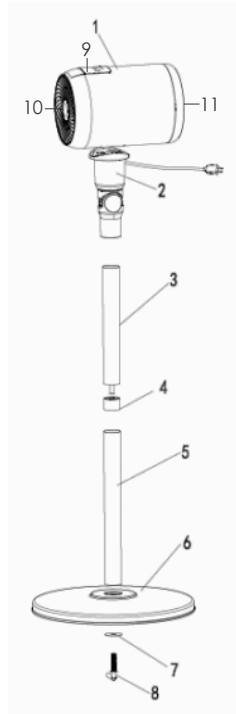

1. Motor Housing
2. Oscillation Head
3. Upper Tube
4. Tube Installation Bush
5. Lower Tube
6. Base
7. Washer
8. Retention Screw
9. Control Panel
10. Front Guard
11. Rear Guard

## Getting to Know Your Dc Metal Drum Jet Fan

Congratulations on the purchase of Your Drum Jet Fan.

Before first using your new Drum Jet Fan, it is important that you read and follow the instructions in this handbook, even if you feel you are familiar with this type of appliance.

Your attention is drawn particularly to the section dealing with IMPORTANT SAFEGUARDS. Find a safe and convenient place to keep this booklet handy for future reference.

This appliance has been designed to operate from a standard domestic power outlet. It is not intended for industrial or commercial use.

Your Drum Jet Fan is safe and easy to use. It has been designed to function quietly and safely under normal circumstances.

The heavy-duty motor is rated to allow continuous use.

## Assembly of DC Metal Drum Jet Fan

Take all parts of the fan from package, remove the packing materials.

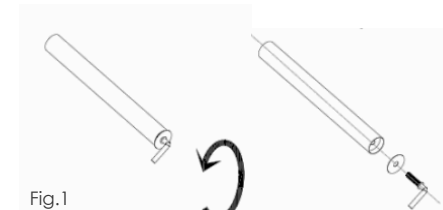

1. Remove the base retention screw and washer from the lower tube by turning it anti-clockwise as shown in Fig.1

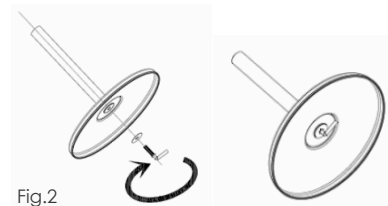

Fig.2

4

2. Insert the lower tube into the base plate, position the washer and secure the lower tube to the base plate with the base retention screw by turning in clockwise direction until hand tight as shown in. (Fig.2)

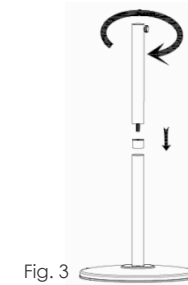

Fig. 3

3. Connect upper tube to the lower tube and turn clockwise until hand tight to secure as shown in Fig.3



Fig.4

4. Position the fan head onto the upper tube assembly and rotate to align the retention knob screw holes on both the upper tube and the fan head post mount as shown in. (Fig.4)

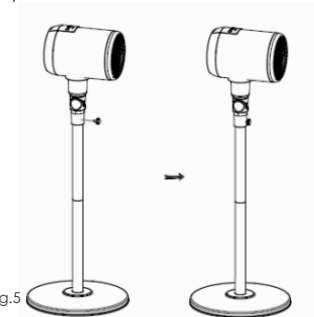

Fig.5

5. Fit the fan head retention knob and tighten to secure the fan head in place as shown in. (Fig.5)



**Note: The fan head comes pre-assembled with fan blade and grilles all in place, so no assembly or dis-assembly required. Just mount direct to the base assembly.**

## Operation of Your DC Metal Drum Jet Fan

Place the fan on a flat and stable surface. Insert the power supply cord set into nearby domestic power outlet and switch On at the wall outlet.

You will hear a "Beep" when power connection is made.

You can now operate the fan via the control panel operating keys on top of the fan head.

Press the  key to turn on the fan. This Power icon key is used to perform both the On and Off (Standby) function of the fan. The  Key is used to activate the speeds of the fan, with the corresponding selected speed indicator lights illuminating. The  key will activate and deactivate the fan head oscillation.

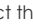
To select the desired speed. Press the  key on the control panel. For the selected speed the corresponding speed indicator light(s) will illuminate.

The fan speed settings are as indicated below:

- Low Speed 1 – Indicator Light 1
- Medium Speed 2 – Indicator Light 2
- High Speed 3 -Indicator Light 3

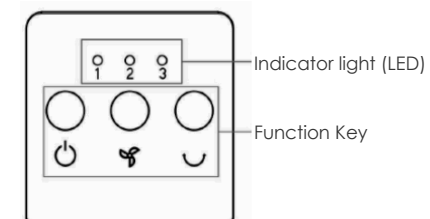

- 1 = Low fan speed setting
- 2 = Medium fan speed setting
- 3 = High fan speed setting

To adjust the angle of the fan head, hold the fan housing securely and push or lift the fan head to the desired angle. While adjusting the fan head, you can hear "click, click" sounds indicate the fan head is adjusting.

5