

**Extended Warranty
Sign Up**

Welcome home!

Romanza Tripod Floor Lamp

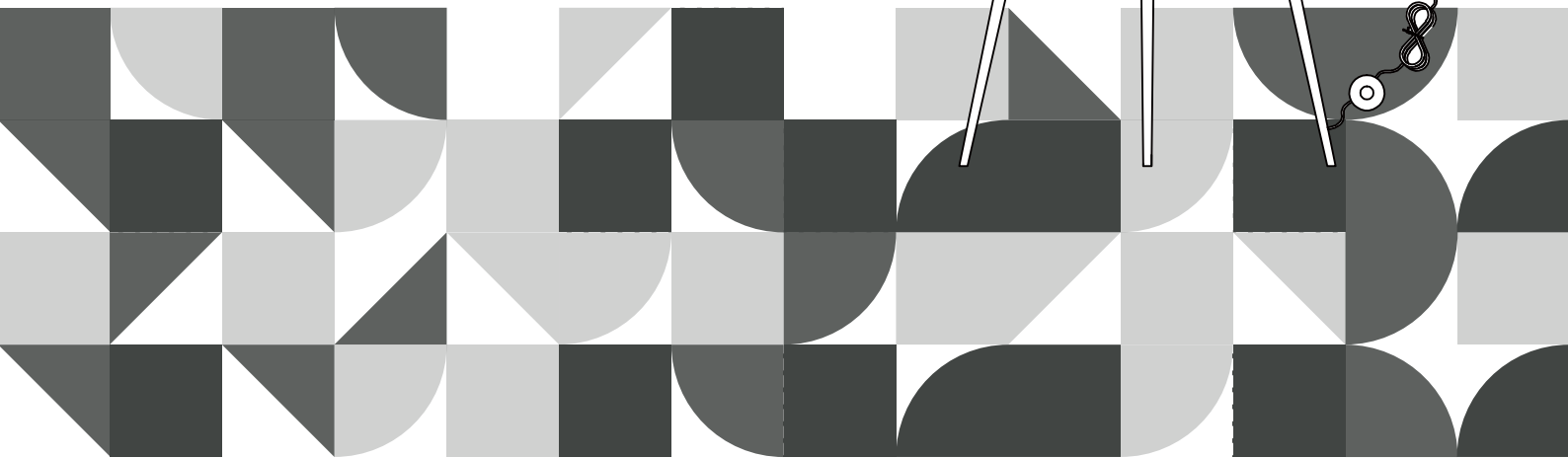

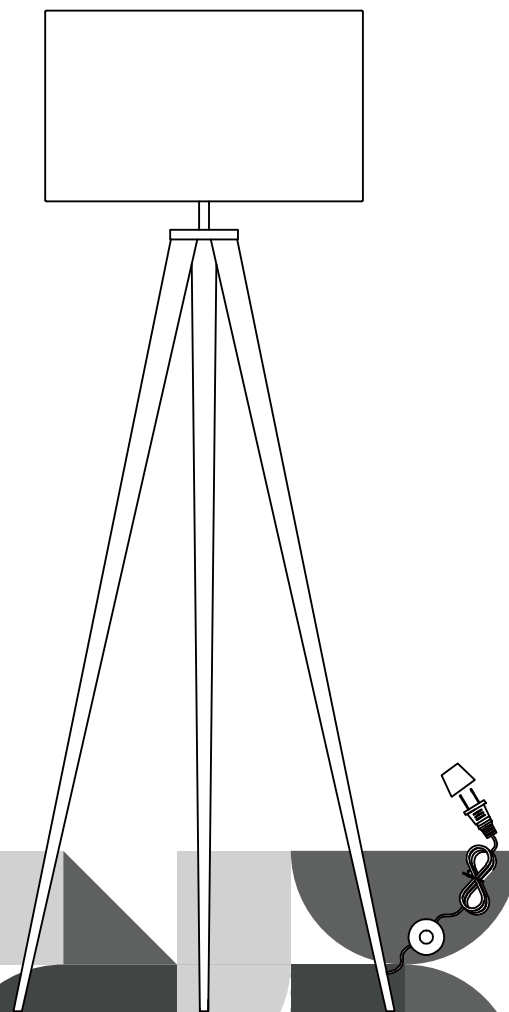
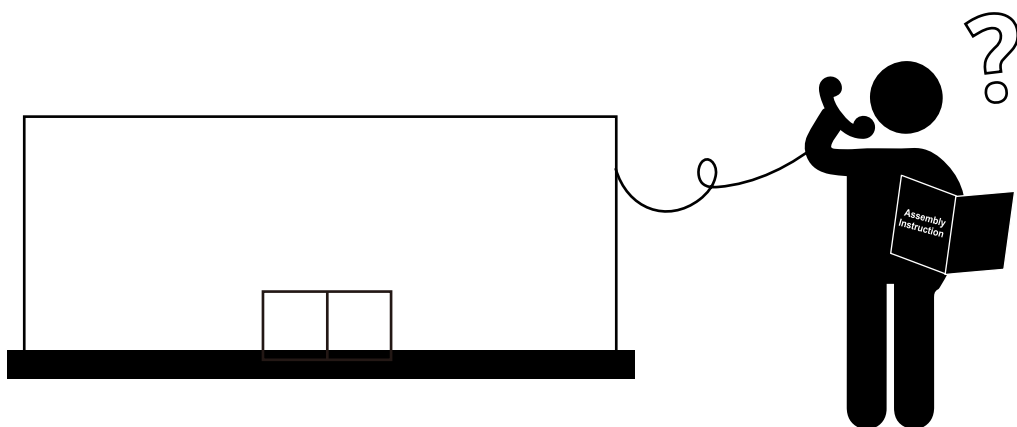
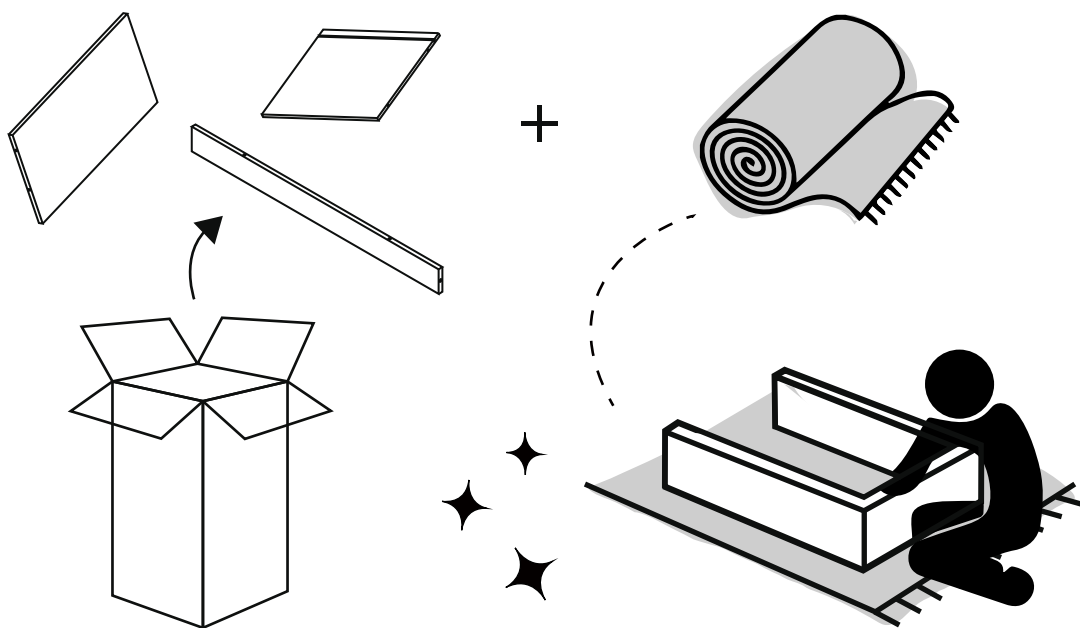
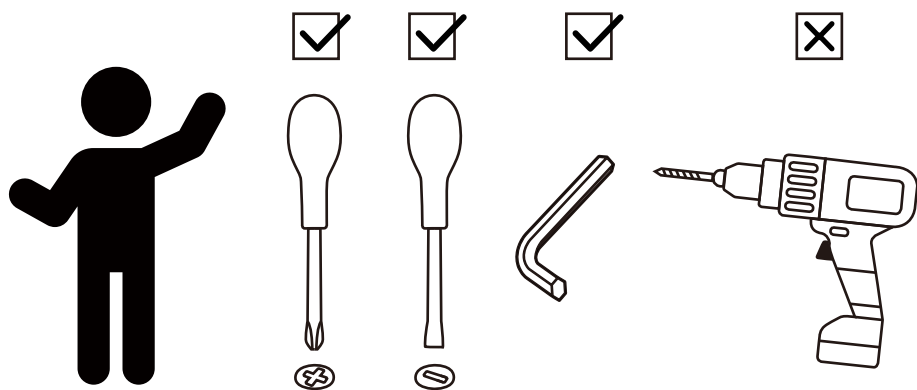

Exploded Drawing

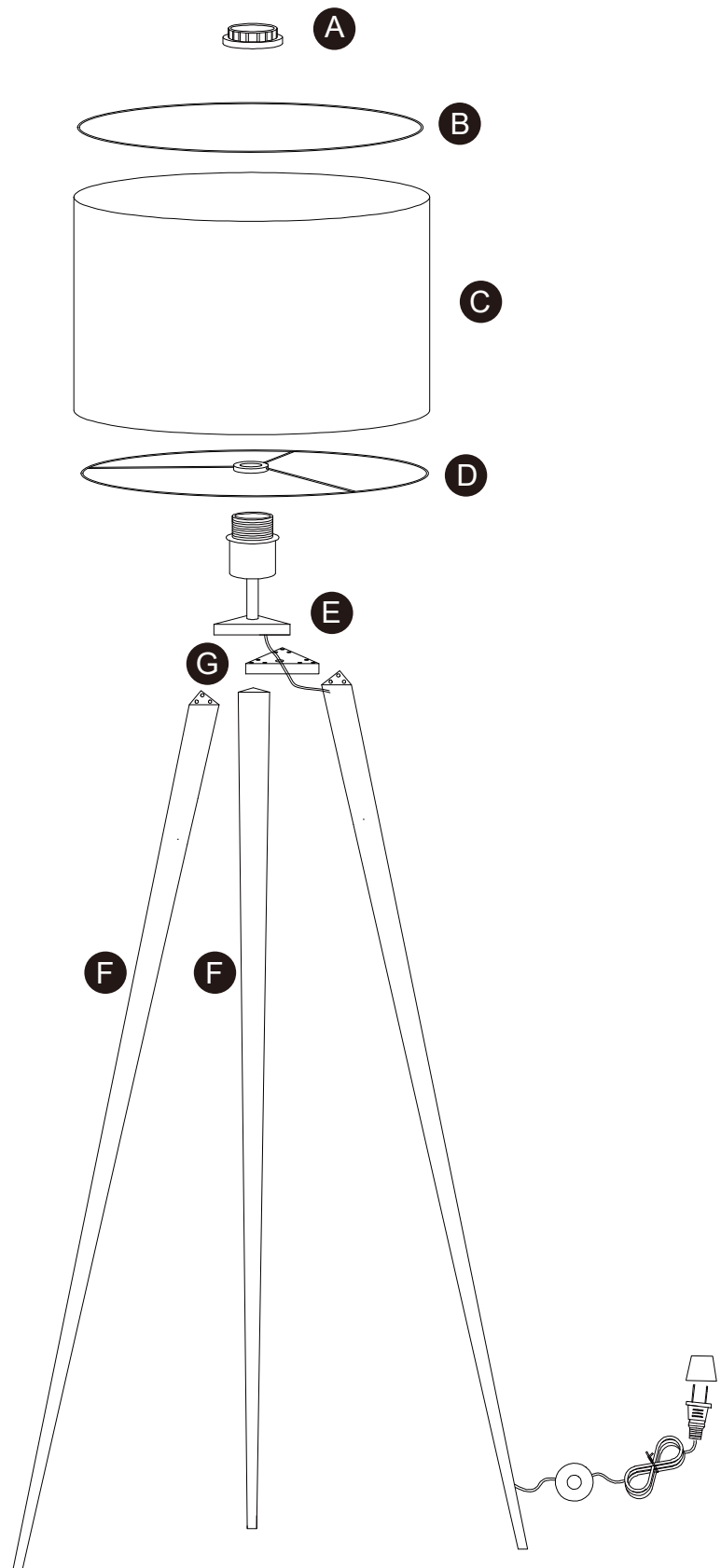

Product Parts

A



1 PC

B



1 PC

C

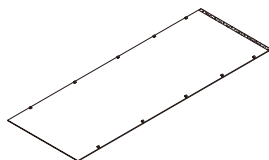

1 PC

D

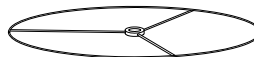

1 PC

E

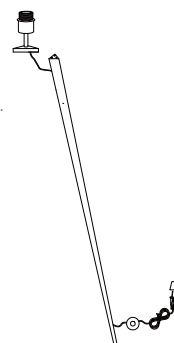

1 PC

F



2 PCS

G

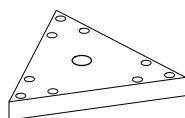

1 PC

Scan for assembly instructions.

! Care Instructions

Dust surface with a dry soft cloth. Do not use window cleaners or cleaning abrasives as they will scratch the surface and could damage the protective coating

! WARNING

Small parts and sharp edges may be present prior to assembly.

Step 1

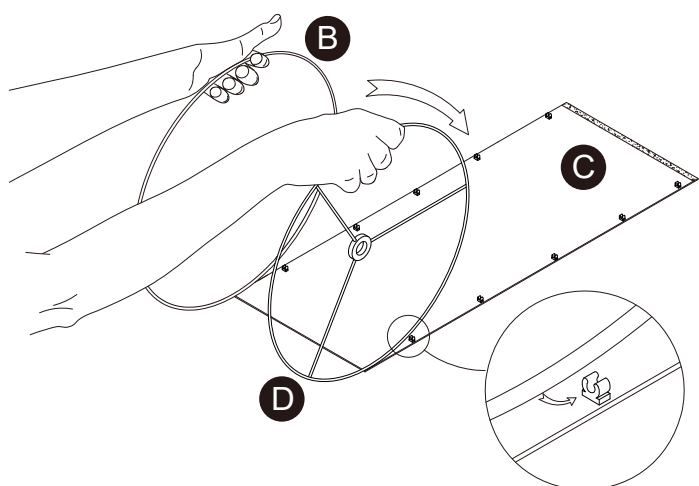

Step 2

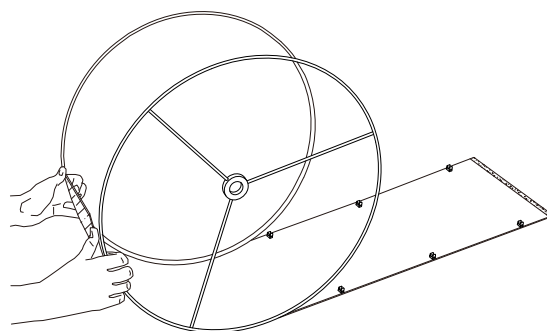

Step 3

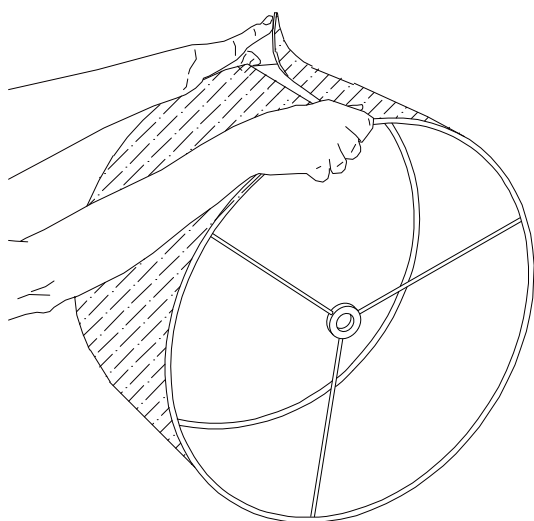

Step 4

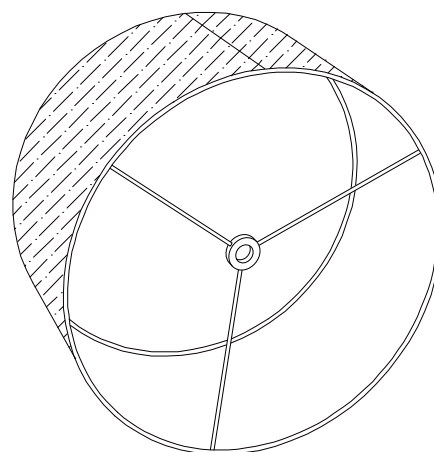

Scan for assembly instructions.

Step 8

Step 7

Step 6

A line drawing of a mechanical assembly. It features a vertical handle connected to a horizontal plate. Below this plate is a curved, flexible component. This component is connected to a larger, triangular base plate. The base plate has several small circular holes. To the right of the base plate, there are three screws or bolts. Dashed lines indicate that these screws are used to secure the base plate to a larger, trapezoidal structure below it. A handle with a loop is shown at the top, connected to the upper plate.

E

G

Step 5

F

F

E

Scan for assembly instructions.