

NewGen

Instructions for models D2VHMA & D4VHMA

Instructions pour les modèles D2VHMA & D4VHMA

Instrucciones para los modelos D2VHMA y D4VHMA

Dualit®

Since 1945

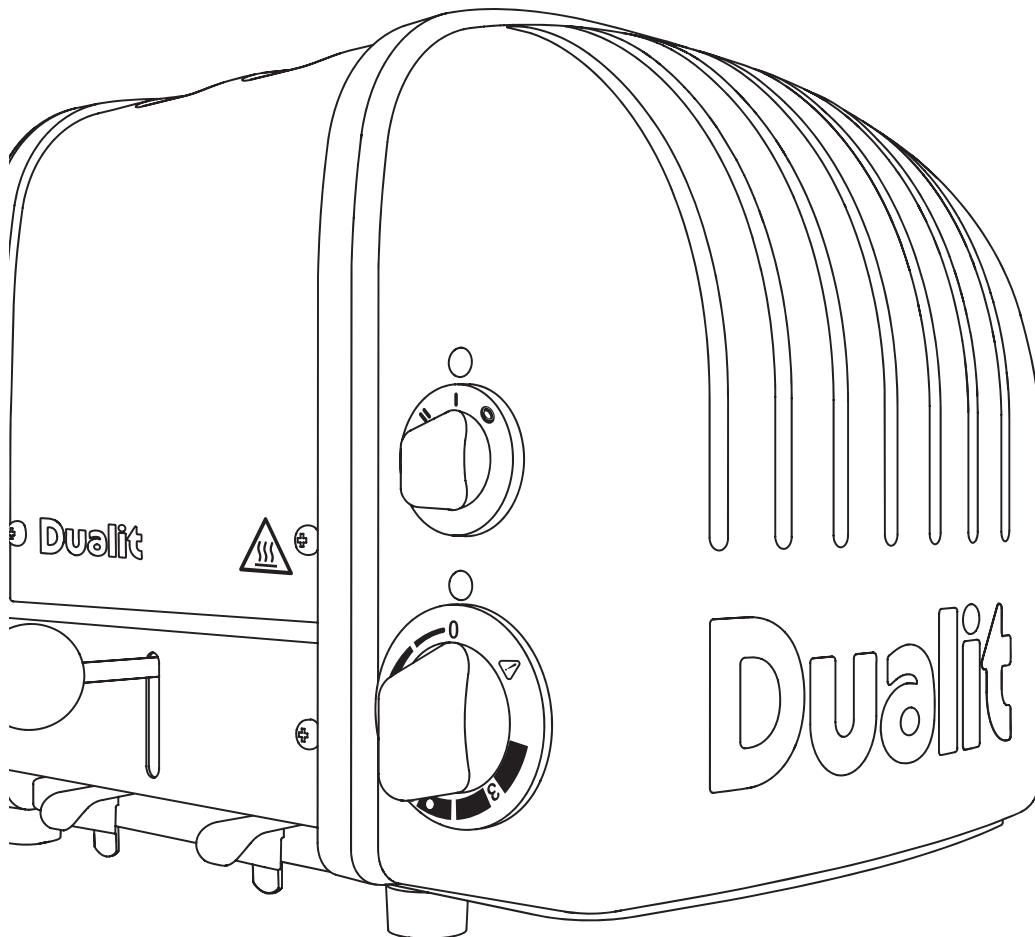

**SAVE THESE INSTRUCTIONS
CONSERVEZ CES INSTRUCTIONS
GUARDE ESTAS INSTRUCCIONES**

TOASTER SAFETY



Hot Surface Symbol:

Warning: Hot Surface



General Warning Symbol:

Warning: Instructions must be followed to avoid danger and risk of injury.

TOASTING SINCE 1945

For seven decades, Dualit toasters have reflected an attitude that's fundamentally British. They are a symbol of the fact that it's the simple things in life that are the most rewarding and the most important.

Dualit toasters can turn out hundreds of crisp, golden slices per hour. They are gleaming, sturdy and tough as old boots. And as much a part of British life as toast itself.

It should come as no surprise that the man who invented the Dualit toaster was an engineer. In 1946, Max Gort-Barten produced the original Dualit toaster from his workshop just off London's Old Kent Road.

Combining strength, versatility and ingenuity it was a toaster that set new standards, soon followed by a commercial toaster, incorporating a time switch among its many (entirely) original features.

Manually operated and designed for heavy-duty use, each Dualit toaster is a blend of the simple and highly sophisticated. Each toaster is assembled by hand, much as it always was.

The assembler's individual number will be found on the base plate.

In an age in which so much becomes obsolete overnight, the Dualit toaster is built without compromise. It remains one of the few objects to survive the passing of the years with grace and style.

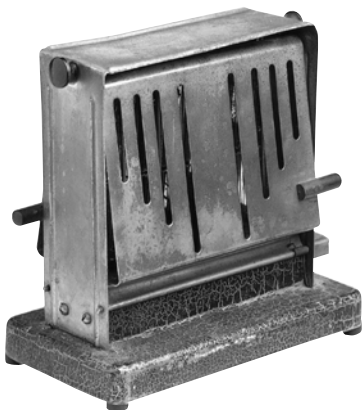

CONTENTS

Safety precautions	04
Setting up	06
Toasting tips	07
Know your Toaster	08
Accessories	10
The selector	11
Toasting	12
Toasting frozen bread	14
Making toasted sandwiches	15
Cleaning and care	16
Thermal protection device	17
Replacement parts	18
Troubleshooting	19
90 Day return policy	21

DON'T FORGET
TO REGISTER
YOUR PRODUCT

WWW.DUALIT.COM/REGISTER

OR BY POST



Register
my appliance

Design Number: 3000460, 4020987, 4020988
Patent Number: EP1138176, GB2374509, GB2384961, GB2350550, GB2373159, EP1086608, GB2374509,
PCT/GB99/03786, I31078.8, WO2006/061633, GB2453812, GB2522889
Trademark: 2231283, 3084797



IMPORTANT SAFETY PRECAUTIONS

READ ALL INSTRUCTIONS

KEEP THESE INSTRUCTIONS FOR FUTURE REFERENCE

- When using electrical appliances, basic safety precautions should always be followed, including the following:

IMPORTANT SAFEGUARDS

THIS IS AN ATTENDED APPLIANCE.

- **Do not leave unattended during use, isolate after each use (risk of fire if an unattended appliance is left operating or plugged in).**
- This appliance must not be used by children younger than 8 years old and persons with very extensive and complex disabilities.
- Children aged 8-14 years and persons with reduced physical, sensory or mental capabilities or lack of experience and knowledge shall not use this appliance, unless they are supervised and have been given instruction concerning the use of the appliance in a safe way and understand the hazards involved.
- Children shall not play with the appliance.
- Cleaning and user maintenance shall not be made by children unless they are older than 8 and supervised.
- Keep the appliance and its cord out of reach of children less than 8 years old.
- Close supervision is necessary when any appliance is used by or near children.
- Do not use outdoors. This appliance is intended for indoor household use only. If the appliance is used improperly or for professional or semi-professional purposes or if it is not used according to these instructions the Guarantee becomes invalid and Dualit refuses any liability for damage caused.

Electrical safety

-  Before plugging in, check that the voltage on the rating label is the same as the mains supply.
- We recommend that the toaster is plugged into a socket that has no other appliance connected to it.
- Isolate from outlet when not in use and before cleaning.

- Allow to cool before putting on or taking off parts, and before cleaning the appliances.
- **Should any of the lights remain illuminated after using the appliance, immediately isolate the toaster and call service centre.**
- **If the timer sticks, isolate and do not use. Contact a Dualit repair centre.**
- The toaster is not intended to be operated by means of an external timer or separate remote-control system.
- To protect against electric shock, do not immerse any part of this product in water or other liquid.
- NOTE: Any plug cut from power supply cord should be disposed of immediately. Inserting any cut off plug into a socket-outlet is hazardous.
- Do not operate any appliance with a damaged cord or plug or after the appliance malfunctions, or has been damaged in any manner. Return appliance to the nearest authorized service facility for examination, repair or adjustment.
- **WARNING:** This appliance must be earthed.



Attended appliance. Unplug after use - fire risk.

General safety

-  Do not touch hot surfaces. Use handles or knobs.
- Bread may burn. Therefore toasters must not be used near or below curtains and other combustible materials.
- **A fire may occur if toasters are covered or touching flammable material, including curtains, draperies, walls and the like, when in operation.**
- Do not operate near flammable materials (observe clearance details).
- Do not place on or near a hot gas or electric burner; or in a heated oven.
- Do not attempt to dislodge bread when the toaster is plugged in.
- Crumb tray must be in place during toasting.
- Crumb tray should be regularly cleaned. A build up of crumbs can burn or cause a fire.
- Do not allow cable to touch hot surfaces, or to hang over edge of a table or counter top.



• **Do not use appliance for any purpose other than the intended use.**

- Do not store or use toaster in an appliance garage or under cupboards.
- Do not put a pan on top of the toaster or warming rack.
- Do not toast bread in slots and use warming rack at the same time.
- Do not use if dropped, cracked or damaged.
- Do not use scouring pad or abrasive cleaner on the toaster body.
- The use of accessory attachments not recommended by Dualit may result in fire, electric shock or injury to persons.
- Always ensure that the timer switch is set to '0' or 'OFF' position, before inserting or removing the power supply plug from the wall outlet
- Oversize foods, metal foil packages, or utensils must not be inserted in a toaster as they may involve a risk of fire or electric shock.
- Do not put your fingers in the slots of the toaster;
- Once you have finished toasting, always return the timer switch to the '0' or 'OFF' position.
- Do not use foods with coatings or fillings that may drip when heated.
-  The toasting of toaster pastries is not permitted.

SAVE THESE INSTRUCTIONS

- A short power-supply cord is to be provided to reduce risks resulting from becoming entangled in or tripping over a longer cord. Extension cords are available and may be used if care is exercised in their use. If extension cord is used:
 1. The marked electrical rating of the cord set or extension cord should be at least as great as the electrical rating of the appliance; and
 2. The cord should be arranged so that it will not drape over the countertop or tabletop where it can be pulled on by children or tripped over unintentionally
 3. The appliance is fitted with a 3-wire grounded cord, so the extension cord and plugs must be of the 3-wire grounded type.

- Power cord set should be checked before first use.

INSTRUCTIONS ON ENVIRONMENT PROTECTION

Dispose of in accordance with local and regional codes.

IMPORTANT: BEFORE FIRST USE

- Read this instruction manual before you start using the toaster. It gives you important safety information and will ensure you get the most out of your Dualit toaster.
- Keep this manual and your proof of purchase in a safe place.
- Before you use your toaster for the first time, wash all parts according to the cleaning instructions.
- Position the toaster according to the safety precautions and setting up on page 6.
- Your Dualit toaster has patented ProHeat elements. These elements need to be conditioned before toasting for the very first time. Then continue to toast as per the instructions.
- Set the selector switch so all the slots are active, with no bread in the slots, turn the timer all the way round and let it run back to the off position.
- Some smoke may vent from the slots, this is not a fault and is perfectly safe. There may be a slight popping crinkling sound, this is due to heat expansion of the elements and is perfectly normal. Allow to cool to room temperature. Your toaster is now conditioned and ready for use.

In the interest of improving products, Dualit Ltd. reserves the right to change the product specification without prior notice.

SETTING UP

Read and follow these instructions before using your toaster.

THIS IS AN ATTENDED APPLIANCE. Do not leave unattended during use, unplug after each use (risk of fire if an unattended appliance is left operating).

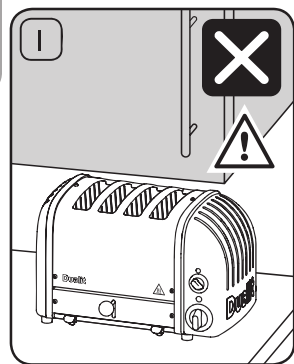

DO NOT STORE OR USE YOUR TOASTER IN AN APPLIANCE GARAGE OR UNDER CUPBOARDS. A fire may occur if incorrectly positioned.

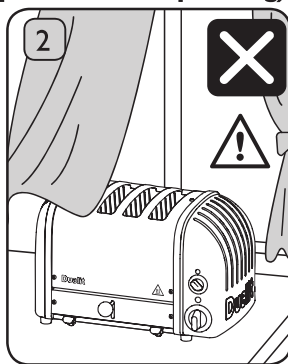

DO NOT STORE OR USE YOUR TOASTER CLOSE TO CURTAINS OR FLAMMABLE MATERIAL. A fire may occur if incorrectly positioned.

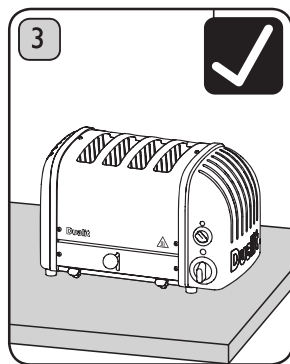

Place the toaster on a open level surface.

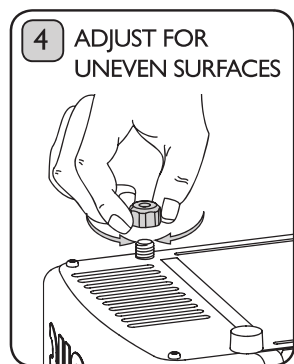

The adjustable foot located on the base of the toaster may be raised or lowered to compensate for uneven surfaces. Rotate it to adjust the height.

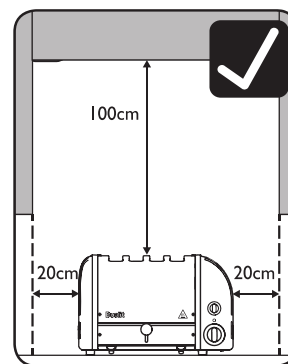

Ensure the Toaster is positioned at least 20cm CLEAR FROM ANY OVERHANGING CUPBOARDS.

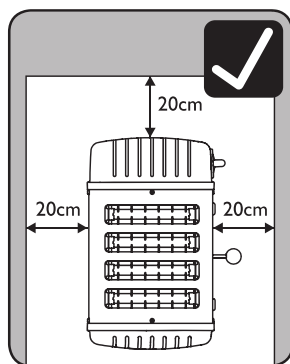

Ensure the toaster is positioned at least 20cm clear from walls.

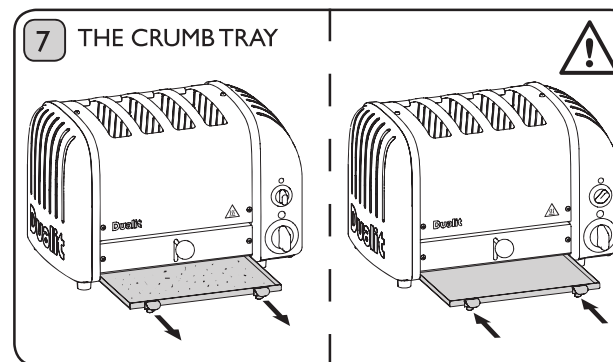

Crumbs will accumulate in the crumb tray and could catch fire if the tray is not emptied frequently. Pull out the crumb tray and wipe clean using a damp cloth. **CRUMB TRAY MUST BE IN PLACE BEFORE TURNING ON THE TOASTER AND DURING TOASTING.**

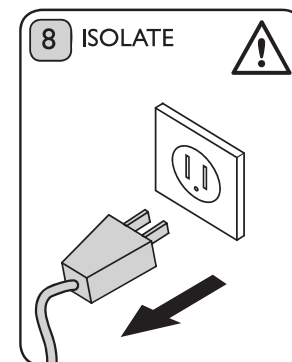

ISOLATE WHEN NOT IN USE.

TOASTING TIPS

Here are a few tips to help get the best out of your toaster.

- Your toaster is fitted with a mechanical timer; please note this is not a conventional browning setting. Our patented Peek & Pop® feature allows you to check the progress of your toast at any time by pushing down on the ejector knob.
- FULLY LOAD ALL HEATED UP SLOTS.** If a slot is heated but no bread is inserted, the bread in the adjacent slot will toast unevenly.
- ALWAYS LOAD YOUR SLOTS STARTING FROM THE LEFT.**
- DIFFERENT BREADS WILL TOAST AT DIFFERENT RATES,** wholemeal bread takes longer than white bread, fresh bread will take longer than day old bread, sweet bread will toast quicker than white bread. Remember to adjust your timer to allow for your particular type of bread.
- After the first round of toast, the elements and toaster body will be at full operating temperature, subsequent rounds will take less time to toast.
- The thickest slice of bread that will fit in your toaster is 28mm thick. Forcing bread which is too thick or too long into the slots will be difficult to eject once toasted.
- You may find it easier to use a 'sandwich cage' to toast smaller items. Inserting, checking and removing will all be easier (sold separately).
- When hand cutting a fresh loaf, cut the slices as evenly as possible. Uneven slices will toast unevenly.
- Keep elements free from breadcrumbs and broken pieces of bread. If left these may burn out the elements. With the toaster isolated use a soft brush to clean inside your toaster; do not use a knife!
- To reheat recently made toast set timer to 'defrost' symbol.
- Cancel toasting manually at any time by rotating the timer back to 'O'. This will not damage your timer.
- Always isolate your toaster from the wall socket after use.

KNOW YOUR TOASTER

Unpack the box with care, keeping all the packaging materials until you are satisfied everything is present and in working order. Once satisfied remove any tags from the appliance body and recycle the packaging appropriately. Do not remove tags from the cord. You may wish to keep the box to store your appliance

All illustrations are for representation only, your model may vary from illustrations shown.

PROHEAT ELEMENTS

Patented heavy duty replaceable elements.

STAINLESS STEEL COVER

MANUAL EJECTOR

Mechanical Peek & Pop ejector for greater toasting control.

CRUMB TRAY

Keeps your work surfaces clear of crumbs.

WIDE SLOTS

Wide slots to fit thick bread, buns and bagels.

ALUMINIUM CASTINGS

Heavy duty cast aluminium castings.

SELECTOR SWITCH

Select number of slices or buns you are toasting.

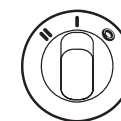

2 SLOT MODEL



4 SLOT MODEL

TOASTING WARNING LIGHT

Elements heating when on

MECHANICAL TIMER WITH DEFROST

Timer controlled defrost and toasting.

FEET

Compensate for uneven surfaces.

ACCESSORIES - SOLD SEPARATELY

THE SANDWICH CAGE

Convert your toaster into a toasted sandwich maker with this quick and easy to use accessory.

Using a cage also offers greater toasting control, for toasting smaller items such as crumpets, scones, teacakes or muffins.



THE WARMING RACK

The 'warming rack' is a universal accessory for all Dualit Classic Toasters.

Perfect for warming or lightly toasting any bread product that will not fit inside the slots. Such as croissants, scones, pastries or tortillas.



Use for a maximum of 3 minutes and then allow to cool between each use.



Do not toast bread in slots and use warming rack at the same time.



DO NOT PUT A PAN ON TOP OF THE WARMING RACK.

NOTE: Be mindful that repeated use of the Warming Rack without allowing the toaster to fully cool between cycles may cause the Thermal Protection Device to activate (see page 17)

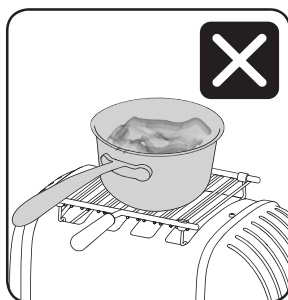

THE SELECTOR

ONLY HEAT UP SLOTS YOU ARE GOING TO USE.

This avoids uneven toasting and saves energy at the same time.

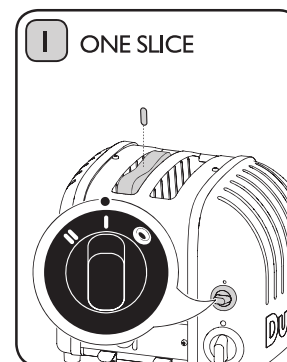

2 & 4 slot model: Select the one slice indicator on the 'selector switch'. The left hand slot will heat up on both sides.

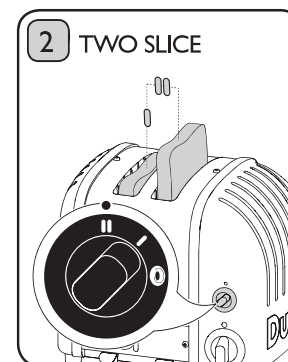

2 & 4 slot model: Select the two slice indicator. The two slots from the left will toast on both sides.

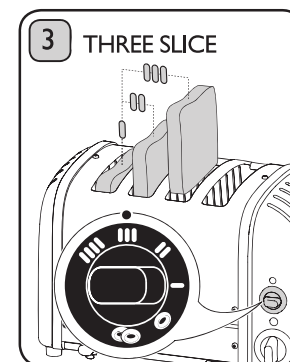

4 slot model: Select the three slice indicator. The three slots from the left will toast on both sides.

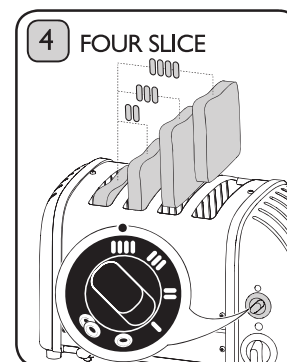

4 slot model: Select the four slice indicator. All slots will heat up.

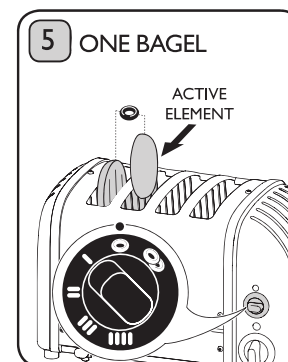

2 & 4 slot model: Select the one bagel symbol. Only the second element from the left will heat up.

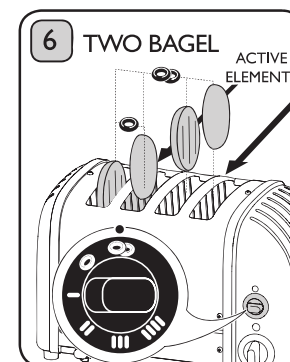

4 slot model: Select the two bagel symbol. Only the second and fourth element from the left will heat up.

TOASTING BREAD

THIS IS AN ATTENDED APPLIANCE. Do not leave unattended during use, isolate after each use (risk of fire if an unattended appliance is left operating).

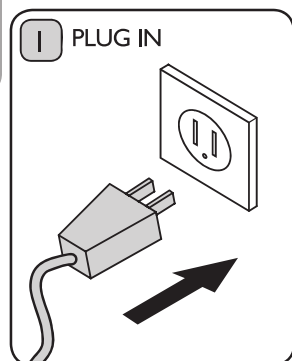

Plug the toaster into the wall power socket and turn power on at socket.

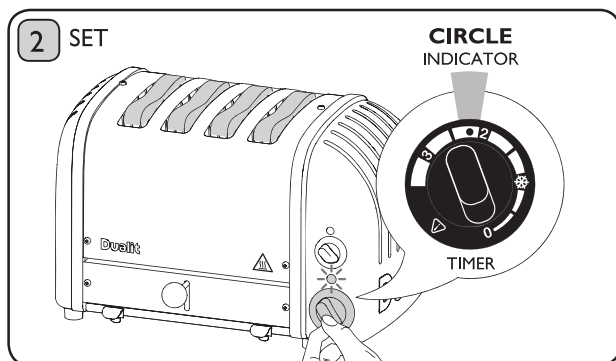

Note: The required toasting time is affected by the freshness, thickness and type of bread. Reduce the toasting time if the toaster is warm from a previous toasting operation.

See chart below for a guide to toasting different bread types.

For a quick start, turn the timer to the Circle Indicator (just past the number 2 setting). This is the optimised toasting setting for medium sliced, white bread using a cold toaster.

For repeated toasting or when the toaster is warm, reduce the toasting time for best results.



FRESHNESS (age) of bread	5+ days old	2 days old	0 days old (freshly baked)	
MOISTURE CONTENT of bread	Dry	Average	Moist	
COLOUR of bread	—	White	Brown	Rye
INGREDIENTS in bread	Sweet	Savoury	Lots of seeds & savoury	

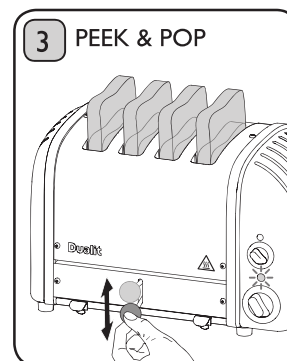

Check the progress of your toast at any time by pushing down on the 'ejector knob'.

If you remove your toast before the cycle is complete, cancel timer and isolate.



The 'timer' will click off to 'O' position. To cancel toasting manually rotate the 'timer' to 'O'.

! If Toasting Warning Light remains illuminated after use immediately isolate the toaster & call service centre.

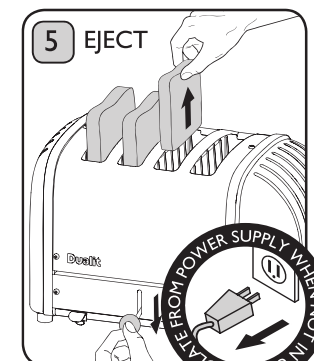

The toast will not pop up, but will keep warm inside the toaster. Press down the 'ejector knob' and the toast will pop up ready for serving.

TOASTING FROZEN BREAD

Toast bread directly from the freezer with this handy setting.

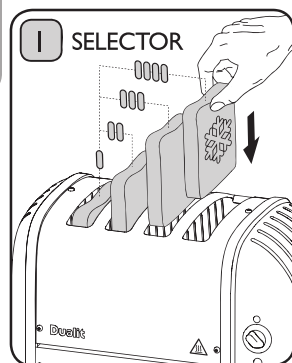

Set the 'selector switch' to the desired number slots you require and insert your frozen slices of bread.

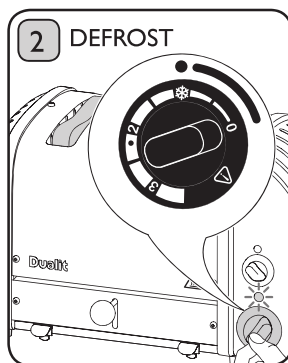

Rotate the 'timer' to the defrost symbol and let the timer wind down to '0'.

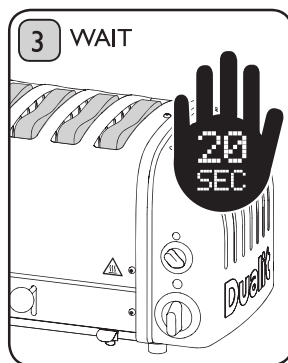

When the timer stops wait 20 seconds.

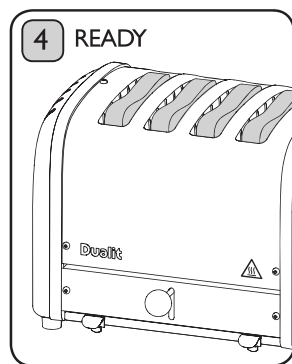

Your bread will now be defrosted and ready for toasting.

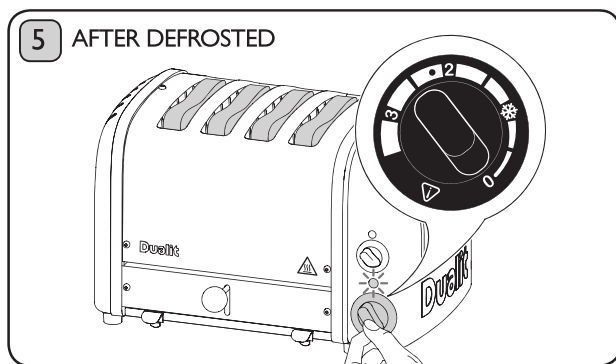

Set the timer to your preferred setting and continue to toast as if toasting fresh bread.

MAKING TOASTED SANDWICHES

The sandwich cage accessory (sold separately) will transform your toaster into a versatile sandwich toaster.

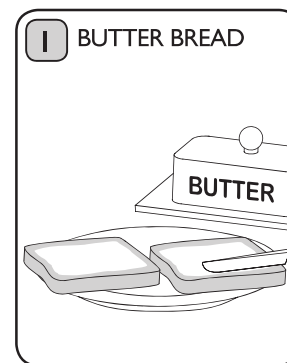

Use medium sliced bread, lightly butter the **OUTSIDE OF EACH SLICE.**

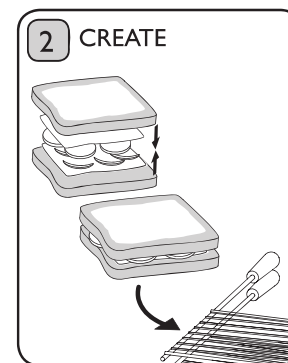

Place your fillings between the **unbuttered** sides. **DO NOT OVERFILL THE SANDWICH.** Place sandwich in cage.

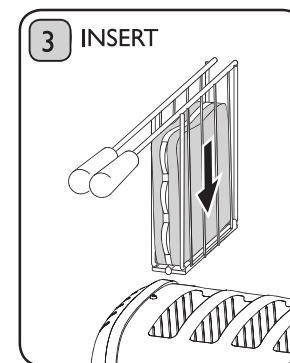

Set 'selector' and starting from the left insert cage into the slots. Push down until clamped tightly shut.

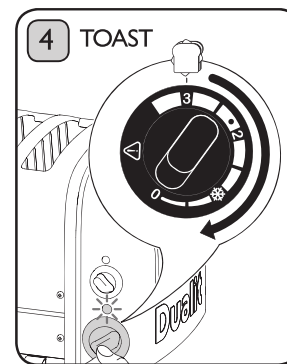

Toast until the sandwich is golden. Setting 3 on the 'timer'. Adjust for your bread type.

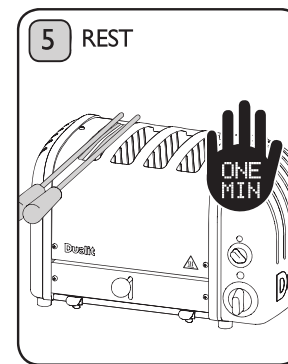

Allow to rest for a further minute inside the toaster to allow fillings to fully warm.

! If Toaster Warning Light remains illuminated after use immediately isolate the toaster & call the service centre.

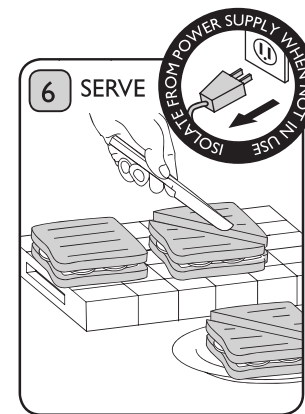

Remove, cut and serve.

! CAUTION: FILLINGS CAN BE HOT.

CLEANING & CARE



IMPORTANT: ensure the toaster is isolated and allowed to fully cool before starting to clean.

Any other servicing should be performed by authorized service representative.

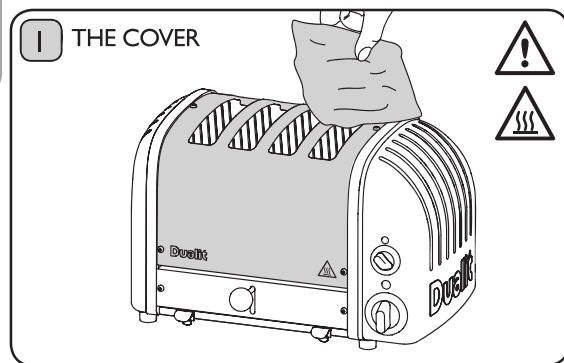

AFTER EACH USE

Wipe the 'stainless steel cover' with a non-abrasive cloth. A stainless steel cleaner can be used to restore shine to the cover only, but do not use an aggressive cleaner or one that contains ammonia.

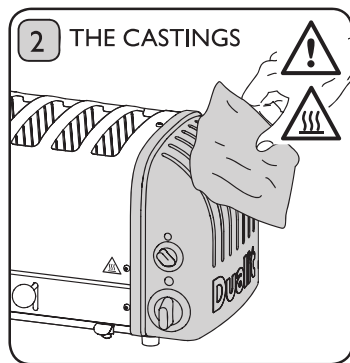

Wipe the aluminium end castings with a damp cloth. Do not use a chemical or abrasive cleaner.

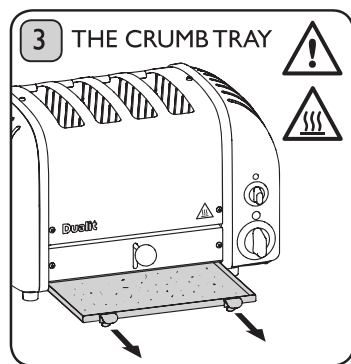

Crumbs will accumulate in the crumb tray and could catch fire if the tray is not emptied frequently. Pull out the crumb tray and wipe clean using a damp cloth. **CRUMB TRAY MUST BE IN PLACE DURING TOASTING.**

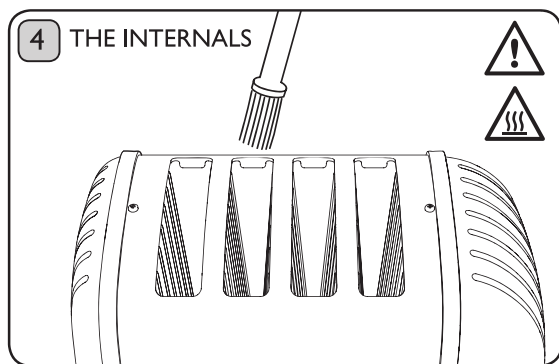

With the toaster isolated from the power supply use a **SOFT BRUSH** to clean inside your toaster; do not use a sharp or metal utensil! Crumbs should be carefully brushed off the elements using only a soft brush, the toaster can be turned upside down and excess crumbs be shaken out.

THERMAL PROTECTION DEVICE

TO PREVENT ACTIVATING THE THERMAL PROTECTION DEVICE:

- Ensure your toaster is situated in an area with at least 20cm of space to the left, right and back of the toaster.
- Use the toaster clear of overhanging cupboards and away from any flammable materials.

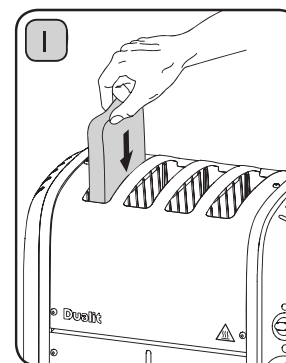

Always load bread into the toaster starting from the left hand slot.

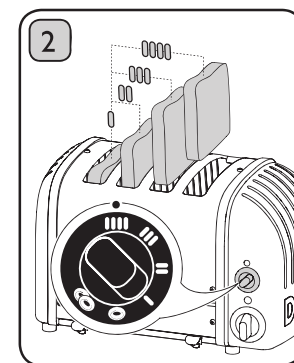

Always use the appropriate setting for the number of slices of bread to be toasted.

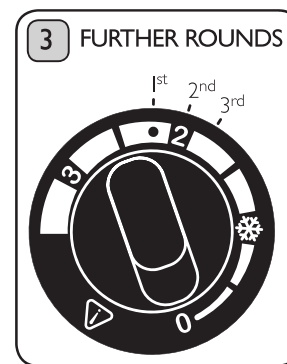

Be mindful of reducing the toasting time if the toaster is already warm from previous use, as the bread toasts faster on 2nd and 3rd cycles.



Be mindful that repeated use of the Warming Rack without allowing the toaster to fully cool between cycles may cause the device to activate.

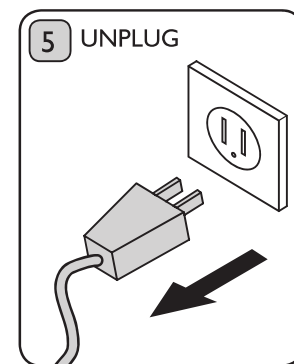

Always isolate the toaster after use.

REPLACEMENT PARTS

Repair departments regularly receive toasters over 40 years old. They are fixed and go back to the owner in full working order. If your toaster needs a repair, contact your nearest service centre.

ALL SERVICING MUST BE CARRIED OUT BY AN AUTHORISED DUALIT REPAIR CENTRE OR DUALIT SERVICE ENGINEER.

For your own protection only use original Dualit spares in your toaster.

- Fitting of non Dualit parts will invalidate the guarantee.

THERMAL PROTECTION DEVICE

- If the Toasting Warning Light illuminates, but the elements fail to warm up or if there is an audible 'click' above the normal ticking of the timer from the toaster while it is still operating, you may have activated the **Thermal Protection Device**.
- To reset the Thermal Fuse contact the service centre.

ELEMENT SPARES

- Your toaster is fitted with replaceable ProHeat elements, contact the service centre for an estimate.
- The safety and the performance of the toaster cannot be guaranteed if inferior elements are used. Genuine Dualit elements are stamped with "DUALIT".

TIMER SPARES

- When replacing the timer, only use a genuine Dualit timer.
- The safety and the performance of the toaster cannot be guaranteed if an inferior timer is used.

TROUBLESHOOTING

Your toaster is designed to last and be repaired in the event of a fault. Read the guide below;

MY TOASTER IS NOT WORKING:

- Check the toaster is plugged in.
- Check if the 'Toasting Warning Light' is glowing red when the timer is activated. If yes, your elements, 'selector' switch or your thermal fuse may need replacing. If no, your timer may need replacing. Isolate and do not use. Contact a Dualit repair centre.

I GET UNEVEN TOASTING:

- Check the selector switch is set for the number of slots being used.
- Starting from the left, ensure you have loaded all heated up slots.
- The heavy duty Proheat elements can take a few moments to reach optimum toasting temperature. Preheating the slots prior to inserting your bread will eliminate this. Rotate the 'timer' all the way round, let it wind down to the circle indicator then insert your bread into the active slots.
- Ensure size and type of bread being toasted is the same.
- End elements take a little longer to warm up than centre elements, once toaster is at optimum operating temperature this will no longer occur.
-  If the timer is noticeably slow, **isolate and do not use the toaster, risk of fire.** Spare timers are available from www.dualit.com and must be fitted by an authorised Dualit repair centre or Dualit service engineer.

MY TOASTER WOBBLER ON MY WORK SURFACE:

- Use the adjustable foot under the toaster to compensate for uneven surfaces.

MY TOAST GETS STUCK WHEN I EJECT FROM THE TOASTER:

-  Isolate and allow to cool before attempting remove the toast. Note: slices thicker than 28mm will get stuck. Hand cut slices must be cut evenly.
- Using a 'sandwich cage' can make toasting thicker items easier.

ONE SIDE OF MY BREAD IS NOT TOASTING:

- Check the 'selector' switch is set correctly. If set to Bagel setting only one side will toast and remember to insert bread from the very left hand slot.
- One or more of the elements may need replacing, call the helpline or visit www.dualit.com for replacements.

TROUBLESHOOTING

SMOKE COMING OUT OF THE SLOTS

- If this is the first time using your toaster, this is normal, your elements are being conditioned.
-  Empty the crumb tray. A build up of crumbs can burn or cause a fire.
- Some crumbs or pieces of bread may be stuck in the toaster. Isolate, remove the crumb tray then turn the toaster down over a sink or bin and gently shake the crumbs out or use a soft brush to clean inside your toaster.

MY TIMER IS NOTICEABLY SLOW OR STICKING

-  Isolate and do not use the toaster. Replace the timer immediately. Spare timers are available from www.dualit.com and must be fitted by a qualified electrical engineer.

THE TOASTING WARNING LIGHT IS ILLUMINATED BUT MY TOASTER IS NOT TOASTING

- The thermal fuse has been activated. Contact the service centre.

DON'T FORGET TO REGISTER YOUR PRODUCT	WWW.DUALIT.COM/REGISTER	Register  my appliance
	OR BY POST 	



Dualit Limited County Oak Way Crawley West Sussex RH11 7ST
Telephone: +44 (0) 1293 652 500 Facsimile: +44 (0) 1293 652 555
Email: info@dualit.com Web: www.dualit.com



US-NEWGEN-G