

Twin towers garden

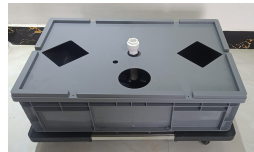

Includs components



water tank



tower body



basket



sponge



water pump



timer

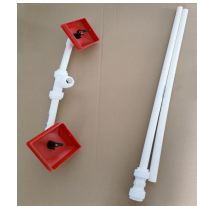

Water supply pipe
+top cover



screw

NO.1 : Put the water tank on the wheel support.

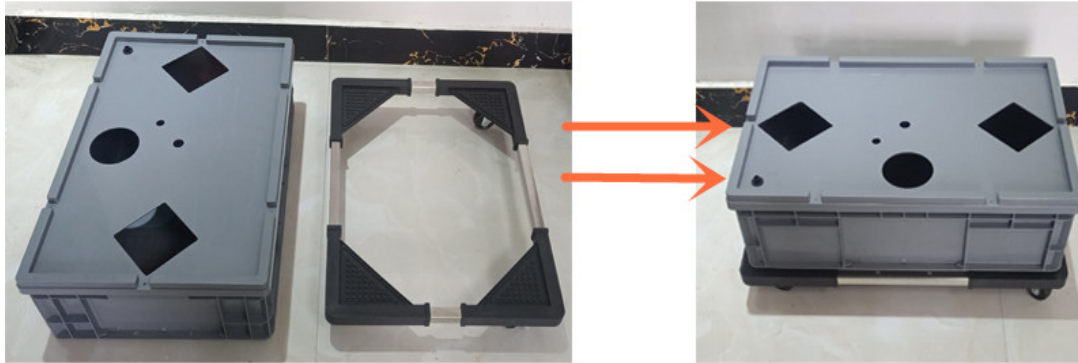

NO.2 : Installation of water pump , The black gasket of the connector is exposed above and extends into the central hole of the water tank cover. And the connecting rod of the water pump is connected and tightened.



NO.3 Tower connection



Note: There are holes on the top surface of the tower.

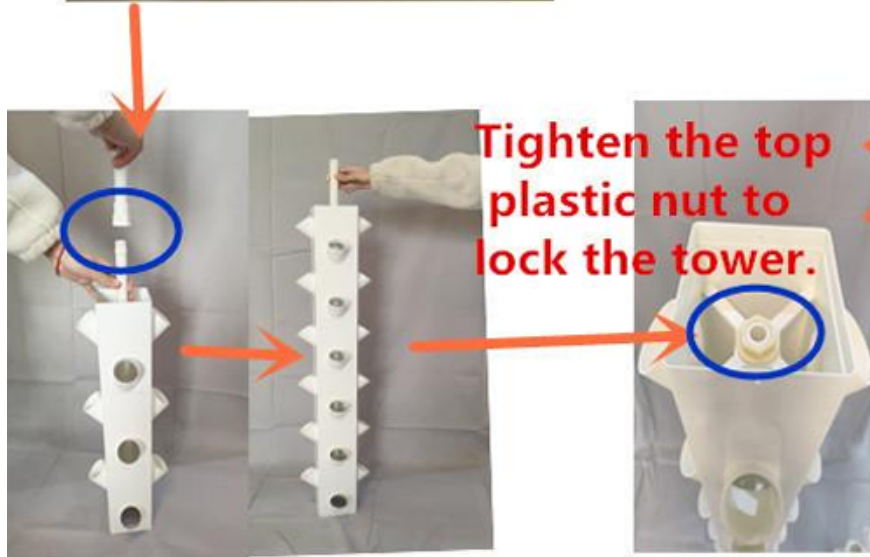
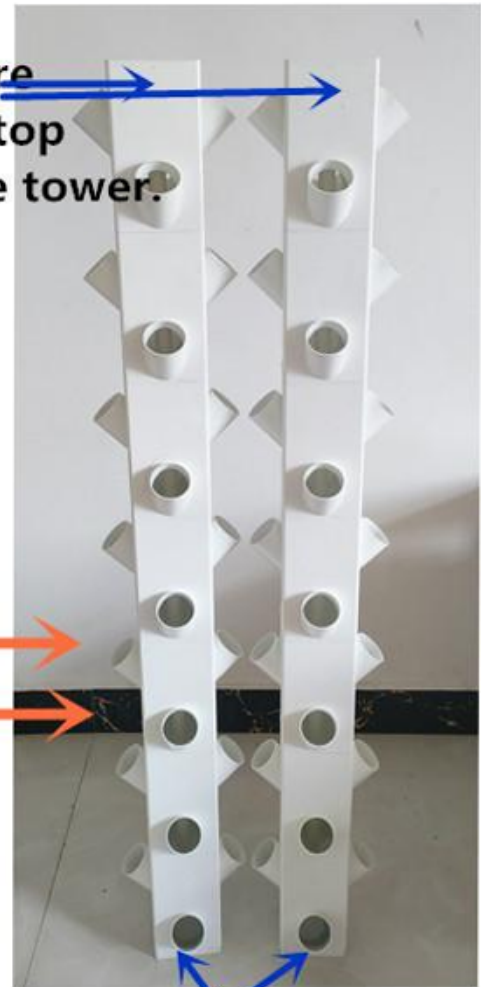

Tighten the top plastic nut to lock the tower.

Note: The bottom surface of the lowest layer has holes.

NO. 4 Connection between tower body and water supply pipe

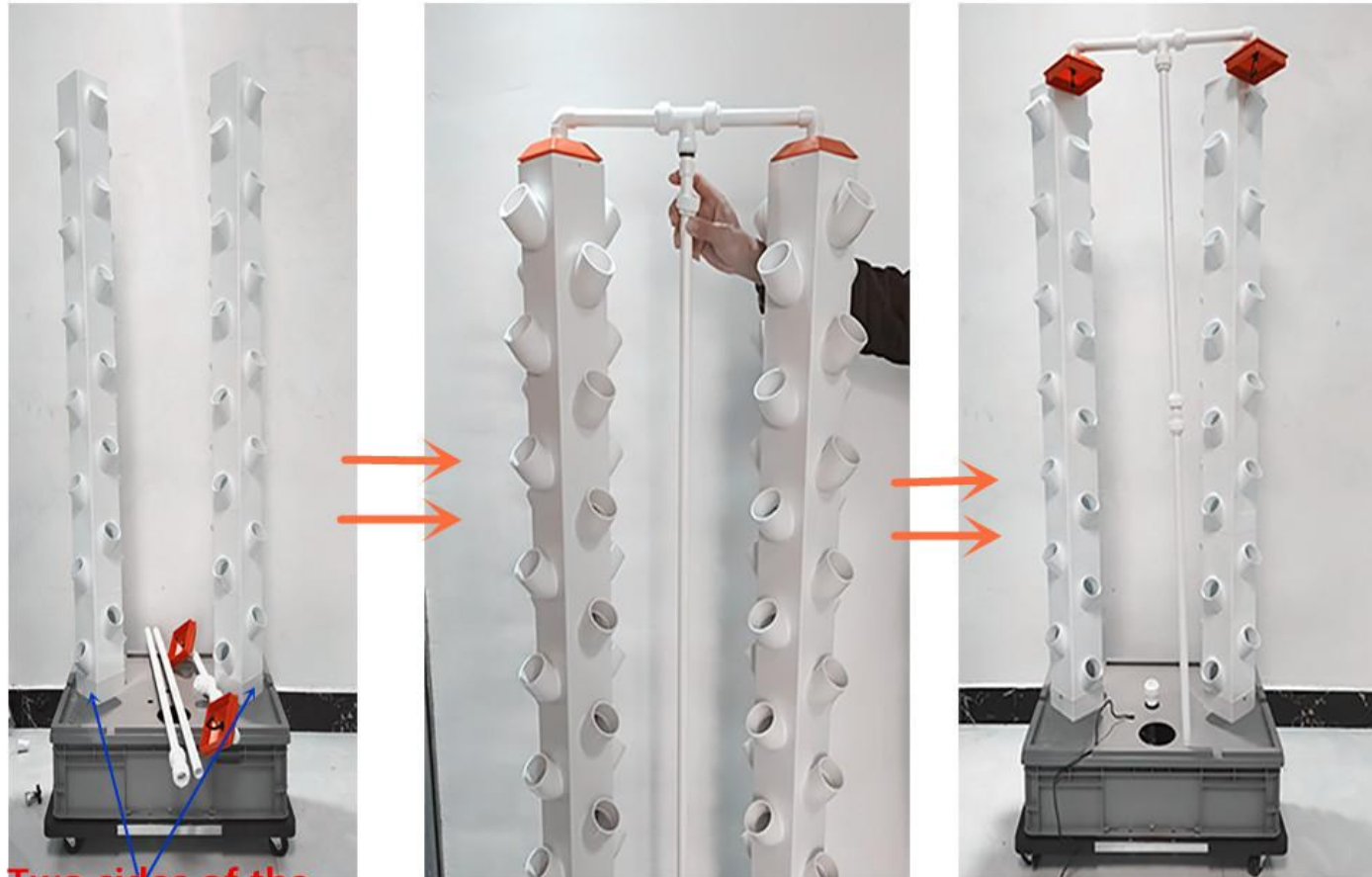

Two sides of the
bottom of the planting
tower respectively
Screw in the screws.

NO.5 Connection between water supply pipe and pump

