

Dining Chair

ASSEMBLY
INSTRUCTION



Dear customer, Thank you very much for buying our items. Please read the assembly instruction carefully before assembly.

Notices:

- Verify that all parts are present and in good condition before assembly.
- Put the chair on a clean flat surface.
- Please tighten the screws to about 80% for the first step; Then, sit with caution on the chair to adjust the balance; Finally, tighten all the screws to 100%.
- If you find that is unlevel after assembly, you can use adjustable pegs to keep four legs level.

Contact us

If there are installation problems, damage, missing parts, or any questions and concerns, please contact the shop where you bought it so we can make things right.

If the product is damaged, please send the following information:

- Photos that show the reason for your claim/damage.
- Photos of the packaging (inside and outside).

Thank you very much for your support!

Package Contents

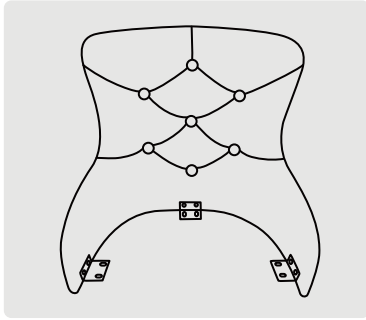

Back

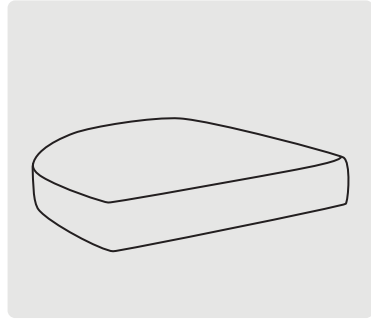

Seat



Legs

A × 1

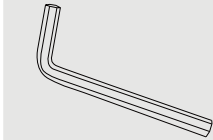

Allen key

B × 12



M6x20mm
Screws

C × 6



M6x25mm
Screws

Step by Step Guide

1

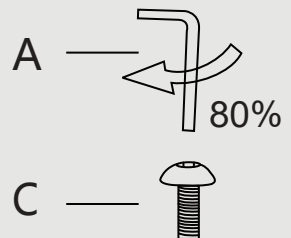
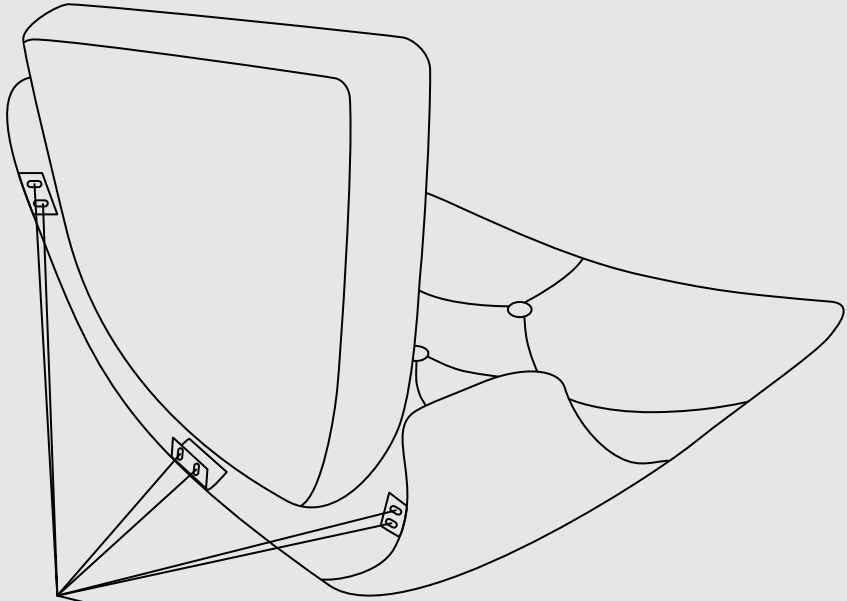

Use screws (C) to assemble the seat and backrest together
Tighten the screws up to 60%-80%.

Step by Step Guide

2

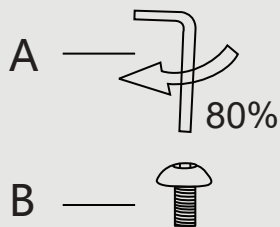
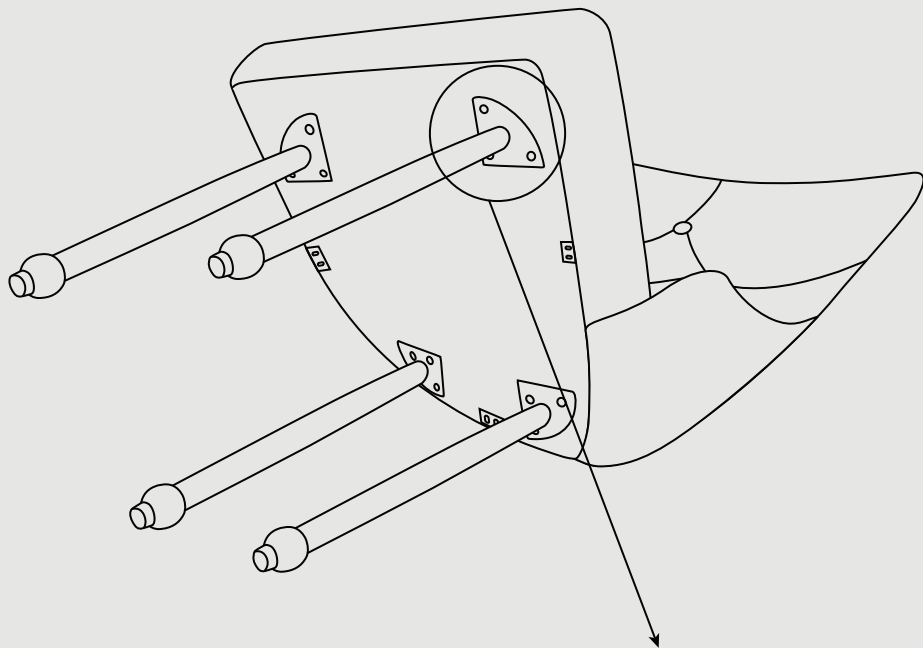

Align the four legs into the seat by using screws (B)
Tighten all screws together at the same time.
Just tighten them up to 60-80%.

Step by Step Guide

3

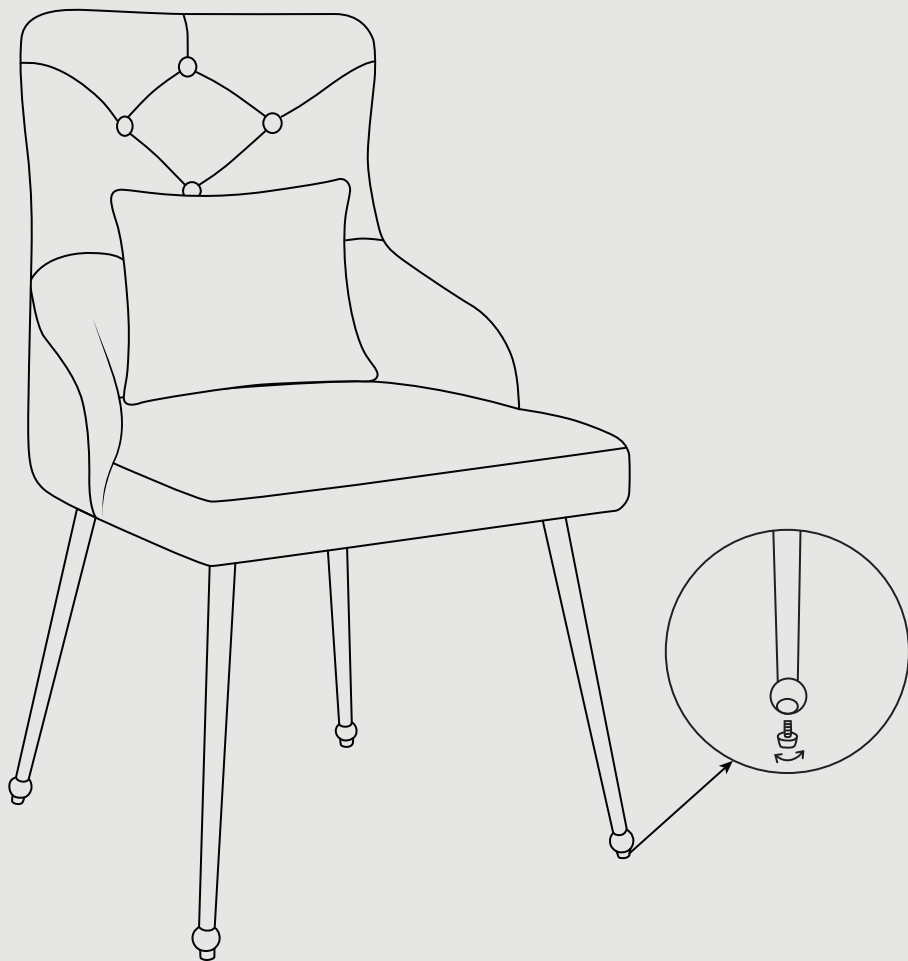

If you find that four legs are unlevel after assembly, adjustable foot nails can help adjust the level.

Once all legs are leveled, tighten all screws up to 100%.