

The limited warranty set forth below is given by Precision Products, Incorporated with respect to new merchandise purchased and used in the United States, its possessions and territories.

Precision Products, Incorporated warrants the product (s) listed against defects in material and workmanship, and will at our option, repair or replace, free of charge, any part found to be defective in materials or workmanship. This limited warranty shall only apply if this product has been assembled, operated, and maintained in accordance with the owner’s manual furnished with the product, and has not been subject to misuse, abuse, neglect, accident, improper maintenance, alteration, vandalism, theft, fire, water, or damage because of other peril or natural disaster.

Normal wear parts or components thereof are subject to separate terms as follows: All normal wear parts or component failures will be covered on the product for a period of one year. Parts found to be defective within the warranty period will be replaced at our expense. Our obligation under this warranty is expressly limited to the replacement or repair, at our option, of parts found to be defective in material and workmanship.

**Contacting Service**

Warranty parts replacements are available, only with **Proof of Purchase**, through our Customer Service Department. Call **1 (800) 225-5891**

This limited warranty does not provide coverage in the following cases:

1. Routine maintenance items such as lubricants and filters.
2. Normal deterioration of the exterior finish due to use or exposure.
3. Transportation and/or labor charges.

No implied warranty, including any implied warranty of merchantability of fitness for a particular purpose, applies after the applicable period of expressed written warranty above as to the part as identified below. No other expressed warranty whether written or oral, except as mentioned above, given by any person or entity, including a dealer or retailer, with respect to any product, shall bind Precision Products, Inc. During the period of the warranty, the exclusive remedy is repair or replacement of the product as set forth above.

The provisions as set forth in this warranty provide the sole and exclusive remedy arising from the sale.

Precision Products, Inc. will not be liable for incidental or consequential loss or damage including, without limitation, expenses incurred for substitute or replacement lawn care services or for rental expenses to temporarily replace a warranted product.

Some states do not allow the exclusion or limitation of incidental or consequential damages, or limitations on how long an implied warranty lasts, so the above exclusions or limitations may not apply to you.

During the warranty period, the exclusive remedy is replacement of the part. In no event shall recovery of any kind be greater that the amount of the purchase price of the product sold. Alteration of safety features of the product shall void this warranty. You assume the risk and liability for loss, damage, or injury to you and your property and/or to others and their property arising out of the misuse or inability to use this product.

This limited warranty shall not extend to anyone other than the original purchaser or to the person for whom it was purchased as a gift.

**Local Law to this Warranty**

This limited warranty gives you specific legal rights, and you may also have other rights which vary from state to state.

**Warranty Period**

The Warranty period stated below begins with the **Proof of Purchase**. Without the proof of purchase, the Warranty period begins from the date of manufacture.

**Hose Reel Cart Warranty Period**

The warranty period for this unit is as follows: All part are covered for one year from date of sale.



Tread pattern on tires may vary.

Manual Contents

Safety Instructions .....	2
Parts .....	3
Assembly.....	4-6
Operation .....	6
Maintenance .....	6
Warranty .....	8

Your New Hose Reel Cart

**Congratulations** on your purchase of a new Precision Products, Inc. Hose Reel Cart. Your Hose Reel Cart has been engineered and built to give you the most dependable and best performing product possible.

If you experience any problem you can not easily resolve, please feel free to contact our knowledgeable and helpful customer service department toll-free at **1 (800) 225-5891**.

**Caution:** Carefully read all rules and instructions for safe operation.

**! Rules for Safe Operation**

The following safety precautions are suggested. This Hose Reel Cart is designed, engineered and tested to offer reasonably safe and effective service, provided that it is operated in strict accordance with these instructions. Failure to do so may result in personal injury. Always observe the rules of safe operation. Please read and retain this manual.

- Be alert for holes in the terrain and other hazards.
- Follow maintenance and lubrication instructions as outlined in this manual.
- Always wear substantial footwear. Do not wear loose fitting clothing that may get caught in moving parts.

**Parts and Support**

***Please do not return this product to the store prior to contacting Precision.***

At Precision Products, Inc. our goal is to deliver quality, value and outstanding service. If for any reason our product does not meet your expectations, please contact us and we will take care of any problem you may have with this unit.

When ordering replacement parts please have the model number, part description, part number, inspector number and date on carton, available so that we can best serve you.

**1 (800) 225-5891**  
**www.precisionprodinc.com**  
**Precision Products Inc.**

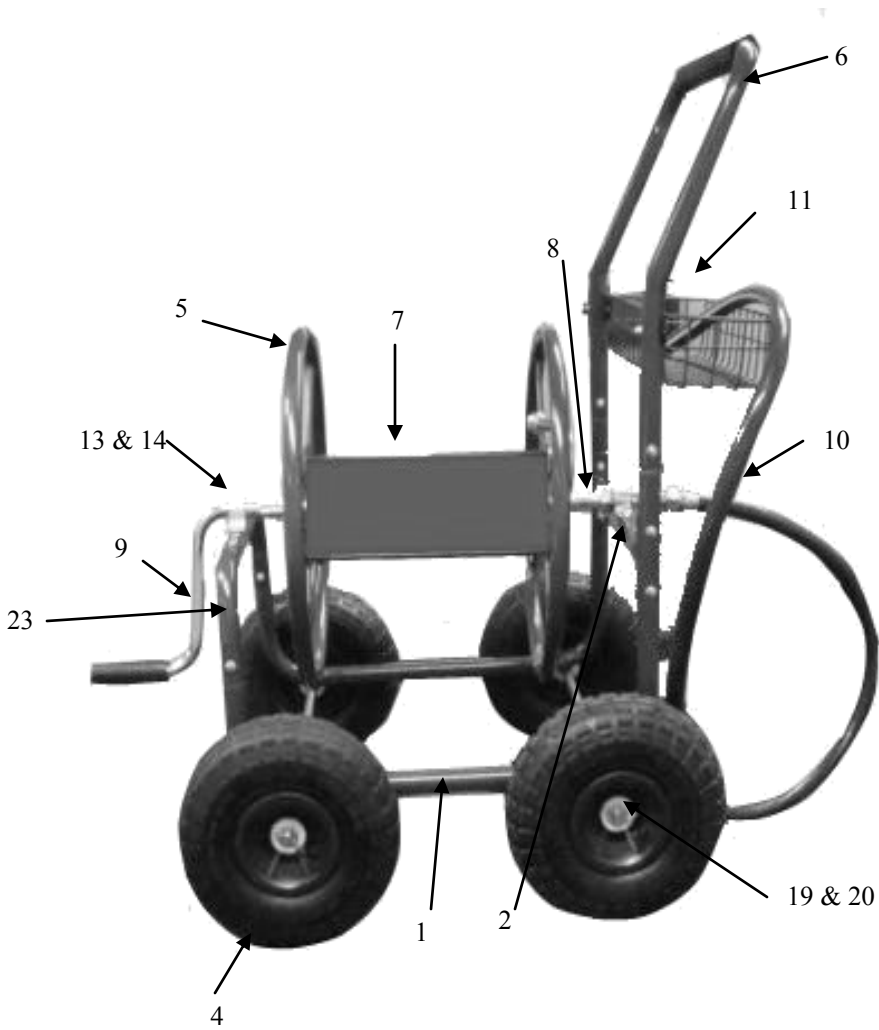

**Carton Contents**

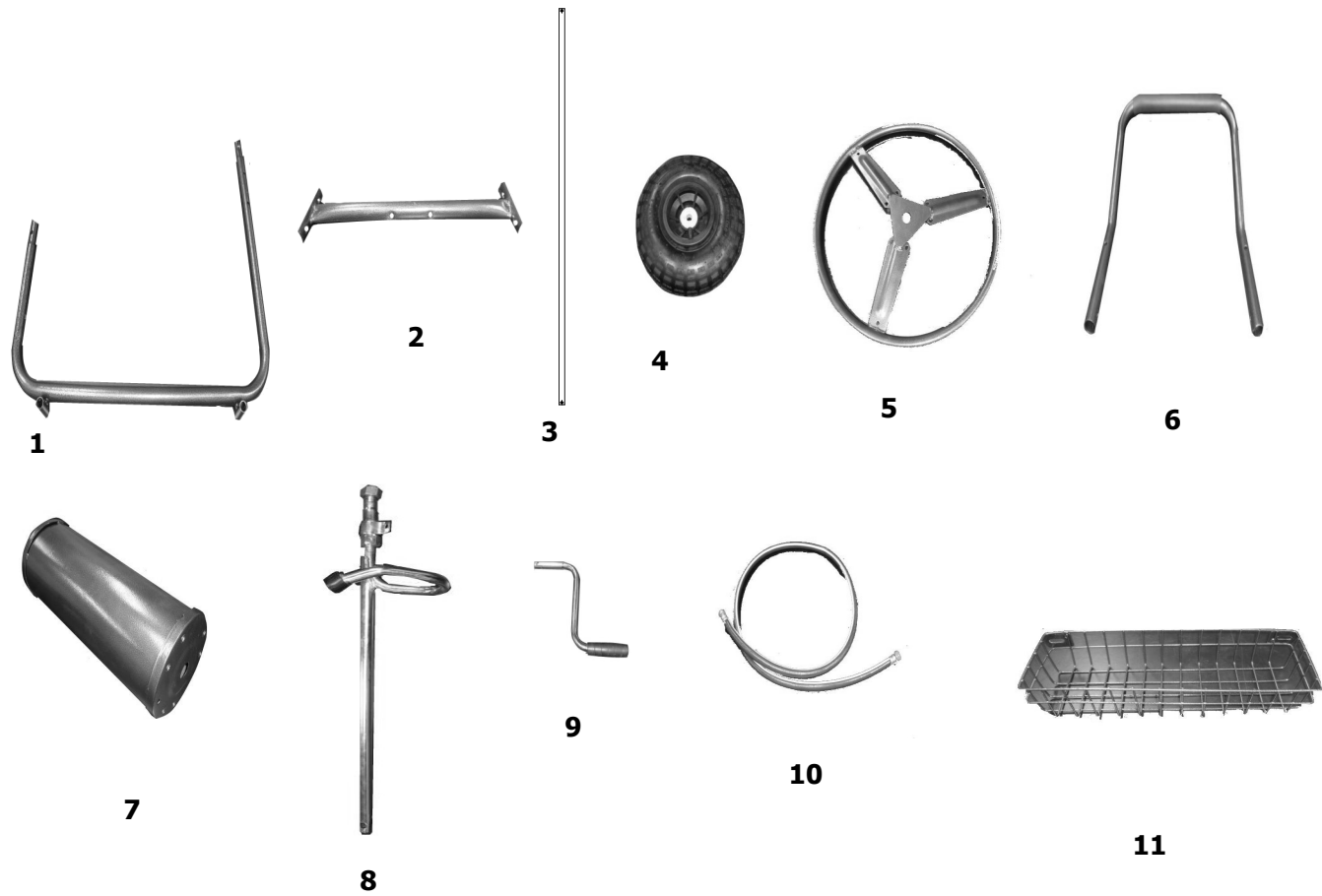

**\*Not all parts shown**

Ref.	QTY.	Description	Ref.	QTY.	Description
1	2	Side Frame	15	2	Hose Washer
2	1	Cross Brace	16	14	M6 x 35 Bolt
3	2	Axle	17	2	M6x 25 Bolt
4	4	Wheels	18	13	M6 x 15 Screws
5	2	Hose Reel Ends	19	4	Cotter Pin
6	1	Push Handle	20	4	12 MM Large Washer
7	1	Hose Reel Center Hub	21	16	6 MM Small Washer
8	1	Water Coupling Tube	22	16	6 MM Nylock Nuts
9	1	Crank Handle	23	1	Front Crank Frame
10	1	Hose Extension			
11	1	Wire Basket			
12	1	U-Bracket			
13	1	Crank U-Bracket			
14	1	Crank Bracket Bushing			

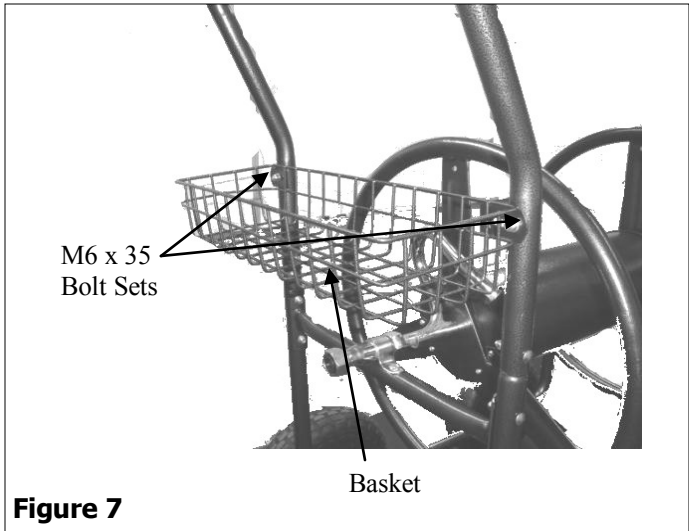

Figure 7

8. Insert Rubber Washers into Hose Extension and Water Coupler. See Figure 8

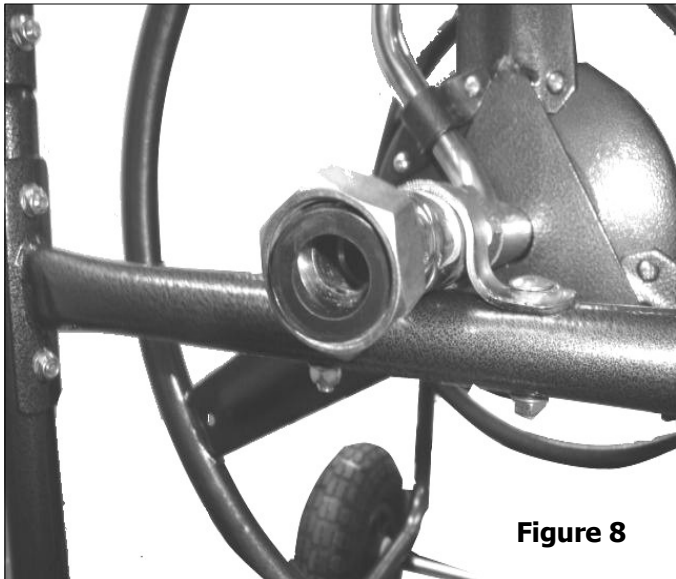

Figure 8

#### Maintenance Instructions

- Keeping the cart clean and dry will prolong the unit's life.
- Lubricate Wheels at regular intervals, at least once every six months, more frequently if used regularly.
- Should rust develop, sand lightly and spray paint.

7 Attach Basket to Handle using (2) M6 x 35 Bolt Sets. See Figure 7

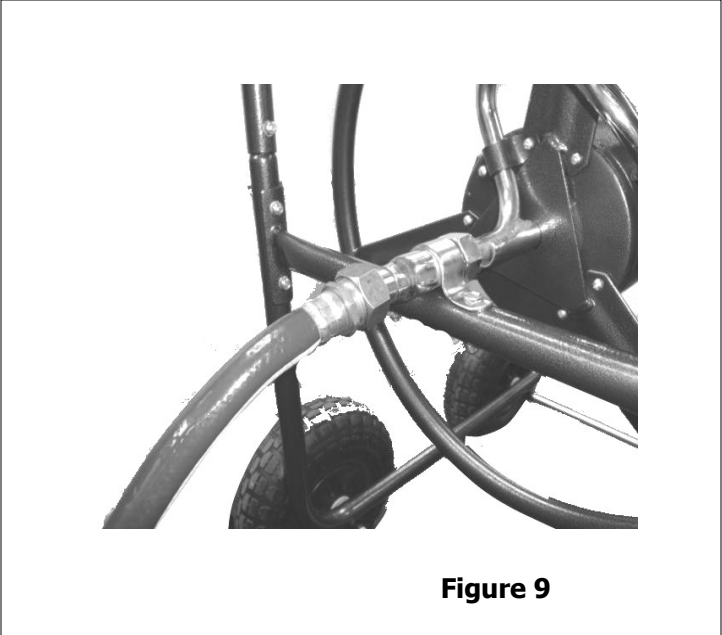

Figure 9

9. Attach Hose Extension to Water Coupler. See Figure 9

#### Parts and Support

***Please do not return this product to the store prior to contacting Precision.***

At Precision Products, Inc. our goal is to deliver quality, value and outstanding service. If for any reason our product does not meet your expectations, please contact us and we will take care of any problem you may have with this unit.

When ordering replacement parts please have the model number, part description, part number, inspector number and date on carton, available so that we can best serve you.

**1 (800) 225-5891**

**[www.precisionprodinc.com](http://www.precisionprodinc.com)**

**Precision Products Inc.  
316 Limit St.  
Lincoln IL 62656**

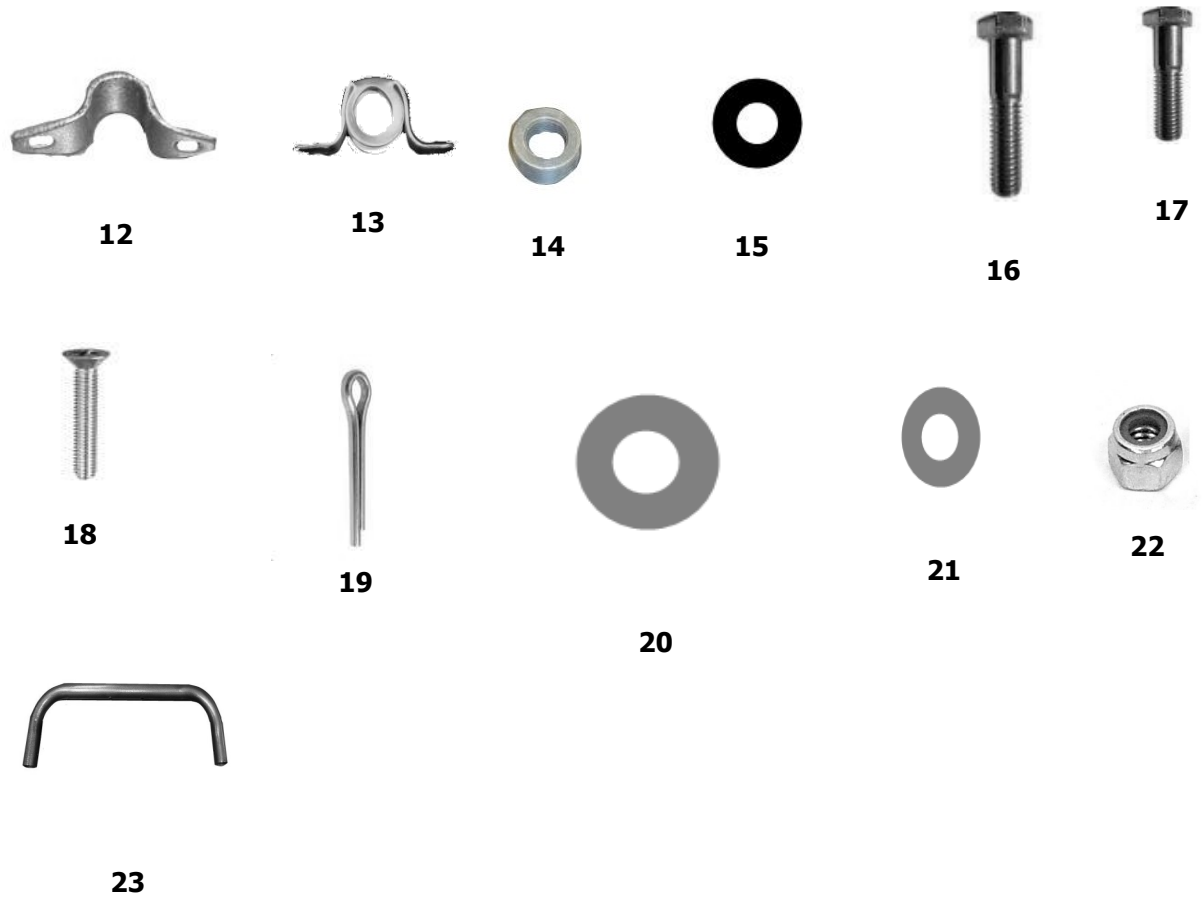

Ref.	QTY.	Description	Ref.	QTY.	Description
1	2	Side Frame	15	2	Hose Washer
2	1	Cross Brace	16	14	M6 x 35 Bolt
3	2	Axle	17	2	M6 x 25 Bolt
4	4	Wheels	18	13	M6 x 15 Screws
5	2	Hose Reel Ends	19	4	Cotter Pin
6	1	Push Handle	20	4	12 MM Large Washer
7	1	Hose Reel Center Hub	21	16	6 MM Small Washer
8	1	Water Coupling Tube	22	16	6 MM Nylock Nuts
9	1	Crank Handle	23	1	Front Crank Frame
10	1	Hose Extension			
11	1	Wire Basket			
12	1	Painted Water Coupler U-Bracket			
13	1	Crank U-Bracket			
14	1	Crank Bracket Bushing			

## Assembly Instructions

### Tools Needed For Cart Assembly

- (1) Screwdriver
- (1) M10 Wrench or Adjustable Wrench

1. Install Front Crank Frame to Side Frames using two M6 X 35 Bolt Sets. Next add Cross Brace to Side Frame using four M6 x 35 Bolt Sets. Slide Axles through tabs on the bottom of Side Frames. See Figure 1

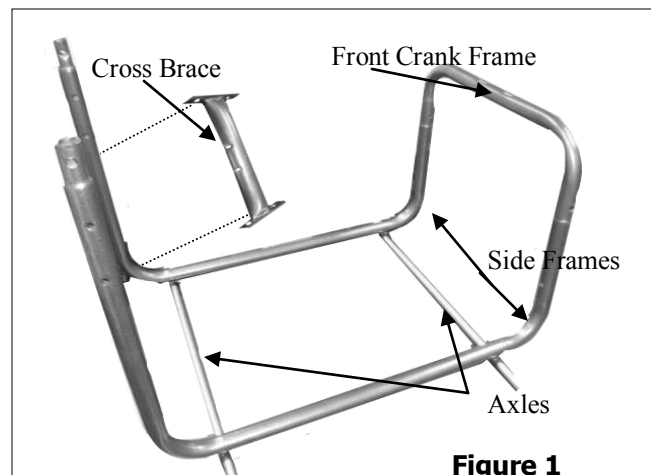
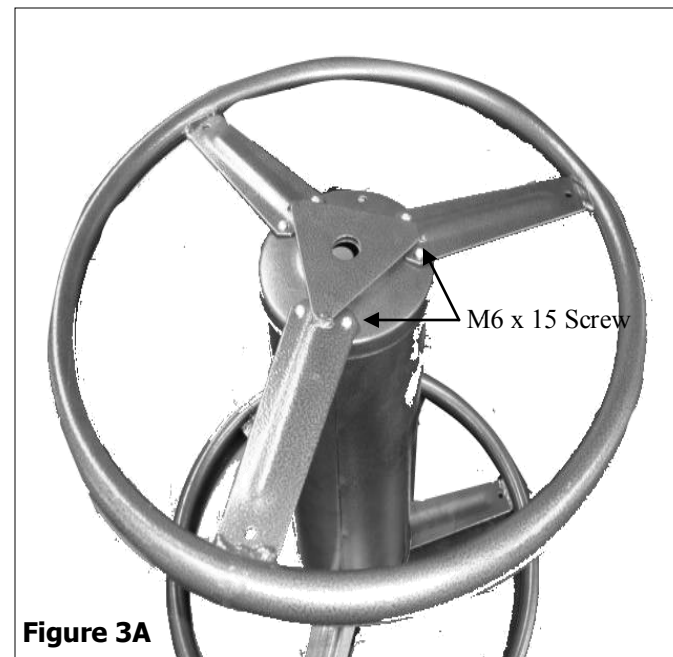

**Figure 1**



**Figure 2**

2. Install Wheels using 12MM Large Washer and Cotter Pin. See Figure 2

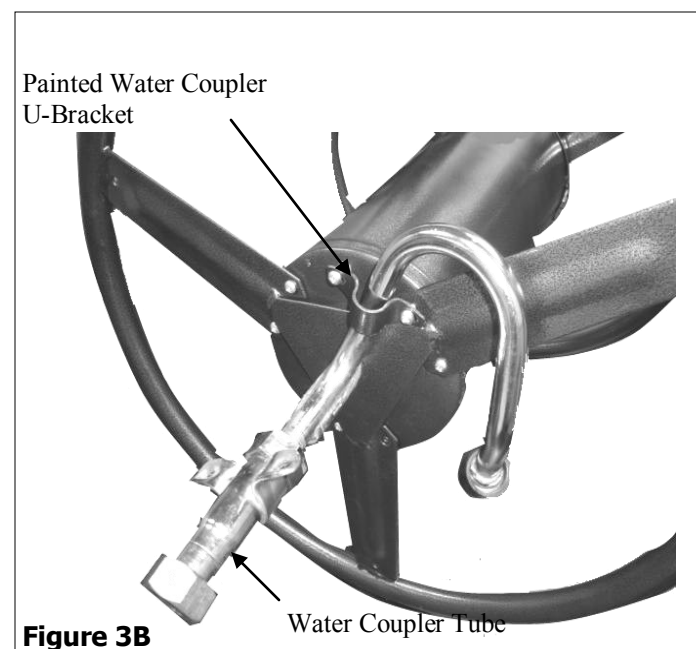

**Figure 3A**

3. Attach Hose Reel End to the Center Hub using (6) M6 x 15 Screws. Repeat opposite side. See figure 3A.

Find the end of the Center Hub with the extra threaded screw hole and insert Water Coupler Tube through this end first.

Attach Water Coupler Tube to the Center Hub using the Painted Water Coupler U-Bracket. See Figure 3B



**Figure 3B**

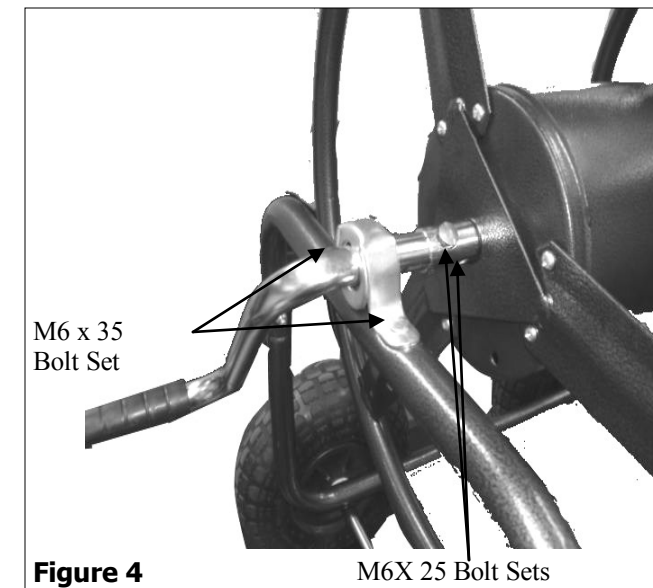

**Figure 4**

4. Insert Crank Bushing into Crank U-Bracket and attach to the Front Crank Frame Using (2) M6 x 35 Bolt Sets. Insert Crank Handle through the Crank Bushing then slide Hose Reel Assembly onto Crank Handle securing with (2) M6 x 25 Bolt Sets. See Figure 4

5. Attach Opposite end of the Hose Reel Assembly to the Cross Brace using (2) M6 x 35 Bolt Sets. See Figure 5

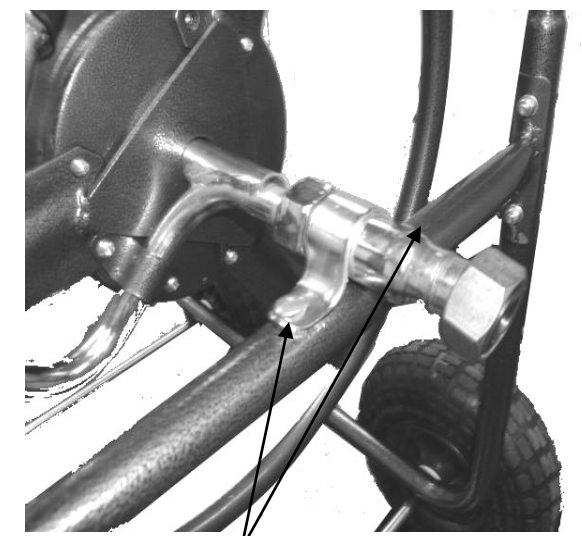

**Figure 5**

6. Assemble Push handle onto Cart Frame using (2) M6 x 35 Bolt Sets. See Figure 6

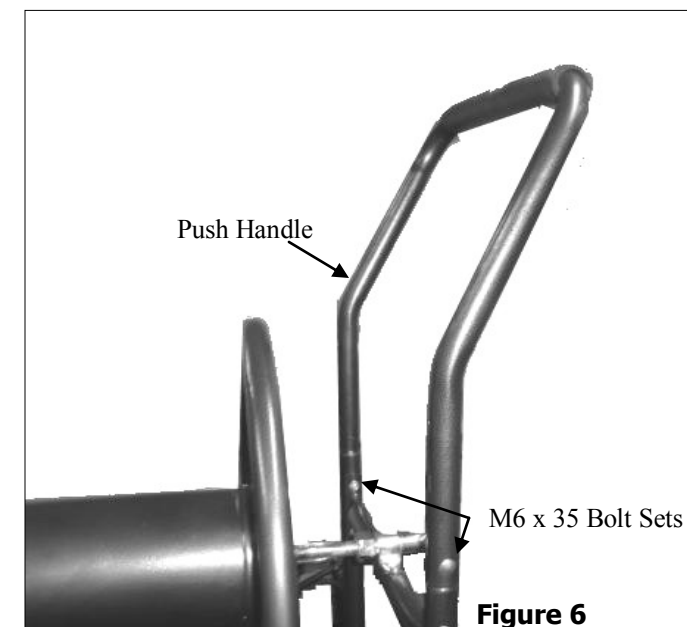

**Figure 6**