

# PRODUCT DESCRIPTION

The soft wind warms the lamp  
Warms you and me



# 1.Components and parts verification

Before you installation, please checking the parts one by one as below :

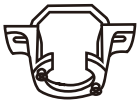

Hanging bracket

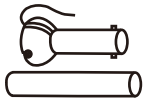

Down rod



Hanging cup



Bottom decorative cup



Wood crews



Spare parts for  
balance sticker



Wiring caps



Remote controller



Lampshade



Retaining screws  
for lamp shade  
and crystal frame



American standard  
junction box screws  
M4\*16\*2PCS

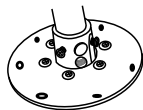

Connecting cover

## 2.Fan lamp installation diagram

### step 1

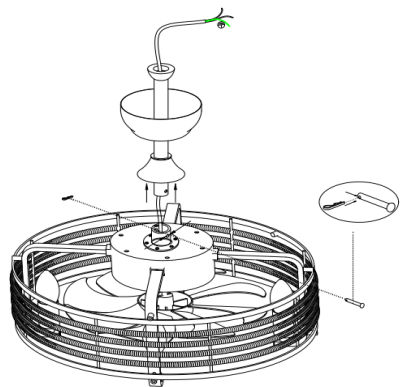
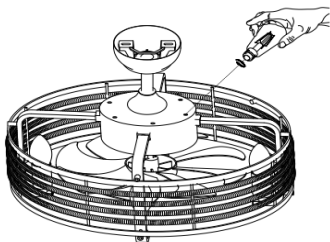

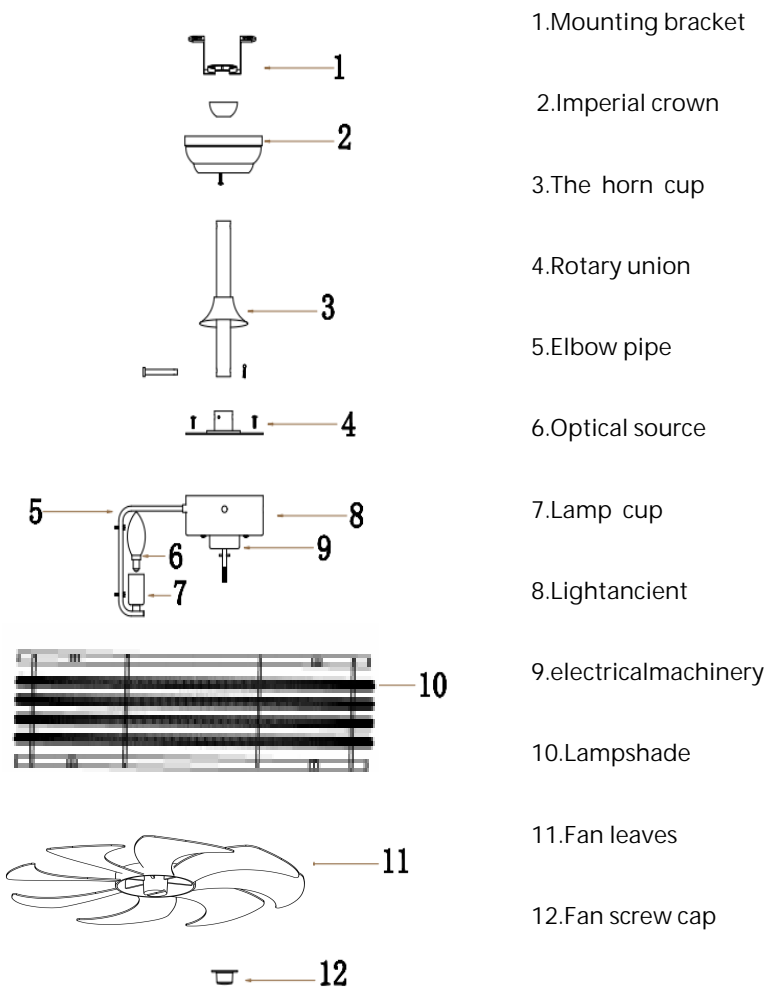

## T Tips

The cage holes maybe small or some bulbs, Please kindly install bulbs first before put ceiling fan to ceiling.

Then align the lamp with the hole on the iron sheet along the hole and screw it

First, unscrew the four screws on the motor, then align the holes on the lampshade and motor, use the screws through the two holes, and tighten. Please check the drawing for reference.



①

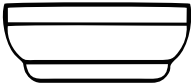

②



③

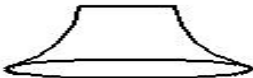



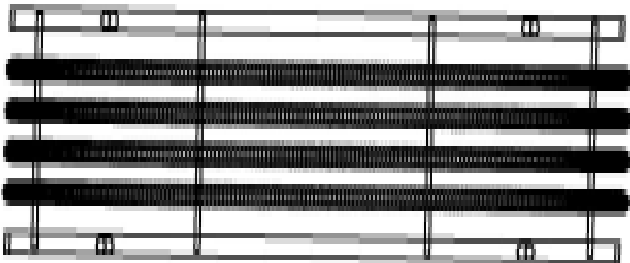



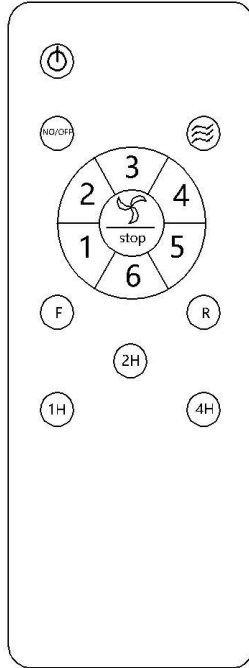



④



## Dimmable Remote

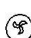

### Fan lamp remotr controlinstruuctions

- |  |   |
|--|---|
|  Main switch          |  Forward rotation                  |
|  Light switch         |  Reversal                          |
|  360° rotation        |  Fixed time 1 hour                 |
|  Fan off              |  Fixed time 2 hours(learning code) |
|  Fan gear kry Gear1-6 |  Fixed time 4 hours                |

Remote control batteryNo.7 1.5V\*2

# WARRANTY

Thanks for choose our product!

About Ceiling Fan, we will provide you promise and service as below:

## Warranty Time

- 1.Fan Motor: Within 1 years for free replace from order date.
- 2.Remote: Within 1 years for free replace from order date.
- 3.Other Parts: Within 1 years for free replace from order date.

## Scope of warranty

The manufacturer warrants that the lamp can be repaired within 2 years from the date of purchase. During the warranty period, if there is any problem with the lamp, you can contact the relevant staff to repair or replace the product, The premise is that the failure of the product occurs under normal use, rather than the failure caused by man-made intentional damage. This warranty does not apply to the product failure caused by misuse, abuse, man-made damage, etc.

## Out of warranty

This warranty does not apply to any product that is found to be faulty due to improper installation, improper setting or use not in accordance with the instructions. This warranty does not apply to the product failure caused by human damage, artificial change, misuse, abuse or wrong installation. This warranty does not apply to the repair of the external surface of the product, such as scratch, wear, weathering, etc., which are considered as normal wear parts of the product.

Temte control matching code

1.If the remote control is not used for a long time, Please remove the battery.

2.Remote control matching code: Turn on the power.

Press the pair code button within 5 seconds of the light on, When you hear two "tick" sound or the light flashes, the code matches successfully. If you need to match the code again, You need to wait 30 seconds before turning on the power and repeat the above operation,



Quiet and comfortable



Multi gear adjustment



Intelligent remote control

## Return/Replacement Policy

We are sorry for you not satisfied on our product When you choose Return / Replacement, please checking policy carefully as following:

## Period of Validity

After you get package within 30 days.

## Defect of Product

Due to the product defect, you want to return it, we suggest you contact us first, we will replace parts you need for free.

## Return Package Must Be

1. Complete parts of the product.
2. Non trace of use or installation.
3. Original package and foam box.
4. No-influence second selling.

## Privacy Protection

All Provide contact way just for help you solve the problem. we will promise protect your privacy. thanks for your cooperation and support!