

# Simply Motorized Cellular Shade Programming Guide

P1  
Motor receiver button

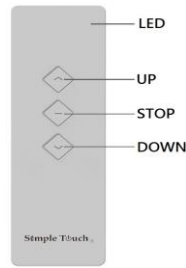

Front side of the remote

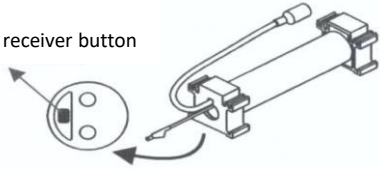
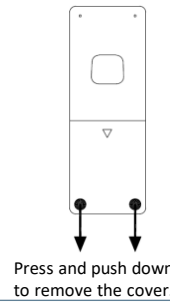

Press and push down to remove the cover.

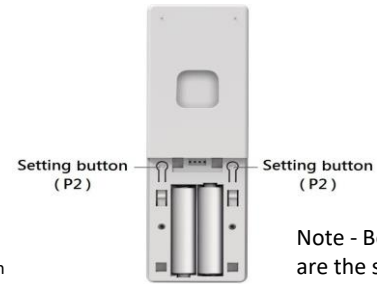

Setting button (P2)

Setting button (P2)

Note - Both P2 buttons are the same.

## ADJUST THE BOTTOM LIMIT WHEN NEEDED!

To avoid the controlling cords tangled inside the shade, adjust the bottom limit to fit your window height when needed. This will ensure that the cords have the right tension when you raise or lower the shade. Additionally, by adjusting the bottom limit, you can be sure that the shade is the right length for your window.

Follow the instructions below.

**NOTE. DO NOT USE A PIN OR A NEEDLE TO PRESS THE P2 BUTTON. IT MAY DAMAGE THE P2 BUTTON.**



### ADJUST THE BOTTOM LIMIT to fit your window height

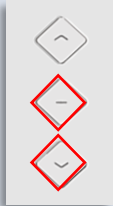

Step 1. Press the **STOP** and **DOWN** buttons for about 5 seconds until the shade jogs once.

JOG x 1

Step 2. Use the remote to control the bottom rail to fit your window height.

Step 3. Press the **STOP** and **DOWN** buttons for about 2-3 seconds until the shade jogs twice.

JOG x 2

**Adjust the bottom limit** is done.

Option to set up "MY FAVORITE POSITION" if you prefer, simply follow the instructions below. Once you have set it up, you will be able to quickly access your preferred position with just the press of the STOP button.

### PROGRAMMING FOR MY FAVORITE POSITION

#### Set Up My Favorite Position

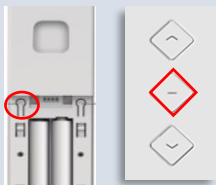

Step 1. Raise the shade all the way up by clicking the **UP** button. Skip this step if the shade is already at the top position.

Step 2. Adjust the bottom rail to your favorite height by clicking the **DOWN** or **UP** buttons.

Step 3. Click either one of the **P2** buttons. The shade jogs once.

JOG x 1

Step 4. Click the **STOP** button once. The shade jogs once.

JOG x 1

Step 5. Click the **STOP** button again. The shade jogs twice.

JOG x 2

**My favorite position set up** is done.

#### Remove My Favorite Position

Step 1. Click either one of the **P2** buttons. The shade jogs once.

JOG x 1

Step 2. Click the **STOP** button once. The shade jogs once.

JOG x 1

Step 3. Click the **STOP** button again. The shade jogs once.

JOG x 1

**Remove My Favorite Position** is done.

## Additional Programming Instructions (optional setup)

### ADJUST THE TOP LIMIT



Step 1. Press the **STOP** and **UP** buttons for about 5 seconds until the shade jogs once.

JOG x 1

Step 2. Use the remote to control the shade to the desired upper position.

Step 3. Press the **STOP** and **UP** buttons for about 2-3 seconds until the shade jogs twice.

JOG x 2

**Adjust the top limit** is done.

## LOCK/ UNLOCK 3 FRONT BUTTONS to prevent resetting the top and bottom limits

### LOCK



Step 1. Press the **STOP** button for about 15 seconds (the LED light will flash, off, flash, off, and remains on). Only release it when the LED light remains on.

Note: If you have set up “my favorite” position, then the shade will move to that position during this process.

Step 2. Click one of the **P2** buttons once. The LED will flash slowly.

The lock setup is done.

### UNLOCK

Process the step 1 and step 2 above. Then the LED light will flash quickly. The unlock setup is done.

## ADD/ REMOVE A DUPLICATED REMOTE CONTROL

### ADD



Step 1. Click one of the **P2** buttons once on the existing remote. The shade jogs once. **JOG x 1**

Step 2. Click the same **P2** button again. The shade jog once. **JOG x 1**

Step 3. Click one of the **P2** buttons on the new remote. The shade jogs twice. **JOG x 2**

### Remove

Process the step 1 to 3 above to remove the remote.

## REVERSE THE MOTOR DIRECTION

P1 motor receiver button

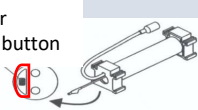

Step 1. Press the **P1** button until the shade jogs 3 times (about 10 seconds). **JOG x 3**

NOTE. The **P1** button is at side of the motor.

## ADJUST THE MOTOR SPEED (Three speeds are available. The slowest speed is the default setting)

### ACCELERATE



Step 1. Click one of the **P2** buttons once. The shade jogs once. **JOG x 1**

Step 2. Click the **UP** button. The shade jogs once. **JOG x 1**

Step 3. Click the **UP** button again. The shade jogs twice. **JOG x 2**

### DECELERATE



Step 1. Click one of the **P2** buttons once. The shade jogs once. **JOG x 1**

Step 2. Click the **DOWN** button. The shade jogs once. **JOG x 1**

Step 3. Click the **DOWN** button again. The shade jogs twice. **JOG x 2**

In the rare instance that you may have to do the “**FACTORY RESET**”, follow the steps at right. Then, continue to “**PAIR THE REMOTE TO THE SHADE**” and set up “**TOP & BOTTOM LIMITS**” before using the motorized shade again.

## FACTORY RESET

P1 motor receiver button

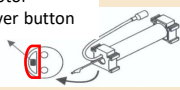

Step 1. Press the **P1** button until the shade jogs 4 times (about 15 seconds). **JOG x 4**

**Note. DO NOT RELEASE the P1 button during this step. If accidentally release it, please must redo it again. Different numbers of jogs will result in different settings.**

## PAIR THE REMOTE TO THE SHADE

P1 motor receiver button

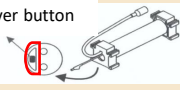

Step 1. Press the **P1** button about 2-3 seconds. The shade jogs once **JOG x 1**

Step 2. Press the **STOP** button for about 2-3 seconds. The shade jogs twice. **JOG x 2**

## SET UP THE TOP AND BOTTOM LIMIT

### TOP Limit



Step 1. Move the shade to the top position by pressing the **UP** button.

Step 2. Press both **UP** and **STOP** buttons for about 2-3 seconds. The shade jogs twice. **JOG x 2**

### Bottom Limit



Step 1. Move the bottom rail to the bottom position by pressing the **DOWN** button.

Step 2. Press both **DOWN** and **STOP** buttons for about 2-3 seconds. The shade jogs twice. **JOG x 2**

**FCC** FCC ID #2AWSE-STP053

FOR INDOOR USE ONLY  
This motorized shade has been tested and found to complete with the limits for a Class B digital device, pursuant to part 15 of the FCC rules.  
See more information on the user guide.