

ZDM-AW010GY-11

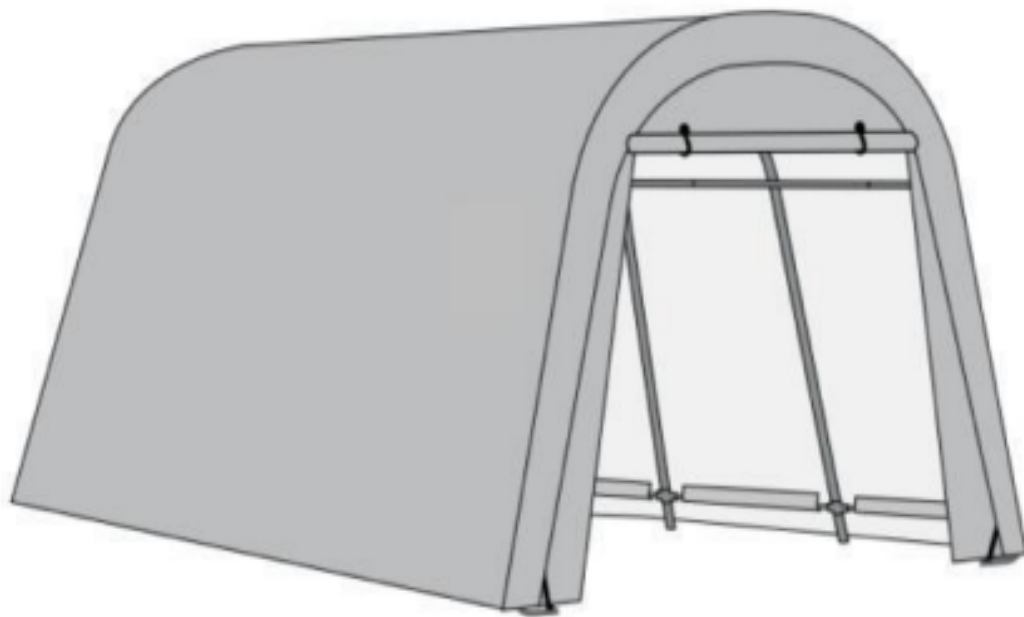

A Minimum of 3 People is required for a safe assembly of the product

Se requiere un mínimo de 3 personas para el montaje seguro del producto

SAFETY PRECAUTIONS...

Safety precautions MUST be followed at all times throughout the construction of your building!

**Always practice
proper tool
safety**

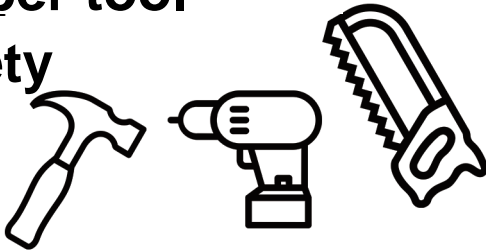

Exercise caution when using tools during assembly. It's particularly important to be well-versed in the use of any power tools involved in the process.

**No children or
pets at worksite**



Ensure that children and pets are kept at a safe distance from the construction area until the building is fully assembled. This precaution minimizes distractions and reduces the risk of accidents.

**Don't focus weight
on roof**



Roof Safety Warning:
Never put your full weight on the building's roof. Always ensure that a step ladder is fully extended and placed on level ground before climbing it.

Wind advisory



Wind Advisory:

Avoid assembling your building on a windy day. Large panels can act like sails in the wind, making them hard to control and posing safety risks during construction.

Complete Check:

Before starting assembly, verify that you have all the parts and hardware listed. A partially assembled building can be vulnerable to damage, even from mild winds.

PRECAUCIONES DE SEGURIDAD...

¡Las precauciones de seguridad DEBEN ser seguidas en todo momento durante la construcción de su edificio!

Siempre practique la seguridad adecuada con las herramientas



Tenga precaución al usar herramientas durante el ensamblaje. Es especialmente importante estar bien familiarizado con el uso de uso de cualquier herramienta eléctrica involucrada en el proceso.

No permita niños ni mascotas en el lugar de trabajo



Asegúrese de que los niños y las mascotas se mantengan a una distancia segura del área de construcción hasta que el edificio esté completamente ensamblado. Esta precaución minimiza las distracciones y reduce el riesgo de accidentes.

No concentre peso en el techo

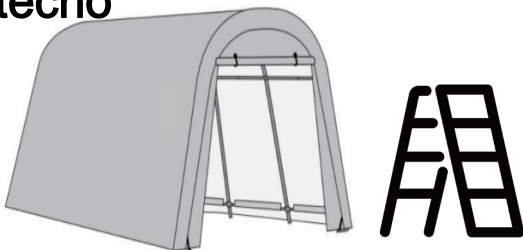

Advertencia de seguridad en el techo: Nunca ponga todo su peso sobre el techo del edificio. Asegúrese siempre de que una escalera de mano esté completamente extendida y colocada sobre terreno nivelado antes de subir.



Aviso de viento:
Evite ensamblar su edificio en un día ventoso. Los paneles grandes pueden actuar como velas en el viento, lo que los hace difíciles de controlar y representa riesgos de seguridad durante la construcción.

Revisión completa:
Antes de comenzar el ensamblaje, verifique que tiene todas las piezas y herrajes listados. Un edificio parcialmente ensamblado puede ser vulnerable a daños, incluso por vientos suaves.

ASSEMBLY TIPS & TOOLS

Weather Awareness:

Choose a clear and calm day for your installation. Avoid building assembly on windy days, and be cautious if the ground is wet or muddy.

Team Effort Required:

Assembling your building is a three-person job at minimum. One can hold parts or panels in place, while the other secures them and manages the tools, ensuring a quicker and safer assembly process.

Gathering Your Tools and Supplies:

Prepare by listing the basic tools and materials necessary for assembly. Your choice of anchoring method and base type will determine the complete list of materials required.

WHAT YOU NEED

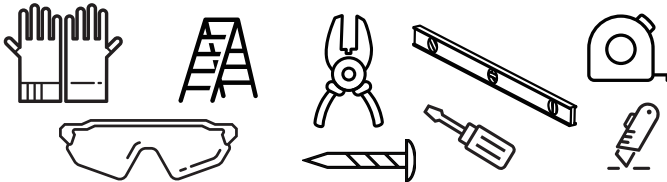

- Work Gloves
- Safety Glasses
- Step Ladder
- No. 2 Phillips Screwdriver (Magnetic Tip Preferred)
- Utility Knife or Scissors
- Pliers
- Carpenter's Level
- Tape Measure

RECOMMENDED TIME SAVERS

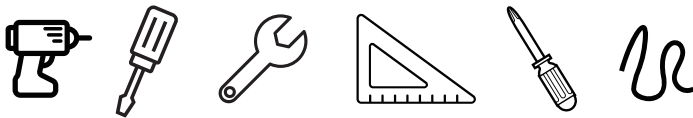

- Power Drill (Cordless, Variable Speed)
- Nut Driver or Wrench
- Square
- String (for squaring the frame)
- Awl (to align holes)

BASE PREPARATION TOOLS

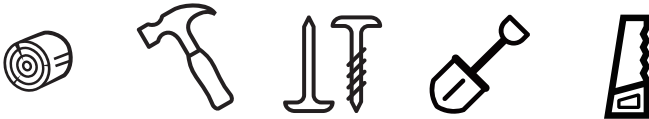

- Lumber and/or Concrete
 - Hammer and Nails
 - Spade or Shovel
 - Hand Saw or Power Saw
-

Choosing and Preparing Your Site:

Select an ideal spot for your building before assembly begins. Opt for a level area with effective drainage.

Ensure ample space around the construction area for easy movement and assembly of parts. Check that there's sufficient clearance at the entrance for doors to open fully. Additionally, you'll need enough external space around the building for attaching panel screws from the outside.

Prior to starting the assembly of any parts, make sure your base is in place and the anchoring system is set up and ready for action.

CONSEJOS DE ENSAMBLAJE Y HERRAMIENTAS

Conciencia sobre el clima:

Elija un día claro y calmado para su instalación. Evite el ensamblaje del edificio en días ventosos y tenga precaución si el suelo está mojado o embarrado.

Trabajo en equipo requerido:

El ensamblaje de su edificio es un trabajo que requiere un mínimo de tres personas. Una puede sostener las piezas o paneles en su lugar, mientras que la otra los asegura y maneja las herramientas, lo que asegura un proceso de ensamblaje más rápido y seguro.

Recolección de herramientas y suministros:

Prepárese haciendo una lista de las herramientas y materiales básicos necesarios para el ensamblaje. Su elección de método de anclaje y tipo de base determinará la lista completa de materiales requeridos.

LO QUE NECESITAS

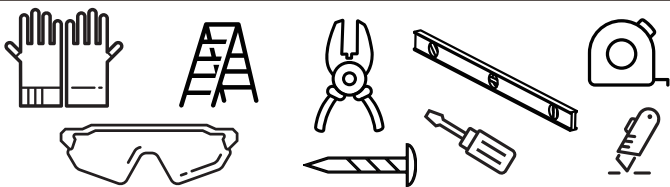

- Guantes de trabajo
- Gafas de seguridad
- Escalera de mano
- Destornillador Phillips No. 2 (se recomienda con punta magnética)
- Cuchillo utility o tijeras
- Alicates
- Nivel de carpintero
- Cinta métrica

AHORRADORES DE TIEMPO RECOMENDADOS

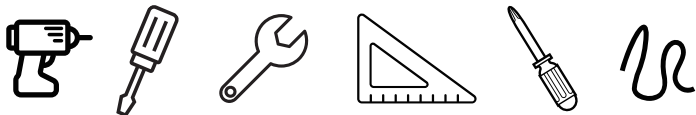

- Taladro eléctrico (inalámbrico, velocidad variable)
- Destornillador de tuercas o llave
- Escuadra
- Cuerda (para cuadrar el marco)
- Punzón (para alinear los agujeros)

HERRAMIENTAS PARA LA PREPARACIÓN DE LA BASE

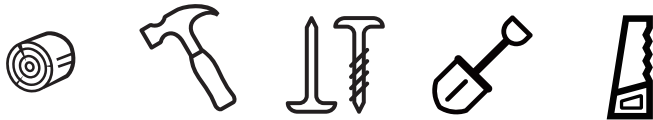

- Madera y/o concreto
- Martillo y clavos
- Pala o azada
- Sierra manual o sierra eléctrica

Elegir y preparar el sitio:

Seleccione un lugar ideal para su edificio antes de que comience el ensamblaje.

Elija una zona nivelada con buen drenaje.

Asegúrese de tener suficiente espacio alrededor del área de construcción para facilitar el movimiento y el ensamblaje de las piezas. Verifique que haya suficiente espacio libre en la entrada para que las puertas se abran completamente. Además, necesitará suficiente espacio exterior alrededor del edificio para fijar los tornillos de los paneles desde el exterior.

Antes de comenzar el ensamblaje de cualquier parte, asegúrese de que la base esté en su lugar y que el sistema de anclaje esté preparado y listo para usar.

**HARDWARE
HERRAMIENTAS**

【A】 ×15

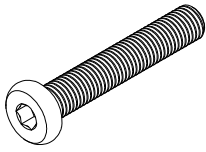

M6×75mm

【B】 ×36

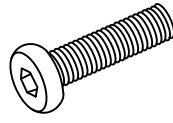

M6×40mm

【C】 ×6

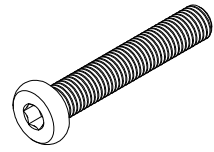

M6×45mm

【D】 ×15



M6 mm

【E】 ×42



M6 mm

【F】 ×1

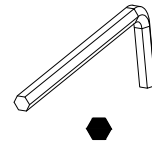

6 mm

【G】 ×34

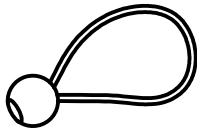

【H】 ×15

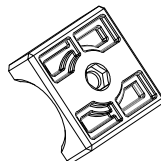

【I】 ×15

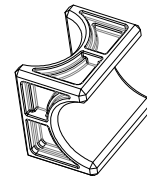

【J】 ×8

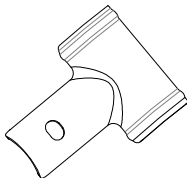

【K】 ×12

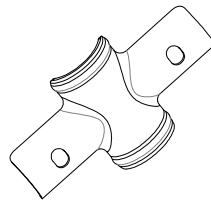

【L】 ×4

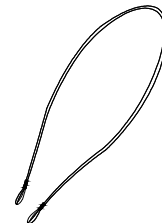

×6

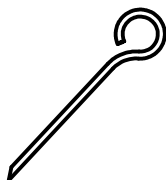

×4

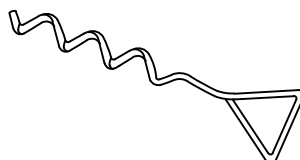

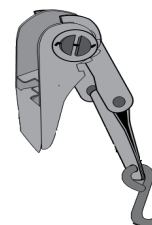

×4

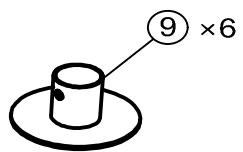
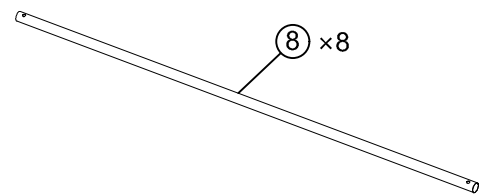
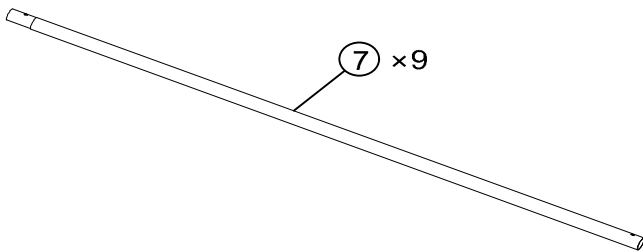
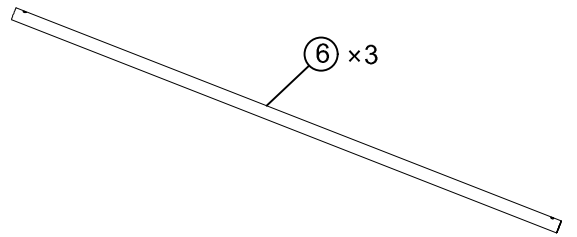
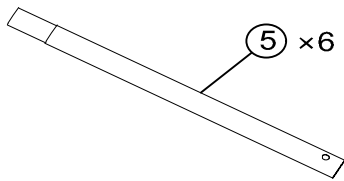
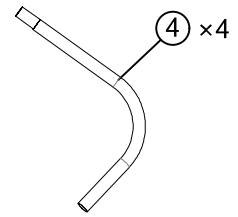
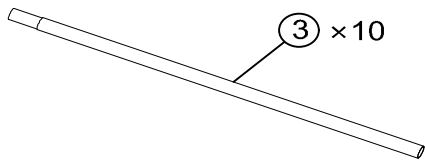
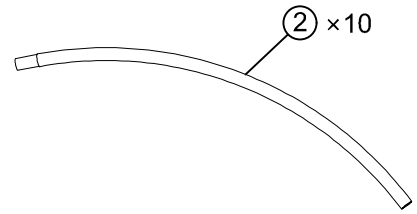
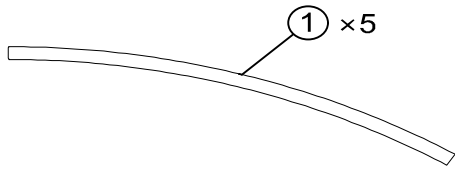

PART
PARTE



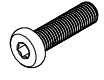

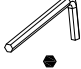

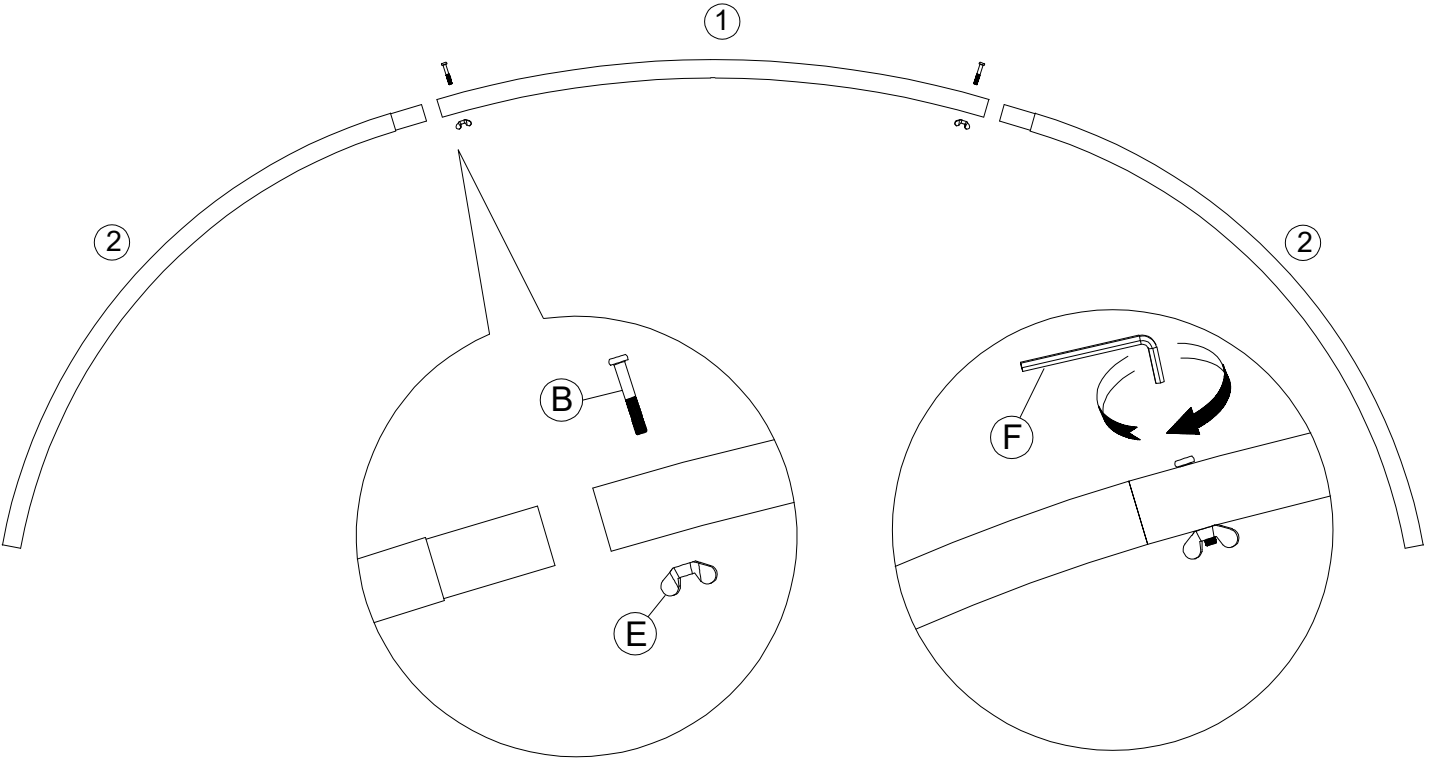
STEP 1
PASO 1

【B】 ×10  M6×40mm	【E】 ×10  M6mm	【F】 ×1  4mm		
--	---	---	--	--





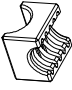

x5

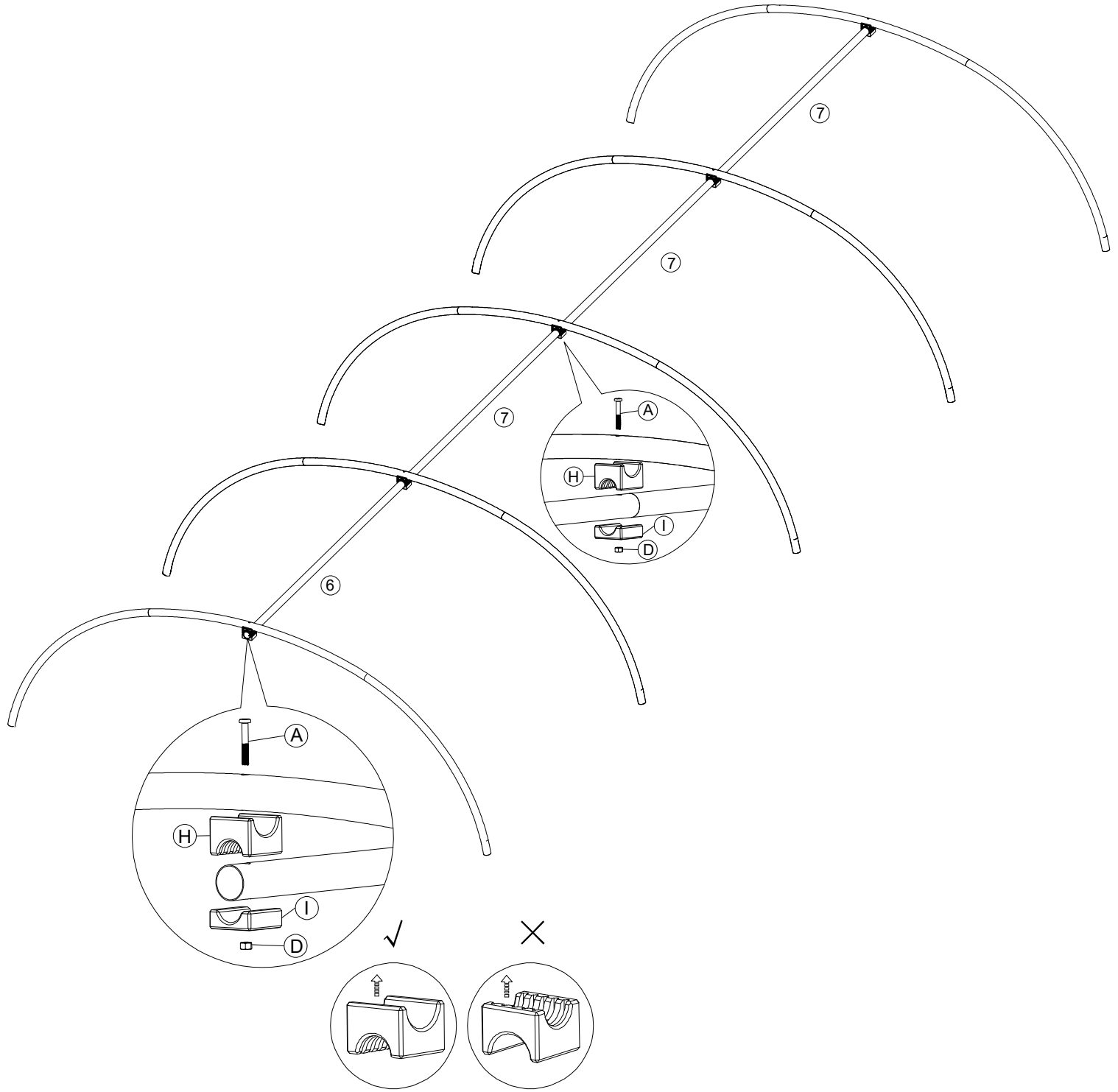
STEP 2
PASO 2

<p>[A] x5</p>  <p>M6x75mm</p>	<p>[D] x5</p>  <p>M6mm</p>	<p>[F] x1</p>  <p>4mm</p>	<p>[H] x5</p> 	<p>[I] x5</p> 
---	--	---	--	--

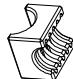

STEP 3
PASO 3

[A] ×10  M6×75mm	[D] ×10  M6mm	[F] ×1  4mm	[H] ×10 	[I] ×10 
--	---	---	---	---

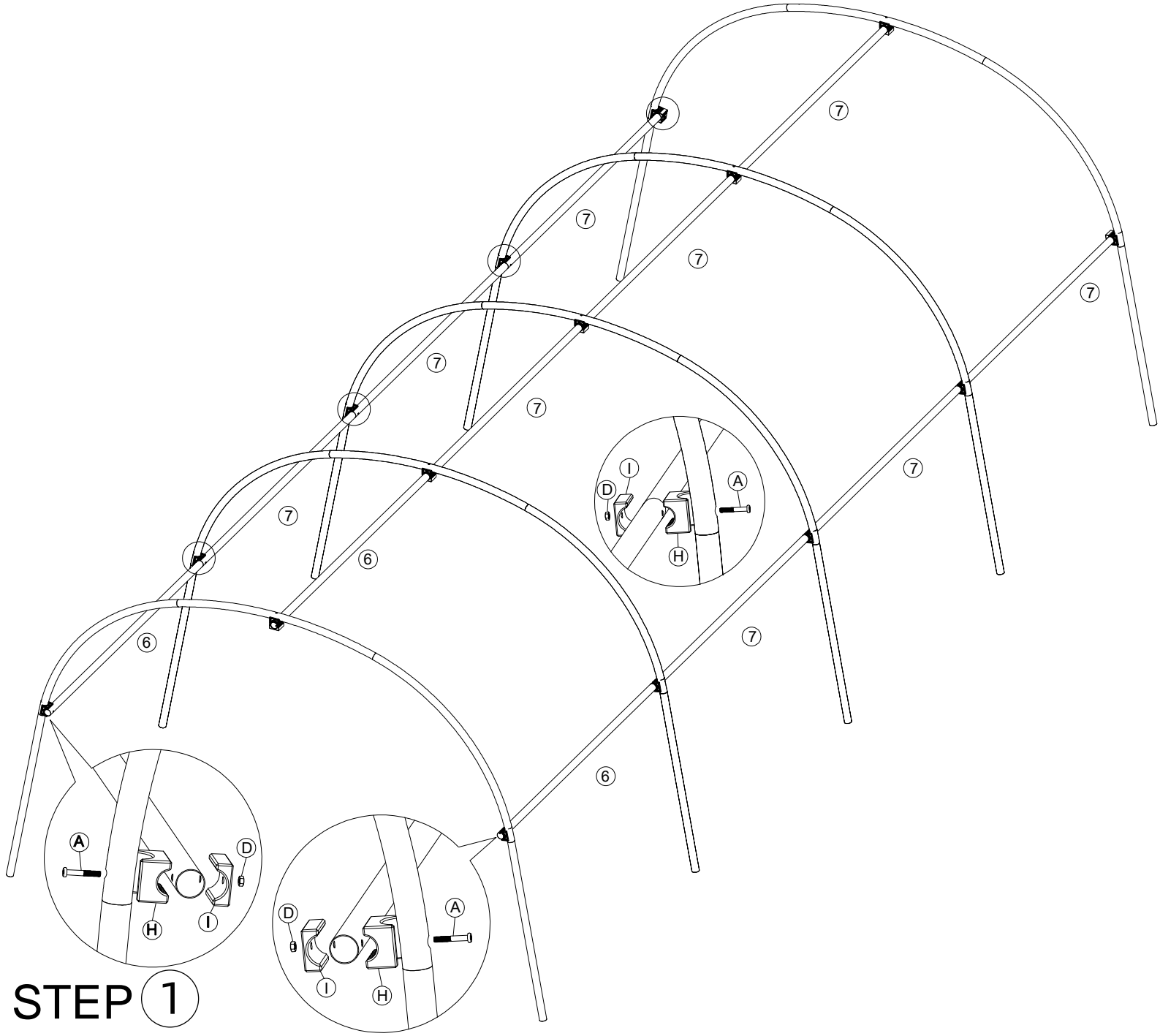

STEP 1
PASO 1

STEP 2
PASO 2



STEP 4
PASO 4

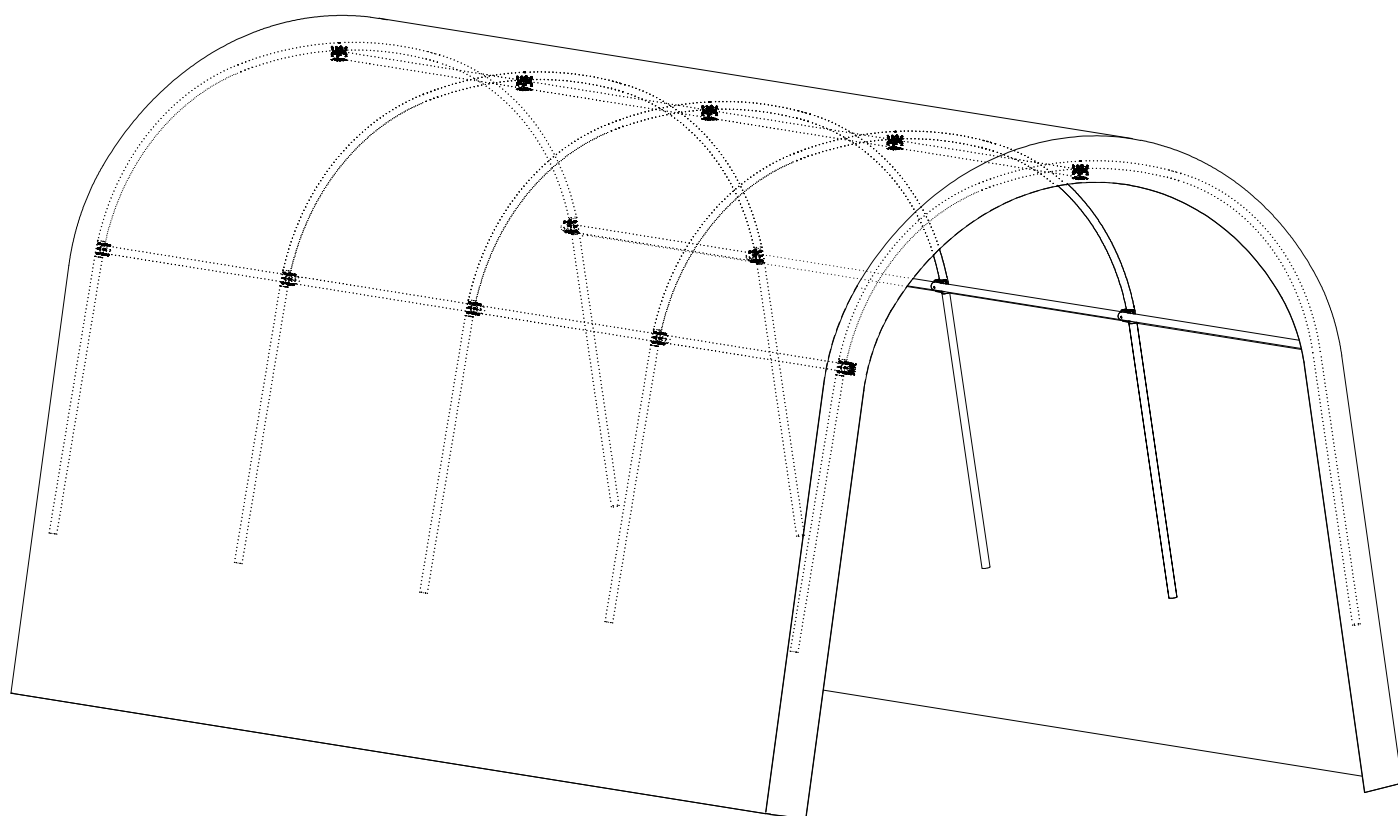
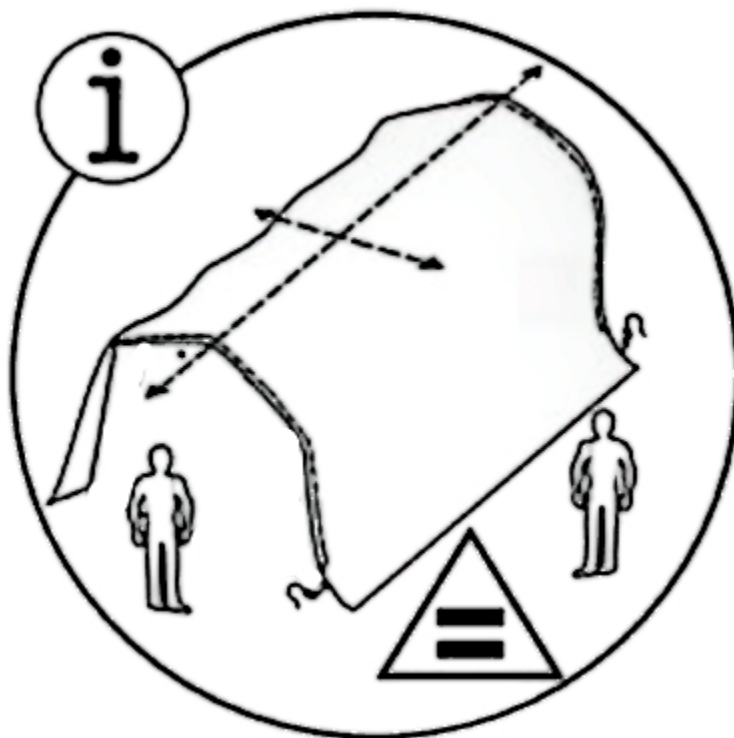



After the roof of the carport goes up, pay attention to the size of both ends.

Después de que el techo del cobertizo se instale, preste atención al tamaño de ambos extremos.

STEP 5

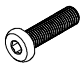
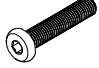

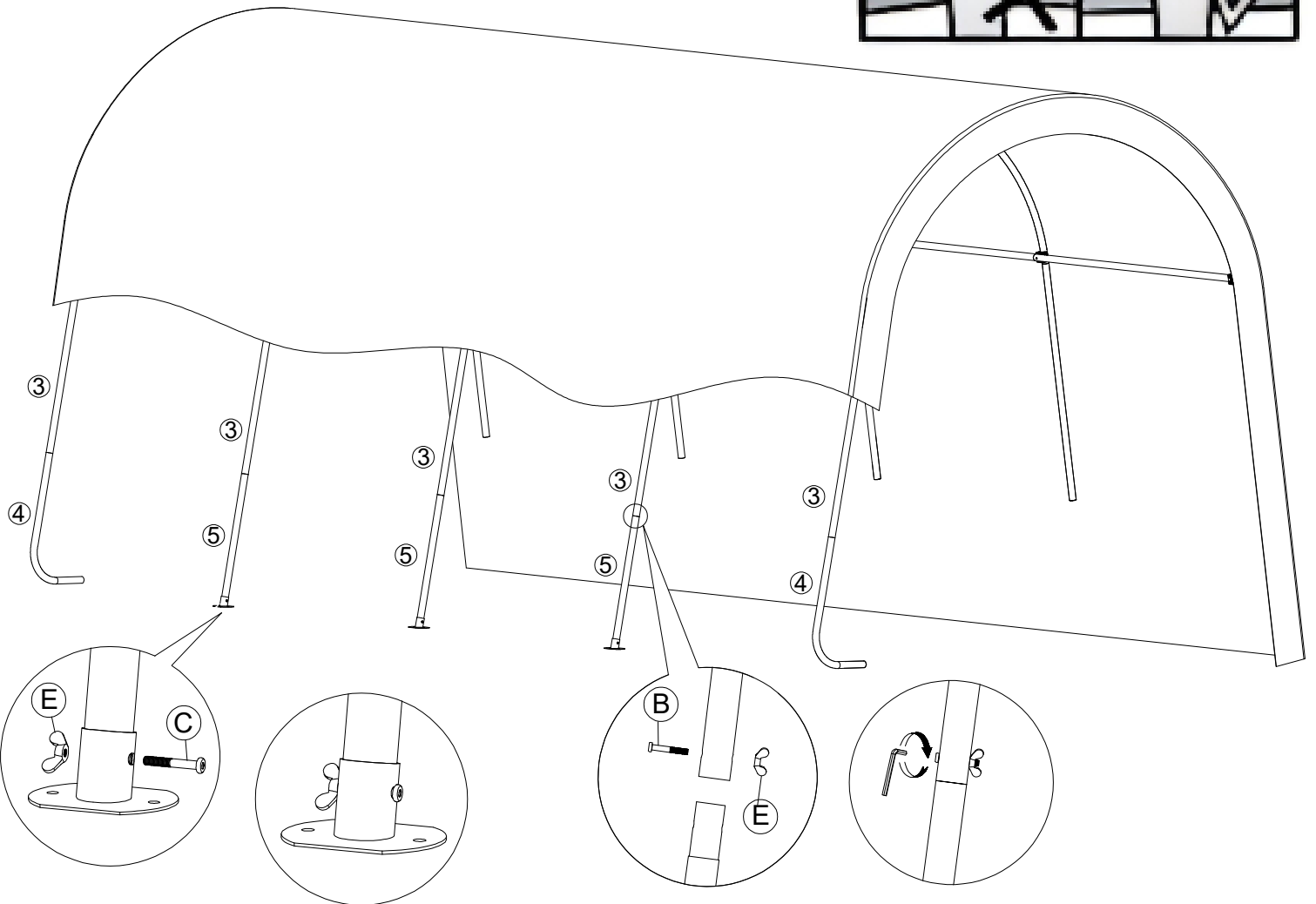

PASO 5

[B] x5  M6x40mm	[C] x 3  M6x45mm	[E] x 8  M6mm	[F] x1  4mm	
---	--	---	---	--

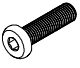

PRODUCT ASSEMBLY
MONTAJE DEL PRODUCTO

STEP 6
PASO 6

[B] x5  M6x40mm	[C] x3  M6x45mm	[E] x8  M6mm	[F] x1  4mm	
---	---	--	---	--

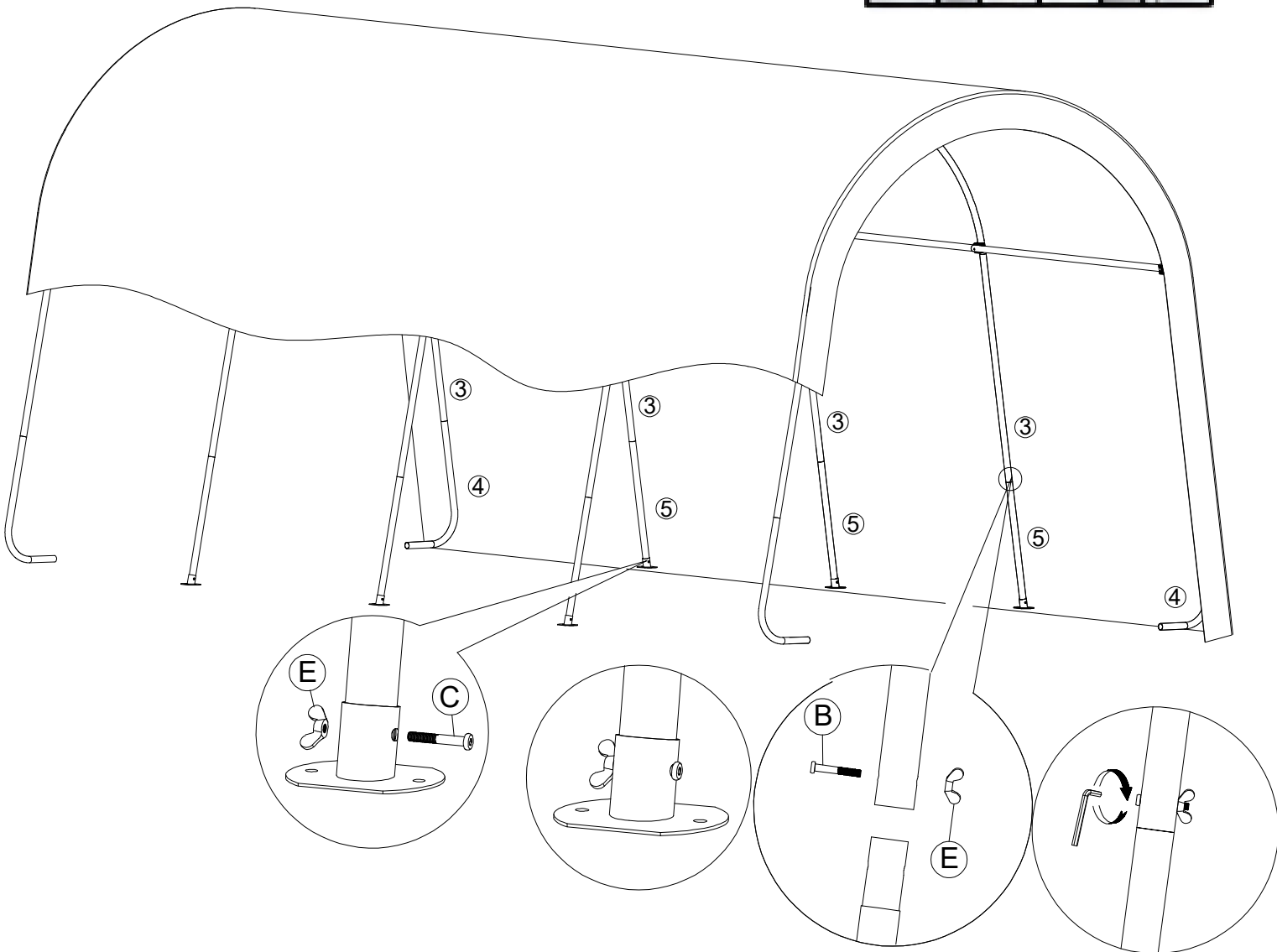



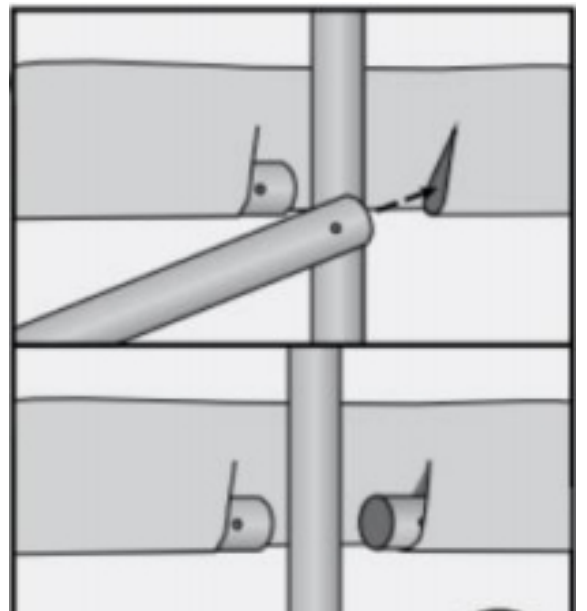
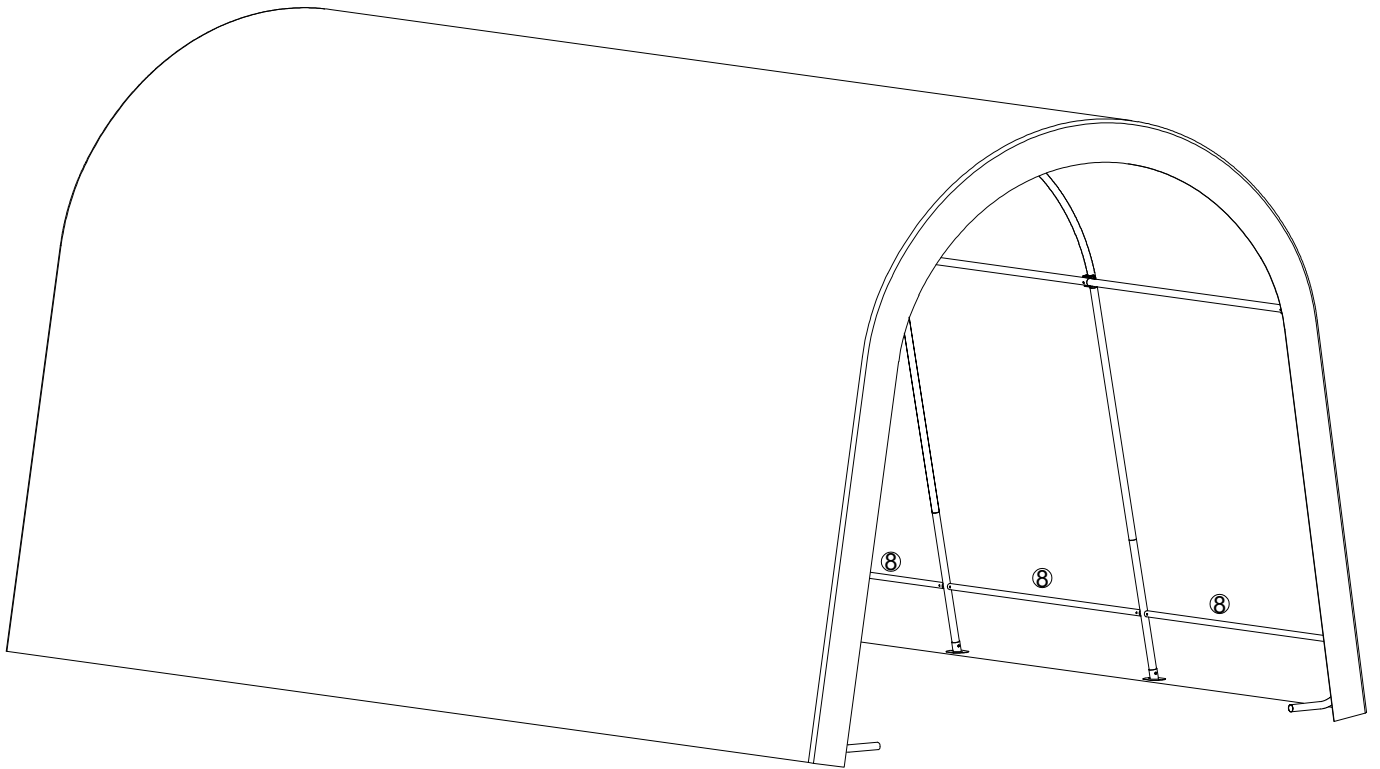

STEP 7
PASO 7



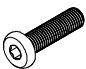

STEP 8

PASO 8

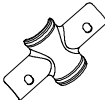
[B] ×16  M6×40mm	[E] ×16  M6mm	[F] ×1  4mm	[J] ×8 	[K] ×12 
--	---	---	--	--

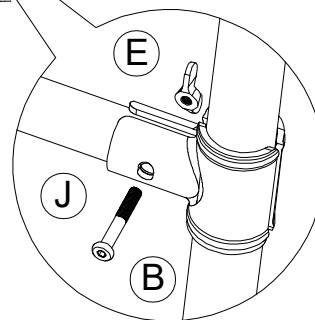
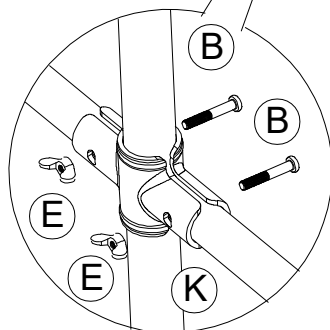
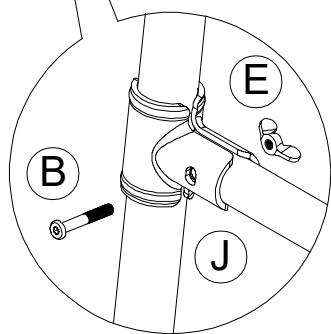
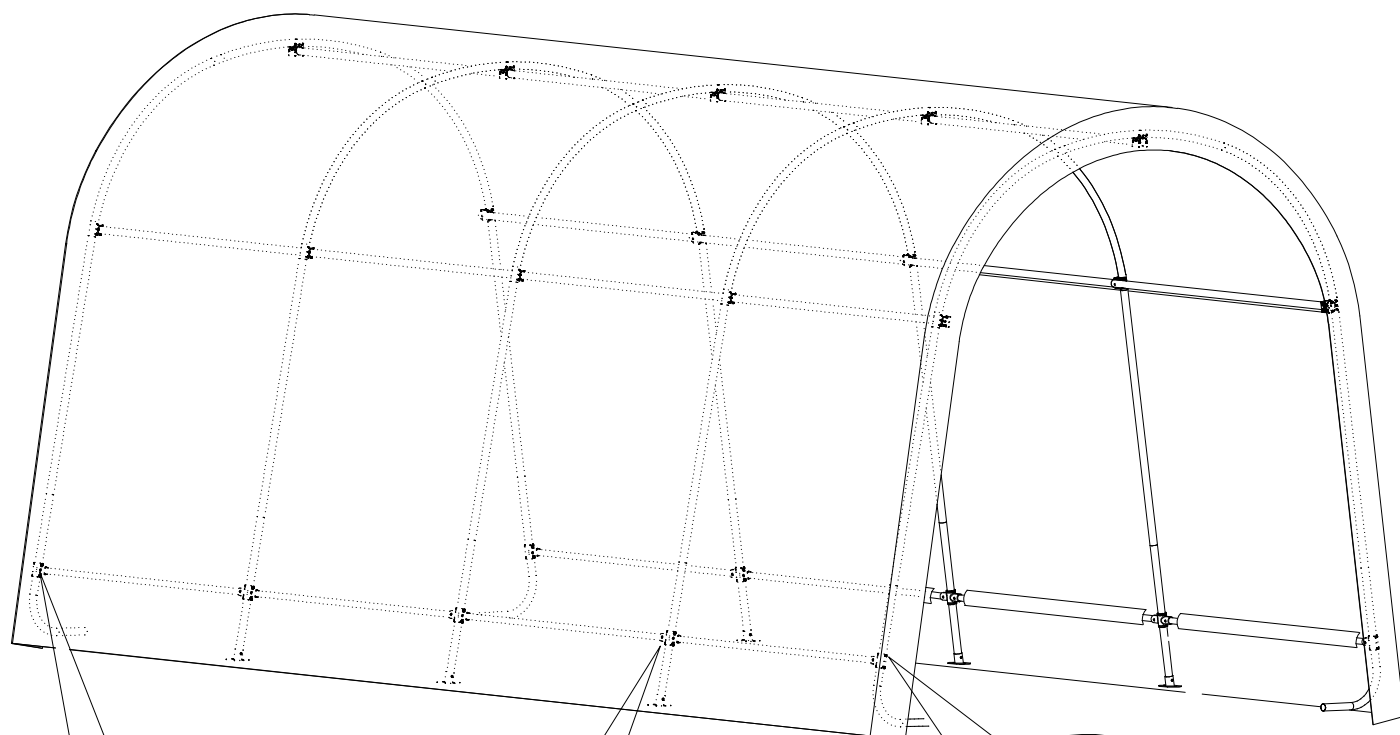

STEP 9

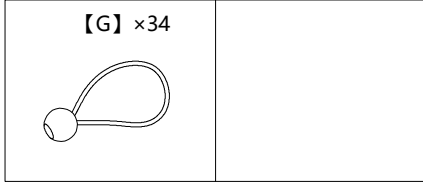

PASO 9

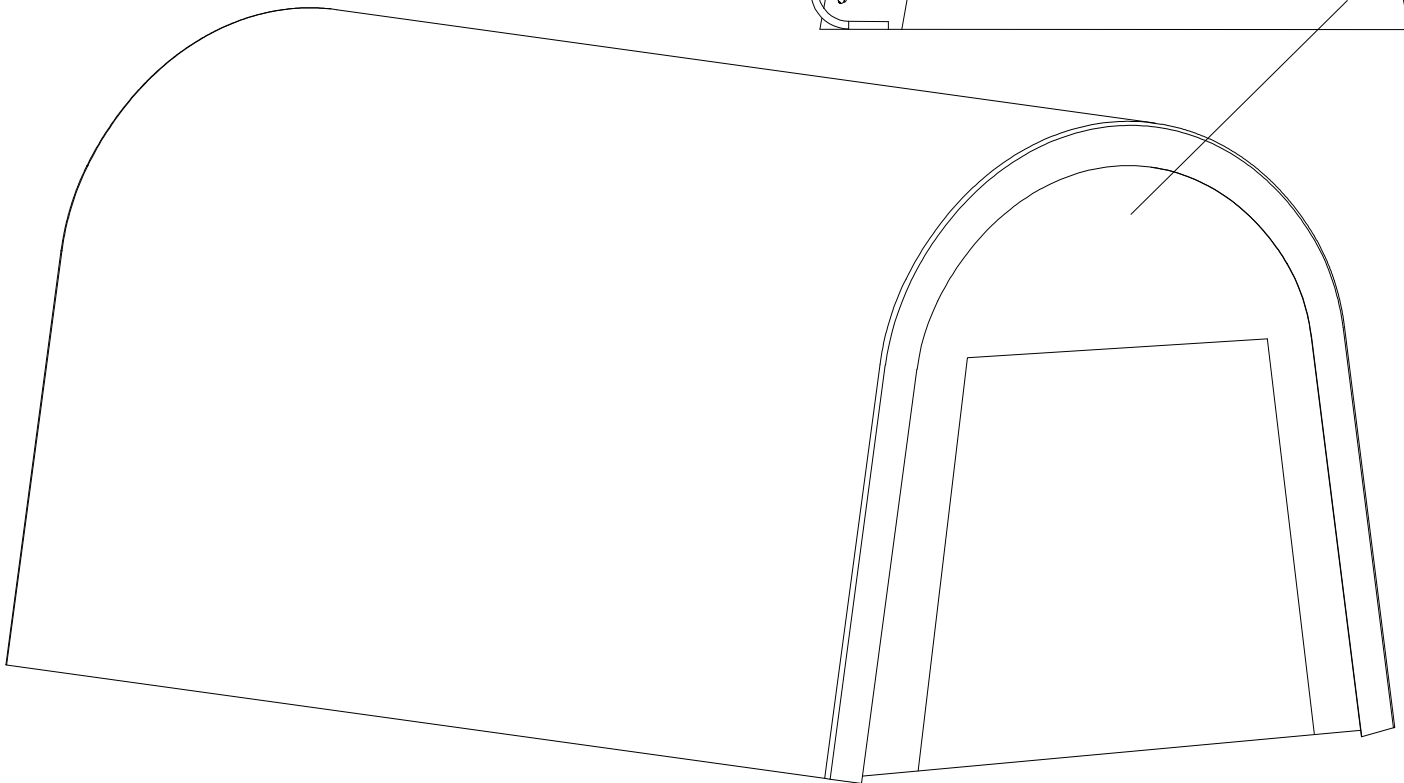
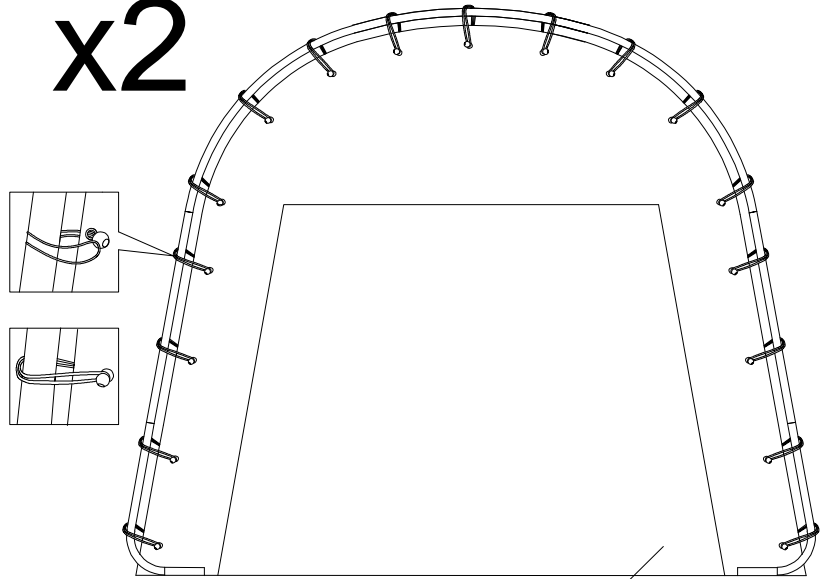

x2

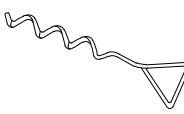

STEP 10
PASO 10

[L] x4	x6	x4
		

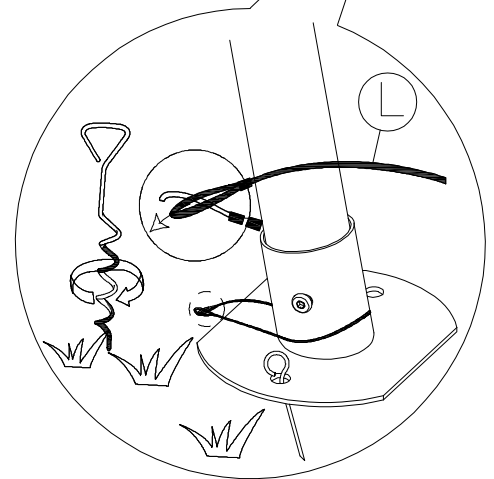
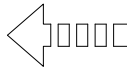
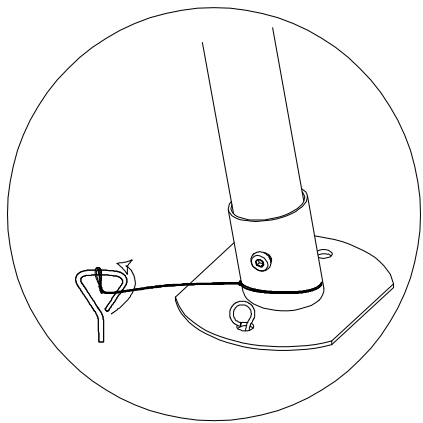
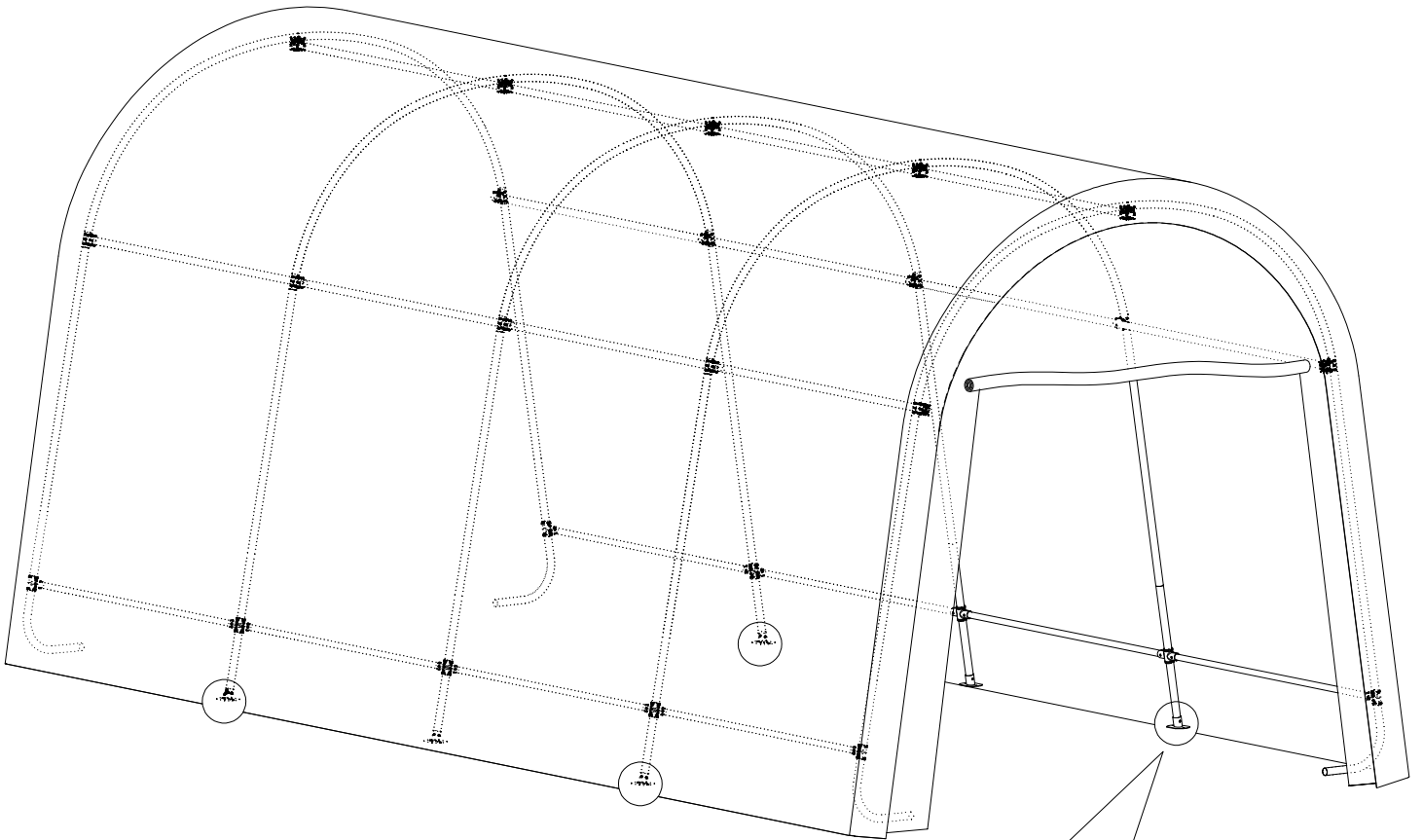

STEP 11
PASO 11

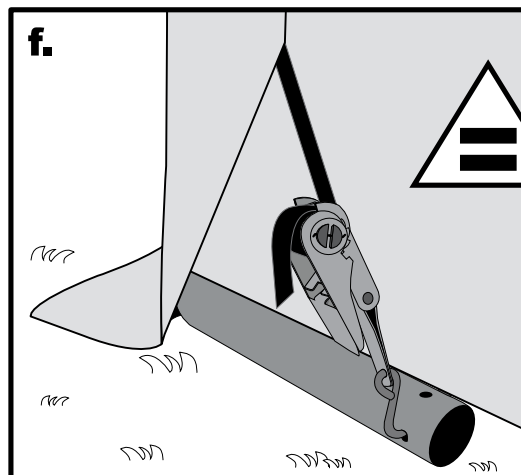
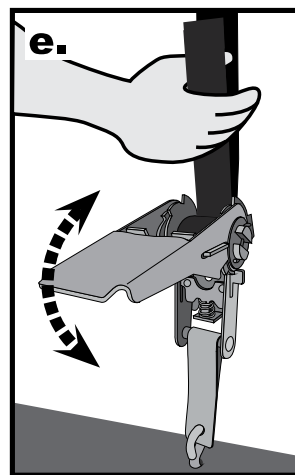
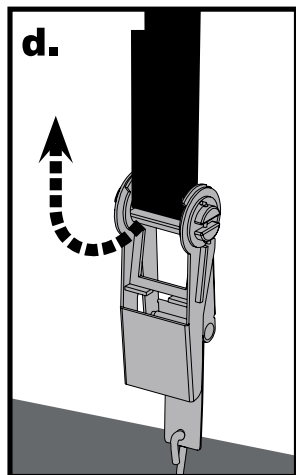
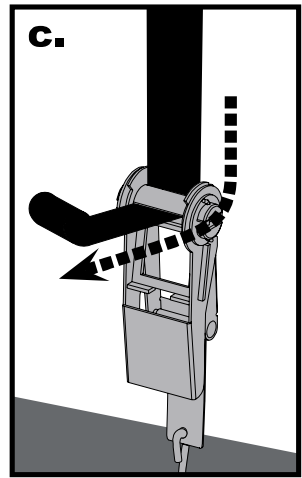
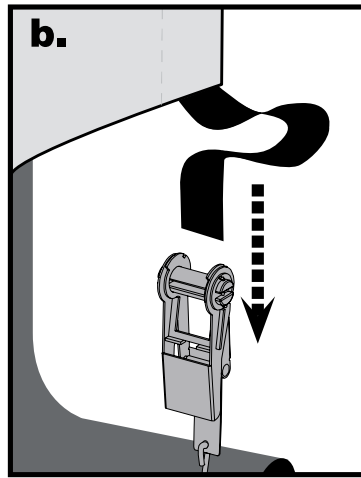
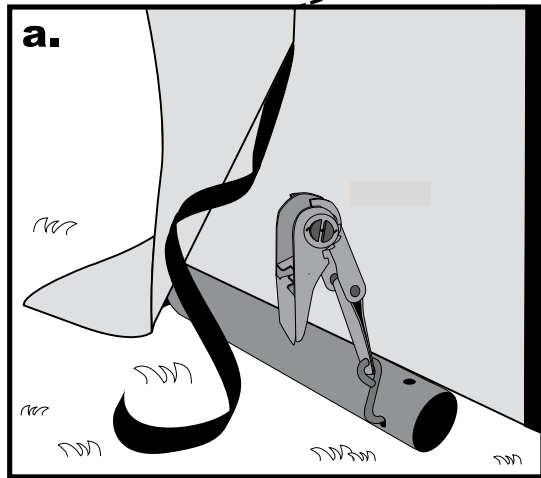
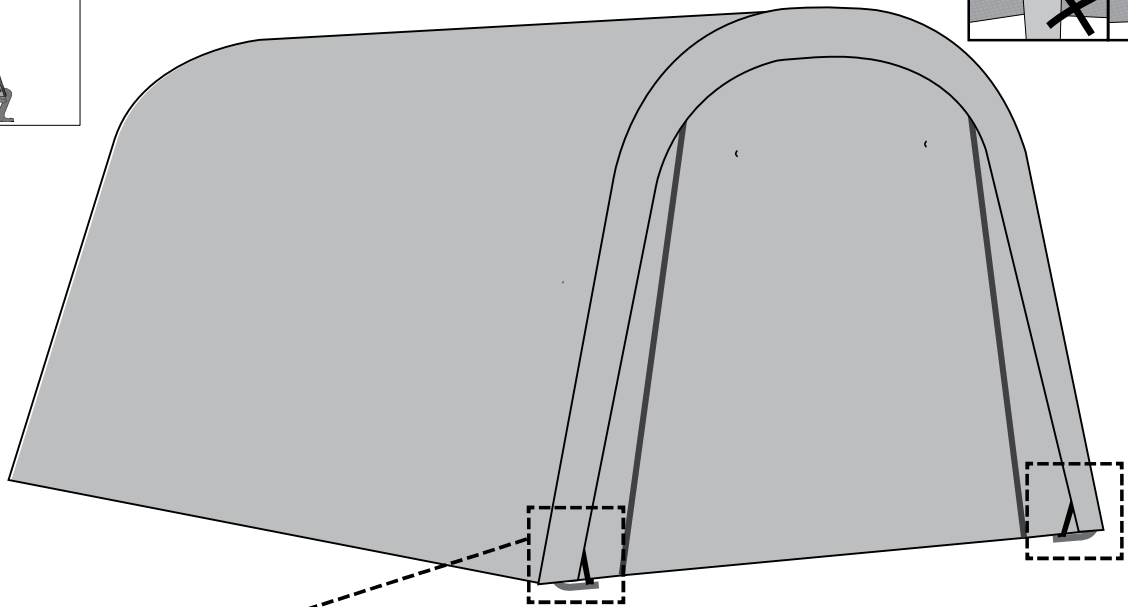
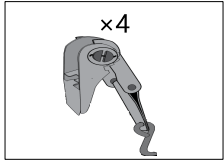
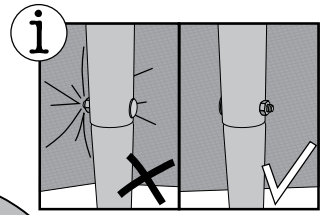
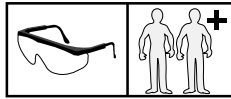

STEP 12

PASO 12

If you need to remove the top cover, please follow the following steps.
Si necesita quitar la cubierta superior, por favor siga los siguientes pasos.



1. Fasten the safety piece outward.
1. Asegurar la pieza de seguridad hacia afuera.



2. Open the tensioner to level.
2. Abrir el tensor a nivel.

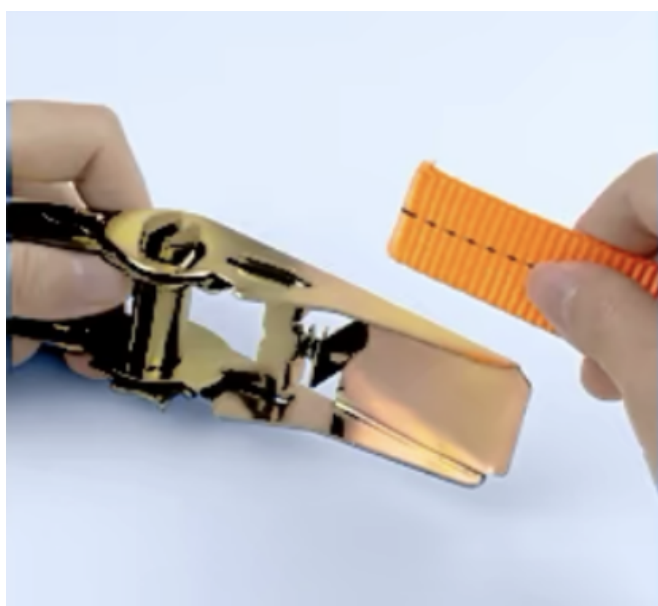

3. Pull out the webbing.
3. Tire de la cinta.



Contact Information

If you have any questions, concerns, or need assistance, please reach out to our customer support team using the contact information provided below:

Customer Support Email

support@royalcraft.store



Información de Contacto

Si tiene alguna pregunta, inquietud o necesita asistencia, por favor, póngase en contacto con nuestro equipo de atención al cliente utilizando la información de contacto proporcionada a continuación:

Información de Contacto

support@royalcraft.store