

Frame installation guide

1. Remove shrink wrap from around frame.

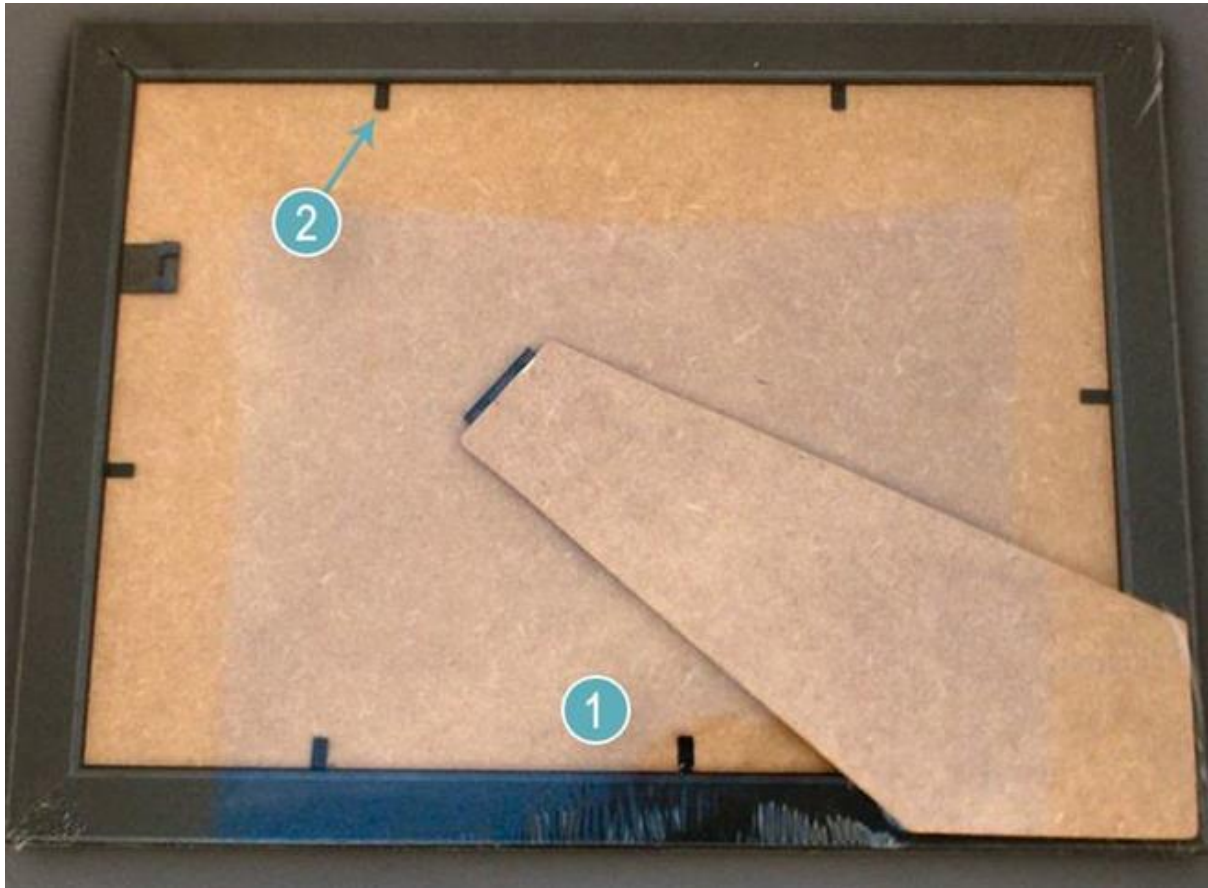

2. Lift metal tabs holding backboard into the frame
3. Remove backing board
4. Remove protective film from both sides of the Perspex sheet.

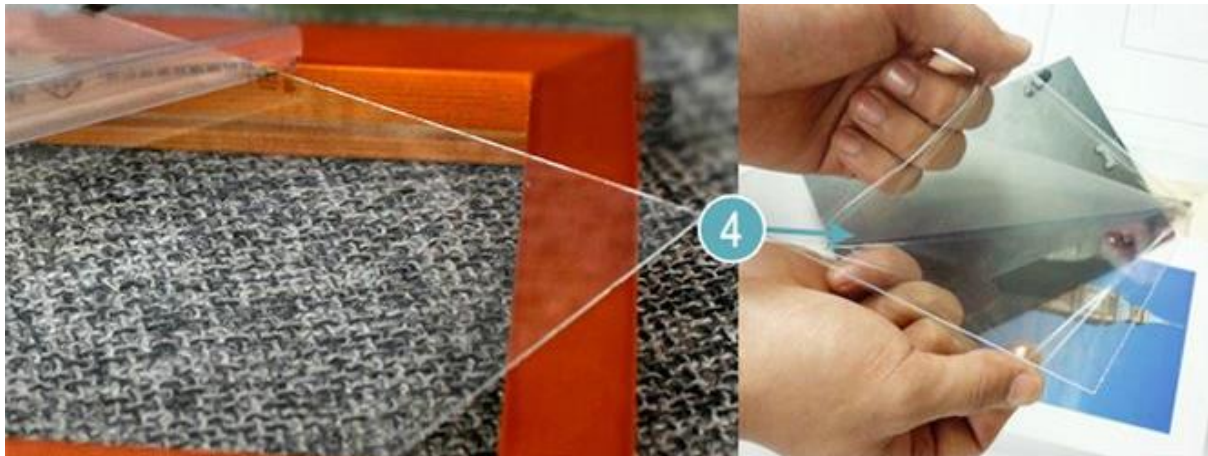

5. Place the hanging hook in the desired location for portrait or landscape orientation.



6. Insert Picture/Poster
7. Replace the backing board and secure with metal tabs
8. Hang on the wall and Enjoy.