

MARMOLUX

Towel Ring/ Toilet Paper Holder/ Towel Hook

For instructions, please
scan the QR code below



Installation (Mounting Bracket in product bottom)

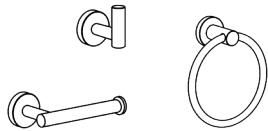

Allen Key



Wall Plug



Screw

1

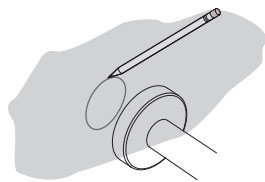

Place Towel Ring/Toilet Paper Holder/
Towel Hook on the wall in the desired position.
Mark the outline on the wall with a pencil.

2

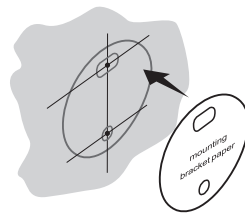

Place the template card over the pencil
outline. Mark the 2 drill holes
according to the template.

3

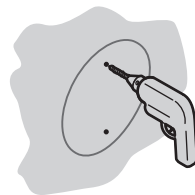

Use 1/4" or 6mm drill bit and drill holes.
The depth should be equivalent to the
length of the wall plug provided.

4

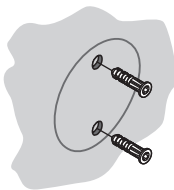

Push the wall plugs into the drilled holes, you may need to use a hammer to tap them in. Ensure the entire length is in the hole.

5

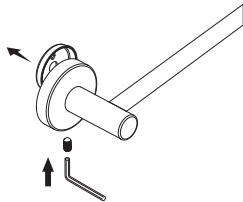

Use the provided allen key/wrench to loosen the small setting screw and remove the mounting bracket from the body.

6

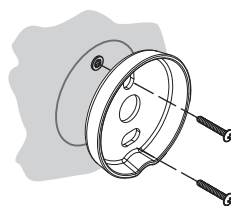

Using a screw driver, tighten the mounting bracket to the wall with the screws provided.

7

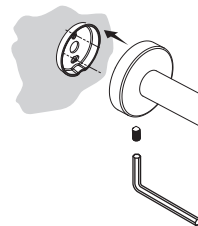

Place the product over the mounting bracket and tighten the setting screw underneath to secure the product.

For extended warranty,
please visit the QR code below

