

Kitchen Faucet Installation

Tools You Will Need :



Adjustable wrench



Philips Screwdriver



Hexagon Wrench



Pipe Tape

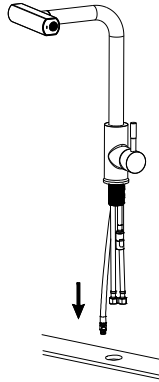

Step1:
Put all hoses of faucet through sink or countertop hole.

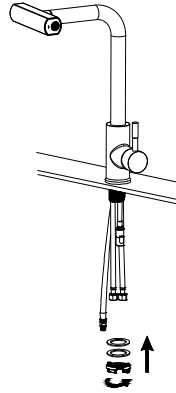

Step2:
Put the rubber washer, metal washer and fixing nut into the bottom of the faucet in turn.

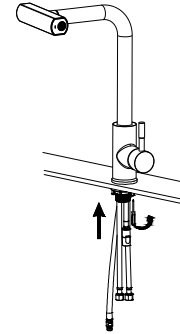

Step3:
Then tighten the screws.

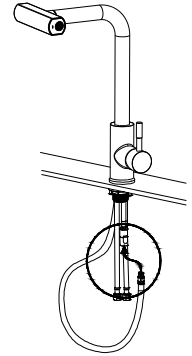

Step4:
Connect the hose of the sprayer to the water outlet.

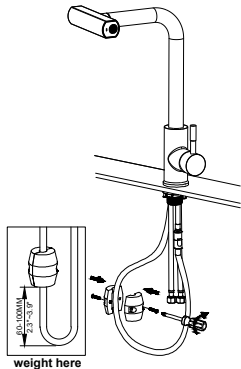

Step5:
Install the weight near the end of the pull-down hose. The optimal place is about 2.3-3.9 inches (60-100mm) from the lowest of the pull-down hose.

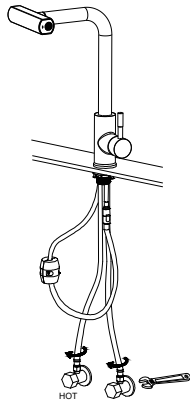

Step6:
Connect the hot & cold supply hose onto the matching water valves and secure the connection with an adjustable wrench.

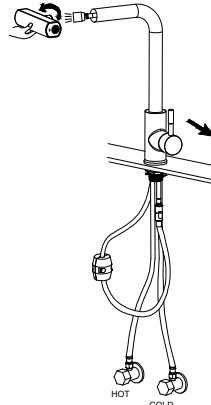

Step7:
Turn faucet on and let the water run for 60 seconds to flush any valves and secure the connection with an adjustable wrench.

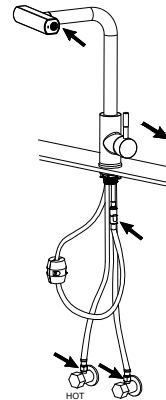

Step8:
Open the water supply valves and let the water flow. Check for the connections whether leak. If leaking, please re-tighten.

1. Please check that all components are present
2. Before installation ensure that all feed lines are clear of debris and on/off valve is present
3. Ensure water pressure is between 20-125 PSI (includes combination of hot and cold feed lines)
4. Pictures in the manual are general in content and may not represent exactly your purchased faucet. If you are having difficulties please contact a professional plumber
5. If you will be away from home for an extended period you should shut off the main water supply.

Daily maintenance

1. Use a soft cloth and vinegar to remove hard-water spots.
2. Check aerator (if present) regularly for calcium build up are when water stream is not optimum
3. DO NOT use caustic cleaning products as the use will break down finish and will void the product warranty.
4. Acceptable cleaners include vinegar or mild non-abrasive liquid detergents.
5. If the water pressure appears to be less than optimum, remove, inspect, clean or replace aerator.