

CARTON B PART LIST

D Seat Frame

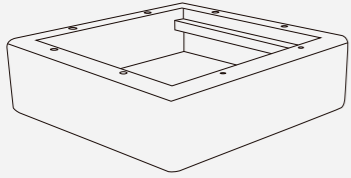

x1

E Seat Frame Cover

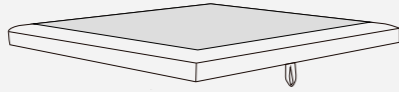

x1

F Seat Cushion

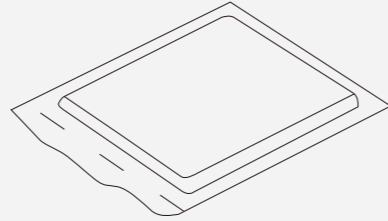

x1

G Pillow

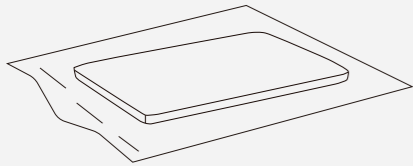

x1

H Backrest

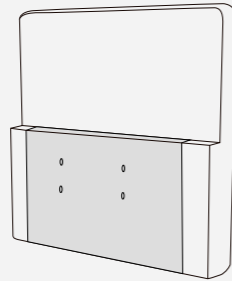

x1

C Plastic Leg

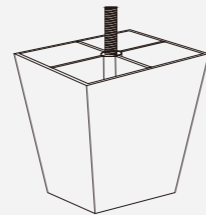

x5

1 Armrest / Backrest Fitting

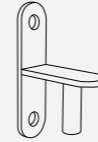

x2

2 Plastic Washer

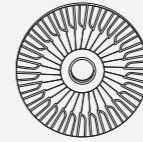

x5

3 Screw



x4

5 Seat Fitting

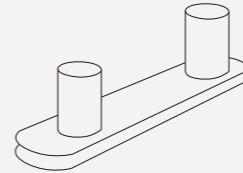

x2

CARTON B ASSEMBLY

Step1:

Seat frame and backrest are in carton B ,Remove all parts from the carton B, Place them on protected surface or carpet.

Step2:

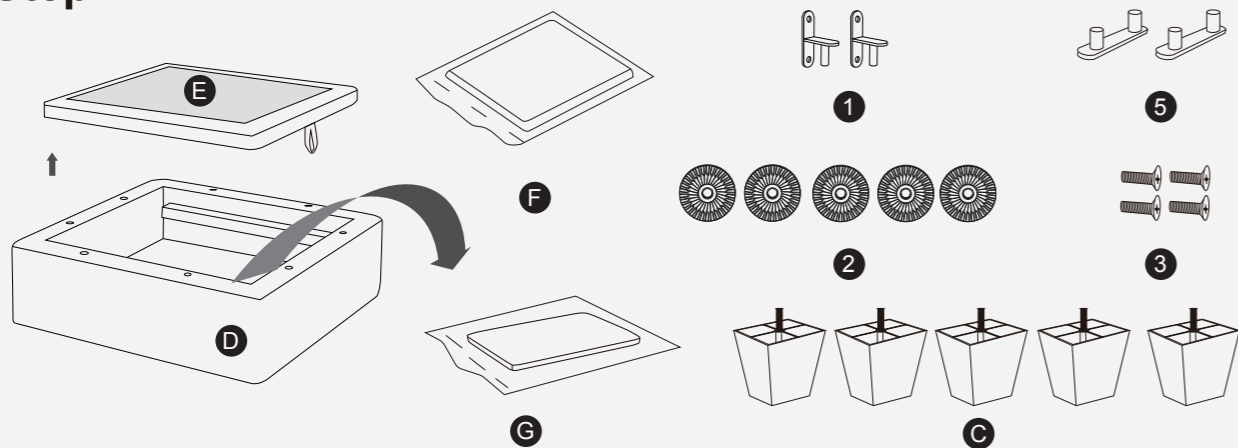

Step3:

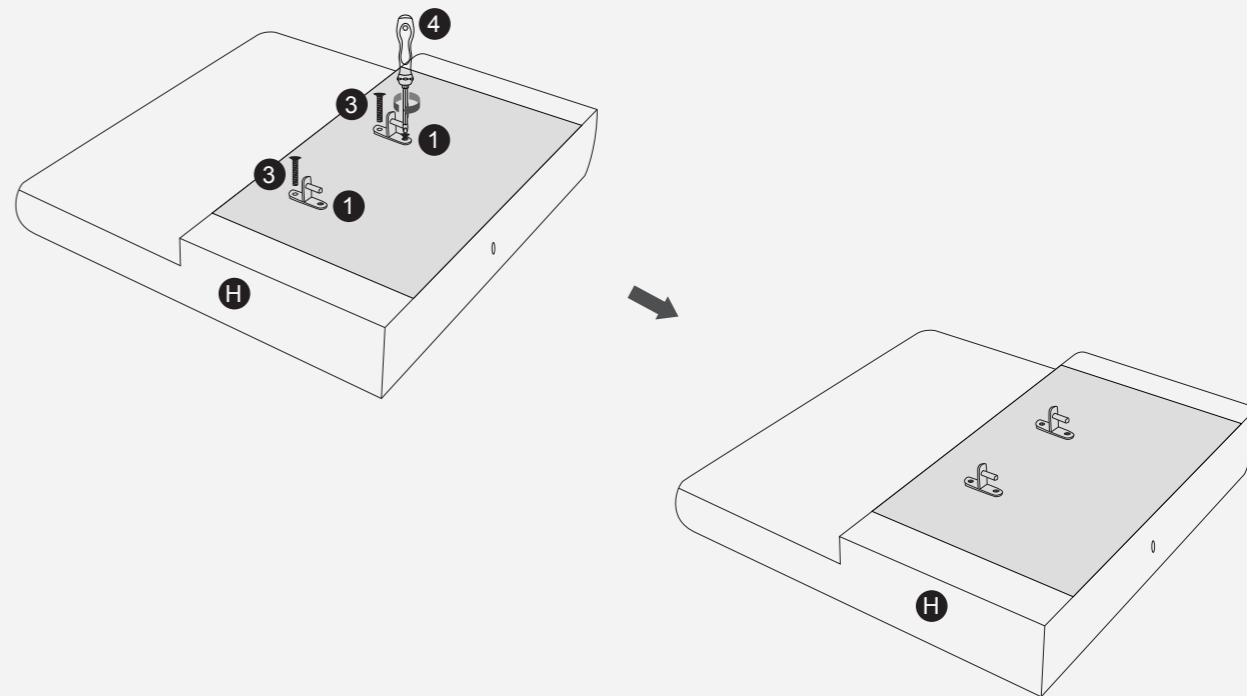

Step4:

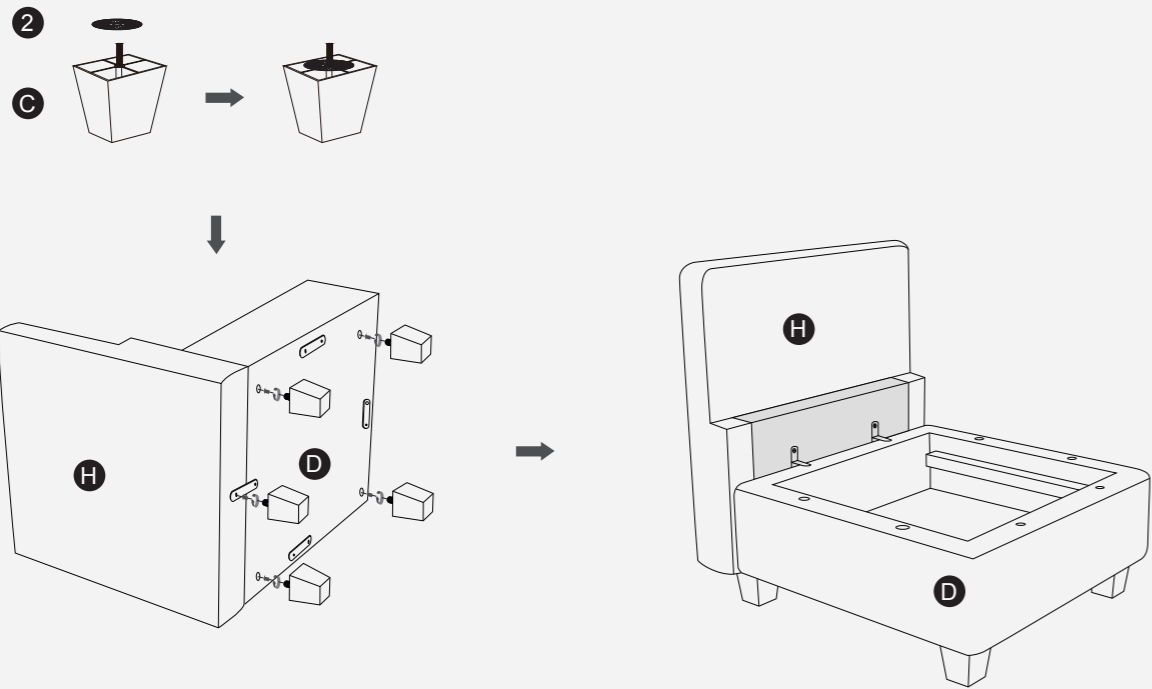

Step5:

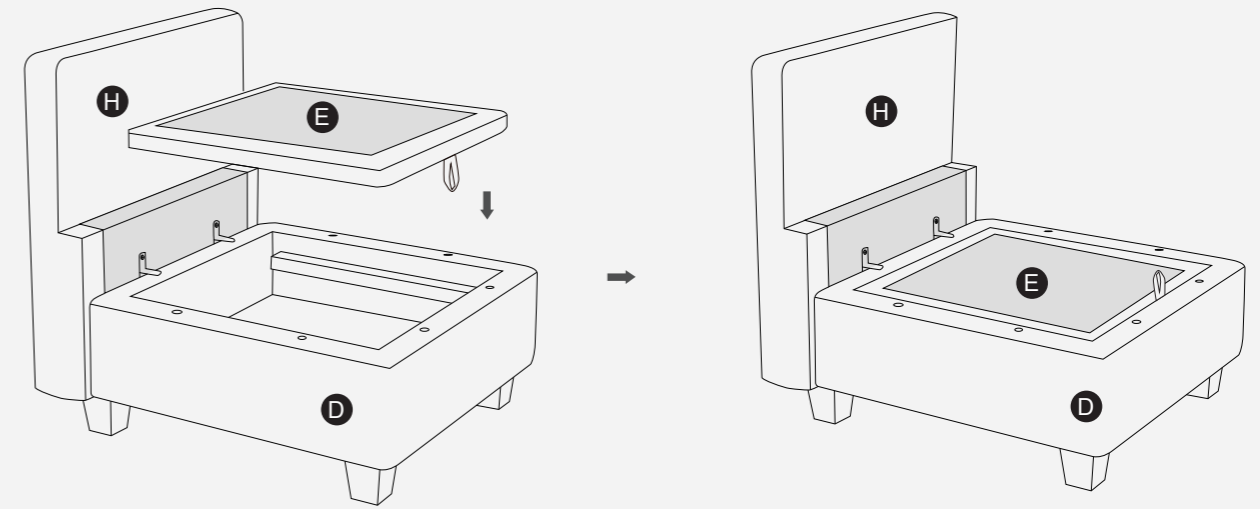

Step6:

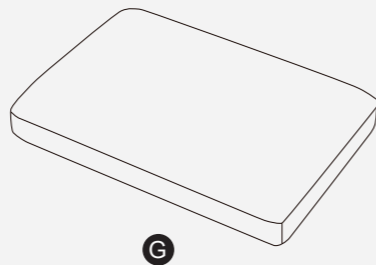
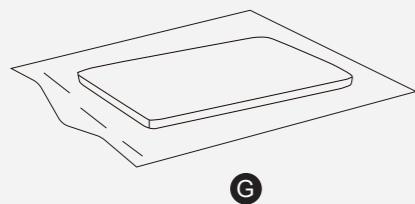
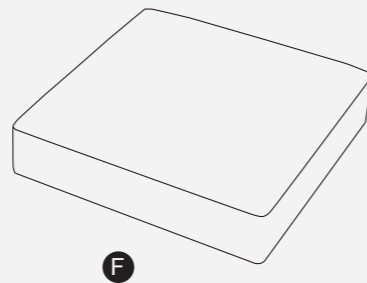
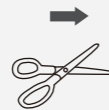
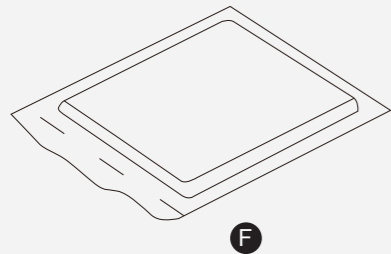

Step7:

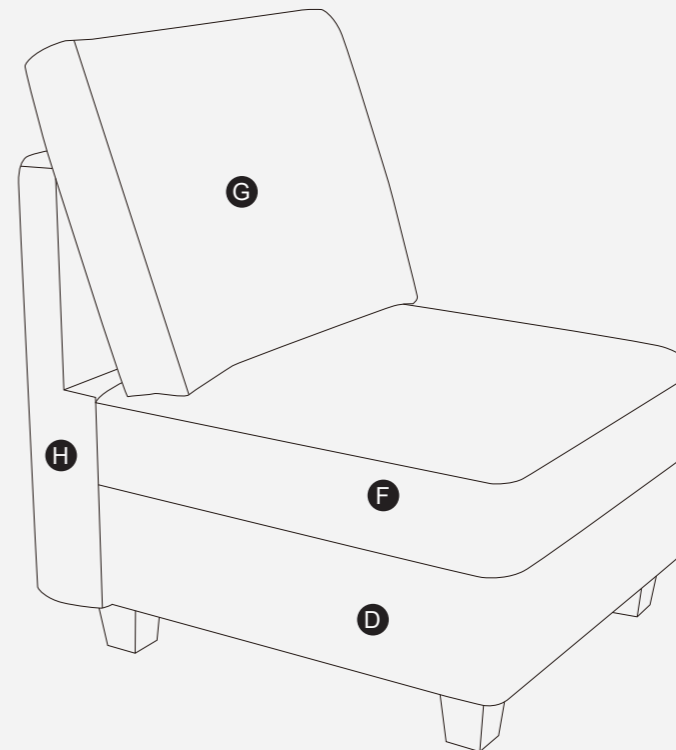

Link Seat Frame and Seat Frame

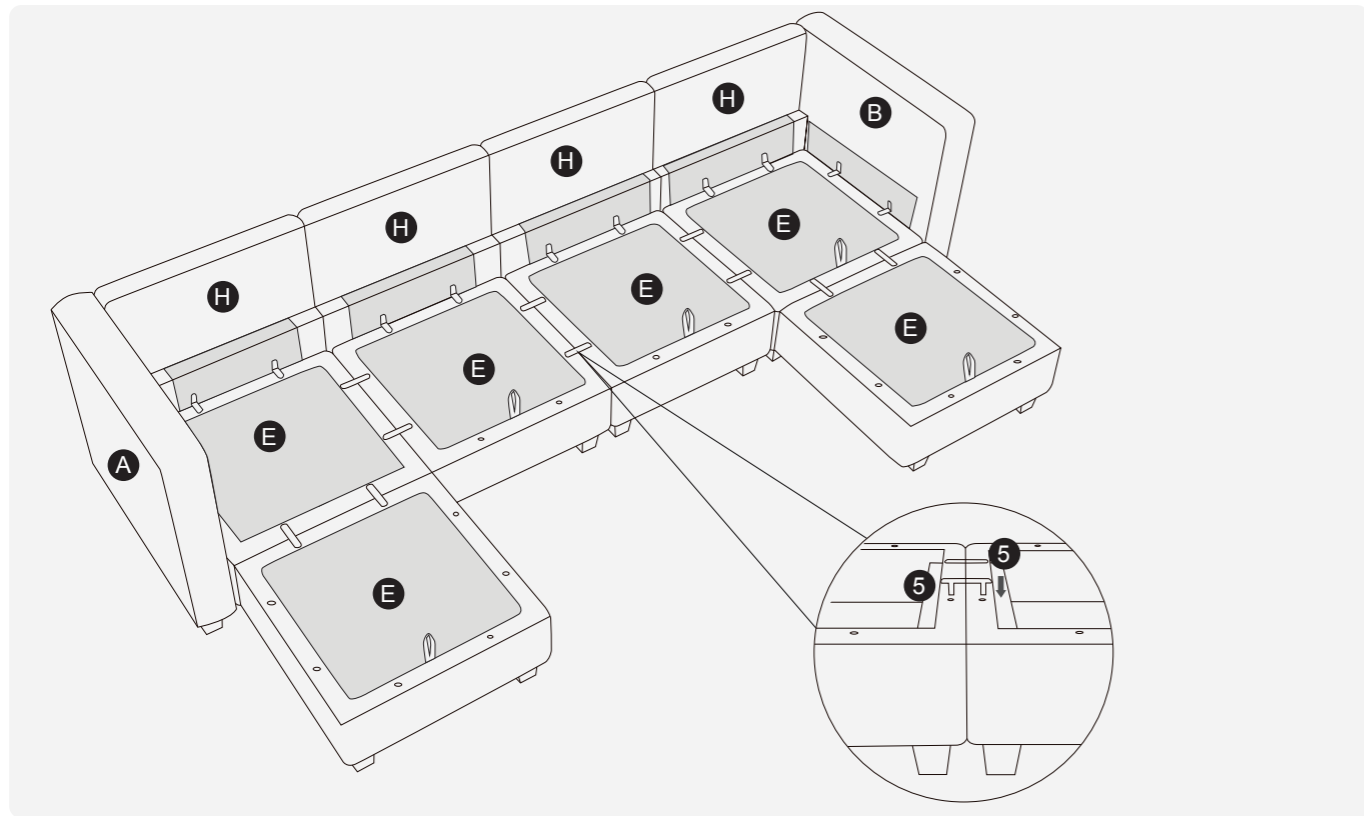

If you have bought other modules (carton A/ carton C) , you can use connectors to insert into the holes to connect with other modules to form a modular sofa.

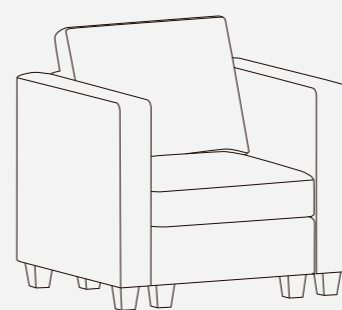

Carton(A+B)

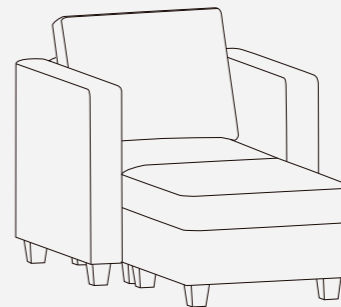

Carton(A+B+C)

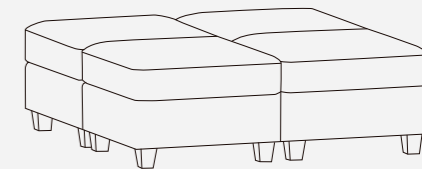

Carton(4C)

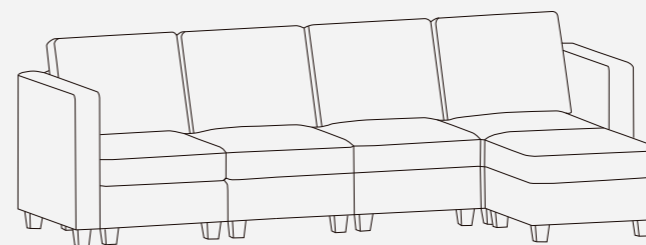

Carton(A+4B+C)

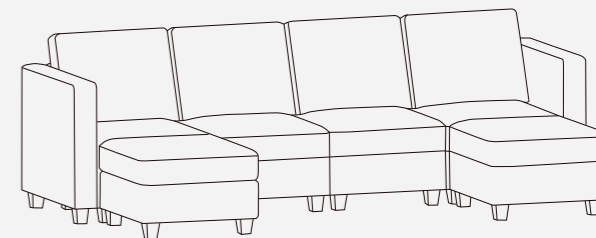

Carton(A+4B+2C)