

INSTRUCTION MANUAL

| | | |
|------------------|----------------|---------------|
| Model Number | FR-DR-S03R | FR-DR-S04R |
| Rated Power | 90W | 120 |
| Rated Voltage | 110*130V~ 60HZ | 110-130V-60HZ |
| Dimensions (mm) | 950*190*80mm | 950*300*80MM |

1. Basic description:

1.1. Power specifications: AC230V/50HZ

1.2. Temperature range: 0-55 °C

1.3. Set temperature range: 30-60 °C

1.4 BOOST mode: 1-hour step

1.5. System modes: Constant temperature mode, BOOST mode

2. Digital display instructions

2.1. Shutdown state: The digital display does not show as shown in the picture.



2.2. Constant temperature mode: adjustable temperature range of 30 °C -60 °C as shown in the figure.



2.3 BOOST mode: The heating time can be set from 1 to 8 hours, as shown in the figure.

2.4. Heating status: The device is turned on for heating (flashing at the selected box) as shown in the figure.

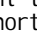
3. Operating instructions

3.1. Power on/off: Short press  to turn on the device and enter constant temperature mode.

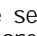
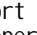
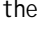
3.2. Set the constant temperature mode temperature: To enter the constant temperature mode, short press  the digital tube to flash, set the temperature to 5 °C, set the temperature until it reaches 60 °C, then short press again to set  the temperature back to 30 °C. After 5 seconds of no operation after setting, the digital display stops flashing when entering the working state.

Enter BOOST mode: Long press  and hold for 5 seconds in constant temperature mode to enter BOOST  mode. BOOST mode defaults to 2 hours, and the heating time is set in the same way as the set temperature. Short press  the digital tube to flash, increase the time by 1 hour, and set the time  until it reaches 8 hours. Short press  the set time again to return to 1 hour. After 5 seconds of no operation  er setting, the digital display stops flashing when entering the working state. When the heating time is over, the device will automatically shut down.



SAFETY INSTRUCTIONS Please read these instructions before operating the appliance.

- Electrical installation must be carried out by a qualified professional in accordance with the latest edition of the IEE wiring regulations.
- Appliance must be earthed.
- A means for electrical disconnection must be incorporated in the wiring in accordance with the latest wiring rules.
- Unit must be connected to a single phase supply with a mains voltage as specified on the rating plate.
- Do not carry the appliance by the supply cord.

Installation Wall Mounting • Ensure selected mounting surface is suitable for the weight of the product.



• In order to avoid a hazard for very young children, this appliance should be installed with lowest heated rail at least 600mm above the ground.

1



1. Select a location for a towel rail. Mark & drill the four holes in the wall and insert wall plug, then fix the wall plates by screws

2



2. and insert wall plug, then fix the wall plates by screws

3



3. Use screws to fix the 4 fixed bases on the wall. Note that a base with 3 connection holes should be used on the side where the wires are connected

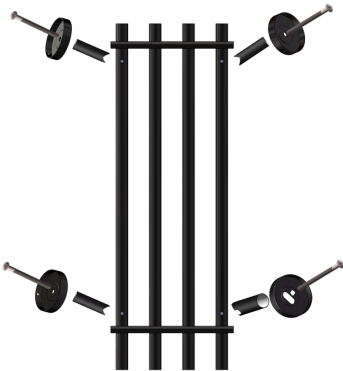

4. Connect the brackets to the back of the towel rail. Tighten each bracket tightly enough, that the

circular plate is firmly held in place and does not rotate.

5. Buckle the four decorative covers of the towel rack into the four fixed bases on the wall, Secure the supports by tightening the allen screws.

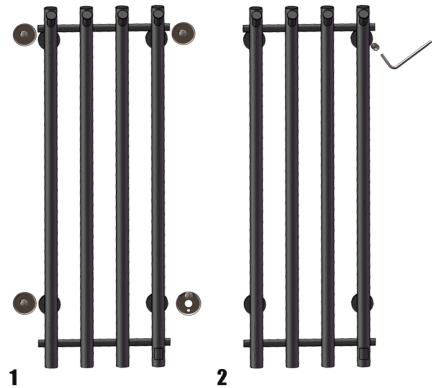

Accessories include: 4 connecting rods, 3 single hole bases, 1 double hole base, 3 single hole decorative covers, 1 double hole decorative cover, 4 expansion rubber particles, 4 self tapping screws, 4 small screws, 4 long fixing screws, 1 small hex wrench

1. plug-in

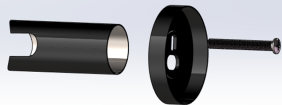

The wire comes out of the U-shaped groove

1. Green Line - Ground Line
2. White line - neutral line
3. Black wire - live wire

2. hard-wired



Cut off the plug and connect the wires through the large hole in the decorative cover of the connecting rod to the pre-embedded wires in the wall

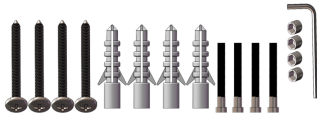

3 Однодырочное основание
1 Двойное основание



3 Однодырочная крышка
1 Двойная крышка



3 Кронштейн
1 Кронштейн с U-образным желобом