

①

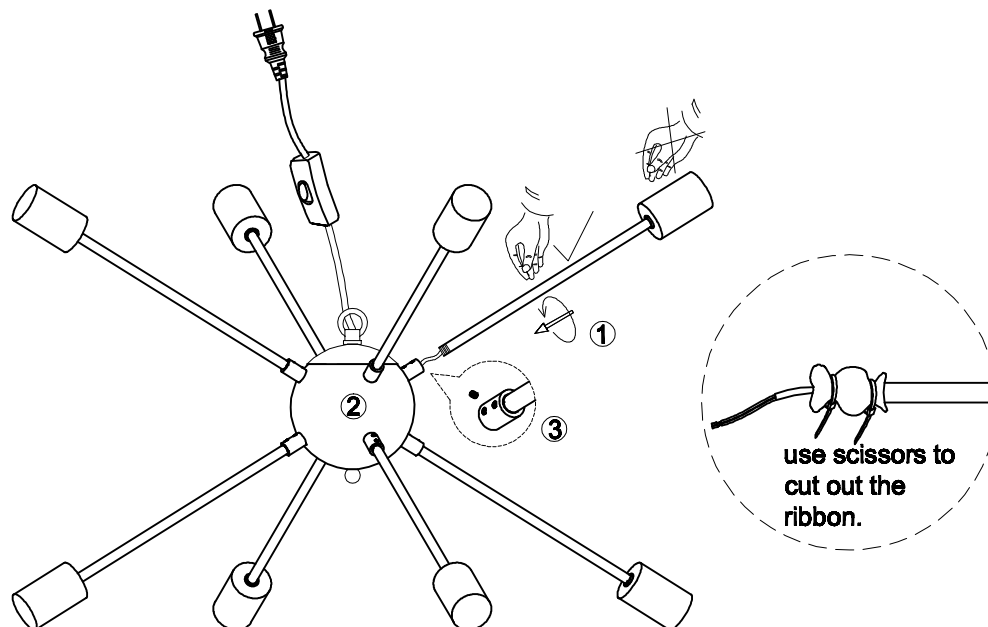

1. Rotate to fix the arms 1 to the ball 2, lock the arms 1 with grub screw.

②

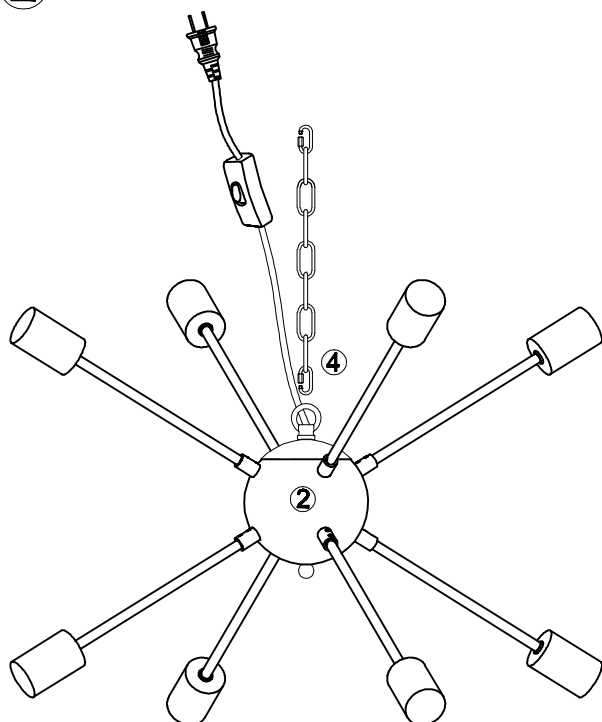

2. Install the chain 4 on the ball 2.

③

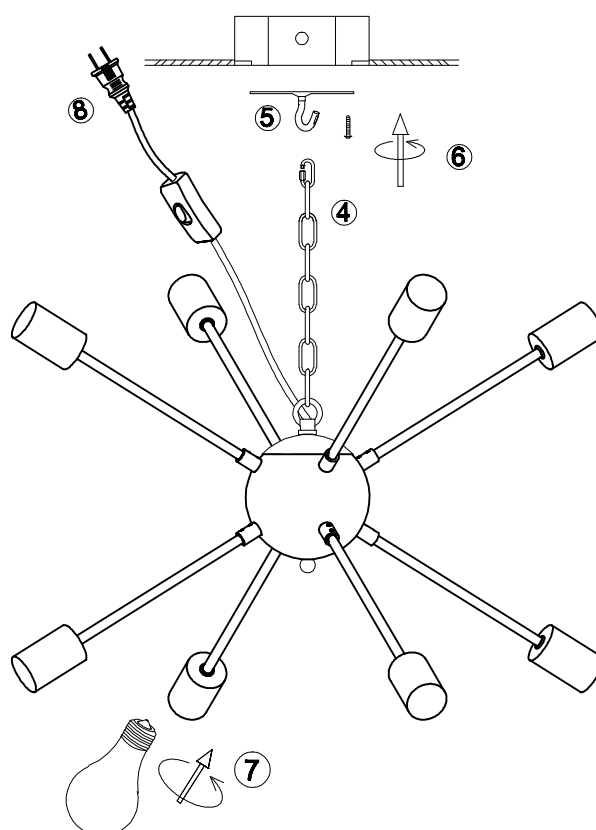

3. Install the hook 5 to the junction box with scrw 6.
4. Put the chain 4 on the hook 5.
5. Install the bulbs 7 and plug the switch 8 into the electric socket.

Please read carefully before installation!!!

Note : Please make sure that the electricity is powered off during installation !

Only a professional electrician should install this kind of product !