

# ASSEMBLY INSTRUCTIONS



## CAUTION

◆ Inspect the wire insulation for any cuts, abrasions, or exposed copper that may have resulted during shipping. If there is a defect in the wire, do not attempt installation.

◆ Before starting installation of this fixture or removal of a previous fixture, disconnect the power by turning off the circuit breaker or by removing the fuse at the fuse box.

## TOOLS REQUIRED

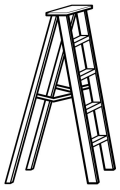

Ladder



Safety Goggles



Electrical Tape

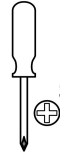

Phillips Screwdriver



Electroprobe Pen



Wire Cutter



Wire Stripper

## HARDWARE INCLUDED

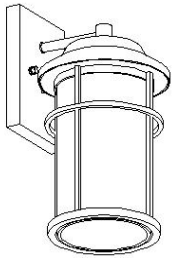

Fixtue

A

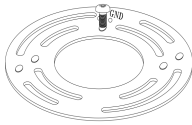

MountingUnit

B

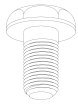

Screws

C



Nut x2

D

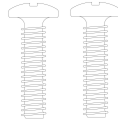

MountingScrews

E



WireNuts

F



Sheet iron

G

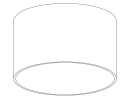

Iron hoop

H



Screws 2

**\*PARTS SHOWN MAY DIFFER SLIGHTLY PER LIGHT FIXTURE**

## EXPLODED PARTS

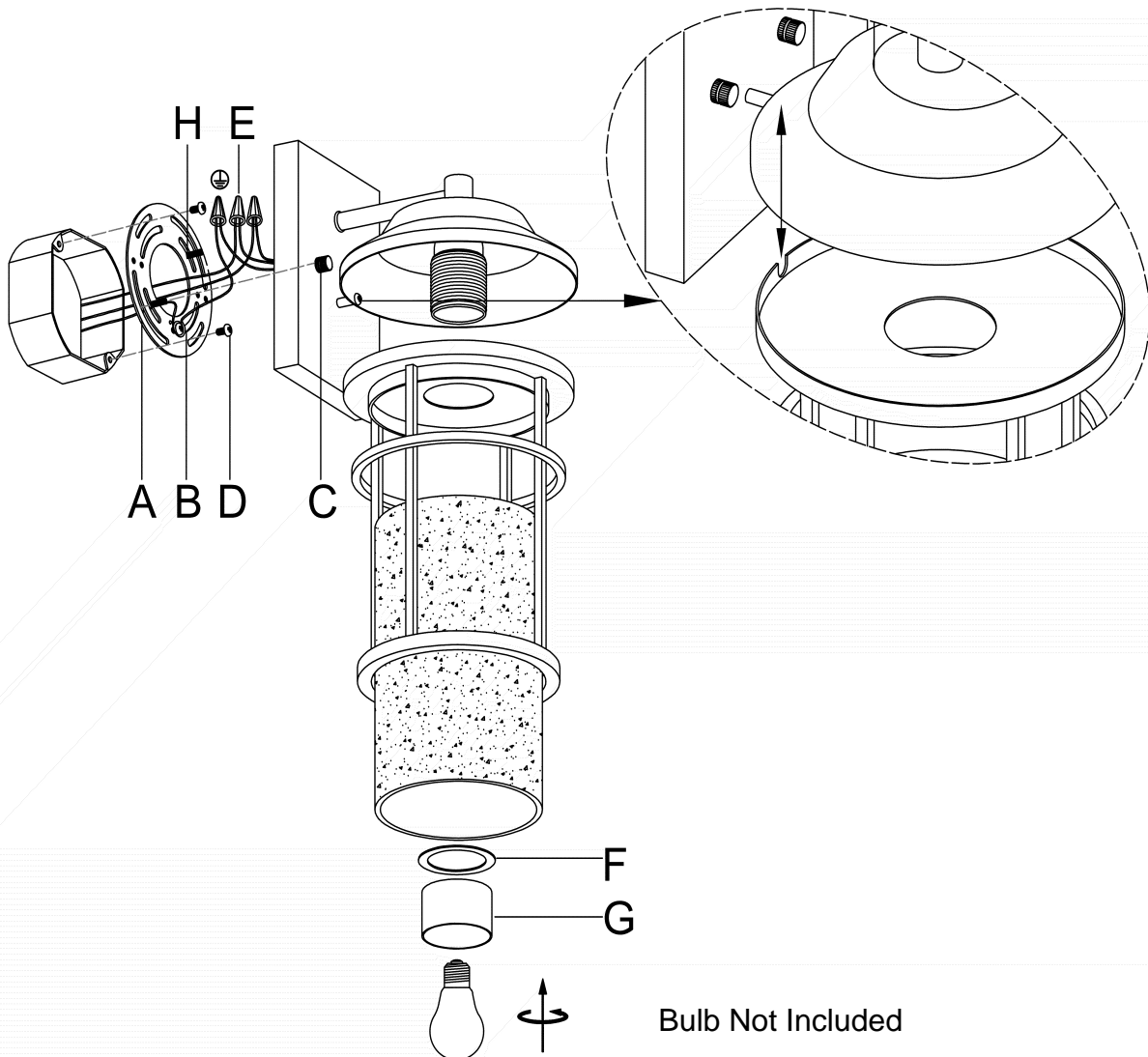

# INSTALLATION

## STEP 1

Unscrew the Screws from the mounting unit.  
Use the mounting screws to attach the mounting unit to the junction box.

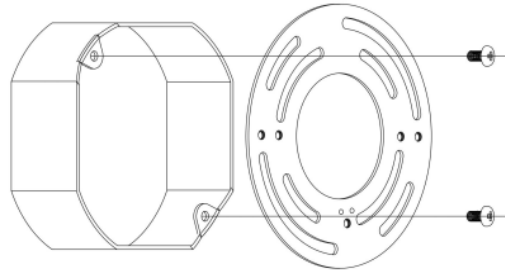

Mounting Screws

## STEP 2

Make the electrical connection from the junction box to the fixture  
Connect the ground wire to the mounting unit using the preinstalled green ground screw  
Then, connect the positive, negative and ground wires with the supplied wire nuts, Secure with electrical tape

Black or Red wire(hot)  
from the Junction box

white wire(neutral)  
from the Junction  
box

Bare or green ground wire  
from the Junction box

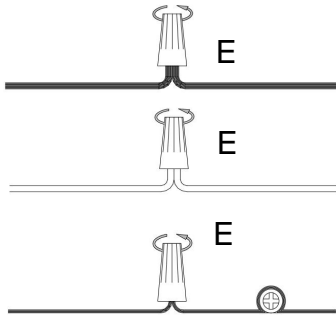

Black wire from  
the fixture

White wire from

the fixture  
Ground wire from

the fixture

Green Ground Screw

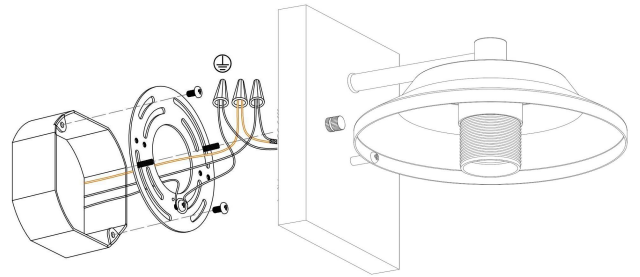

Sealing tape  
(not Included)

## STEP 3

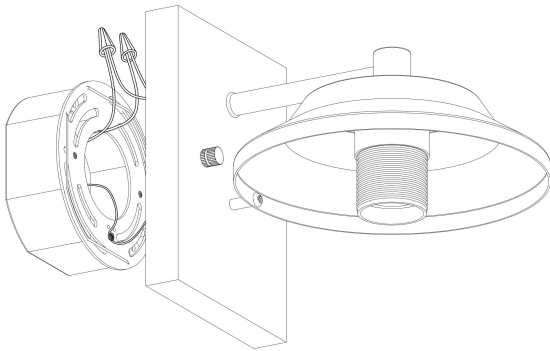

## STEP 4

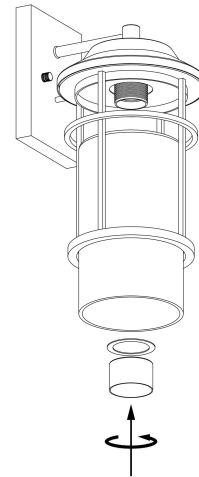

## STEP 5

