

Need Help Disassembling Your Stool?

For step-by-step instructions on how to disassemble your stool, please scan the QR code below to watch our tutorial video. Although the video may feature a different model, the disassembly process is the same across all our stools.

We're here to help you every step of the way!

Information About Hydraulic Cylinders for Stools

If your new stool cannot be adjusted in height, or the seat lowers when sat upon after assembly, please contact us to arrange for a replacement hydraulic cylinder.

Size & Availability

The hydraulic cylinder for our stools is universal and can be purchased from any vendor on various marketplaces. If you need a longer or shorter cylinder, search for "hydraulic cylinder for stools" on your preferred marketplace.

Understanding Hydraulic Cylinders

The hydraulic cylinder is consumable and will wear out over time with regular use. Its lifespan varies based on usage frequency and conditions. Typically, it requires replacement after a few years of regular use.

Maintenance Recommendations

Regularly check the cylinder's performance. If height adjustment becomes uneven or the stool fails to hold its position, it may be time for a replacement.

Step 1

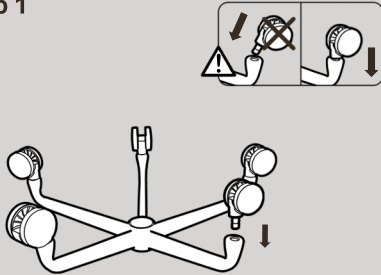

Set up Wheel Casters

Pop in five wheel casters into the corresponding holes on the leg base straightly.

Step 2

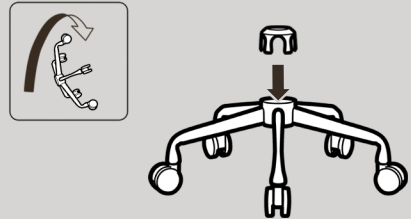

Set up the Leg Base

Flip the leg base to ensure it stands upright. Firmly place the metal collar cap at the center top of the leg base.

Step 3

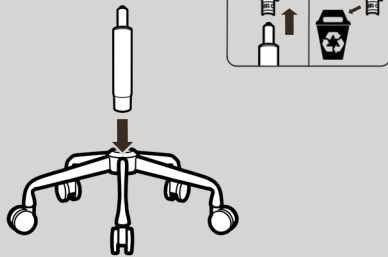

Set up the Hydraulic Cylinder

Remove the hydraulic cylinder cap. Insert the hydraulic cylinder into the center hole on the leg base.

Step 4

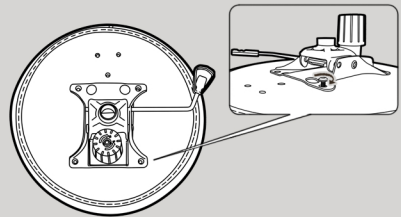

Set up the Seat

Secure the mount to the back of the seat using the four screws provided.

Step 5

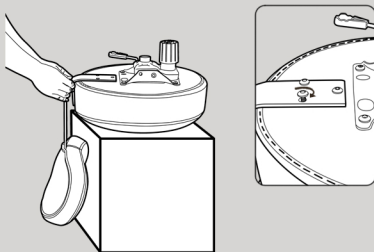

Set up the Backrest

Align the tail part of the L-shaped backrest bar with the three matching holes on the back of the seat. Secure the bar with the three screws provided.

Step 6

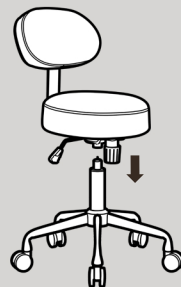

Set up the Seat

Connect the mount on the seat with the top of the hydraulic cylinder.